

Legal Description

SCIENTEL SOLUTIONS SUBDIVISION BEING A RESUBDIVISION OF LOT 6 (EXCEPT THAT PART CONVEYED TO THE COUNTY OF DUPAGE BY DOCUMENT NUMBER R1993-191752 AND DOCUMENT NUMBER R2004-318740) IN DIEHL INDUSTRIAL PARK ASSESSMENT PLAT NO., 2 OF PART OF THE WEST 739 FEET OF TRACT 2 IN ASSESSMENT PLAT OF CULVER FARM AND THE HARRIS FARM OF PART OF SECTIONS 5, 6, 7 AND 8, TOWNSHIP 38 NORTH, RANGE 9 EAST OF THE THIRD PRINCIPAL MERIDIAN, ACCORDING TO THE PLAT THEREOF RECORDED AUGUST 19, 1964 AS DOCUMENT R64-30327, IN DUPAGE COUNTY, ILLINOIS.

Locator Map

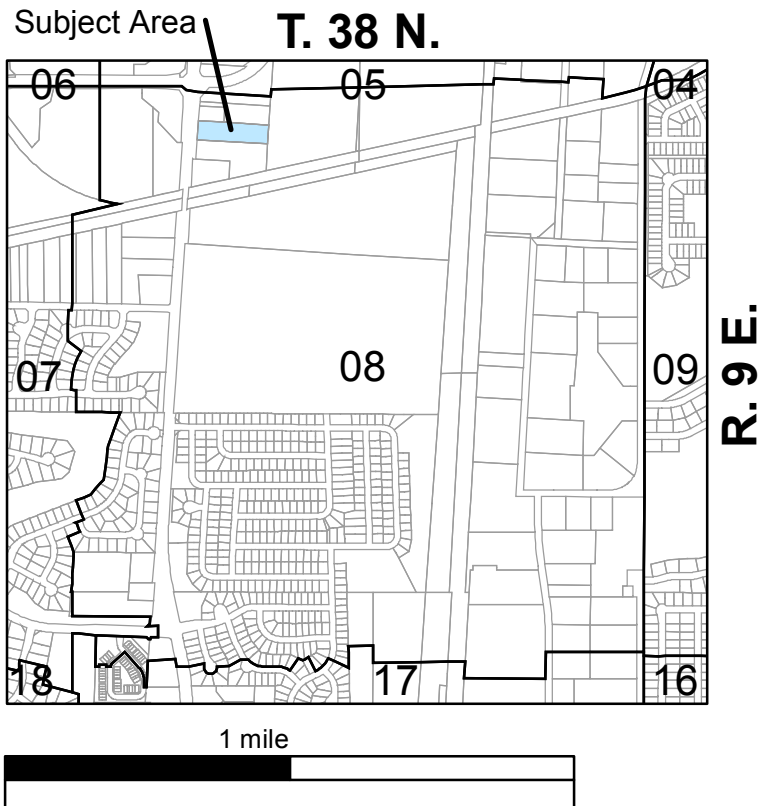

Actual Area

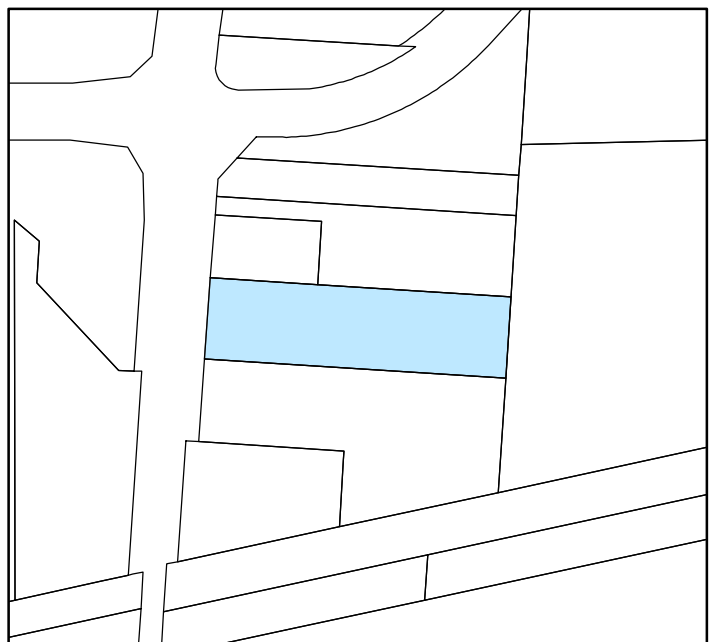

PIN(s)

07-08-103-020

Common Address

Vacant Land
2021 N. Eola Rd.

