

Legal Description

LOT 7 IN FINAL PLAT WATERFORD UNIT NO. 2,
BEING A SUBDIVISION OF PART OF THE
SOUTH HALF OF SECTION 25 AND PART
OF THE NORTH HALF OF SECTION 36,
TOWNSHIP 38 NORTH, RANGE 8 EAST
OF THE THIRD PRINCIPAL MERIDIAN,
ACCORDING TO THE PLAT THEREOF
RECORDED MARCH 2, 2000 AS DOCUMENT
NO. 2000K015250, IN KANE COUNTY, ILLINOIS.

Locator Map

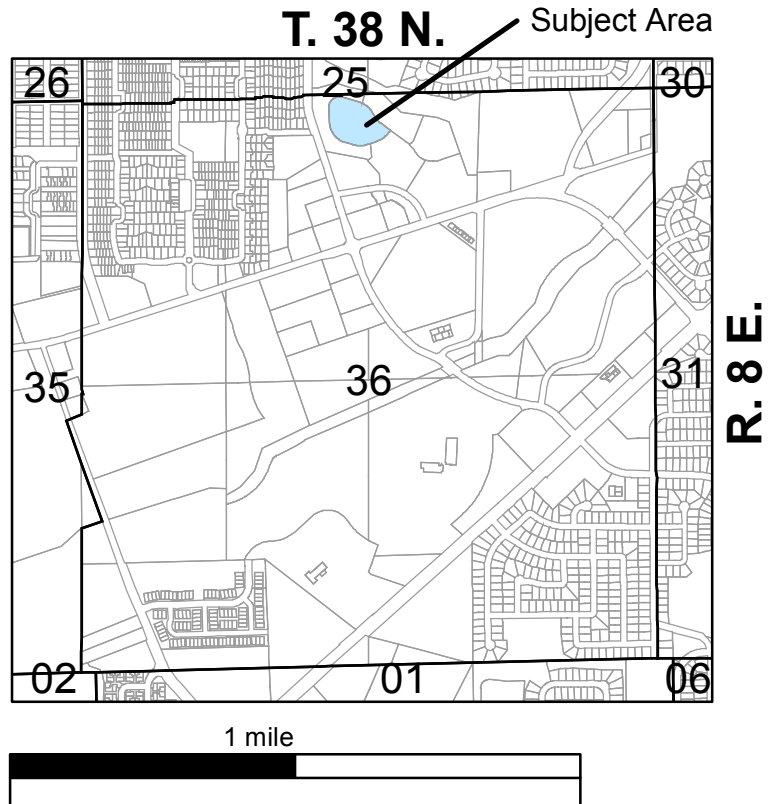

Actual Area



PIN(s)

15-36-127-002

Common Address

Vacant Land
1865 Audra Cr.

