

Property Research Sheet**Location ID#: 61638***As of: 12/1/2014**Researched By: Tracey Vacek*Address: 34W015 Butterfield RoadSchool District: SD 101 - Batavia School DistrictParcel Number(s): 12-36-300-006Park District: BPD - Batavia Park DistrictSize: 0.650 AcresWard: 11929 Zoning: Not ApplicableHistoric District: None1957 Zoning: Not ApplicableANPI Neighborhood: Big Woods MarmionComp Plan Designation: CommercialTIF District: N/A**Current Land Use**

Current Land Use: Vacant Land/Open Space**Zoning Provisions**

There is no Zoning Provisions since this property is unincorporated and is not within the City Limits.

Legislative History

There is no legislative history for this Property.

Location Maps Attached:

Aerial Overview

Aerial Map

Zoning Map

Comprehensive Plan Map

Property Research Sheet**Location ID#: 61640***As of: 12/1/2014**Researched By: Tracey Vacek*Address: 33W991 Butterfield RoadSchool District: SD 101 - Batavia School DistrictParcel Number(s): 12-36-300-009Park District: BPD - Batavia Park DistrictSize: 1.05 AcresWard: 11929 Zoning: Not ApplicableHistoric District: None1957 Zoning: Not ApplicableANPI Neighborhood: Big Woods MarmionComp Plan Designation: CommercialTIF District: N/A**Current Land Use**

Current Land Use: Vacant Land/Open Space**Zoning Provisions**

There is no Zoning Provisions since this property is unincorporated and is not within the City Limits.

Legislative History

There is no legislative history for this Property.

Location Maps Attached:

Aerial Overview

Aerial Map

Zoning Map

Comprehensive Plan Map

Property Research Sheet**Location ID#: 61631***As of: 12/1/2014**Researched By: Tracey Vacek*Address: VacantSchool District: SD 101 - Batavia School DistrictParcel Number(s): 12-35-477-006Park District: BPD - Batavia Park DistrictSize: 0.37 AcresWard: 11929 Zoning: Not ApplicableHistoric District: None1957 Zoning: Not ApplicableANPI Neighborhood: Big Woods MarmionComp Plan Designation: CommercialTIF District: N/A**Current Land Use**

Current Land Use: Vacant Land/Open Space**Zoning Provisions**

There is not Zoning Provisions since this Property is unincorporated and is not within the City Limits.

Legislative History

There is no legislative history for this Property.

Location Maps Attached:

Aerial Overview

Aerial Map

Zoning Map

Comprehensive Plan Map

Location Map (1:5,000):

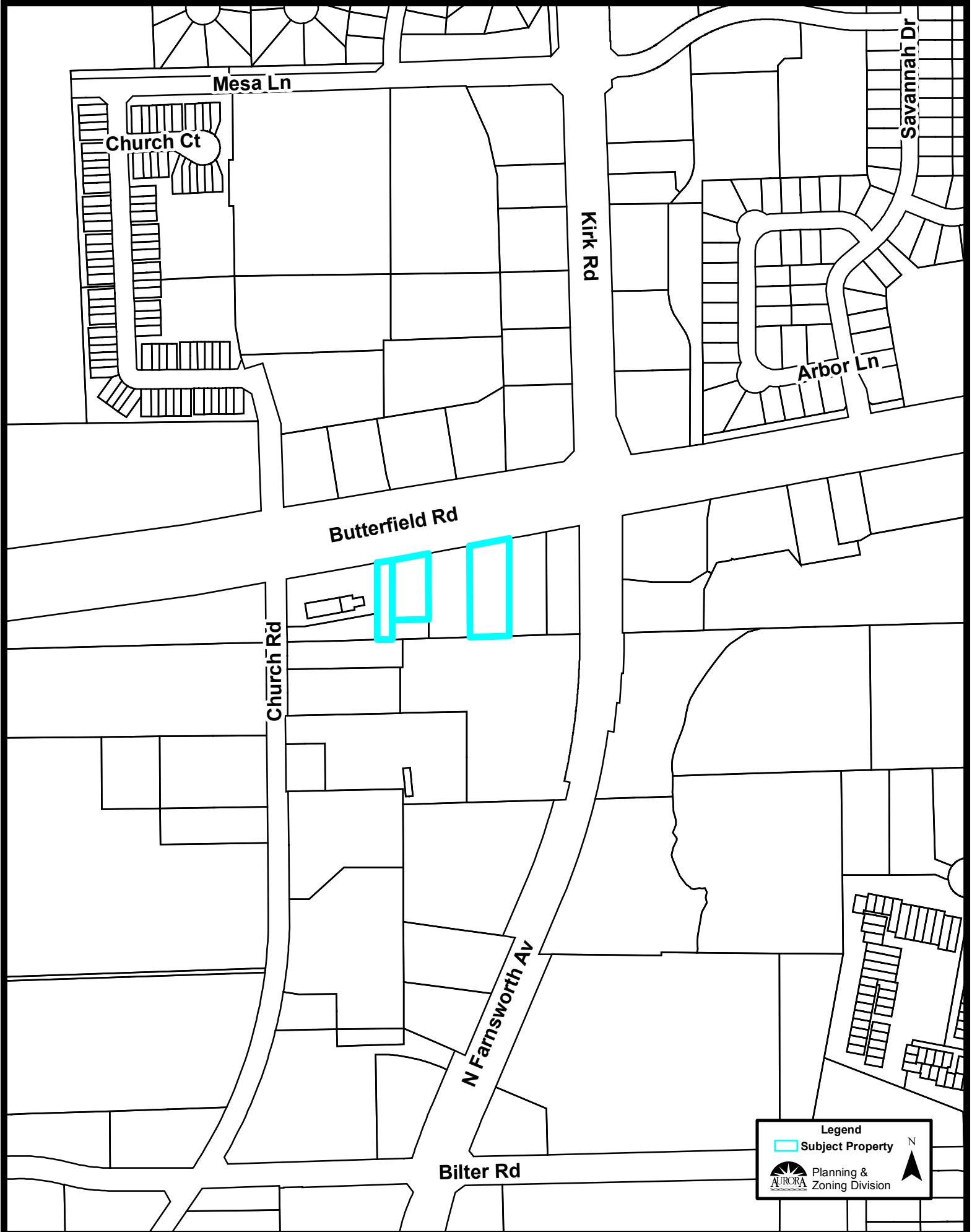

Legend

-  Subject Property

 Planning & Zoning Division

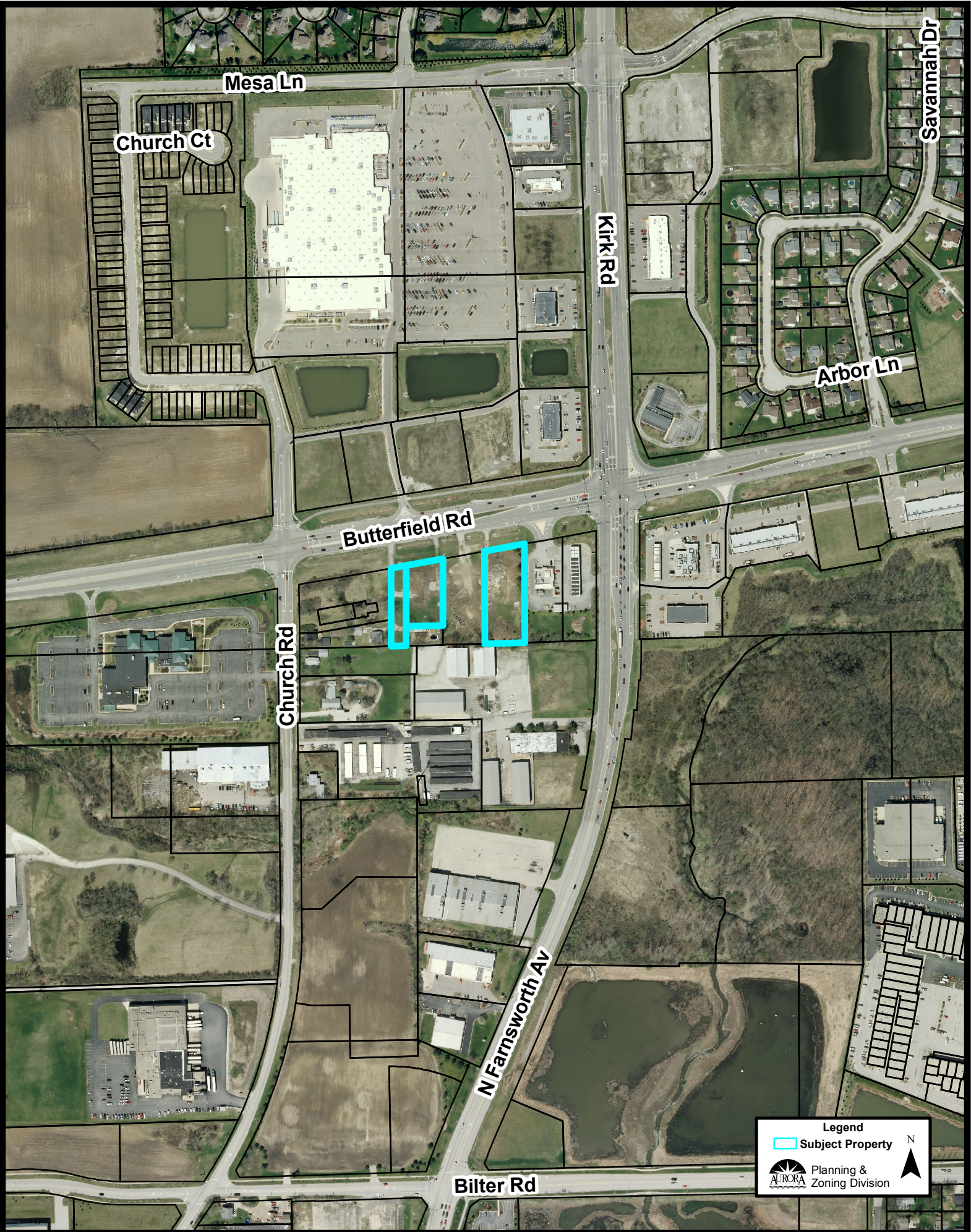

 N



Legend

- Subject Property

Planning & Zoning Division



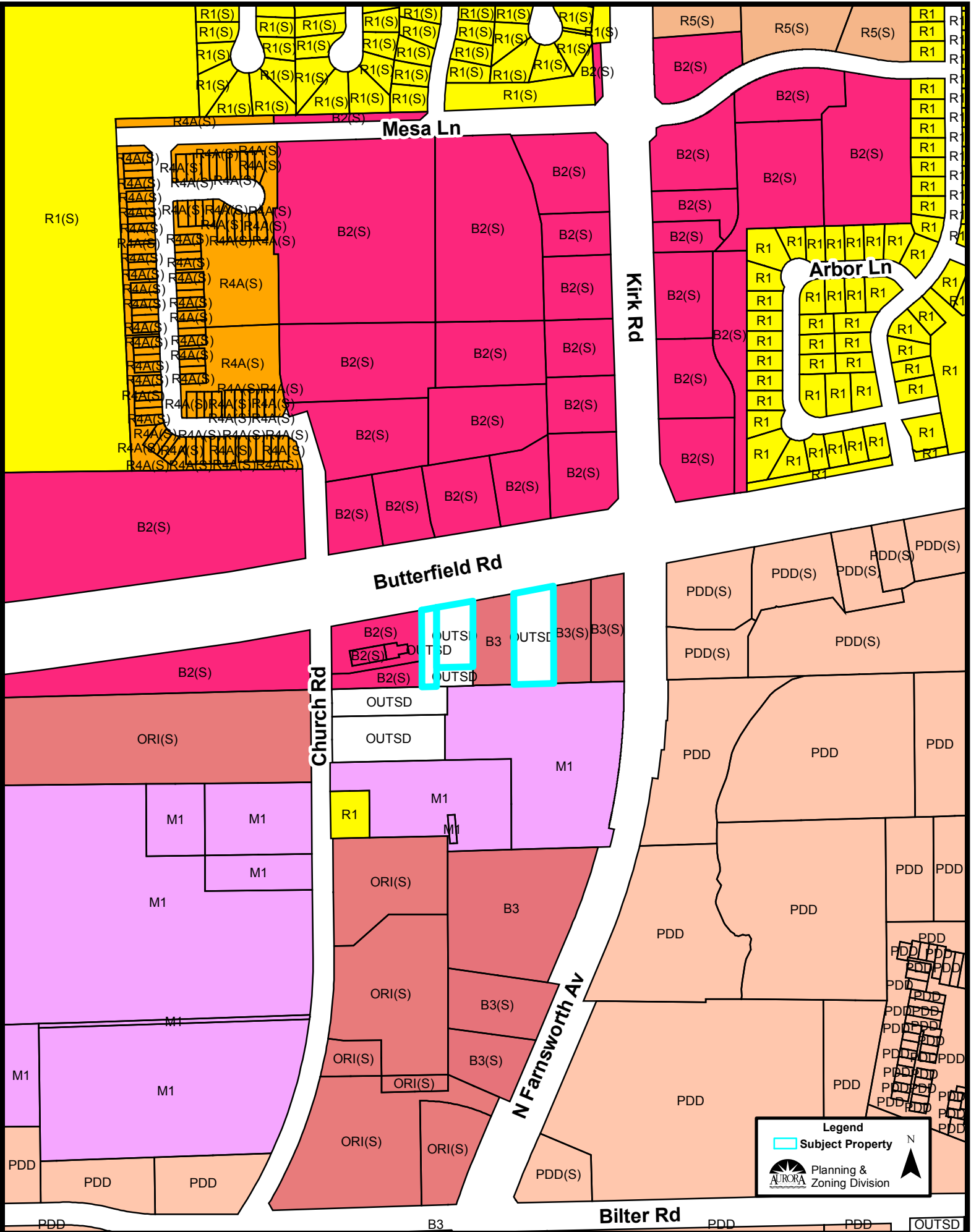

Zoning Plan (1:5,000):



Legend

-  Subject Property

 N

 Planning & Zoning Division

Comprehensive Plan (1:5,000):

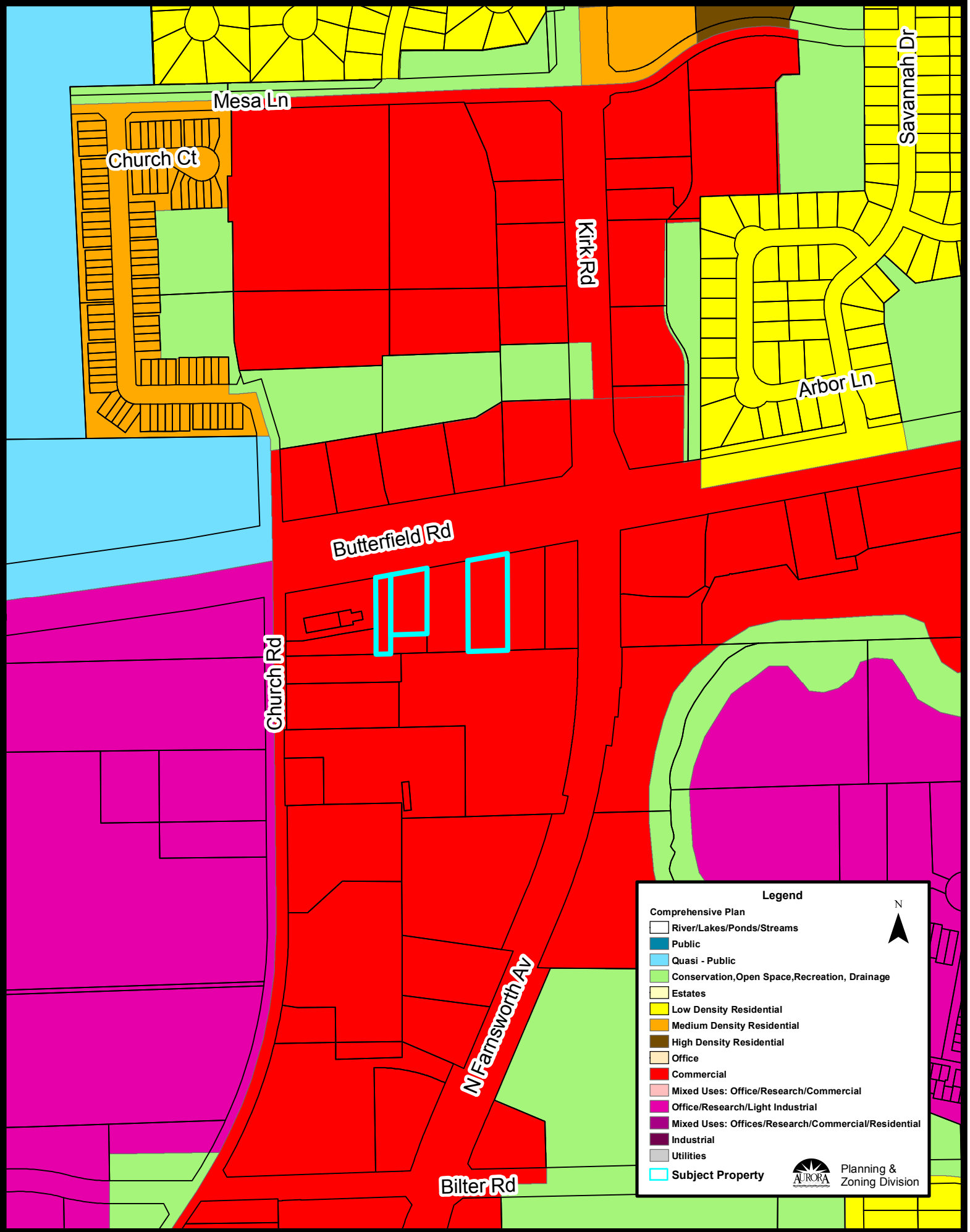

Legend

Comprehensive Plan

- River/Lakes/Ponds/Streams
- Public
- Quasi - Public
- Conservation, Open Space, Recreation, Drainage
- Estates
- Low Density Residential
- Medium Density Residential
- High Density Residential
- Office
- Commercial
- Mixed Uses: Office/Research/Commercial
- Office/Research/Light Industrial
- Mixed Uses: Offices/Research/Commercial/Residential
- Industrial
- Utilities
- Subject Property

N
▲

Planning & Zoning Division