

Legal Description

See Attached

Locator Map

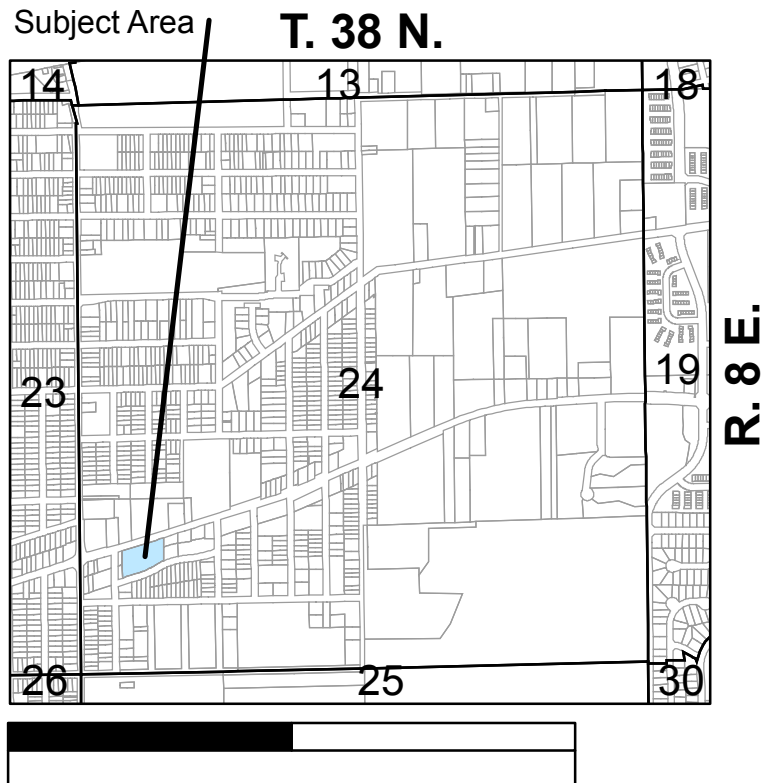

Actual Area

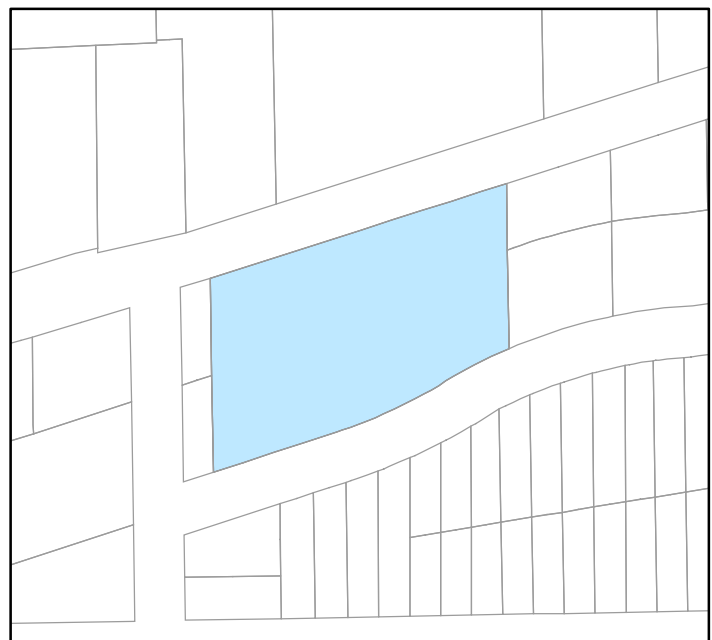

PIN(s)

15-24-352-025

Common Address

1435 E. New York Street



EXHIBIT "A"
SSA #192
O'REILLY AUTO PARTS
1435 EAST NEW YORK STREET

RECORD LEGAL DESCRIPTION:

PARCEL 1: LOT 343 (EXCEPT THE EASTERLY 10 FEET THEREOF), LOTS 344, 345, 346, 367, 368, 369, 370, 371, 372, 373, 374, 375, 376 (EXCEPT THE EASTERLY 10 FEET THEREOF) AND ALSO THE NORTH 1/2 OF THE VACATED ALLEY LYING SOUTHERLY OF AND ADJOINING LOTS 367, 368, 369, 370, 371, AND 372, AND ALL OF THE VACATED ALLEY LYING SOUTHERLY AND ADJOINING LOTS 373, 374, 375 AND 376 (EXCEPT THE EASTERLY 10 FEET THEREOF) IN OGDEN GARDENS, IN THE TOWNSHIP OF AURORA, KANE COUNTY, ILLINOIS

PARCEL 2: LOTS 347, 348, AND 349 AND THE SOUTHERLY HALF OF THE VACATED ALLEY LYING NORTHERLY OF AND ADJOINING SAID LOTS, IN OGDEN GARDENS, BEING A SUBDIVISION OF THE SOUTHWEST 1/4 OF SECTION 24, TOWNSHIP 38 NORTH, RANGE 8 EAST OF THE THIRD PRINCIPAL MERIDIAN, IN THE TOWNSHIP OF AURORA, KANE COUNTY, ILLINOIS.

PARCEL 3: LOTS 350, 351 AND 352 AND THE SOUTHERLY HALF OF THE VACATED ALLEY LYING NORTHERLY OF AND ADJOINING SAID LOTS, IN OGDEN GARDENS, BEING A SUBDIVISION OF THE SOUTHWEST 1/4 OF SECTION 24, TOWNSHIP 38 NORTH, RANGE 8 EAST OF THE THIRD PRINCIPAL MERIDIAN, IN THE TOWNSHIP OF AURORA, KANE COUNTY, ILLINOIS.

MEASURED METES AND BOUNDS DESCRIPTION:

THAT PART OF OGDEN GARDENS, BEING A SUBDIVISION OF PART OF SECTION 24, TOWNSHIP 38 NORTH, RANGE 8 EAST OF THE THIRD PRINCIPAL MERIDIAN, RECORDED SEPTEMBER 4TH, 1925 AS DOCUMENT 260960, DESCRIBED AS FOLLOWS:

BEGINNING AT THE NORTHWEST CORNER OF LOT 367 IN SAID OGDEN GARDENS; THENCE NORTH 72 DEGREES 29 MINUTES 01 SECONDS EAST, ALONG THE NORTHERLY LINE OF LOTS 367 THROUGH 376 INCLUSIVE, 389.65 FEET TO A LINE 10.00 FEET WEST OF AND PARALLEL WITH THE EAST LINE OF LOTS 376 AND 343; THENCE SOUTH 0 DEGREES 37 MINUTES 27 SECONDS EAST, ALONG SAID PARALLEL LINE, 217.35 FEET TO THE SOUTHERLY LINE OF LOT 343; THENCE SOUTHWESTERLY 163.69 FEET, ALONG THE SOUTHERLY LINE OF LOTS 343 THROUGH 347 INCLUSIVE, SAID LINE BEING A NON-TANGENTIAL CURVE TO THE LEFT, SAID CURVE HAVING A RADIUS OF 1,146.28 FEET, A CHORD THAT BEARS SOUTH 62 DEGREES 44 MINUTES 54 SECONDS WEST AND A CHORD DISTANCE OF 163.55 FEET TO A POINT OF REVERSE CURVATURE; THENCE SOUTHWESTERLY 49.58 FEET, ALONG THE SOUTHERLY LINE OF LOTS 347 AND 348, SAID SOUTHERLY LINE BEING A CURVE TO THE RIGHT, TANGENTIAL TO LAST DESCRIBED CURVE, HAVING A RADIUS OF 204.87 FEET, A CHORD THAT BEARS SOUTH 65 DEGREES 35 MINUTES 25 SECONDS WEST AND A CHORD DISTANCE OF 49.46 FEET; THENCE SOUTH 72 DEGREES 31 MINUTES 24 SECONDS WEST, ALONG THE SOUTHERLY LINE OF LOTS 348 THROUGH 352 INCLUSIVE AND TANGENT TO LAST DESCRIBED CURVE, 189.51 FEET TO THE SOUTHWEST CORNER OF SAID LOT 352; THENCE NORTH 0 DEGREES 37 MINUTES 27 SECONDS WEST, ALONG THE WEST LINE OF SAID LOT 352, THE NORTHERLY EXTENSION THEREOF AND THE WEST LINE OF SAID LOT 367, 252.32 FEET TO SAID POINT OF BEGINNING, ALL IN KANE COUNTY, ILLINOIS.

PIN #: 15-24-352-025

COMMON ADDRESS: 1435 East New York Street, Aurora, Illinois 60505