

City of Aurora
2500' Scale

Approved Census Tract
Areas for Lead Service
Replacements

Legend

-  Lead Service Replacement Tracts
-  2020 Census Tracts
-  City Limits
-  Major Streets

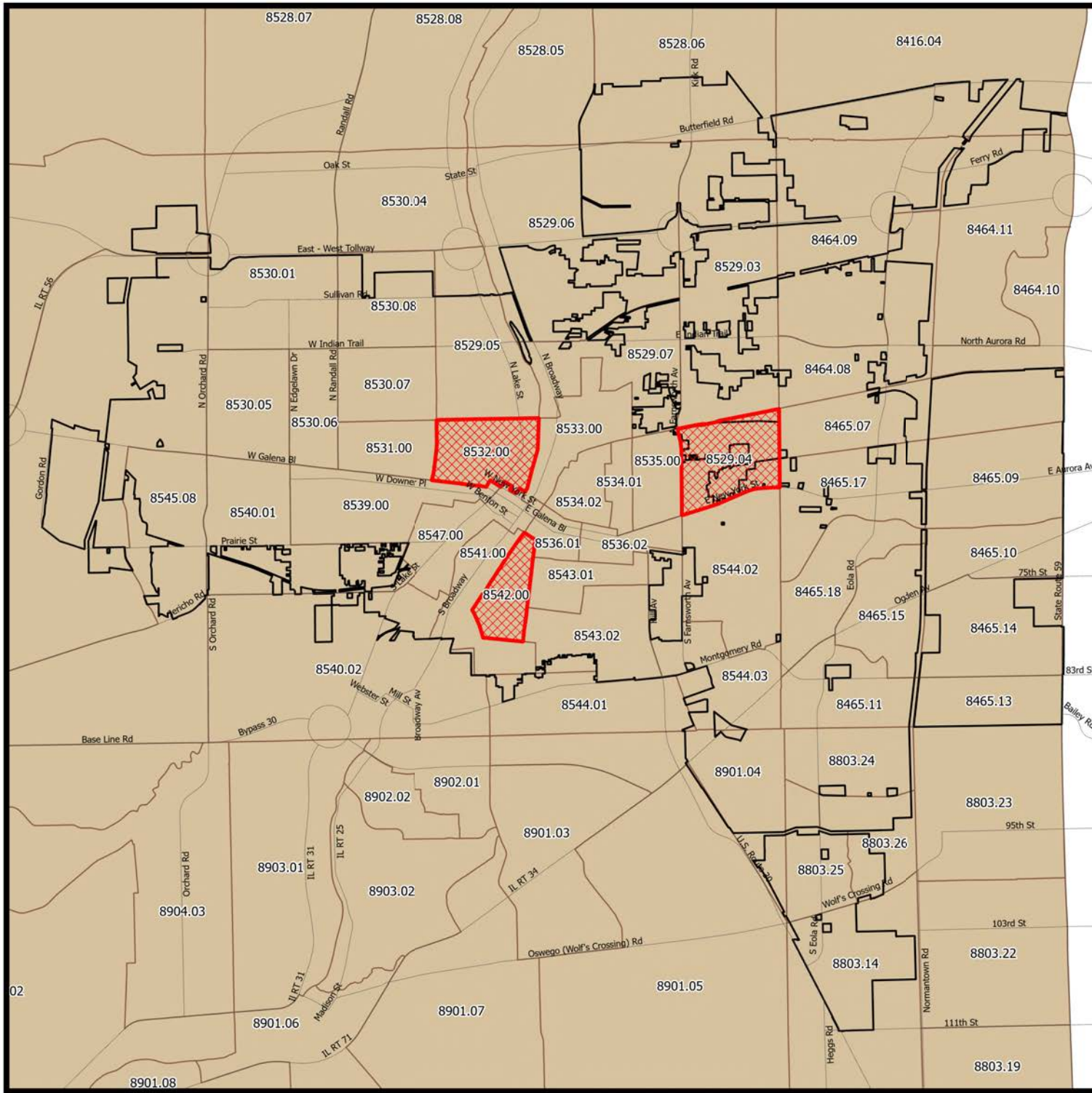

GIS DIVISION - AURORA, ILLINOIS
The information and/or data on this map depicts theoretical geographical roadways and elevations and their relationships and is not intended to reflect precise dimensions, use or distances of individual roads, and/or exact road alignments and right of ways.
The map and data on this map is intended for informational purposes only.

City of Aurora
2500' Scale

Approved Census Tract Area 8529.04

Legend

-  Tract 8529.04
-  2020 Census Tracts
-  City Limits
-  Streets

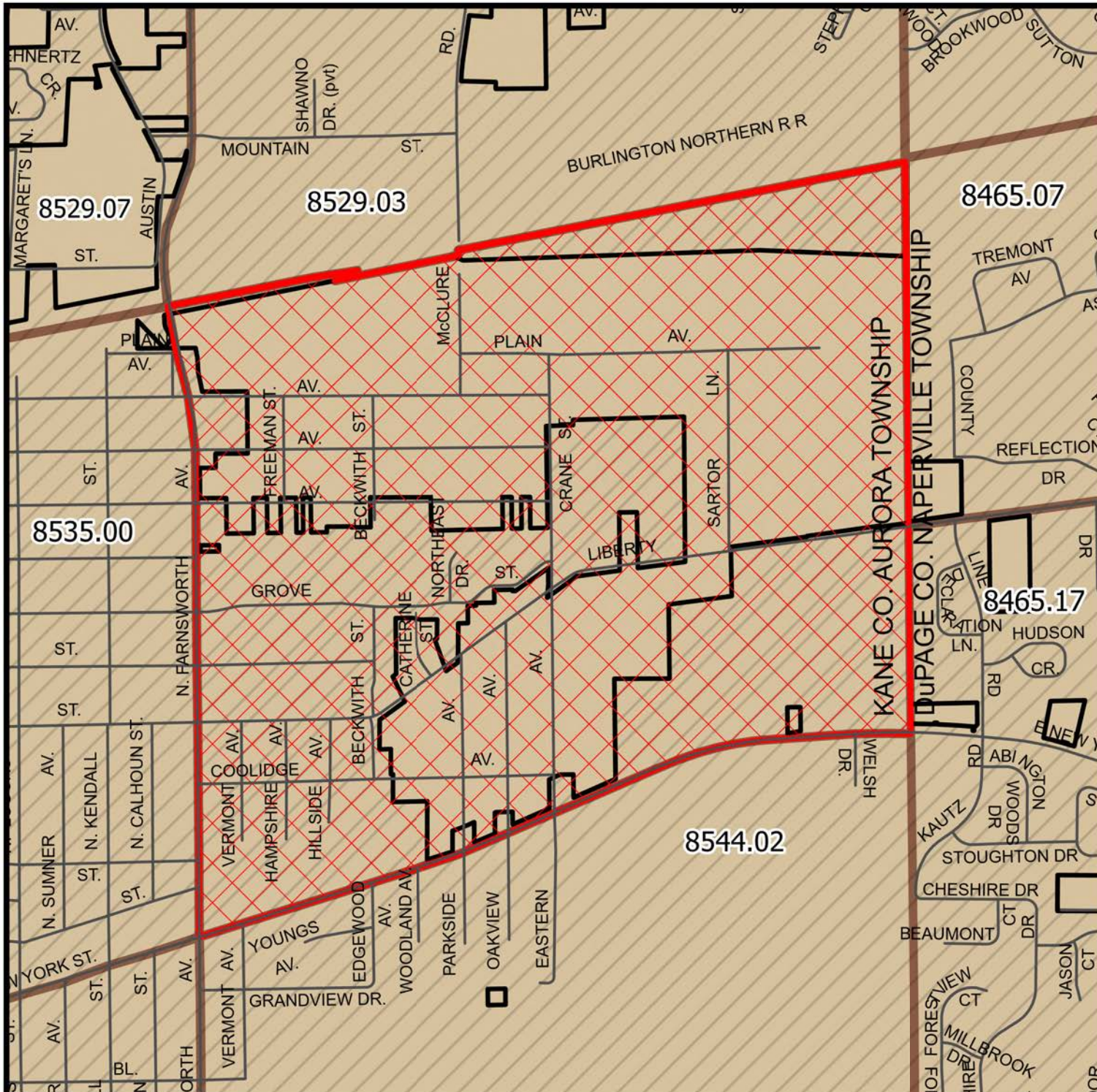

GIS DIVISION - AURORA, ILLINOIS
The information and/or data on this map depicts theoretical geographical
roadways and circulation and their relationships and is not intended to
reflect precise dimensions, use or distances of individual roads, and/or
exact road alignments and right-of-ways.
The map and data on this map is intended for informational purposes only.

City of Aurora
2500' Scale

Approved Census Tract Area 8532.00

Legend

-  Tract 8532.00
-  2020 Census Tracts
-  Streets

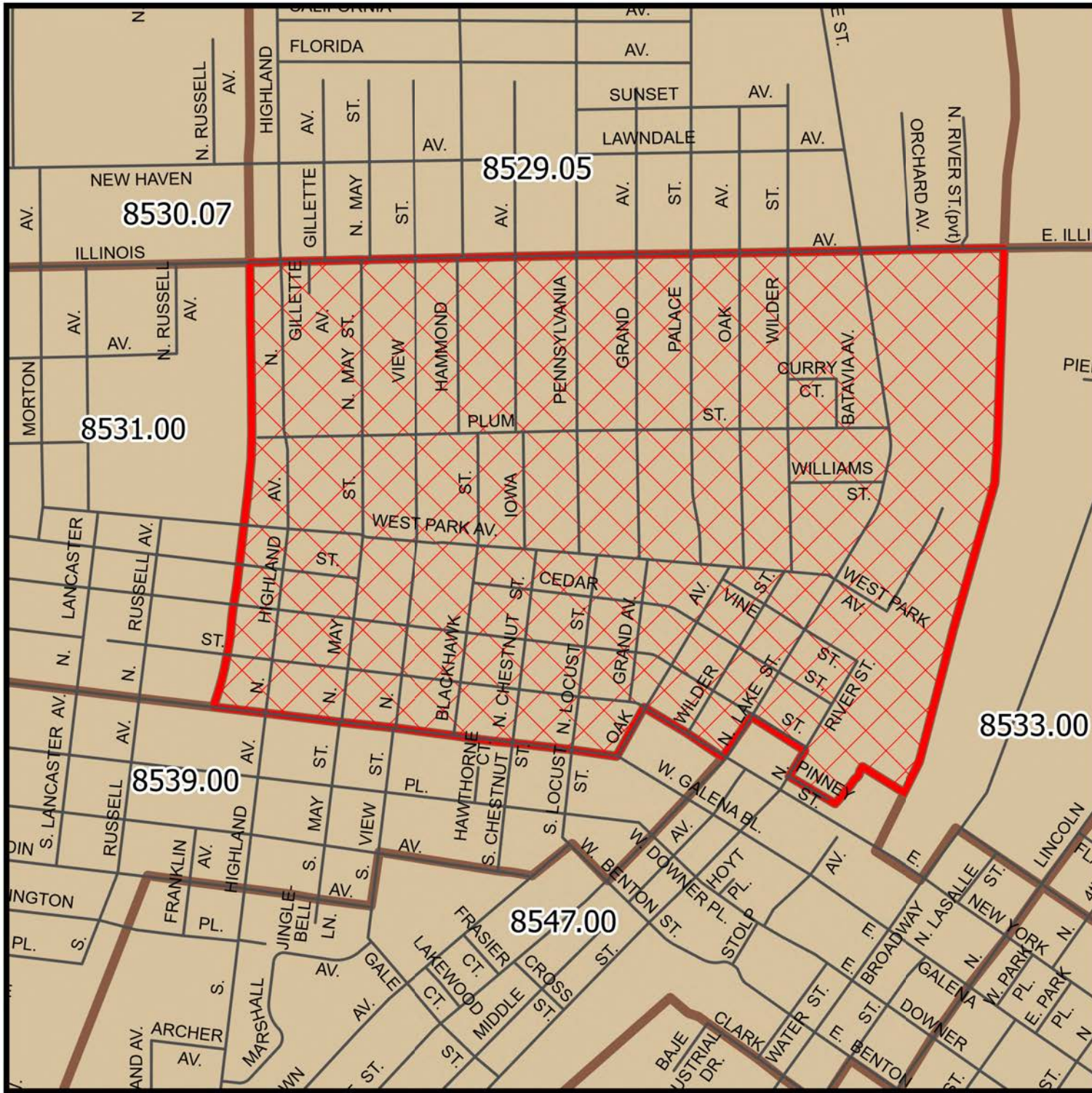

GIS DIVISION - AURORA, ILLINOIS
The information and/or data on this map depicts theoretical geographical
roadways and circulations and their relationships and is not intended to
reflect precise dimensions, use or ownership of individual roads, and/or
exact road alignments and right-of-ways.
The map and data on this map is intended for informational purposes only.

City of Aurora
2500' Scale

Approved Census Tract Area 8542.00

Legend

-  Tract 8542.00
-  2020 Census Tracts
-  Streets

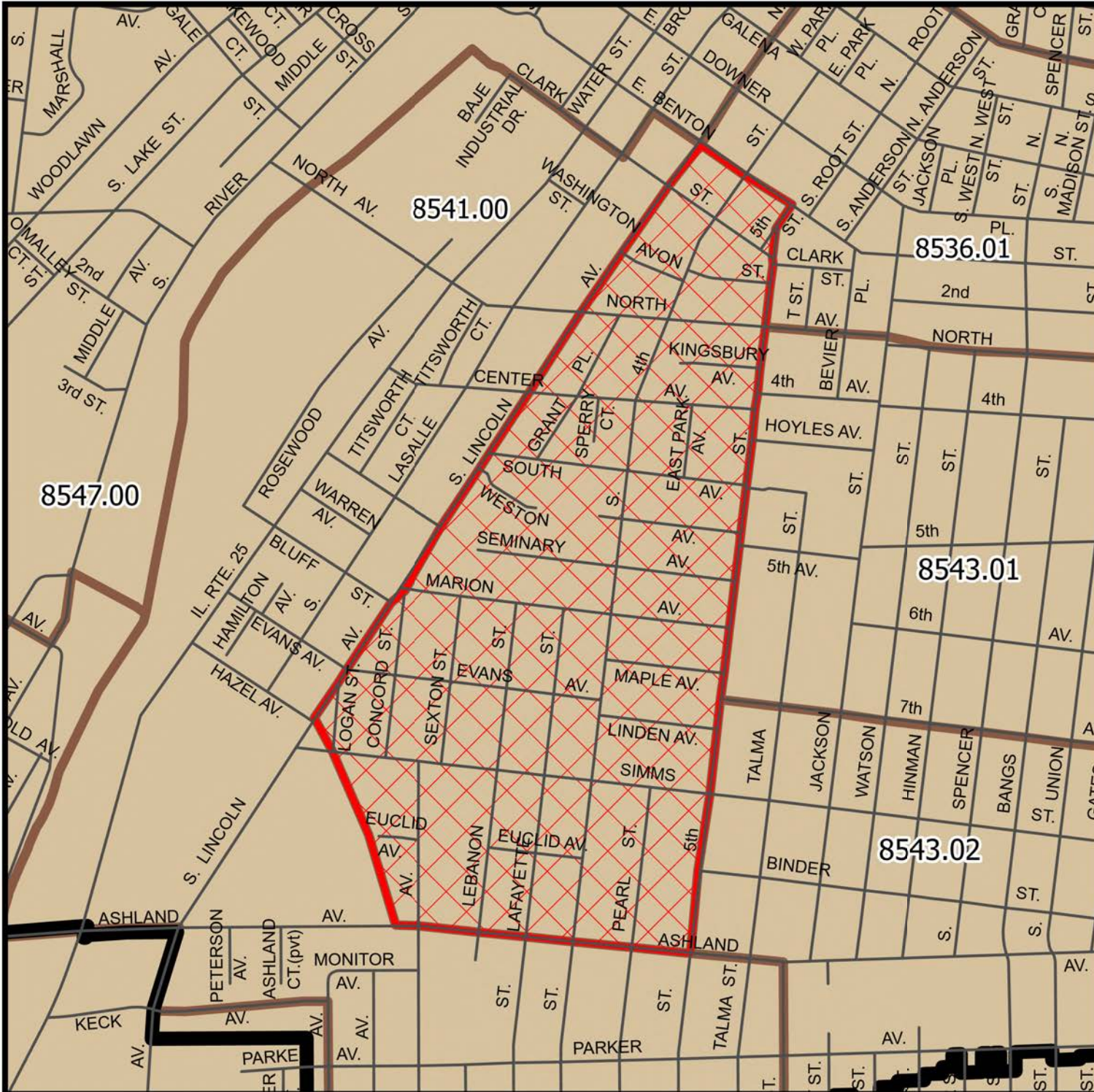

GIS DIVISION - AURORA, ILLINOIS
The information and/or data on this map depicts illustrative geographical
boundaries and delineation and their relationships and is not intended to
reflect precise dimensions, use or dimensions of individual roads, or
exact road alignments and right of ways.
The map and data on this map is intended for informational purposes only.