

## Legal Description

See Attached

## Locator Map

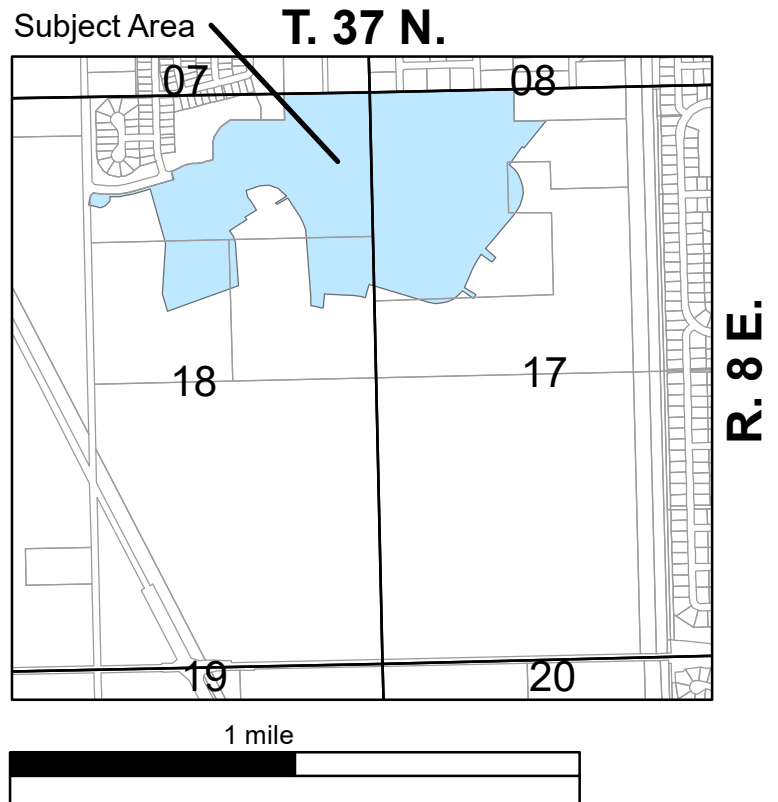

## Actual Area

### PIN(s)

01-17-100-021  
01-17-100-023  
01-18-200-001  
01-18-200-002  
01-18-200-003

### Common Address

East of S. Eola Rd.  
south of Wolf's Crossing Rd.

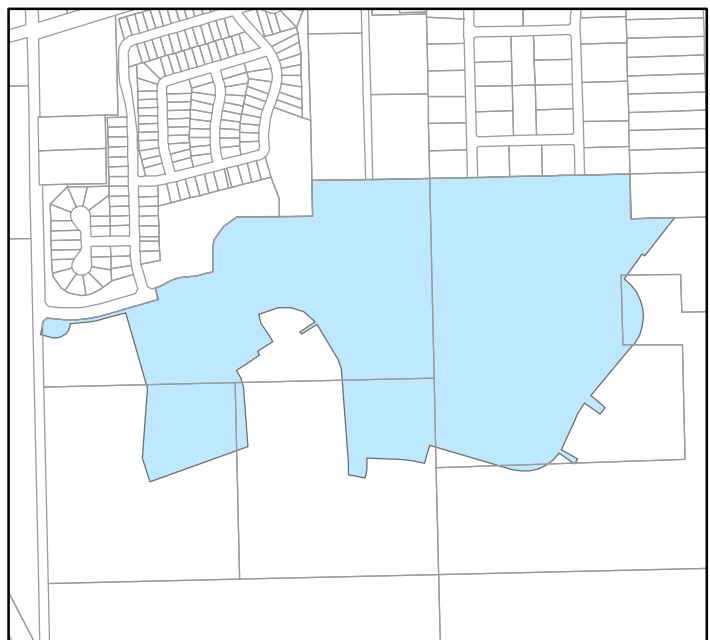

**LEGAL DESCRIPTION FOR**  
**LINCOLN PRAIRIE BY DEL WEBB SUBDIVISION – PHASE 1**  
**AURORA, ILLINOIS**

THAT PART OF SECTION 18 AND SECTION 17, TOWNSHIP 37 NORTH, RANGE 9 EAST OF THE THIRD PRINCIPAL MERIDIAN, CITY OF AURORA, COUNTY OF WILL, STATE OF ILLINOIS, BEING MORE PARTICULARLY DESCRIBED AS FOLLOWS:

BEGINNING AT THE NORTHWEST CORNER OF THE NORTHWEST QUARTER OF SAID SECTION 17; THENCE NORTH 88 DEGREES 38 MINUTES 25 SECONDS EAST, ALONG THE NORTH LINE OF SAID NORTHWEST QUARTER, A DISTANCE OF 1337.55 FEET TO A LINE BEING 1040.73 FEET WEST OF AND PARALLEL WITH THE WEST LINE OF LAND CONVEYED TO COMMONWEALTH EDISON COMPANY BY WARRANTY DEED RECORDED MAY 24, 1926, AS DOCUMENT 394069; THENCE SOUTH 01 DEGREES 29 MINUTES 20 SECONDS EAST, ALONG SAID PARALLEL LINE, A DISTANCE OF 300.00 FEET TO A LINE BEING 300.00 FEET SOUTH OF AND PARALLEL WITH THE NORTH LINE OF SAID NORTHWEST QUARTER; THENCE NORTH 88 DEGREES 38 MINUTES 25 SECONDS EAST, ALONG SAID PARALLEL LINE, A DISTANCE OF 292.20 FEET; THENCE SOUTH 38 DEGREES 23 MINUTES 16 SECONDS WEST, A DISTANCE OF 327.29 FEET TO A POINT ON A NON-TANGENT CURVE; THENCE NORTHWESTERLY, ALONG A CURVE, CONCAVE TO THE SOUTHWEST, HAVING A RADIUS OF 515.00 FEET, AN ARC DISTANCE OF 21.01 FEET, A CHORD BEARING NORTH 52 DEGREES 46 MINUTES 53 SECONDS WEST, AND A CHORD DISTANCE OF 21.01 FEET TO A POINT OF NON-TANGENCY; THENCE SOUTH 36 DEGREES 02 MINUTES 59 SECONDS WEST, A DISTANCE OF 205.00 FEET; THENCE SOUTH 48 DEGREES 25 MINUTES 06 SECONDS EAST, A DISTANCE OF 59.77 FEET; THENCE SOUTH 37 DEGREES 21 MINUTES 15 SECONDS EAST, A DISTANCE OF 59.77 FEET; THENCE SOUTH 26 DEGREES 17 MINUTES 25 SECONDS EAST, A DISTANCE OF 59.77 FEET; THENCE SOUTH 15 DEGREES 13 MINUTES 34 SECONDS EAST, A DISTANCE OF 59.77 FEET; THENCE SOUTH 04 DEGREES 09 MINUTES 44 SECONDS EAST, A DISTANCE OF 59.77 FEET; THENCE SOUTH 06 DEGREES 54 MINUTES 07 SECONDS WEST, A DISTANCE OF 59.77 FEET; THENCE SOUTH 17 DEGREES 57 MINUTES 57 SECONDS WEST, A DISTANCE OF 59.77 FEET; THENCE SOUTH 29 DEGREES 01 MINUTES 47 SECONDS WEST, A DISTANCE OF 59.77 FEET; THENCE SOUTH 38 DEGREES 49 MINUTES 39 SECONDS WEST, A DISTANCE OF 63.58 FEET; THENCE SOUTH 40 DEGREES 09 MINUTES 36 SECONDS WEST, A DISTANCE OF 396.00 FEET; THENCE SOUTH 49 DEGREES 50 MINUTES 24 SECONDS EAST, A DISTANCE OF 125.00 FEET; THENCE SOUTH 40 DEGREES 09 MINUTES 36 SECONDS WEST, A DISTANCE OF 16.80 FEET TO A POINT OF CURVATURE; THENCE SOUTHWESTERLY, ALONG A CURVE, CONCAVE TO THE SOUTHEAST, HAVING A RADIUS OF 540.00 FEET, AN ARC DISTANCE OF 40.00 FEET, A CHORD BEARING SOUTH 38 DEGREES 02 MINUTES 17 SECONDS WEST, AND A CHORD DISTANCE OF 39.99 FEET TO A POINT OF NON-TANGENCY; THENCE NORTH 54 DEGREES 05 MINUTES 03 SECONDS WEST, A DISTANCE OF 125.00 FEET; THENCE SOUTH 32 DEGREES 34 MINUTES 25 SECONDS WEST, A DISTANCE OF 77.54 FEET; THENCE SOUTH 26 DEGREES 07 MINUTES 46 SECONDS WEST, A DISTANCE OF 74.42 FEET; THENCE SOUTH 23 DEGREES 58 MINUTES 48 SECONDS WEST, A DISTANCE OF 132.00 FEET; THENCE SOUTH 25 DEGREES 10 MINUTES 33 SECONDS WEST, A DISTANCE OF 63.60 FEET; THENCE SOUTH 60 DEGREES 29 MINUTES 16 SECONDS EAST, A DISTANCE OF 125.00 FEET TO A POINT ON A NON-TANGENT CURVE; THENCE SOUTHWESTERLY, ALONG A CURVE, CONCAVE TO THE NORTHWEST, HAVING A RADIUS OF 410.00 FEET, AN ARC DISTANCE OF 41.87 FEET, A CHORD BEARING SOUTH 32 DEGREES 26 MINUTES 16 SECONDS WEST, AND A CHORD DISTANCE OF 41.85 FEET TO A POINT OF NON-TANGENCY; THENCE NORTH 54 DEGREES 38 MINUTES 12 SECONDS WEST, A DISTANCE OF 125.00 FEET; THENCE SOUTH 41 DEGREES 17 MINUTES 19 SECONDS WEST, A DISTANCE OF 58.84 FEET; THENCE SOUTH 53 DEGREES 08 MINUTES 21 SECONDS WEST, A DISTANCE OF 58.84 FEET; THENCE SOUTH 64 DEGREES 59 MINUTES 22 SECONDS WEST, A DISTANCE OF 58.84 FEET; THENCE SOUTH 76 DEGREES 50 MINUTES 24 SECONDS WEST, A DISTANCE OF 58.84 FEET; THENCE SOUTH 88 DEGREES 41 MINUTES 26 SECONDS WEST, A DISTANCE OF 58.84 FEET; THENCE NORTH 79 DEGREES 27 MINUTES 33 SECONDS WEST, A DISTANCE OF 58.84 FEET; THENCE NORTH 73 DEGREES 32 MINUTES 02 SECONDS WEST, A DISTANCE OF 576.00 FEET; THENCE SOUTH 16 DEGREES 27 MINUTES 58 SECONDS WEST, A DISTANCE OF 125.66 FEET TO A POINT ON A NON-TANGENT CURVE; THENCE WESTERLY, ALONG A CURVE, CONCAVE TO THE SOUTH, HAVING A RADIUS OF 790.00 FEET, AN ARC DISTANCE OF 160.91 FEET, A CHORD BEARING NORTH 81 DEGREES 42

**LEGAL DESCRIPTION FOR  
LINCOLN PRAIRIE BY DEL WEBB SUBDIVISION – PHASE 1  
AURORA, ILLINOIS**

MINUTES 56 SECONDS WEST, AND A CHORD DISTANCE OF 160.63 FEET TO A POINT OF TANGENCY; THENCE NORTH 87 DEGREES 33 MINUTES 02 SECONDS WEST, A DISTANCE OF 223.27 FEET TO A POINT ON A NON-TANGENT CURVE; THENCE SOUTHERLY, ALONG A CURVE, CONCAVE TO THE WEST, HAVING A RADIUS OF 540.00 FEET, AN ARC DISTANCE OF 132.30 FEET, A CHORD BEARING SOUTH 05 DEGREES 13 MINUTES 11 SECONDS WEST, AND A CHORD DISTANCE OF 131.96 FEET TO A POINT OF NON-TANGENCY; THENCE NORTH 78 DEGREES 32 MINUTES 40 SECONDS WEST, A DISTANCE OF 114.45 FEET; THENCE NORTH 00 DEGREES 13 MINUTES 46 SECONDS WEST, A DISTANCE OF 79.27 FEET; THENCE NORTH 04 DEGREES 28 MINUTES 42 SECONDS WEST, A DISTANCE OF 627.71 FEET; THENCE NORTH 17 DEGREES 28 MINUTES 08 SECONDS WEST, A DISTANCE OF 66.03 FEET; THENCE NORTH 29 DEGREES 30 MINUTES 59 SECONDS WEST, A DISTANCE OF 66.17 FEET; THENCE NORTH 32 DEGREES 11 MINUTES 06 SECONDS WEST, A DISTANCE OF 208.32 FEET; THENCE SOUTH 57 DEGREES 48 MINUTES 54 SECONDS WEST, A DISTANCE OF 120.19 FEET TO A POINT ON A NON-TANGENT CURVE; THENCE NORTHWESTERLY, ALONG A CURVE, CONCAVE TO THE SOUTHWEST, HAVING A RADIUS OF 133.00 FEET, AN ARC DISTANCE OF 20.19 FEET, A CHORD BEARING NORTH 39 DEGREES 36 MINUTES 30 SECONDS WEST, AND A CHORD DISTANCE OF 20.17 FEET TO A POINT OF NON-TANGENCY; THENCE NORTH 57 DEGREES 48 MINUTES 54 SECONDS EAST, A DISTANCE OF 122.80 FEET; THENCE NORTH 48 DEGREES 12 MINUTES 28 SECONDS WEST, A DISTANCE OF 104.85 FEET; THENCE NORTH 71 DEGREES 39 MINUTES 34 SECONDS WEST, A DISTANCE OF 87.41 FEET; THENCE SOUTH 88 DEGREES 50 MINUTES 04 SECONDS WEST, A DISTANCE OF 87.41 FEET; THENCE SOUTH 68 DEGREES 23 MINUTES 19 SECONDS WEST, A DISTANCE OF 137.29 FEET; THENCE SOUTH 15 DEGREES 14 MINUTES 09 SECONDS EAST, A DISTANCE OF 57.02 FEET; THENCE SOUTH 32 DEGREES 11 MINUTES 06 SECONDS EAST, A DISTANCE OF 144.08 FEET; THENCE SOUTH 57 DEGREES 48 MINUTES 54 SECONDS WEST, A DISTANCE OF 121.00 FEET; THENCE SOUTH 32 DEGREES 11 MINUTES 06 SECONDS EAST, A DISTANCE OF 30.67 FEET; THENCE SOUTH 57 DEGREES 48 MINUTES 54 SECONDS WEST, A DISTANCE OF 186.00 FEET; THENCE SOUTH 31 DEGREES 37 MINUTES 54 SECONDS EAST, A DISTANCE OF 64.17 FEET; THENCE SOUTH 15 DEGREES 42 MINUTES 01 SECONDS EAST, A DISTANCE OF 57.22 FEET; THENCE SOUTH 04 DEGREES 28 MINUTES 42 SECONDS EAST, A DISTANCE OF 404.00 FEET; THENCE SOUTH 70 DEGREES 18 MINUTES 27 SECONDS WEST, A DISTANCE OF 696.49 FEET; THENCE NORTH 17 DEGREES 53 MINUTES 12 SECONDS WEST, A DISTANCE OF 165.00 FEET; THENCE NORTH 03 DEGREES 52 MINUTES 30 SECONDS EAST, A DISTANCE OF 470.00 FEET; THENCE NORTH 15 DEGREES 58 MINUTES 05 SECONDS WEST, A DISTANCE OF 526.00 FEET; THENCE SOUTH 74 DEGREES 01 MINUTES 55 SECONDS WEST, A DISTANCE OF 150.00 FEET TO A POINT OF CURVATURE; THENCE WESTERLY, ALONG A CURVE, CONCAVE TO THE NORTH, HAVING A RADIUS OF 814.00 FEET, AN ARC DISTANCE OF 229.61 FEET, A CHORD BEARING SOUTH 82 DEGREES 06 MINUTES 46 SECONDS WEST, AND A CHORD DISTANCE OF 228.85 FEET; THENCE SOUTHWESTERLY, ALONG A CURVE, CONCAVE TO THE NORTHWEST, HAVING A RADIUS OF 95.00 FEET, AN ARC DISTANCE OF 173.48 FEET, A CHORD BEARING SOUTH 51 DEGREES 16 MINUTES 36 SECONDS WEST, AND A CHORD DISTANCE OF 150.36 FEET TO A POINT OF TANGENCY; THENCE NORTH 76 DEGREES 24 MINUTES 32 SECONDS WEST, A DISTANCE OF 84.54 FEET TO A POINT ON A NON-TANGENT CURVE, SAID POINT BEING ON THE EASTERLY RIGHT-OF-WAY LINE OF EOLA ROAD PER DOCUMENT R2020116928; THENCE NORTHERLY, ALONG SAID RIGHT-OF-WAY LINE, BEING A CURVE, CONCAVE TO THE WEST, HAVING A RADIUS OF 1090.00 FEET, AN ARC DISTANCE OF 89.95 FEET, A CHORD BEARING NORTH 11 DEGREES 13 MINUTES 37 SECONDS EAST, AND A CHORD DISTANCE OF 89.93 FEET TO A POINT OF NON-TANGENCY; THENCE NORTH 51 DEGREES 51 MINUTES 05 SECONDS EAST, A DISTANCE OF 34.77 FEET; THENCE SOUTH 84 DEGREES 30 MINUTES 12 SECONDS EAST, A DISTANCE OF 82.09 FEET TO A POINT OF CURVATURE; THENCE EASTERLY, ALONG A CURVE, CONCAVE TO THE NORTH, HAVING A RADIUS OF 790.00 FEET, AN ARC DISTANCE OF 295.96 FEET, A CHORD BEARING NORTH 84 DEGREES 45 MINUTES 51 SECONDS EAST, AND A CHORD DISTANCE OF 294.23 FEET TO A POINT OF TANGENCY; THENCE NORTH 74 DEGREES 01 MINUTES 55 SECONDS EAST, A DISTANCE OF 384.75 FEET; THENCE NORTH 15 DEGREES 58 MINUTES 05 SECONDS WEST, A DISTANCE OF 80.00 FEET TO A POINT ON A NON-TANGENT CURVE; THENCE EASTERLY, ALONG A CURVE, CONCAVE TO THE NORTH, HAVING A RADIUS OF 280.00 FEET, AN ARC DISTANCE OF 78.05

**LEGAL DESCRIPTION FOR  
LINCOLN PRAIRIE BY DEL WEBB SUBDIVISION – PHASE 1  
AURORA, ILLINOIS**

FEET, A CHORD BEARING NORTH 66 DEGREES 02 MINUTES 48 SECONDS EAST, AND A CHORD DISTANCE OF 77.79 FEET TO A POINT OF REVERSE CURVATURE; THENCE EASTERLY, ALONG A CURVE, CONCAVE TO THE SOUTH, HAVING A RADIUS OF 290.00 FEET, AN ARC DISTANCE OF 161.67 FEET, A CHORD BEARING NORTH 74 DEGREES 01 MINUTES 55 SECONDS EAST, AND A CHORD DISTANCE OF 159.58 FEET TO A POINT OF REVERSE CURVATURE; THENCE EASTERLY, ALONG A CURVE, CONCAVE TO THE NORTH, HAVING A RADIUS OF 280.00 FEET, AN ARC DISTANCE OF 78.05 FEET, A CHORD BEARING NORTH 82 DEGREES 01 MINUTES 02 SECONDS EAST, AND A CHORD DISTANCE OF 77.79 FEET TO A POINT OF TANGENCY; THENCE NORTH 74 DEGREES 01 MINUTES 55 SECONDS EAST, A DISTANCE OF 10.00 FEET TO A POINT OF CURVATURE; THENCE EASTERLY, ALONG A CURVE, CONCAVE TO THE SOUTH, HAVING A RADIUS OF 840.00 FEET, AN ARC DISTANCE OF 75.70 FEET, A CHORD BEARING NORTH 76 DEGREES 36 MINUTES 49 SECONDS EAST, AND A CHORD DISTANCE OF 75.68 FEET TO A POINT OF NON-TANGENCY; THENCE NORTH 00 DEGREES 18 MINUTES 36 SECONDS WEST, A DISTANCE OF 163.77 FEET; THENCE NORTH 12 DEGREES 24 MINUTES 37 SECONDS EAST, A DISTANCE OF 50.92 FEET; THENCE NORTH 33 DEGREES 53 MINUTES 01 SECONDS EAST, A DISTANCE OF 109.18 FEET; THENCE NORTH 54 DEGREES 13 MINUTES 08 SECONDS EAST, A DISTANCE OF 111.00 FEET; THENCE NORTH 89 DEGREES 41 MINUTES 24 SECONDS EAST, A DISTANCE OF 506.84 FEET; THENCE NORTH 01 DEGREES 18 MINUTES 50 SECONDS WEST, A DISTANCE OF 241.43 FEET, TO A POINT ON THE NORTH LINE OF THE NORTHEAST QUARTER OF SAID SECTION 18; THENCE NORTH 89 DEGREES 10 MINUTES 37 SECONDS EAST, ALONG SAID NORTH LINE, A DISTANCE OF 791.25 FEET TO THE POINT OF BEGINNING.

CONTAINING 5,032,390 SQUARE FEET (115.528 ACRES), MORE OR LESS

PINS: 01-18-200-001; 01-18-200-002; 01-18-200-003; 01-17-100-021; 01-17-100-023