

HIGHWAY AUTHORITY AGREEMENT

This Agreement is entered into this 23 day of SEPTEMBER, 2022 pursuant to 35 Ill. Adm. Code 742.1020 by and between the Paul and Bill's Service Center, Inc. ("Owner/Operator") and the City of Aurora ("Highway Authority"), collectively known as the "Parties."

WHEREAS, Paul and Bill's Service Center, Inc. is the owner or operator of one or more leaking underground storage tanks presently or formerly located at 300 West Galena Boulevard, Aurora, Illinois 60506 ("the Site");

WHEREAS, Paul and Bill's Service Center, Inc. is the owner of the property located at 300 West Galena Boulevard, Aurora, Illinois 60506 ("the Site");

WHEREAS, as a result of one or more releases of contaminants from above referenced underground storage tanks ("the Release"), soil and groundwater contamination at the Site exceeds the Tier 1 residential remediation objectives of 35 Ill. Adm. Code 742;

WHEREAS, the soil and/or groundwater contamination exceeding Tier 1 residential remediation objectives extends or may extent into the Highway Authority right-of-way;

WHEREAS, the Owner/Operator or Property Owner is conducting corrective action in response to the Releases;

WHEREAS, the Parties desire to prevent groundwater beneath the Highway Authority's right-of-way that exceeds Tier 1 remediation objectives from use as a supply of potable or domestic water and to limit access to soil within the right-of-way that exceeds Tier 1 residential remediation objectives so that human health and the environment are protected during and after any access;

NOW, THEREFORE, the Parties agree as follows:

1. The recitals set forth above are incorporated by reference as if fully set forth herein.
2. The Illinois Emergency Management Agency has assigned incident number(s) 20180517 to the Release.
3. Attached as **Exhibit A** is a scaled map prepared by the Owner/Operator that shows the Site and surrounding area and delineates the current and estimated future extent of soil and groundwater contamination above the applicable Tier 1 residential remediation objectives as a result of the Releases.
4. Attached as **Exhibit B** are tables prepared by the Owner/Operator that lists each contaminant of concern that exceeds its Tier 1 residential remediation objective, its Tier 1 residential remediation objective and its concentrations within the zone where Tier 1 residential remediation objectives are exceeded. The locations of the concentrations listed in **Exhibit B** are identified on the map in **Exhibit A**.
5. Attached as **Exhibit C** is a scaled map prepared by the Owner/Operator showing the area of Highway Authority's right-of-way that is governed by this agreement ("Right-of-Way"). Because **Exhibit C** is not a surveyed plat, the Right-of-Way boundary may be an approximation of the actual Right-of-Way lines.

6. The Highway Authority stipulates it has jurisdiction over the Right-of-Way that gives it sole control over the use of the groundwater and access to the soil located within or beneath the Right-of-Way. Because the collection of samples within the Right-of-Way is not practical, the Parties stipulate that, based on modeling, soil and groundwater contamination exceeding Tier 1 residential remediation objectives does not and will not extend beyond the Right-of-Way.
7. The Highway Authority agrees to prohibit within the Right-of-Way all potable and domestic uses of groundwater exceeding Tier 1 residential remediation objectives.
8. The Highway Authority further agrees to limit access by itself and others to soil within the Right-of-Way exceeding Tier 1 residential remediation objectives. Access shall be allowed only if human health (including worker safety) and the environment are protected during and after any access. The Highway Authority may construct, reconstruct, improve, repair, maintain and operate a highway and utilities upon the Right-of-Way, or allow others to do the same by permit. In addition, the Highway Authority and others using or working in the Right-of-Way under permit have the right to remove soil or groundwater from the Right-of-Way and dispose of the same in accordance with applicable environmental laws and regulations. The Highway Authority agrees to issue all permits for work in the Right-of-Way, and make all existing permits for work in the Right-of-Way, subject to the following or substantially similar condition:

As a condition of this permit the permittee shall request the office issuing this permit to identify sites in the Right-of-Way where a Highway Authority Agreement governs access to soil that exceeds the Tier 1 residential remediation objectives of 35 Ill. Adm. Code 742. The permittee shall take all measures necessary to protect human health (including worker safety) and the environment during and after any access to such soil.

9. This agreement shall be referenced in the Agency's no further remediation determination issued for the Releases.
10. The Illinois Environmental Protection Agency ("Agency") shall be notified of any transfer of jurisdiction over the Right-of-Way at least 30 days prior to the date the transfer takes effect. This agreement shall be null and void upon the transfer unless the transferee agrees to be bound by this agreement as if the transferee were an original party to this agreement. The transferee's agreement to be bound by the terms of this agreement shall be memorialized at the time of transfer in a writing ("Rider") that references this Highway Authority Agreement and is signed by the Highway Authority, or subsequent transferor, and the transferee.
11. This agreement shall become effective on the date the Agency issues a no further remediation determination for the Releases. It shall remain effective until the Right-of-Way is demonstrated to be suitable for unrestricted use and the Agency issues a new no further remediation determination to reflect there is no longer a need for this agreement, or until the agreement is otherwise terminated or voided.
12. In addition to any other remedies that may be available, the Agency may bring suit to enforce the terms of this agreement or may, in its sole discretion, declare this agreement null and void if any of the Parties or any transferee violates any term of this agreement. The Parties or transferee shall be notified in writing of any such declaration.
13. This agreement shall be null and void if a court of competent jurisdiction strikes down any part or provision of the agreement.

14. This agreement supersedes any prior written or oral agreements or understandings between the Parties on the subject matter addressed herein. It may be altered, modified or amended only upon the written consent and agreement of the Parties.

15. Any notices or other correspondence regarding this agreement shall be sent to the Parties at following addresses:

IN WITNESS WHEREOF, the Parties have caused this agreement to be signed by their duly authorized representatives.

Manager, Division of Remediation
Management
Bureau of Land
Illinois Environmental Protection Agency
P.O. Box 19276
Springfield, IL 62974-9276

Paul and Bill's Service Center, Inc.
Mr. William Rudigier
610 Hernando Place
Dauphin Island, AL 36528

City of Aurora, Highway Authority
77 South Broadway, 2nd Floor
Aurora, IL 60507
Attn: Ken Schroth

IN WITNESS WHEREOF, the Parties have caused this agreement to be signed by their duly authorized representatives.

City of Aurora, Highway Agency

Paul and Bill's Service Center, Inc.

Date: _____

Date: 09/23/2022

By: _____

By: William Rudigier

Its: _____

Its: _____

EXHIBIT A

PREDICTED EXTENT OF SOIL AND GROUNDWATER IMPACTS

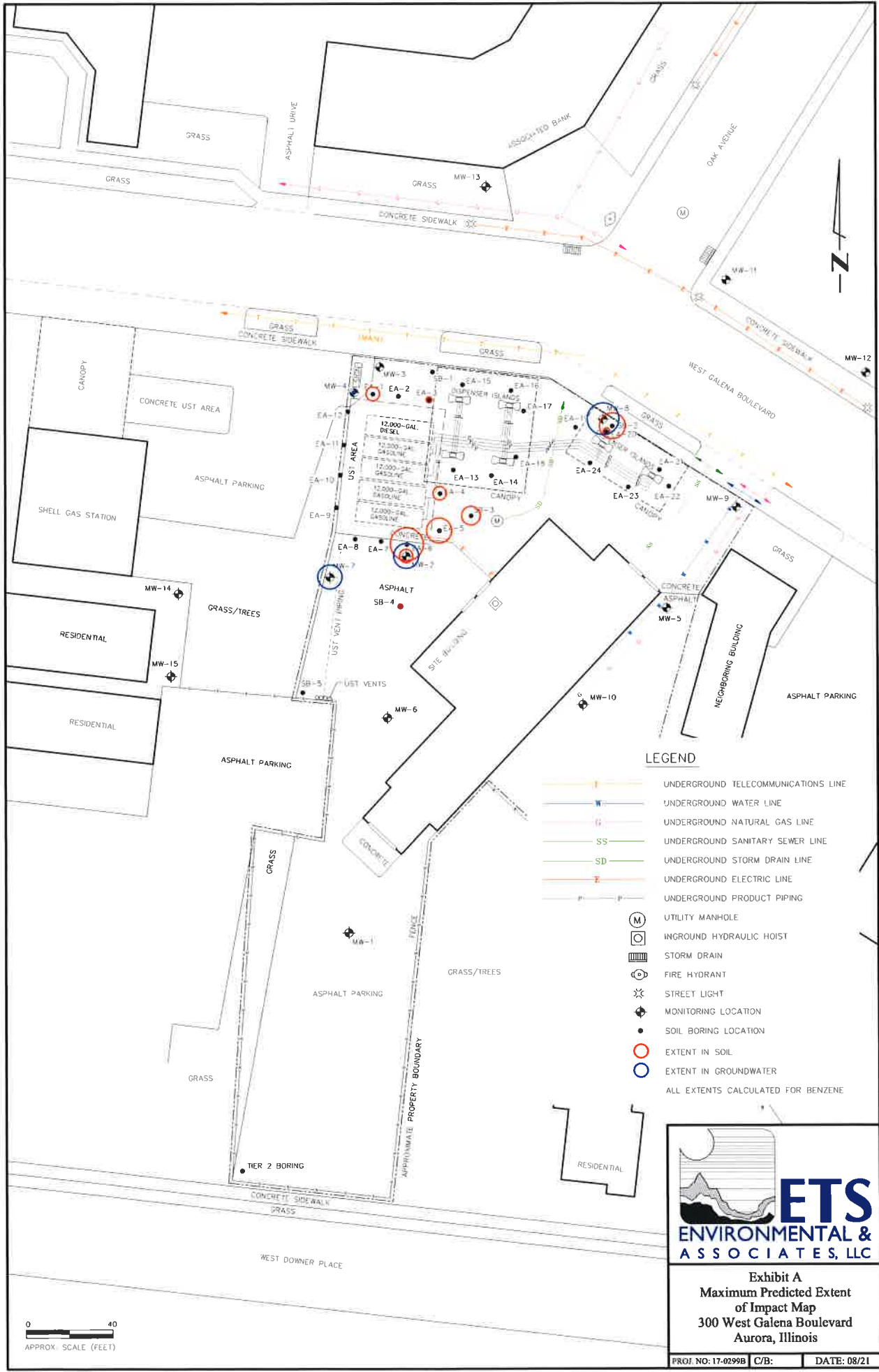

Exhibit A
Maximum Predicted Extent
of Impact Map
300 West Galena Boulevard
Aurora, Illinois

EXHIBIT B

SOIL AND GROUNDWATER ANALYTICAL TABLES

Soil BTEX/MTBE Analytical Results
300 West Galena Boulevard
Aurora, Illinois
Project No. 17-0299C

SAMPLE ID	DATE	DEPTH (FEET)	BENZENE	TOLUENE	ETHYL-BENZENE	TOTAL XYLENES	MTBE
EA-1	06/26/18	2.5	<0.0050	<0.0050	<0.0050	<0.0050	<0.0050
EA-1	06/26/18	7	<0.0050	<0.0050	<0.0050	<0.0050	<0.0050
EA-1	06/26/18	12	<0.0050	<0.0050	<0.0050	<0.0050	<0.0050
EA-1	06/26/18	17	0.0066	0.0098	<0.0050	<0.0050	<0.0050
EA-1	06/26/18	25	0.238 ^{1,2}	<0.500	<0.500	<0.500	<0.320
EA-2	06/26/18	2	<0.0050	<0.0050	<0.0050	<0.0050	<0.0050
EA-2	06/26/18	6.5	<0.0050	<0.0050	<0.0050	<0.0050	<0.0050
EA-2	06/26/18	12	<0.0050	<0.0050	<0.0050	<0.0050	<0.0050
EA-2	06/26/18	17	<0.0050	<0.0050	<0.0050	<0.0050	<0.0050
EA-3	06/26/18	2	<0.0050	<0.0050	<0.0050	<0.0050	<0.0050
EA-3	06/26/18	7	<0.0050	<0.0050	<0.0050	<0.0050	<0.0050
EA-3	06/26/18	12	<0.0050	<0.0050	<0.0050	<0.0050	<0.0050
EA-3	06/26/18	20	0.0385 ¹	<0.0050	<0.0050	<0.0050	<0.0050
EA-3	06/26/18	24.5	0.0785 ¹	<0.500	<0.500	<0.500	<0.320
EA-4	06/26/18	2	<0.0050	<0.0050	<0.0050	<0.0050	<0.0050
EA-4	06/26/18	6	<0.0050	<0.0050	<0.0050	<0.0050	<0.0050
EA-4	06/26/18	12	<0.0050	<0.0050	<0.0050	<0.0050	<0.0050
EA-4	06/26/18	18	0.224 ^{1,2}	0.255	0.0767	0.228	<0.0050
EA-5	06/26/18	2	<0.0050	<0.0050	<0.0050	<0.0050	<0.0050
EA-5	06/26/18	7	<0.0050	<0.0050	<0.0050	<0.0050	<0.0050
EA-5	06/26/18	12	<0.0050	0.005	<0.0050	<0.0050	<0.0050
EA-5	06/26/18	17.5	0.244 ^{1,2}	0.023	0.0145	0.0098	<0.0050
EA-5	06/26/18	23	0.915 ^{1,2,5}	<0.500	<0.500	<0.500	<0.320
EA-6	06/26/18	2	<0.0050	<0.0050	<0.0050	<0.0050	<0.0050
EA-6	06/26/18	7	<0.0050	<0.0050	<0.0050	<0.0050	<0.0050
EA-6	06/26/18	12	<0.0050	<0.0050	<0.0050	<0.0050	<0.0050
EA-6	06/26/18	17	<0.0050	<0.0050	<0.0050	<0.0050	<0.0050
EA-6	06/26/18	23	2.18 ^{1,2,5,6}	<0.500	<0.500	<0.500	<0.320
EA-7	06/26/18	2	<0.0050	<0.0050	<0.0050	<0.0050	<0.0050
EA-7	06/26/18	7	<0.0050	<0.0050	<0.0050	<0.0050	<0.0050
EA-7	06/26/18	12	<0.0050	<0.0050	<0.0050	<0.0050	<0.0050
EA-7	06/26/18	17	<0.0050	<0.0050	<0.0050	<0.0050	<0.0050
EA-7	06/26/18	23	<0.0050	<0.0050	<0.0050	<0.0050	<0.0050
EA-8	06/26/18	2	<0.0050	<0.0050	<0.0050	<0.0050	<0.0050
EA-8	06/26/18	7	<0.0050	0.0053	<0.0050	<0.0050	<0.0050
EA-8	06/26/18	12	<0.0050	<0.0050	<0.0050	<0.0050	<0.0050
EA-8	06/26/18	19.5	<0.0050	<0.0050	<0.0050	<0.0050	<0.0050
EA-8	06/26/18	24	<0.0050	<0.0050	<0.0050	<0.0050	<0.0050
EA-9	06/26/18	2	<0.0050	<0.0050	<0.0050	<0.0050	<0.0050
EA-9	06/26/18	7	<0.0050	<0.0050	<0.0050	<0.0050	<0.0050
EA-9	06/26/18	12	<0.0050	<0.0050	<0.0050	<0.0050	<0.0050
EA-9	06/26/18	17	<0.0050	<0.0050	<0.0050	<0.0050	<0.0050
EA-9	06/26/18	24	<0.0050	<0.0050	<0.0050	<0.0050	<0.0050
EA-10	06/26/18	2	<0.0050	<0.0050	<0.0050	<0.0050	<0.0050
SOIL COMPONENT TO GROUNDWATER INGESTION	CLASS I		0.03	12	13	150	0.32
	CLASS II		0.17	29	19	150	0.32
INGESTION REMEDIATION OBJECTIVES	RESIDENTIAL		12	16,000	7,800	16,000	780
	COMMERCIAL		100	410,000	200,000	410,000	20,000
INHALATION REMEDIATION OBJECTIVES	RESIDENTIAL		0.8	650	400	320	8,800
	COMMERCIAL		1.6	650	400	320	8,800
CONSTRUCTION WORKER REMEDIATION OBJECTIVES	INGESTION		2,300	410,000	20,000	41,000	2,000
	INHALATION		2.2	42	58	5.6	140

1-Class I Soil Component to Groundwater Remediation Objective exceeded

Results in mg/kg

2-Class II Soil Component to Groundwater Remediation Objective exceeded

3-Residential Ingestion Remediation Objective exceeded

4-Commercial Ingestion Remediation Objective exceeded

5-Residential Inhalation Remediation Objective exceeded

6-Commercial Inhalation Remediation Objective Exceeded

7-Construction Worker Ingestion Remediation Objective exceeded

8-Construction Worker Inhalation Remediation Objective exceeded



Soil BTEX/MTBE Analytical Results
300 West Galena Boulevard
Aurora, Illinois
Project No. 17-0299C

SAMPLE ID	DATE	DEPTH (FEET)	BENZENE	TOLUENE	ETHYL-BENZENE	TOTAL XYLENES	MTBE
EA-10	06/26/18	7	<0.0050	<0.0050	<0.0050	<0.0050	<0.0050
EA-10	06/26/18	12	<0.0050	<0.0050	<0.0050	<0.0050	<0.0050
EA-10	06/26/18	17	<0.0050	<0.0050	<0.0050	<0.0050	<0.0050
EA-10	06/26/18	24	<0.0050	<0.0050	<0.0050	<0.0050	<0.0050
EA-11	06/26/18	2	<0.0050	<0.0050	<0.0050	<0.0050	<0.0050
EA-11	06/26/18	7	<0.0050	<0.0050	<0.0050	<0.0050	<0.0050
EA-11	06/26/18	12	<0.0050	<0.0050	<0.0050	<0.0050	<0.0050
EA-11	06/26/18	17	<0.0050	<0.0050	<0.0050	0.0092	<0.0050
EA-11	06/26/18	22	<0.0050	<0.0050	<0.0050	<0.0050	<0.0050
EA-12	06/26/18	2	<0.0050	<0.0050	<0.0050	<0.0050	<0.0050
EA-12	06/26/18	7	<0.0050	<0.0050	<0.0050	<0.0050	<0.0050
EA-12	06/26/18	12	<0.0050	<0.0050	<0.0050	<0.0050	<0.0050
EA-12	06/26/18	17	<0.0050	<0.0050	<0.0050	<0.0050	<0.0050
EA-12	06/26/18	24	<0.0050	<0.0050	<0.0050	<0.0050	<0.0050
EA-13	06/26/18	2	<0.0050	<0.0050	<0.0050	<0.0050	<0.0050
EA-13	06/26/18	6	<0.0050	<0.0050	<0.0050	<0.0050	<0.0050
EA-13	06/26/18	12	<0.0050	0.0075	<0.0050	<0.0050	<0.0050
EA-14	06/26/18	2	<0.0050	<0.0050	<0.0050	<0.0050	<0.0050
EA-14	06/26/18	7	<0.0050	<0.0050	<0.0050	<0.0050	<0.0050
EA-14	06/26/18	12	<0.0050	<0.0050	<0.0050	<0.0050	<0.0050
EA-15	06/27/18	3	<0.0050	<0.0050	<0.0050	<0.0050	<0.0050
EA-15	06/27/18	7	<0.0050	<0.0050	<0.0050	<0.0050	<0.0050
EA-15	06/27/18	12	<0.0050	<0.0050	<0.0050	<0.0050	<0.0050
EA-16	06/27/18	3	<0.0050	<0.0050	<0.0050	<0.0050	<0.0050
EA-16	06/27/18	7	<0.0050	<0.0050	<0.0050	<0.0050	<0.0050
EA-16	06/27/18	12	<0.0050	<0.0050	<0.0050	<0.0050	<0.0050
EA-17	06/27/18	2	<0.0050	<0.0050	<0.0050	<0.0050	<0.0050
EA-17	06/27/18	7	<0.0050	<0.0050	<0.0050	<0.0050	<0.0050
EA-17	06/27/18	12	<0.0050	<0.0050	<0.0050	<0.0050	<0.0050
EA-18	06/27/18	2	<0.0050	<0.0050	<0.0050	<0.0050	<0.0050
EA-18	06/27/18	7	<0.0050	<0.0050	<0.0050	<0.0050	<0.0050
EA-18	06/27/18	12	<0.0050	<0.0050	<0.0050	<0.0050	<0.0050
EA-19	06/27/18	2	<0.0050	<0.0050	<0.0050	<0.0050	<0.0050
EA-19	06/27/18	7	<0.0050	<0.0050	<0.0050	<0.0050	<0.0050
EA-19	06/27/18	12	<0.0050	<0.0050	<0.0050	<0.0050	<0.0050
EA-20	06/27/18	2	<0.0050	<0.0050	<0.0050	<0.0050	<0.0050
EA-20	06/27/18	7	<0.0050	<0.0050	<0.0050	<0.0050	<0.0050
EA-20	06/27/18	14	0.0374 ¹	0.0413	0.0054	0.0508	<0.0050
EA-21	06/27/18	2	<0.0050	<0.0050	<0.0050	<0.0050	<0.0050
EA-21	06/27/18	7	<0.0050	<0.0050	<0.0050	<0.0050	<0.0050
EA-21	06/27/18	12	<0.0050	<0.0050	<0.0050	<0.0050	<0.0050
EA-22	06/27/18	2	<0.0050	<0.0050	<0.0050	<0.0050	<0.0050
EA-22	06/27/18	7	<0.0050	<0.0050	<0.0050	<0.0050	<0.0050
EA-22	06/27/18	12	<0.0050	<0.0050	<0.0050	<0.0050	<0.0050
SOIL COMPONENT TO GROUNDWATER INGESTION	CLASS I		0.03	12	13	150	0.32
	CLASS II		0.17	29	19	150	0.32
INGESTION REMEDIATION OBJECTIVES	RESIDENTIAL		12	16,000	7,800	16,800	780
	COMMERCIAL		100	410,000	200,000	410,000	20,000
INHALATION REMEDIATION OBJECTIVES	RESIDENTIAL		0.8	650	400	320	8,800
	COMMERCIAL		1.6	650	400	320	8,800
CONSTRUCTION WORKER REMEDIATION OBJECTIVES	INGESTION		2,300	410,000	20,000	41,000	2,000
	INHALATION		2.2	42	58	5.6	140

1-Class I Soil Component to Groundwater Remediation Objective exceeded

Results in mg/kg

2-Class II Soil Component to Groundwater Remediation Objective exceeded

3-Residential Ingestion Remediation Objective exceeded

4-Commercial Ingestion Remediation Objective exceeded

5-Residential Inhalation Remediation Objective exceeded

6-Commercial Inhalation Remediation Objective Exceeded

7-Construction Worker Ingestion Remediation Objective exceeded

8-Construction Worker Inhalation Remediation Objective exceeded



Soil BTEX/MTBE Analytical Results
300 West Galena Boulevard
Aurora, Illinois
Project No. 17-0299C

SAMPLE ID	DATE	DEPTH (FEET)	BENZENE	TOLUENE	ETHYL-BENZENE	TOTAL XYLENES	MTBE
EA-23	06/27/18	2	<0.0050	0.0064	<0.0050	<0.0050	<0.0050
EA-23	06/27/18	2	<0.0050	0.0064	<0.0050	<0.0050	<0.0050
EA-23	06/27/18	7	<0.0050	<0.0050	<0.0050	<0.0050	<0.0050
EA-23	06/27/18	12	<0.0050	<0.0050	<0.0050	<0.0050	<0.0050
EA-24	06/27/18	2	<0.0050	<0.0050	<0.0050	<0.0050	<0.0050
EA-24	06/27/18	7	<0.0050	<0.0050	<0.0050	<0.0050	<0.0050
EA-24	06/27/18	14	0.0143	0.011	<0.0050	0.0121	<0.0050
MW-1	02/20/19	18	<0.0050	<0.0050	<0.0050	<0.0050	<0.0050
MW-1	02/20/19	23	<0.0050	<0.0050	<0.0050	<0.0050	<0.0050
MW-2	02/20/19	17	<0.0050	<0.0050	<0.0050	<0.0050	<0.0050
MW-2	02/20/19	22	0.226 ^{1,2}	0.0088	0.0354	0.0069	<0.0050
MW-3	02/21/19	17	<0.0050	<0.0050	<0.0050	<0.0050	<0.0050
MW-3	02/21/19	24	<0.0050	<0.0050	<0.0050	<0.0050	<0.0050
MW-4	02/21/19	17	<0.0050	<0.0050	<0.0050	<0.0050	<0.0050
MW-4	02/21/19	24	<0.0050	<0.0050	<0.0050	<0.0050	<0.0050
MW-5	02/22/19	12	<0.0050	<0.0050	<0.0050	<0.0050	<0.0050
MW-5	02/22/19	17.5	<0.0050	<0.0050	<0.0050	<0.0050	<0.0050
MW-5	02/22/19	23	<0.0050	<0.0050	<0.0050	<0.0050	<0.0050
SB-1	02/22/19	13	<0.0050	<0.0050	<0.0050	<0.0050	<0.0050
SB-1	02/22/19	17	<0.0050	<0.0050	<0.0050	<0.0050	<0.0050
SB-1	02/22/19	24	<0.0050	<0.0050	<0.0050	<0.0050	<0.0050
SB-2	02/22/19	14	0.0055	0.0088	<0.0050	0.0055	<0.0050
SB-2	02/22/19	18	<0.0050	<0.0050	<0.0050	0.0067	<0.0050
SB-2	02/22/19	23	1.01 ^{1,2,5}	3.76	9.09	45.8 ⁴	<0.320
SB-3	02/22/19	14	<0.0050	<0.0050	<0.0050	<0.0050	<0.0050
SB-3	02/22/19	19	0.446 ^{1,2}	0.53	0.631	0.955	<0.320
SB-3	02/22/19	22	0.0339 ¹	0.0458	0.119	0.0944	<0.0050
SB-4	02/22/19	17	<0.0050	<0.0050	<0.0050	<0.0050	<0.0050
SB-4	02/22/19	23	0.0567 ¹	<0.0050	<0.0050	0.0117	<0.0050
MW-6	08/05/19	17'	<0.0050	<0.0050	<0.0050	<0.0050	<0.0050
MW-6	08/05/19	23'	<0.0050	<0.0050	<0.0050	<0.0050	<0.0050
MW-7	08/05/19	17'	<0.0050	<0.0050	<0.0050	<0.0050	<0.0050
MW-7	08/05/19	24'	0.0083	<0.0050	0.0172	0.0056	<0.0050
MW-9	08/06/19	17'	<0.0050	<0.0050	<0.0050	<0.0050	<0.0050
MW-9	08/06/19	21'	<0.0050	<0.0050	<0.0050	<0.0050	<0.0050
MW-10	08/06/19	17'	<0.0050	<0.0050	<0.0050	<0.0050	<0.0050
MW-10	08/06/19	22'	<0.0050	<0.0050	<0.0050	<0.0050	<0.0050
SB-5	08/06/19	19'	<0.0050	<0.0050	0.0129	0.0174	<0.0050
SB-5	08/06/19	23.5	0.0306	<0.0050	0.0464	0.0702	<0.0050
MW-11	10/21/20	18'	<0.0050	<0.0050	<0.0050	<0.0050	<0.0050
MW-11	10/21/20	22'	<0.0050	<0.0050	<0.0050	<0.0050	<0.0050
MW-12	10/21/20	18'	<0.0050	<0.0050	<0.0050	<0.0050	<0.0050
MW-12	10/21/20	21'	<0.0050	<0.0050	<0.0050	<0.0050	<0.0050
MW-14	04/05/21	3'	<0.0050	<0.0050	<0.0050	<0.0050	<0.0050
MW-14	04/05/21	8'	<0.0050	<0.0050	<0.0050	<0.0050	<0.0050
MW-15	04/05/21	3'	<0.0050	<0.0050	<0.0050	<0.0050	<0.0050
MW-15	04/05/21	8'	<0.0050	0.0061	<0.0050	<0.0050	<0.0050
SOIL COMPONENT TO GROUNDWATER INGESTION	CLASS I		0.03	12	13	150	0.32
	CLASS II		0.17	29	19	150	0.32
INGESTION REMEDIATION OBJECTIVES	RESIDENTIAL		12	16,000	7,800	16,000	780
	COMMERCIAL		100	410,000	200,000	410,000	20,000
INHALATION REMEDIATION OBJECTIVES	RESIDENTIAL		0.8	650	400	320	8,800
	COMMERCIAL		1.6	650	400	320	8,800
CONSTRUCTION WORKER REMEDIATION OBJECTIVES	INGESTION		2,300	410,000	20,000	41,000	2,000
	INHALATION		2.2	42	58	5.6	140

Results in mg/kg

- 1-Class I Soil Component to Groundwater Remediation Objective exceeded
- 2-Class II Soil Component to Groundwater Remediation Objective exceeded
- 3-Residential Ingestion Remediation Objective exceeded
- 4-Commercial Ingestion Remediation Objective exceeded
- 5-Residential Inhalation Remediation Objective exceeded
- 6-Commercial Inhalation Remediation Objective Exceeded
- 7-Construction Worker Ingestion Remediation Objective exceeded
- 8-Construction Worker Inhalation Remediation Objective exceeded



Groundwater BTEX/MTBE Analytical Results
300 West Galena Boulevard
Aurora, Illinois
Project No. 17-0299C

SAMPLE ID	DATE	BENZENE	TOLUENE	ETHYLBENZENE	TOTAL XYLENES	MTBE
MW-1	03/14/19	< 0.0050	< 0.0050	< 0.0050	< 0.0050	< 0.0050
MW-2	03/14/19	0.1780 ^{1,2}	< 0.0050	0.0249	< 0.0050	0.0119
MW-3	03/14/19	< 0.0050	< 0.0050	< 0.0050	< 0.0050	< 0.0050
MW-4	03/14/19	0.0098 ¹	< 0.0050	0.0319	0.0129	< 0.0050
MW-5	03/14/19	< 0.0050	< 0.0050	< 0.0050	< 0.0050	< 0.0050
MW-6	08/16/19	< 0.0050	< 0.0050	< 0.0050	< 0.0050	< 0.0050
MW-7	08/16/19	0.1610 ^{1,2}	< 0.0050	0.206	0.101	< 0.0050
MW-8	08/16/19	0.3620 ^{1,2}	0.0238	1.0400 ^{1,2}	1.78	0.0066
MW-9	08/16/19	< 0.0050	< 0.0050	< 0.0050	< 0.0050	< 0.0050
MW-10	08/16/19	< 0.0050	< 0.0050	< 0.0050	< 0.0050	< 0.0050
MW-11	10/30/20	< 0.0050	< 0.0050	< 0.0050	< 0.0050	< 0.0050
MW-12	10/30/20	< 0.0050	< 0.0050	< 0.0050	< 0.0050	< 0.0050
MW-13	10/30/20	< 0.0050	< 0.0050	< 0.0050	< 0.0050	< 0.0050
MW-14	04/19/21	< 0.0050	< 0.0050	< 0.0050	< 0.0050	< 0.0050
MW-15	04/19/21	< 0.0050	< 0.0050	< 0.0050	< 0.0050	< 0.0050
GROUNDWATER REMEDIAION OBJECTIVES	CLASS I	0.005	1	0.7	10	0.07
	CLASS II	0.025	2.5	1	10	0.07
GROUNDWATER INDOOR INHALATION	Residential	0.11	530	0.37	30	1,900
	Commercial	0.41	530	1.4	93	6,800

1 = Class I Remediation Objectives exceeded

Units in mg/L

2 = Class II Remediation Objectives exceeded

3 = Residential GW Indoor Inhalation Objectives exceeded

4 = Commercial GW Indoor Inhalation Objectives exceeded

* This site has been evaluated based on Class I Remediation Objectives



EXHIBIT C

PROPOSED HIGHWAY AUTHORITY AGREEMENT AREA

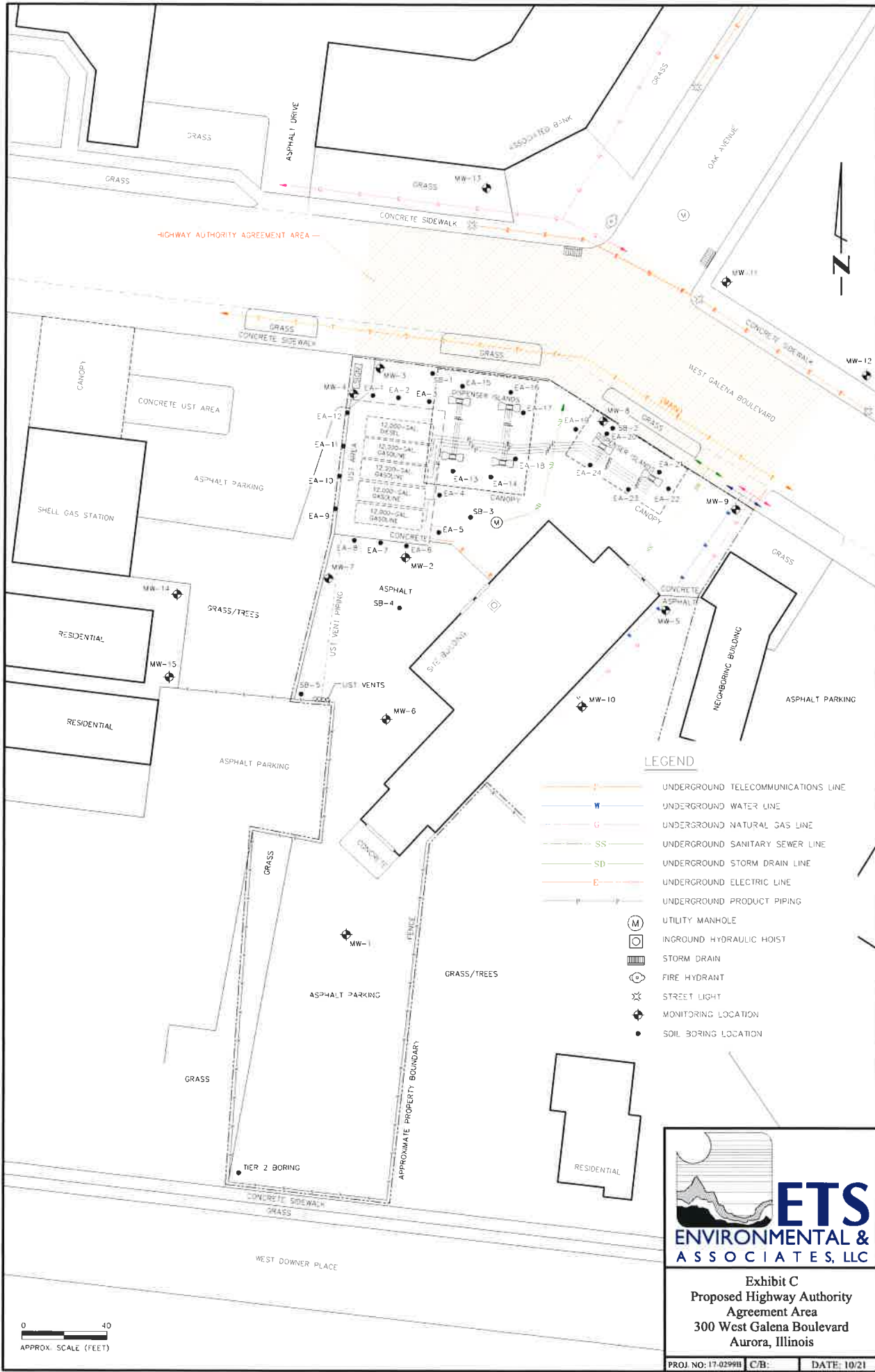

LEGEND

- UNDERGROUND TELECOMMUNICATIONS LINE
- UNDERGROUND WATER LINE
- UNDERGROUND NATURAL GAS LINE
- UNDERGROUND SANITARY SEWER LINE
- UNDERGROUND STORM DRAIN LINE
- UNDERGROUND ELECTRIC LINE
- UNDERGROUND PRODUCT PIPING
- UTILITY MANHOLE
- INGROUND HYDRAULIC HOIST
- STORM DRAIN
- FIRE HYDRANT
- STREET LIGHT
- MONITORING LOCATION
- SOIL BORING LOCATION



ETS
ENVIRONMENTAL &
ASSOCIATES, LLC

Exhibit C
 Proposed Highway Authority
 Agreement Area
 300 West Galena Boulevard
 Aurora, Illinois