

KANE COUNTY ← → DUPAGE COUNTY

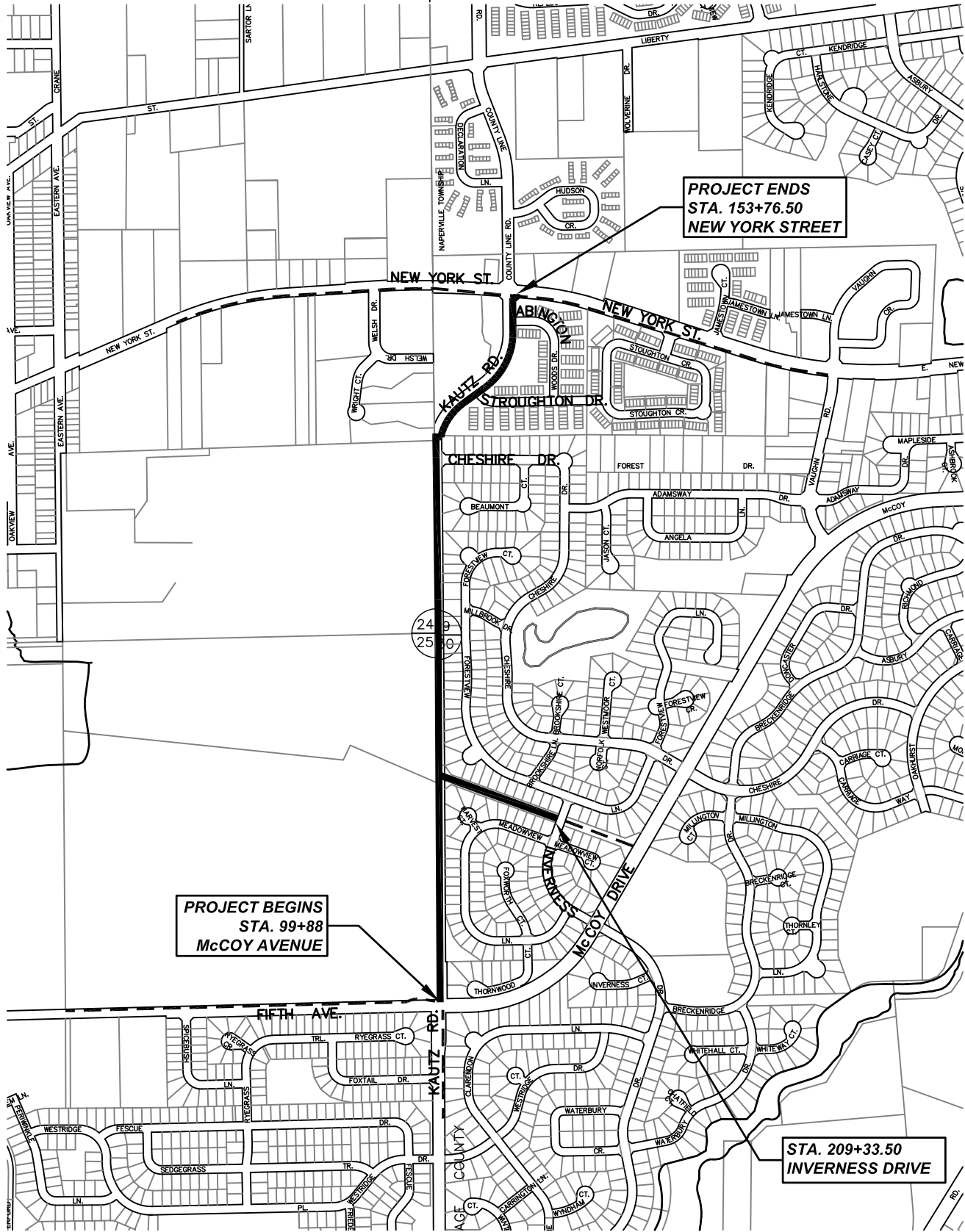

PROJECT BEGINS
STA. 99+88
McCOY AVENUE

PROJECT ENDS
STA. 153+76.50
NEW YORK STREET

STA. 209+33.50
INVERNESS DRIVE

CITY OF AURORA

SECTION 14-00303-00-BT
ADDENDUM NUMBER 1

KAUTZ ROAD ITP SHARED USE PATH - LOCATION MAP

Engineering Enterprises, Inc.
 52 Wheeler Road
 Sugar Grove, Illinois 60554
 630.466.6700 - www.eeiweb.com

SCALE:
N.T.S.
 DATE:
06/06/16

DRAWN BY:
KKP
 REVISED: