

**Legal Description**

SEE ATTACHED

**Locator Map**

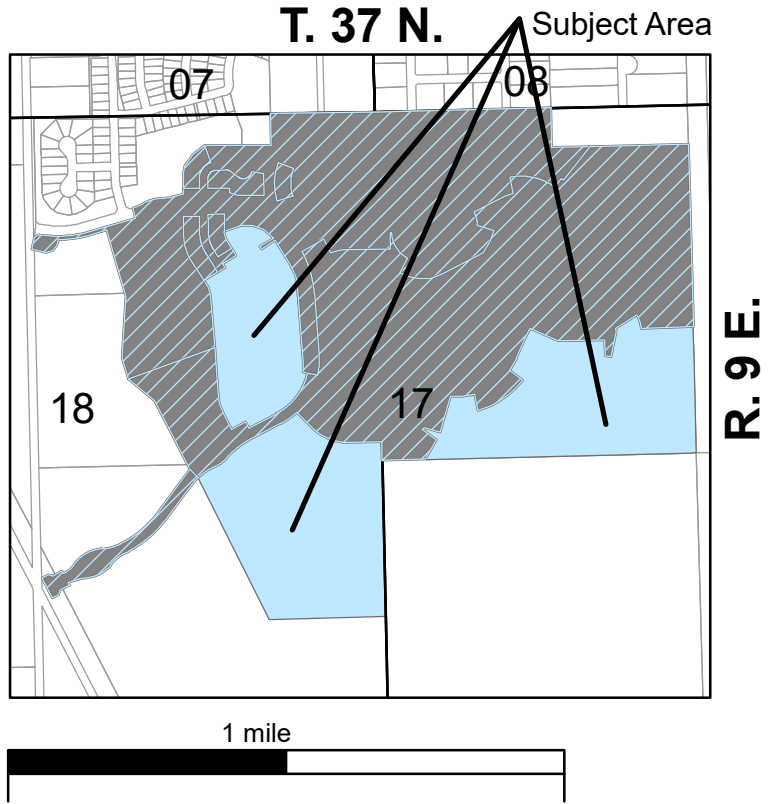

**Actual Area**

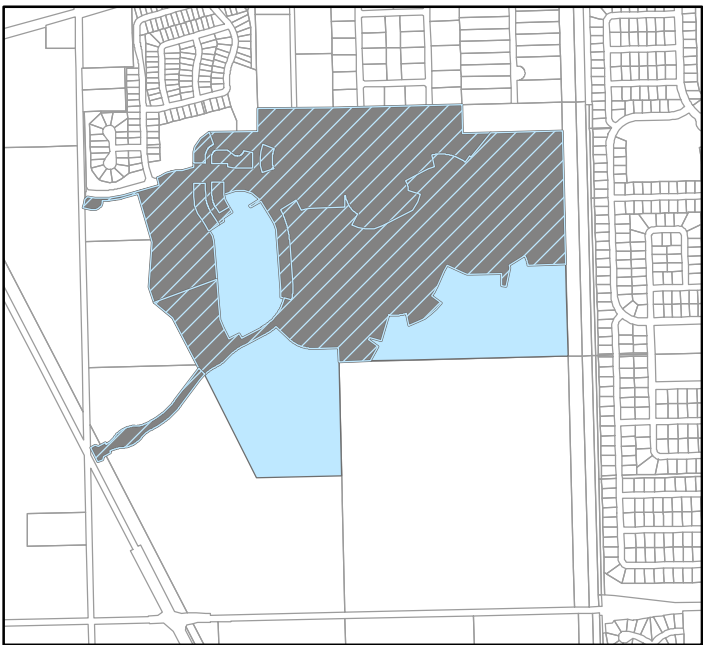

**PIN(s)**

SEE ATTACHED

**Common Address**

East of South Eola Road & South of Wolf's Crossing Road  
(Lincoln Prairie by Del Webb)



**LEGAL DESCRIPTION FOR  
LINCOLN PRAIRIE BY DEL WEBB SUBDIVISION – PHASE 3  
AURORA, ILLINOIS**

LOT 559 IN LINCOLN PRAIRIE BY DEL WEBB – PHASE 1A, BEING A SUBDIVISION OF PART OF SECTION 17 AND SECTION 18, IN TOWNSHIP 37 NORTH, RANGE 9 EAST OF THE THIRD PRINCIPAL MERIDIAN, ACCORDING TO THE PLAT THEREOF RECORDED MAY 10, 2022, AS DOCUMENT R2022037215, IN WILL COUNTY, ILLINOIS.

TOGETHER WITH:

LOT 566 IN LINCOLN PRAIRIE BY DEL WEBB – PHASE 2A, BEING A SUBDIVISION OF PART OF SECTION 17 AND SECTION 18, IN TOWNSHIP 37 NORTH, RANGE 9 EAST OF THE THIRD PRINCIPAL MERIDIAN, ACCORDING TO THE PLAT THEREOF RECORDED SEPTEMBER 11, 2023, AS DOCUMENT R2023047268, IN WILL COUNTY, ILLINOIS.

TOGETHER WITH:

THAT PART OF THE NORTHEAST QUARTER OF SECTION 18, TOWNSHIP 37 NORTH, RANGE 9 EAST OF THE THIRD PRINCIPAL MERIDIAN, IN WILL COUNTY, ILLINOIS, BEING MORE PARTICULARLY DESCRIBED AS FOLLOWS:

BEGINNING AT THE MOST SOUTHEASTERLY CORNER OF LOT 556 IN LINCOLN PRAIRIE BY DEL WEBB-PHASE 1A, RECORDED AS DOCUMENT NUMBER R2022037215, SAID CORNER BEING A POINT ON THE EXTERIOR BOUNDARY OF LINCOLN PRAIRIE BY DEL WEBB-PHASE 2A, RECORDED AS DOCUMENT NUMBER R2023047268; THENCE ALONG SAID EXTERIOR BOUNDARY FOR THE FOLLOWING EIGHT (8) COURSES: (1) THENCE SOUTHWESTERLY, ALONG A CURVE, CONCAVE TO THE NORTHWEST, HAVING A RADIUS OF 460.00 FEET, AN ARC DISTANCE OF 404.31 FEET, A CHORD BEARING SOUTH 37 DEGREES 33 MINUTES 15 SECONDS WEST, AND A CHORD DISTANCE OF 391.42 FEET TO A POINT OF TANGENCY; (2) THENCE SOUTH 62 DEGREES 44 MINUTES 03 SECONDS WEST, A DISTANCE OF 233.00 FEET; (3) THENCE NORTH 27 DEGREES 15 MINUTES 57 SECONDS WEST, A DISTANCE OF 50.00 FEET; (4) THENCE SOUTH 62 DEGREES 44 MINUTES 03 SECONDS WEST, A DISTANCE OF 120.00 FEET; (5) THENCE NORTH 27 DEGREES 15 MINUTES 57 SECONDS WEST, A DISTANCE OF 140.08 FEET; (6) THENCE NORTH 20 DEGREES 50 MINUTES 06 SECONDS WEST, A DISTANCE OF 80.94 FEET; (7) THENCE NORTH 06 DEGREES 40 MINUTES 41 SECONDS WEST, A DISTANCE OF 86.02 FEET; (8) THENCE NORTH 04 DEGREES 28 MINUTES 42 SECONDS WEST, A DISTANCE OF 334.83 FEET TO THE SOUTHEASTERLY CORNER OF LOT 559 IN SAID LINCOLN PRAIRIE BY DEL WEBB - PHASE 1A; THENCE ALONG THE EAST LINE OF SAID LOT 559 FOR THE NEXT THREE (3) COURSES: (1) THENCE NORTH 04 DEGREES 28 MINUTES 42 SECONDS WEST, A DISTANCE OF 404.00 FEET; (2) THENCE NORTH 15 DEGREES 42 MINUTES 01 SECONDS WEST, A DISTANCE OF 57.22 FEET; (3) THENCE NORTH 31 DEGREES 37 MINUTES 54 SECONDS WEST, A DISTANCE OF 64.17 FEET TO A POINT ON THE SOUTH LINE OF LOT 533 IN LINCOLN PRAIRIE BY DEL WEBB-PHASE 1B, RECORDED AS DOCUMENT NUMBER R2023003958; THENCE NORTH 57 DEGREES 48 MINUTES 54 SECONDS EAST, ALONG SAID SOUTH LINE, A DISTANCE OF 120.00 FEET TO THE SOUTHEAST CORNER OF LOT 533 AND THE EXTERIOR BOUNDARY OF SAID LINCOLN PRAIRIE BY DEL WEBB - PHASE 1A; THENCE ALONG SAID EXTERIOR BOUNDARY FOR THE FOLLOWING FOUR (4) COURSES: (1) THENCE NORTH 57 DEGREES 48 MINUTES 54 SECONDS EAST, A DISTANCE OF 66.00 FEET (2) THENCE NORTH 32 DEGREES 11 MINUTES 06 SECONDS WEST, A DISTANCE OF 30.67 FEET; (3) THENCE NORTH 57 DEGREES 48 MINUTES 54 SECONDS EAST, A DISTANCE OF 122.00 FEET; (4) THENCE NORTH 32 DEGREES 11 MINUTES 06 SECONDS WEST, A DISTANCE OF 66.00 FEET TO THE SOUTHEAST CORNER OF LOT 523 IN SAID LINCOLN PRAIRIE BY DEL WEBB - PHASE 1B; THENCE ALONG THE EXTERIOR BOUNDARY OF LINCOLN PRAIRIE BY DEL WEBB - PHASE 1B FOR THE FOLLOWING THREE (3) COURSES: (1) THENCE NORTH 32 DEGREES 11 MINUTES 06 SECONDS WEST, A DISTANCE OF 81.26 FEET; (2) THENCE NORTH 13 DEGREES 48 MINUTES 41 SECONDS WEST, A DISTANCE OF 59.35 FEET; (3) THENCE NORTH 70 DEGREES 41 MINUTES 39 SECONDS EAST, A DISTANCE OF 5.29 FEET TO THE EXTERIOR BOUNDARY OF SAID LINCOLN PRAIRIE BY DEL WEBB - PHASE 1A; THENCE ALONG SAID EXTERIOR BOUNDARY FOR THE FOLLOWING THIRTEEN (13)

**LEGAL DESCRIPTION FOR  
LINCOLN PRAIRIE BY DEL WEBB SUBDIVISION – PHASE 3  
AURORA, ILLINOIS**

COURSES: (1) THENCE NORTH 70 DEGREES 41 MINUTES 39 SECONDS EAST, A DISTANCE OF 129.99 FEET; (2) THENCE NORTH 88 DEGREES 50 MINUTES 04 SECONDS EAST, A DISTANCE OF 87.41 FEET; (3) THENCE SOUTH 71 DEGREES 39 MINUTES 34 SECONDS EAST, A DISTANCE OF 87.41 FEET; (4) THENCE SOUTH 48 DEGREES 12 MINUTES 28 SECONDS EAST, A DISTANCE OF 104.85 FEET; (5) THENCE SOUTH 57 DEGREES 48 MINUTES 54 SECONDS WEST, A DISTANCE OF 122.80 FEET TO A POINT OF NON-TANGENT CURVATURE; (6) THENCE SOUTHEASTERLY, ALONG A CURVE, CONCAVE TO THE SOUTHWEST, HAVING A RADIUS OF 133.00 FEET, AN ARC DISTANCE OF 20.19 FEET, A CHORD BEARING SOUTH 39 DEGREES 36 MINUTES 30 SECONDS EAST, AND A CHORD DISTANCE OF 20.17 FEET TO A POINT OF NON-TANGENCY; (7) THENCE NORTH 57 DEGREES 48 MINUTES 54 SECONDS EAST, A DISTANCE OF 120.19 FEET; (8) THENCE SOUTH 32 DEGREES 11 MINUTES 06 SECONDS EAST, A DISTANCE OF 208.32 FEET; (9) THENCE SOUTH 29 DEGREES 30 MINUTES 59 SECONDS EAST, A DISTANCE OF 66.17 FEET; (10) THENCE SOUTH 17 DEGREES 28 MINUTES 08 SECONDS EAST, A DISTANCE OF 66.03 FEET; (11) THENCE SOUTH 04 DEGREES 28 MINUTES 42 SECONDS EAST, A DISTANCE OF 627.71 FEET; (12) THENCE SOUTH 00 DEGREES 13 MINUTES 46 SECONDS EAST, A DISTANCE OF 79.27 FEET; (13) THENCE SOUTH 78 DEGREES 32 MINUTES 40 SECONDS EAST, A DISTANCE OF 34.44 FEET TO THE POINT OF BEGINNING.

TOGETHER WITH:

THAT PART OF THE NORTHWEST QUARTER OF SECTION 17, TOWNSHIP 37 NORTH, RANGE 9 EAST OF THE THIRD PRINCIPAL MERIDIAN, IN WILL COUNTY, ILLINOIS, BEING MORE PARTICULARLY DESCRIBED AS FOLLOWS:

BEGINNING AT THE SOUTHEAST CORNER OF LOT 372 IN LINCOLN PRAIRIE BY DEL WEBB-PHASE 2A, RECORDED AS DOCUMENT NUMBER R2023047268; THENCE ALONG THE EXTERIOR BOUNDARY OF SAID LINCOLN PRAIRIE BY DEL WEBB - PHASE 2A FOR THE FOLLOWING TWENTY-SEVEN (27) COURSES: (1) THENCE NORTH 29 DEGREES 40 MINUTES 13 SECONDS EAST, A DISTANCE OF 170.31 FEET; (2) THENCE NORTH 53 DEGREES 49 MINUTES 27 SECONDS WEST, A DISTANCE OF 130.00 FEET TO A POINT OF NON-TANGENT CURVATURE; (3) THENCE NORTHEASTERLY, ALONG A CURVE, CONCAVE TO THE NORTHWEST, HAVING A RADIUS OF 208.00 FEET, AN ARC DISTANCE OF 21.68 FEET, A CHORD BEARING NORTH 33 DEGREES 11 MINUTES 25 SECONDS EAST, AND A CHORD DISTANCE OF 21.67 FEET TO A POINT OF NON-TANGENCY; (4) THENCE SOUTH 73 DEGREES 32 MINUTES 02 SECONDS EAST, A DISTANCE OF 125.95 FEET; (5) THENCE NORTH 16 DEGREES 27 MINUTES 58 SECONDS EAST, A DISTANCE OF 285.87 FEET TO A POINT OF NON-TANGENT CURVATURE; (6) THENCE EASTERLY, ALONG A CURVE, CONCAVE TO THE NORTH, HAVING A RADIUS OF 490.00 FEET, AN ARC DISTANCE OF 183.22 FEET, A CHORD BEARING NORTH 85 DEGREES 28 MINUTES 25 SECONDS EAST, AND A CHORD DISTANCE OF 182.15 FEET TO A POINT OF NON-TANGENCY; (7) THENCE SOUTH 11 DEGREES 22 MINUTES 36 SECONDS EAST, A DISTANCE OF 127.28 FEET; (8) THENCE NORTH 69 DEGREES 38 MINUTES 40 SECONDS EAST, A DISTANCE OF 102.46 FEET; (9) THENCE NORTH 62 DEGREES 20 MINUTES 09 SECONDS EAST, A DISTANCE OF 79.02 FEET; (10) THENCE NORTH 54 DEGREES 58 MINUTES 10 SECONDS EAST, A DISTANCE OF 79.02 FEET; (11) THENCE NORTH 47 DEGREES 36 MINUTES 10 SECONDS EAST, A DISTANCE OF 79.02 FEET; (12) THENCE NORTH 40 DEGREES 14 MINUTES 10 SECONDS EAST, A DISTANCE OF 79.02 FEET; (13) THENCE NORTH 53 DEGREES 26 MINUTES 50 SECONDS WEST, A DISTANCE OF 125.00 FEET TO A POINT OF NON-TANGENT CURVATURE; (14) THENCE NORTHEASTERLY, ALONG A CURVE, CONCAVE TO THE NORTHWEST, HAVING A RADIUS OF 490.00 FEET, AN ARC DISTANCE OF 107.52 FEET, A CHORD BEARING NORTH 30 DEGREES 15 MINUTES 59 SECONDS EAST, AND A CHORD DISTANCE OF 107.31 FEET TO A POINT OF TANGENCY; (15) THENCE NORTH 23 DEGREES 58 MINUTES 48 SECONDS EAST, A DISTANCE OF 181.62 FEET TO A POINT OF CURVATURE; (16) THENCE NORTHEASTERLY, ALONG A CURVE, CONCAVE TO THE SOUTHEAST, HAVING A RADIUS OF 460.00 FEET, AN ARC DISTANCE OF 67.23 FEET, A CHORD BEARING NORTH 28 DEGREES 10 MINUTES 01 SECONDS EAST, AND A CHORD DISTANCE OF 67.17 FEET TO A POINT OF NON-TANGENCY; (17) THENCE SOUTH 66 DEGREES 01 MINUTES 12 SECONDS EAST, A DISTANCE OF 190.90 FEET; (18) THENCE SOUTH 71 DEGREES 10 MINUTES 14 SECONDS EAST, A

**LEGAL DESCRIPTION FOR  
LINCOLN PRAIRIE BY DEL WEBB SUBDIVISION – PHASE 3  
AURORA, ILLINOIS**

DISTANCE OF 39.36 FEET; (19) THENCE SOUTH 86 DEGREES 01 MINUTES 47 SECONDS EAST, A DISTANCE OF 39.01 FEET; (20) THENCE NORTH 88 DEGREES 37 MINUTES 27 SECONDS EAST, A DISTANCE OF 315.00 FEET; (21) THENCE SOUTH 01 DEGREES 22 MINUTES 33 SECONDS EAST, A DISTANCE OF 123.52 FEET TO A POINT OF NON-TANGENT CURVATURE; (22) THENCE EASTERLY, ALONG A CURVE, CONCAVE TO THE SOUTH, HAVING A RADIUS OF 533.00 FEET, AN ARC DISTANCE OF 45.68 FEET, A CHORD BEARING SOUTH 82 DEGREES 20 MINUTES 01 SECONDS EAST, AND A CHORD DISTANCE OF 45.67 FEET TO A POINT OF NON-TANGENCY; (23) THENCE NORTH 11 DEGREES 37 MINUTES 27 SECONDS EAST, A DISTANCE OF 193.18 FEET; (24) THENCE NORTH 11 DEGREES 01 MINUTES 23 SECONDS WEST, A DISTANCE OF 25.77 FEET; (25) THENCE NORTH 56 DEGREES 53 MINUTES 49 SECONDS EAST, A DISTANCE OF 191.00 FEET TO A POINT OF NON-TANGENT CURVATURE; (26) THENCE SOUTHERLY, ALONG A CURVE, CONCAVE TO THE WEST, HAVING A RADIUS OF 208.00 FEET, AN ARC DISTANCE OF 111.05 FEET, A CHORD BEARING SOUTH 17 DEGREES 48 MINUTES 31 SECONDS EAST, AND A CHORD DISTANCE OF 109.73 FEET TO A POINT OF NON-TANGENCY; (27) THENCE NORTH 87 DEGREES 29 MINUTES 10 SECONDS EAST, A DISTANCE OF 397.63 FEET TO THE WEST LINE OF THE COMMONWEALTH EDISON COMPANY RIGHT-OF-WAY DEDICATED PER DOCUMENT NUMBER 394069; THENCE SOUTH 01 DEGREES 29 MINUTES 20 SECONDS EAST, ALONG SAID WEST LINE, A DISTANCE OF 962.03 FEET TO THE SOUTH LINE OF THE NORTHWEST QUARTER OF SAID SECTION 17; THENCE SOUTH 88 DEGREES 37 MINUTES 27 SECONDS WEST, ALONG SAID SOUTH LINE, A DISTANCE OF 2063.18 FEET TO THE POINT OF BEGINNING.

TOGETHER WITH:

THAT PART OF THE EAST HALF OF SECTION 18, TOWNSHIP 37 NORTH, RANGE 9 EAST OF THE THIRD PRINCIPAL MERIDIAN, IN WILL COUNTY, ILLINOIS, BEING MORE PARTICULARLY DESCRIBED AS FOLLOWS:

BEGINNING AT THE SOUTHWEST CORNER OF LOT 376 IN LINCOLN PRAIRIE BY DEL WEBB-PHASE 2A, RECORDED AS DOCUMENT NUMBER R2023047268, SAID CORNER ALSO BEING THE NORTHEAST CORNER OF THE SOUTHEAST QUARTER OF SAID SECTION 18; THENCE SOUTH 01 DEGREES 20 MINUTES 40 SECONDS EAST, ALONG THE EAST LINE OF SAID SOUTHEAST QUARTER, A DISTANCE OF 1181.96 FEET; THENCE SOUTH 88 DEGREES 39 MINUTES 20 SECONDS WEST, A DISTANCE OF 885.00 FEET; THENCE NORTH 26 DEGREES 45 MINUTES 46 SECONDS WEST, A DISTANCE OF 1201.19 TO A POINT ON THE EXTERIOR BOUNDARY OF SAID LINCOLN PRAIRIE BY DEL WEBB - PHASE 2A; THENCE ALONG SAID EXTERIOR BOUNDARY FOR THE FOLLOWING NINE (9) COURSES: (1) THENCE NORTHEASTERLY, ALONG A CURVE, CONCAVE TO THE SOUTHEAST, HAVING A RADIUS OF 440.00 FEET, AN ARC DISTANCE OF 146.72 FEET, A CHORD BEARING NORTH 55 DEGREES 49 MINUTES 36 SECONDS EAST, AND A CHORD DISTANCE OF 146.04 FEET TO A POINT OF REVERSE CURVATURE; (2) THENCE NORTHEASTERLY, ALONG A CURVE, CONCAVE TO THE NORTHWEST, HAVING A RADIUS OF 300.00 FEET, AN ARC DISTANCE OF 119.05 FEET, A CHORD BEARING NORTH 54 DEGREES 00 MINUTES 39 SECONDS EAST, AND A CHORD DISTANCE OF 118.27 FEET TO A POINT OF REVERSE CURVATURE; (3) THENCE NORTHEASTERLY, ALONG A CURVE, CONCAVE TO THE SOUTHEAST, HAVING A RADIUS OF 700.00 FEET, AN ARC DISTANCE OF 245.46 FEET, A CHORD BEARING NORTH 52 DEGREES 41 MINUTES 18 SECONDS EAST, AND A CHORD DISTANCE OF 244.21 FEET TO A POINT OF TANGENCY; (4) THENCE NORTH 62 DEGREES 44 MINUTES 03 SECONDS EAST, A DISTANCE OF 244.07 FEET TO A POINT OF CURVATURE; (5) THENCE NORTHEASTERLY, ALONG A CURVE, CONCAVE TO THE NORTHWEST, HAVING A RADIUS OF 540.00 FEET, AN ARC DISTANCE OF 145.27 FEET, A CHORD BEARING NORTH 55 DEGREES 01 MINUTES 38 SECONDS EAST, AND A CHORD DISTANCE OF 144.83 FEET TO A POINT OF NON-TANGENCY; (6) THENCE SOUTH 46 DEGREES 11 MINUTES 00 SECONDS EAST, A DISTANCE OF 173.10 FEET TO A POINT OF CURVATURE; (7) THENCE EASTERLY, ALONG A CURVE, CONCAVE TO THE NORTH, HAVING A RADIUS OF 383.00 FEET, AN ARC DISTANCE OF 301.88 FEET, A CHORD BEARING SOUTH 68 DEGREES 45 MINUTES 50 SECONDS EAST, AND A CHORD DISTANCE OF 294.13 FEET TO A POINT OF TANGENCY; (8) THENCE NORTH 88 DEGREES 39 MINUTES 20 SECONDS EAST, A DISTANCE OF 249.17 FEET; (9)

**LEGAL DESCRIPTION FOR  
LINCOLN PRAIRIE BY DEL WEBB SUBDIVISION – PHASE 3  
AURORA, ILLINOIS**

THENCE SOUTH 01 DEGREES 20 MINUTES 40 SECONDS EAST, A DISTANCE OF 144.00 FEET TO THE POINT OF BEGINNING.

CONTAINING 5,055,452 SQUARE FEET (116.057 ACRES), MORE OR LESS