



Proposed Sign Package
Aurora, IL
1390 Butterfield Road

3.18.2023A

Revisions:
XX.XX.XX | Revision Notes

| Elevation Data Table: Wall Signage | | | |
|------------------------------------|---|----------|-------------|
| Wall Sign # | Description | Value | Unit |
| S1 | i) Width of Façade - on which Sign is Located | 38.75 | Feet |
| | ii) Height of Façade - on which Sign is Located | 23.25 | Feet |
| | iii) Square Footage of Façade - on which Sign is Located | 900.94 | Square Feet |
| | iv) Width of Sign Face | 13.50 | Feet |
| | v) Height of Sign Face | 4.00 | Feet |
| | vi) Square Footage of Sign Face | 54.00 | Square Feet |
| | vii) Percent of Sign Coverage - Façade on which Sign is Located | 6% | Percent |
| S2 | i) Width of Façade - on which Sign is Located | 65.33 | Feet |
| | ii) Height of Façade - on which Sign is Located | 23.25 | Feet |
| | iii) Square Footage of Façade - on which Sign is Located | 1,519.00 | Square Feet |
| | iv) Width of Sign Face | 6.00 | Feet |
| | v) Height of Sign Face | 6.00 | Feet |
| | vi) Square Footage of Sign Face | 36.00 | Square Feet |
| | vii) Percent of Sign Coverage - Façade on which Sign is Located | 2% | Percent |
| S3 | i) Width of Façade - on which Sign is Located | 65.33 | Feet |
| | ii) Height of Façade - on which Sign is Located | 21.67 | Feet |
| | iii) Square Footage of Façade - on which Sign is Located | 1,415.44 | Square Feet |
| | iv) Width of Sign Face | 6.00 | Feet |
| | v) Height of Sign Face | 6.00 | Feet |
| | vi) Square Footage of Sign Face | 36.00 | Square Feet |
| | vii) Percent of Sign Coverage - Façade on which Sign is Located | 3% | Percent |
| S4 | i) Width of Façade - on which Sign is Located | 65.33 | Feet |
| | ii) Height of Façade - on which Sign is Located | 21.67 | Feet |
| | iii) Square Footage of Façade - on which Sign is Located | 1,415.70 | Square Feet |
| | iv) Width of Sign Face | 2.83 | Feet |
| | v) Height of Sign Face | 9.90 | Feet |
| | vi) Square Footage of Sign Face | 28.02 | Square Feet |
| | vii) Percent of Sign Coverage - Façade on which Sign is Located | 2% | Percent |
| S5 | i) Width of Façade - on which Sign is Located | 39.67 | Feet |
| | ii) Height of Façade - on which Sign is Located | 21.67 | Feet |
| | iii) Square Footage of Façade - on which Sign is Located | 859.65 | Square Feet |
| | iv) Width of Sign Face | 6.00 | Feet |
| | v) Height of Sign Face | 6.00 | Feet |
| | vi) Square Footage of Sign Face | 36.00 | Square Feet |
| | vii) Percent of Sign Coverage - Façade on which Sign is Located | 4% | Percent |

| Elevation Data Table: Ground Signage | | | |
|--------------------------------------|---|--|-------------|
| Ground Sign # | Description | Value | Unit |
| D6.1/6.2 | i) Length of street frontage - on which Sign is Located | 65 | Feet |
| | ii) Width of Sign Face | 5 | Feet |
| | iii) Height of Sign Face | 1 | Feet |
| | iv) Square Footage of Sign Face | 8 | Square Feet |
| | v) Height of Sign (overall) | 6 | Feet |
| | vi) Width of Sign (overall) | 6 | Feet |
| | vii) Type of Sign | Clearance Bar | |
| | viii) Type of Sign Base | Concrete foundation | |
| | ix) Is there a Digital Display | no | |
| | | If Yes then, Location of Digital Display on the sign | |
| | | Height of Digital Display | Feet |
| | | Width of Digital Display | Feet |
| | | Square Footage of Digital Display | Square Feet |
| | Percent of Digital Display Sign Coverage | Percent | |
| D7 | i) Length of street frontage - on which Sign is Located | 65 | Feet |
| | ii) Width of Sign Face | 1 | Feet |
| | iii) Height of Sign Face | 6 | Feet |
| | iv) Square Footage of Sign Face | 4 | Square Feet |
| | v) Height of Sign (overall) | 11 | Feet |
| | vi) Width of Sign (overall) | 6 | Feet |
| | vii) Type of Sign | Drive-thru Canopy | |
| | viii) Type of Sign Base | Concrete foundation | |
| | ix) Is there a Digital Display | no | |
| | | If Yes then, Location of Digital Display on the sign | |
| | | Height of Digital Display | Feet |
| | | Width of Digital Display | Feet |
| | | Square Footage of Digital Display | Square Feet |
| | Percent of Digital Display Sign Coverage | Percent | |
| D8 | i) Length of street frontage - on which Sign is Located | 39 | Feet |
| | ii) Width of Sign Face | 7 | Feet |
| | iii) Height of Sign Face | 4 | Feet |
| | iv) Square Footage of Sign Face | 29 | Square Feet |
| | v) Height of Sign (overall) | 6 | Feet |
| | vi) Width of Sign (overall) | 7 | Feet |
| | vii) Type of Sign | DT Menu Board | |
| | viii) Type of Sign Base | Concrete foundation | |
| | ix) Is there a Digital Display | no | |
| | | If Yes then, Location of Digital Display on the sign | |
| | | Height of Digital Display | Feet |
| | | Width of Digital Display | Feet |
| | | Square Footage of Digital Display | Square Feet |
| | Percent of Digital Display Sign Coverage | Percent | |

| | | | |
|-----|---|--|-------------|
| D9 | i) Length of street frontage - on which Sign is Located | 65 | Feet |
| | ii) Width of Sign Face | 2 | Feet |
| | iii) Height of Sign Face | 4 | Feet |
| | iv) Square Footage of Sign Face | 8 | Square Feet |
| | v) Height of Sign (overall) | 4 | Feet |
| | vi) Width of Sign (overall) | 2 | Feet |
| | vii) Type of Sign | Directional | |
| | viii) Type of Sign Base | Concrete Foundation | |
| | ix) Is there a Digital Display | no | |
| | | If Yes then, Location of Digital Display on the sign | |
| | | Height of Digital Display | Feet |
| | | Width of Digital Display | Feet |
| | | Square Footage of Digital Display | Square Feet |
| | Percent of Digital Display Sign Coverage | Percent | |
| S10 | i) Length of street frontage - on which Sign is Located | 65 | Feet |
| | ii) Width of Sign Face | 8 | Feet |
| | iii) Height of Sign Face | 7 | Feet |
| | iv) Square Footage of Sign Face | 40 | Square Feet |
| | v) Height of Sign (overall) | 8 | Feet |
| | vi) Width of Sign (overall) | 6 | Feet |
| | vii) Type of Sign | Monument | |
| | viii) Type of Sign Base | stone | |
| | ix) Is there a Digital Display | no | |
| | | If Yes then, Location of Digital Display on the sign | |
| | | Height of Digital Display | Feet |
| | | Width of Digital Display | Feet |
| | | Square Footage of Digital Display | Square Feet |
| | Percent of Digital Display Sign Coverage | Percent | |
| S11 | i) Length of street frontage - on which Sign is Located | 65 | Feet |
| | ii) Width of Sign Face | 1 | Feet |
| | iii) Height of Sign Face | 2 | Feet |
| | iv) Square Footage of Sign Face | 2 | Square Feet |
| | v) Height of Sign (overall) | 7 | Feet |
| | vi) Width of Sign (overall) | - | Feet |
| | vii) Type of Sign | Parking - pole | |
| | viii) Type of Sign Base | Concrete foundation | |
| | ix) Is there a Digital Display | no | |
| | | If Yes then, Location of Digital Display on the sign | |
| | | Height of Digital Display | Feet |
| | | Width of Digital Display | Feet |
| | | Square Footage of Digital Display | Square Feet |
| | Percent of Digital Display Sign Coverage | Percent | |
| S12 | i) Length of street frontage - on which Sign is Located | 65 | Feet |
| | ii) Width of Sign Face | 1 | Feet |
| | iii) Height of Sign Face | 2 | Feet |
| | iv) Square Footage of Sign Face | 2 | Square Feet |
| | v) Height of Sign (overall) | 7 | Feet |
| | vi) Width of Sign (overall) | - | Feet |
| | vii) Type of Sign | Parking - pole | |
| | viii) Type of Sign Base | Concrete foundation | |
| | ix) Is there a Digital Display | no | |
| | | If Yes then, Location of Digital Display on the sign | |
| | | Height of Digital Display | Feet |
| | | Width of Digital Display | Feet |
| | | Square Footage of Digital Display | Square Feet |
| | Percent of Digital Display Sign Coverage | Percent | |

C81894



Code Summary

| SIGN | LOCATION | TYPE | HEIGHT | WIDTH | ALLOWED | PROPOSED | BALANCE |
|------|----------------------|--------------|------------|------------|---------|--------------|---------------|
| S1 | SHORT STOREFRONT | LETTERSET | 3'-11 3/8" | 13'-5 1/2" | 75 | 53.13 | 21.87 |
| S2 | LONG STOREFRONT | LOCK UP LOGO | 6'-0" | 6'-0" | 141 | 36 | 105 |
| S3 | DRIVE THRU ELEVATION | LOCK UP LOGO | 6'-0" | 6'-0" | 141 | 36 | 105 |
| S4 | DRIVE THRU ELEVATION | LETTERSET | 9'-10 3/8" | 2'-10" | 105 | 27.95 | 77.05 |
| S5 | REAR ELEVATION | LOCK UP LOGO | 6'-0" | 6'-0" | 75 | 36 | 39 |
| S10 | STREET | MONUMENT | 8'-0" | 5'-9" | 50 | 40.25 | 9.75 |
| | | | | | | TOTAL | 229.33 |

Code Allowance

Wall: NTE 10% of facade
F/S: 50sf - 8ft height

Elevation

Allowed

Long Storefront 65'-4" x 21'-8" x 10% = 141 sf

Short Storefront 38'-8" x 19'-5" x 10% = 75 sf

Elevation

Allowed

Drive Thru 65'-4" x 21'-8" x 10% = 105 sf

Rear 38'-8" x 19'-5" x 10% = 75 sf



| Revisions: | |
|------------|--|
| X | |
| X | |
| X | |
| X | |

| | |
|-----------------------------|-----------------------------|
| File Location: | STND |
| Drive/Clients/ | CSTM |
| <input type="checkbox"/> AS | <input type="checkbox"/> CR |
| <input type="checkbox"/> EN | |

Date: 3/18/2024

Designer: PV PM: SN

City/State: Aurora, IL

Address: 1390 Butterfield Road

Drawing # **C81894**

OE # **171210**

Site Plan

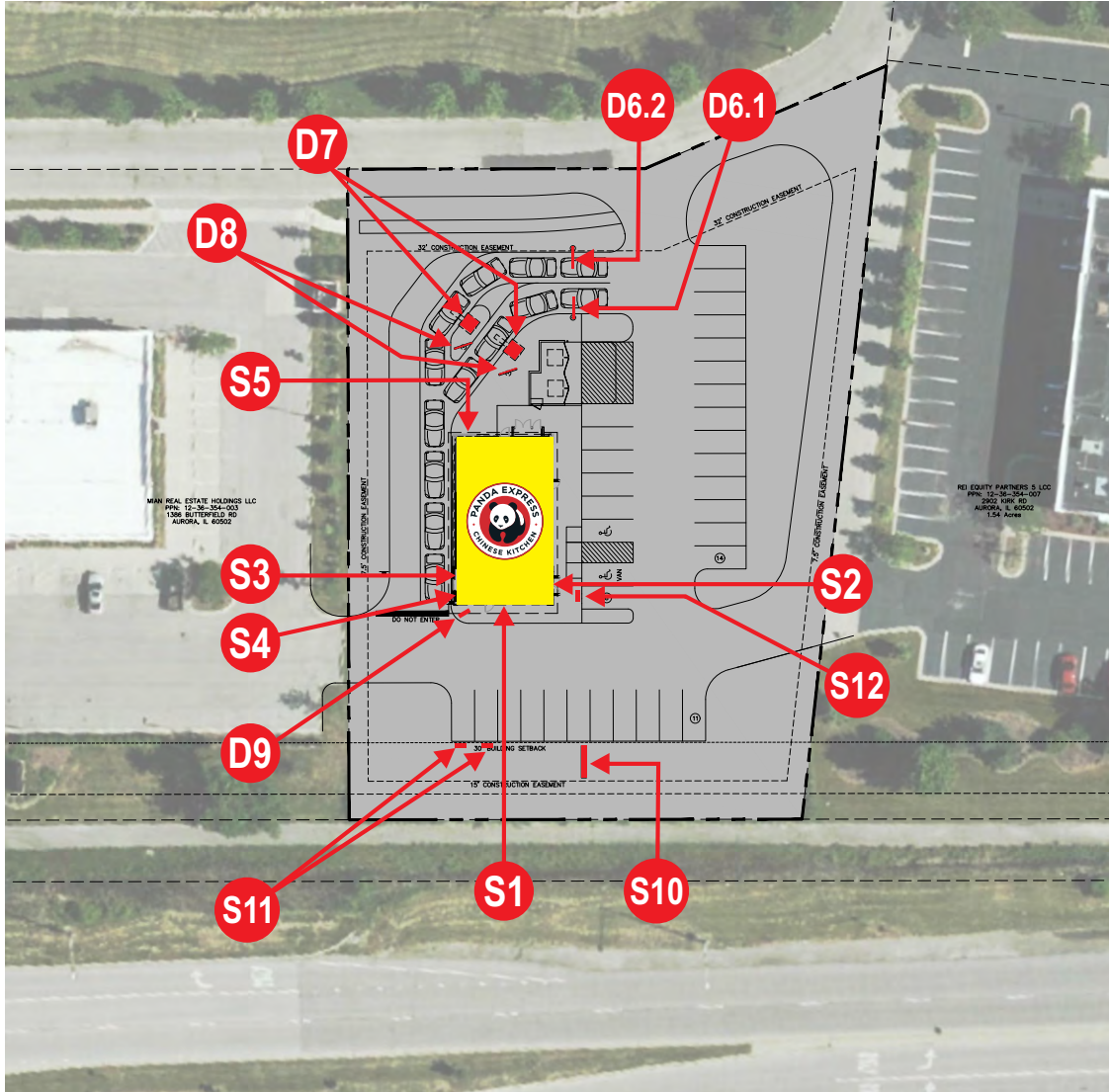

PANDA EXPRESS



S1 2'-6" stacked red letterset

S2

S3

S5 6' Lock Up Logo

S4 1'-6" Vertical Letterset

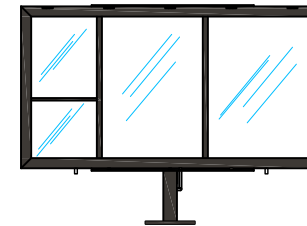

D8 Qty. 2



D7 Qty. 2



D9



S10



S11 Qty. 2



S12 Qty. 1

| Revisions: | | |
|------------|--|---|
| X | | X |
| X | | X |
| X | | X |
| X | | X |

| | | |
|-----------------------------|-----------------------------|-----------------------------|
| File Location: | STND | |
| Drive/Clients/ | CSTM | |
| <input type="checkbox"/> AS | <input type="checkbox"/> CR | <input type="checkbox"/> EN |

Date: 3/18/2024

City/State: Aurora, IL

Designer: PV PM: SN

Address: 1390 Butterfield Road

| | |
|-----------|---------------|
| Drawing # | C81894 |
| OE # | 171210 |

Elevations

Scale | 3/32" = 1'



Scale | 1/4" = 1'

| SIGN | LOCATION | TYPE | HEIGHT | WIDTH | ALLOWED | PROPOSED | BALANCE |
|------|------------------|-----------|------------|------------|---------|----------|---------|
| S1 | SHORT STOREFRONT | LETTERSET | 3'-11 3/8" | 13'-5 1/2" | 75 | 53.13 | 21.87 |



| Revisions: | |
|------------|---|
| X | X |
| X | X |
| X | X |
| X | X |

File Location: STND_X
 Drive/Clients/ CSTM
 AS CR EN

Date: 3/18/2024
 Designer: PV PM: SN

City/State: Aurora, IL
 Address: 1390 Butterfield Road

Drawing # **C81894**
 OE # **171210**

Elevations

Scale | 3/32" = 1'

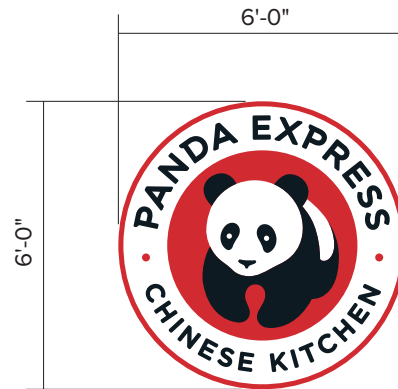

Scale | 1/4" = 1'

| SIGN | LOCATION | TYPE | HEIGHT | WIDTH | ALLOWED | PROPOSED | BALANCE |
|------|-----------------|--------------|--------|-------|---------|----------|---------|
| S2 | LONG STOREFRONT | LOCK UP LOGO | 6'-0" | 6'-0" | 141 | 36 | 105 |



| Revisions: | | |
|------------|--|---|
| X | | X |
| X | | X |
| X | | X |
| X | | X |

File Location: STND_X
 Drive/Clients/ CSTM
 AS CR EN

Date: 3/18/2024
 Designer: PV PM: SN

City/State: Aurora, IL
 Address: 1390 Butterfield Road

Drawing # **C81894**
 OE # **171210**

Elevations

Scale | 3/32" = 1'

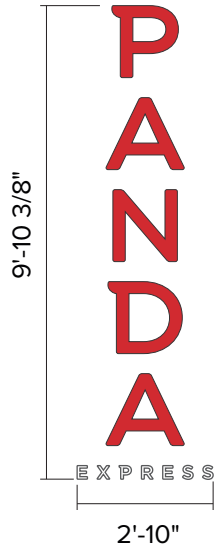
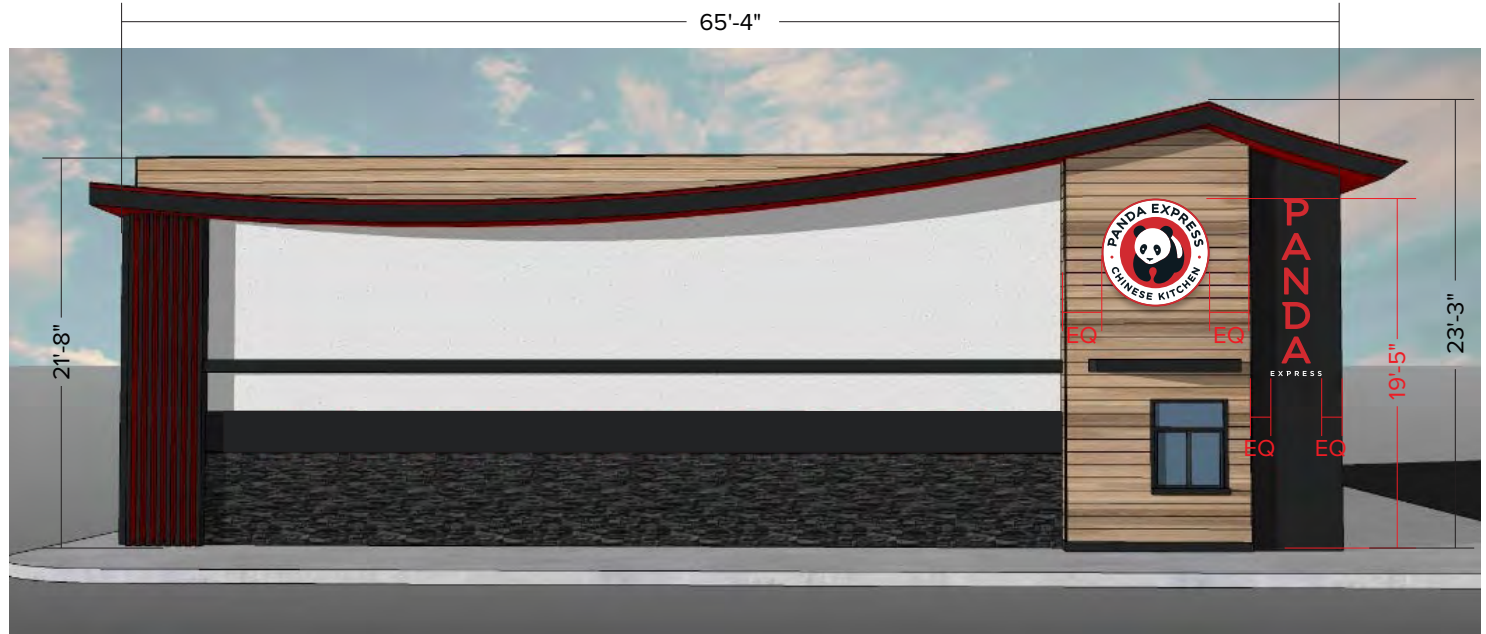

| SIGN | LOCATION | TYPE | HEIGHT | WIDTH | ALLOWED | PROPOSED | BALANCE |
|------|----------------------|--------------|------------|--------|---------|----------|---------|
| S3 | DRIVE THRU ELEVATION | LOCK UP LOGO | 6'-0" | 6'-0" | 141 | 36 | 105 |
| S4 | DRIVE THRU ELEVATION | LETTERSET | 9'-10 3/8" | 2'-10" | 105 | 27.95 | 77.05 |



| Revisions: | |
|------------|---|
| X | X |
| X | X |
| X | X |
| X | X |

| | |
|----------------|--------|
| File Location: | STND_X |
| Drive/Clients/ | CSTM |
| AS | CR |
| EN | |

| | |
|-----------|-----------|
| Date: | 3/18/2024 |
| Designer: | PV |
| PM: | SN |

| | |
|-------------|-----------------------|
| City/State: | Aurora, IL |
| Address: | 1390 Butterfield Road |

| | |
|-----------|--------|
| Drawing # | C81894 |
| OE # | 171210 |

Elevations

Scale | 3/32" = 1'

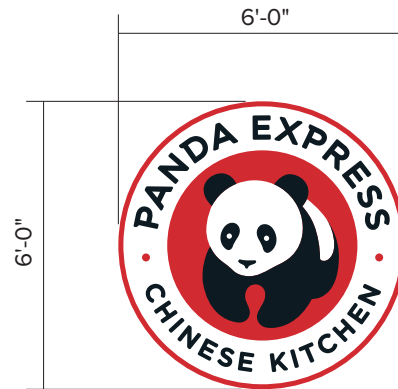

Scale | 1/4" = 1'

| SIGN | LOCATION | TYPE | HEIGHT | WIDTH | ALLOWED | PROPOSED | BALANCE |
|------|----------------|--------------|--------|-------|---------|----------|---------|
| S5 | REAR ELEVATION | LOCK UP LOGO | 6'-0" | 6'-0" | 75 | 36 | 39 |



| Revisions: | | |
|------------|--|---|
| X | | X |
| X | | X |
| X | | X |
| X | | X |

File Location: STND_X
 Drive/Clients/ CSTM

AS CR EN

Date: 3/18/2024
 Designer: PV PM: SN

City/State: Aurora, IL
 Address: 1390 Butterfield Road

Drawing # **C81894**
 OE # **171210**

S1

Red Face-Lit Letterset - Qty: 1

Install new face-lit illuminated letterset pin-mounted to wall with aluminum FCO tagline.

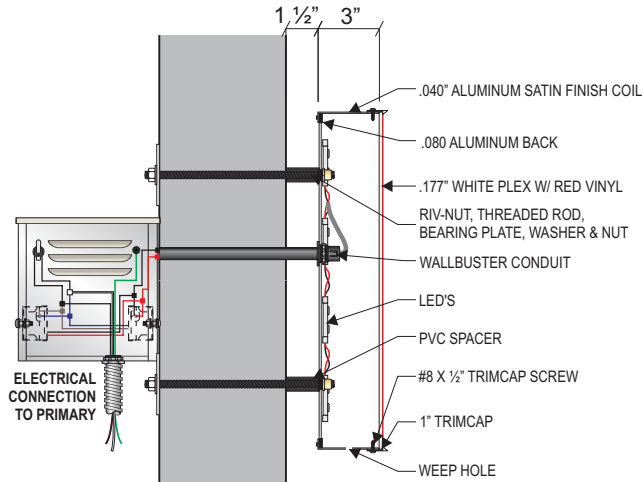

BS?J J&AF?LLCJ JCRCP

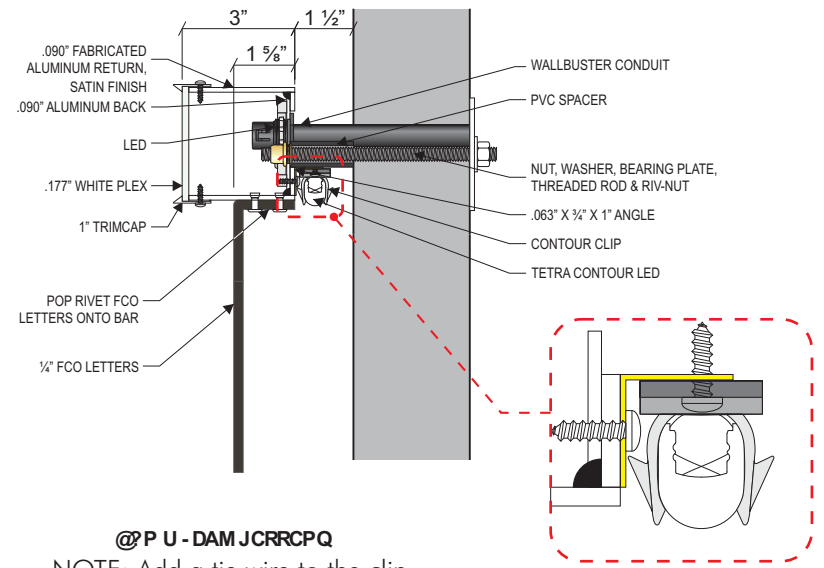

@P U - DAM JCRCPQ

NOTE: Add a tie wire to the clip that holds the LED strip in

TETRA CONTOUR LED ATTACHEMENT

GENERAL SPECIFICATIONS:

FACE-LIT LETTERS:

- FACES..... .177" WHITE #7328 PLEX W/ 1ST SURFACE 3M #3630-33 RED
- TRIMCAP.... 1" BLACK
- RETURNS.. .040" X 3" BLACK / WHITE COIL PAINTED TO MATCH BLACK 7C, SATIN FINISH

BACKS..... .080" ALUMINUM

BAR W/ FCO LETTERS:

- ┌ FACES.....177" WHITE #7328 PLEX
- └ TRIMCAP.....1" WHITE
- ▭ RETURNS.....125" X 3" FABRICATED WHITE COIL RETURN, SATIN FINISH
- BACKS......090" ALUMINUM, INTERIOR PAINTED WHITE

DOWNLIGHT....063" BRAKE FORMED ALUMINUM BOX BEHIND THE BAR WITH DOWNLIGHT LENS AND WHITE LED'S

EXPRESS.....25" FCO ALUMINUM LETTER PAINTED TO MATCH BLACK 7C SATIN FINISH



| | A | B | C | D | E | F | SF (F x B) |
|-----------|-------|------------|--------|-------------|----|------------|------------|
| PE-CL-30R | 2'-6" | 13'-5 1/2" | 9 1/8" | 7'-7 11/16" | 3" | 3'-11 3/8" | 53.13 |



| Revisions: | |
|------------|---|
| X | X |
| X | X |
| X | X |
| X | X |

| | |
|---|--|
| File Location: | STND_X |
| Drive/Clients/ | CSTM |
| ■ AS | △ CR |
| ⚙ EN | |

| | |
|-----------|-----------|
| Date: | 3/18/2024 |
| Designer: | PV |
| PM: | SN |

| | |
|-------------|-----------------------|
| City/State: | Aurora, IL |
| Address: | 1390 Butterfield Road |

| | |
|-----------|---------------|
| Drawing # | C81894 |
| OE # | 171210 |

S2, S3, S5

Face Illuminated Lockup Logo - Qty: 3

Install new face-lit lockup logo as shown.

GENERAL SPECIFICATIONS:

FACES:..... .177" WHITE POLYCARBONATE W/APPLIED VINYL GRAPHICS

RETAINER:.... 1" BLACK TRIMCAP / 1 1/2" ALUMINUM RETAINER (SEE DETAILS BELOW)

RETURNS:.. .040" X 3" BLACK / WHITE COIL PAINTED TO MATCH BLACK 7C SATIN FINISH



COLOR SPECIFICATIONS FOR FACE



(MANUFACTURING NOTE: ALL LOGO SIZES 3'-6" AND UNDER WILL HAVE A 3" RETURN DEPTH)

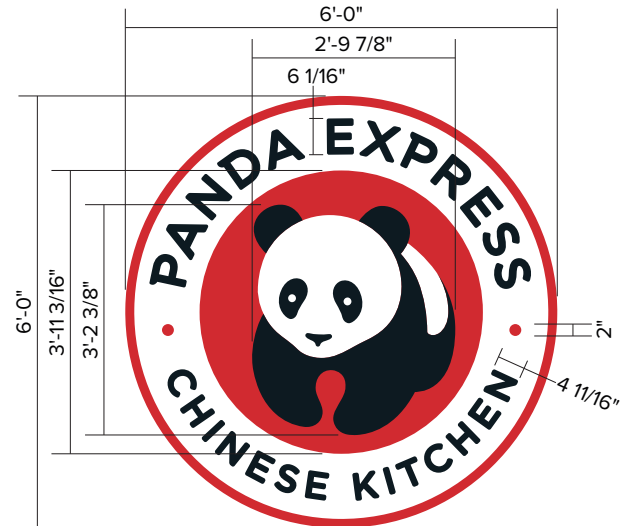
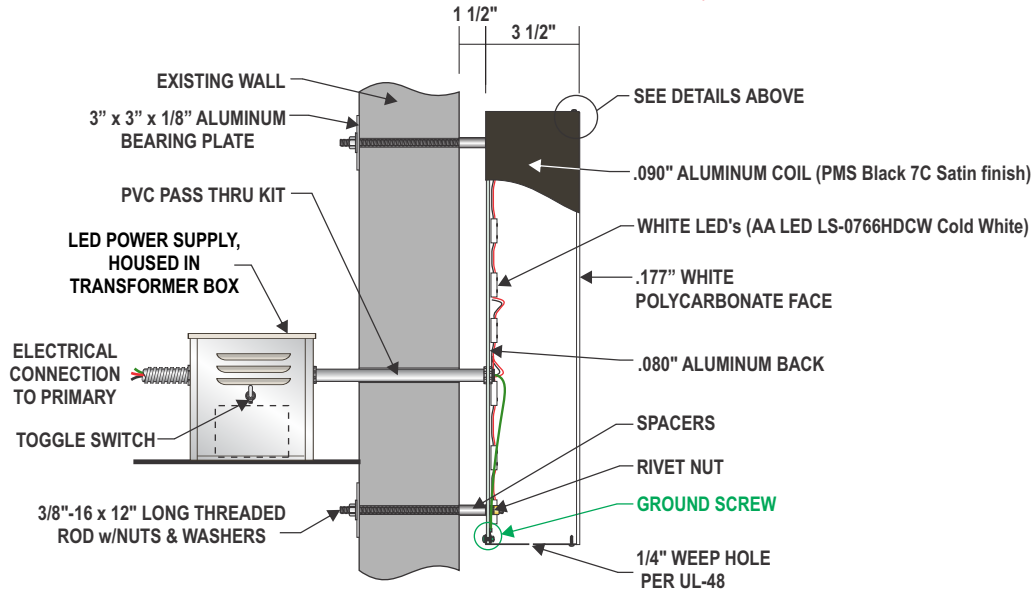

NC+DJ+50+DSJJ
QA?JCz 1-6 ; /
QO DR; 14U

*Logos over 6' to have 45° seam across 3M #3630-33 Red film



| Revisions: | | |
|------------|--|---|
| X | | X |
| X | | X |
| X | | X |
| X | | X |

| | |
|----------------|--------|
| File Location: | STND_X |
| Drive/Clients/ | CSTM |
| AS | CR |
| EN | |

| | |
|-----------|-----------|
| Date: | 3/18/2024 |
| Designer: | PV |
| PM: | SN |

| | |
|-------------|-----------------------|
| City/State: | Aurora, IL |
| Address: | 1390 Butterfield Road |

| | |
|-----------|--------|
| Drawing # | C81894 |
| OE # | 171210 |



S4

Vertical Face-Lit Letterset - Qty: 1

Install new face-lit illuminated letterset with aluminum FCO tagline.

GENERAL SPECIFICATIONS:

FACE-LIT LETTERS:

-  FACES..... .177" WHITE PLEX WITH 1ST SURFACE W/ 1ST SURFACE 3M #3630-33 RED
-  TRIMCAP.... 1" BLACK
-  RETURNS.. .040" X 3" BLACK / WHITE COIL PAINTED TO MATCH BLACK 7C, SATIN FINISH
- BACKS..... .080" ALUMINUM

FCO LETTERS:

EXPRESS.....1/4" THICK ALUMINUM PLATE LETTERS PAINTED N202SP WHITE, SATIN FINISH

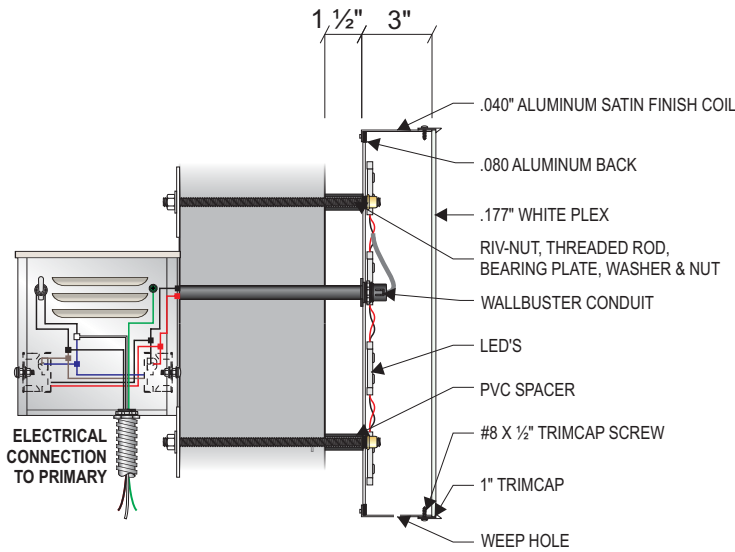

D? AC J@ AF ? LLCJ JCRRC P

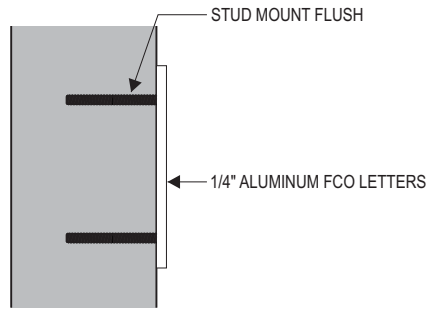

DAM á CVNPCQQi JCRRC P Q

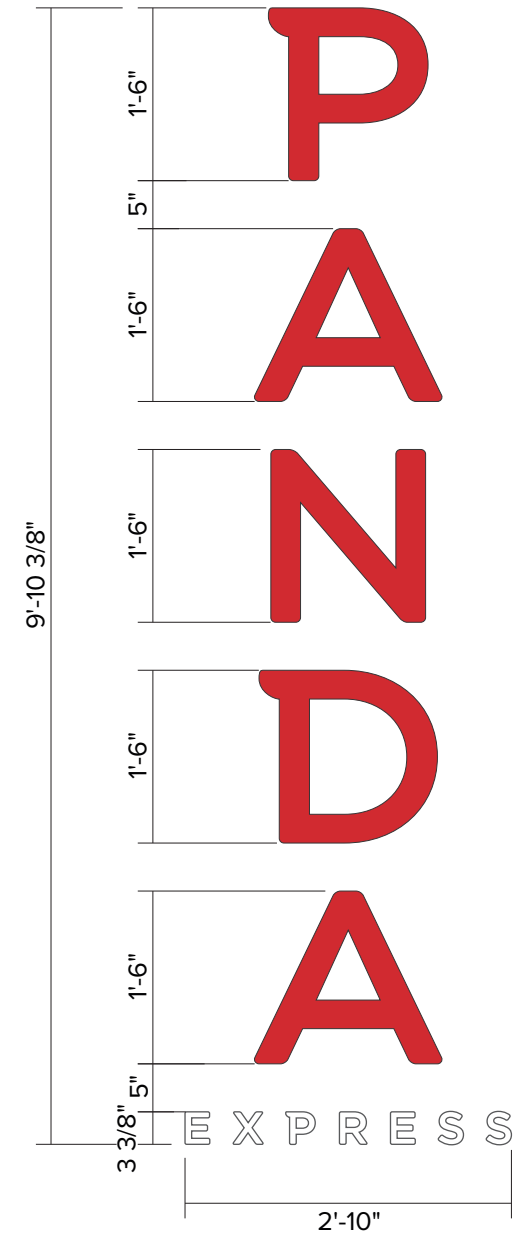

PE-FL-18-Vert
SCALE | 1:20
SQ FT | 27.95



| Revisions: | | |
|------------|--|---|
| X | | X |
| X | | X |
| X | | X |
| X | | X |

| | |
|--|--|
| File Location: | STND_X |
| Drive/Clients/ | CSTM |
|  AS |  CR |
|  EN | |

| | |
|-----------|-----------|
| Date: | 3/18/2024 |
| Designer: | PV |
| PM: | SN |

| | |
|-------------|-----------------------|
| City/State: | Aurora, IL |
| Address: | 1390 Butterfield Road |

| | |
|-----------|---------------|
| Drawing # | C81894 |
| OE # | 171210 |

D6.1

DT-L Clearance Bar - (Qty: 1)

Install new DT-L Clearance Bar sign. Refer to site plan for exact location.
NOTE: Wind Load: 115 mph wind speed / Snow Load: 60 PSF ground snow load.

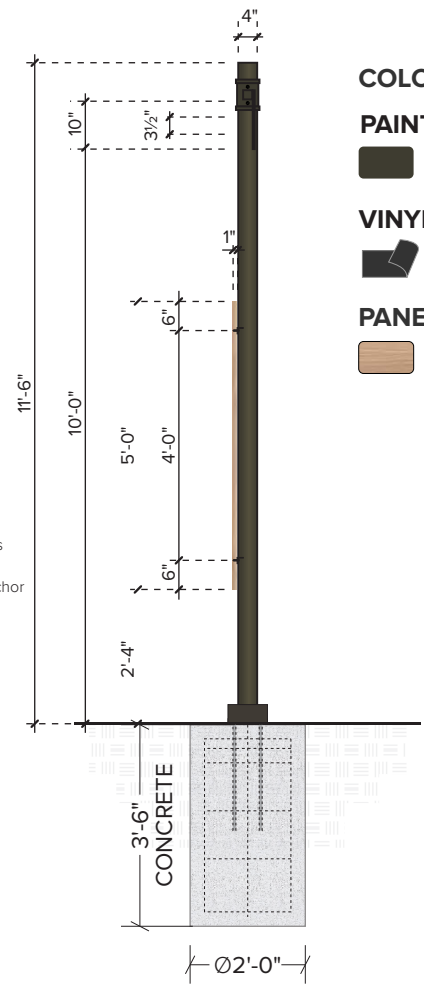
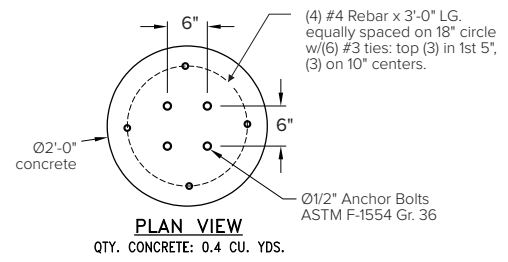
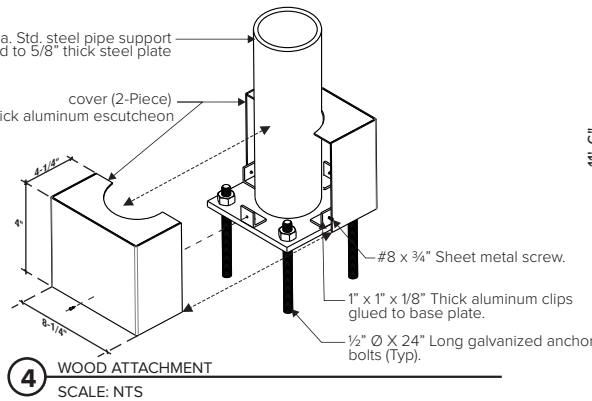
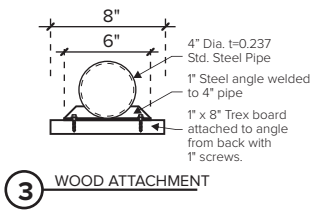
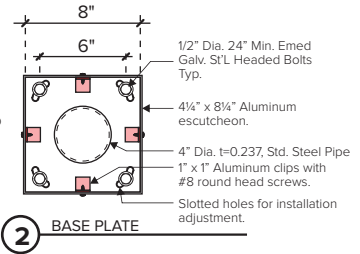
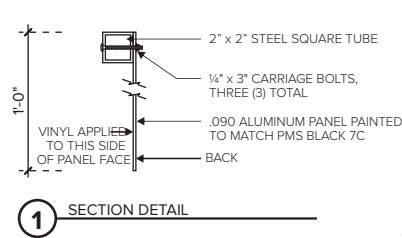
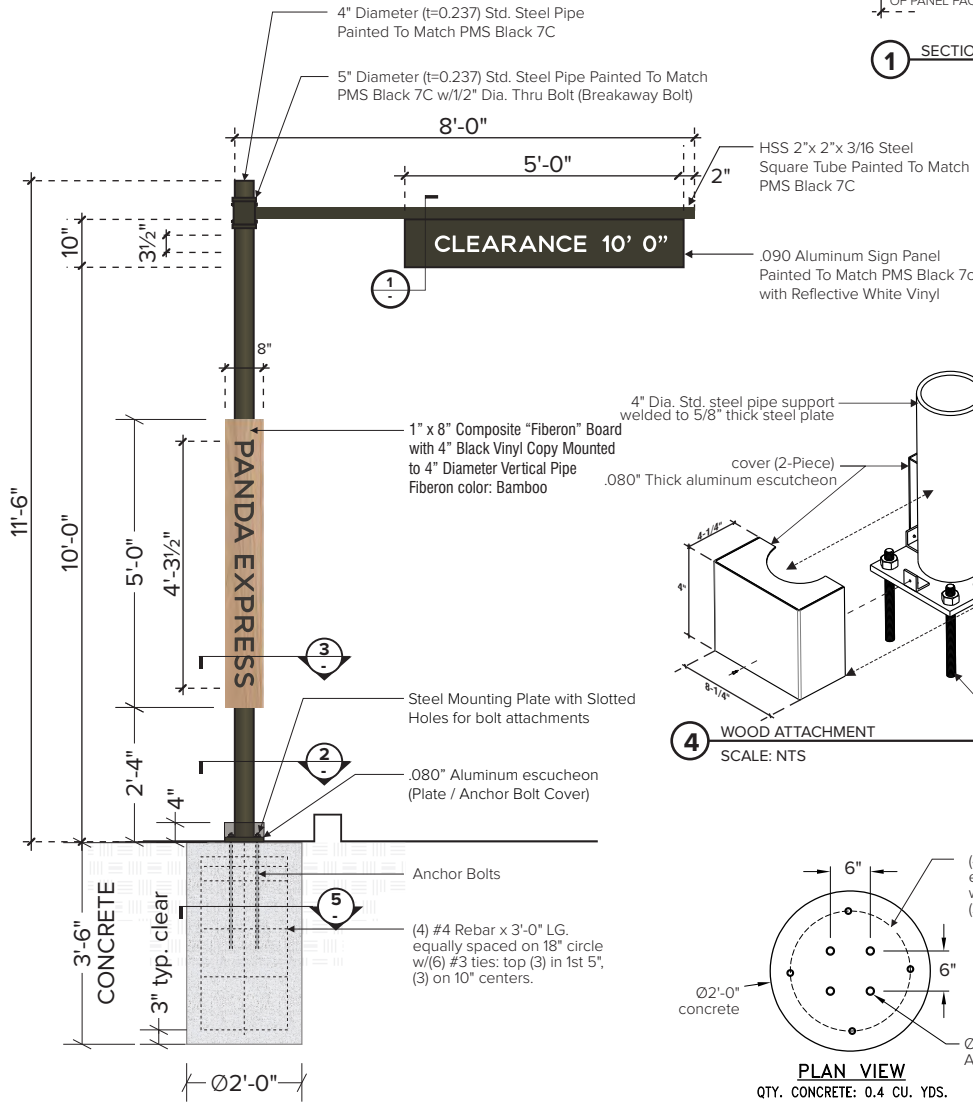

- COLOR SPECIFICATIONS**
- PAINT**
 PMS Black 7C
- VINYL**
 Reflective Black Film
- PANEL COLOR**
 Bamboo

J NON-ILLUMINATED CLEARANCE BAR
 QUANTITY: ONE (1) SET REQUIRED SCALE: 1:40

5 FOOTING DETAIL
 SCALE: NTS

SIDE VIEW - NON-ILLUMINATED CLEARANCE BAR
 SCALE: 1:40



| Revisions: | |
|------------|---|
| X | X |
| X | X |
| X | X |
| X | X |

| | |
|----------------|---------------|
| File Location: | STND <u>X</u> |
| Drive/Clients/ | CSTM |
| AS | CR |
| EN | |

Date: 3/18/2024
 Designer: PV PM: SN

City/State: Aurora, IL
 Address: 1390 Butterfield Road

| | |
|-----------|---------------|
| Drawing # | C81894 |
| OE # | 171210 |

D6.2

DT-R Clearance Bar - (Qty: 1)

Install new DT-R Clearance Bar sign. Refer to site plan for exact location.

NOTE: Wind Load: 115 mph wind speed / Snow Load: 60 PSF ground snow load.

COLOR SPECIFICATIONS

PAINT

 PMS Black 7C

VINYL

 Reflective Black Film

PANEL COLOR

 Bamboo

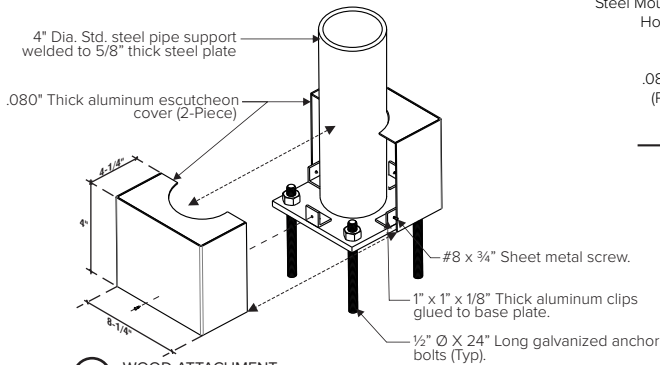

4 WOOD ATTACHMENT
SCALE: NTS

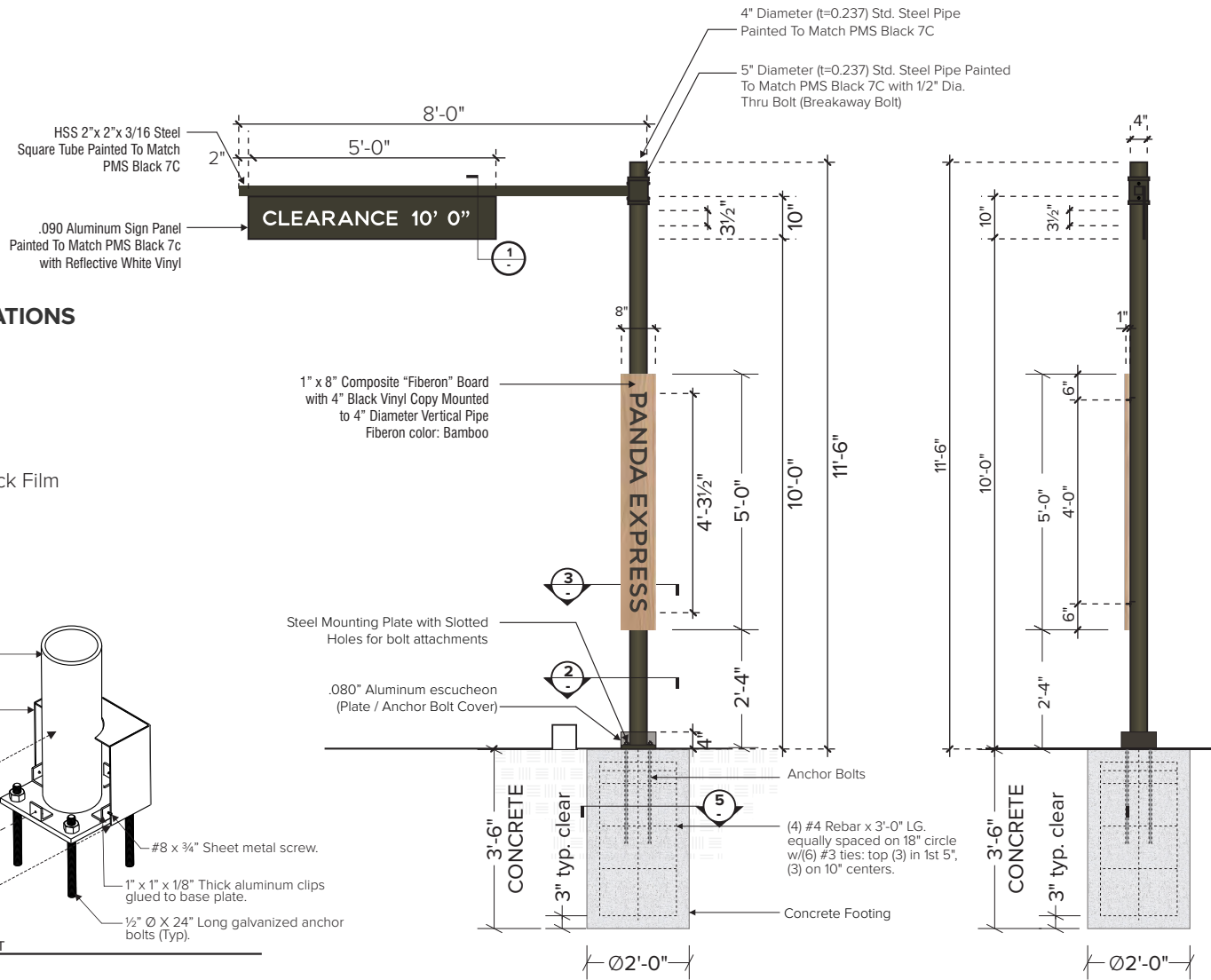

J NON-ILLUMINATED CLEARANCE BAR
QUANTITY: ONE (1) SET REQUIRED
SCALE: 1:40

SIDE VIEW - NON-ILLUMINATED CLEARANCE BAR
SCALE: 1:40



| Revisions: | | |
|------------|--|---|
| X | | X |
| X | | X |
| X | | X |
| X | | X |

| | |
|----------------|--------|
| File Location: | STND_X |
| Drive/Clients/ | CSTM |
| AS | CR |
| EN | |

Date: 3/18/2024

City/State: Aurora, IL

Designer: PV PM: SN

Address: 1390 Butterfield Road

Drawing # **C81894**

OE # **171210**

D7

DT COD Canopy - (Qty: 2)

Install new DT COD Canopy per site plan for exact location.

NOTE: Wind Load: 115 mph wind speed / Snow Load: 60 PSF Ground Snow Load

COLOR SPECIFICATIONS

- Composite "Fiberon" Board
- Clear Vinyl Digitally Printed (FAMILY SEAL)
- Opaque Black Vinyl (ORDER HERE TEXT ONLY)

CABINET CANOPY PAINT COLORS

- Aluminum painted to match MS Black 7C
- Aluminum painted to match Matthews Brushed Silver



Fiberon Panel
SCALE: 1" = 1'-0"

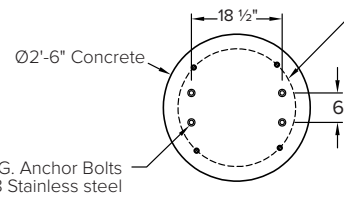

PLAN VIEW
QTY. CONCRETE: 1.0 CU. YDS.
FOOTING DETAIL
nts

(4) #4 Rebar x 5'-0" LG. equally spaced on 24" circle w/(7) #3 rebar ties: top (3) in 1st 5", (1) on 12" centers, remaining (3) on 14" centers.

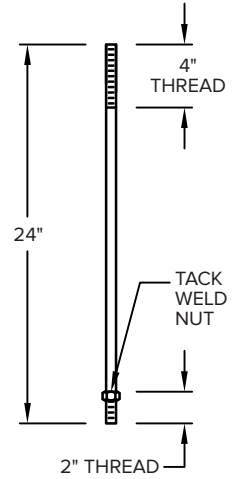

ANCHOR BOLT DETAIL
Ø5/8" 18-8 STAINLESS STEEL

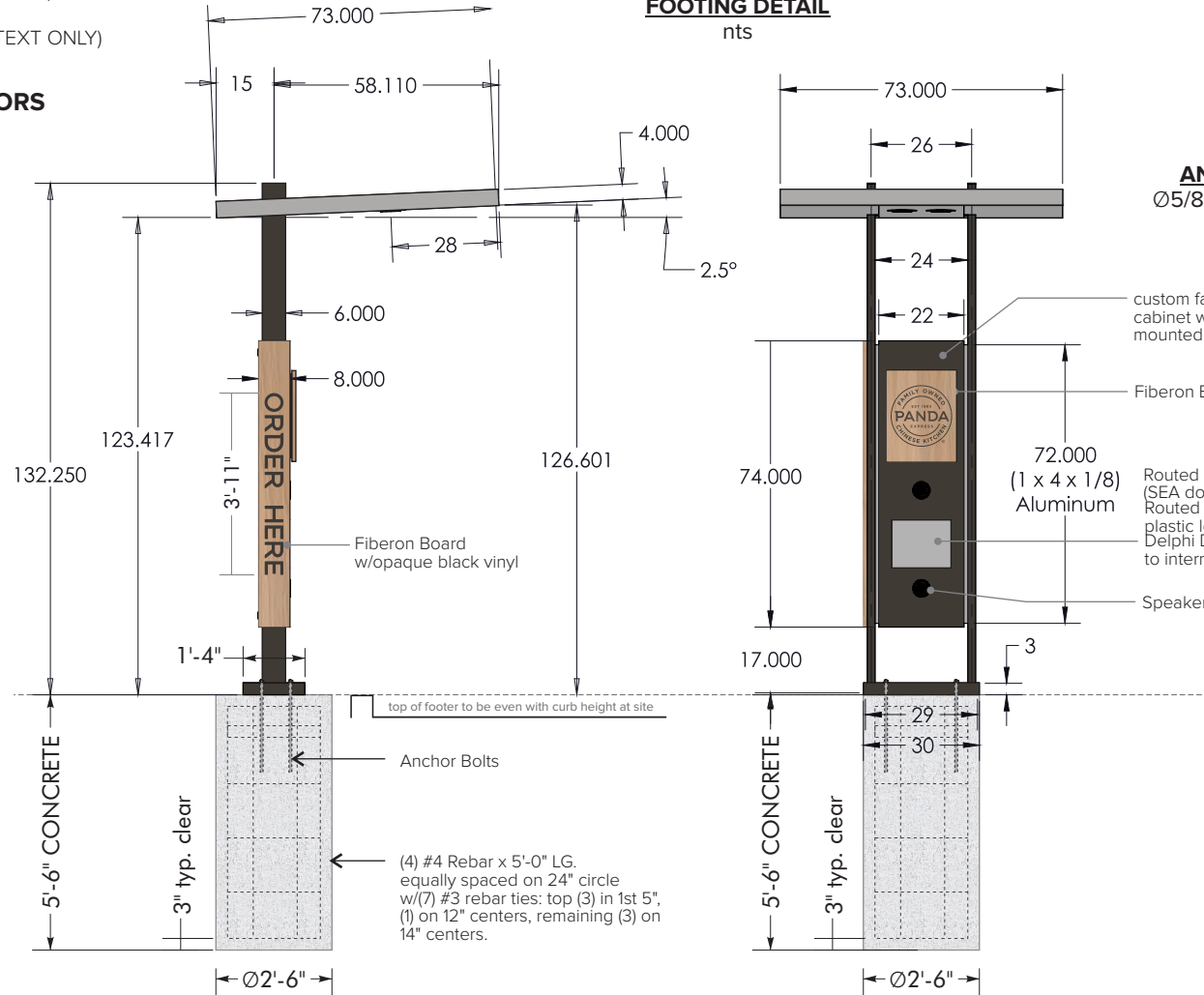

SCALE: 1/4" = 1'-0"

- custom fabricated aluminum cabinet with 1" reveal mounted between aluminum supports
- Fiberon Board w/digitally printed vinyl
- 72.000 (1 x 4 x 1/8) Aluminum
- Routed out face for camera (SEA does not provide camera)
- Routed out opening for 1/8" thick clear plastic lens
- Delphi Display Unit mounted internally to internal square tube frame
- Speaker x2



| Revisions: | | |
|------------|--|---|
| X | | X |
| X | | X |
| X | | X |
| X | | X |

| | |
|----------------|--------|
| File Location: | STND_X |
| Drive/Clients/ | CSTM |
| AS | CR |
| EN | |

| | |
|-----------|-----------|
| Date: | 3/18/2024 |
| Designer: | PV |
| PM: | SN |

| | |
|-------------|-----------------------|
| City/State: | Aurora, IL |
| Address: | 1390 Butterfield Road |

| | |
|-----------|--------|
| Drawing # | C81894 |
| OE # | 171210 |

D8

DT Menu Board - (Qty: 2)

Install new DT Menu Board. Refer to site plan for exact location.
NOTE: Wind Load: 115 mph wind speed

COLOR SPECIFICATIONS

MAIN CABINET

Painted to match PMS Black 7C

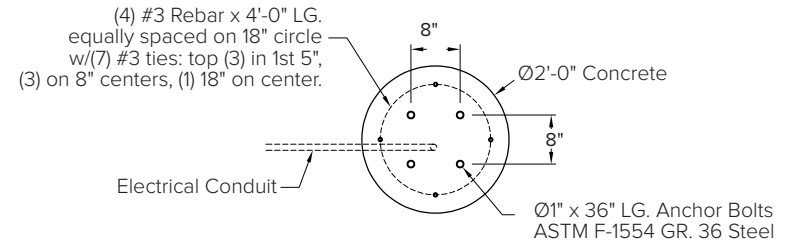
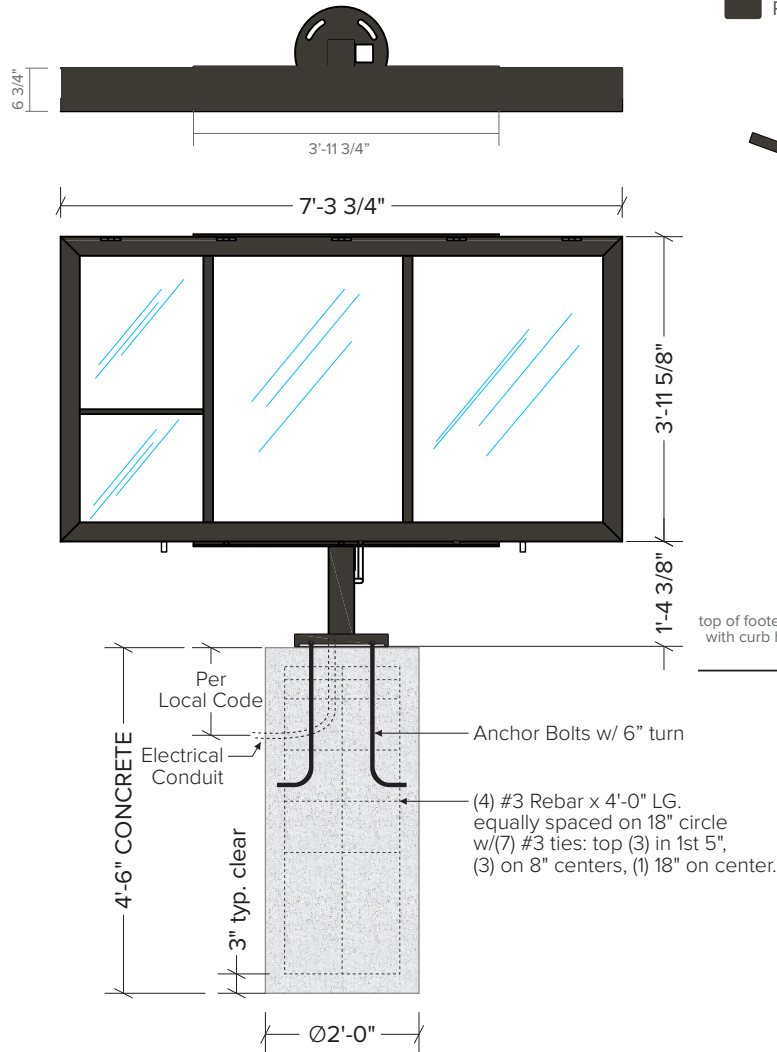

PLAN VIEW
 QTY. CONCRETE: 0.5 CU. YDS.
FOOTING DETAIL
 nts

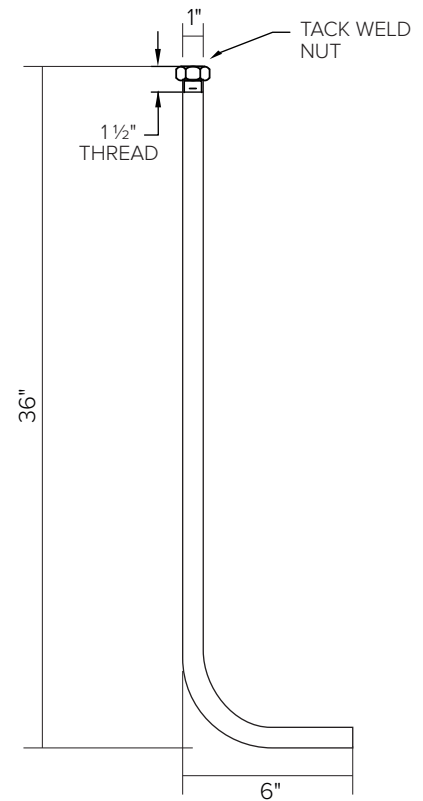
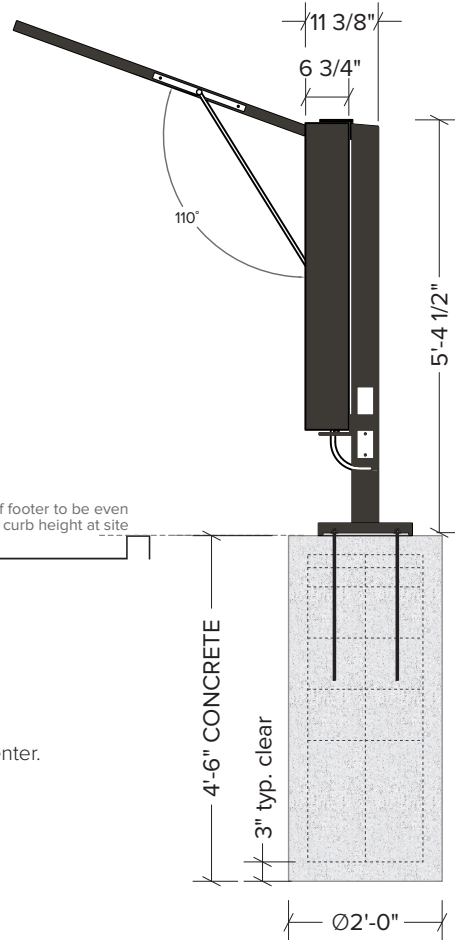

ANCHOR BOLT DETAIL (NTS)
 Ø1" ASTM F-1554 GR. 36 STEEL

SCALE | 1:30



| Revisions: | | |
|------------|--|---|
| X | | X |
| X | | X |
| X | | X |
| X | | X |

| | |
|----------------|---------------|
| File Location: | STND <u>X</u> |
| Drive/Clients/ | CSTM |
| AS | CR |
| EN | |

| | |
|-----------|-----------|
| Date: | 3/18/2024 |
| Designer: | PV |
| PM: | SN |

| | |
|-------------|-----------------------|
| City/State: | Aurora, IL |
| Address: | 1390 Butterfield Road |

| | |
|-----------|---------------|
| Drawing # | C81894 |
| OE # | 171210 |

D9

Non-Illuminated Directional - (Qty: 1)

Install new non-illuminated directional. Refer to site plan for exact location.

NOTE: Wind Load: 115 mph wind speed

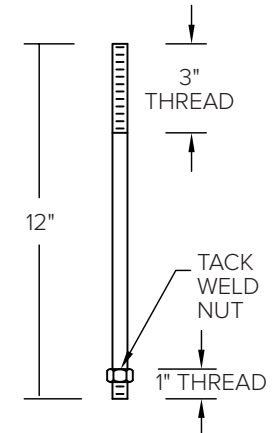
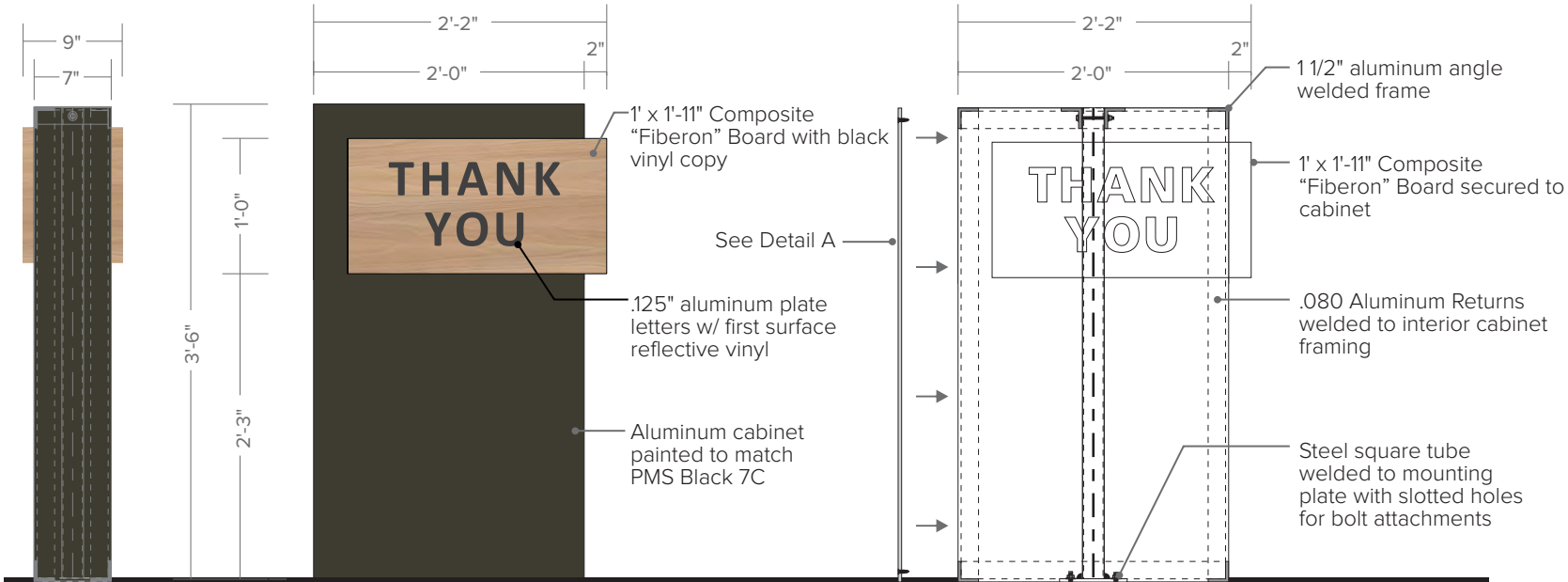
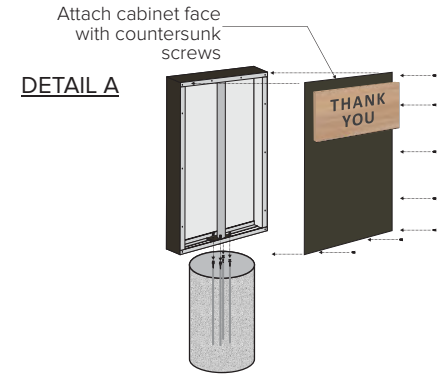

ANCHOR BOLT DETAIL
Ø3/8" 18-8 STAINLESS STEEL

Scale | 3/4" = 1'

BACK SIDE

COLOR SPECIFICATIONS

PAINT

■ PMS Black 7C

VINYL

■ Reflective Black Film

PANEL COLOR

■ Bamboo

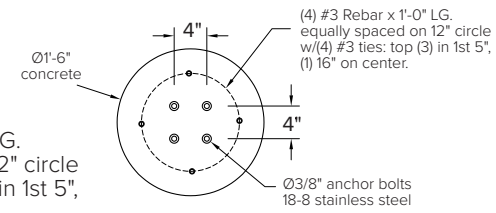
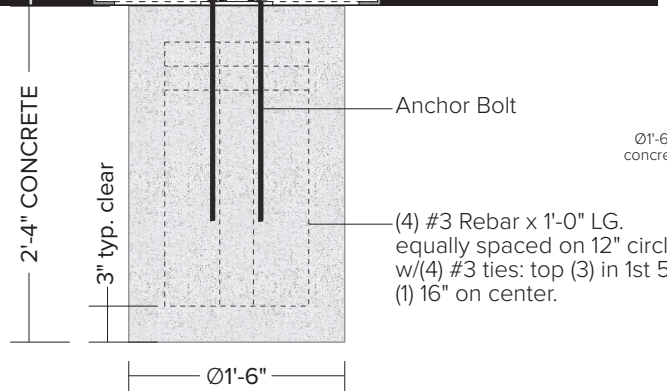

PLAN VIEW
QTY. CONCRETE: 0.2 CU. YDS.

FOOTING DETAILS
nts



| Revisions: | | |
|------------|--|---|
| X | | X |
| X | | X |
| X | | X |
| X | | X |

File Location: STND_X
Drive/Clients/ CSTM

AS CR EN

Date: 3/18/2024

Designer: PV PM: SN

City/State: Aurora, IL

Address: 1390 Butterfield Road

Drawing # **C81894**

OE # **171210**

S10

Custom D/F Illuminated Monument - (Qty: 1)

Install new internally illuminated double-faced monument sign. Refer to site plan for exact location. Custom size.

NOTE: Faux stone base to match building to be provided and installed by GC.

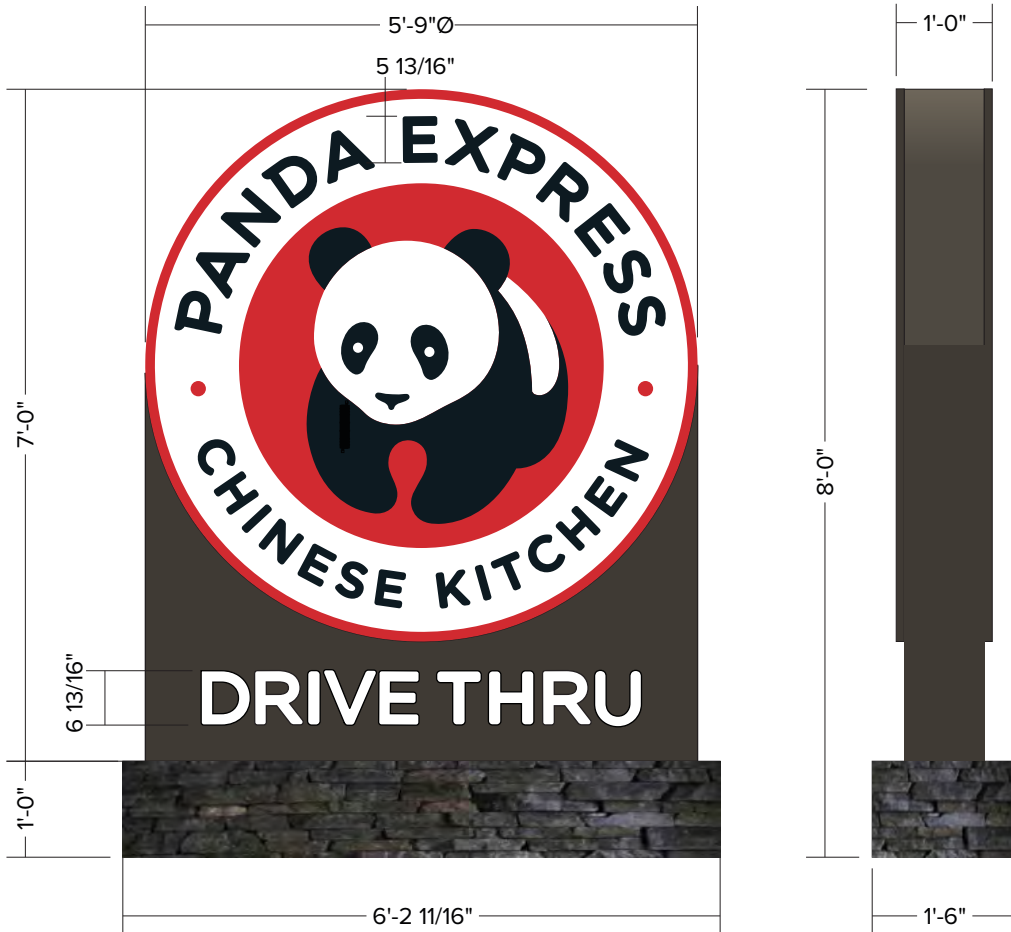

COLOR SPECIFICATIONS

TOP CLADDING

 .080" Aluminum sign cladding
Color: To match PMS Black 7C

RETAINER

 .080" Routed aluminum ring with .040" welded return
Color: To match PMS Black 7C on return edge only
To match PMS 711C on face

FACE

 .125" Routed aluminum cladding
Color: To match PMS Black 7C

BASE/SKIRT

 faux stone base to match building to be provided and installed by GC.

ILLUMINATED PANDA LOGO

 Bayer Makrolon .77" #7328 White LD Polycarbonate

 3M Scotchcal #3630-33 Red film

 3M #180C-22 Black film

"DRIVE THRU" COPY

 Bayer Makrolon .77" #7328 White LD Polycarbonate

40.25 sq
SCALE: 1/2" = 1'-0"



| Revisions: | | |
|------------|--|---|
| X | | X |
| X | | X |
| X | | X |
| X | | X |

| | |
|-----------------------------|--|
| File Location: | STND |
| Drive/Clients/ | CSTM |
| <input type="checkbox"/> AS | <input checked="" type="checkbox"/> CR |
| <input type="checkbox"/> EN | |

| | |
|-----------|-----------|
| Date: | 3/18/2024 |
| Designer: | PV |
| PM: | SN |

| | |
|-------------|-----------------------|
| City/State: | Aurora, IL |
| Address: | 1390 Butterfield Road |

| | |
|-----------|--------|
| Drawing # | C81894 |
| OE # | 171210 |

S11

Drive Thru Parking Panel | PE-Park-DT



Qty: 2 (panels), 2 (direct bury post)

Preparation: Remove any old signs or obstructions.

Manufacture: Manufacture a .125" aluminum panel painted Akzo-Nobel Black (satin finish). Apply the lockup logo as shown below. The lockup logo to be 3M 680-10 White Scotchlite Reflective White vinyl digitally printed to match Pantone 711 C Red and Pantone Black C.

Installation: Install the new panels to the direct bury post as shown below.

COLOR SPECIFICATIONS

-  3M #680-10 White Scotchlite reflective vinyl
-  Background painted to match Akzo-Nobel Black, satin finish
-  Digitally printed graphics on 3M #680-10 White Scotchlite reflective vinyl to match Pantone 711C Red and Pantone Black C



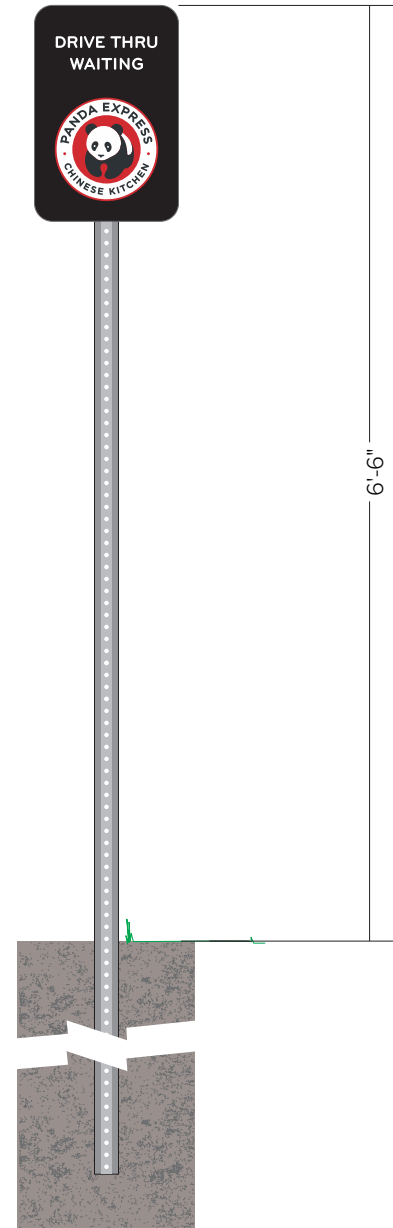

PE-Park-DT
Scale: 1:8



DTP-Post-DB
Scale: 1:16

| Revisions: | | |
|------------|--|---|
| X | | X |
| X | | X |
| X | | X |
| X | | X |

| | |
|--|--|
| File Location: | STND <u>X</u> |
| Drive/Clients/ | CSTM |
|  AS |  CR |
|  EN | |

| | |
|-----------|-----------|
| Date: | 3/18/2024 |
| Designer: | PV |
| PM: | SN |

| | |
|-------------|-----------------------|
| City/State: | Aurora, IL |
| Address: | 1390 Butterfield Road |

| | |
|-----------|---------------|
| Drawing # | C81894 |
| OE # | 171210 |

S12

Online Order Pickup Panel | PE-Park-OOP



Qty: 1 (panel), 1 (plate mounted post)

Preparation: Remove any old signs or obstructions.

Manufacture: Manufacture a .125" aluminum panel painted Akzo-Nobel Black (satin finish). Apply the lockup logo as shown below. The lockup logo to be 3M 680-10 White Scotchlite Reflective White vinyl digitally printed to match Pantone 711 C Red and Pantone Black C.

Installation: Install the new panels to the plate mounted post as shown below.

COLOR SPECIFICATIONS

-  3M #680-10 White Scotchlite reflective vinyl
-  Background painted to match Akzo-Nobel Black, satin finish
-  Digitally printed graphics on 3M #680-10 White Scotchlite reflective vinyl to match Pantone 711C Red and Pantone Black C



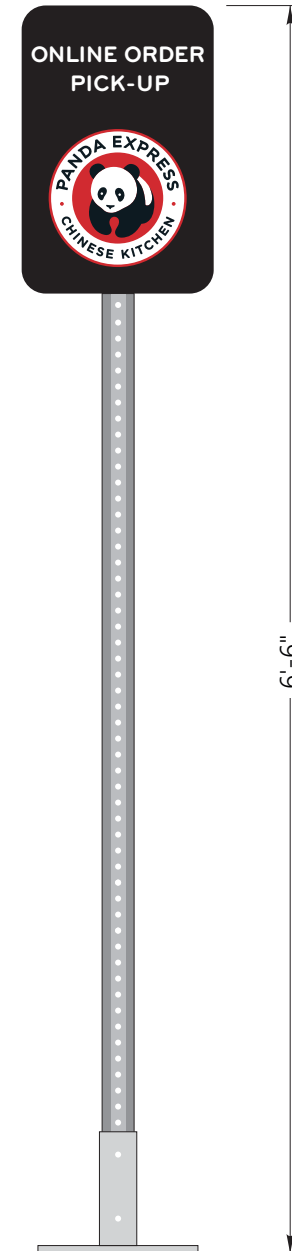

PE-Park-Online
Scale: 1:8

Plate Mounting:
For mounting to concrete or paved surfaces. Cut post down to 6'-6" and insert into surface mount base. Secure post to base with two 5/16 x 2 1/4" bolts and nuts. Install base in concrete using (4) 1/2" concrete anchors. Install base in asphalt using (4) 1/2" x 14" steel spikes.



DTP-Post-Plate
Scale: 1" = 1'-0"

| Revisions: | |
|------------|---|
| X | X |
| X | X |
| X | X |
| X | X |

| | | |
|---|--|--|
| File Location: | STND <input checked="" type="checkbox"/> Drive/Clients/ CSTM | |
|  AS |  CR |  EN |

| | |
|-----------|-----------|
| Date: | 3/18/2024 |
| Designer: | PV |
| PM: | SN |

| | |
|-------------|-----------------------|
| City/State: | Aurora, IL |
| Address: | 1390 Butterfield Road |

| | |
|-----------|---------------|
| Drawing # | C81894 |
| OE # | 171210 |

EQUIPMENT SCHEDULE

| PLUMBING | | | | ELECTRICAL | | | | DESCRIPTION | | | | | | | |
|--|-------|------------|-----------|---------------------------------|--------------------|------|------|---------------------------------|---|---------------------|----------------------|--|---|-------|----------|
| FS - INDIRECT CONNECTION TO FLOOR SINK | | | | D - DIRECT CONNECTION | | | | O - OWNER (PANDA EXPRESS, INC.) | | | | | | | |
| D - DIRECT CONNECTION | | | | C - CONVENIENT OUTLET | | | | S - SERVING AREA | | | | | | | |
| RH - ROUGH-IN HEIGHT (TO CENTER OF CONNECTION) | | | | FSD - FLOOR STUB OUT | | | | K - KITCHEN | | | | | | | |
| DC - DROPPED CORD | | | | EC - ELECTRICAL CONTRACTOR | | | | (E) - EXISTING | | | | | | | |
| | | | | KEC - KITCHEN EQUIPMENT COMPANY | | | | UC - UNDER COUNTER | | | | | | | |
| GAS | WASTE | COLD WATER | HOT WATER | CONNECTION | LOAD | PH | HP | VOLTS | REMARKS | DIMENSIONS | MANUFACTURER | MODEL NO | DESCRIPTION | NO. | SUPPLIER |
| KBTU | RH | SIZE | TYPE | SIZE | RH | SIZE | SIZE | WATT | W" x D" x H" (Ø x H) | | | | | | |
| | | | | 12" D | 475/64L 650/65R | | | 120 | 120 EA. PART OF SERVICE COUNTER TABLE ASSEMBLY & INCLUDES SS FRAME, GLASS, HARDWARE, LIGHTS & HEATERS | 44"X18"X17" | KEC | PER MFG | 44IN SNEEZE GUARD ASSEMBLY | 152B1 | 0 |
| | | | | 12" D | 475/64L 650/65R | | | 120 | 120 EA. PART OF SERVICE COUNTER TABLE ASSEMBLY & INCLUDES SS FRAME, GLASS, HARDWARE, LIGHTS & HEATERS | 59"X18"X17" | KEC | PER MFG | 59IN SNEEZE GUARD ASSEMBLY | 152B2 | 0 |
| | | | | 12" D | 475/64L 650/65R | | | 120 | BUILT-INTO SERVICE COUNTER TABLE ASSEMBLY, SEE ARCH. ELEV'S & DTLS | SEE PLAN | KEC | PER MFG | SS BUILT-IN RICE WARMER HOLDER FRONT POSITION | 153A | 0 |
| | | | | 12" D | 475/64L 650/65R | | | 120 | SERVICE COUNTER TABLE ASSEMBLY, SEE ARCH. ELEV'S & DTLS | SEE PLAN | KEC | PER MFG | SS 19 WELL SERVICE TABLE | 1F | 0 |
| | | | | | | | | | SEE ELEV. & DETAILS | 20"X15"X12" | KROWNE | D278 | DROP-IN ICE BIN SUBL | 105B | 0 |
| | | | | | | | | | 41" X 24 1/2" X 30" | | KEC | PER MFG | CASHER UIC CABINET DOUBLE POS | 202 | 0 |
| | | | | | | | | | 20.5"X17.25"X27.5" | CS-4E-16 | CRATINGCO | | BEVERAGE RUBBLER | 13A | 0 |
| | | | | | | | | | 20 1/2"X24 1/2"X30" | | KEC | PER MFG | SS CASHER UIC CABINET 1-POS | 244 | 0 |
| | | | | | | | | | 15 3/4" DIA | ABC-266-14 | NO CONTROLS CORP | | INDUCTION WELL WARMER 14IN | 3F | 0 |
| | | | | | | | | | 12 1/8" DIA | ABC-266-10 | NO CONTROLS CORP | | INDUCTION WELL WARMER 10IN | 3G | 0 |
| | | | | | | | | | 30"X30"X30" | IBC-255 | CORNELIUS | | BEVERAGE DISPENSER COUNTERTOP MOUNT | 4A | 0 |
| | | | | | | | | | 19"X17"X16" | 16-172 | WELBILT | | WATER BOOSTER | 4S3 | 0 |
| | | | | | | | | | 40"X18"X48" | 15-2803-P | WELBILT | | BEVERAGE BAG IN BOX PACK | 4S4 | 0 |
| | | | | | | | | | 22" DIA | ESPHR6AS | PER MFG | | CO2 TANK | 4D1 | 0 |
| | | | | | | | | | RAD-0102-6 | CO2METER.COM | | | CO2 MONITOR & DISPLAY | 4D51 | 0 |
| | | | | | | | | | 38"X21"X7" | KEC | PER MFG | SS ICE BIN COLD PAN & BOTTLE DISPLAY RACK | SC32 | 0 | |
| | | | | | | | | | 40 1/2"X31"X30" | KEC | PER MFG | SS ICE BIN COLD PAN UIC CABINET | SC | 0 | |
| | | | | | | | | | SEE PLAN | KEC | PER MFG | SS 10 WELL SERVICE TABLE DRIVE-THRU | 8H | 0 | |
| | | | | | | | | | 37"X27"X38" | KEC | PER MFG | SS HAND SINK CABINET & COUNTERTOP | 7G | 0 | |
| | | | | | | | | | SEE PLAN | KEC | PER MFG | SS PACKING STATION CABINET & COUNTERTOP OT | 8J | 0 | |
| | | | | | | | | | SEE PLAN | KEC | PER MFG | SS CASHER, BEV. CAB., HAND SINK, & COUNTERTOP OT | 9C | 0 | |
| | | | | | | | | | 12"X27"X4" | BUNN | T83 | | ICED TEA BREWER | 9D | 0 |
| | | | | | | | | | 22"X14"X26.5" | MANITOWOC | IBP9000-161 | 825 LB ICE MACHINE FOR BEVERAGE DISPENSER | 10K | 0 | |
| | | | | | | | | | 22"X14"X26.5" | MANITOWOC | CHD9000A-261 | REMOTE CONDENSER FOR BEVERAGE DISPENSER | 10K51 | 0 | |
| | | | | | | | | | 96"X42" | KEC | PER MFG | SS 90" CHINESE ENTRÉE WOK RANGE (L & R) | 20N | 0 | |
| | | | | | | | | | 42"X42" | KEC | PER MFG | SS 42" CHINESE CHA-FR WOK RANGE (L & R) | 20C | 0 | |
| | | | | | | | | | 42"X42" | KEC | PER MFG | SS 42" CHINESE CHA-FR AUTO WOK RANGE (L & R) | 20R | 0 | |
| | | | | | | | | | 40"X33 1/8"X47 3/4" | FRYMASTER | 218-HGF | 1814 HIGH-PRODUCTION 2-FRYER POT UNIT | 21F | 0 | |
| | | | | | | | | | 13 3/4"X29"X2" | KCC | TMC-T0208-MC01 | FRYER TIMER | 21S4 | 0 | |
| | | | | | | | | | 24"X31 1/2"X15 1/4" | VULCAN | MSA24-C2010P | 2" GAS GRIDDLE | 23E | 0 | |
| | | | | | | | | | 10"X42"X2" | VULCAN | VMCS-101 | ELECTRIC GRIDDLE TOP | 24R | 0 | |
| | | | | | | | | | 19.9"X27 1/4"X43.5" | WINSTON | HAM005 | RICE HOLDING ROLLING CABINET - HINGE RIGHT | 24R8 | 0 | |
| | | | | | | | | | 24"X19"X17" | PANTIN | GC-6700-N | RICE COOKER SS CUP GAS | 25A | 0 | |
| | | | | | | | | | 60"X33"X38" | RANDELL | 9205F-200-PE-N | 60" WORKTOP FREEZER NO SS BACK | 30K2N | 0 | |
| | | | | | | | | | SEE PLAN | IMPERIAL BROWN/RE | CUSTOM | WALK-IN-COOLER UNIT | 31 | 0 | |
| | | | | | | | | | SEE ELEVATIONS | IMPERIAL BROWN/RE | CUSTOM | GLASS DISPLAY DOORS WALK-IN-COOLER | 31S11 | 0 | |
| | | | | | | | | | SEE PLAN | IMPERIAL BROWN/RE | CUSTOM | WALK-IN-COOLER CONDENSER | 31S | 0 | |
| | | | | | | | | | SEE PLAN | IMPERIAL BROWN/RE | CUSTOM | WALK-IN-FREEZER UNIT | 32 | 0 | |
| | | | | | | | | | SEE PLAN | IMPERIAL BROWN/RE | CUSTOM | WALK-IN-FREEZER CONDENSER | 32S1 | 0 | |
| | | | | | | | | | SEE PLAN | IMPERIAL BROWN/RE | CUSTOM | WALK-IN-FREEZER DOOR HEATER | 32S7 | 0 | |
| | | | | | | | | | 48"X22 1/2"X35 1/4" TOP OF LID | RANDELL | PT48-18V-L-PE-N | 48" REFRIG PREP TABLE NO SS BACK | 34D2N | 0 | |
| | | | | | | | | | 54"X33"X38" / 48" TOP OF LID | RANDELL | PT54-36V-L-PEN-DL-N | 54" REFRIG PREP TABLE DRAWERS LEFT NO SS BACK | 34D2LN | 0 | |
| | | | | | | | | | 28"X33"X28" | ELECTROLUX | T2848 | THAWING CABINET | 40T | 0 | |
| | | | | | | | | | 100"X30" | KEC | PER MFG | SS POT SINK (3-COMP) | 40A | 0 | |
| | | | | | | | | | 42"X30" | KEC | PER MFG | SS PREP SINK (1-COMP R) | 41B | 0 | |
| | | | | | | | | | 42"X30" | KEC | PER MFG | SS PREP SINK (1-COMP L) | 41C | 0 | |
| | | | | | | | | | 80"X18" | KEC | PER MFG | SS 18" WALL SHELF DRIVE-THRU | 43B-60 | 0 | |
| | | | | | | | | | 96"X12" | WAREHOUSE | PER MFG | SS 12" SHLF WALL MOUNTED PREP-COMP | 43A-96 | 0 | |
| | | | | | | | | | 48"X18" | GOLD BOND | ISS | WIRE 18" SHLF WALL MOUNTED PREP-3000P | 44AS | 0 | |
| | | | | | | | | | VARIABLES 18"X14" | GOLD BOND | ISS | WIRE SHLF FLOOR MOUNTED - 18 DEEP | 44A | 0 | |
| | | | | | | | | | VARIABLES 24"X14" | GOLD BOND | ISS | WIRE SHLF FLOOR MOUNTED - 24 DEEP | 44C | 0 | |
| | | | | | | | | | 24"X18"X14" | GOLD BOND | ISS | SHORT WIRE SHLF FLOOR MOUNTED | 44AU | 0 | |
| | | | | | | | | | 14 1/4"X18 1/2" | GSW | HS-1818PASS | HAND SINK KNEE OPERATED | 45A | 0 | |
| | | | | | | | | | 24"X30"X28" & 18"X30"X46" CART | KEC | PER MFG | SS RICE COOKER STAND AND CART | 46A | 0 | |
| | | | | | | | | | 18"X29"X20 1/4" | KEC | PER MFG | SS FOOD TRAY CART | 46G | 0 | |
| | | | | | | | | | 24"X33"X28" | KEC | PER MFG | SS 24" GRIDDLE STAND WITH SHELF | 46H | 0 | |
| | | | | | | | | | 48"X28"X42" | KEC | PER MFG | SS MANAGER STATION | 46A | 0 | |
| | | | | | | | | | 17" DIA | WELBON | WRS-1088S | RICE WARMER | 54A | 0 | |
| | | | | | | | | | 11 1/2"X22 1/2"X15 1/2"X13 5/8" | SHARP | R-C21800W | MICROWAVE | 55A | 0 | |
| | | | | | | | | | 21"X24 1/4" | KEC | PER MFG | SS MICROWAVE SHELF | 55S2 | 0 | |
| | | | | | | | | | SEE PLAN | PER PLAN | | FIRE EXTINGUISHER | 56 | 0C | |
| | | | | | | | | | SEE DETAIL | SAN-JAMAR | SAJNT5007K | PAPER TOWEL DISPENSER | 60D | 0 | |
| | | | | | | | | | 12"X18"X7" | GSW | ELS-DR | LOCKER | 61B | 0 | |
| | | | | | | | | | 27"X22"X27 3/4" | TIDEL | CUSTOM | SMART SAFE | 62B | 0 | |
| | | | | | | | | | 32"X37"X8" | HOBART | PW150R | POT WARMER | 70D | 0 | |
| | | | | | | | | | 14"X14"X21" | HOBART | WS-40 | WATER SOFTENER | 70D1 | 0 | |
| | | | | | | | | | | DELL OPTIPLEX | XE2 | COMPUTER | 83A | 0 | |
| | | | | | | | | | | | | POS ORDER PRINTERS | 86A | 0 | |
| | | | | | | | | | | | | FAX | 87 | 0 | |
| | | | | | | | | | | | | CASH REGISTER SYSTEM | 94 | 0 | |
| | | | | | | | | | | | | HYPERACTIVE TIMER SYSTEM | 941A | 0 | |
| | | | | | | | | | 15"X13" | DELL 17" | | CONTACT PANDA IS TEAM | 942B | 0 | |
| | | | | | | | | | | | | LCD MONITOR MANAGER STATION | 94W | 0 | |
| | | | | | | | | | | | | LCD DRIVE-THRU MONITOR | 94W | 0 | |
| | | | | | | | | | | | | SECURITY VCR | 954S2 | 0 | |
| | | | | | | | | | | | | SECURITY MONITOR | 954S3 | 0 | |
| | | | | | | | | | | | | HME INTERCOM SYSTEM | 9611 | 0 | |
| | | | | | | | | | | | | MUSIC SYSTEM | 955 | 0 | |
| | | | | | | | | | 54"X24"X31", COUNTER @ 34" | KEC | PER MFG | SS EQ LOW WALL CAB. & COUNTERTOP | LWC36B | 0 | |
| | | | | | | | | | 54"X24"X31", COUNTER @ 34" | KEC | PER MFG | SS EQ LOW WALL PACKING-TEA CAB. & COUNTERTOP | LWC35L | 0 | |
| | | | | | | | | | 28 1/2"X28" | LSI | PER MFG | MENU PANEL BOARD | D2B | 0 | |
| | | | | | | | | | 16.2"X34.2"X16.55" | HAMPEL CORP | SK1712 | HOOD SOAK TANK ASSEMBLY | E5 | 0 | |
| | | | | | | | | | SEE PLAN | GC | QUARTZ | FRONT LINE COUNTERTOP | F1D | 0 | |
| | | | | | | | | | SEE PLAN | CAPTIVEARE | CUSTOM | EXHAUST HOOD | M1 | 0 | |
| | | | | | | | | | SEE PLAN | CAPTIVEARE | CUSTOM | HOOD CONTROL PANEL | M4 | 0 | |
| | | | | | | | | | SEE PLAN | CAPTIVEARE | CUSTOM | FIRE SUPPRESSION SYSTEM | M5 | 0 | |
| | | | | | | | | | | | | ANSUL PUSH BOX | M6 | 0C | |
| | | | | | | | | | 42"X10 5/8" | MARS | STD242-1U | AIR CURTAIN - DOOR | M8D | 0 | |
| | | | | | | | | | 25"X9"X10 3/8" | QUICK-SERV | QSK1025AA-BK | AIR CURTAIN - OT WINDOW | M8A | 0C | |
| | | | | | | | | | 24"X24"X13" | QUICK-SERV | SST-4800E | DRIVE-THRU WINDOW | M10 | 0C | |
| | | | | | | | | | 24"X24"X13" | GSW | SE242FM | SS MOP SINK | P1 | 0C | |
| | | | | | | | | | 39"X29 3/4"X13" | RINNAI | MTO-00247 | GAS TANKLESS WATER HEATER | P3 | 0C | |
| | | | | | | | | | 8"X2 3/8"X25 5/8" | 3M WATER FILTRATION | BEV190-56164-01 | WATER FILTER - BEVERAGE BAG IN BOX | P4 | 0 | |
| | | | | | | | | | 7 1/2"X8 3/4"X12" | EDCO | EDCO-4P1-SP-54, OR R | WATER FILTER - GAS TANKLESS WATER HEATER | P6 | 0 | |
| | | | | | | | | | 30"X20"X64" | DAR PRO | CLEANSTAR GRN 1500 | OIL CONTAINER GREASE TANK EXTERIOR | POT1 | 0 | |
| | | | | | | | | | 10 1/8"X11 1/8"X12" | KEC | PER MFG | SS SANITIZER BUCKET SHELF | SS11 | 0 | |
| | | | | | | | | | 16 1/2"X33 1/2"X28 1/4" | FARBO | FARBP434C | MULTIPLE INGREDIENT BINS | SN2 | 0 | |
| | | | | | | | | | 16.5"X18"X28 5/8"X28" | CAMBRO | CAMB-85S-27 | INGREDIENT BIN | SV11 | 0 | |
| | | | | | | | | | 88"X42" | GC | QUARTZ | BEVERAGE COUNTERTOP LEFT | BC04L | 0 | |

ELEVATIONS

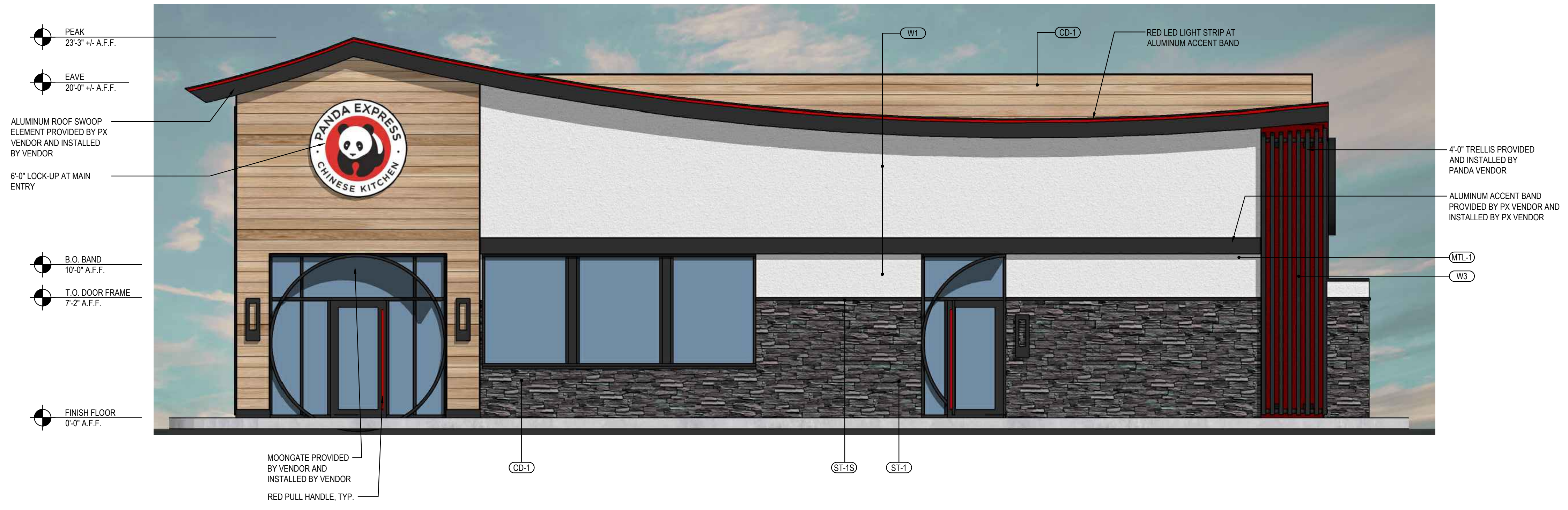

WEST ELEVATION 2
Scale= 1/4" = 1'-0" A-200

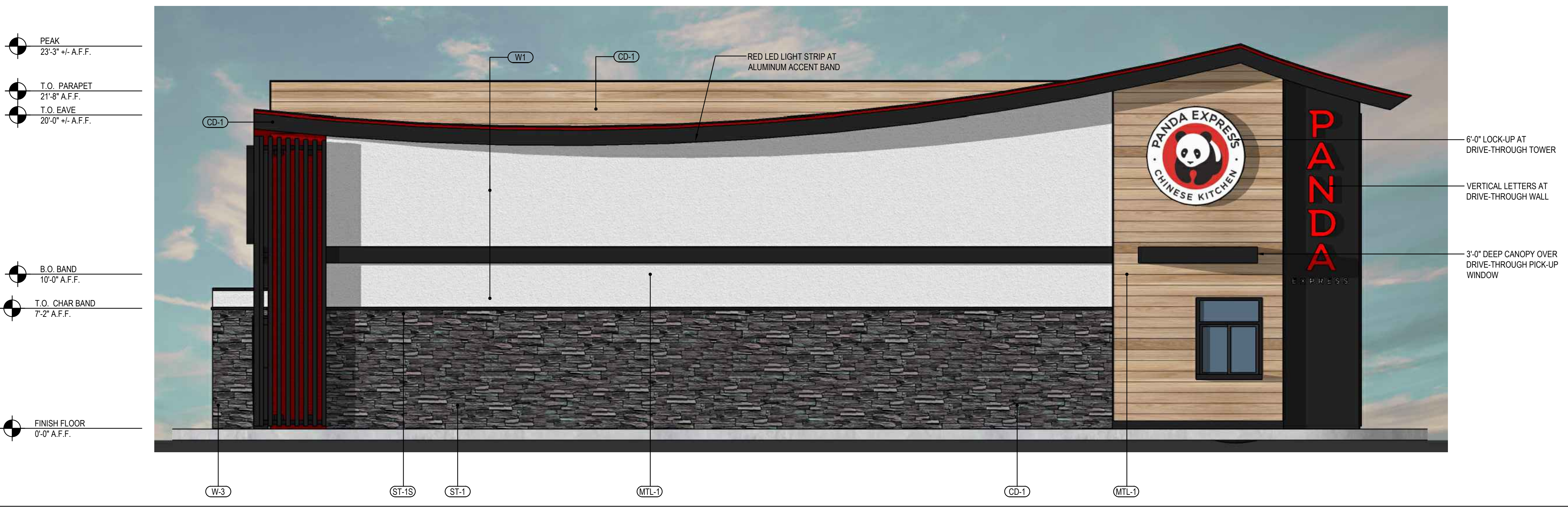

EAST ELEVATION 1
Scale= 1/4" = 1'-0" A-200

EXTERIOR FINISH SCHEDULE

| NO. | MANUFACTURER | MFG# | COLOR | FINISH | NOTES |
|---------|-------------------------|-----------------------|-----------------------------------|--------------|---|
| (W-1) | STO | POWERWALK DRAINSCREEN | SW 7646 FIRST STAR | FINE | BUILDING BODY |
| (W-2) | STO | POWERWALK DRAINSCREEN | SW 7069 IRON ORE | FINE | ACCENT BAND |
| (W-3) | STO | POWERWALK DRAINSCREEN | PANTONE COLOR P200C - RED | - | BEHIND TRELLIS |
| (ST-1S) | CORONADO STONE PRODUCTS | CHISELED STONE SILL | CHARCOAL | - | STONE CAP (3/8" VERTICAL JOINT - MORTAR TO MATCH STONE CAP) |
| (ST-1) | CORONADO STONE PRODUCTS | STRIP STONE | BLACK FOREST | - | WAINSCOT CONTACT: 864-962-1221 PROVIDE 3/8" MORTAR JOINTS. MFG.: ARGOS, COLOR: CHARCOAL |
| (CD-1) | FIBERON | WILDWOOD | BAMBOO | - | COMPOSITE CLADDING - CONTACT: MARIA SCHOLLER 419-704-5924 EMAIL: MARIA.SCHOLLER@FIBERONCLADDING.COM |
| (MTL-2) | PANDA VENDOR | ALLEN INDUSTRIES | PMS BLACK- 7C | SATIN FINISH | CANOPY W/ LED W/ DOWN LIGHT AROUND BUILDING |
| (CD-1) | EXCEPTIONAL METALS | - | "PANDA EXPRESS SW7069 - IRON ORE" | - | CAP FLASHING |

EXTERIOR MATERIAL IMAGES

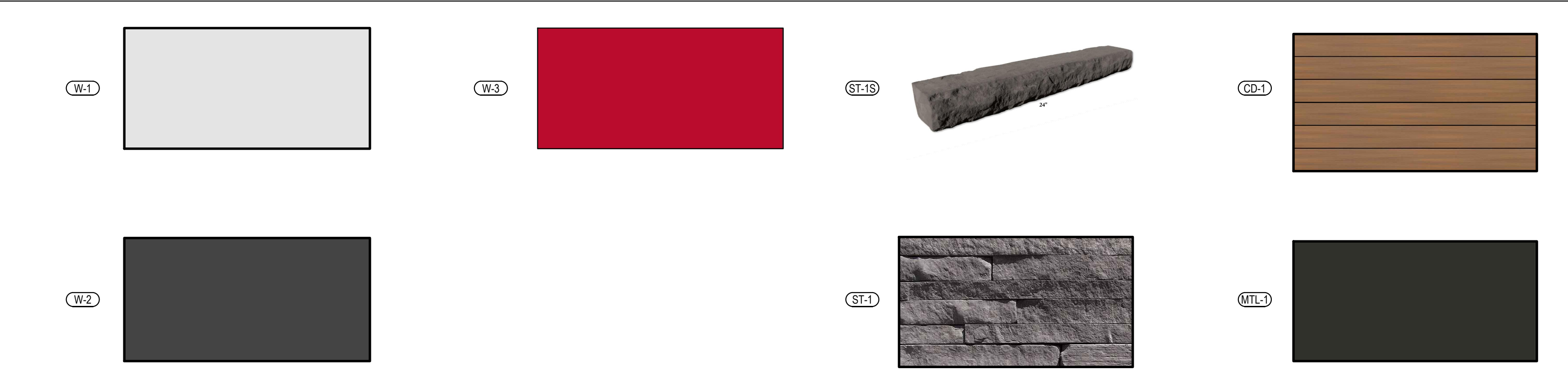

INSTALLED AND FURNISHED BY G.C. UNLESS NOTED OTHERWISE.



PANDA EXPRESS, INC.
1683 Walnut Grove Ave.
Rosemead, California 91770
Telephone: 626.799.9898
Facsimile: 626.372.6288

All ideas, designs, arrangement and plans indicated or represented by this drawing are the property of Panda Express Inc. and were created for use on this specific project. None of these ideas, designs, arrangements or plans may be used by or disclosed to any person, firm, or corporation without the written permission of Panda Express Inc.

REVISIONS:

| NO. | DESCRIPTION |
|-----|-------------|
| | |
| | |
| | |
| | |
| | |
| | |
| | |
| | |
| | |
| | |

ISSUE DATE:

| NO. | DESCRIPTION | DATE |
|-----|-------------|------|
| | | |
| | | |
| | | |
| | | |
| | | |
| | | |
| | | |
| | | |
| | | |
| | | |

DRAWN BY: LC & LS

PANDA PROJECT #: D33024
PANDA STORE #: S8-25-D33024
ARCH PROJECT #: 24038

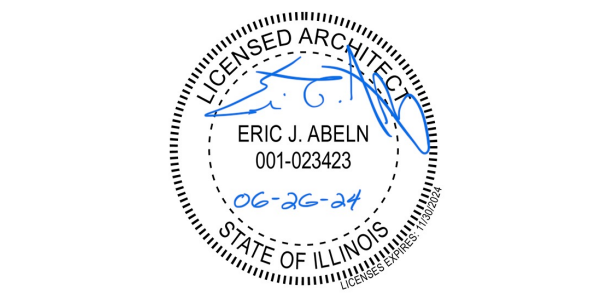

Heights Venture
ARCHITECTURE • DESIGN

HOUSTON
1111 North Loop West, Suite 800
Houston, Texas 77008
281.854.6100

DALLAS
5741 Legacy Drive, Suite 320
Plano, Texas 75024
281.854.6100

CHICAGO
3333 Warrenville Road, Suite 200
Lisle, Illinois 60532
281.854.6100

PANDA EXPRESS
PANDA HOME 2700 R2
1390 BUTTERFIELD RD
AURORA, IL 60502

A-200

COLORED ELEVATIONS

PANDA HOME 2700 R2

NOTE: GC TO COORDINATE PLACEMENT
ONSITE WITH PANDA PROJECT MANAGER.

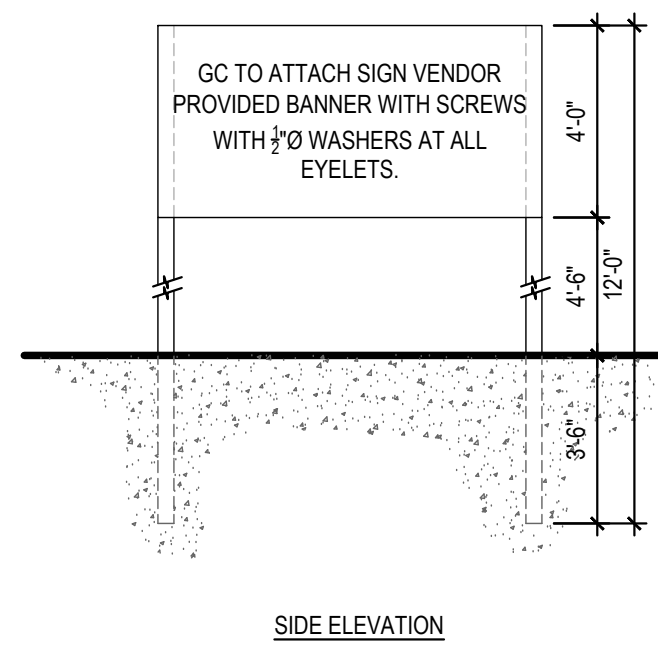
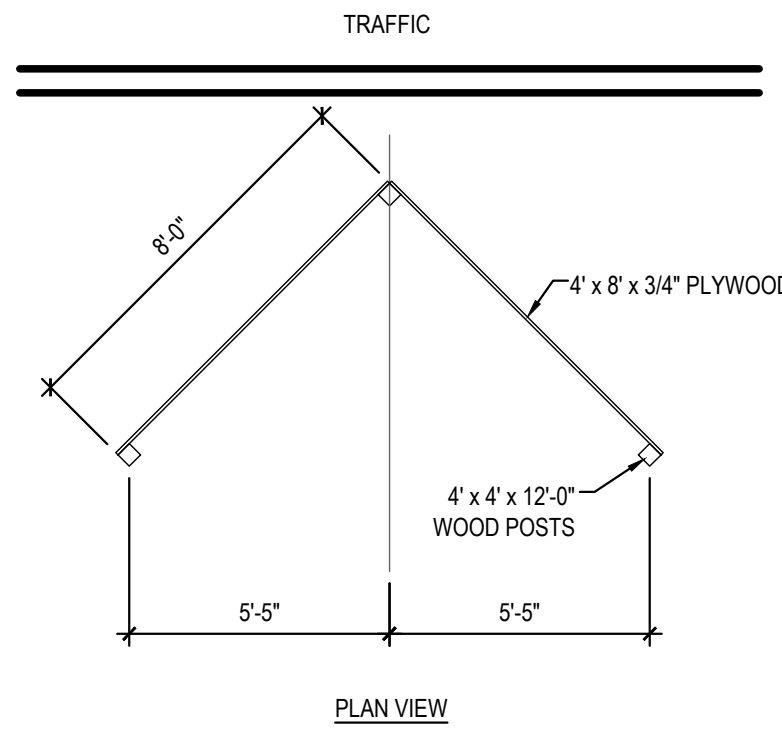

"COMING SOON" SIGN DETAIL 16

Scale= 1/4" = 1'-0" A-407

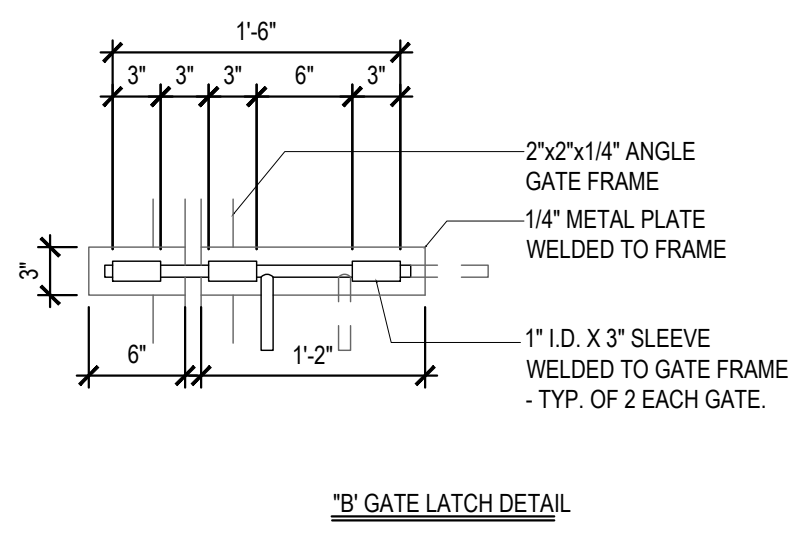
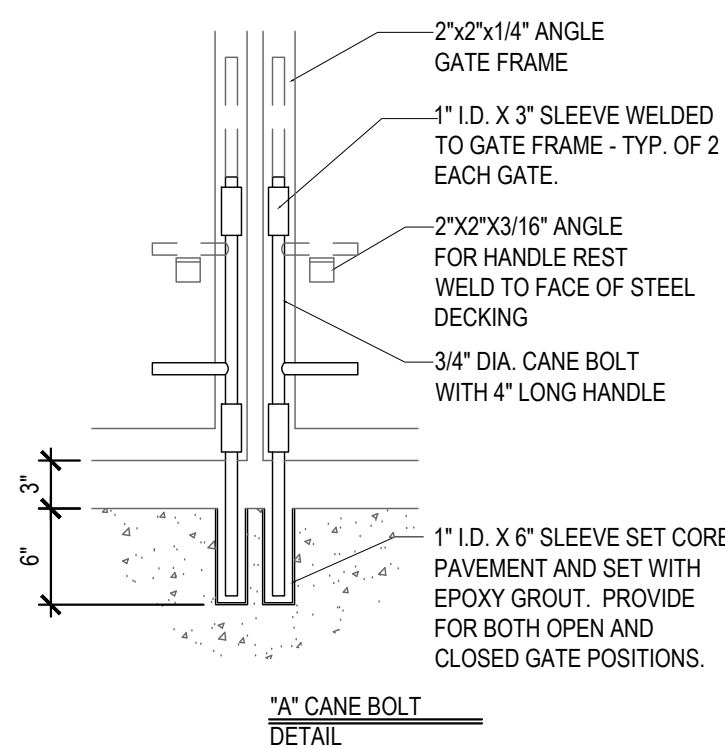

DUMPSTER GATE LATCH DETAILS 15

Scale= NTS A-407

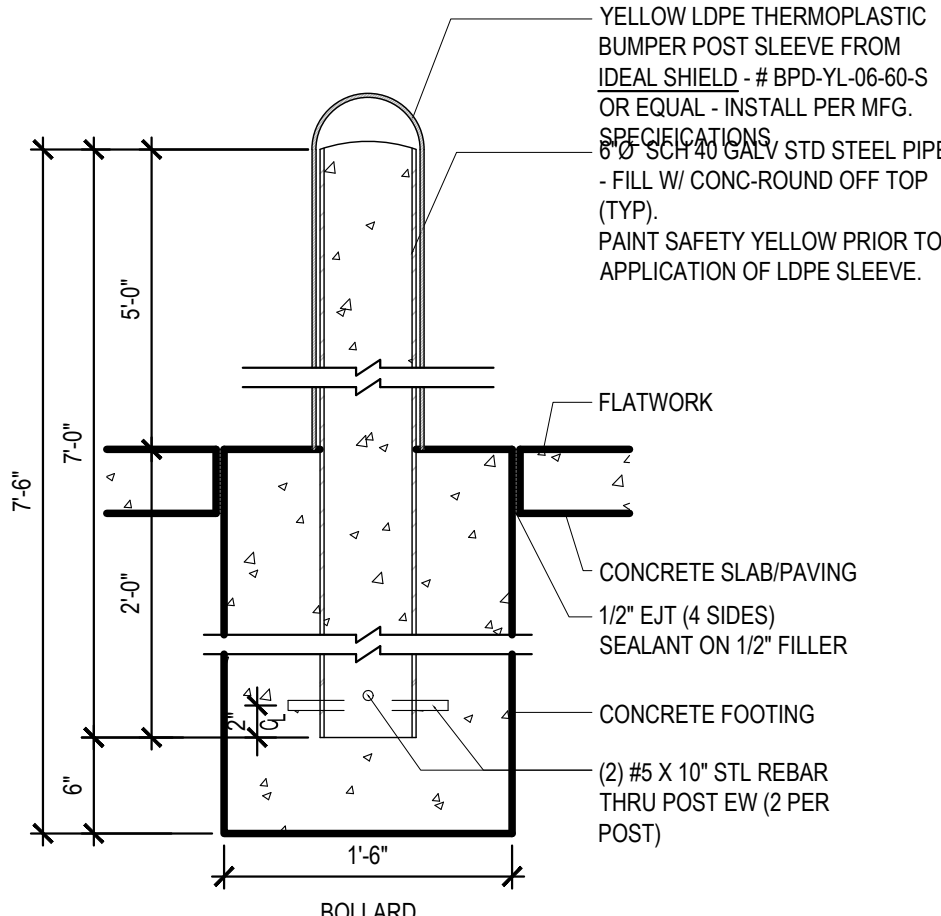

BOLLARD / POST BASE 18

Scale= 1" = 1'-0" A-407

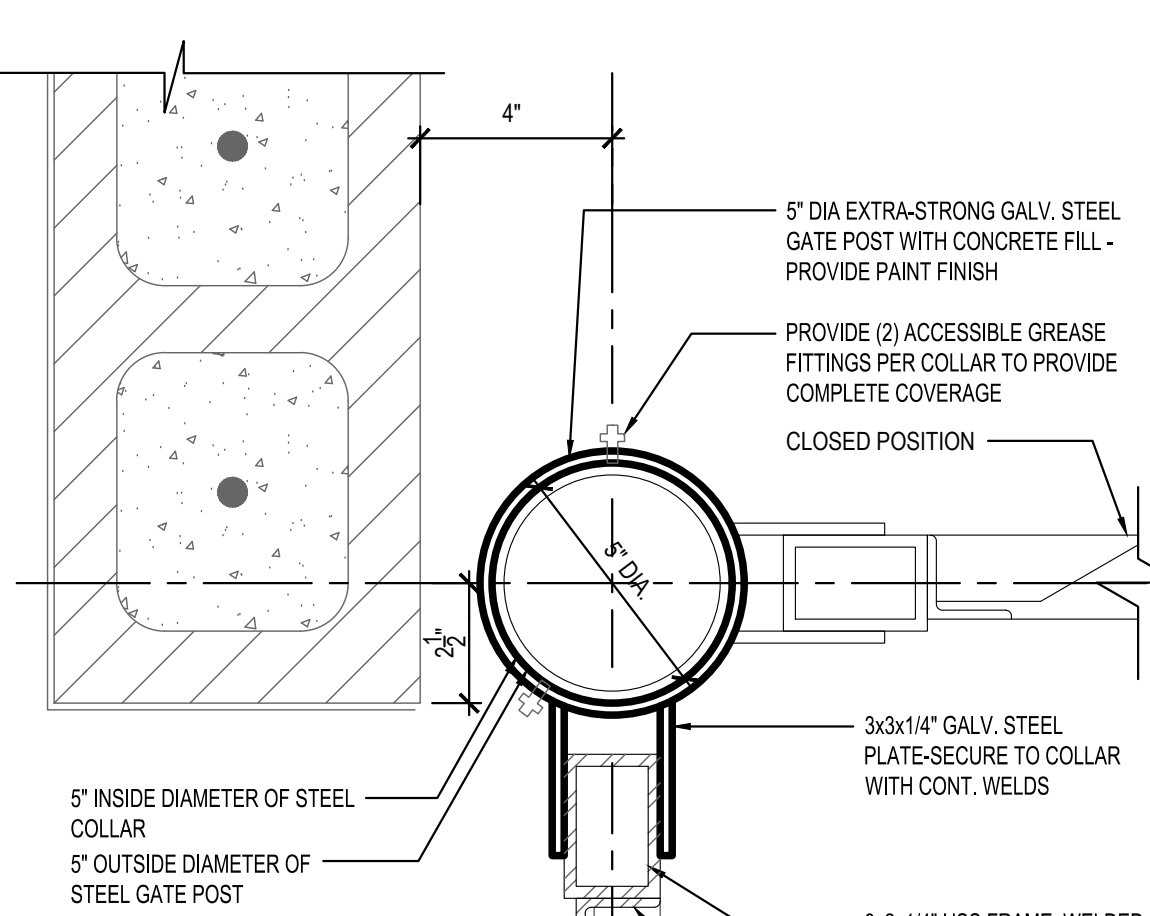

BOLLARD AT DUMPSTERS 10

Scale= 1" = 1'-0" A-407

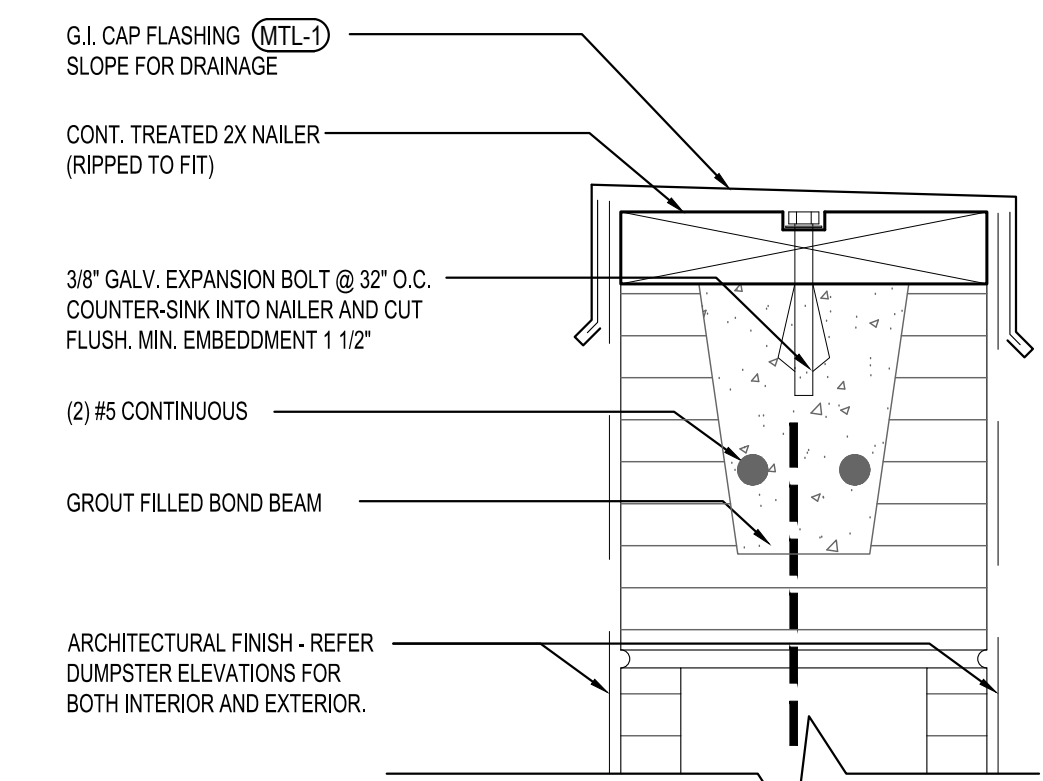
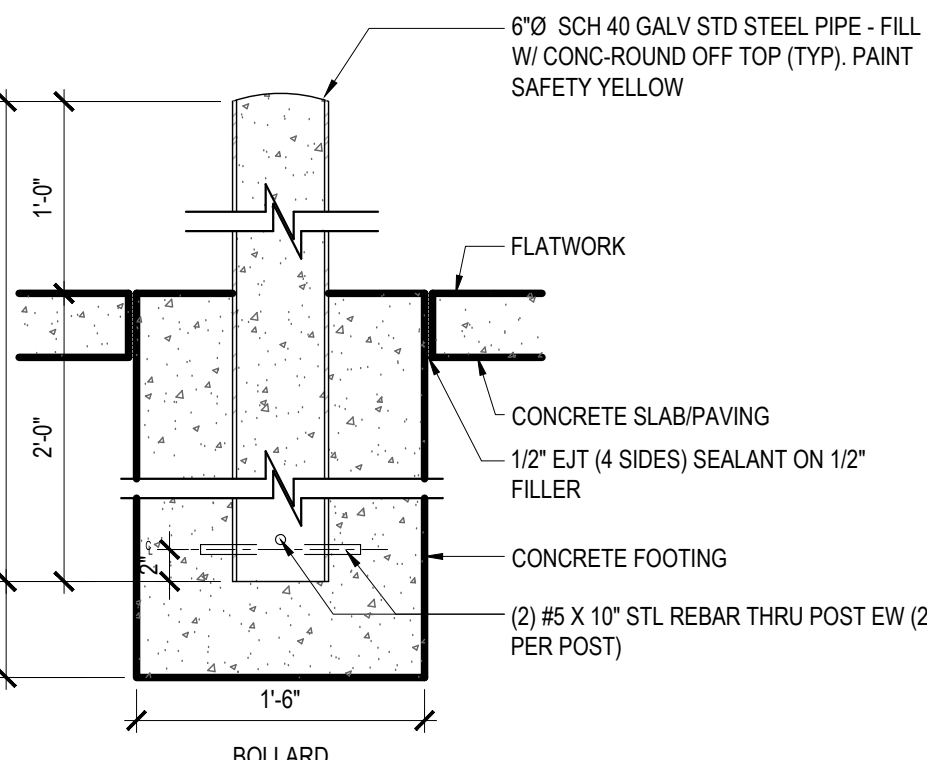

DUMPSTER CAP DETAIL 17

Scale= 3" = 1'-0" A-407

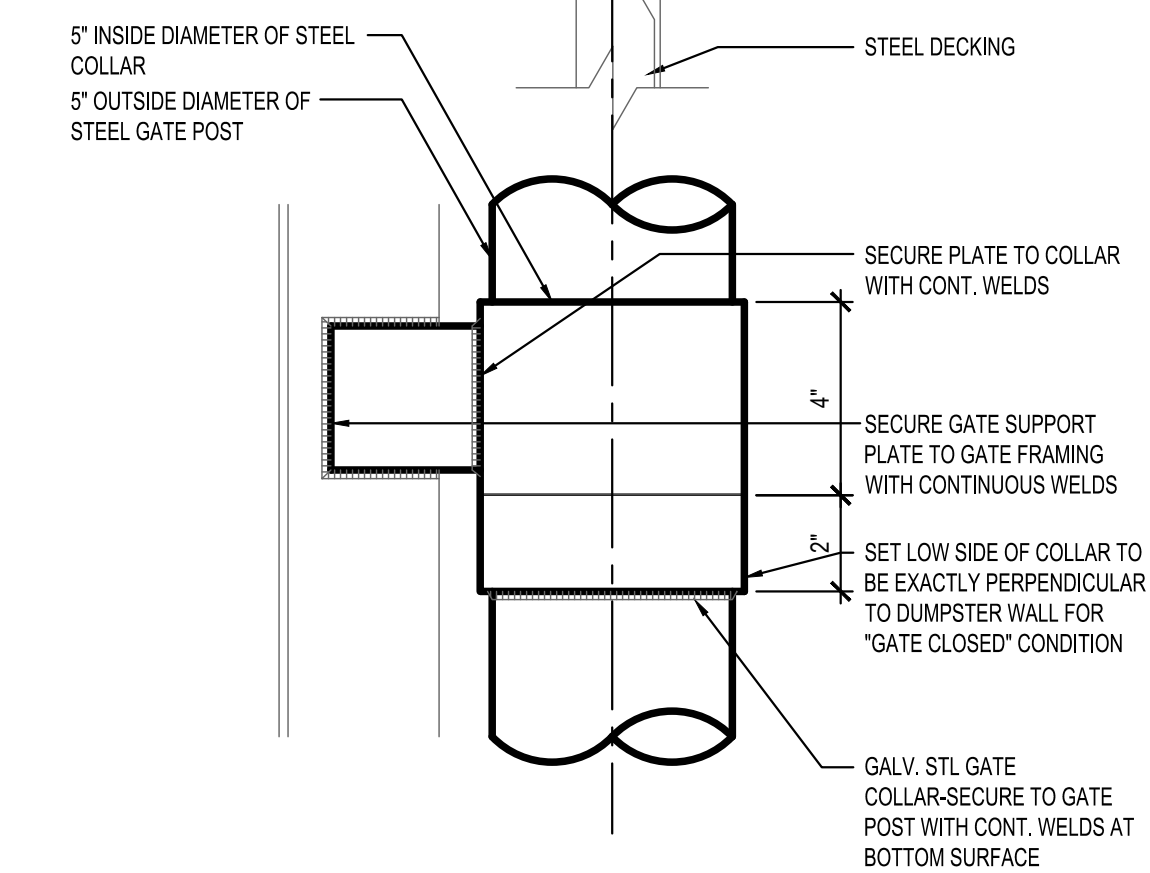

HINGE DETAIL 13

Scale= 3" = 1'-0" A-407

NOT USED 09

Scale= A-407

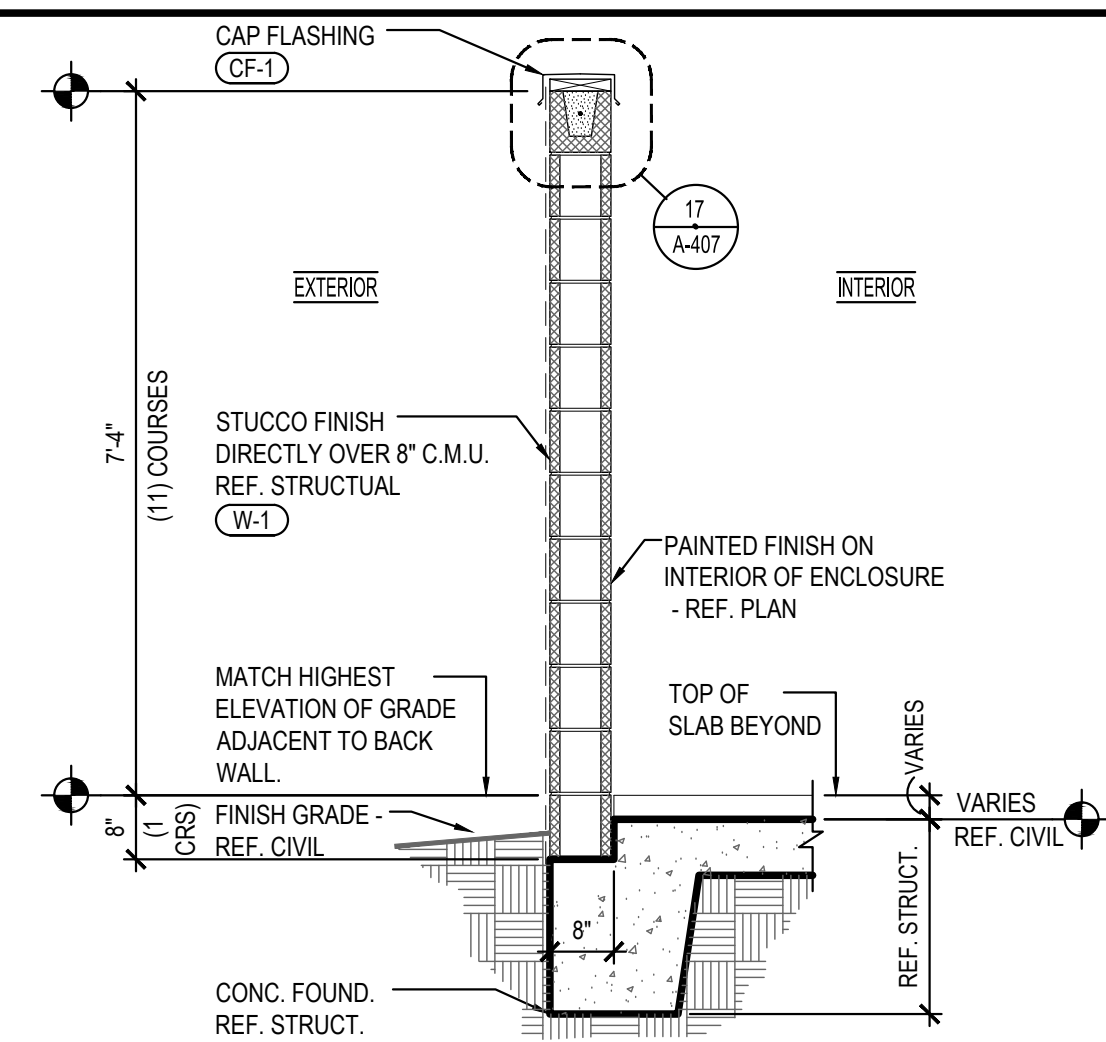

TRASH ENCLOSURE WALL SECTION 08

Scale= 1/2" = 1'-0" A-407

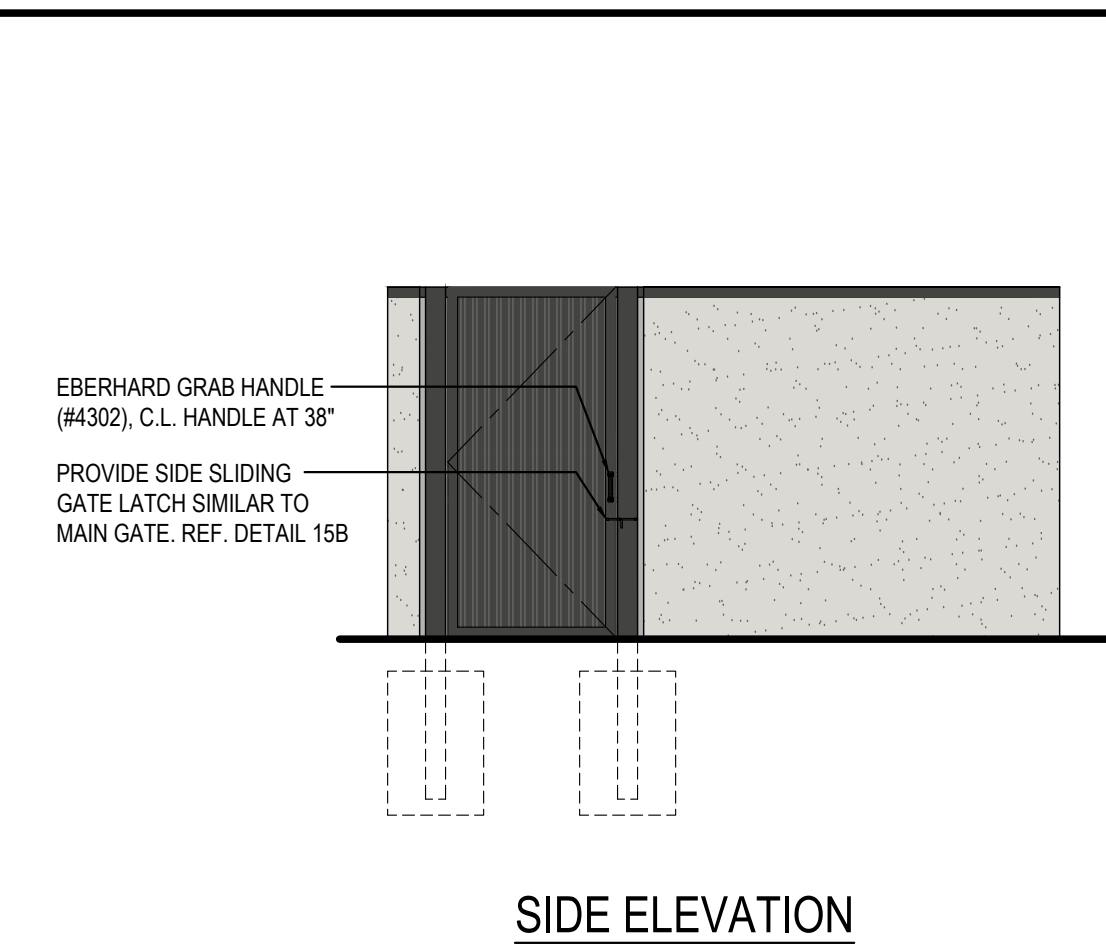

SIDE ELEVATION 04

Scale= 1/4" = 1'-0" A-407

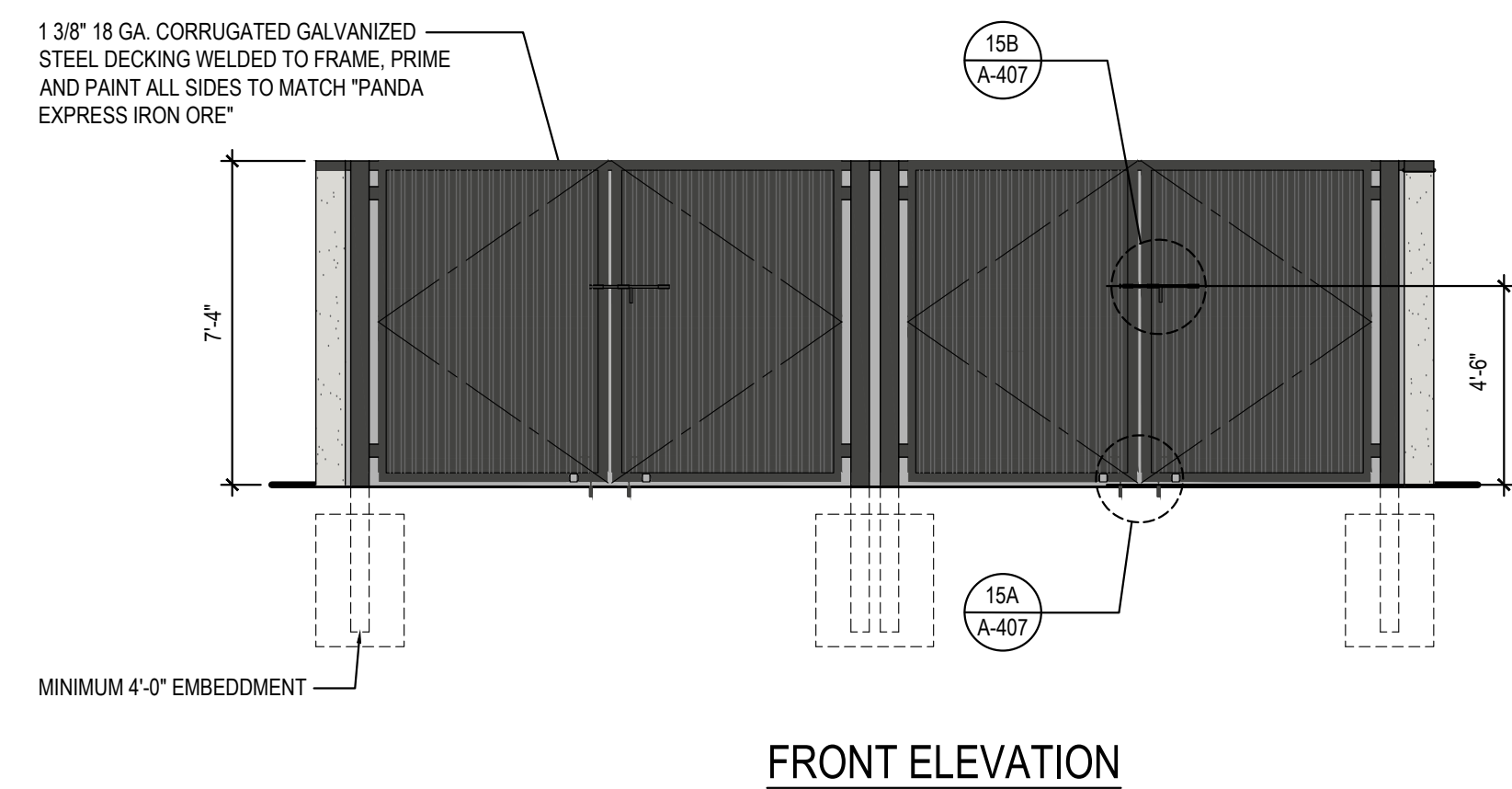

FRONT ELEVATION 02

Scale= 1/4" = 1'-0" A-407

REVISIONS:

LAND DEV. RE-SUBMITTAL 09-11-24

ISSUE DATE:

LAND DEVELOPMENT 06-28-24

DRAWN BY: LC & LS

PANDA PROJECT #: D33024

PANDA STORE #: S8-25-D33024

ARCH PROJECT #: 24038

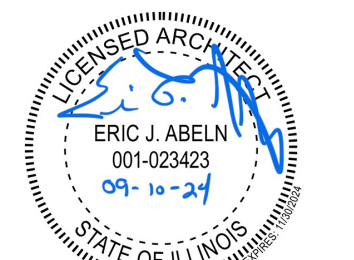

Heights Venture ARCHITECTURE + DESIGN

HOUSTON
1111 North Loop West, Suite 800
Houston, Texas 77008
281.854.6100

DALLAS
5741 Legacy Drive, Suite 320
Plano, Texas 75024
281.854.6100

CHICAGO
3333 Warrenville Road, Suite 200
Lisle, Illinois 60532
281.854.6100

PANDA EXPRESS

PANDA HOME 2700 R2
1390 BUTTERFIELD RD
AURORA, IL 60502

A-407

TRASH ENCLOSURE DETAILS

TRASH ENCLOSURE 01

Scale= 1/4" = 1'-0" A-407