

# Property Research Sheet

***Location ID#(s): 63640***

*As of: 4/8/2020*

*Researched By: Steve Broadwell*

Address: 1875 PLAIN AV

Current Zoning: Unincorporated, Kane County zoning

Parcel Number(s): 15-24-276-028

Comp Plan Designation: Industrial

Size: 3.84 Acres / 167,270 Sq. Ft.

ANPI Neighborhood: Light of the Community

School District: SD 131 - East Aurora School District

Park District: FVPD - Fox Valley Park District

Ward: 7

## **Current Land Use**

Current Land Use: Industry ..

AZO Land Use Category: Processing, finishing and assembly facilities (3140)

Number of Buildings: 1

Number of Stories: 1

Building Built In: 1990

Parking Spaces: 17

Total Building Area: 16,508 sq. ft.

Non-Residential Area: 167,270 sq. ft.

## **Zoning Provisions**

Unincorporated Property, no current City of Aurora zoning provisions.

## **Legislative History**

The known legislative history for this Property is as follows:

**R2008-029 approved on 1/29/2008:** A RESOLUTION ADOPTING THE LIGHT OF THE COMMUNITY NEIGHBORHOOD PLAN CREATED AS PART OF THE AURORA NEIGHBORHOOD PLANNING INITIATIVE (WARD 7).

## **Location Maps Attached:**

Aerial Overview

Location Map

Zoning Map

Comprehensive Plan Map



Plain Av

Sartor Ln

Legend

Subject Property



Planning & Zoning Division

N



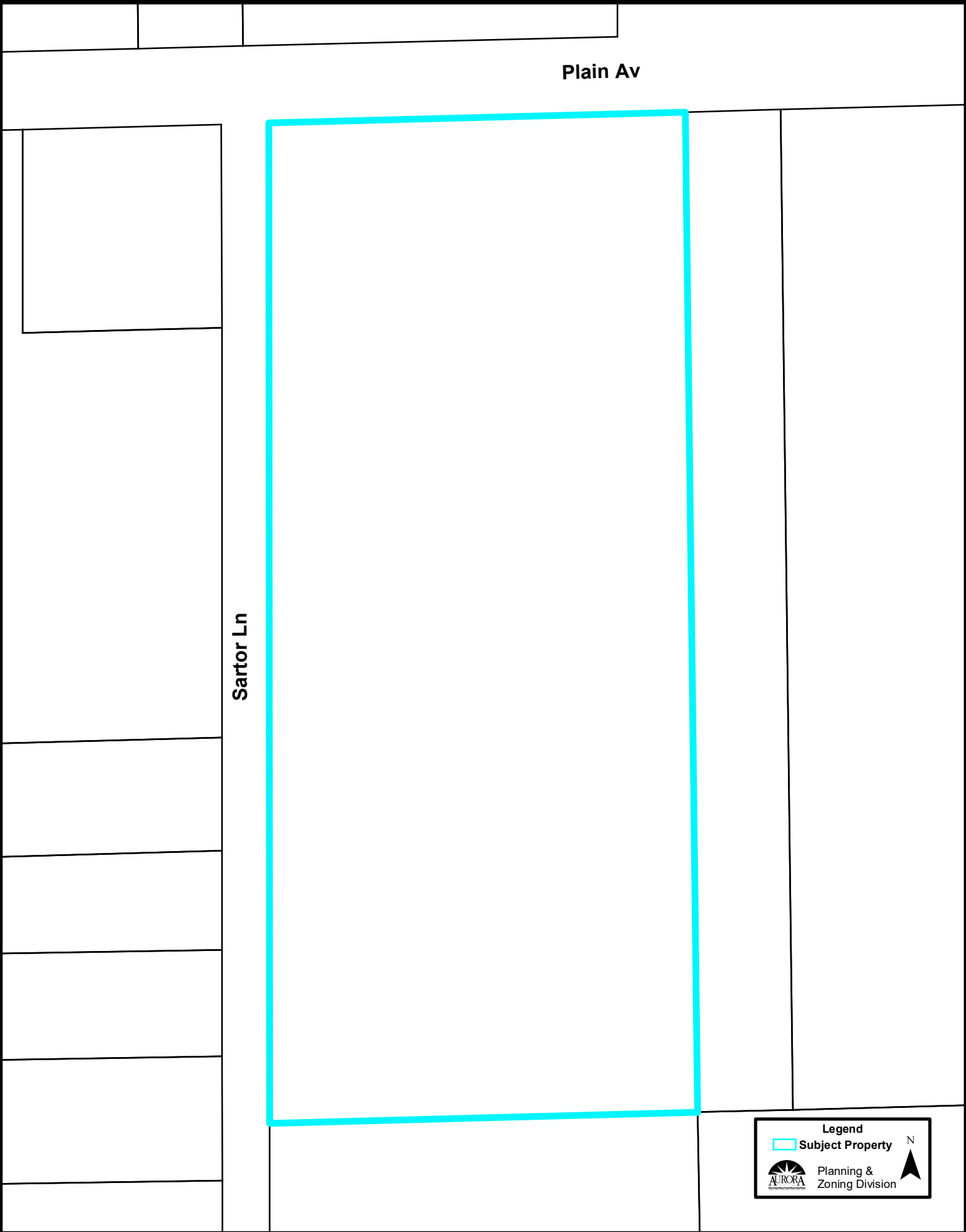

Plain Av

Sartor Ln

Legend

 Subject Property

 Planning & Zoning Division

N



Zoning Map (1:5,000):

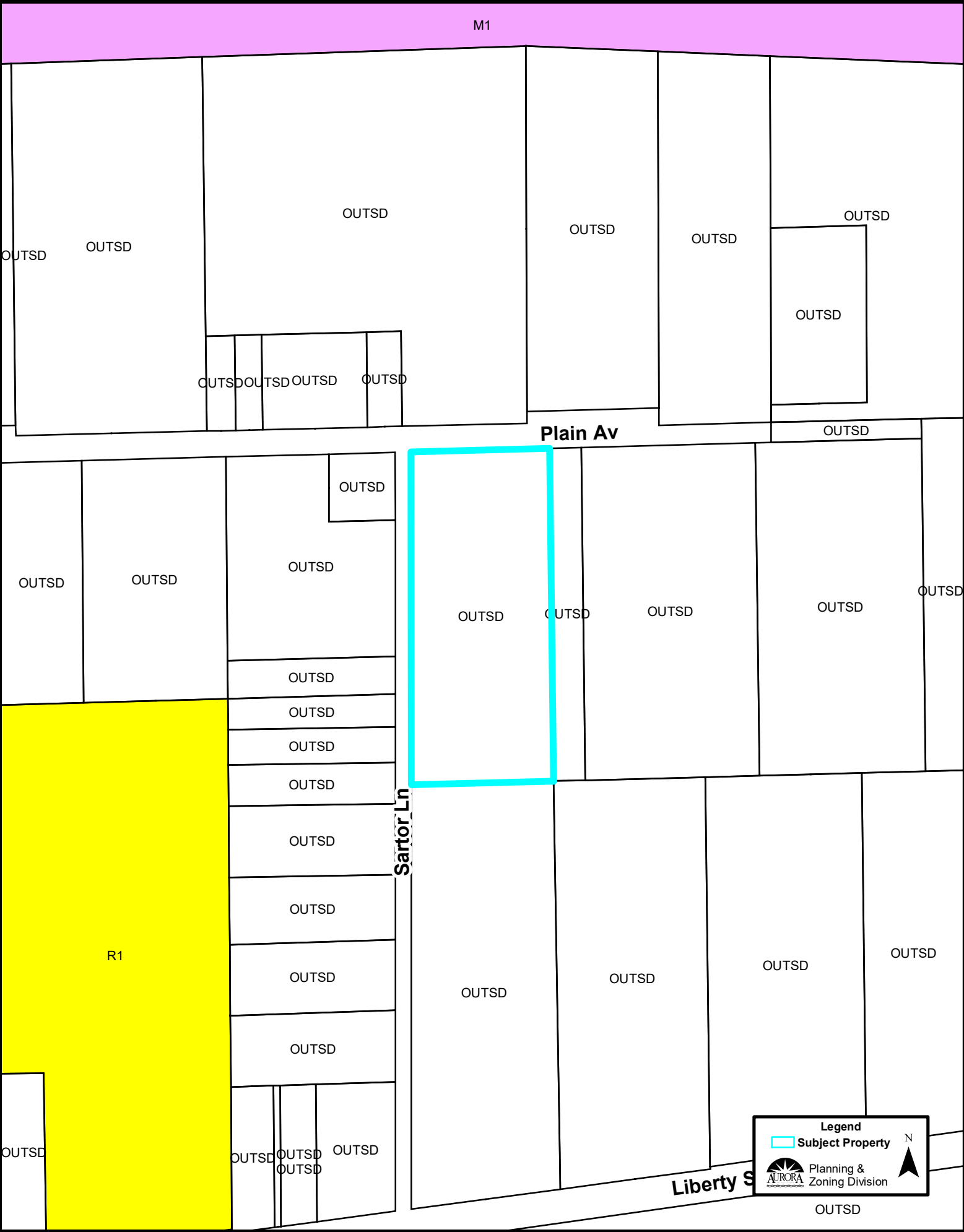

Comprehensive Plan (1:5,000):

