

KANE COUNTY ← → DUPAGE COUNTY

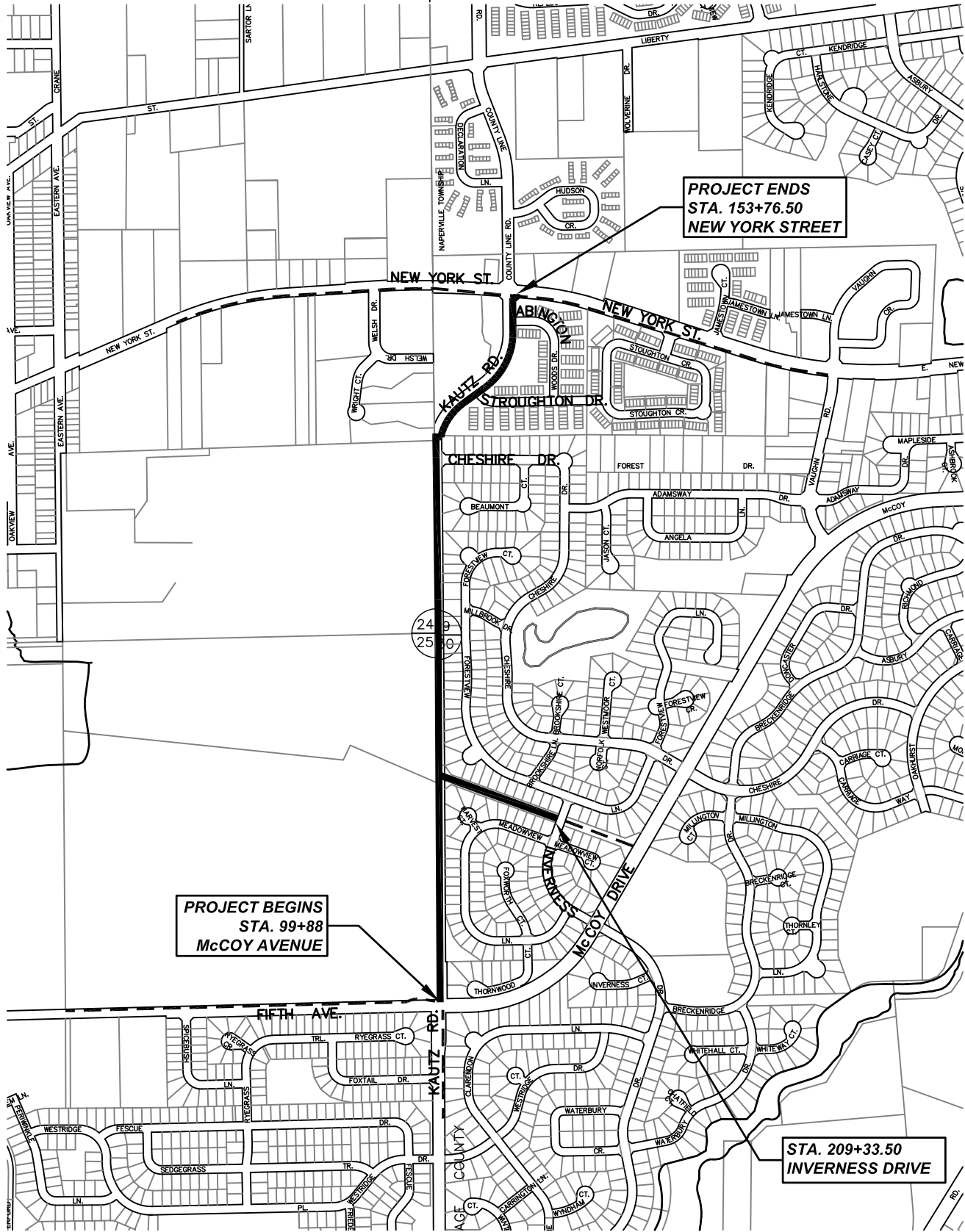

**PROJECT BEGINS**  
STA. 99+88  
**McCOY AVENUE**

**PROJECT ENDS**  
STA. 153+76.50  
**NEW YORK STREET**

**STA. 209+33.50**  
**INVERNESS DRIVE**

**CITY OF AURORA**

**SECTION 14-00303-00-BT**  
**ADDENDUM NUMBER 1**

**KAUTZ ROAD ITP SHARED USE PATH - LOCATION MAP**



**Engineering Enterprises, Inc.**  
52 Wheeler Road  
Sugar Grove, Illinois 60554  
630.466.6700 - www.eeiweb.com

SCALE:  
**N.T.S.**  
DATE:  
**06/06/16**

DRAWN BY:  
**KKP**  
REVISED: