

NOTES:

1. INSPECT TREE FOR DAMAGED BRANCHES, APPLY CORRECTIVE PRUNING.
2. SET ROOT BALL ON UNEXCAVATED OR TAMPED SOIL. TOP OF ROOTBALL SHALL BE TWO INCHES ABOVE SURROUNDING GRADE WITH BURLAP AND WIRE BASKET INTACT.
3. REMOVE WIRE BASKET AND BURLAP DOWN FOUR TO SIX INCHES BELOW TOP OF ROOT BALL. REMOVE ALL TWINE AND (IF USED), SYNTHETIC MATERIAL. REMOVE OR CORRECT GIRDLING ROOTS.
4. TAMP EXCAVATED SOIL AROUND BASE OF ROOTBALL.
5. BACKFILL REMAINDER EXCAVATED SOIL TAMPED LIGHTLY. HIGH CLAY OR POOR SOIL SHALL RECEIVE SOIL AMENDMENT PER LANDSCAPE NOTES.
6. WATER THOROUGHLY WITHIN TWO HOURS USING 10 TO 15 GALLONS OF WATER.
7. APPLY MULCH IN EVEN LAYER, KEEPING AWAY FROM ROOT FLARE.
8. FINAL LOCATION OF TREE TO BE APPROVED BY OWNER.

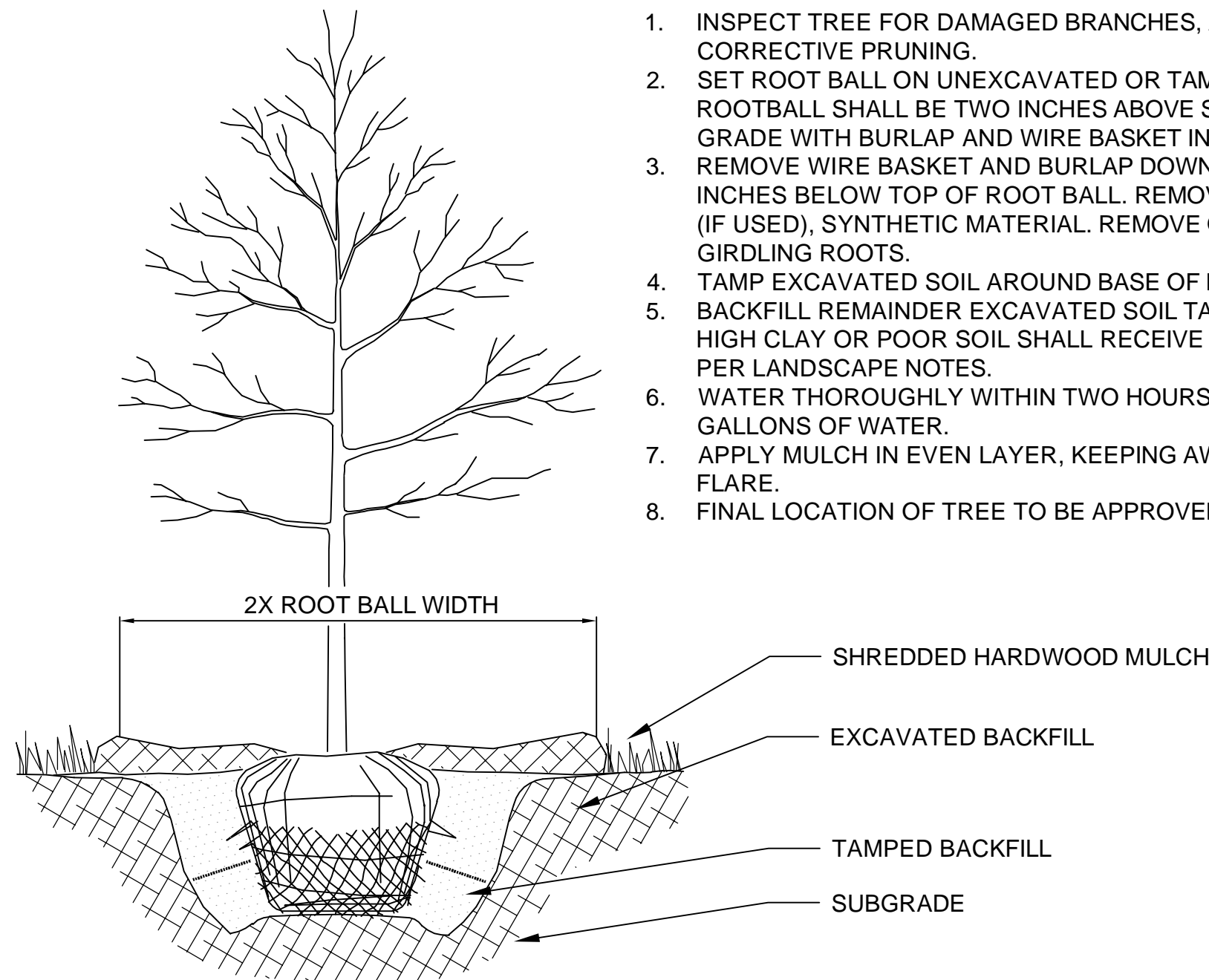

1 TREE PLANTING

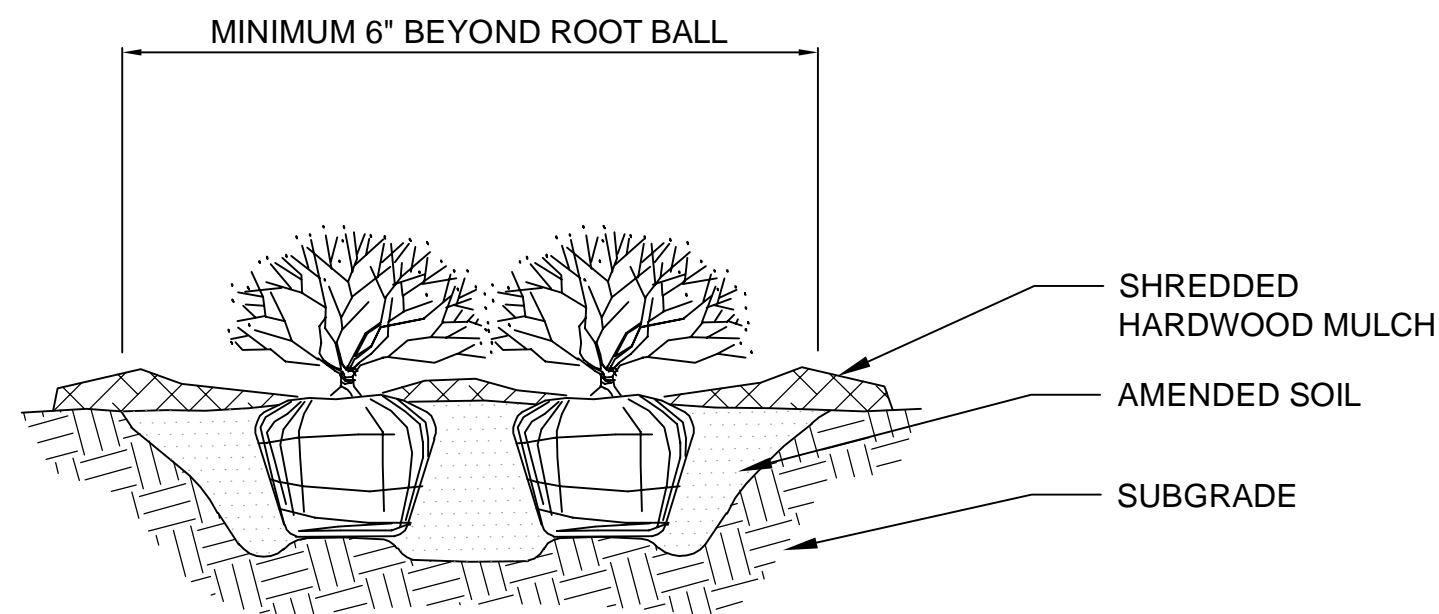

NOTES:

1. APPLY CORRECTIVE PRUNING.
2. SET ROOT BALL OR CONTAINER ON UNEXCAVATED OR TAMPED SOIL. TOP OF ROOTBALL (CONTAINER) SHALL BE ONE INCH ABOVE SURROUNDING GRADE. FOR LARGER SHRUBS WITHIN PLANTING BED DIG A DEEPER PIT ONLY FOR THOSE SHRUBS.
3. REMOVE BURLAP FROM TOP HALF THE LENGTH OF ROOTBALL. TWINE AND (IF USED) SYNTHETIC MATERIAL SHALL BE REMOVED FROM PLANTING BED. FOR CONTAINER GROWN SHRUBS, REMOVE CONTAINER AND LOOSEN ROOTS PRIOR TO INSTALLATION.
4. REMOVE OR CORRECT GIRDLING ROOTS.
5. PLUMB AND BACKFILL WITH AMENDED SOIL PER LANDSCAPE NOTES. WATER THOROUGHLY WITHIN TWO HOURS.
6. APPLY MULCH IN EVEN LAYER, KEEPING AWAY FROM ROOT FLARE. MULCH LIMITS FOR SHRUBS EXTEND TO ALL LIMITS OF PLANTING BED. SEE PLANS FOR BED LAYOUTS.

2 SHRUB PLANTING

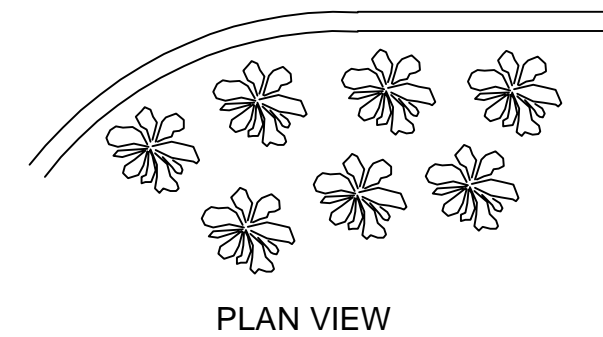

NOTES:

1. EXCAVATE PLANTING BED.
2. BED HEIGHT IS TO BE 2" ABOVE FINISH GRADE AND WELL DRAINED.
3. REMOVE CONTAINER, SCORE SOIL MASS TO REDIRECT AND PREVENT CIRCLING ROOTS. CORRECT GIRDLING ROOTS.
2. PLANT MATERIAL SHALL BE LAID OUT BY FOLLOWING THE BED EDGE, WORKING TOWARDS THE CENTER OF THE BED USING TRIANGULAR (STAGGERED) SPACING AS PLAUSIBLE.
3. PLUMB AND BACKFILL WITH PLANTING MIX AS SPECIFIED IN LANDSCAPE NOTES.
4. APPLY MULCH IN EVEN LAYER, KEEPING AWAY FROM ROOT FLARE. MULCH LIMITS FOR PERENNIALS/GROUNDCOVER EXTEND TO ALL LIMITS OF PLANTING BED, SEE PLANS FOR BED LAYOUTS.
5. SPACING TO BE AS SPECIFIED IN THE PLANT LIST. PERENNIALS SHALL BE PLACED WITH THEIR CENTER 24" FROM EDGE OF BED.

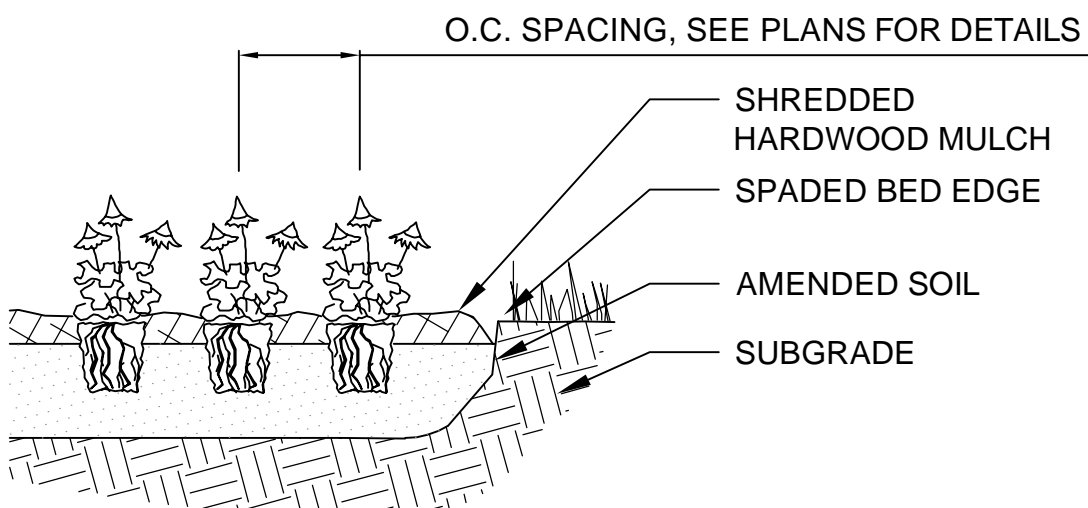

SECTION

3 PERENNIAL PLANTING

LANDSCAPE NOTES

1. THE LANDSCAPE CONTRACTOR SHALL BE RESPONSIBLE FOR INSTALLING MATERIALS AND PLANTS SHOWN ON THE LANDSCAPE PLAN. THE CONTRACTOR IS RESPONSIBLE FOR THE COST TO REPAIR UTILITIES, ADJACENT LANDSCAPE, PUBLIC AND PRIVATE PROPERTY THAT IS DAMAGED BY THE CONTRACTOR OR THEIR SUBCONTRACTOR'S OPERATIONS DURING INSTALLATION OR DURING THE SPECIFIED MAINTENANCE PERIOD. CALL FOR UTILITY LOCATIONS PRIOR TO ANY EXCAVATION.
2. THE CONTRACTOR SHALL REPORT ANY DISCREPANCY IN PLAN VS. FIELD CONDITIONS IMMEDIATELY TO THE LANDSCAPE ARCHITECT, PRIOR TO CONTINUING WITH THAT PORTION OF WORK.
3. THE CONTRACTOR SHALL BE RESPONSIBLE FOR THE REPAIR OF ANY OF THEIR TRENCHES OR EXCAVATIONS THAT SETTLE.
4. ALL NURSERY STOCK SHALL BE WELL BRANCHED, HEALTHY, FULL, PRE-INOCULATED AND FERTILIZED. DECIDUOUS TREES SHALL BE FREE OF FRESH SCARS. TRUNKS WILL BE WRAPPED IF NECESSARY TO PREVENT SUN SCALD AND INSECT DAMAGE. THE LANDSCAPE CONTRACTOR SHALL REMOVE THE WRAP AT THE PROPER TIME AS A PART OF THIS CONTRACT.
5. ALL NURSERY STOCK SHALL BE GUARANTEED, BY THE CONTRACTOR, FOR ONE YEAR FROM DATE OF FINAL INSPECTION.
6. AMENDED SOIL SHALL BE PROVIDED AND GRADED BY THE GENERAL CONTRACTOR UP TO 6 INCHES BELOW FINISHED GRADE IN TURF AREAS AND 18 INCHES IN PLANTING AREAS.
7. PLANTING AREA SOIL SHALL BE AMENDED WITH 25% SPHANGUM PEATMOSS, 5% HUMUS AND 65% PULVERIZED SOIL FOR ALL SHRUB, ORNAMENTAL GRASS, PERENNIAL AND ANNUAL BEDS. AMENDED TURF AREA SOIL SHALL BE STANDARD TOPSOIL.
8. SEED/SOD LIMIT LINES ARE APPROXIMATE. CONTRACTOR SHALL SEED/SOD ALL AREAS WHICH ARE DISTURBED BY GRADING WITH THE SPECIFIED SEED/SOD MIXES.
9. CONTRACTOR SHALL INSTALL SHREDDED HARDWOOD MULCH AT A 3" DEPTH TO ALL TREES, SHRUB, PERENNIAL, AND GROUNDCOVER AREAS. TREES PLACED IN AREA COVERED BY TURF SHALL RECEIVE A 4 FT WIDE MAXIMUM TREE RING WITH 3" DEPTH SHREDDED HARDWOOD MULCH. A SPADED BED EDGE SHALL SEPARATE MULCH BEDS FROM TURF OR SEEDED AREAS. A SPADED EDGE IS NOT REQUIRED ALONG CURBED EDGES.
10. WEED FABRIC SHALL ONLY BE APPLIED UNDER DECORATIVE STONE APPLICATIONS.
11. INSTALLATION OF TREES WITHIN PARKWAYS SHALL BE COORDINATED IN THE FIELD WITH LOCATIONS OF UNDERGROUND UTILITIES. TREES SHALL NOT BE LOCATED CLOSER THAN 5' FROM UNDERGROUND UTILITY LINES AND NO CLOSER THAN 10' FROM UTILITY STRUCTURES.
12. DO NOT DISTURB THE EXISTING PAVING, LIGHTING, OR LANDSCAPING THAT EXISTS ADJACENT TO THE SITE UNLESS OTHERWISE NOTED ON PLAN.
13. PLANT QUANTITIES SHOWN ARE FOR THE CONVENIENCE OF THE OWNER AND JURISDICTIONAL REVIEW AGENCIES. THE CONTRACTOR IS RESPONSIBLE FOR VERIFYING ALL PLANT QUANTITIES AS DRAWN.
14. THE OWNER'S REPRESENTATIVE MAY REJECT ANY PLANT MATERIALS THAT ARE DISEASED, DEFORMED, OR OTHERWISE NOT EXHIBITING SUPERIOR QUALITY.
15. THE CONTINUED MAINTENANCE OF ALL REQUIRED LANDSCAPING SHALL BE THE RESPONSIBILITY OF THE OWNER OF THE PROPERTY ON WHICH SAID MATERIALS ARE REQUIRED. ALL PLANT MATERIALS REQUIRED BY THIS SECTION SHALL BE MAINTAINED AS LIVING VEGETATION AND SHALL BE PROMPTLY REPLACED IF THE PLANT MATERIAL HAS DIED PRIOR TO FINAL ACCEPTANCE. PLANTING AREAS SHALL BE KEPT FREE OF TRASH, LITTER, AND WEEDS AT ALL TIMES.

SITE LANDSCAPE ORDINANCE		
ZONING ORDINANCE	REQUIREMENT	PROVIDED
PARKING LOT REQUIREMENT		
1.5 CANOPY TREE CREDITS (1 CANOPY TREE AND 10 SHRUBS) PER 20 PARKING STALLS	39 PARKING SPACES TOTAL REQUIRED = 3 CANOPY TREE CREDITS	TWO CANOPY TREES AND 20 SHRUBS PROVIDED
STREET TREE REQUIREMENT		
3 CANOPY TREES PER EVERY 100 LINEAR FEET OF STREET FRONTAGE ADJACENT TO A RIGHT OF WAY	MCCOY DRIVE = 227 LINEAR FEET REQUIRED = 7 CANOPY TREES	6 CANOPY TREES ALONG MCCOY DRIVE AND ONE CANOPY TREE ALONG VENUTI DRIVE
PERIMETER YARD REQUIREMENT		
3 CANOPY TREE CREDITS PER 100 LINEAR FEET OF PARKING LOT PERIMETER	PARKING LOT PERIMETER = 940 LINEAR FEET REQUIRED = 28 CANOPY TREE CREDITS	15 PROVIDED TREES + 8 EXISTING = 23 CREDITS 84 PROVIDED SHRUBS + 16 EXISTING = 5 CREDITS TOTAL OF 28 CANOPY TREE CREDITS PROVIDED

NO.	REVISIONS	DATE	BY

Kimley»Horn
 © 2019 KIMLEY-HORN AND ASSOCIATES, INC.
 1001 WARRENVILLE ROAD, SUITE 350,
 WARRENVILLE, IL 60550
 PHONE: 630-487-5550
 WWW.KIMLEY-HORN.COM

SCALE: AS NOTED
 DESIGNED BY: JPM
 DRAWN BY: BMH
 CHECKED BY: JPM

PERFECT HOME SERVICES
 4341 FOX VALLEY CENTER ROAD, AURORA IL 60505

LANDSCAPE PLAN NOTES AND DETAILS FOR FOX VALLEY EAST, REGION 1, LOT 11

FOX VALLEY CENTER DR.
 4341 FOX VALLEY CENTER DR. AURORA, IL 60504

ORIGINAL ISSUE: 06/05/2019
 KHA PROJECT NO. 168800000
 SHEET NUMBER

L1.0

Drawing name: K:\SUS_L10A_168800000_Excavation.dwg - LANDSCAPE PLAN.dwg
 This document, together with the concepts and designs presented herein, is intended solely for the specific purpose and client for which it was prepared. No other use, reproduction, or distribution is permitted without the prior written authorization and adaptation by Kimley-Horn and Associates, Inc.