

ERECT ORANGE SAFETY/BARRIER FENCE PRIOR TO ANY CONSTRUCTION ACTIVITY, AS SHOWN ON PLAN. DO NOT STORE ANY EQUIPMENT OR MATERIALS WITHIN THE PROTECTED AREA. REMOVE THE BARRIER FENCE ONLY AFTER CONSTRUCTION OPERATIONS ARE COMPLETED.

# 1 Tree Protection Plan NTS

## Root Pruning

Existing tree roots greater than one (1) inch in diameter, measured at the edge of excavation, shall be pruned within 24 hours of the time they have been damaged by construction activity. The severed root shall be pruned at the edge of excavation, or one (1) inch beyond the entire damaged portion of the tree root, if damaged root extends beyond the edge of excavation into undisturbed soil.

All cuts shall be cleanly made with sharp tools.

The excavated area around the existing tree roots shall be backfilled as soon as construction activities permit.

Amended existing soil shall be used as backfill material within the disturbed root zone areas not receiving drainage or subbase stone items. Amended existing soil shall be amended with peat or compost in the ratio of one part organic to seven parts existing soil.

## Vulnerable Area Protection Methods

All tree root zones designated as "Vulnerable" shall receive special care and attention during construction. These areas contain roots for large trees that are within the construction area. Since these trees have high value to the project, efforts shall be made to preserve these trees, however the property owner will not be held liable if the trees do not survive.

An arborist should be consulted prior to construction to provide advice on preservation techniques. Each tree and construction condition is unique so an arborist is best qualified to provide a recommendation for each tree. Preservations may include root pruning, crown pruning, hormone treatment, fertilizers, soil amendments, excavation techniques, etc.

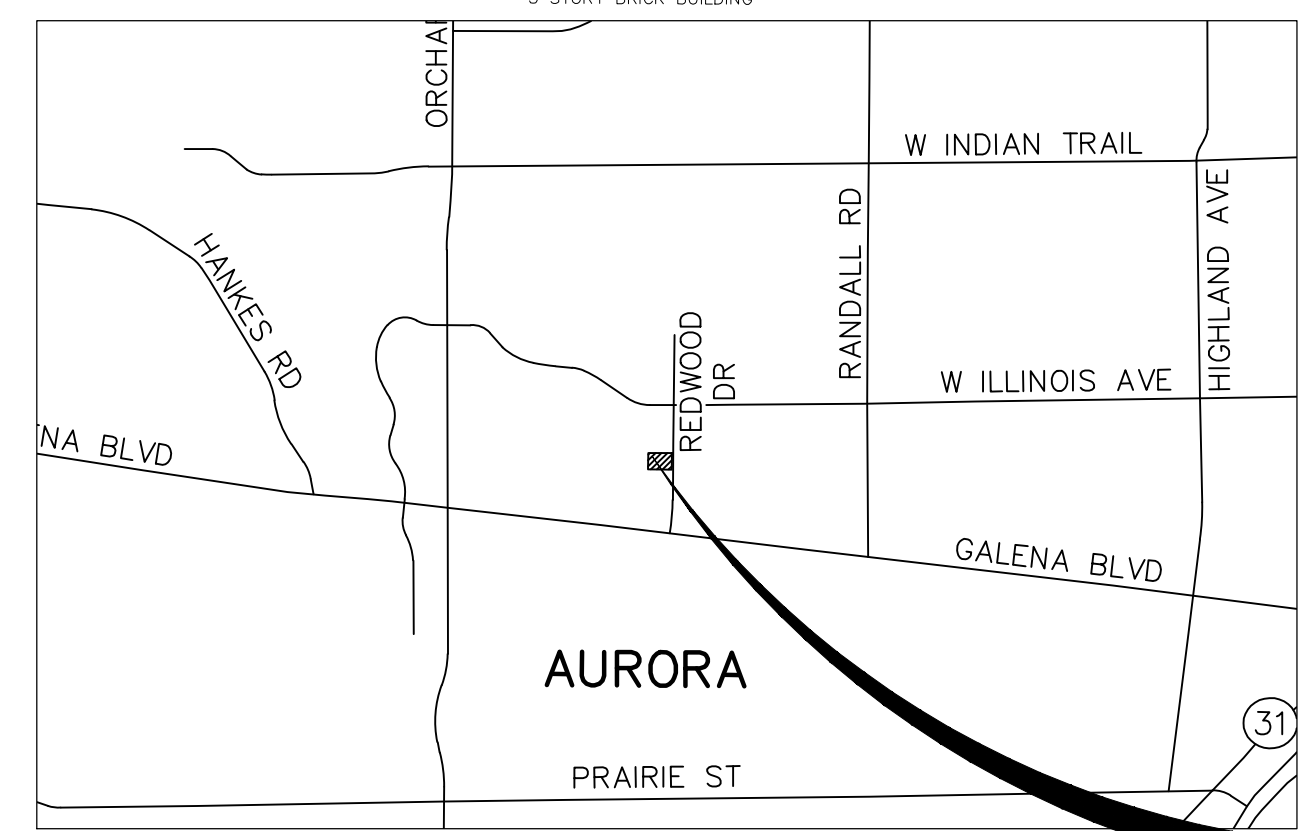
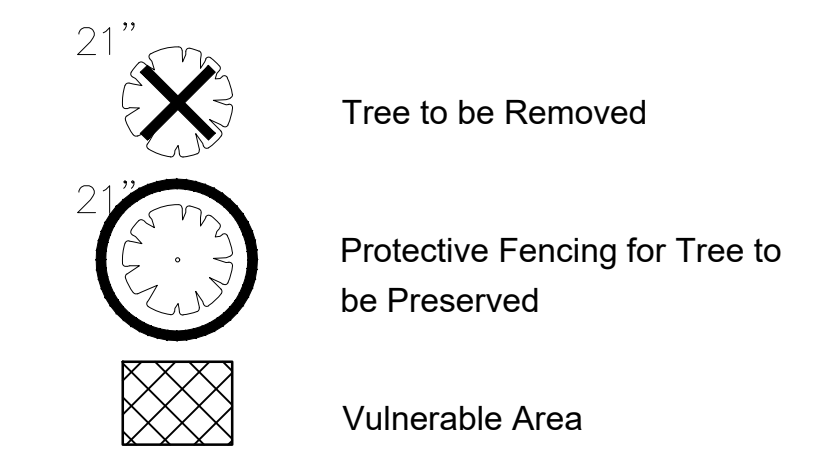

## PROJECT LOCATION

INDEX OF SHEETS	
SHEET NO.	DESCRIPTION
L1	TREE PRESERVATION PLAN
L2	LANDSCAPE PLAN
L3	LANDSCAPE DETAILS & SUMMARY
L4	LANDSCAPE SPECIFICATIONS

**SEAL** Date: 06/07/19  
 James Matthew Nelson, ASLA, PLA, LEED  
 Illinois Registered Landscape Architect  
 # 157-001644  
 Expires 08/31/2019

**JULIE**  
 ILLINOIS  
 ONE-CALL SYSTEM  
 Simply Call 811

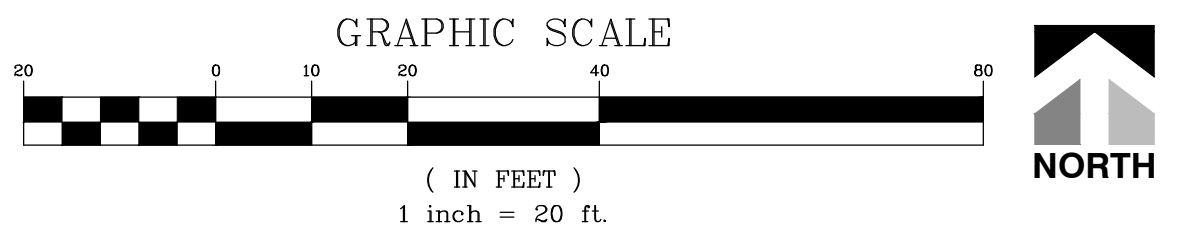

DRAWN BY: [ ]  
 REVISIONS: [ ]  
 DATE: [ ]

**Manhard CONSULTING LTD**  
 800 Westchester Parkway, Suite 200, Naperville, IL 60563  
 Civil Engineers • Surveyors • Water Resource Engineers • Water & Wastewater Engineers • Environmental Scientists • Landscape Architects • Planners  
 Construction Managers • Environmental Scientists • Landscape Architects • Planners

SALVATION ARMY COMMUNITY CENTER  
 CITY OF AURORA, ILLINOIS  
 TREE PRESERVATION PLAN

PROJ. MGR.: DBM  
 PROJ. ASSOC.: DEM3  
 DRAWN BY: MN  
 DATE: 01-25-19  
 SCALE: 1"=20'  
 SHEET  
**L1** OF **L4**  
 WHA.AU101

June 7, 2019 - 10:00 Draw Name: P:\Whanaui\03\Land\Land\Final Drawings\Plan Set\03-Final LA Plan\CITY STANDARD-PRINT VERSION.dwg, Updated By: M.Nelson

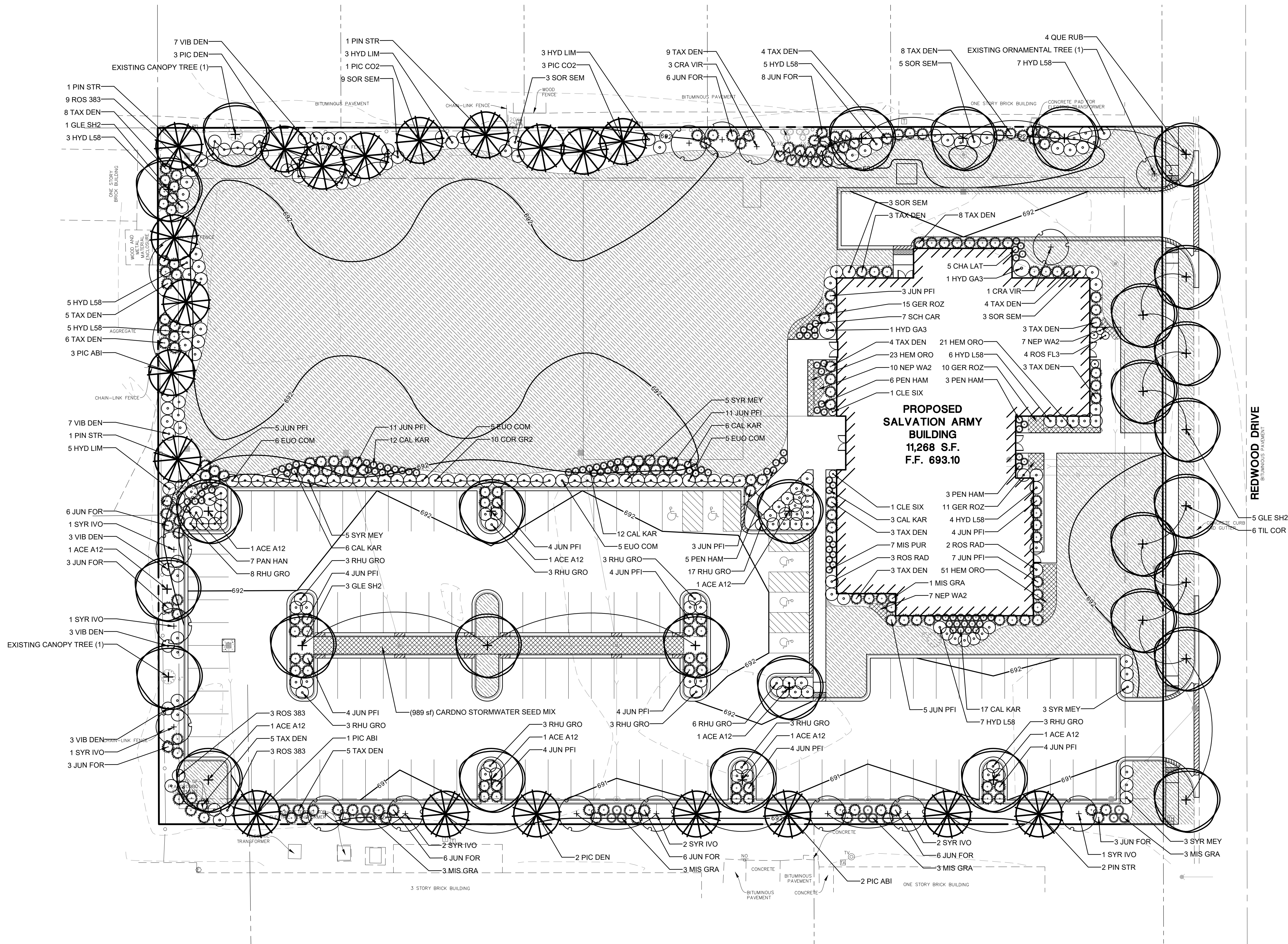

**PROPOSED SALVATION ARMY BUILDING**  
11,268 S.F.  
F.F. 693.10

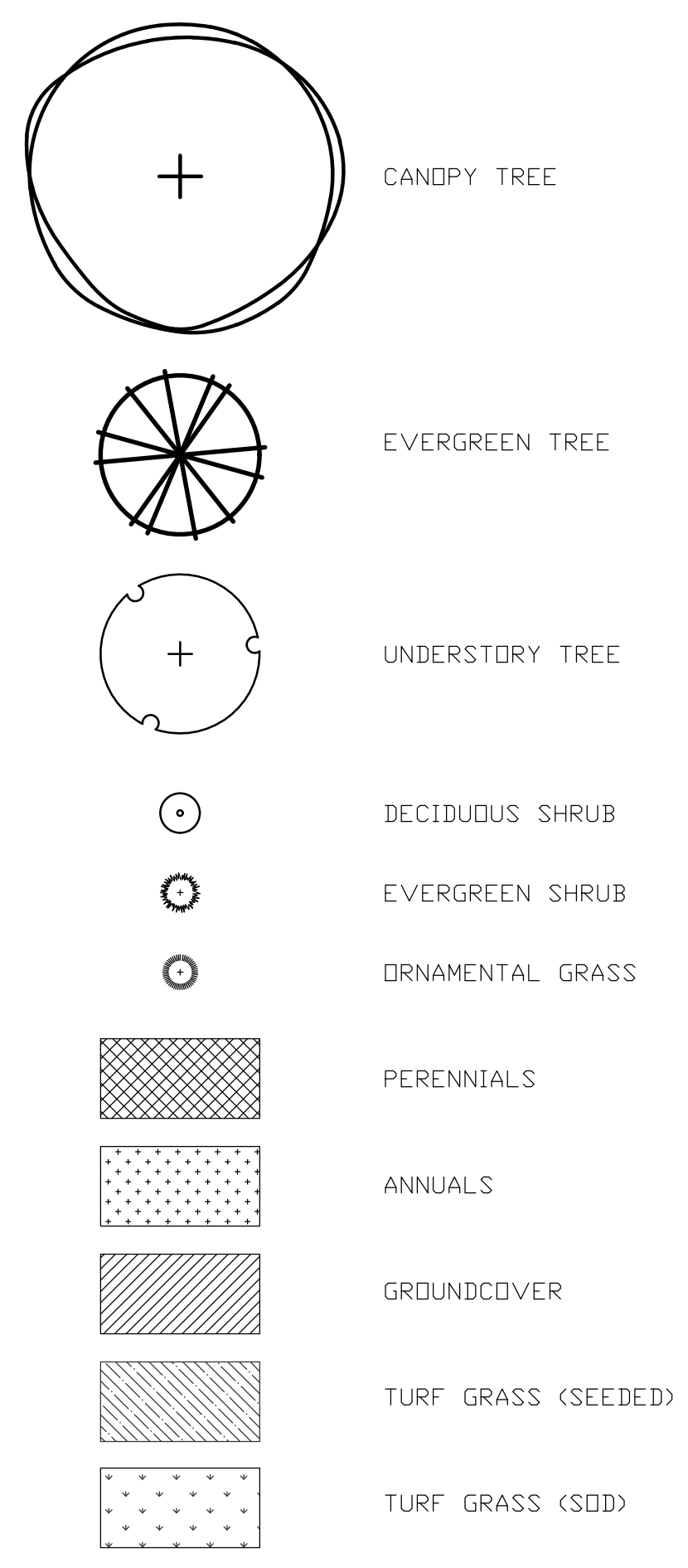

**SEAL** Date: 06/07/19  
 James Matthew Nelson, ASLA, PLA, LEED  
 Illinois Registered Landscape Architect  
 # 157-001644  
 Expires 08/31/2019

**JULIE**  
 ILLINOIS  
 ONE-CALL SYSTEM  
**Simply Call 811**

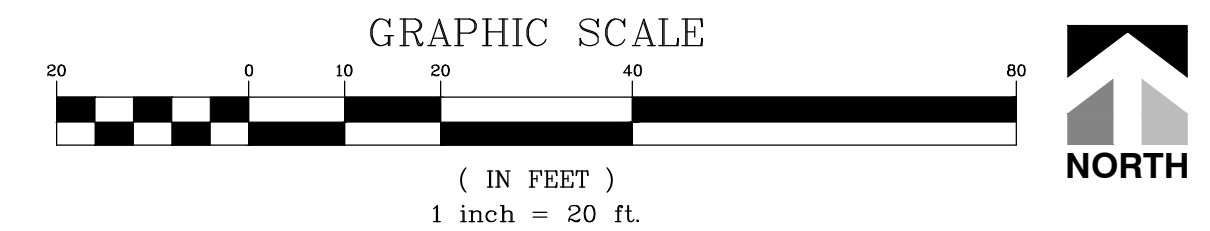

NO.	DATE	REVISIONS

**Manhard CONSULTING LTD.**  
 880 Westmoreland Road  
 Suite 100  
 Aurora, IL 60504  
 630.891.1888  
 Civil Engineers • Surveyors • Water Resources Engineers • Water & Wastewater Engineers  
 Construction Managers • Environmental Scientists • Landscape Architects • Planners

**SALVATION ARMY COMMUNITY CENTER**  
**CITY OF AURORA, ILLINOIS**  
**PRELIMINARY LANDSCAPE PLAN**

PROJ. MGR.: DBM  
 PROJ. ASSOC.: DEM3  
 DRAWN BY: MN  
 DATE: 01-25-19  
 SCALE: 1"=20'  
 SHEET  
**L2 OF L4**  
 WHA.AU101

©2019 MANHARD CONSULTING, LTD. ALL RIGHTS RESERVED.

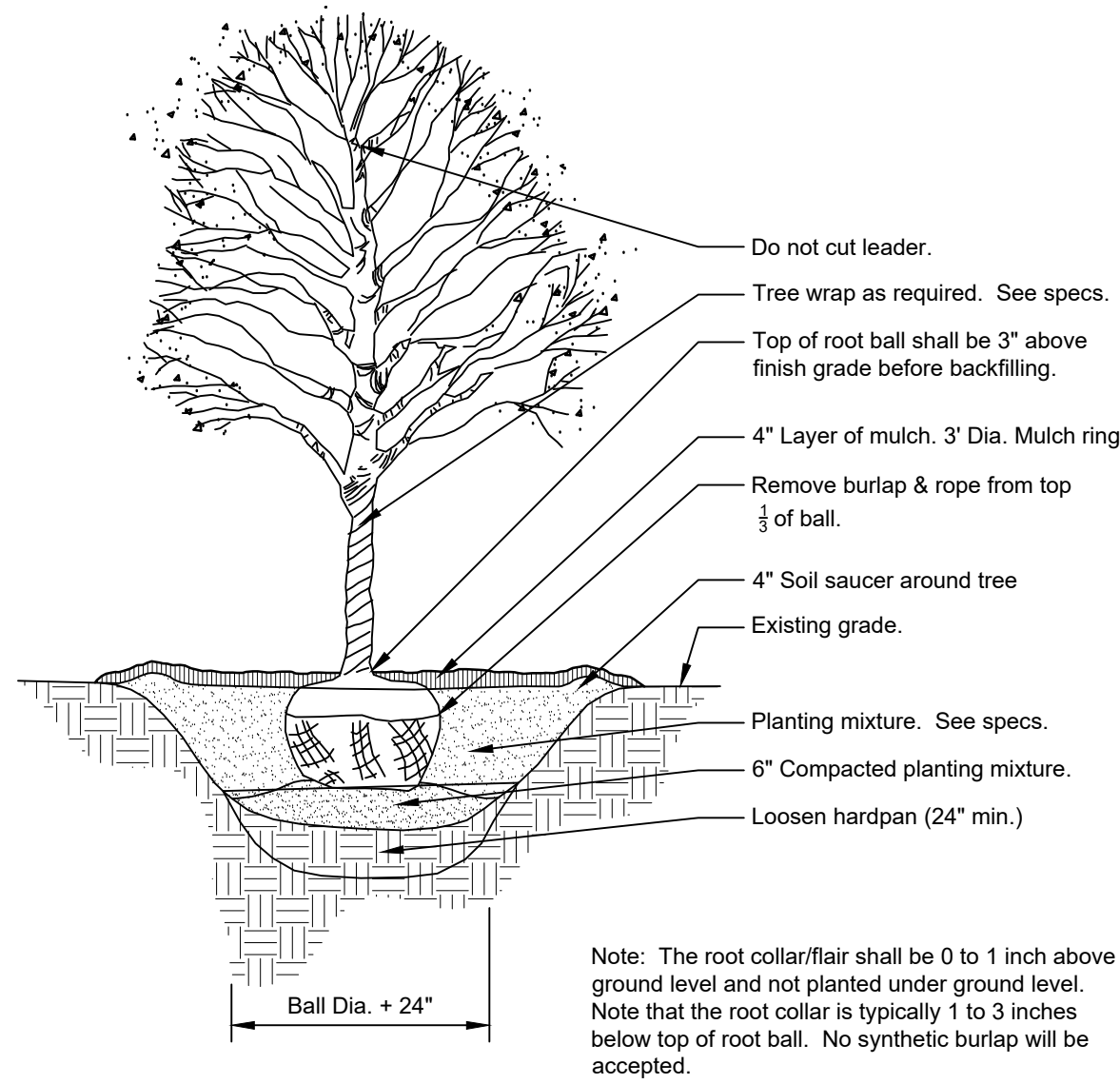

**1 DECIDUOUS TREE PLANTING**  
1/4" = 1'-0" 329343.33-20

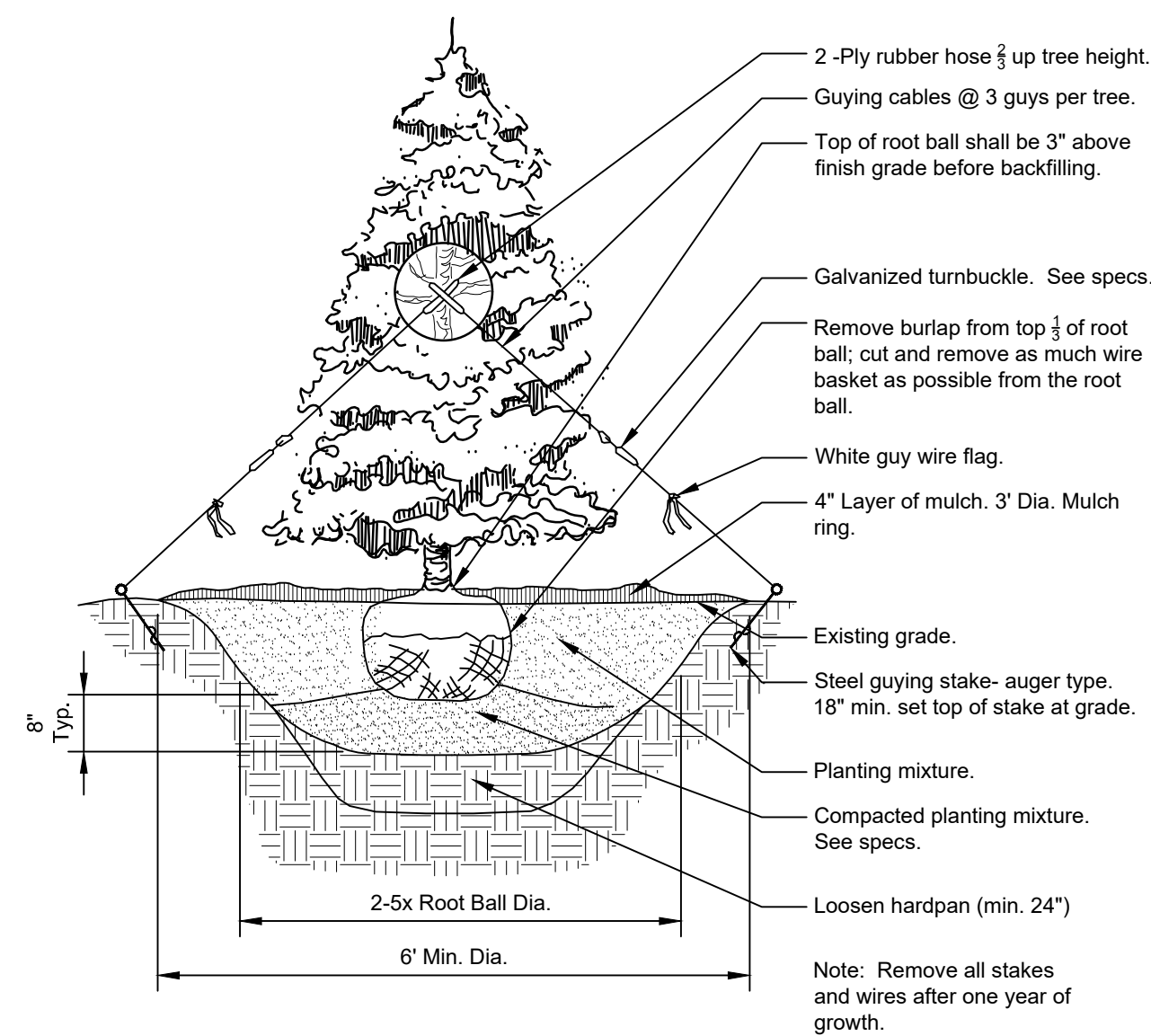

**2 CONIFER TREE PLANTING**  
1/4" = 1'-0" 329343.46-01

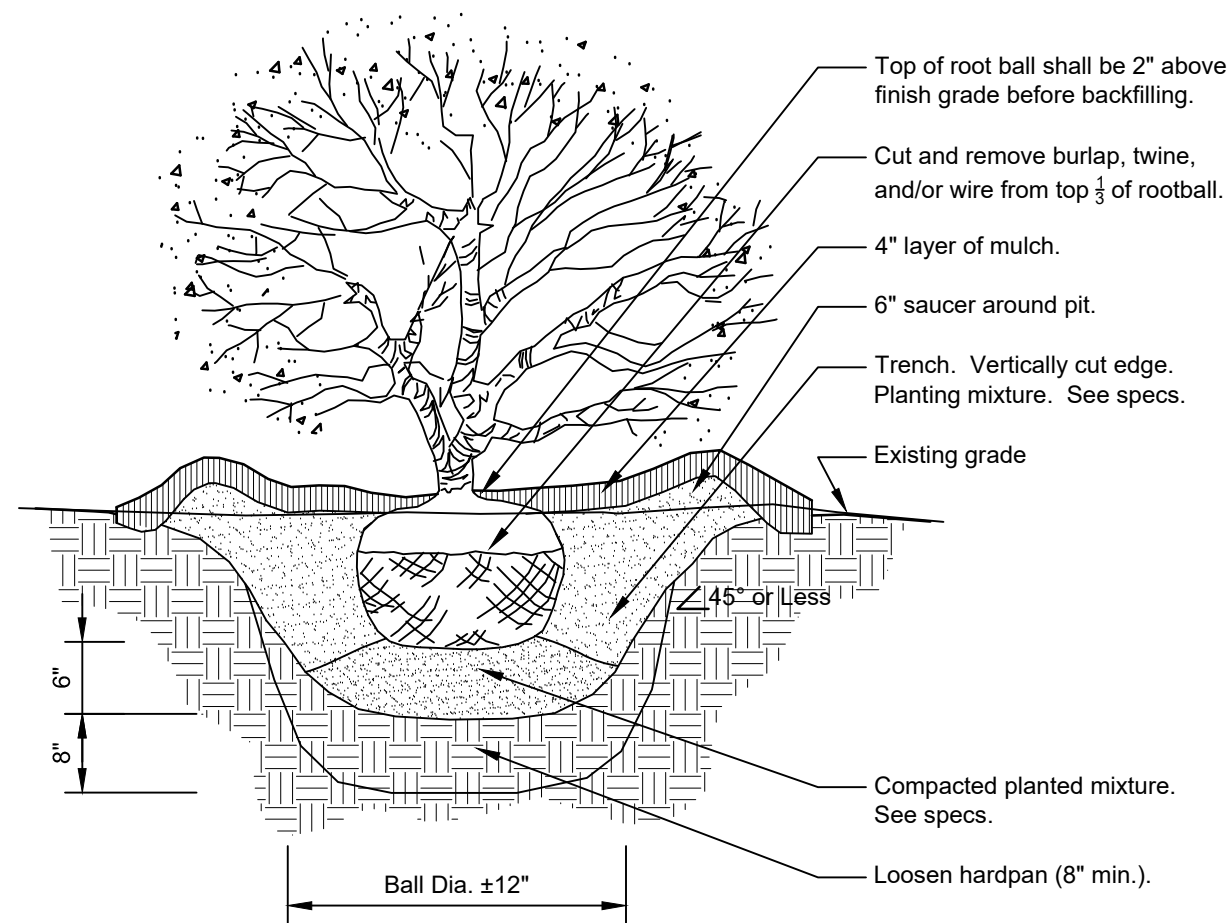

**3 SHRUB PLANTING DETAIL**  
3/4" = 1'-0" 329333.16-05

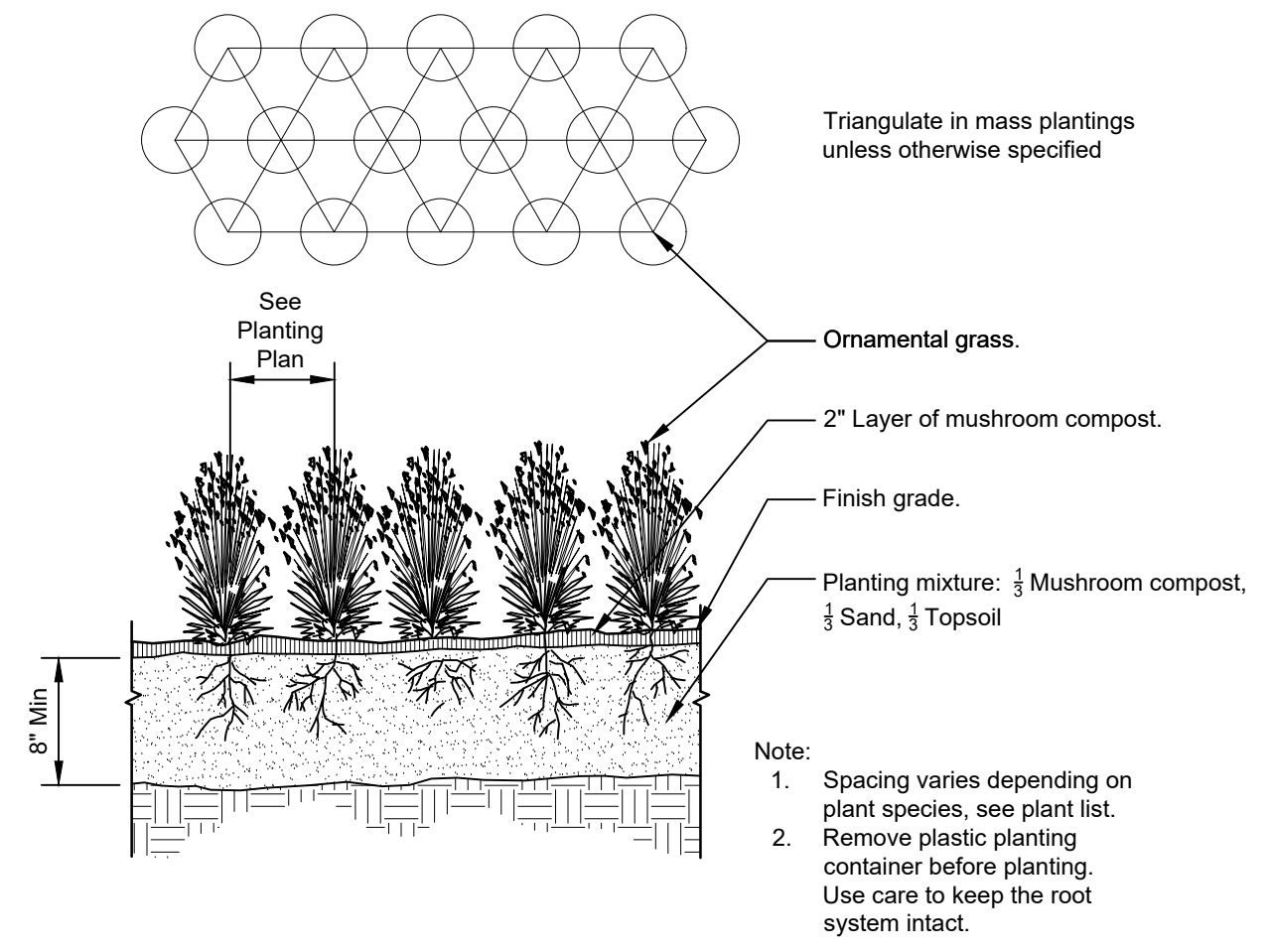

**4 ORNAMENTAL GRASS PLANTING**  
1" = 1'-0" 329313-01

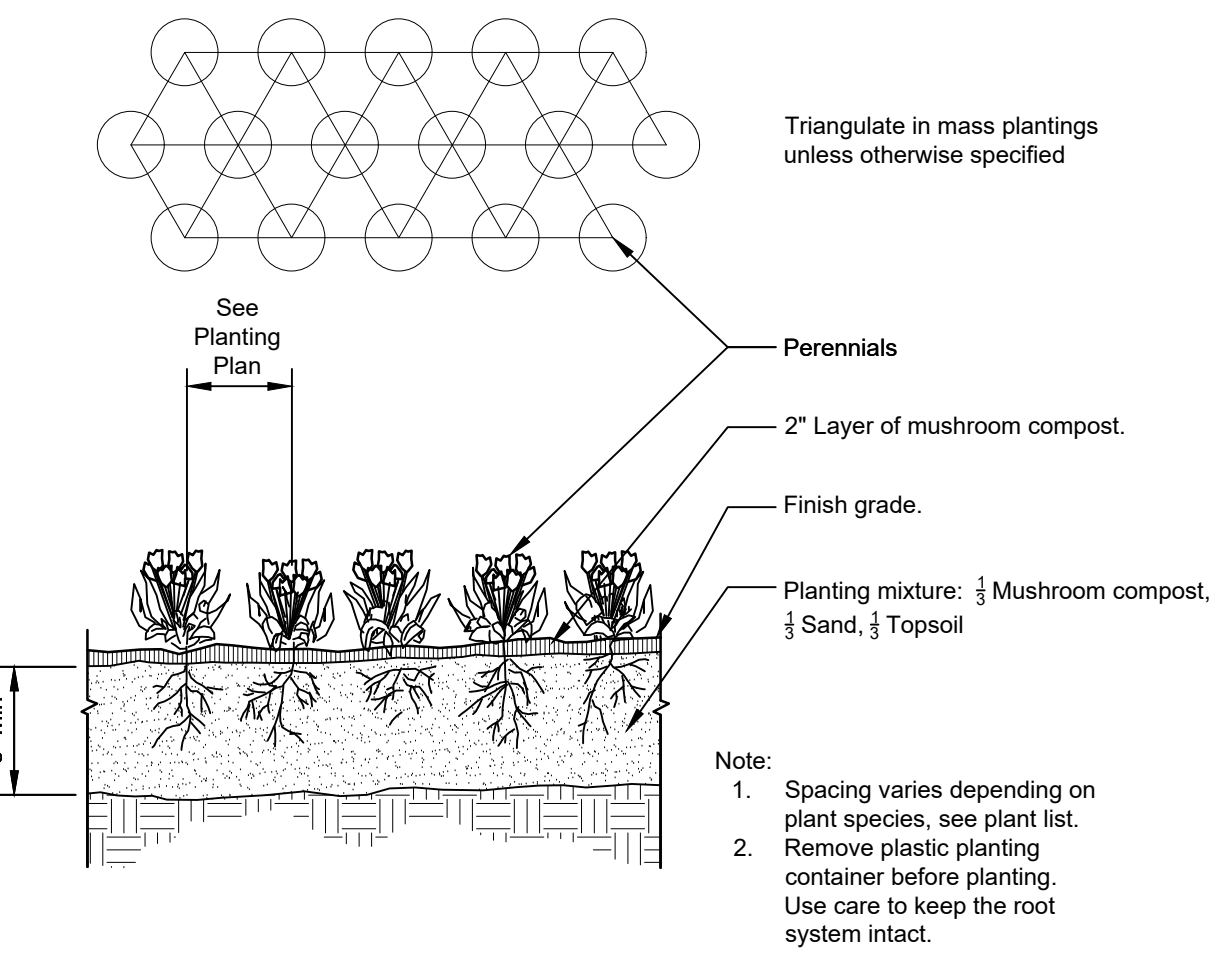

**5 PERENNIAL / ANNUAL PLANTING**  
1" = 1'-0" 329313-02

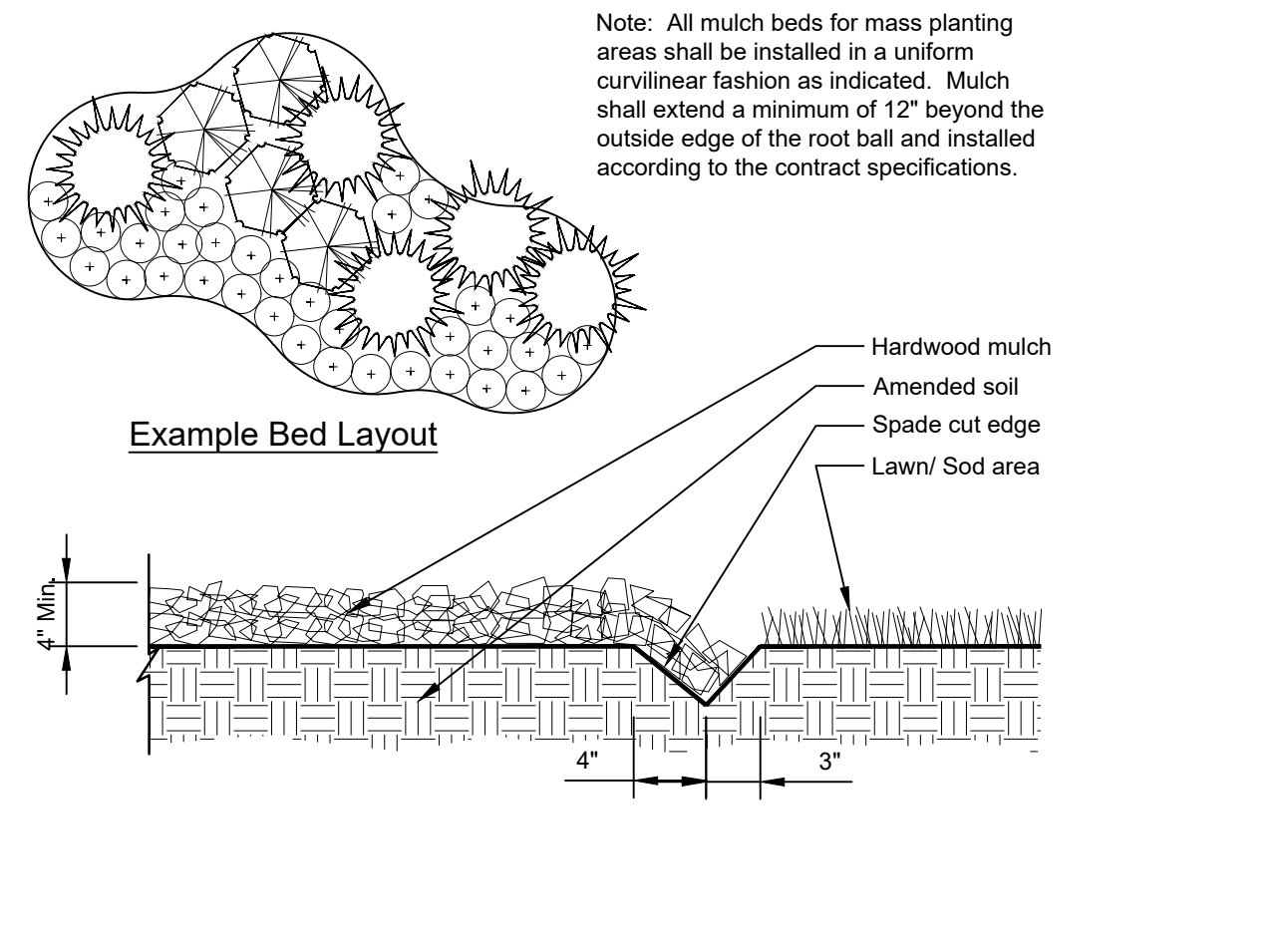

**6 CONTINUOUS MULCH EDGING**  
1" = 1'-0" 329113.26-01

**Planting Material Key**

**Landscape Data Table: Planting Material Key**  
Note: Symbols are blackline for proposed grayscale for existing

Canopy Trees (minimum size 2.5 caliper) Count:	28
Evergreen Trees (minimum size 6 feet) Count:	20
Understory Trees (minimum size 2.5 caliper or 8 feet if multi-stemmed) Count:	14
Evergreen Shrubs (minimum of 18 inches) Count:	209
Deciduous Shrubs (minimum of 18 inches) Count:	229
Ornamental Grasses Count:	112
Perennials Count:	155
Annuals Count:	0
Groundcover Square Footage:	456
Turf (Seeded) Square Footage:	42,795
Turf (Sod) Square Footage:	0
Native Prairie Planting Square Footage:	0
Native Wetland Planting Square Footage:	989

**PLANT SCHEDULE**

DECIDUOUS TREES	QTY	BOTANICAL NAME	COMMON NAME	SIZE	CONTAINER
ACE A12	9	Acer x freemanii 'Jeffersred'	Autumn Blaze Maple	2.5" Cal.	B&B
GLE SH2	9	Gleditsia triacanthos inermis 'Shademaster' TM	Shademaster Locust	2.5" Cal.	B&B
QUE RUB	4	Quercus rubra	Red Oak	2.5" Cal.	B&B
TIL COR	6	Tilia cordata	Littleleaf Linden	2.5" Cal.	B&B

EVERGREEN TREES	QTY	BOTANICAL NAME	COMMON NAME	SIZE	CONTAINER
PIC ABI	6	Picea abies	Norway Spruce	6' Ht.	B&B
PIC DEN	5	Picea glauca 'Densata'	Black Hills Spruce	6' Ht.	B&B
PIC CO2	4	Picea pungens	Colorado Spruce	6' Ht.	B&B
PIN STR	5	Pinus strobus	White Pine	6' Ht.	B&B

ORNAMENTAL TREES	QTY	BOTANICAL NAME	COMMON NAME	SIZE	CONTAINER
CRA VIR	4	Crataegus viridis 'Winter King'	'Winter King' Hawthorn	8' Ht.	B&B
SYR IVO	10	Syringa reticulata 'Ivory Silk'	Ivory Silk Japanese Tree Lilac	8' Ht.	B&B

DECIDUOUS SHRUBS	QTY	BOTANICAL NAME	COMMON NAME	SIZE	CONTAINER
CLE SIX	2	Clethra alnifolia 'Sixteen Candles'	Summersweet Clethra	5 gal.	Pot
COR GR2	10	Cornus racemosa	Gray Dogwood	5 gal.	Pot
EUO COM	21	Euonymus alatus 'Compactus'	Compact Burning Bush	5 gal.	Pot
HYD LIM	11	Hydrangea paniculata 'Limelight' TM	Limelight Hydrangea	5 gal.	Pot
HYD L58	42	Hydrangea paniculata 'Little Lime'	Little Lime Hydrangea	5 gal.	Pot
OAK GA3	2	Hydrangea quercifolia 'Gatsby Gal'	Oakleaf Hydrangea	5 gal.	Pot
RHU GRO	55	Rhus aromatica 'Gro-Low'	Gro-Low Fragrant Sumac	5 gal.	Pot
ROS FL3	4	Rosa x 'Flower Carpet Coral'	Rose	5 gal.	Pot
ROS RAD	5	Rosa x 'Knockout' TM	Rose	5 gal.	Pot
ROS 383	15	Rosa x 'Rotes meer'	Pavement Purple	5 gal.	Pot
SOR SEM	23	Sorbaria sorbifolia 'Sem'	Sem Ash Leaf Spirea	5 gal.	Pot
SYR MEY	16	Syringa meyeri 'Palbin'	Dwarf Korean Lilac	5 gal.	Pot
VIB DEN	23	Viburnum dentatum 'Arrowwood'	Arrowwood Viburnum	5 gal.	Pot

EVERGREEN SHRUBS	QTY	BOTANICAL NAME	COMMON NAME	SIZE	CONTAINER
JUN PFI	81	Juniperus chinensis 'Kallays Compact'	Kallay Compact Pfitzer Juniper	5 gal.	Pot
JUN FOR	47	Juniperus chinensis 'Sea Green'	Sea Green Juniper	5 gal.	Pot
TAX DEN	81	Taxus x media 'Densiformis'	Dense Yew	5 gal.	Pot

ORNAMENTAL GRASSES	QTY	BOTANICAL NAME	COMMON NAME	SIZE	CONTAINER
CAL KAR	56	Calamagrostis x acutiflora 'Karl Foerster'	Feather Reed Grass	1 gal.	Pot
CHA LAT	5	Chasmanthium latifolium	Wood Oats	1 gal.	Pot
MIS GRA	13	Miscanthus sinensis 'Gracillimus'	Maiden Grass	1 gal.	Pot
MIS PUR	7	Miscanthus sinensis 'Purpurescens'	Flame Grass	1 gal.	Pot
PAN HAN	7	Panicum virgatum 'Hanes Hears'	Red Switch Grass	1 gal.	Pot
PEN HAM	17	Pennisetum alopecuroides 'Hamel'	Hamel Dwarf Fountain Grass	1 gal.	Pot
SCH CAR	7	Schizachyrium scoparium 'Carousel'	Carousel Little Bluestem	1 gal.	Pot

  

GROUND COVERS	QTY	BOTANICAL NAME	COMMON NAME	SIZE	CONTAINER	SPACING
GER ROZ	36	Geranium x 'Rozanne' TM	Hybrid Cranesbill	1 gal.	Pot	24" o.c.
HEM ORO	95	Hemerocallis x 'Stella de Oro'	Stella de Oro Daylily	1 gal.	Pot	18" o.c.
NEP WA2	24	Nepeta mussinii 'Walker's Low'	Walker's Low Catmint	1 gal.	Pot	24" o.c.

**CTEs Provided Table**

**Landscape Data Table: CTEs Provided**

	CTE Value	Count Provided	Total CTEs Provided
Canopy Trees	1	28	28
Evergreen Trees	1/2	20	6.7
Understory Trees	1/3	14	4.7
Deciduous Shrubs	1/20	229	11.5
Evergreen Shrubs	1/20	209	10.5
<b>Total:</b>		<b>408</b>	<b>61.4</b>

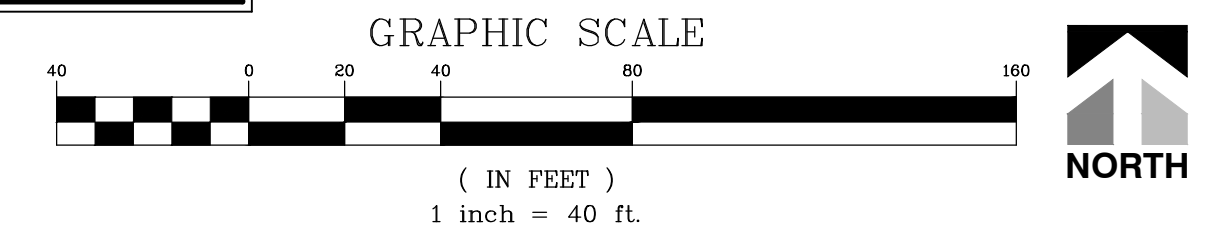
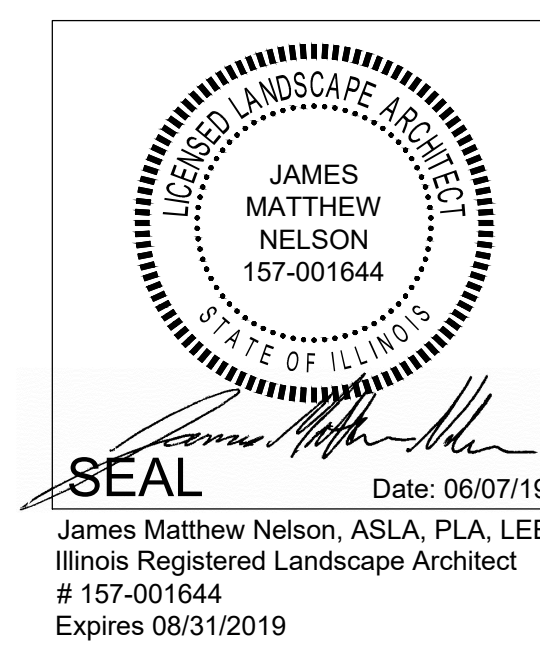

DRAWN BY: [ ]  
 REVISIONS: [ ]  
 DATE: [ ]

**Manhard CONSULTING LTD.**  
 800 Westchester Parkway, Suite 200, Naperville, IL 60563  
 Civil Engineers • Surveyors • Water Resources Engineers • Water & Wastewater Engineers  
 Construction Managers • Environmental Scientists • Landscape Architects • Planners

**SALVATION ARMY COMMUNITY CENTER**  
**CITY OF AURORA, ILLINOIS**  
**LANDSCAPE DETAILS & SUMMARY**

PROJ. MGR.: DBM  
 PROJ. ASSOC.: DEM3  
 DRAWN BY: MN  
 DATE: 01-25-19  
 SCALE: AS NOTED

SHEET  
**L3 OF L4**  
 WHA.AU101

June 7, 2019 - 10:00 Draw Name: P:\Whas01\Eng\Landscap\Final Drawings\Plan Set\01-Final LA Plan-CITY STANDARD-PRINT VERSION.dwg, Uploaded By: M.Nelson

