

FIRE ACCESS PLAN

FOR
WENDY'S - (SAVANNAH CROSSINGS - LOT 4)
 2962 KIRK ROAD
 AURORA, IL 60502

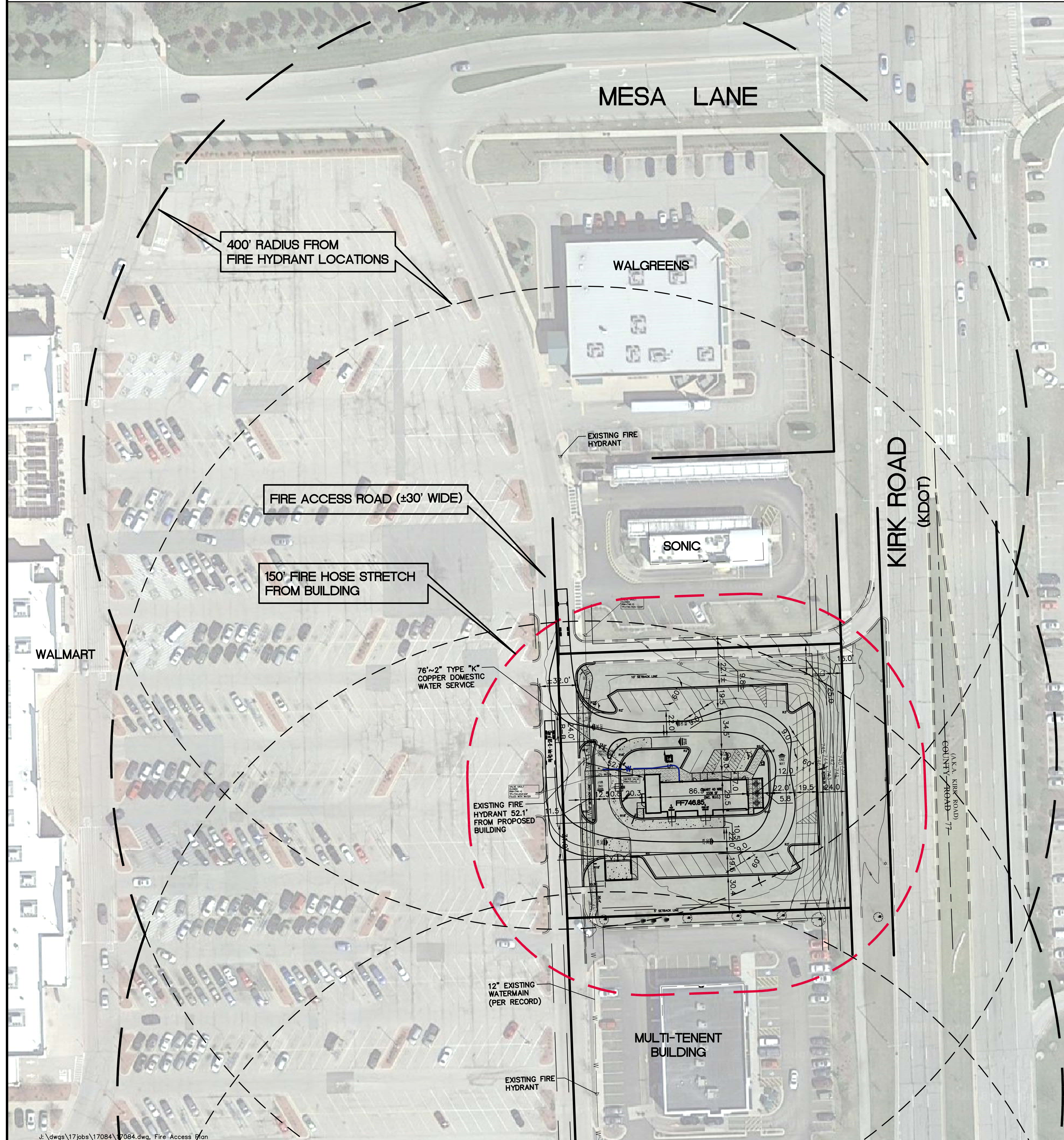

EXISTING	DESCRIPTION	PROPOSED
	CATCH BASIN	
	INLET	
	STORM MANHOLE	
	SANITARY MANHOLE	
	VALVE VAULT	
	FIRE HYDRANT	
	FLAMED DND SECTION	
	ELECTRICAL POWER POLE	
	OVERHEAD TRAFFIC SIGNAL	
	TRAFFIC SIGNAL MANHOLE	
	OVERHEAD ELECTRIC WIRES	
	TELEPHONE POLES	
	TELEPHONE PEDESTAL	
	CABLE TELEVISION PEDESTAL	
	CONCRETE HEALTH EDUCTOR MANHOLE	
	LIGHT POLE	
	SIGN	
	ROLLING POLE	
	GAS METER	
	ELECTRIC METER	
	TELEPHONE MARKER	
	WATER MARK	
	GAS MARK	
	ELECTRIC LINE	
	TELEPHONE LINE	
	CABLE TV LINE	
	STORM SEWER	
	SANITARY SEWER	
	GUY POLE	
	CONIFEROUS TREE W/DIAMETER	
	DECIDUOUS TREE W/DIAMETER	
	WOOD FENCE	
	CHAIN LINK FENCE	
	METAL GUARDRAIL	
	CONCRETE SURFACE	
	CONTOUR LINE	
	FINISHED FLOOR ELEVATION	
	PAVEMENT ELEVATION	
	MATCH EXISTING ELEVATION	
	GROUND ELEVATION	
	TOP OF WALL ELEVATION	
	TOP OF RETAINING WALL ELEVATION	
	FLOOR LINE ELEVATION	
	TOP OF CURB ELEVATION	
	SPOT ELEVATION	
	PROPOSED AREA SLOPE DIRECTION	
	PAVEMENT SLOPE DIRECTION	
	INLET PROTECTION	
	INLET BASKET FILTER	

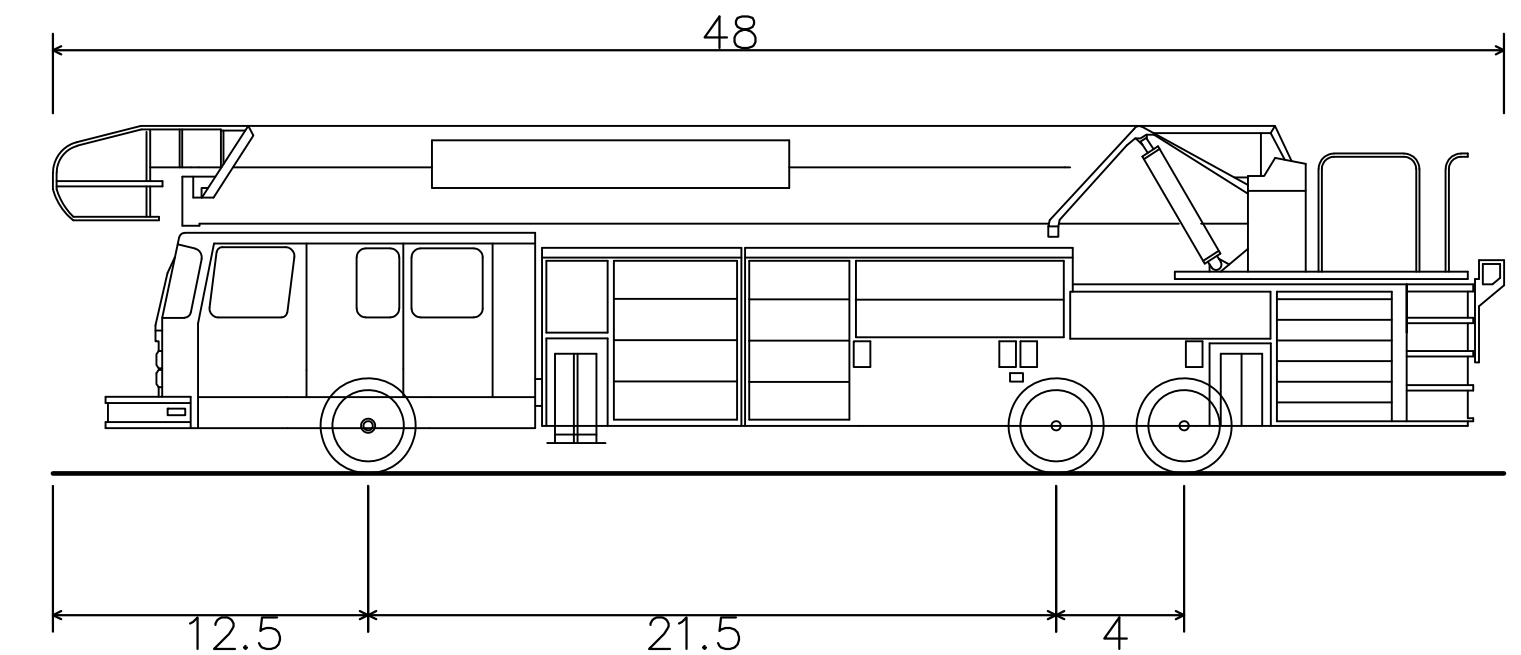

AASHTO (BUS-45) Inner City Bus
 Overall Length 48.000ft
 Overall Width 8.500ft
 Overall Body Height 10.859ft
 Min Body Ground Clearance 0.950ft
 Track Width 8.500ft
 Lock-to-lock time 5.00s
 Max Steering Angle (Virtual) 34.00°

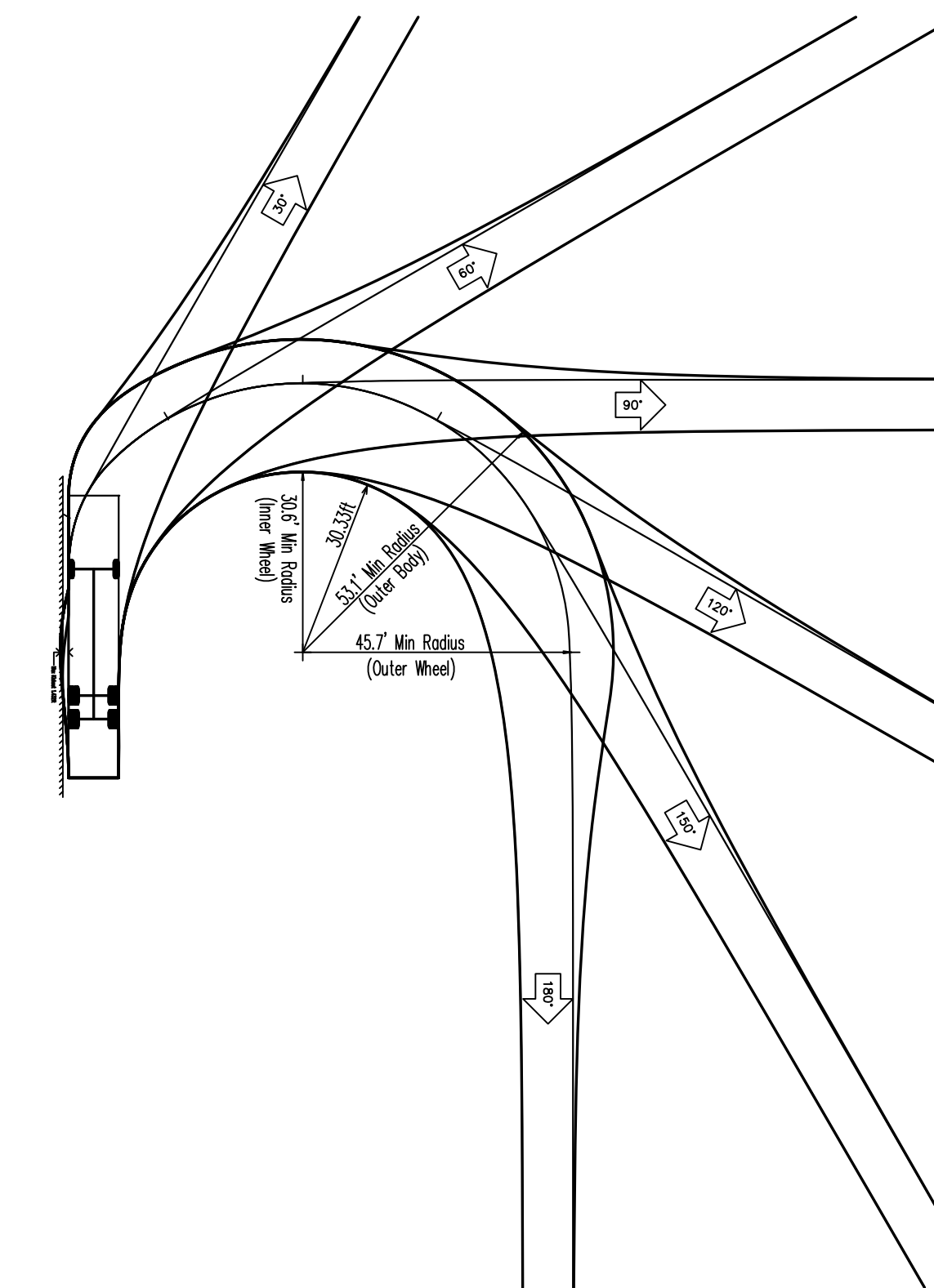

Fire Access Plan Data Table		
Description	Value	Unit
a) Building Height	24.00	feet
b) Building Square Footage (typical)	2,336	square feet
c) Building fire suppression information including any proposed use of sprinkler systems, fire alarm systems, whether fire extinguishers are needed: Fire alarm system. There is no proposed fire sprinkler system proposed.		
d) General description of business to be conducted within each building including: will there be rack storage in the building, will there be storage of combustible materials over twelve feet in height, clearance of sprinkler heads and stored materials (18 inch minimum): Restaurant with drive-thru, combustible storage items will not be stacked greater 12' height.		

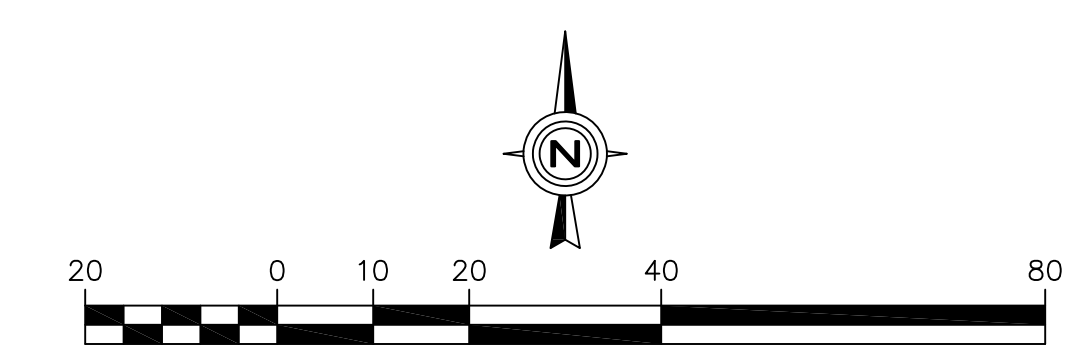

FIRE ACCESS PLAN

DATE	3/12/18
REVISIONS	PER CITY COMMENTS
NO.	1
Prepared For:	The Wendy's Company 1220 East Liff Avenue, Suite 208 Aurora, CO 80014 WENDY'S - AURORA, IL 2962 Kirk Road Aurora, Illinois
Prepared By:	Wendy's
 2631 Ginger Woods Parkway, Suite 100, Aurora, IL 60502 phone 630-375-1800 fax 630-238-9800 www.watermark-engineering.com	
CHECKED BY: B. PERRY	DESIGN BY: K. PRICE
DRAWN BY: K. PRICE	DATE: JANUARY 30, 2018
SCALE: 1" = 20'	PROJECT NO.: 17-084
2-6	
FIRE ACCESS PLAN	