

FIRE ACCESS PLAN

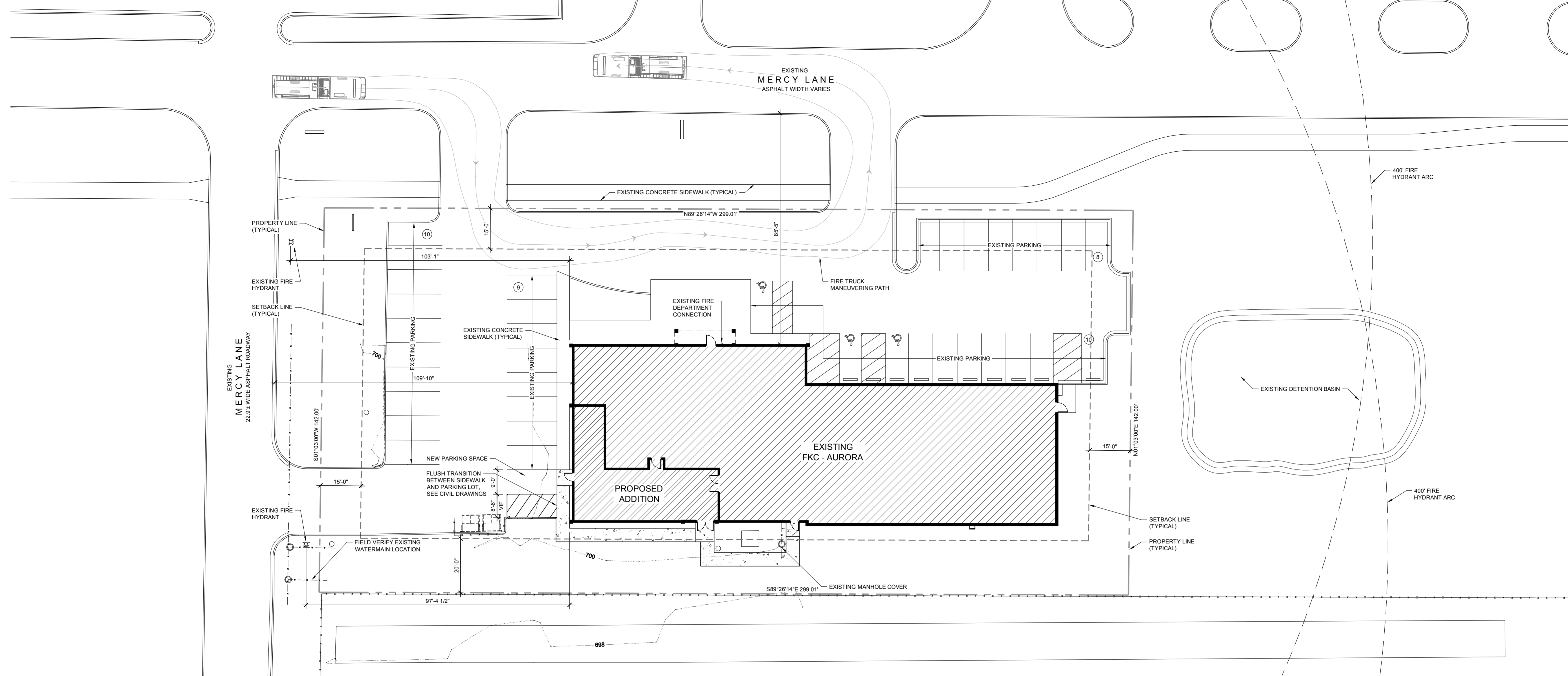

Fire Access Plan Data Table		
Description	Value	Unit
a) Building Height	17.80	feet
b) Building Square Footage (typical)	10,259	square feet
c) Building fire suppression information including any proposed use of sprinkler systems, fire alarm systems, whether fire extinguishers are needed.		
Fire Extinguishers, locate per code		
Smoke Detection and Fire Alarm system, design/buildwork existing per code (NFPA 72)		
Sprinkler System, design/buildwork existing per code (NFPA 13)		
d) General description of business to be conducted within each building including will there be rack storage in the building, will there be storage of combustible materials over twelve feet in height, clearance of sprinkler heads and stored materials (18 inch minimum).		
Existing Outpatient Kidney Dialysis Clinic, Mixed Used, Nonseparated Occupancies, Business Group B, Ambulatory Care Facility, Storage Group S-1. The addition is for Offices, Toilets, Staff Lounge and Locker room.		

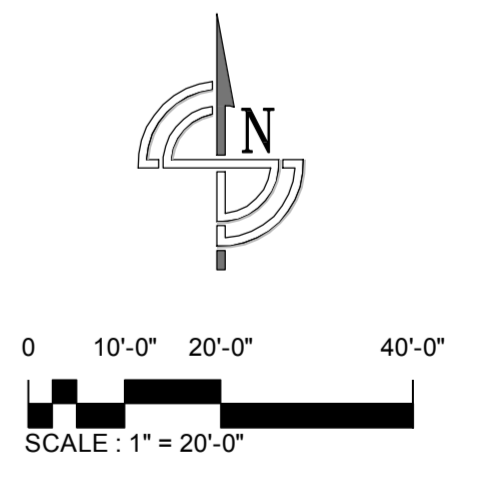

Prepared By:
ARCHITECT

Christopher D. Kidd, AIA, ALA, RIBA
Illinois License # 001-016182
Expires : November 30, 2018



#	DATE	REVISION DESCRIPTION

CKA
Christopher Kidd and Associates, LLC
 ARCHITECTS ENGINEERS PLANNERS
 455 Mercy Lane, Aurora, Illinois 60506
 P: 630.261.6000 F: 630.261.6001 @ckadetroit.com

CKA Registration # 184-003003

Fire Access Plan for:
FKC - Aurora (Shell)
 455 Mercy Lane
 Aurora, Illinois 60506

These drawings, as instruments of service, remain the property of the Architect or Engineer. Any changes, publication, or use of any kind is prohibited unless expressly authorized by said party.

Copyright 2018
 Drafted By: JES
 Checked By: EAH
 Date Drafted: 09/10/2018
 Project #: 17159-02

A101
 FIRE ACCESS PLAN