

Permit Type: **Highway Permit**

Expiration Date: **10/10/19**

Division of Transportation

County of DuPage, Illinois



Permission is hereby given per the DuPage County Highway Rights-of-Way Permit and Fee Ordinance ODT-0001A-06, to perform work per the approved drawings, contract specifications and attachments to this Permit, as noted herein:

Permit Purpose: SERVICE CONNECTION; PLACE (4) HANDHOLES, 1000LF OF CONDUIT UNDERGROUND BY DIRECTIONAL BORE AND OPEN TRENCH DAILY LANE CLOSURES, GRADING AND RESTORATION. (REMOVAL OF ROADWAY PAVEMENT, SIDEWALK OR CURB AND GUTTER IS STRICTLY PROHIBITED WITHOUT PRIOR APPROVAL.)

County HWY # and Route: 14 Eola Road

Location: DIEHL RD.

Utility WO #: 1826-001

Applicant Name: AURORA CITY OF

Contact Person: MIKE BAKER

Contractor: UTILITY DYNAMICS CORP

IMPORTANT

This Permit is effective only insofar as the DuPage County Division of Transportation has jurisdiction and does not release the Permittee from complying with existing Local, County, Township, State, and/or Federal Statutes.

Failure to comply with any of the conditions of the Application, Permit, and/or the attachments made thereto shall cause said Permit, under the direction of the County Engineer, or the duly authorized assign, to become NULL and VOID and may result in the FOREITURE of the Highway Bond Posted.

For County Engineer

10/10/18

Date Issued

No. W180368

For all Inspections call 630/407-6900, (Mon - Fri 8 am - 4:30 pm., excluding holidays).
All Inspections require minimum 48 hours Notice (Excluding weekends & holidays).



DIVISION OF TRANSPORTATION

(630) 407-6900

FACSIMILE (630) 407-6901

Permit Number: **W180368**

Page 1 of 3

ATTACHMENTS TO PERMIT

1. Equipment and materials shall NOT be stored within the County's rights-of-way.
2. Existing sidewalk, curb/gutter and pavement disturbed or damaged due to the permitted work shall be replaced in kind as directed by the County Engineer, the duly authorized assign.
3. Pavement, curb/gutter and storm structures shall be maintained free of mud/debris at all times.
4. The Permittee, it's agent, successor, assign, and/or contractor shall furnish all material, labor, and pay all costs required to restore said County rights-of-way to a condition similar or equal to the conditions that existed before the commencement of the described work. It shall be the responsibility of the Permittee to properly grade, install a min. of 6" topsoil and seed (with erosion control blanket or hydro seeding) or sod (salt tolerant and staked in place) any portions of the rights-of-way disturbed during the described work.
5. Construction and erosion control measures shall comply with the minimum requirements of the "DuPage County Stormwater and Floodplain Ordinance" and any supplemental specifications made thereto.
6. The permitted improvements shall be located and constructed per the DuPage County standards and to the satisfaction of DuPage County Division of Transportation. The material used and method of construction shall comply with and conform to IDOT's "Standard Specifications for Road and Bridge Construction" (latest edition) and "Supplemental Specifications and Recurring Special Provisions" (latest edition).
7. The Permittee, it's agent, successor, assign, and/or contractor agrees to provide traffic control with advance warning signs, an arrow board and barricades conforming to the FHWA's "Manual on Uniform Traffic Control Devices" and IDOT's Highway Standards, "Standard Specifications for Road and Bridge Construction" (latest edition) and "Supplemental Specifications and Recurring Special Provisions" (latest edition) or as specified. The Permittee, it's agent, successor, assign, and/or contractor agrees to provide controlled flow of traffic at all times by approved detour or flag persons (with applicable warning signage) to minimize the inconvenience to traffic. Daily lane closures of County roadways are permitted Monday through Friday between 9:00 a.m. and 4:00 p.m. ONLY.
8. The Permittee, it's agent, successor, assign, and/or contractor assumes all risk and liability and agrees to defend, indemnify, and hold harmless the County of DuPage, its successors, assigns or employees, for any injury incurred to persons and/or damage to property in conjunction with and/or due to the permitted work/event.
9. The Permittee, it's agent, successor, assign, and/or contractor shall not trim, remove, or in any way disturb trees or shrubs along and/or within the highway or trail system rights-of-way without prior written approval by or from the DuPage County Division of Transportation.
10. The Permittee, it's agent, successor, assign, and/or contractor shall properly maintain all existing regulatory, warning and/or informational traffic control signage and/or devices along or within the DuPage County rights-of-way within the limits of the work covered under the permit and for the duration of said event permitted work/event. The DuPage County Division of Transportation shall be notified prior to construction and/or potential conflicts with existing signage due to the permitted construction. The Permittee, it's agent, successor, assign, and/or contractor furthermore shall reimburse the DuPage County Highway Maintenance Dept. for any relocation and/or replacement of, due to conflicts with and/or damage to, said signage, posts and/or equipment.
11. DuPage County reserves the right to make changes, additions and/or repairs to and relocations of, within its statutory limits, the facilities and/or their appurtenances constructed under this permit within the County rights-of-way as may at any time be considered necessary to permit the relocation, reconstruction, widening and/or maintaining of the highway, trail and/or path and/or to provide proper protection to life and property on or adjacent to the County rights-of-way. However, in the event this permit is granted to construct, locate, operate and/or maintain facilities on and/or within the County rights-of-way, the Permittee, it's agent, successor, assign, and/or contractor upon written notification from the County Engineer to the Permittee, shall perform such alterations or change of location of the facilities, solely at the permittee's cost as far as statutory authority dictates, without expense to DuPage County. Should the Permittee fail to make satisfactory arrangements to comply with said request within a reasonable time, DuPage County reserves the right to make such alterations to, change of location of and/or remove the facilities, and the Permittee, furthermore, shall pay for any costs incurred by DuPage County for said work.
12. The Permittee, it's agent, successor, assign, and/or contractor shall notify the DuPage County Division of Transportation a minimum of 48 hours prior to the start of construction, to arrange for any inspections and at the completion of the described work according to County procedures and/or policy.
13. The Permittee, it's agent, successor, assign and/or contractor shall contact J.U.L.I.E. (800)892-0123 for utility locations including storm sewer, traffic signals, conduit and related equipment, a minimum of 48 hours prior to the start of construction.
14. The Permittee, it's agent, successor, assign, and/or contractor agrees to reimburse the County for any costs incurred by DuPage County for any repair, relocation and/or adjustment to the traffic signals or related equipment that is in conflict with or is damaged due to the permitted work. All construction shall be coordinated with the County's Signal Coordinator. Contact the Division of Transportation with any questions pertaining to traffic signal related equipment at (630) 407-6900 a minimum of 48 hours prior to the start of construction to coordinate inspections.
15. The Permittee, it's agent, successor, assign, and/or contractor is required to contact the local agencies (including, but not limited to, municipal fire and police departments and the DuPage County Sheriff's Department) notifying them of all roadway construction or special event and traffic restrictions and/or temporary detours a minimum of 72 hours prior to the start of said construction/event.

ATTACHMENTS TO PERMIT

Trench backfill for any excavation(s) shall be installed within the County rights-of-way per the attached County standard.

Open cutting of the roadway pavement is NOT permitted without the express written permission of the County Engineer or the duly authorized assign.

LANE CLOSURES ARE NOT PERMITTED ON COUNTY ROADWAYS DURING SNOWFALL OR WITHIN 2 HOURS PRIOR TO PREDICTED SNOWFALL OR PRECIPITATION CONDITIONS BETWEEN NOVEMBER 15 AND APRIL 15 FOR MAINTENANCE OF THE ROADWAY PAVEMENT BY COUNTY HIGHWAY MAINTENANCE DEPARTMENT STAFF AND EQUIPMENT.

The Permittee, it's agent, successor, assign, and/or contractor agrees to assume sole responsibility for the maintenance of and liability for the permitted installation/construction.

The Permittee, it's agent, successor, assign, and/or contractor agrees to adjust, modify, relocate or remove the permitted items within sixty- (60) days of receipt of written notification as directed by the County to the Permittee.

**This permit is perpetual and thus the conditions stated herein and attached to the permit are without expiration, regardless of release of the bond posted and/or permit and/or acceptance of the construction/installation as permitted.*

ROADWAY PAVEMENT, CURB/GUTTER, SIDEWALK/PATH AND/OR STORM STRUCTURES SHALL BE MAINTAINED FREE OF MUD/DEBRIS AT ALL TIMES DURING THE PERMITTED WORK.

ATTACHMENTS TO PERMIT

DUPAGE COUNTY DIVISION OF TRANSPORTATION
TRENCH BACKFILL STANDARD IN NON-PAVED AREAS
(PARKWAYS, ETC.)

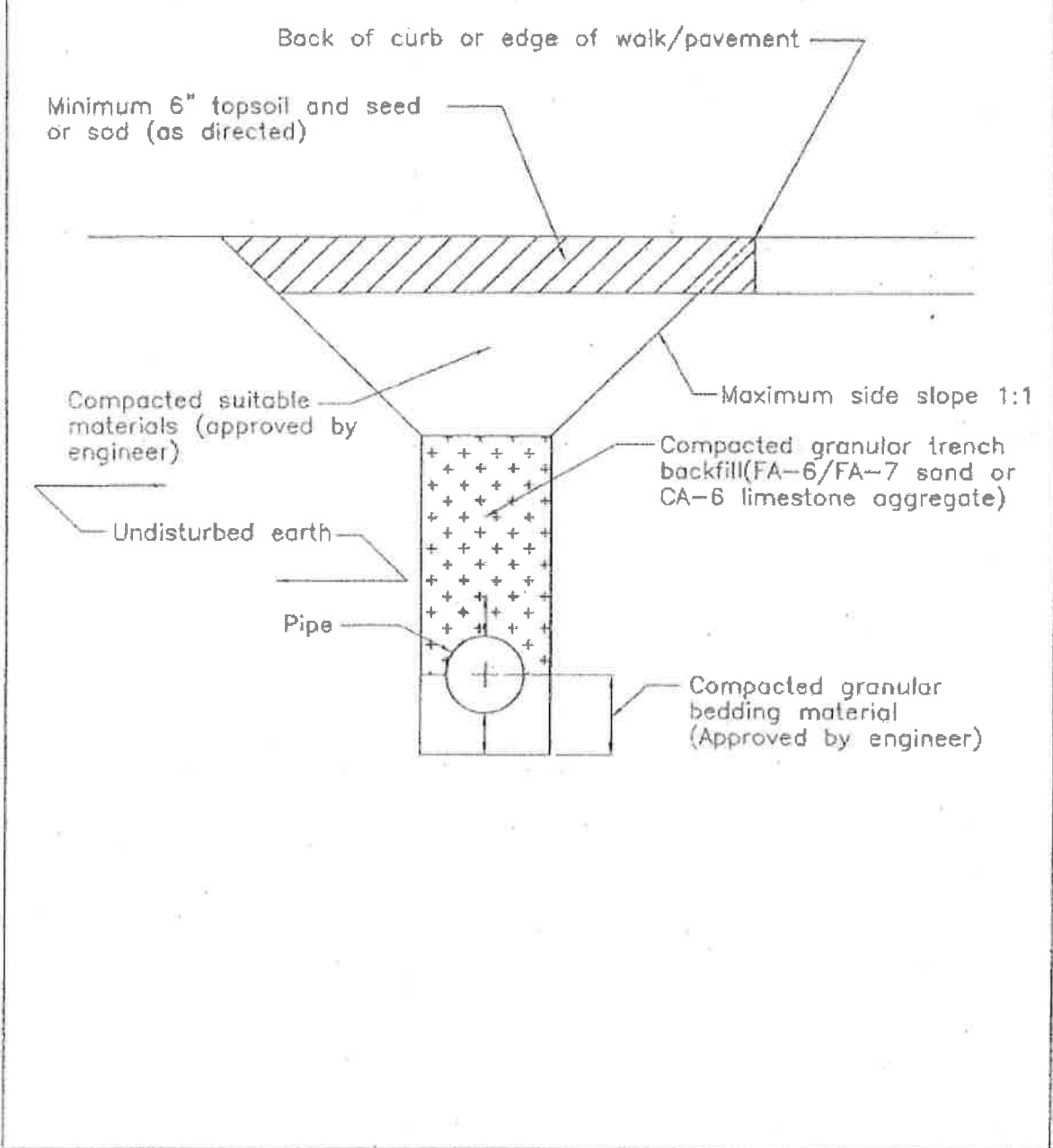

CITY OF AURORA

OUTSIDE PLANT FIBER OPTIC BUILD

A P 180696

180368
 -
 Notify D.O.T.

W DIEHL RD & N EOLA RD (CO RD 14)
 AURORA, IL 60502

SEC 5 & 8, T38N-R9E
 AURORA, DUPAGE COUNTY, ILLINOIS

CONTACT INFORMATION:

ENGINEER:

CCSI
 2649 GARDNER RD
 BROADVIEW, IL 60155
 OFFICE 630.572.9999 • FAX 630.572.9998

OWNER:

CITY OF AURORA
 44 E DOWNER PLACE
 AURORA, IL 60507
 OFFICE 630.256.3200 • FAX 630.256.3229

CONTRACTOR:

NTI NATIONAL TECHNOLOGIES
 1350 W WASHINGTON ST
 WEST CHICAGO, IL 60185
 OFFICE: 630.851.7751

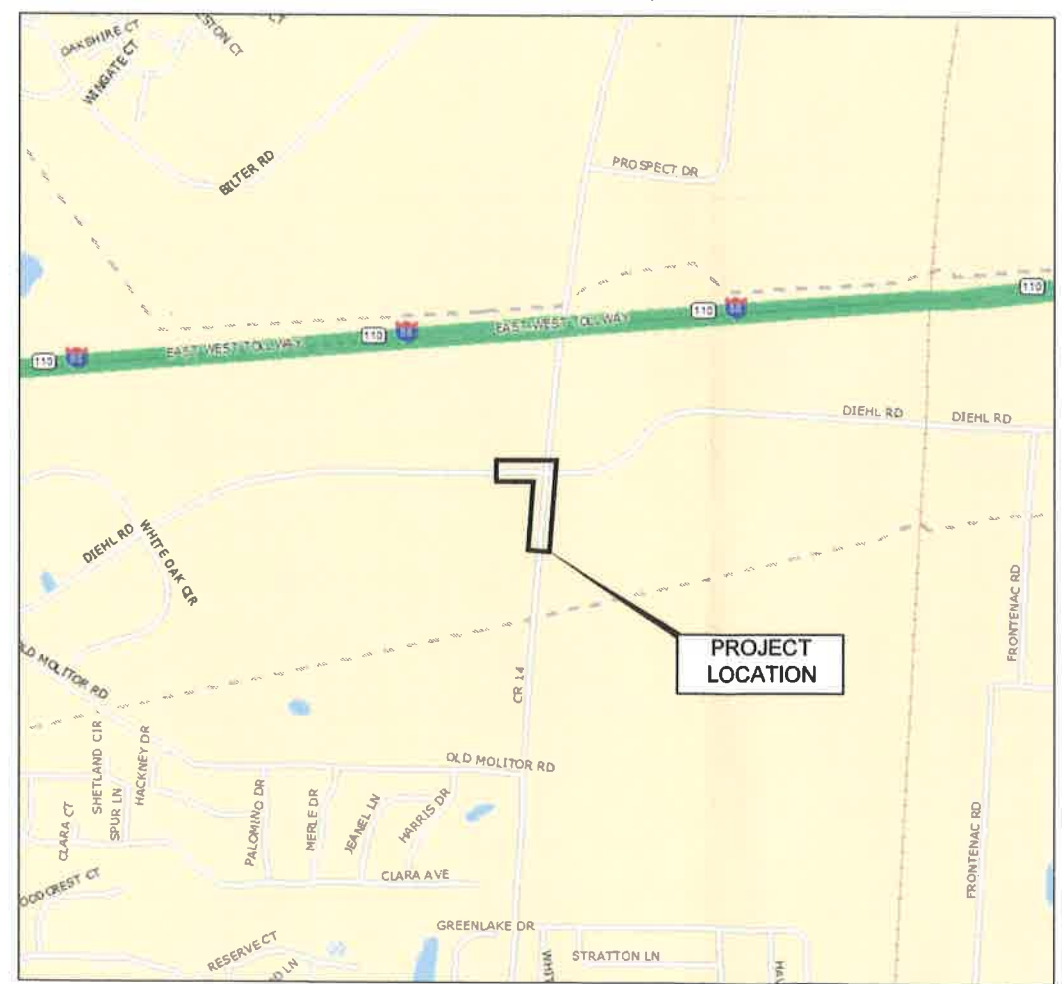

LOCATION MAP
 SCALE: NOT TO SCALE



PROJECT NUMBERS:

PROJECT NO: 1826-001

PROJECT DESCRIPTION:

INSTALLATION OF (6)-2" SCHEDULE 40 PVC AND CONDUIT OR (6)-2" SDR-11 HDPE CONDUIT @ A MINIMUM DEPTH DETERMINED IN THE FIELD BY TRENCH / OPEN CUT OR DIRECTIONAL BORE;

CONSTRUCTION STARTS AT EXISTING MANHOLE AT 3.4' SSL (DIEHL) & 731.2' WWL (EOLA), CONTINUES EAST APPROX. 705', THEN SOUTH APPROX. 520', THEN EAST APPROX. 83', THEN NORTH APPROX. 489' AND PLACE HANDHOLE AT 68.7' SSL (DIEHL) & 2.2' NWSL (EOLA).

DRAWING INDEX

SHEET	TITLE
1	COVER
2	LEGEND
3	NOTES AND ABBREVIATIONS
4	TYPICALS
5	BILL OF MATERIALS
6	SITE PLAN
7-9	OSP PLAN(S)



JULIE
 1-800-892-0123
 REQUIRES 48 HRS.
 NOTICE BEFORE YOU EXCAVATE



ENGINEER'S CERTIFICATION:
 I HEREBY CERTIFY THAT THESE PLANS WERE PREPARED UNDER MY DIRECT SUPERVISION, AND TO THE BEST OF MY KNOWLEDGE CONFORM TO ALL LOCAL ORDINANCES AND ORDINANCES. ANY REPRODUCTIONS, CHANGES OR ASSIGNMENTS WITH OUT MY WRITTEN CONSENT ARE PROHIBITED.

Anthony Antonio
 ANTHONY G. ANTONIO
 PROFESSIONAL ENGINEER
 P.E. 002.050569 EXP. 11-20-2019

DRAWING SCALE:
 AS NOTED

ENGINEER:

CCSI
 2649 GARDNER RD
 BROADVIEW, IL 60155
 OFFICE 630.572.9999
 FAX 630.572.9998

OWNER:

CITY OF AURORA
 44 E DOWNER PLACE
 AURORA, IL 60507
 OFFICE: 630.256.3200
 FAX: 630.256.3229

CONTRACTOR:

NTI NATIONAL TECHNOLOGIES
 1350 W WASHINGTON ST
 WEST CHICAGO, IL 60185
 OFFICE: 630.851.7751

TITLE:

OUTSIDE PLANT FIBER OPTIC BUILD
 W DIEHL RD & N EOLA RD (CO RD 14)
 AURORA, IL 60502

PROJECT NUMBER: 1826-001

DRAWN BY: JCS DATE DRAWN: 04/23/18

NO.	DATE	DESCRIPTION
4	08/09/18	REVISED PER CLIENT
3	08/03/18	ADDED DIMENSIONS
2	06/07/18	CALLOUT REVISION
1	06/07/18	ROUTE REVISION
	04/23/18	PERMIT

REVISIONS

SHEET NUMBER

1

LEGEND

UTILITIES:

UTILITY MARKER	
STORM INLET	
CULVERT	
CATV MANHOLE	
STORM MANHOLE	
SANITARY MANHOLE	
CATCH BASIN	
GAS MANHOLE	
GAS VALVE	
WATER MANHOLE	
WATER VALVE	
FIRE HYDRANT	
ELECTRIC MANHOLE	
ELECTRIC EQUIPMENT BOX	
TRAFFIC CONTROL BOX/MANHOLE	
COMED MANHOLE	
COMED EQUIPMENT BOX	
STREET LIGHT	
TRAFFIC SIGNAL	
POWER POLE	
UTILITY POLE	
FOC MANHOLE	
UNIDENTIFIED MANHOLE	
RAILROAD SIGNAL	
CATV PED	
POWER PED	
FOC PED	
UNIDENTIFIED PED	
ELECTRICAL CABLE	
COMED	
GAS LINE	
GAS LINE 4"	
WATER LINE	
WATER 8"	
STORM SEWER	
STORM SEWER 8"	
SAN SEWER	
SAN SEWER 8"	

COMMUNICATIONS:

ATT MANHOLE/HANDHOLE		
COMCAST MANHOLE/HANDHOLE		
COMMUNICATION MH/HH		
FOC HANDHOLE		
KDL MANHOLE/HANDHOLE		
LEVEL 3 MANHOLE/HANDHOLE		
LIGHTTOWER MANHOLE/HANDHOLE		
MCI MANHOLE/HANDHOLE		
NEXTEL MANHOLE/HANDHOLE		
NEXTLINK MANHOLE/HANDHOLE		
RCN MANHOLE/HANDHOLE		
SBC MANHOLE/HANDHOLE		
SIDERA MANHOLE/HANDHOLE		
SPRINT MANHOLE/HANDHOLE		
SUNESYS MANHOLE/HANDHOLE		
VINAKOM MANHOLE/HANDHOLE		
VERIZON MANHOLE/HANDHOLE		
ZAYO MANHOLE/HANDHOLE		
ADELPHIA		
ATT		
COMCAST		
CROWN CASTLE		
FIBER OPTIC CABLE		
IBT		
KDL		
LEVEL 3		
LIGHTTOWER		
MCI		
NEXTEL		
NEXTLINK		
RCN		
SBC		
SIDERA		
SPRINT		
SUNESYS		
TELEPHONE		
UNICOM		
VERIZON		
VINAKOM		
WOW		
XO		
ZAYO		

PROPOSED:

BORE PIT	
MANHOLE	
QUAZITE BOX	
DIRECTIONAL BORE	
TRENCH	

GENERAL:

HANDICAP RAMP	
PARKING BOX	
SIGN	
TREE	
BACK OF CURB	
EDGE OF PAVEMENT	
FENCE	
RAILROAD TRACKS	
RIGHT OF WAY	
WEST SHORE	
BUCKEYE	

DRAWING SCALE: N/A

ENGINEER:



2649 GARDNER RD
BROADVIEW, IL 60155
OFFICE 630.572.9999
FAX 630.572.9999

OWNER:

**CITY OF
AURORA**

44 E DOWNER PLACE
AURORA, IL 60507
OFFICE: 630.258.3200
FAX: 630.258.3229

CONTRACTOR:



1350 W WASHINGTON ST
WEST CHICAGO, IL 60185
OFFICE: 630.851.7751

TITLE:

OUTSIDE PLANT FIBER
OPTIC BUILD

W DIEHL RD &
N EOLA RD (CO RD 14)
AURORA, IL 60502

PROJECT NUMBER: 1826-001

DRAWN BY: JCS DATE DRAWN: 04/23/18

NO.	DATE	DESCRIPTION
4	08/09/18	REVISED PER CLIENT
3	08/03/18	ADDED DIMENSIONS
2	06/07/18	CALLOUT REVISION
1	06/07/18	ROUTE REVISION PERMIT

REVISIONS

SHEET NUMBER

2

2 OF 9

NOTES & ABBREVIATIONS:

ABBREVIATIONS:

ASPH	ASPHALT
BLDG	BUILDING
BLVD	BOULEVARD
CB	CATCH BASIN
CBL	CURB LINE
CIP	CAST IRON PIPE
CL	CENTERLINE
CNTY	COUNTY
CONC	CONCRETE
CWALK	CONCRETE SIDEWALK
CULV	CULVERT
DCT	CONDUIT DUCTS
DPWC	DUPAGE WATER COMMISSION
DRIV	DRIVEWAY
EA	EACH
EL	ELEVATION
EOC	END OF CABLE
EOP	EDGE OF PAVEMENT
EOS	EDGE OF SIDEWALK
EX	EXISTING
FH	FIRE HYDRANT
GALV	GALVANIZED
GIMT	GALVANIZED INTERMEDIATE TUBE
GIP	GALVANIZED IRON PIPE
GRS	GALVANIZED RIGID STEEL
GRVL	GRAVEL
HDPE	HIGH DENSITY POLYETHYLENE
HH	HANDHOLE
HORIZ	HORIZONTAL
ILAW	ILLINOIS AMERICAN WATER
LT	LEFT
MH	MANHOLE
MWRD	METROPOLITAN WATER RECLAMATION DISTRICT
PED	PEDESTAL
PL	PROPERTY LINE
PR	PROPOSED
PVC	POLYVINYL CHLORIDE
RD	ROAD
ROW, R/W	RIGHT-OF-WAY
RTE	ROUTE
RR	RAILROAD
SAN	SANITARY
SE	SOUTHEAST
SEC	SECTION
SH	SHEET
SIG	SIGNAL
STL	STEEL
TW	TEST WINDOW
WM	WATERMAIN

GENERAL NOTES:

1. ALL WORK TO BE DONE WITH EXTREME CAUTION. FIBER OPTIC CABLE CARRYING TRAFFIC AND LOSS OF SERVICE WILL RESULT IN LOSS OF REVENUE.
2. ALL WORK TO BE PERFORMED IN STRICT ACCORDANCE WITH THE APPLICABLE CODES OR REQUIREMENTS OF ANY REGULATING GOVERNMENTAL AGENCY, OR THE RIGHT-OF-WAY GRANTOR.
3. LOCATIONS OF SOME OF THE PHYSICAL FEATURES WERE OBTAINED FROM DATED RAILROAD VALUATION MAPS OR OTHER DRAWINGS, AND MAY BE AS SHOWN OR DEPICTED ON THESE DRAWINGS.
4. UNDERGROUND UTILITIES HAVE BEEN PLOTTED FROM AVAILABLE RECORDS AND FIELD OBSERVATIONS, BUT NOT NECESSARILY EXACT. THEREFORE, UTILITY LOCATIONS WILL BE VERIFIED AT LEAST 100 FEET IN ADVANCE OF TRENCHING OR PLOWING, SO THAT CHANGES IN CABLE PLACEMENT CAN BE MADE IN EVENT OF CONFLICT.
5. ALL KNOWN BURIED OBSTRUCTIONS ARE SHOWN ON THE CONSTRUCTION DRAWINGS. ANY AND ALL OTHERS ENCOUNTERED ARE ALSO THE RESPONSIBILITY OF THE CONTRACTOR TO LOCATE, PROTECT, OR REPAIR, IF DAMAGED.
6. ANY AND ALL IMPROVEMENTS, SUCH AS , ASPHALT OR CONCRETE PAVEMENT, CURBS, GUTTERS, WALKS, DRAINAGE DITCHES, EMBANKMENTS, SHRUBS, TREES, GRASS SOD, ETC., IF DAMAGED, SHALL BE RESTORED TO ORIGINAL OR BETTER CONDITION.

CONSTRUCTION NOTES:

1. THE ENCLOSED DESIGN IMPLIES EXISTING UTILITIES. THE UTILITIES HAVE NOT BEEN FIELD VERIFIED FOR LOCATION. THEREFORE, ALL UTILITIES IMPLIED WITHIN THIS DOCUMENT ARE TO BE REFERRED TO AS A "REFERENCE TOOL". IT IS THE RESPONSIBILITY OF THE GENERAL CONTRACTOR AND/OR ITS SUBCONTRACTORS TO VERIFY THESE UTILITIES USING ANY AND ALL METHODS AND INSTRUMENTS AVAILABLE IF/WHEN NECESSARY. CCSI DESIGN GROUP, INC. (CCSI) CANNOT GUARANTEE UTILITY LOCATIONS. ALL DOCUMENTATION ON EXISTING UTILITIES HAS BEEN IMPLIED UTILIZING "INFORMATION RETRIEVAL PROCESSES" FROM EACH JURISDICTION INVOLVED (I.E., STATE, COUNTY AND/OR MUNICIPALITY, TO INCLUDE OTHERS). UTILITIES AND THE SAFETY OF SAME, ARE THE RESPONSIBILITY OF THE GENERAL CONTRACTOR PERFORMING THE WORK.
2. IT IS THE RESPONSIBILITY OF THE GENERAL CONTRACTOR TO ENSURE ALL CONDUITS ARE INSTALLED AS PRESCRIBED IN THESE DRAWINGS. CCSI DESIGN GROUP, INC. (CCSI) WAS NOT RETAINED OR PROVIDED A SURVEY OF THE THE PROPERTY BOUNDARIES AND THEREFORE CAN NOT GUARANTEE THE ACCURACY OF BOUNDARY SHOWN (I.E. PUBLIC WAY, PRIVATE PROPERTY, EASEMENTS ETC.) NOR IS IT TO BE ASSUMED EASEMENTS, SALE OF PROPERTIES HAS NOT OCCURRED DURING & AFTER CCSI'S RESPONSIBILITIES FOR THIS PROJECT HAVE PAST. THENCE ALL BOUNDARIES, EASEMENTS, PROPERTY LINES ETC. ARE TO BE USED AS A GUIDELINE OR REFERENCE AND SHOULD NOT BE TAKEN LITERALLY. IT IS THE CONTRACTORS RESPONSIBILITY TO STAKE ALL ASSOCIATED BOUNDARIES IF SO QUESTIONED. ALL ASPECTS OF BOUNDARIES IMPLIED HEREIN, HAVE BEEN DERIVED THROUGH AVAILABLE MEDIA SUCH AS BUT NOT LIMITED TO (SIDWELL, GOOGLE EARTH PRO, MUNICIPAL, STATE, COUNTY AND OTHER RECORD TYPES). CCSI DOES NOT AGREE NOR DISAGREE WITH THE ABOVE-MENTIONED RECORDS, IT IS SIMPLY A REFERENCE TOOL.
3. ALL CONDUIT WILL BE 4" ID SCHEDULE 40. MANUFACTURED SPLIT PVC OR SPLIT BSP/GSP, UNLESS SPECIFIED OTHERWISE.
4. CONTRACTOR IS RESPONSIBLE FOR LOCATING ALL UTILITIES 48 HOURS PRIOR TO CONSTRUCTION ACTIVITY.
5. SHORING MAY BE REQUIRED AND SHALL COMPLY TO O.S.H.A. STANDARDS.
6. ALL BURIED CONDUIT/CABLE WILL BE PLACED AT 36" MINIMUM COVER UNLESS SPECIFIED OR OTHERWISE NOTED ON THE CONSTRUCTION DRAWINGS.
7. MECHANICAL PROTECTION SHALL BE REQUIRED WHENEVER A 36" MINIMUM COVER IS NOT OBTAINABLE UNLESS OTHERWISE SPECIFIED ON THE CONSTRUCTION DRAWINGS.
8. ALL 90 DEGREE BEND IN CONDUIT CONSTRUCTION WILL BE A MINIMUM 36.0" RADIUS UNLESS OTHERWISE SPECIFIED. ALL SPLIT CONDUIT BENDS AND SOLID PVC BENDS SHALL REQUIRE CONCRETE ENCASEMENTS, UNLESS SPECIFIED OTHERWISE.

DRAWING SCALE: N/A

ENGINEER:



2649 GARDNER RD
BROADVIEW, IL 60155
OFFICE 630.572.9999
FAX 630.572.9998

OWNER:

**CITY OF
AURORA**

44 E DOWNER PLACE
AURORA, IL 60507
OFFICE: 630.258.3200
FAX: 630.258.3229

CONTRACTOR:



1350 W WASHINGTON ST
WEST CHICAGO, IL 60185
OFFICE: 630.851.7751

TITLE:

OUTSIDE PLANT FIBER
OPTIC BUILD

W DIEHL RD &
N EO LA RD (CO RD 14)
AURORA, IL 60502

PROJECT NUMBER: 1826-001

DRAWN BY: JCS DATE DRAWN: 04/23/18

NO.	DATE	DESCRIPTION
4	08/09/18	REVISED PER CLIENT
3	08/03/18	ADDED DIMENSIONS
2	06/07/18	CALLOUT REVISION
1	06/07/18	ROUTE REVISION
	04/23/18	PERMIT

REVISIONS

SHEET NUMBER

3

3 OF 9

TYPICALS

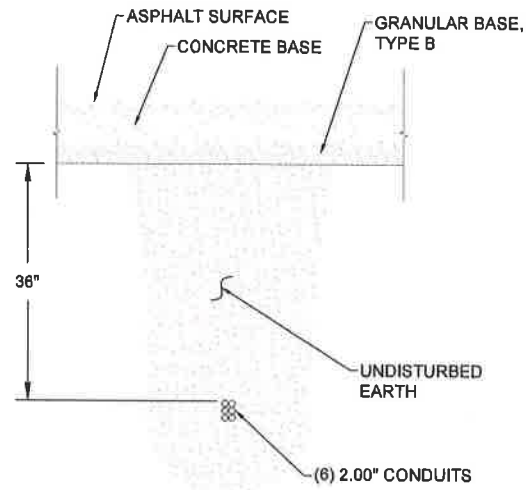

(6) 2.00" BORE CROSS SECTION

SCALE: NOT TO SCALE

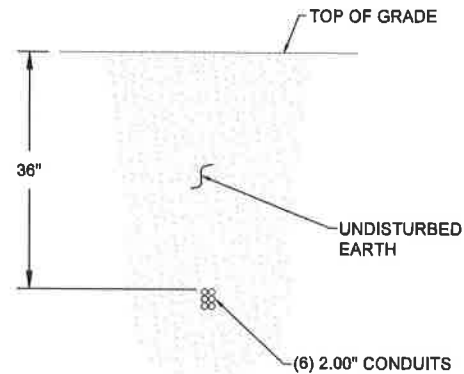

(6) 2.00" BORE CROSS SECTION

SCALE: NOT TO SCALE

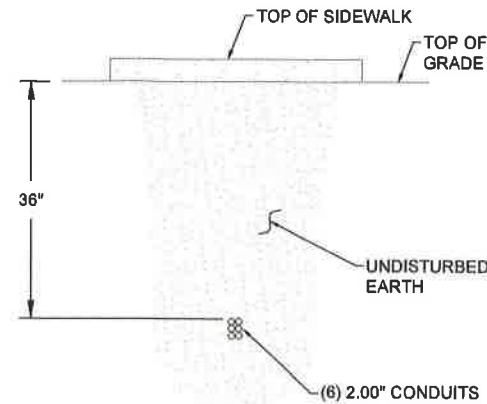

(6) 2.00" BORE CROSS SECTION

SCALE: NOT TO SCALE

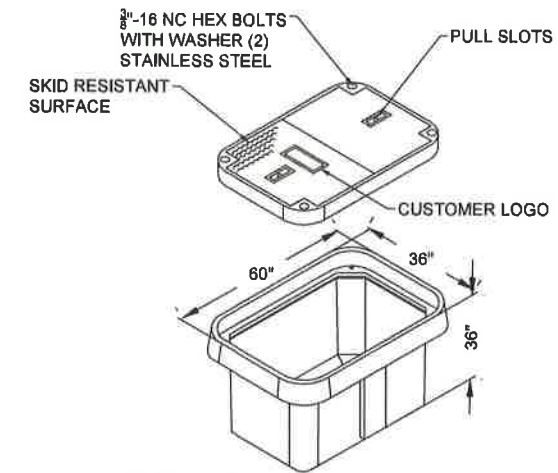

TYPICAL HANDHOLE (ISO VIEW)

SCALE: NOT TO SCALE

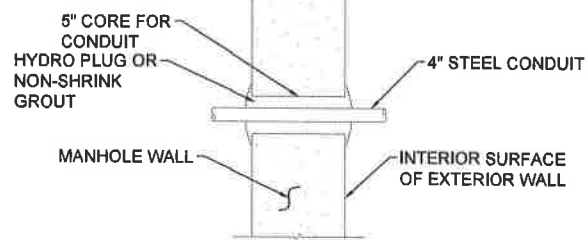

MANHOLE WALL CORE

SCALE: NOT TO SCALE

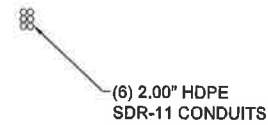

(6) 2.00" HDPE CONDUITS CROSS SECTION

SCALE: NOT TO SCALE

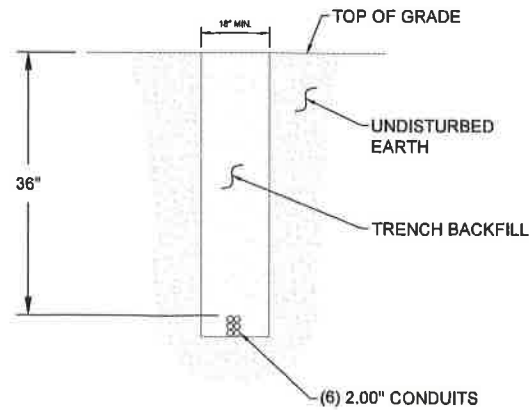

TRENCH CROSS SECTION

SCALE: NOT TO SCALE

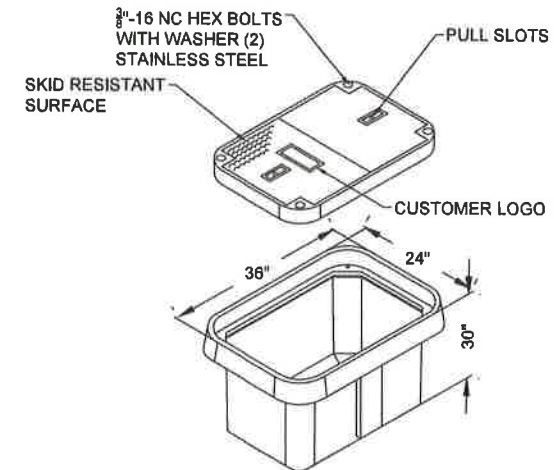

TYPICAL HANDHOLE (ISO VIEW)

SCALE: NOT TO SCALE

DRAWING SCALE:
AS NOTED

ENGINEER:
CCSI
2649 GARDNER RD
BROADVIEW, IL 60155
OFFICE 830.572.9999
FAX 830.572.9998

OWNER:
CITY OF AURORA
44 E DOWNER PLACE
AURORA, IL 60507
OFFICE 830.256.3200
FAX: 830.256.3228

CONTRACTOR:
NTI NATIONAL TECHNOLOGIES
1350 W WASHINGTON ST
WEST CHICAGO, IL 60185
OFFICE: 830.851.7751

TITLE:
OUTSIDE PLANT FIBER OPTIC BUILD
W DIEHL RD & N EOLA RD (CO RD 14)
AURORA, IL 60502

PROJECT NUMBER: 1826-001

DRAWN BY: JCS DATE DRAWN: 04/23/18

NO.	DATE	DESCRIPTION
4	06/09/18	REVISED PER CLIENT
3	06/03/18	ADDED DIMENSIONS
2	06/07/18	CALLOUT REVISION
1	06/07/18	ROUTE REVISION
	04/23/18	PERMIT

REVISIONS

SHEET NUMBER

4

4 OF 9

PLAN & PROFILE

SEC 5 & 8, T38N-R9E
 AURORA, DUPAGE COUNTY, ILLINOIS

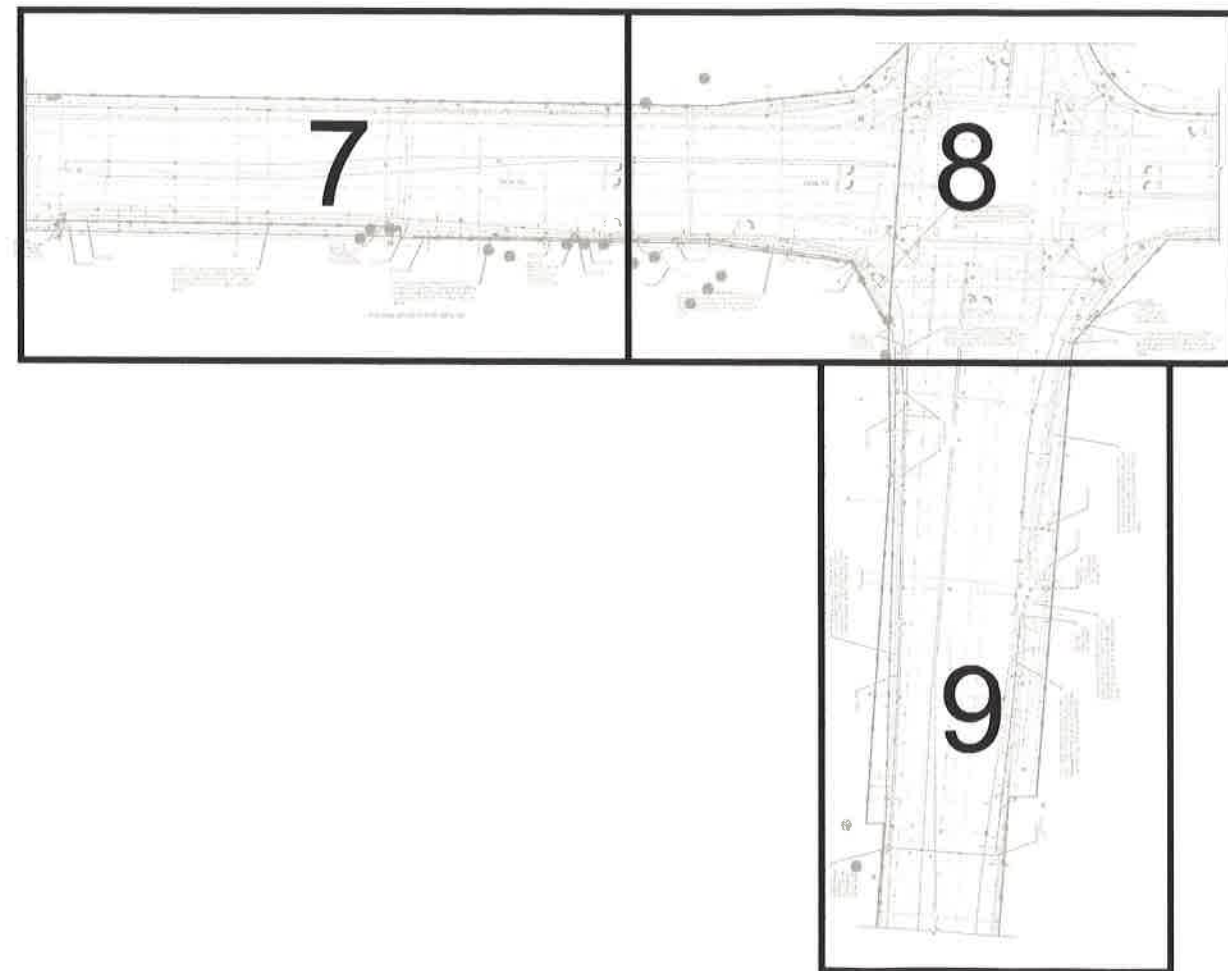

DIEHL RD

EOLA RD



DRAWING SCALE:
 N.T.S.

ENGINEER:



2649 GARDNER RD
 BROADVIEW, IL 60155
 OFFICE 630.572.8989
 FAX 630.572.8988

OWNER:

**CITY OF
 AURORA**

44 E DOWNER PLACE
 AURORA, IL 60507
 OFFICE: 630.258.3200
 FAX: 630.258.3229

CONTRACTOR:



1350 W WASHINGTON ST
 WEST CHICAGO, IL 60185
 OFFICE: 630.851.7751

TITLE:

OUTSIDE PLANT FIBER
 OPTIC BUILD

W DIEHL RD &
 N EOLA RD (CO RD 14)
 AURORA, IL 60502

PROJECT
 NUMBER: 1826-001

DRAWN BY: DATE DRAWN:
 JCS 04/23/18

NO.	DATE	DESCRIPTION
4	08/09/18	REVISED PER CLIENT
3	08/03/18	ADDED DIMENSIONS
2	06/07/18	CALLOUT REVISION
1	06/07/18	ROUTE REVISION
	04/23/18	PERMIT

REVISIONS

SHEET NUMBER

6

6 OF 9

PLAN & PROFILE

SEC 5 & 8, T38N-R9E
AURORA, DUPAGE COUNTY, ILLINOIS

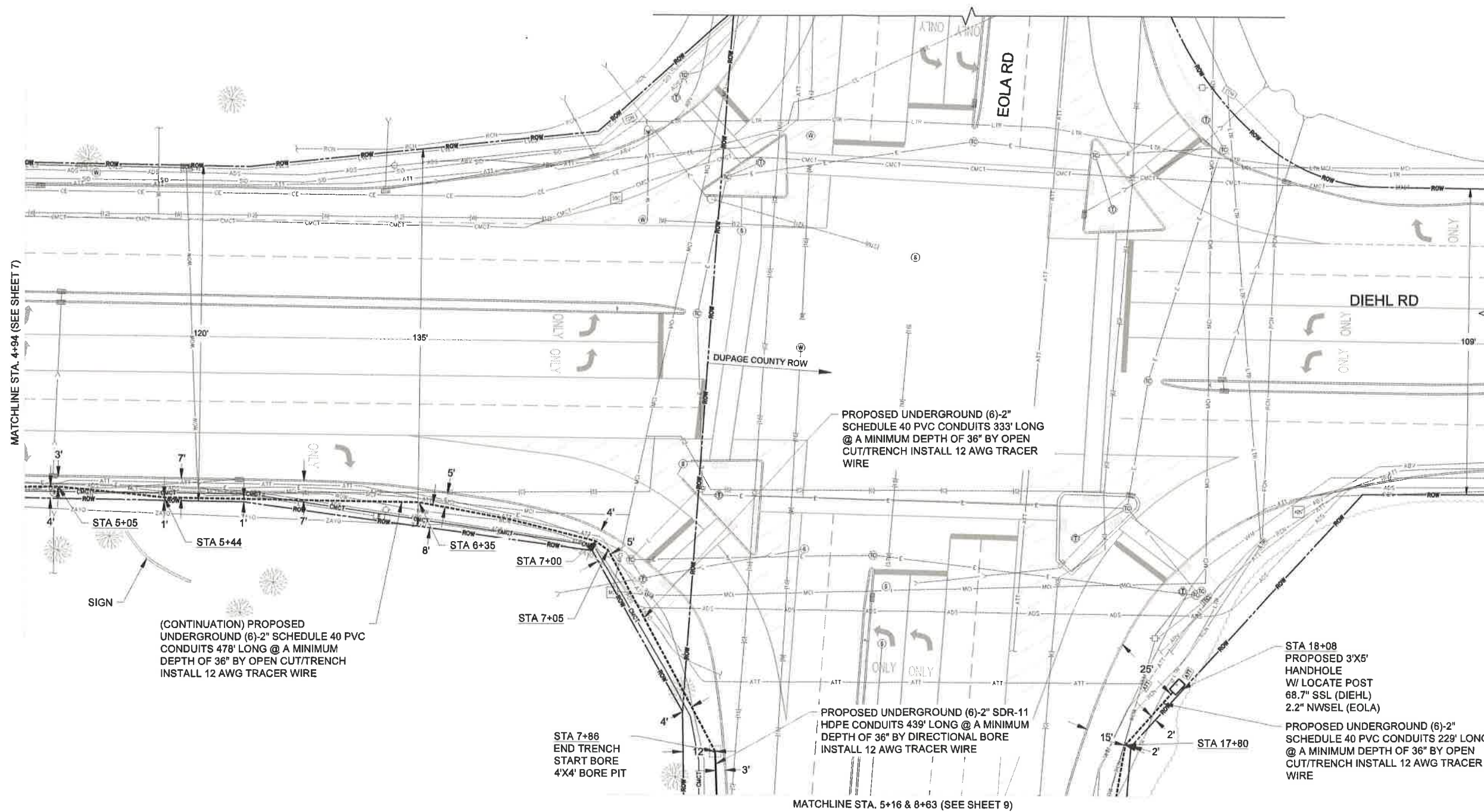

DRAWING SCALE:
1" = 20'

ENGINEER:
CCSI
2649 GARDNER RD
BROADVIEW, IL 60155
OFFICE 630.572.9999
FAX 630.572.9998

OWNER:
CITY OF AURORA
44 E DOWNER PLACE
AURORA, IL 60507
OFFICE: 630.256.3200
FAX: 630.256.3229

CONTRACTOR:
NTI NATIONAL TECHNOLOGIES
1350 W WASHINGTON ST
WEST CHICAGO, IL 60185
OFFICE: 630.861.7751

TITLE:
OUTSIDE PLANT FIBER OPTIC BUILD
W DIEHL RD & N EOLA RD (CO RD 14)
AURORA, IL 60502

PROJECT NUMBER: 1826-001
DRAWN BY: JCS DATE DRAWN: 04/23/18

NO.	DATE	DESCRIPTION
4	08/09/18	REVISED PER CLIENT
3	08/03/18	ADDED DIMENSIONS
2	06/07/18	CALLOUT REVISION
1	06/07/18	ROUTE REVISION
	04/23/18	PERMIT

REVISIONS

SHEET NUMBER
8
8 OF 9

PLAN & PROFILE
 SEC 5 & 8, T38N-R9E
 AURORA, DUPAGE COUNTY, ILLINOIS

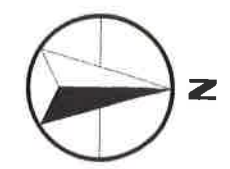
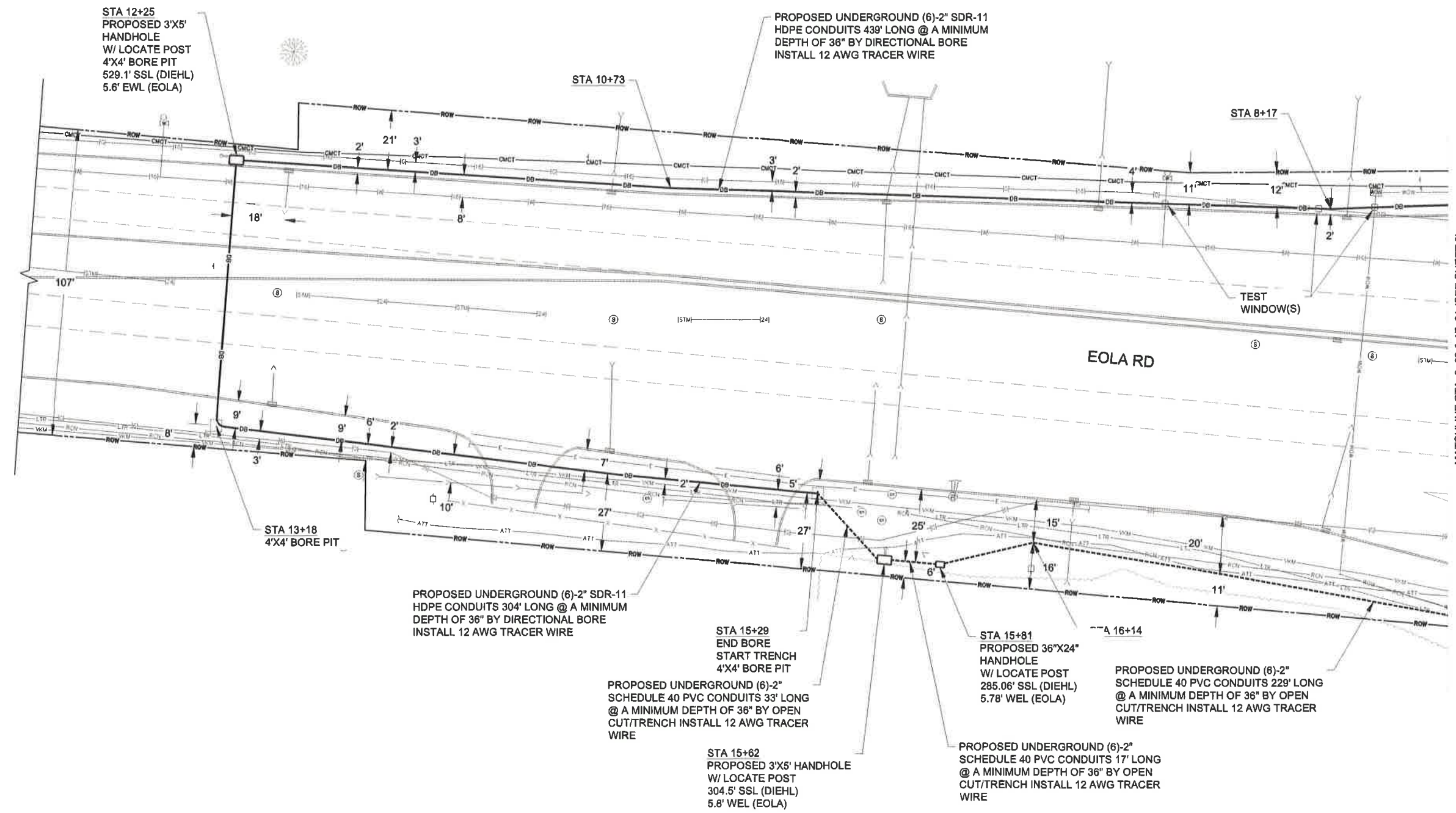

DRAWING SCALE: 1" = 20'

ENGINEER:
CCSI
 2649 GARDNER RD
 BROADVIEW, IL 60155
 OFFICE 630.572.9000
 FAX 630.572.9000

OWNER:
CITY OF AURORA
 44 E DOWNER PLACE
 AURORA, IL 60507
 OFFICE: 630.256.3200
 FAX: 630.256.3220

CONTRACTOR:
NTI NATIONAL TECHNOLOGIES
 1350 W WASHINGTON ST
 WEST CHICAGO, IL 60185
 OFFICE: 630.851.7751

TITLE:
 OUTSIDE PLANT FIBER OPTIC BUILD
 W DIEHL RD & N EOLA RD (CO RD 14)
 AURORA, IL 60502

PROJECT NUMBER: 1826-001
 DRAWN BY: JCS
 DATE DRAWN: 04/23/18

NO.	DATE	DESCRIPTION
4	08/09/18	REVISED PER CLIENT
3	08/03/18	ADDED DIMENSIONS
2	06/07/18	CALLOUT REVISION
1	06/07/18	ROUTE REVISION
	04/23/18	PERMIT

REVISIONS

SHEET NUMBER
9
 9 OF 9