

Bid 23-58
Clark Street and White Eagle Lift Station Improvements
Bid opening: June 28, 2023

ADDENDUM NO. 1
Page 1 of 6

TO: All Bidders

FROM: Engineering Division, City of Aurora

DATE: June 26, 2023

THIS ADDENDUM FORMS A PART OF THE BIDDING AND CONTRACT DOCUMENTS.

1. A non-mandatory pre-bid meeting was held on June 20, 2023, at 10 AM. Please see attached sheets 3 through 5 for the meeting minutes and sign-in sheet.
2. The substantial and final completion dates shall be changed to May 31, 2024.
3. White Eagle lift station work shall not be started until after the proposed 8" force main is completed by others. The 8" force main project completion date is October 27, 2023. The reason for this change is the proposed 8" force main will be installed with a temporary valve vault with a camlock fitting that will be used for bypass pumping during the lift station work. The contractor for this job shall be responsible for removal of this temporary valve vault after the lift station work is completed. Please see the attached White Eagle Lift Station revised plan sheet 4 of 11 for the temporary valve vault location and removal changes.
4. The transformer and lighting panel are NOT being replaced at the Clark Street Lift Station. Delete Photo 2 from Sheet 7.

**Clark Street and White Eagle Lift Station Improvements
ADDENDUM NO. 1, PAGE 2 of 6**

Sincerely,



John D. Hoffmann, P.E.
Engineering Coordinator
City of Aurora Engineering Division

PLEASE ACKNOWLEDGE RECEIPT OF THIS ADDENDUM BY FILLING OUT THE FOLLOWING AND SENDING AN ORIGINAL OR FAX COPY OF THIS SHEET TO THE CITY OF AURORA ENGINEERING DIVISION AT 630/256-3229 OR PREFERRABLY BY E-MAIL AT hoffmannj@aurora.il.us IMMEDIATELY UPON RECIEPT.

COMPANY NAME _____

SIGNATURE OF COMPANY REPRESENTATIVE _____

**Pre-Bid Meeting Minutes for
Clark Street and White Eagle Lift Station Improvements
6/20/2023 @ 10:00 am**

Below are the pre-bid meeting minutes as recorded by the City of Aurora. The attendance sign-in sheet can be found on page 3 of the minutes. All items in **bold text** are considered the minutes from the meeting.

Agenda:

- Clark Street (Not Complete List of Items):
 - No IEPA Permit
 - New Overhead Coiling Garage Door
 - New Meter Vault with Sump Pump & Discharge
 - Replace Valve Vault Fittings and Valves
 - 3 New Pumps with Rails, Piping & Appurtenances **spare pump will be stored in lift station building**
 - Electrical + Conduit
 - Interior Lighting
 - Hatches
 - Flush Mount Davit Crane Base
 - SCADA, **Transformer**, Pump Control, Transfer Switch, Radar Transmitter
 - **Are we removing and replacing the transformer and lighting panel?**
 - **The transformer and lighting panel are NOT being replaced at the Clark Street Lift Station. Delete Photo 2 from Sheet 7.**
 - Shop Drawings/Bypass Pumping Plan
 - **Bypass pumping was reviewed. Approximately 35'-50' to bypass from manhole to interceptor sewer based on COA GIS mapping measurement tool.**
 - Gated Entrance **Gate lock code will be given to contractor during construction.**
- White Eagle (Not Complete List of Items):
 - Submitted IEPA Permit Week of 6/12/23
 - Prefer to be Done First **This may change depending on Force Main to be installed by others and pump lead times. Proposed 8" Force Main will be used as a bypass pumping pipe to the upstream manhole.**
 - Meter Vault with Sump Pump & Discharge
 - Force Main Diversion Structure
 - Proposed Force Main **Existing 6" force main could be used for bypass pumping. However, bypass pumping would still need to be done while making a bypass pumping connection to the existing force main.**
 - Remove and Replace Valve Vault Fittings and Valves
 - 2 Existing Pumps + Provide 1 New Pump. Existing New Pump in Wet Well will be backup. Rails, Piping & Appurtenances **spare pump will be stored in the lift station building**
 - Electrical + Conduit
 - Interior Lighting
 - Hatches
 - Flush Mount Davit Crane Base
 - SCADA, **Transformer**, Pump Control & HMI, Radar Transmitter, Lighting Panel **Relocation**
 - **Where is the transformer in the lift station and does the lift station and transformer need to be relocated?**
 - **There is no transformer at the White Eagle Lift Station. The 120 V power panel will need to be relocated to accommodate the new pump control panel and HMI. Contractor to field determine location and install junction boxes and additional cable and conduits as needed.**

- Bypass Pumping ~1250'
 - **HDPE could be used for above ground bypass pumping, but road ramps would be needed across every driveway and road crossing. The bypass pumping duration is also unknown without input from a general contractor. Bypass pumping logistics were discussed on using existing or proposed force main to eliminate an above ground bypass pipe and alleviate the need/issues associated with driveway and roadway ramps.**
- HMA & PCC Work
- Traffic Control
- Shop Drawings/Bypass Pumping Plan
- Force Main to be Extended by Others
- Spoils to Water and Sewer Pad at 649 S River St
- Completion Date – ~~December 15, 2023~~ - **After the meeting, changed to May 31, 2024,**
- Lump Sum Pay Item + Items Ordered by Engineer
- Other?
 - **What is the horsepower of the pumps at each station for control panel purposes?**
 - **The pumps at White Eagle Lift Station are 230V FM 7.5 HP.**
 - **The pumps at Clark Street Lift Station are 460V FM 12 HP.**
- Site Visit(s)? **No site visits occurred.**



Clark Street and White Eagle Lift Station Improvements Pre-Bid Meeting

6/20/2023

	Name	Company	Phone/Fax	Email
1	John Hoffmann	City of Aurora	(630)256-3244	hoffmannj@aurora.il.us
2	Mike Houston	City of Aurora	(630)256-3712	houstonm@aurora.il.us
3	Grant Funeaux	Xylem	708-476-4223	grant.funeaux@xylem.com
4	Tim Smith	TRI-R Systems	630 514-6785	TSMITH@TRI-RSYSTEMS.COM
5				
6				
7				
8				
9				
10				
11				
12				
13				
14				
15				
16				
17				
18				
19				
20				

WINBERIE AVENUE

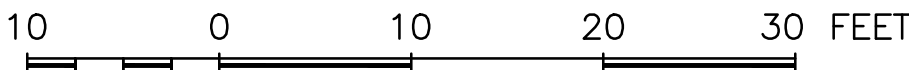
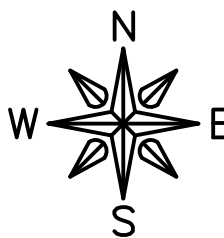
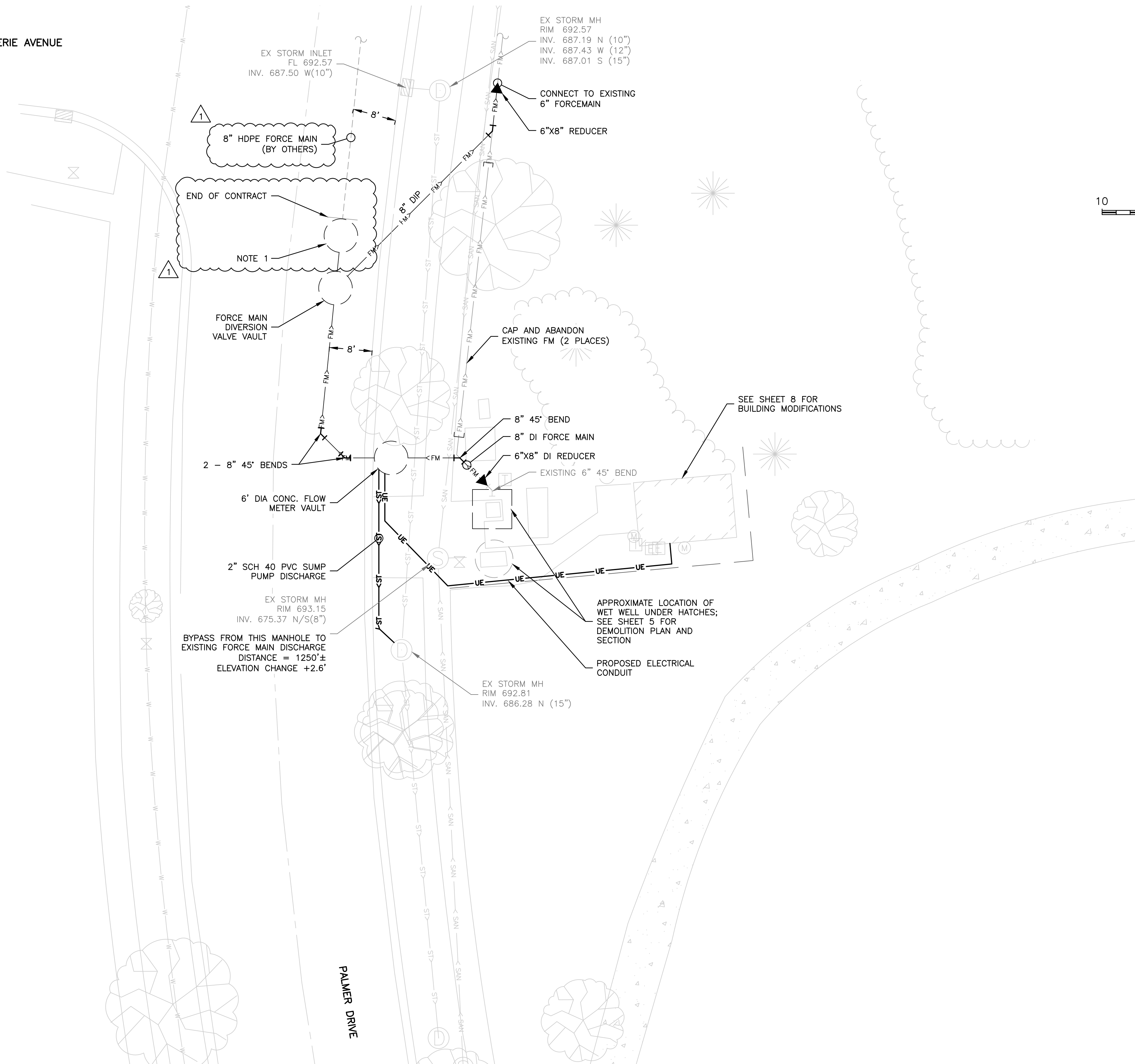

1

NOTE:

1. TEMPORARY 4' DIAMETER BYPASS PUMPING STRUCTURE WITH 8" CAMLOCK FITTING (INSTALLED BY OTHERS PRIOR TO LIFT STATION PROJECT) TO BE USED FOR BYPASS PUMPING AND REMOVED BY LIFT STATION PROJECT DURING FINAL CONNECTION TO 8" FORCE MAIN. CONNECT TO EXISTING 8" HDPE DR-11 FORCE MAIN WITH 8" MJ SOLID SLEEVE.

FEHR GRAHAM

ENGINEERING & ENVIRONMENTAL

ILLINOIS DESIGN FIRM NO. 194-003525

ILLINOIS

IOWA

WISCONSIN

OWNER/DEVELOPER:

CITY OF AURORA
44 E. DOWNER PLACE
AURORA, ILLINOIS

PROJECT AND LOCATION:

WHITE EAGLE LIFT STATION
AURORA, ILLINOIS

DRAWN BY: AS/MK

APPROVED BY: ARD

DATE: 3-10-23

SCALE: AS NOTED

REVISIONS

REV. NO.	DESCRIPTION	DATE
1	ADDENDUM 1	6/26/23

DRAWING:

SITE PLAN

SET TYPE: BID SET

G:\C30\22\22-694\Plans\White Eagle\4 SITE PLAN.dwg, 4 SITE PLAN

JOB NUMBER:

22-694

SHEET NUMBER:

4 of 11