



PROJECT SCOPE

LOWRISE
 LEVEL 0: +/- 4,000 SF
 LEVEL 1: +/- 193,000 SF
 LEVEL 2: +/- 45,000 SF
 TOTAL +/- 242,000 SF

EVENT COURTYARD:
 LEVEL 1: +/- 13,000 SF

HOTEL:
 LEVEL 2: +/- 22,800 SF
 LEVEL 3: +/- 22,800 SF
 LEVEL 4: +/- 22,800 SF
 LEVEL 5: +/- 22,800 SF
 LEVEL 6: +/- 22,800 SF
 LEVEL 7: +/- 22,800 SF
 TOTAL: +/- 136,800 SF

BUILDING TOTAL: +/- 391,800 SF

PARKING REQUIREMENT:

LOWRISE/
 EVENT +/- 255,000 SF (5 SPACES PER 1,000 SF) = 1,275 SPACES
 COURTYARD:

HOTEL: +/- 224 ROOMS (1.05 SPACES PER ROOM) = 236 SPACES
 = 1,511 SPACES

PARKING PROVIDED:

PARKING GARAGE: +/- 1,036 SPACES
 SURFACE PARKING: +/- 564 SPACES
 +/- 1,600 SPACES

PARKING GARAGE:

LEVEL 0: +/- 77,300 SF
 LEVEL 1: +/- 77,300 SF
 LEVEL 2: +/- 77,300 SF
 LEVEL 3: +/- 77,300 SF
 LEVEL 4: +/- 77,300 SF
 LEVEL 5: +/- 77,300 SF
 TOTAL: +/- 463,800 SF





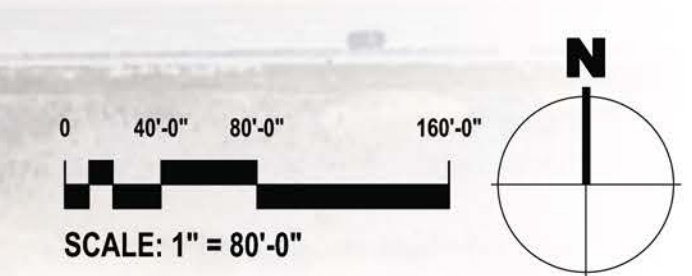

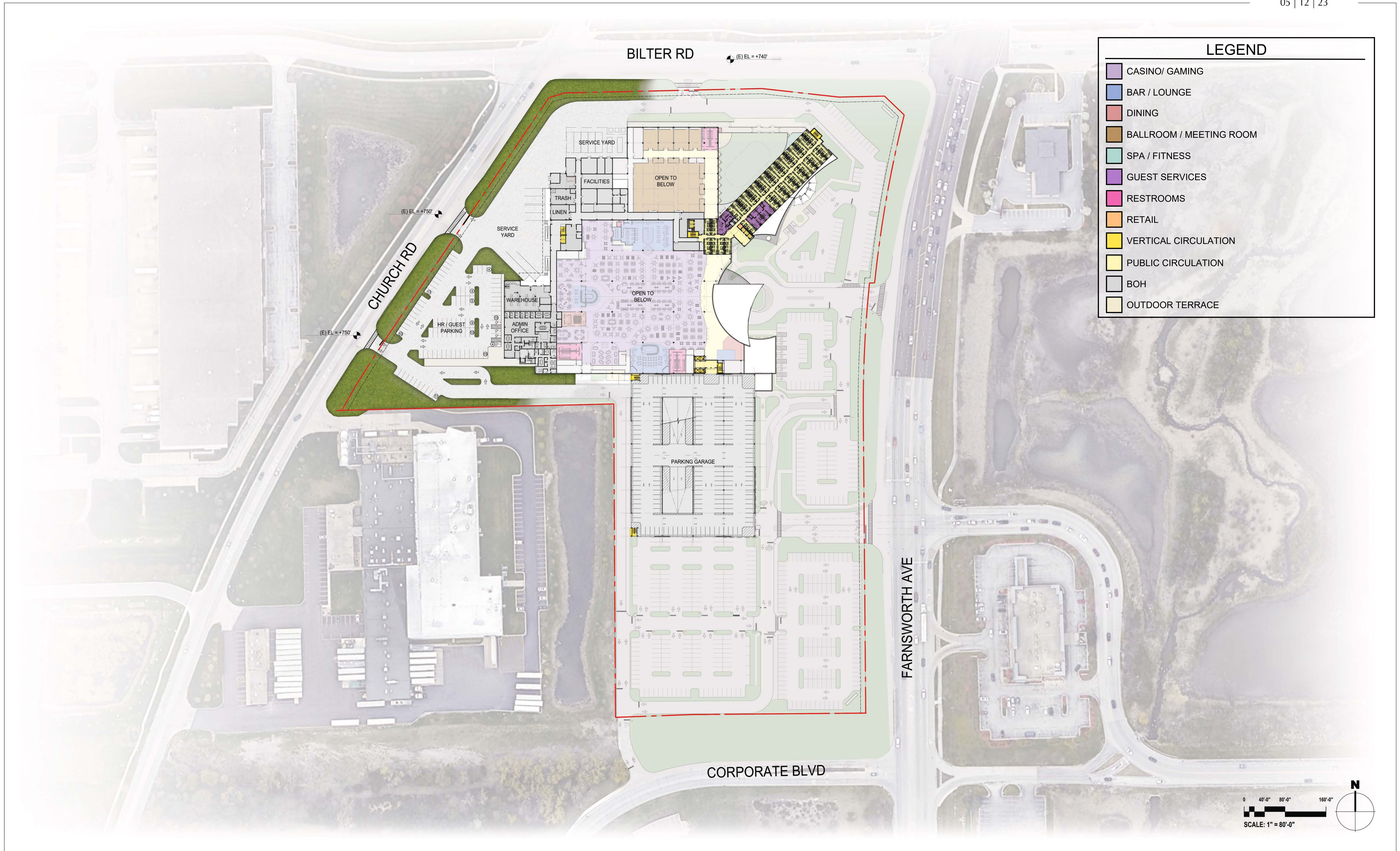



LEGEND

- CASINO/ GAMING
- BAR / LOUNGE
- DINING
- BALLROOM / MEETING ROOM
- SPA / FITNESS
- GUEST SERVICES
- RESTROOMS
- RETAIL
- VERTICAL CIRCULATION
- PUBLIC CIRCULATION
- BOH
- OUTDOOR TERRACE



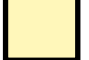

| LEGEND | |
|--|-------------------------|
| | CASINO/ GAMING |
| | BAR / LOUNGE |
| | DINING |
| | BALLROOM / MEETING ROOM |
| | SPA / FITNESS |
| | GUEST SERVICES |
| | RESTROOMS |
| | RETAIL |
| | VERTICAL CIRCULATION |
| | PUBLIC CIRCULATION |
| | BOH |
| | OUTDOOR TERRACE |

| LEGEND | |
|---|-------------------------|
|  | CASINO/ GAMING |
|  | BAR / LOUNGE |
|  | DINING |
|  | BALLROOM / MEETING ROOM |
|  | SPA / FITNESS |
|  | GUEST SERVICES |
|  | RESTROOMS |
|  | RETAIL |
|  | VERTICAL CIRCULATION |
|  | PUBLIC CIRCULATION |
|  | BOH |
|  | OUTDOOR TERRACE |

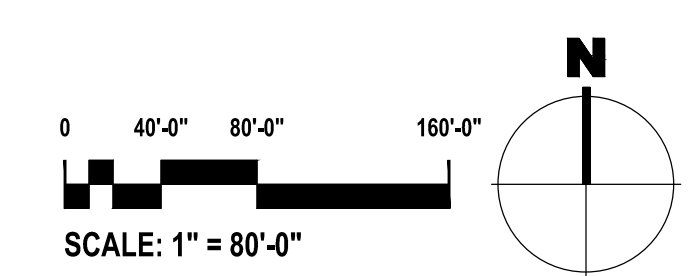
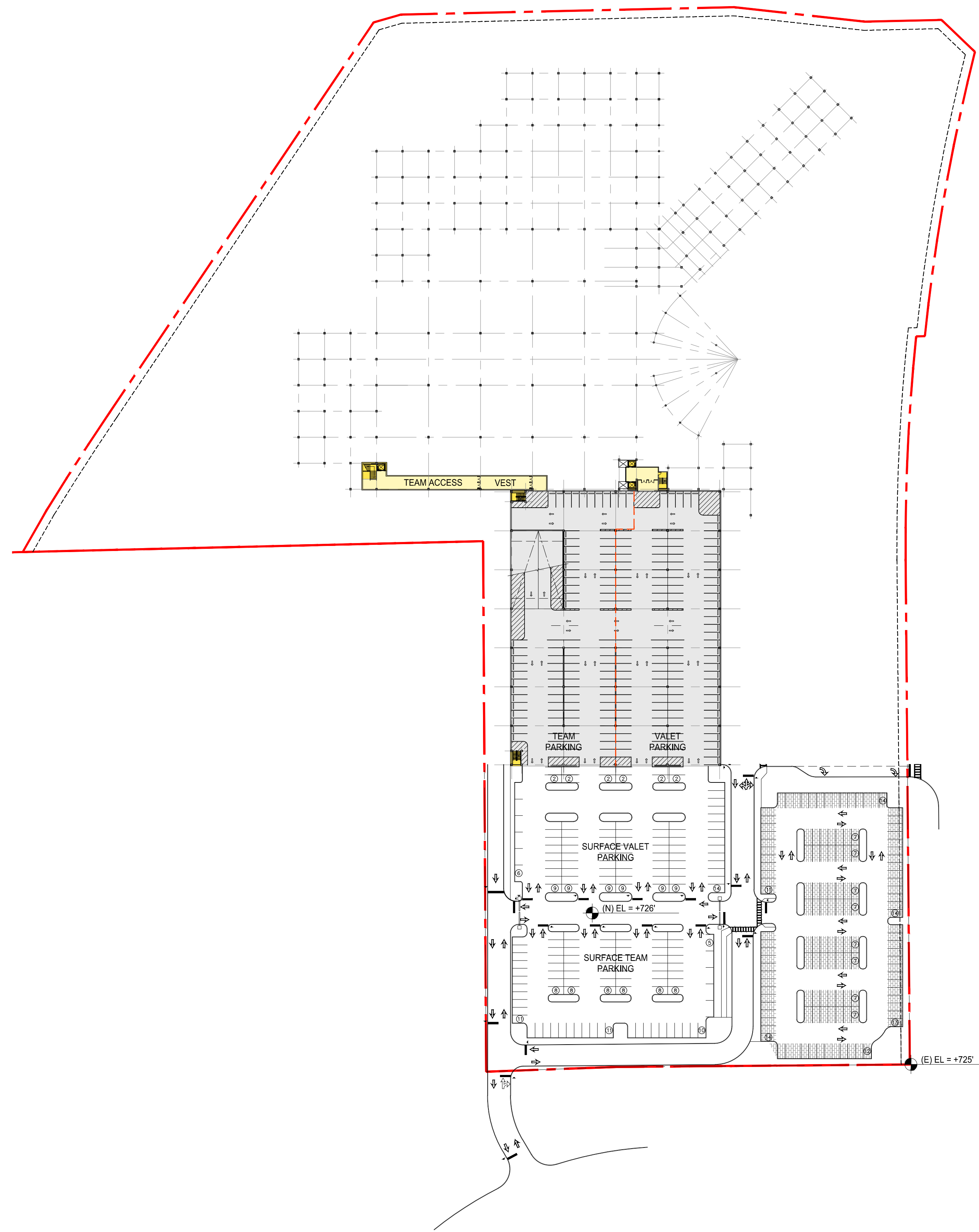

LEGEND

- CASINO/ GAMING
- BAR / LOUNGE
- DINING
- BALLROOM / MEETING ROOM
- SPA / FITNESS
- GUEST SERVICES
- RESTROOMS
- RETAIL
- VERTICAL CIRCULATION
- PUBLIC CIRCULATION
- BOH
- OUTDOOR TERRACE

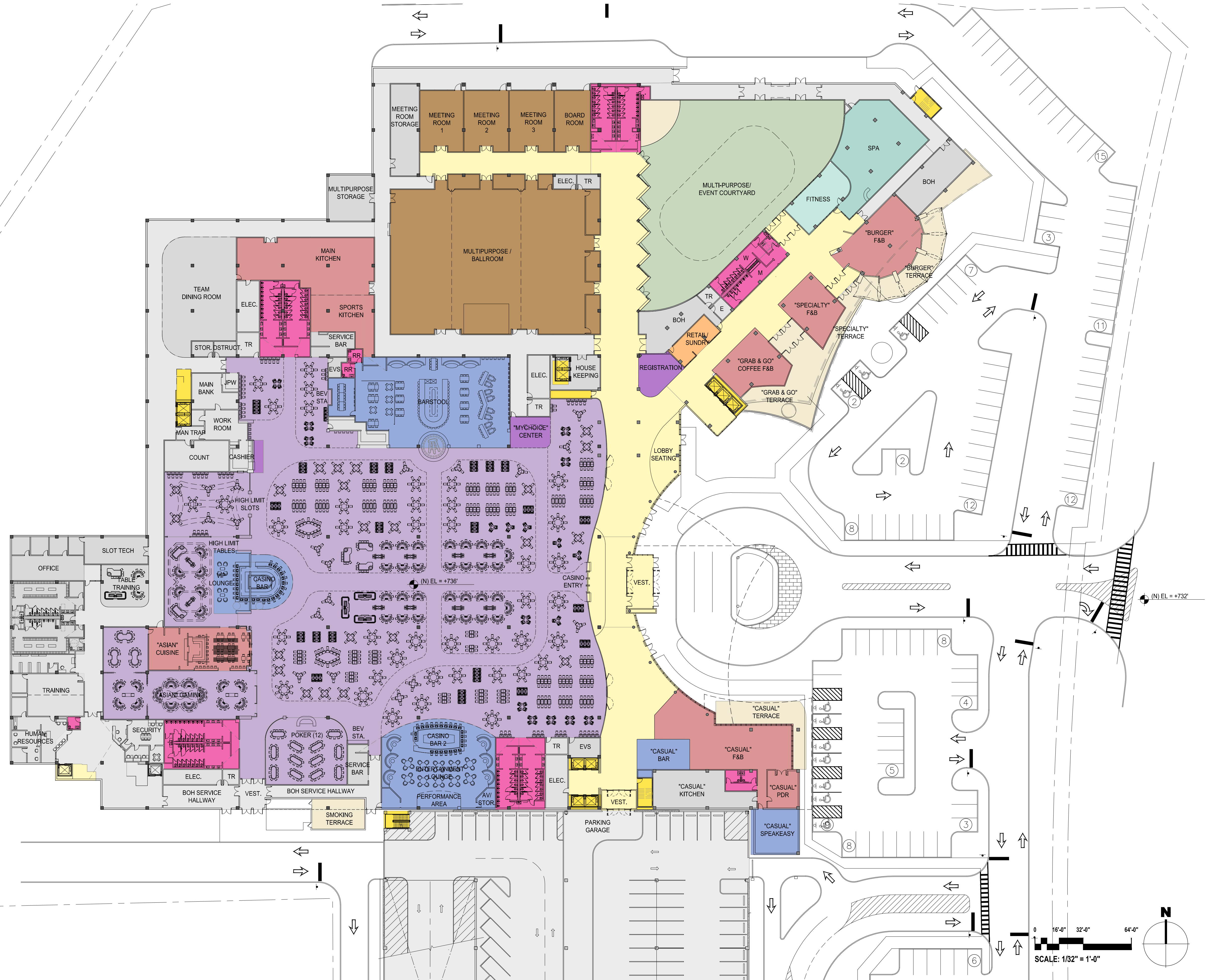

LEGEND

- CASINO/ GAMING
- BAR / LOUNGE
- DINING
- BALLROOM / MEETING ROOM
- SPA / FITNESS
- GUEST SERVICES
- RESTROOMS
- RETAIL
- VERTICAL CIRCULATION
- PUBLIC CIRCULATION
- BOH
- OUTDOOR TERRACE

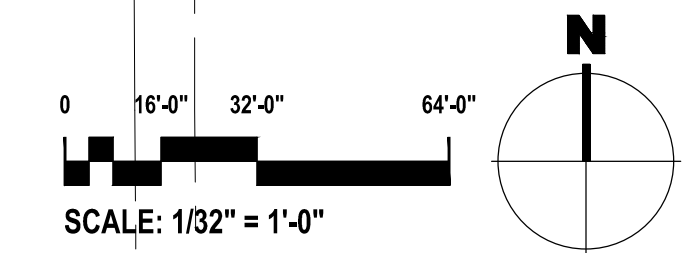

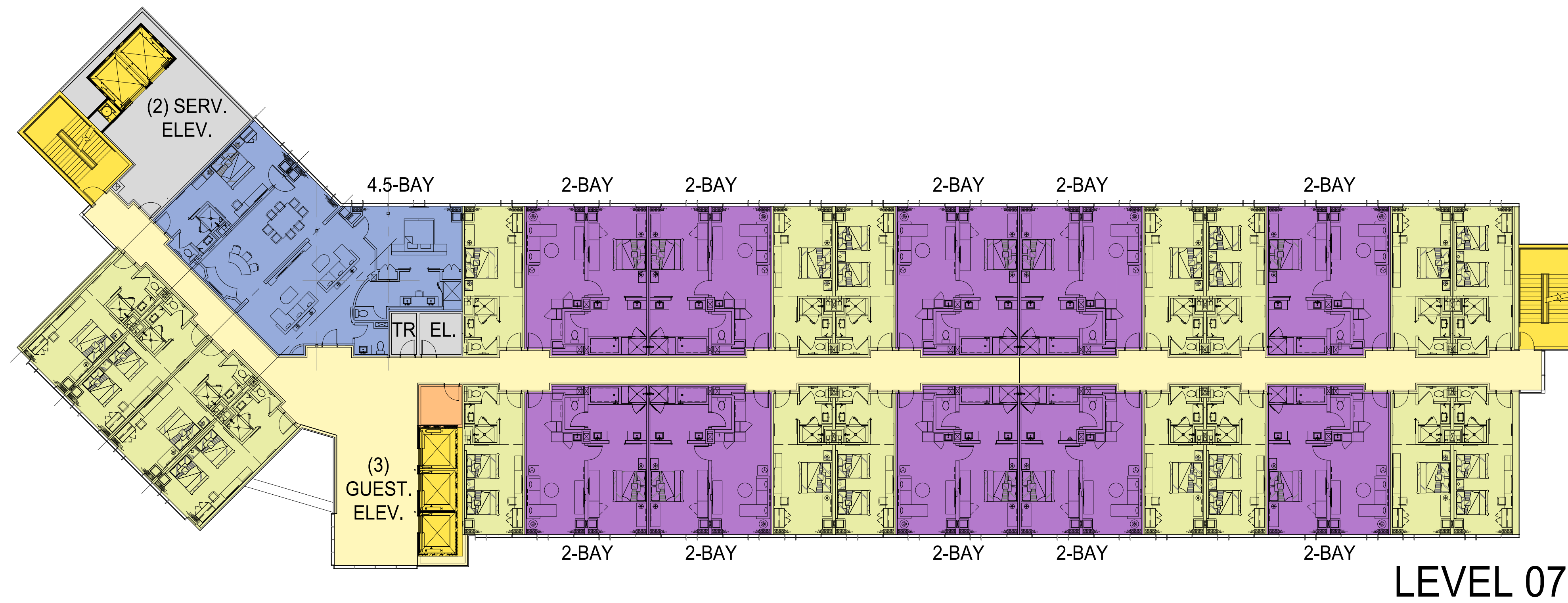

| | |
|-------------------------------|-----------------|
| GUESTROOMS (6 LEVELS): | 224 KEYS |
| - 1-BAY TYPICAL | 198 KEYS |
| - 2-BAY SUITE | 20 KEYS |
| - 2.5-BAY SUITE | 5 KEYS |
| - 4.5-BAY SUITE | 1 KEY |

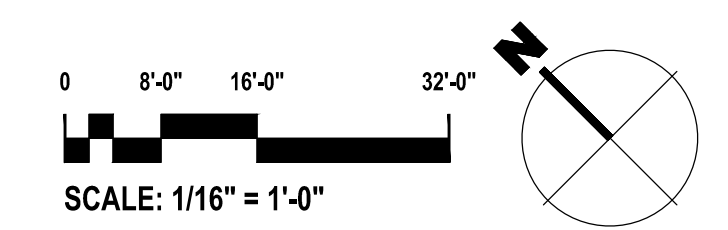
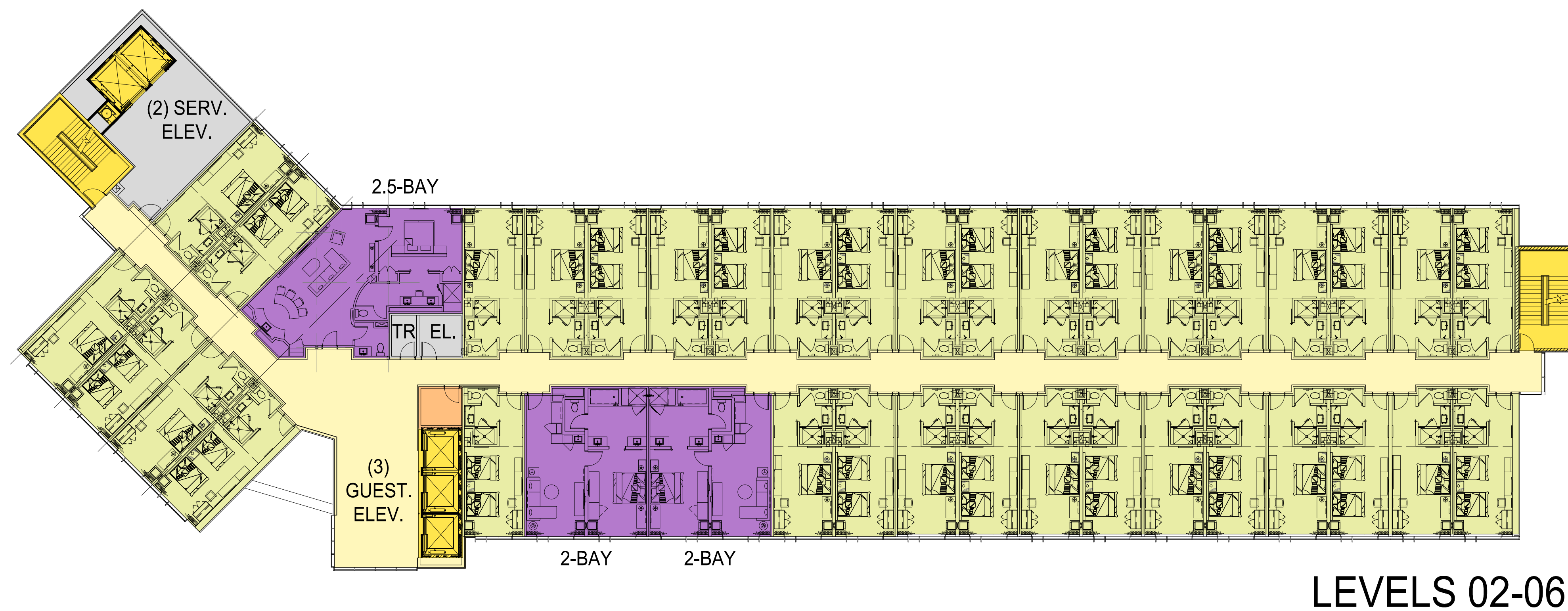

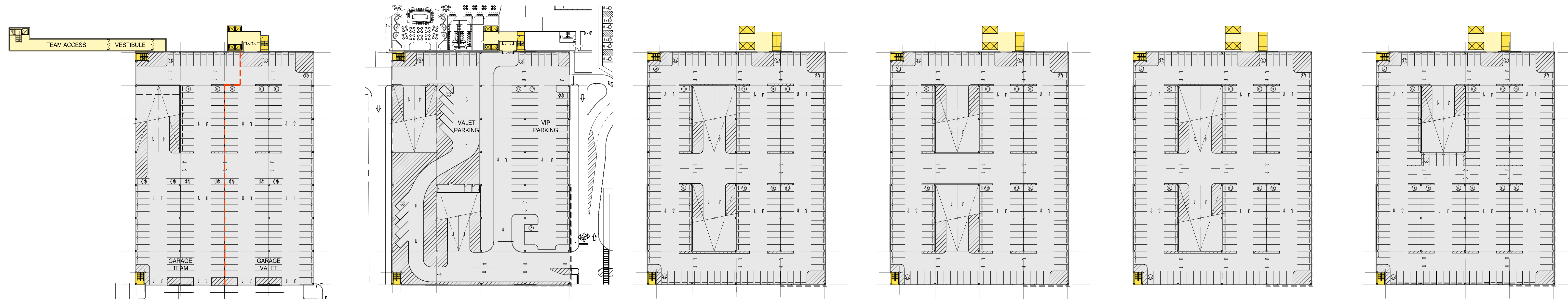

LEVEL 01
 VALET = +/- 19 SPACES
 VIP = +/- 66 SPACES

LEVEL 02
 SELF PARK = +/- 179 SPACES

LEVEL 03
 SELF PARK = +/- 179 SPACES

LEVEL 04
 SELF PARK = +/- 179 SPACES

LEVEL 05
 SELF PARK = +/- 213 SPACES

LEVEL 00
 GARAGE VALET = +/- 112 SPACES
 GARAGE TEAM = +/- 89 SPACES
 SURFACE VALET = +/- 100 SPACES
 SURFACE TEAM = +/- 85 SPACES

TOTAL PARKING GARAGE SPACES
+/- 1,036 SPACES

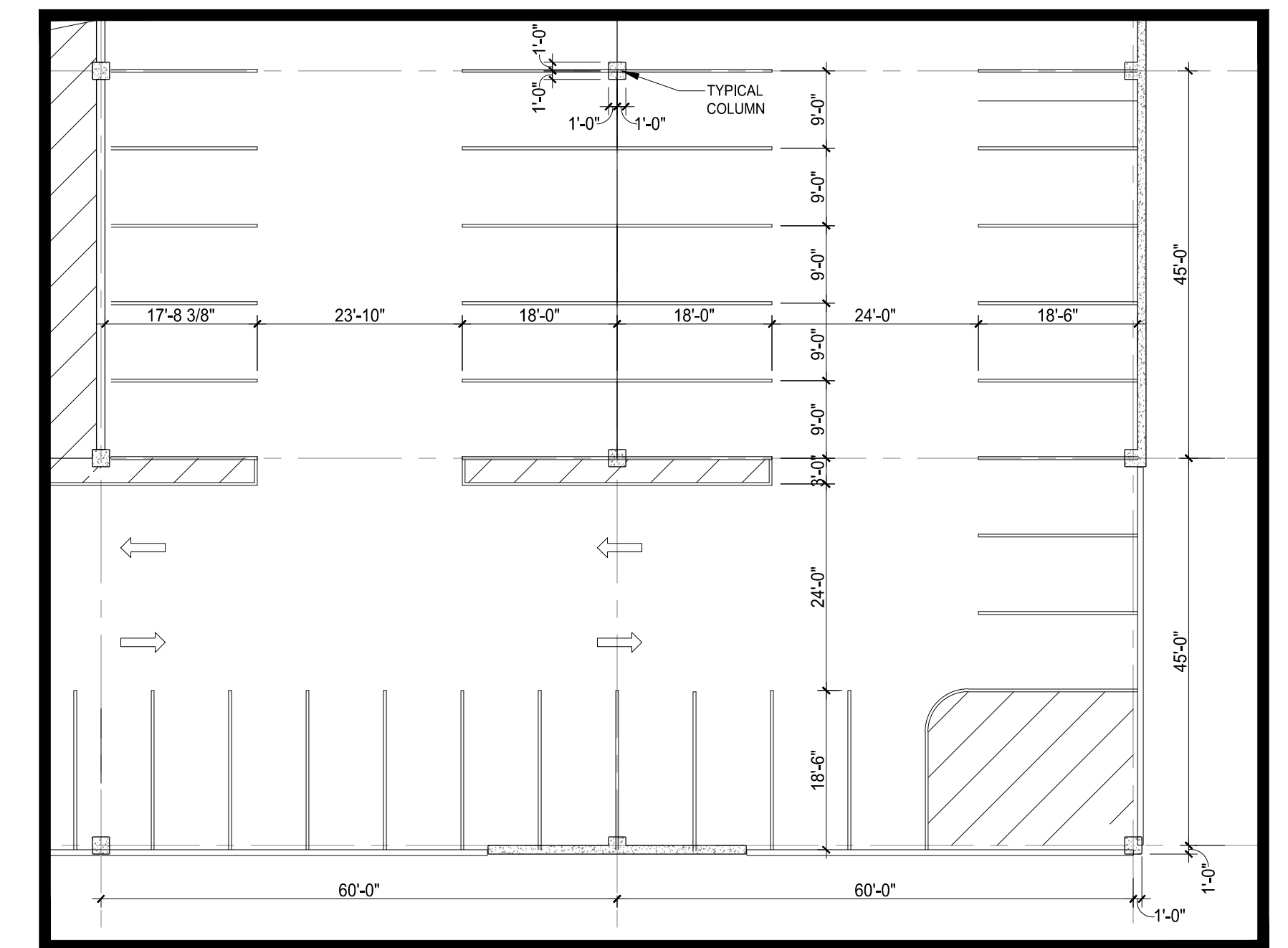

TYPICAL PARKING & DRIVE AISLE DIMENSIONS
 SCALE: 1/16" = 1'-0"

