

FINAL PLAN FOR MCCLEERY  
ELEMENTARY SCHOOL

ZONING  
DISTRICT R-1

ILLINOIS AVENUE

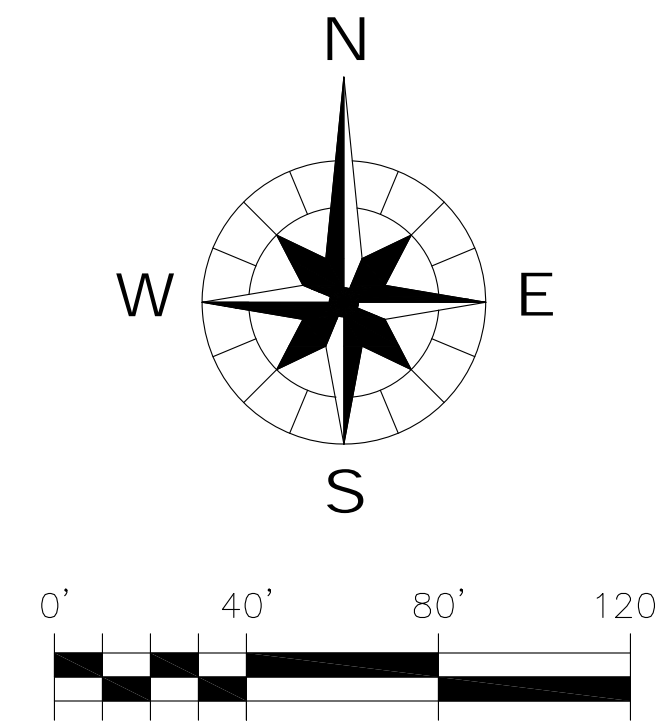

- LEGEND:
- UE- UNDERGROUND ELECTRIC
  - W- WATER MAIN
  - STORM SEWER
  - SANITARY MAIN
  - FO- FIBER OPTIC LINE
  - X- FENCE
  - G- GAS LINE
  - FIRE HYDRANT
  - ⊗ WATER VALVE
  - WATER VALVE VAULT
  - STORM MANHOLE
  - SANITARY MANHOLE
  - POWER POLE
  - GROUND LIGHT
  - SIGN
  - ▨ EXISTING BUILDING
  - PROPOSED BUILDING
  - PROPOSED ASPHALT
  - PROPOSED SIDEWALK

ZONING  
DISTRICT B-2

N ELMWOOD DRIVE

ZONING  
DISTRICT R-3

ZONING  
DISTRICT P

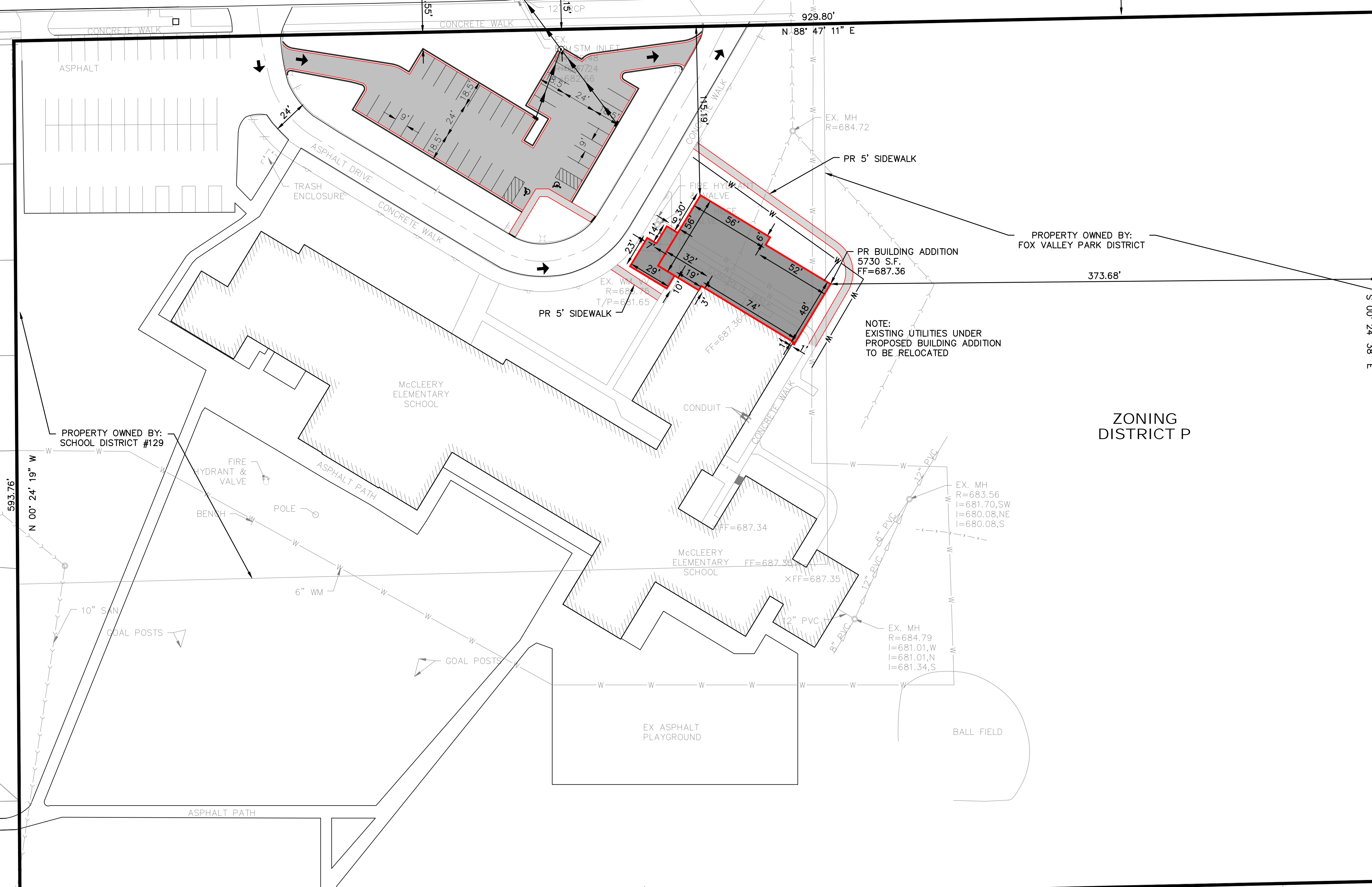

NOTE:  
EXISTING UTILITIES UNDER  
PROPOSED BUILDING ADDITION  
TO BE RELOCATED

PROPERTY OWNED BY:  
FOX VALLEY PARK DISTRICT

PROPERTY OWNED BY:  
SCHOOL DISTRICT #129

ZONING  
DISTRICT R-2

MCCLEERY ELEMENTARY SCHOOL LEGAL DESCRIPTION

PROPERTY DESCRIPTION

THAT PART OF THE SOUTH WEST QUARTER OF SECTION 16 AND PART OF THE SOUTH EAST QUARTER OF SECTION 17, ALL IN TOWNSHIP 38 NORTH, RANGE 8 EAST OF THE THIRD PRINCIPAL MERIDIAN, BEING THAT PART OF VACATED BLOCKS 5, 6, 7 IN WEST PARK ADDITION TO AURORA, AND THAT PART OF VACATED FORDHAM AVENUE AND VACATED SHELDON AVENUE AND DESCRIBED AS FOLLOWS: BEGINNING AT A POINT ON THE SOUTH LINE OF ILLINOIS AVENUE AND THE WEST LINE OF SAID WEST PARK ADDITION TO AURORA, THENCE EAST ALONG THE SOUTH LINE OF SAID ILLINOIS AVENUE TO THE WEST LINE OF ELMWOOD DRIVE, THENCE SOUTH ALONG SAID WEST LINE TO THE NORTH LINE OF HOYT STREET, THENCE WEST ALONG THE NORTH LINE OF HOYT STREET TO THE WEST LINE OF WEST PARK ADDITION, THENCE NORTH ALONG SAID WEST LINE TO THE POINT OF BEGINNING, IN THE TOWNSHIP OF AURORA, KANE COUNTY, ILLINOIS.  
CONTAINING 551696 SQUARE FEET OR 12.665 ACRES, MORE OR LESS

WEST AURORA SCHOOL DISTRICT #129 Development Data Table: Preliminary/Final Plan		
Description	Value	Unit
a) Tax/Parcel Identification Number(s) (PINs): 15-17-477-019 & 020		
b) Proposed land use(s): Education*		
c) Total Property Size	12.9	Acres
	562,795	Square Feet
d) Total Lot Coverage	143,434	Square Feet
(buildings and pavement)	26%	Percent
e) Open space / landscaping	419,361	Square Feet
	75%	Percent
f) Land to be dedicated to the School District		
	0	Acres
g) Land to be dedicated to the Park District		
	0	Acres
h) Number of parking spaces provided (individually accessible)		
i. surface parking lot	83	spaces
perpendicular	78	spaces
parallel	0	spaces
angled	0	spaces
handicapped	5	spaces
ii. enclosed	0	spaces
iii. bike	1	racks
j) Number of buildings		
i. Number of stories	1	stories
ii. Building Square Footage (average)	56,355	square feet
iii. Gross Floor Area of commercial use	0	GFA
iv. Building Foundation perimeter (Typical)	2030	Linear Footage

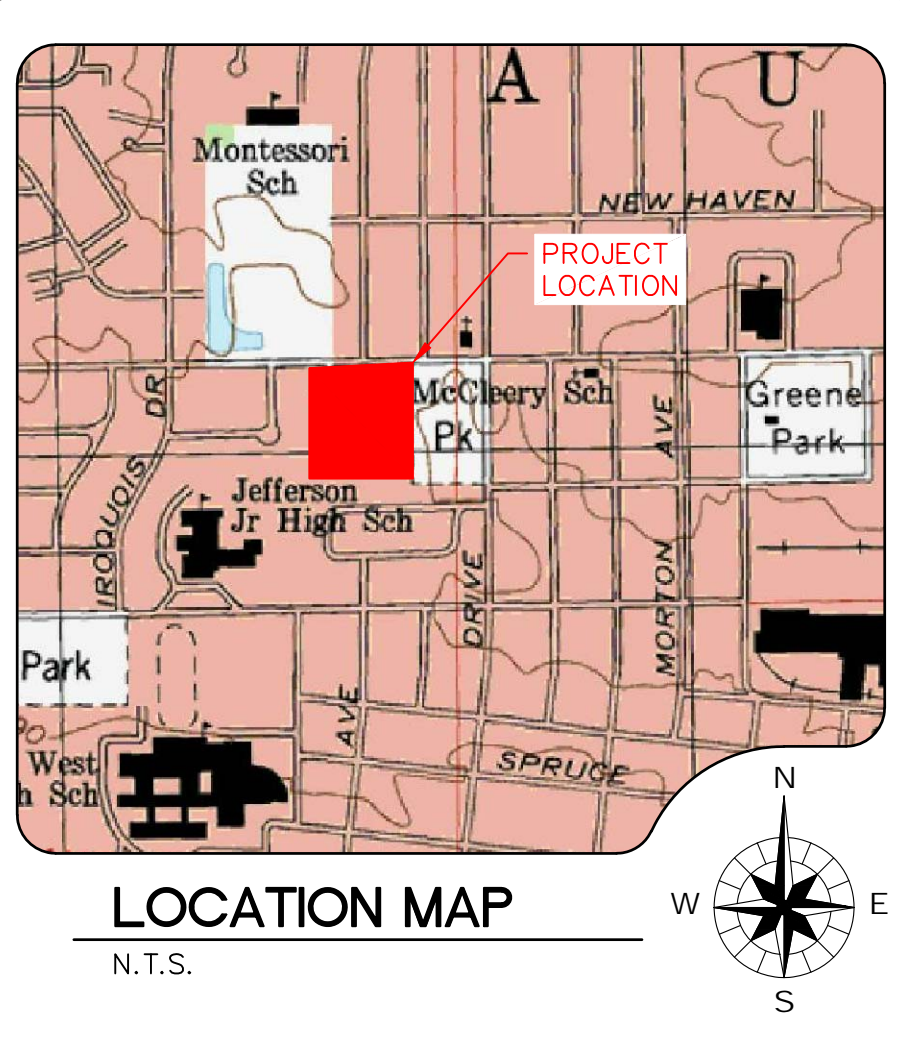

TITLE: MCCLEERY ELEMENTARY SCHOOL FINAL PLAN

CLIENT: WEST AURORA SCHOOL DISTRICT #129  
80 S. RIVER STREET  
AURORA, IL 60506

WILLS BURKE KELSEY ASSOCIATES LTD.  
8 East Galena Blvd., Suite 402  
Aurora, Illinois 60506  
(630) 701-2245

PROJECT NO. 150160  
DATE: 08-11-2015  
DRAWING NO. FP1  
SHEET:  
1 OF 1

W:\Projects\2015\150160 WestAuroraSch\Drawings\150160\_F01.dwg, P1, 11/20/15 4:57:45 PM  
 W:\Projects\2015\150160 WestAuroraSch\Drawings\150160\_F01.dwg, P1, 11/20/15 4:57:45 PM  
 W:\Projects\2015\150160 WestAuroraSch\Drawings\150160\_F01.dwg, P1, 11/20/15 4:57:45 PM