

Property Research Sheet

Location ID#(s): 64481

As of: 7/20/2017

Researched By: Alex Minnella

Address: 0 Vacant

Current Zoning: Unincorporated, Kane County zoning

Parcel Number(s): 15-29-230-024

1929 Zoning: Not Applicable

Subdivision: Lot 1 of Williams; Lathrops

1957 Zoning: Not Applicable

Size: 0.18 Acres / 7,841 Sq. Ft.

Comp Plan Designation: Low Density Residential

School District: SD 129 - West Aurora School District

ANPI Neighborhood: University Neighbors

Park District: FVPD - Fox Valley Park District

TIF District: N/A

Historic District: None

Current Land Use

Current Land Use: Vacant Land/Open Space

Number of Buildings: 0

Parking Spaces: 0

Building Built In: 0

Non-Residential Area: 0 sq. ft.

Total Building Area: 0 sq. ft.

Total Dwelling Units: 0

Number of Stories: 0

Zoning Provisions

Unincorporated Property, no current City of Aurora zoning provisions.

Legislative History

There is no known legislative history for this Property

Location Maps Attached:

Aerial Overview

Location Map

Zoning Map

Comprehensive Plan Map

Aerial Photo (1:1,000):



Lenwood Ct

Hartford Av

S Elmwood Dr

Ridgeway Av

Legend

 Subject Property

 N

 Planning & Zoning Division

Location Map (1:1,000):

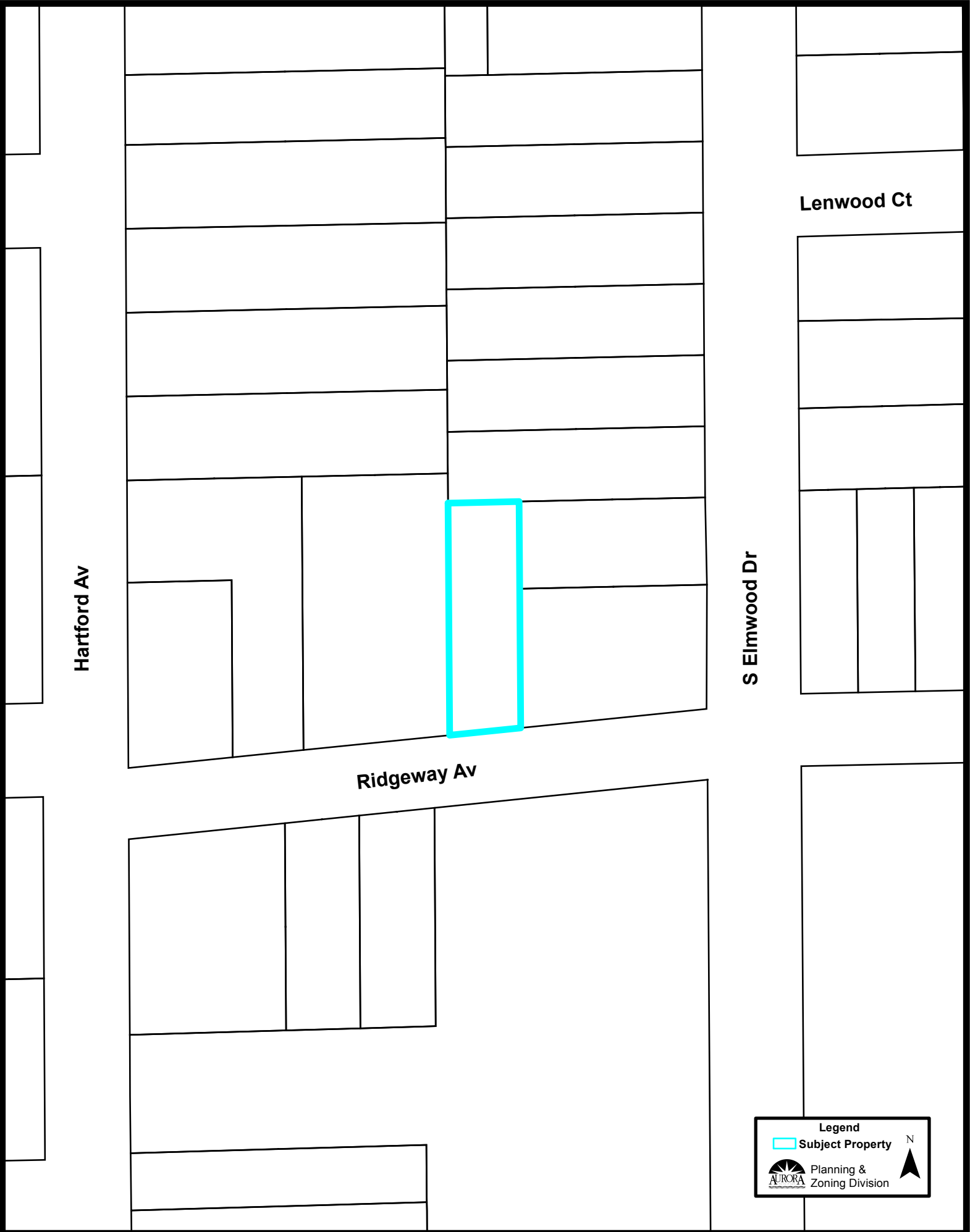

Lenwood Ct

Hartford Av

S Elmwood Dr

Ridgeway Av

Legend
Subject Property
AURORA Planning & Zoning Division
N

Comprehensive Plan (1:5,000):

