

LANDSCAPE PLAN FOR OAKHURST COMMONS RESUBDIVISION, LOT 2

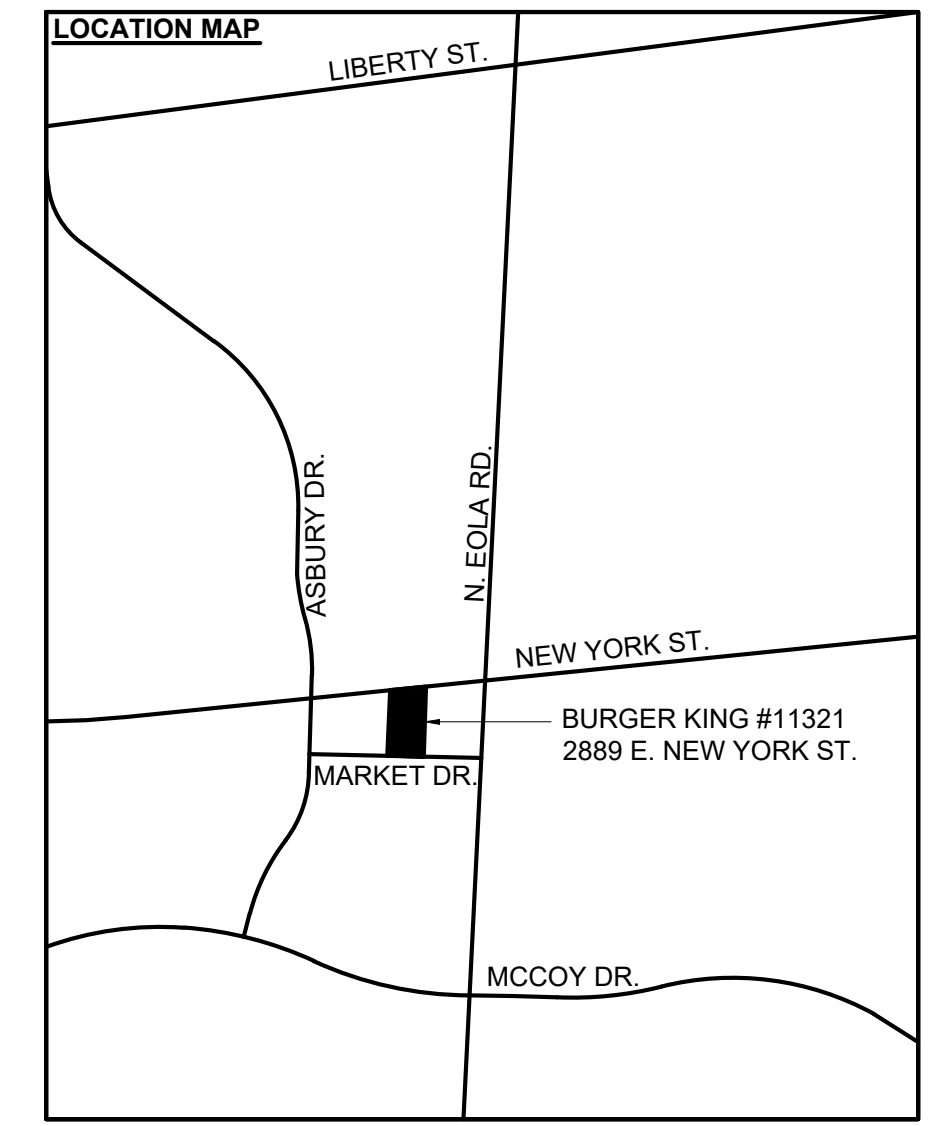

1 TREE PRESERVATION PLAN
SCALE: 1" = 20'-0"

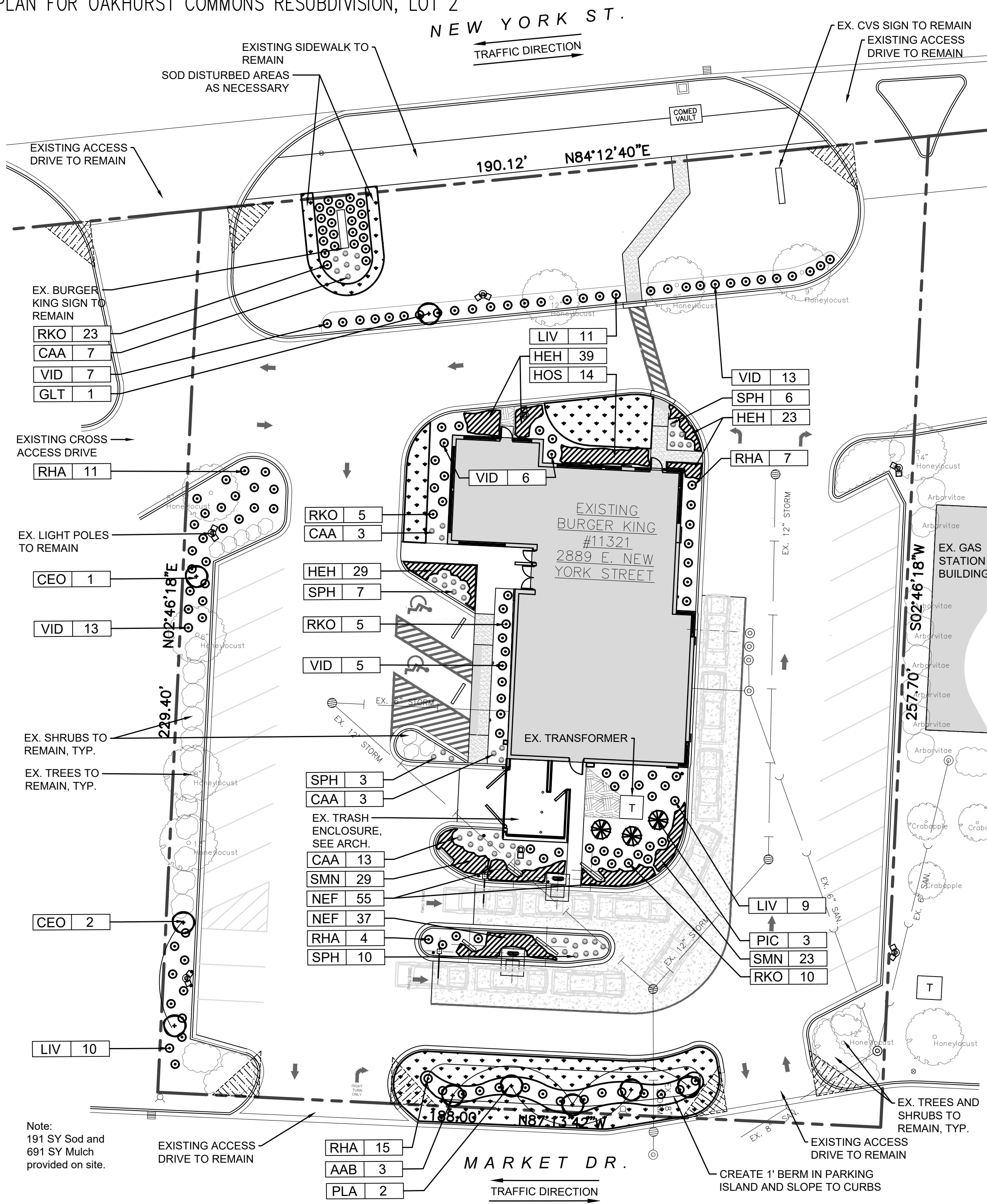
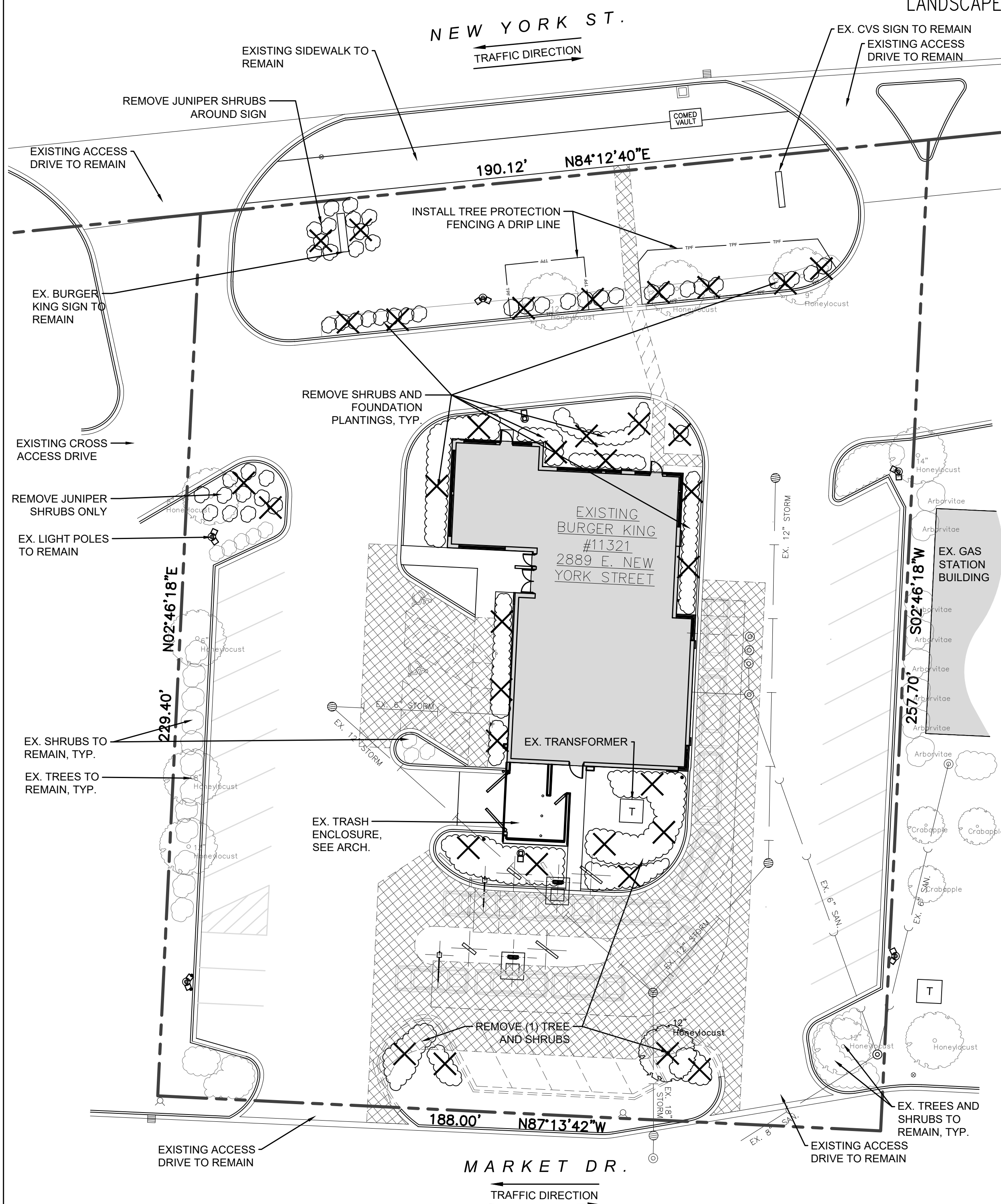
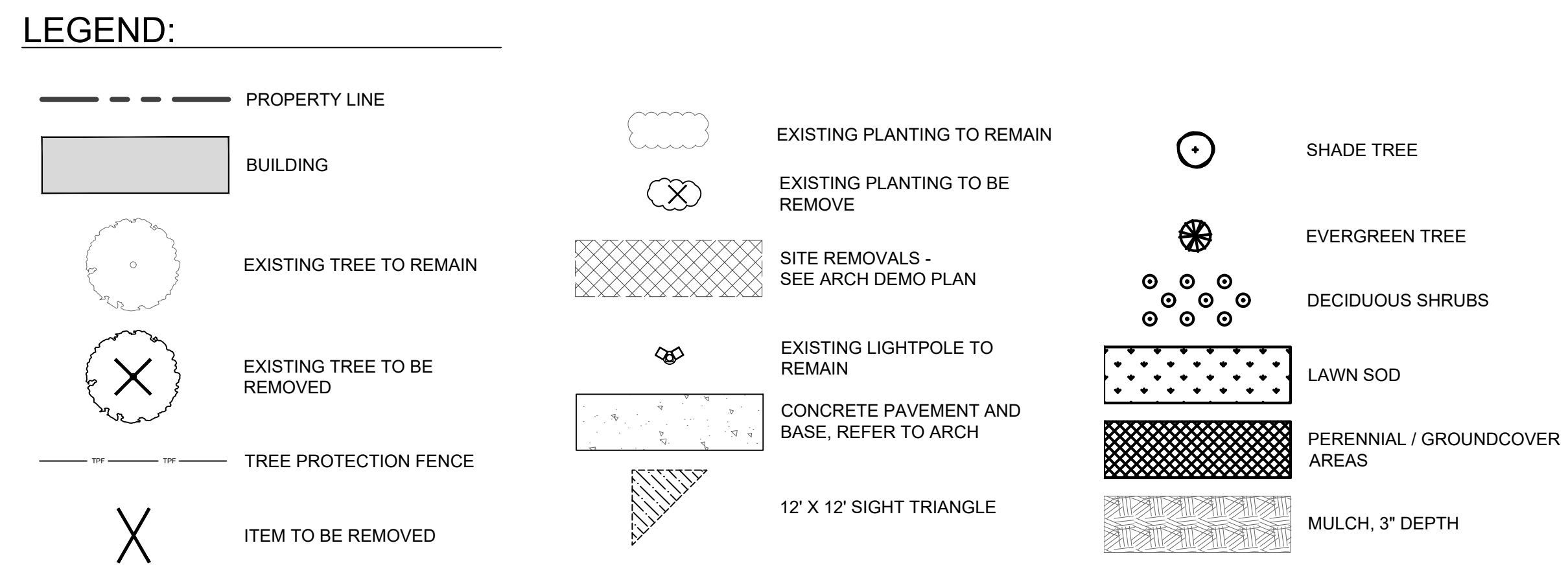
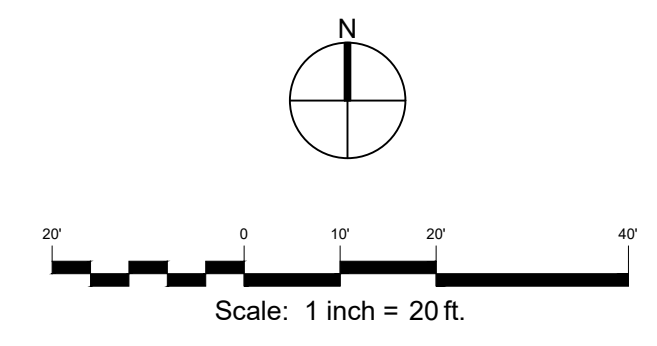

2 LANDSCAPE PLAN
SCALE: 1" = 20'-0"

NOTE:
1. LANDSCAPE TABLES ONLY INCLUDE PROPOSED PLANT MATERIALS.

| Landscape Implementation Data Table: Plant List by Category | | | | | | |
|---|---------------|-------------|-------------|--|------------------------|--------------------------------------|
| | QTY | Percent | SYM | BOTANICAL NAME (Family / Genus / Species) | COMMON NAME | COMMENTS |
| Canopy Trees | 3 | 33% | ABB | Sapindaceae / Acer freemanii 'Autumn Blaze' | Autumn Blaze Maple | 2.5" B & B Central Leader |
| | 3 | 33% | CEO | Carnabaceae / Celtis occidentalis 'Chicagoland' | Chicagoland Hackberry | 2.5" B & B Central Leader |
| | 1 | 11% | GLT | Fabaceae / Gleditsia triacanthos 'Skyline' | Skyline Honeylocust | 2.5" B & B Central Leader |
| | 2 | 22% | PLA | Platanaceae / Platanus x acerifolia | London Planetree | 2.5" B & B Central Leader |
| | Total: | 9 | 100% | | | |
| Evergreen Trees | 3 | 100% | PIC | Pinaceae / Pinus cembra | Swiss Stone Pine | 6' B & B Central Leader |
| | 0 | 0% | | | | |
| | Total: | 3 | 100% | | | |
| Understory Trees | 0 | 0% | | | | |
| | 0 | 0% | | | | |
| | 0 | 0% | | | | |
| | Total: | 0 | 0% | | | |
| Deciduous Shrubs | 21 | 14% | LIV | Oleaceae / Ligustrum vulgare 'Cheyenne' | Cheyenne Privet | 24" B & B 5' O.C. |
| | 46 | 30% | RHA | Anacardiaceae / Rhus aromatica 'Gro-Low' | Gro-Low Sumac | #5 Cont. 18" Ht. 5' O.C. |
| | 43 | 28% | RKO | Rosaceae / Rosa 'Radrazz' | Knockout Rose | #5 Cont. 18" Ht. 5' O.C. |
| | 44 | 29% | VID | Adoxaceae / Viburnum dentatum 'Blue Muffin' | Blue Muffin Viburnum | 24" B & B 5' O.C. |
| | Total: | 154 | 100% | | | |
| Evergreen Shrubs | 0 | 0% | | | | |
| | 0 | 0% | | | | |
| | Total: | 0 | 0% | | | |
| Ornamental Grasses | 13 | 33% | CAA | Poaceae / Calamagrostis x acutiflora 'Karl Forester' | Karl Foerster Grass | #1 Cont. 3' O.C. Mature Height 4' |
| | 26 | 67% | SPH | Poaceae / Sporobolus heterolepis | Prairie Dropseed Grass | #1 Cont. 2.5' O.C. Mature Height 30" |
| | Total: | 39 | 100% | | | |
| Perennials | 91 | 37% | HEH | Xanthoxoaceae / Hemerocallis 'Happy Returns' | Happy Returns Daylily | #1 Cont. 18" O.C. |
| | 14 | 6% | HOS | Asparagaceae / Hosta 'Glaucemole' | Glaucemole Hosta | #1 Cont. 2.5' O.C. |
| | 92 | 37% | NEF | Lamiaceae / Nepeta racemosa 'Walker's Low' | Walker's Low Catmint | #1 Cont. 18" O.C. |
| | 52 | 21% | SMN | Lamiaceae / Salvia nemorosa 'May Night' | May Night Salvia | #1 Cont. 18" O.C. |
| Total: | 249 | 100% | | | | |

Landscape Data Table: Planting Material Key
Note: Symbols are blackline for proposed grayscale for existing

| | | | |
|---|-----------|----------------|---------------------|
| Canopy Trees (minimum size 2.5 caliper) Count: | 9 | | |
| Evergreen Trees (minimum size 6 feet) Count: | 3 | | |
| Understory Trees (minimum size 2.5 caliper or 8 feet if multi-stemmed) Count: | 0 | | |
| Evergreen Shrubs (minimum of 18 inches) Count: | 0 | | |
| Deciduous Shrubs (minimum of 18 inches) Count: | 154 | | |
| Ornamental Grasses Count: | 39 | | |
| Perennials Count: | 249 | | |
| Annuals Count: | 0 | | |
| Landscape Data Table: CTEs Provided | | | |
| | CTE Value | Count Provided | Total CTEs Provided |
| Canopy Trees | 1 | 9 | 9 |
| Evergreen Trees | 1/3 | 3 | 1 |
| Understory Trees | 1/3 | 0 | 0 |
| Deciduous Shrubs | 1/20 | 154 | 8 |
| Evergreen Shrubs | 1/20 | 0 | 0 |
| Total: | | 166 | 18 |

LANDSCAPE ARCHITECT:
TERRA ENGINEERING LTD.
225 W Ohio Street - Suite 400, Chicago, IL 60654
(T) 312-467-0123 | (F) 312-467-0220

STATE OF ILLINOIS
KEVEN GRAHAM
157-00150
LANDSCAPE ARCHITECT
REGISTERED LANDSCAPE ARCHITECT

#157-000150
exp. 8/31/19

Keven Graham FASLA, PLA
TERRA Engineering Ltd.

LANDSCAPE CONTRACTOR:
Landscape Concepts Management
www.landscapeconcepts.com

OWNER:
Tri-City Foods - 1400 Opus Pl. #900,
Downers Grove, IL 60515
630-598-3300

PETITIONER:
Warren Johnson Architects - 19 N.
Greeley St., Palatine, IL 60067
847-359-9616

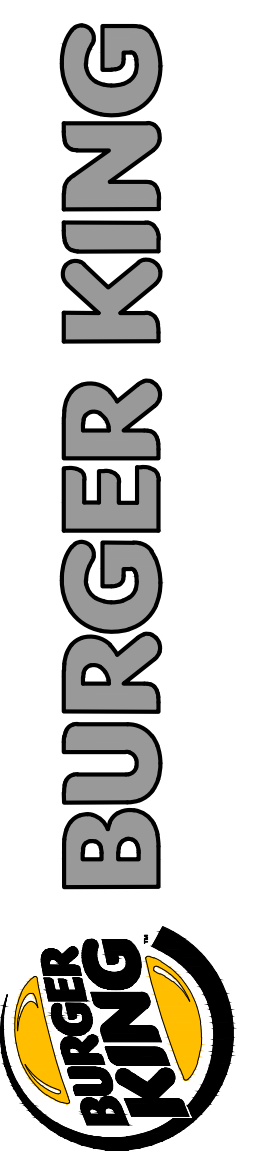

ISSUE DATES / REVISIONS

| NO. | DESCRIPTION | DATE |
|-----|------------------|---------|
| | PERMIT SUBMITTAL | 5.24.19 |

DRAWN BY: CM
CHECKED BY: KG
DATE: 4.16.19
PROJECT No: 19019

BURGER KING
STORE #11321
2889 E. NEW YORK ST.
AURORA, IL 60505

LANDSCAPE PLAN
OAKHURST COMMONS
RESUBDIVISION, LOT 2

SHEET
L1.0

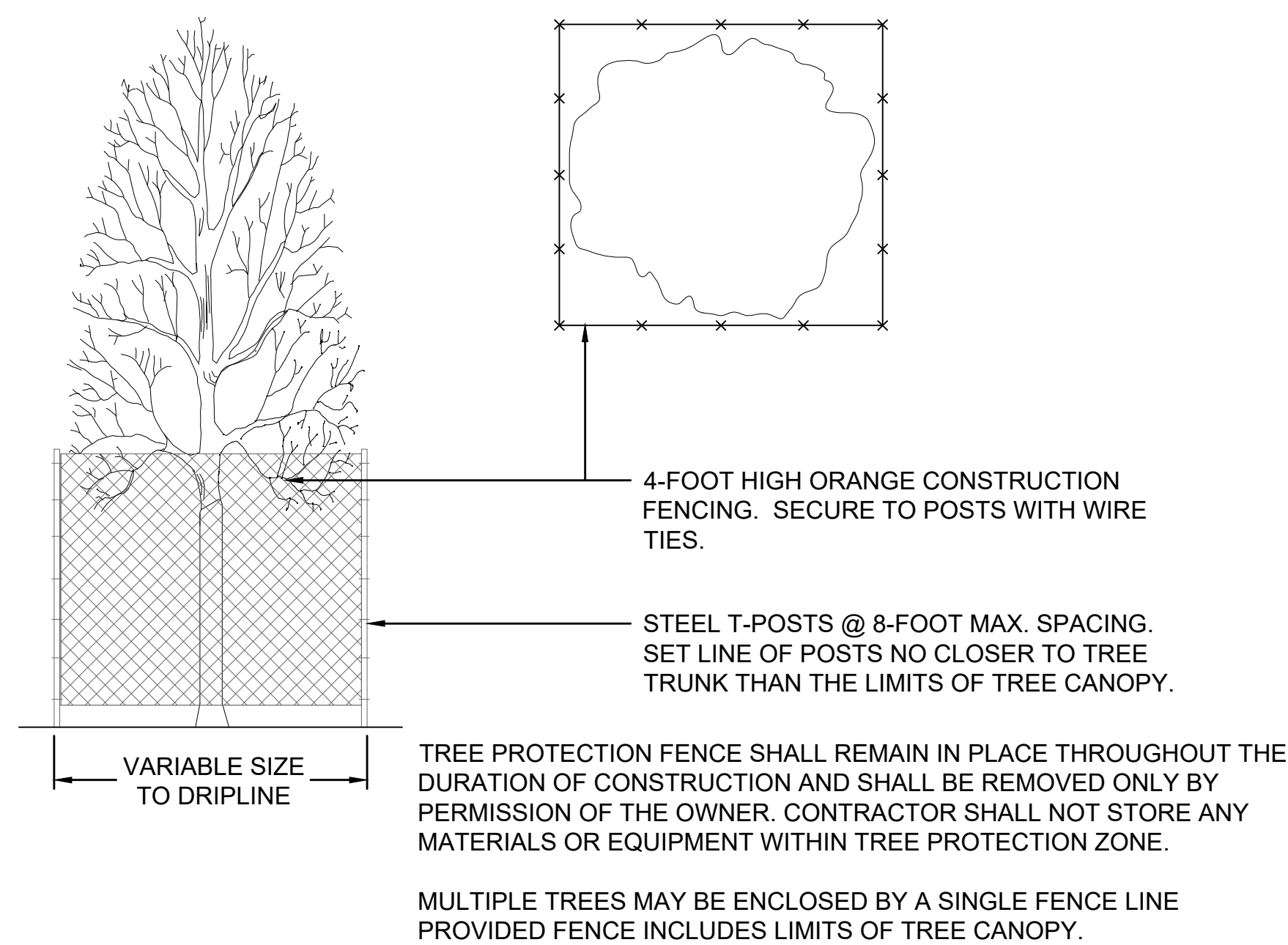

1 TREE PROTECTION DETAIL
 SCALE: NTS

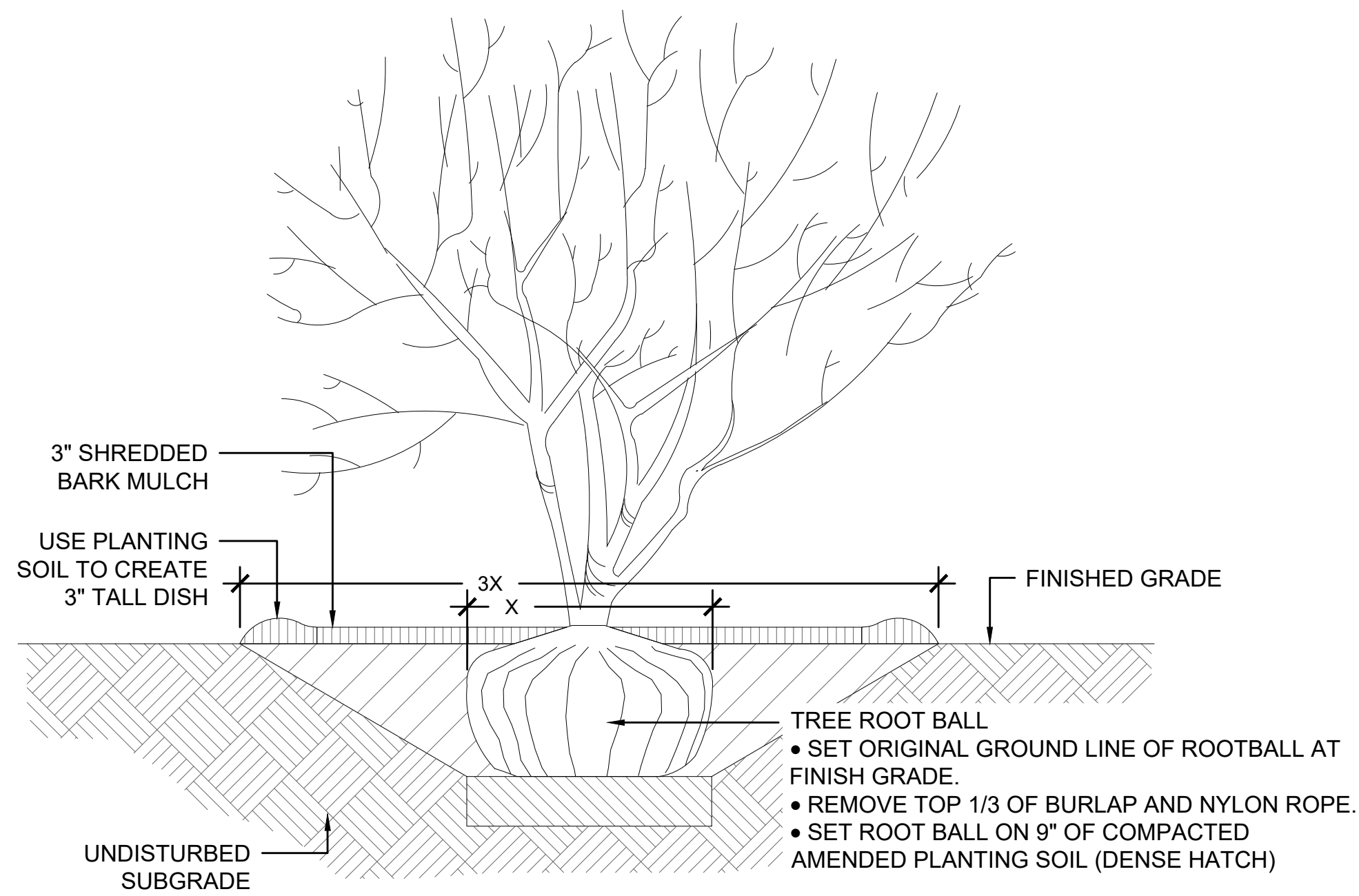

2 SHADE/ORNAMENTAL TREE PLANTING DETAIL
 SCALE: NTS

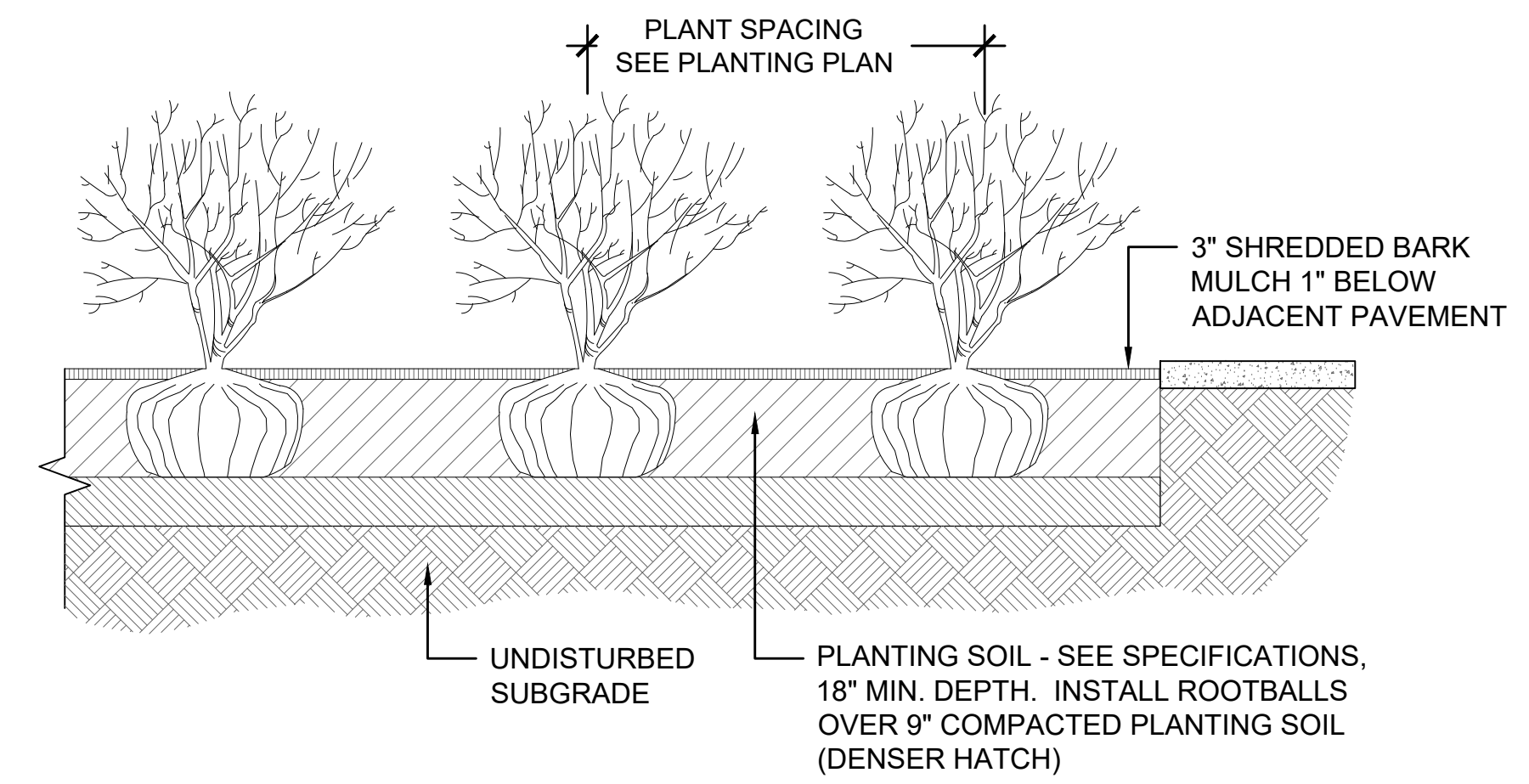

3 SHRUB PLANTING DETAIL
 SCALE: NTS



SKYLINE HONEYLOCUST



AUTUMN BLAZE MAPLE



CHICAGOLAND HACKBERRY



SWISS STONE PINE

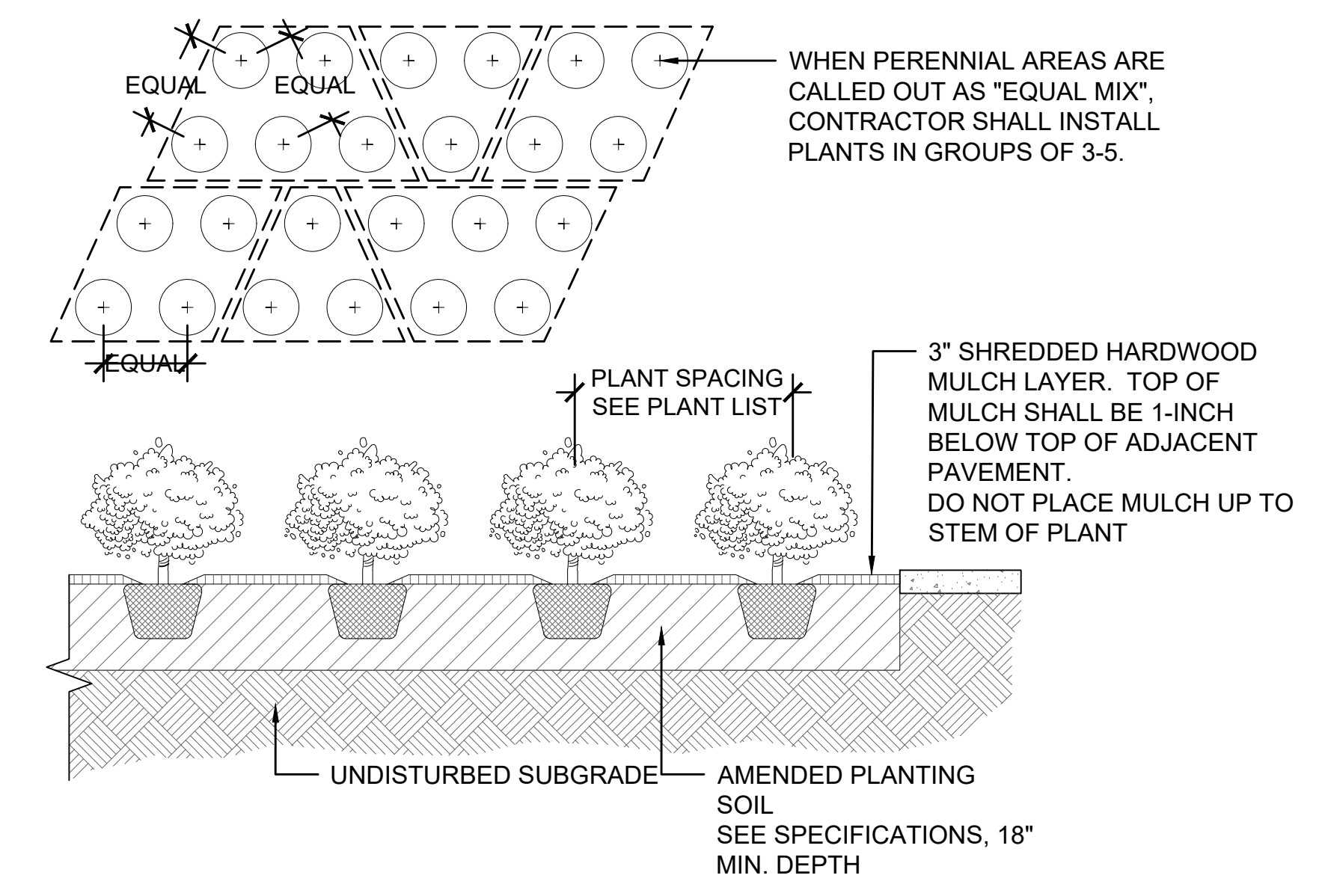

4 GROUNDCOVER / PERENNIAL PLANTING DETAIL
 SCALE: NTS



BLUE MUFFIN VIBURNUM



CHEYENNE PRIVET



KNOCKOUT ROSE



GRO-LOW SUMAC



KARL FOERSTER GRASS



PRAIRIE DROPSEED GRASS



HAPPY RETURNS DAYLILY



MAY NIGHT SALVIA



WALKER'S LOW CATMINT



GUACAMOLE HOSTA

5 PLANT IMAGES
 SCALE: NTS

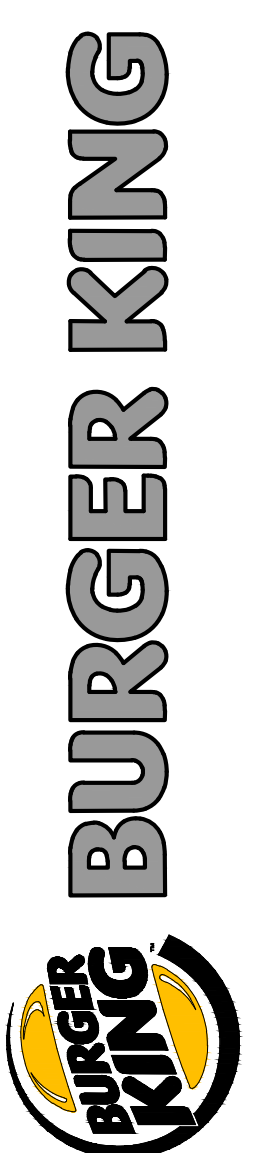

| ISSUE DATES / REVISIONS | | |
|-------------------------|-------------|------|
| | | |
| | | |
| | | |
| | | |
| PERMIT SUBMITTAL | 5.24.19 | |
| NO. | DESCRIPTION | DATE |

| | |
|-------------|---------|
| DRAWN BY: | CM |
| CHECKED BY: | KG |
| DATE: | 4.16.19 |
| PROJECT No: | 19019 |

BURGER KING
 STORE #11321
 2889 E. NEW YORK ST.
 AURORA, IL 60505

LANDSCAPE PLAN
 OAKHURST COMMONS
 RESUBDIVISION, LOT 2