

## Legal Description

SEE ATTACHED

## Locator Map

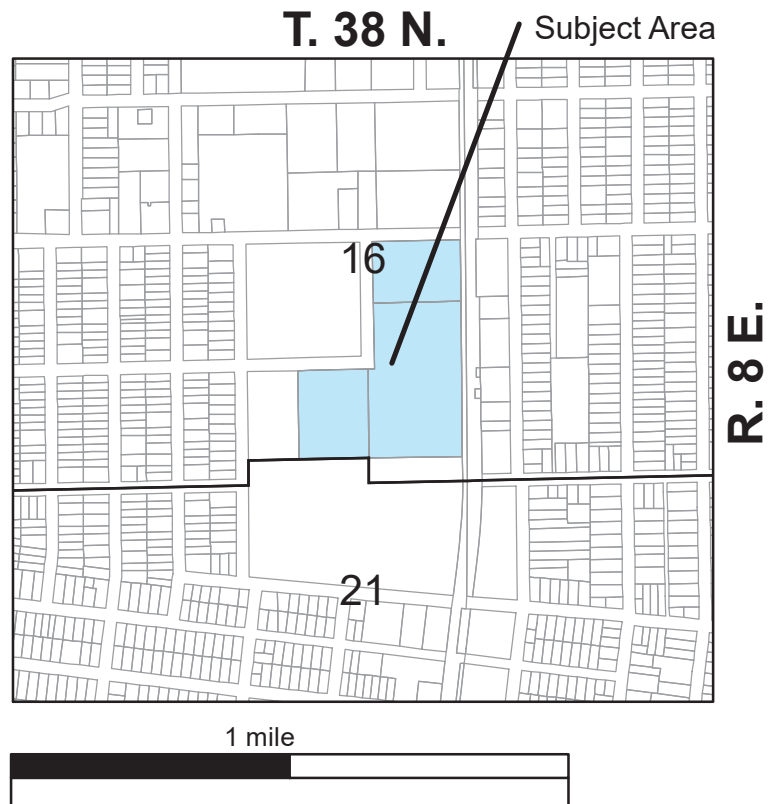

## Actual Area

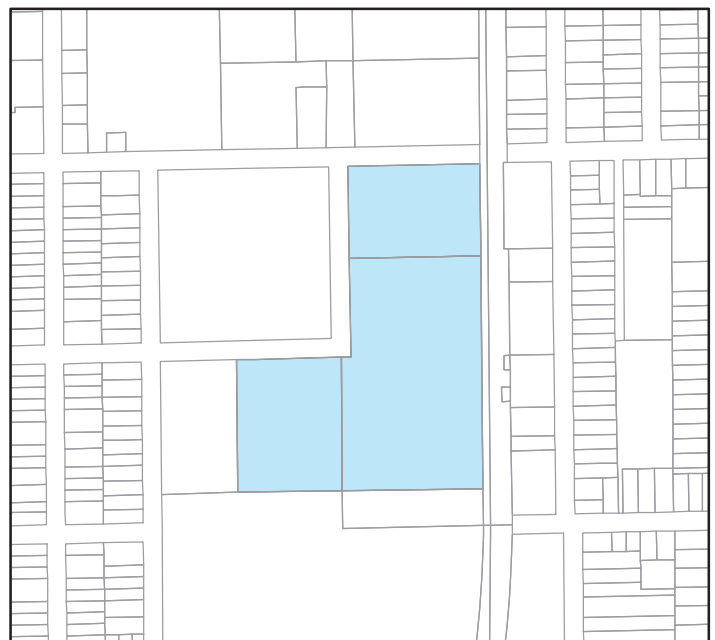

## PIN(s)

15-16-378-005  
15-16-378-007  
15-16-378-008

## Common Address

601 N RUSSEL AV - SEK SUREBOND SUBDIVISION



PARCEL 1:

THAT PART OF THE SOUTH 1/2 OF SECTION 16, TOWNSHIP 38 NORTH, RANGE 8 EAST OF THE THIRD PRINCIPAL MERIDIAN DESCRIBED AS FOLLOWS; BEGINNING AT THE NORTHWEST CORNER OF LOT 1 IN BLOCK IN HOYT'S THIRD ADDITION TO AURORA; THENCE EASTERLY ALONG THE SOUTH SIDE OF ILLINOIS AVENUE FOR A DISTANCE OF 458.48 FEET TO THE WEST RIGHT OF WAY LINE OF BURLINGTON NORTHERN, INC.; THENCE SOUTHERLY ALONG SAID RIGHT OF WAY LINE 320.00 FEET; THENCE WESTERLY 458.74 FEET TO THE SOUTHWEST CORNER OF LOT 8 IN SAID BLOCK 1; THENCE NORTHERLY ALONG THE EAST LINE OF RUSSELL AVENUE 319.91 FEET TO THE POINT OF BEGINNING, IN THE CITY OF AURORA, IN KANE COUNTY, ILLINOIS.

PARCEL 2:

THAT PART OF BLOCKS 1, 7, AND 8 AND VACATED PERRY AVENUE, RUSSELL AVENUE, AND HOYT STREET, ALL IN HOYT'S THIRD ADDITION TO AURORA, AND PART OF THE SOUTHWEST QUARTER OF SECTION 16, TOWNSHIP 38 NORTH, RANGE 8 EAST OF THE THIRD PRINCIPAL MERIDIAN, DESCRIBED AS FOLLOWS; BEGINNING AT THE INTERSECTION OF THE SOUTH LINE OF HOYT STREET WITH THE EAST LINE OF RUSSELL AVENUE; THENCE NORTH ALONG THE EAST LINE OF RUSSELL AVENUE 346.0 FEET TO THE SOUTHWEST CORNER OF VACATED LOT 8 IN BLOCK 1 OF HOYT'S THIRD ADDITION TO AURORA; THENCE EAST AT AN ANGLE OF 90 DEGREES 36 MINUTES 48 SECONDS MEASURED COUNTER CLOCKWISE FROM THE LAST DESCRIBED COURSE 458.62 FEET TO A POINT IN THE WEST LINE OF THE RIGHT OF WAY OF THE BURLINGTON NORTHERN RAILROAD; THENCE SOUTH AT AN ANGLE OF 89 DEGREES 26 MINUTES 02 SECONDS MEASURED COUNTER CLOCKWISE FROM THE LAST DESCRIBED COURSE ALONG SAID WEST LINE 805.87 FEET; THENCE WEST AT AN ANGLE OF 90 DEGREES 34 MINUTES 51 SECONDS MEASURED COUNTER CLOCKWISE FROM THE LAST DESCRIBED COURSE PARALLEL WITH AND 100.00 FEET NORTH OF THE NORTH LINE OF PLUM STREET 855.49 FEET TO THE WEST LINE OF PERRY STREET; THENCE NORTH AT AN ANGLE OF 89 DEGREES 20 MINUTES 46 SECONDS MEASURED COUNTER CLOCKWISE FROM THE LAST DESCRIBED COURSE ALONG SAID WEST LINE 460.00 FEET TO THE SOUTH LINE OF HOYT AVENUE; THENCE EAST ALONG SAID SOUTH LINE TO THE POINT OF BEGINNING, IN THE CITY OF AURORA, KANE COUNTY, ILLINOIS.