

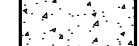







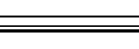

FINAL PLAN FOR CASA DEI BAMBINI

SITE LEGEND

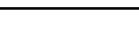
-  INDICATES PAVEMENT
-  INDICATES CONCRETE PAVEMENT AND SIDEWALK
-  INDICATES PAVER AREA
-  LIGHT POLES
-  EXISTING CURB AND GUTTER
-  CURB AND GUTTER
-  ACCESSIBLE SIDEWALK RAMP WITH DETECTABLE WARNING. SEE DETAIL 5/C701
-  INDICATES PARKING COUNT
-  (100 SPACES) INDICATES PARKING TOTAL FOR SURROUNDING AREA
-  PROPERTY BOUNDARY
-  EXISTING RIGHT-OF-WAY
-  PROPOSED FENCE
-  PROPOSED EASEMENT
-  SETBACK LINE

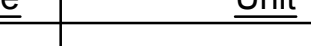
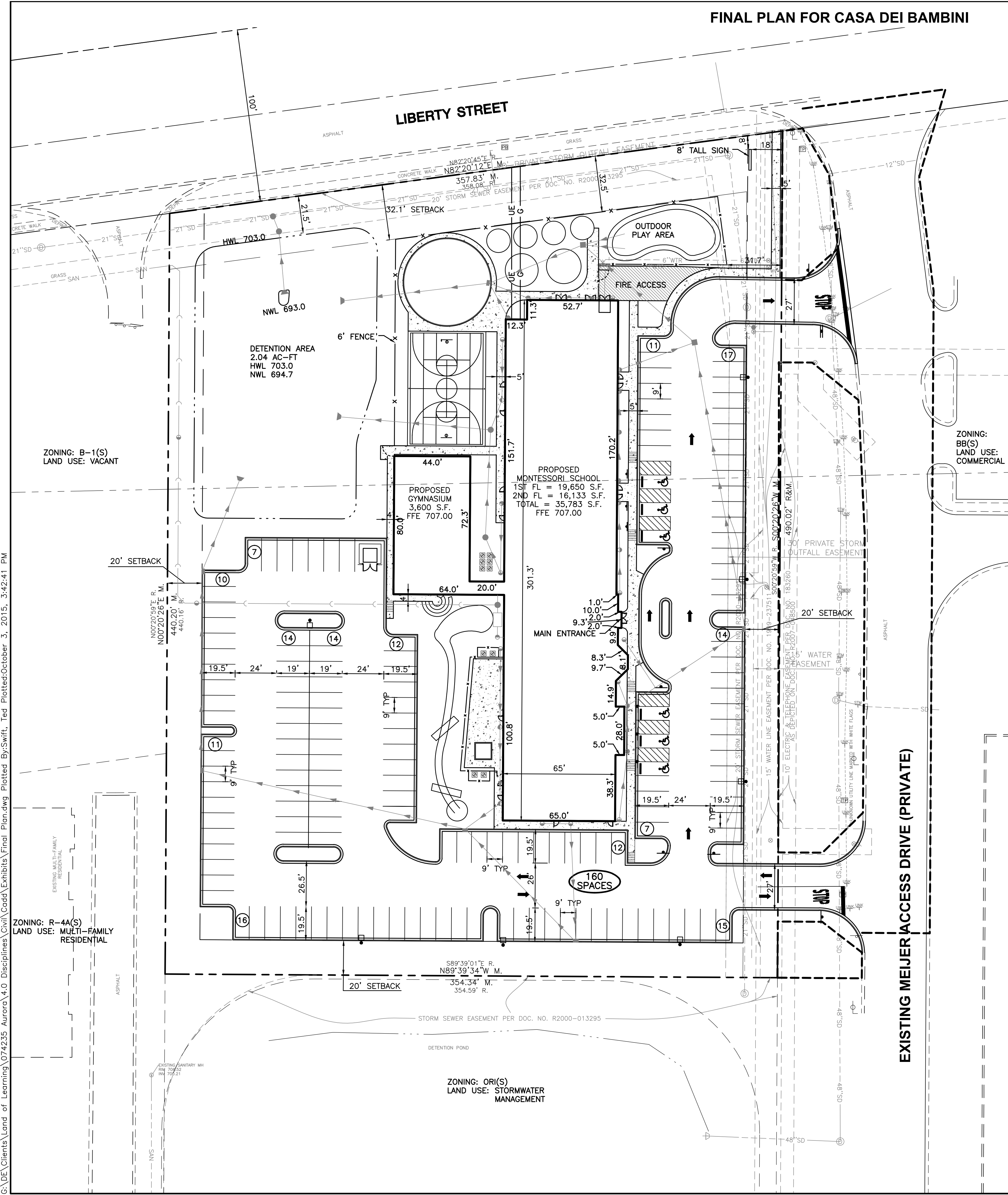

Development Data Table: Qualifying Statement

Description	Value	Unit	Description	Value	Unit
DST Project Number			m) Total High-water Line for all Stormwater Detention/Retention Facilities	0	Linear Footage of Wet Bottom
Petitioner			n) Number of parking spaces provided (individually accessible)	509	Linear Footage of Dry Bottom
Subdivision Name			i. surface parking lot	160.0000	spaces
Subdivision Unit/Phase			perpendicular	160.0000	spaces
Subdivision Lot Number			parallel	0.0000	spaces
a) Tax/Parcel Identification Number(s) (PINs): 07-21-200-052			angled	0.0000	spaces
b) Proposed land use(s): ORI(s), Office, Research and Light Industrial Special Use Plan Development			handicapped	6.0000	spaces
c) Total Property Size	3.79	Acres	ii. enclosed	0.0000	spaces
d) Total Lot Coverage	164,806.00	Square Feet	iii. bike	0.0000	racks
(buildings and pavement)	95,995	Square Feet	o) Number of buildings	1.0000	
e) open space / landscaping	68,881	Square Feet	i. Number of stories	2.0000	stories
	58%	Percent	ii. Building Square Footage (average)	393,833.00	square feet
	42%	Percent	iii. Gross Floor Area of commercial use	0.0000	GFA
f) Proposed New Right-of-way	0.0000	Acres	iv. Building Foundation perimeter (Typical)	1,026.00	Linear Footage
	0.0000	Square Feet			
	0.0000	Linear Feet of Centerline	p) Total Number of Residential Dwelling	0.0000	units
g) Proposed New Easements	0.0000	Acres	i. Gross Density	0.0000	du/acre
	0.0000	Square Feet	ii. Net Density	0.0000	Net Density
	0.0000	Square Feet	q) Land to be dedicated to the School District	0.0000	Acres
h) Total Street Frontage (existing and proposed)	360	Linear Footage	r) Land to be dedicated to the Park District	0.0000	Acres
i) Building Foundation perimeter (Typical)	1,026.00	Linear Footage	s) Construction Value		Dollars
j) Total Perimeter Yard	1,642.00	Linear Footage	t) New Jobs Created		FTE
k) Buffer Yard	1,642.00	Linear Footage	u) Site Disturbance	3.7600	Acres
l) Neighborhood Border	280	Linear Footage	v) School District		
			w) Park District		

EXISTING MEIJER ACCESS DRIVE (PRIVATE)

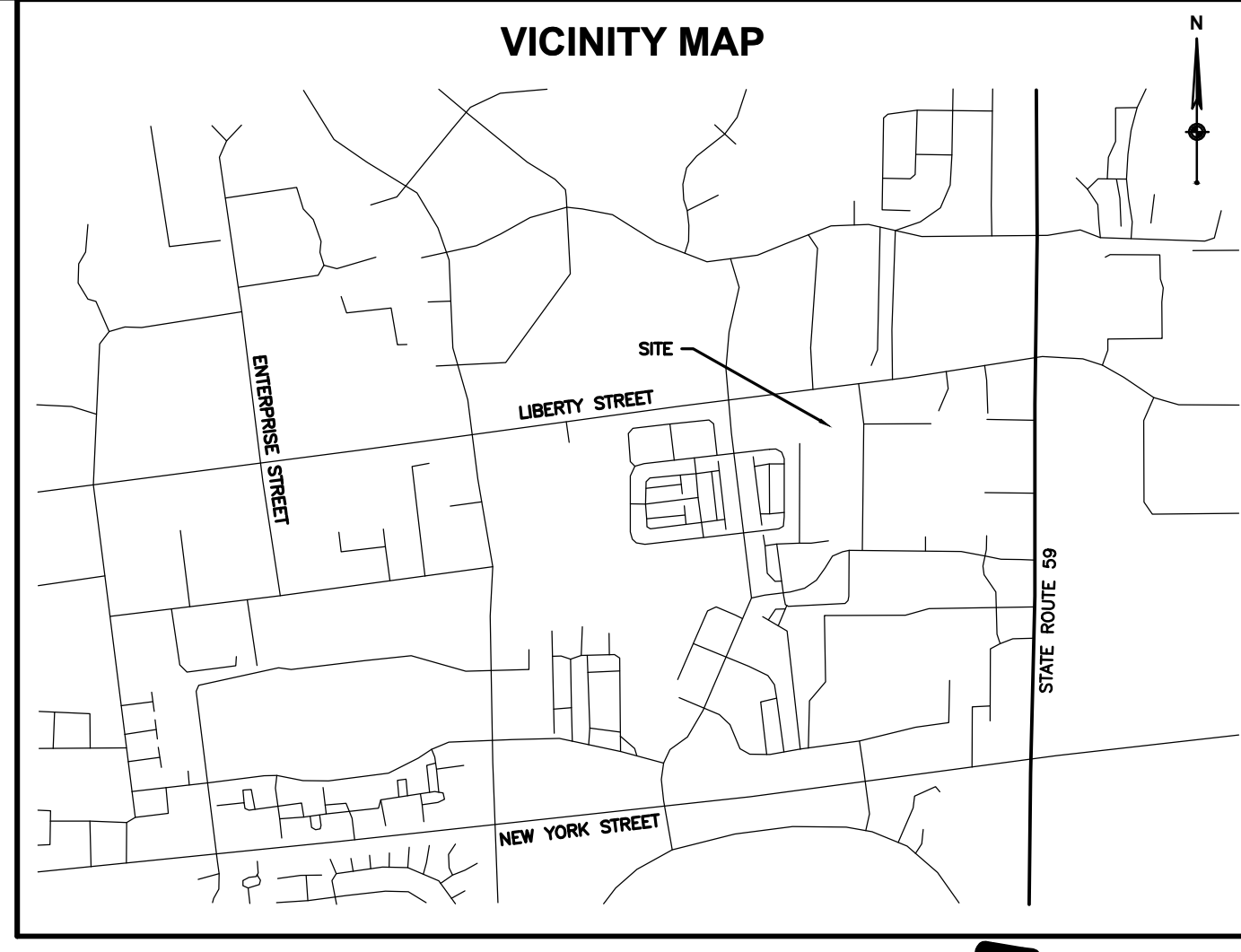

SITE NOTES

- ALL DIMENSIONS, RADII AND COORDINATES ARE TO BACK OF CURB WHERE APPLICABLE. ALL RADII ARE 4' UNLESS INDICATED OTHERWISE.
- ALL PAVEMENT MARKING SHALL BE YELLOW IN COLOR UNLESS INDICATED OTHERWISE.
- ALL CONSTRUCTION ACTIVITIES SHALL CONFORM TO THE ILLINOIS DEPARTMENT OF TRANSPORTATION "STANDARD SPECIFICATIONS FOR ROAD AND BRIDGE CONSTRUCTION" CURRENT EDITION.

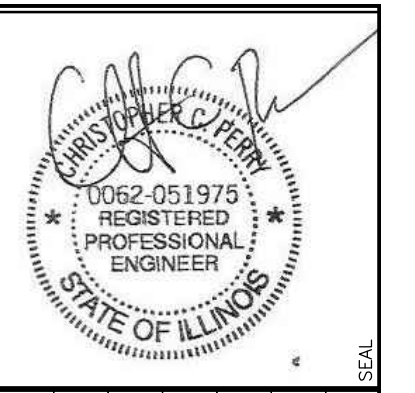
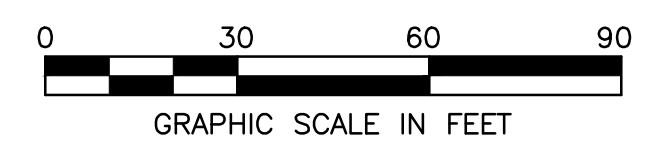

REVISION

No.	DATE	DESCRIPTION

PROJECT NO: 074235
DATE: 07/29/15
DESIGNER: IS
DR: DH
CHECKED: CP

1815 South Meyers Road
 Suite 120
 Oakbrook Terrace, IL 60181
 630.424.9080
 630.495.3731

WOOLPERT
Design & Construction Professionals

FHS DESIGN & BUILD
 OWNER AND PETITIONER

2010 W FULLTON STREET, SUITE F-240, CHICAGO, IL 60612

SITE IMPROVEMENT PLANS
LAND OF LEARNING, LLC
 4395 LIBERTY STREET
 AURORA, ILLINOIS

FINAL PLAN FOR CASA DEI BAMBINI

SHEET NO. **C201**

Layout Tab Name: C200 SITE PLAN, Images: zoom aerial.jpg, Xrefs: 074235-X.dwg, 074235-P.dwg, 074235-TBLK.dwg
 Last Saved By: swift, 10/3/2015 3:38:23 PM
 S:\DE\clients\Land of Learning\074235 Aurora\4.0 Disciplines\Civil\Cadd\Exhibits\Final Plan.dwg Plotted By: Swift, Ted Plotted: October 3, 2015, 3:42:41 PM