

Exhibit "B" District Notice Mailing Affidavit

Casefile Number: SG24/3-24.269-A/F

Petitioner: City of Aurora

City Council Hearing Date: 7/23/2024

An Affidavit as to the Annexation of Certain Territory to the City of Aurora

State of Illinois)
)SS.
County of Kane)

Tracey Vacek, being first duly sworn, upon oath deposes and states as follows:

1. That this affiant is duly authorized to make this affidavit for the City of Aurora.
2. That on July 12, 2024 being at least ten (10) days before and in advance of any action taken for annexation, the County Clerk, County Board Members, Board of Trustees of the Fire Protection District, the Township Supervisor, Township Clerk, the Township Highway Commissioner, and Board of Trustees of the Township, of which land proposed to be annexed is part, were notified in writing, as indicated on the attached annexation notification list, of the proposed annexation herein described.
3. That a copy of the notice served is attached hereto as Attachment "A" Letter of Notification and made part herein and contains the descriptions of the territories proposed to be annexed.
4. Said notices were deposited in the United States Mail at Aurora, Illinois, in envelopes properly addressed with postage and fees for certified mail.

Further Affiant saith naught.

Tracey M Vacek
Petitioner Signature

Given under my hand and notary seal this 12 day of July, 2024.

Sharon M. Burden
Notary Signature

My Commission expires: May 9, 2027

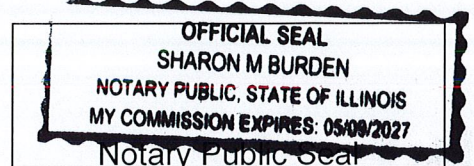

ATTACHMENT "A" LETTER OF NOTIFICATION

NOTICE OF PROPOSED INVOLUNTARY ANNEXATION TO THE CITY OF AURORA OF TERRITORY WITHIN SUGAR GROVE TOWNSHIP, KANE COUNTY, ILLINOIS

To Service List:

You are hereby notified that not less than ten (10) days after the mailing of this Notice to you, the City Council of the City of Aurora, DuPage, Will, Kane and Kendall Counties, Illinois, will consider the involuntary annexation to the City of Aurora of certain property described below. Consideration by the City Council of an ordinance approving the annexation of the property will take place at its regular meeting to be held at the hour of 6 p.m. on Tuesday, July 23, 2024, at the Aurora City Council Chambers, 44 East Downer Place, Aurora, Illinois. The subject property to be considered for annexation (the "Subject Property") is legally described as follows:

PERMANENT REAL ESTATE INDEX NUMBER(S): 14-23-400-026, 14-24-300-001, AND 14-24-151-006

(Taxpayer of Record: RLC Ventures LLC)

COMMONLY KNOWN AS: VACANT PROPERTY BOUNDED BY BARNES ROAD TO THE EAST, COMED UTILITY RIGHT-OF-WAY TO THE WEST, PROGRESSIVE CHURCH TO THE NORTH AND BNSF RAILWAY TO THE SOUTH, IN SUGAR GROVE TOWNSHIP, KANE COUNTY, IL

LEGAL DESCRIPTION:

THAT PART OF THE EAST 1/2 OF SECTION 23 AND THAT PART OF THE WEST 1/2 OF SECTION 24, TOWNSHIP 38 NORTH, RANGE 7 EAST OF THE THIRD PRINCIPAL MERIDIAN, DESCRIBED AS FOLLOWS: COMMENCING AT THE SOUTHEAST CORNER OF THE SOUTHWEST QUARTER OF SAID SECTION 24; THENCE SOUTH 88 DEGREES 47 MINUTE, 41 SECONDS WEST ALONG THE SOUTH LINE OF SAID SOUTHWEST QUARTER 1560.80 FEET TO THE CENTERLINE OF BARNES ROAD; THENCE NORTH 5 DEGREES 48 MINUTES 19 SECONDS WEST ALONG SAID CENTERLINE 1082.39 FEET TO THE NORTHERLY RIGHT OF WAY LINE OF THE BURLINGTON NORTHERN INC (FORMERLY KNOWN AS THE BURLINGTON RAILROAD COMPANY) LANDS RUNNING WESTERLY, SAID NORTHERLY RIGHT OF WAY BEING 85.0 FEET NORMALLY DISTANT NORTHERLY FROM THE CENTERLINE OF SAID RAILROAD; THENCE NORTH 72 DEGREES 46 MINUTES WEST ALONG SAID NORTHERLY RIGHT OF WAY LINE 678.0 FEET FOR A POINT OF BEGINNING; THENCE CONTINUING NORTH 72 DEGREES 46 MINUTES WEST ALONG SAID RIGHT OF WAY LINE, 1077.11 FEET TO AN OLD CLAIM LINE; THENCE NORTH 6 DEGREES 15 MINUTES 29 SECONDS EAST ALONG SAID CLAIM LINE, 5.09 FEET TO AN EASTERLY LINE OF PROPERTY CONVEYED TO COMMONWEALTH EDISON COMPANY BY DOCUMENT NO. 1241630; THENCE NORTH 19 DEGREES 25 MINUTES 27 SECONDS EAST ALONG SAID EASTERLY LINE, 888.95 FEET TO ANGLE POINT IN SAID EASTERLY LINE; THENCE NORTH 6 DEGREES 15 MINUTES 29 SECONDS EAST ALONG SAID EASTERLY LINE 120.40 FEET TO THE SOUTH LINE OF PROPERTY DESCRIBED IN DOCUMENT NO. 2001K003714; THENCE NORTH 85 DEGREES 55 MINUTES 48 SECONDS EAST 1066.17 FEET TO THE CENTERLINE OF BARNES ROAD; THENCE SOUTH 18 DEGREES 13 MINUTES 02 SECONDS EAST 697.00 FEET TO AN ANGLE POINT IN SAID CENTER LINE; THENCE SOUTH 5 DEGREES 18 MINUTES 19 SECONDS EAST, ALONG SAID CENTERLINE, 761.18 FEET TO A POINT THAT IS 139.0 FEET NORTHERLY OF, AS MEASURED ALONG SAID CENTERLINE, THE NORTHERLY RIGHT OF WAY LINE OF SAID RAILROAD; THENCE NORTH 84 DEGREES 22 MINUTES 46 SECONDS WEST 637.78 FEET TO THE POINT OF BEGINNING, ALL IN SUGAR GROVE TOWNSHIP, KANE COUNTY, ILLINOIS.

PERMANENT REAL ESTATE INDEX NUMBER(S): 14-24-300-002 (Taxpayer of Record: Youhanaie Family Trust, Trust #3, c/o Andrew & Marilyn J Youhanaie)

COMMONLY KNOWN AS: 7 S 778 BARNES RD, AURORA, IN SUGAR GROVE TOWNSHIP, KANE COUNTY, IL

LEGAL DESCRIPTION:

THAT PART OF THE WEST HALF OF SECTION 24, TOWNSHIP 38 NORTH, RANGE 7 EAST OF THE THIRD PRINCIPAL MERIDIAN, DESCRIBED AS FOLLOWS: BEGINNING AT A POINT IN THE QUARTER SECTION LINE 10.84 CHAINS EAST OF THE NORTHWEST CORNER OF THE SOUTHWEST QUARTER OF SECTION 24; THENCE SOUTH 17.75° EAST ALONG THE CENTER OF THE ROAD 9.87 CHAINS; THENCE SOUTH 4 ½° EAST ALONG THE CENTER OF SAID ROAD 15.2 CHAINS MORE OR LESS TO THE NORTH LINE OF THE RIGHT OF WAY OF THE CHICAGO AND IOWA RAILWAY, NOW KNOWN AS THE CHICAGO, BURLINGTON AND QUINCY RAILWAY, FOR THE POINT OF BEGINNING; THENCE NORTHWESTERLY ALONG THE SAID NORTH LINE OF SAID RIGHT OF WAY 678 FEET; THENCE IN AN EASTERLY DIRECTION 685 FEET TO A POINT IN THE CENTER OF SAID ROAD 139 FEET NORTHERLY ALONG THE CENTER OF SAID ROAD FROM THE POINT OF BEGINNING; THENCE SOUTHERLY ALONG THE CENTER OF SAID ROAD 139 FEET TO THE POINT OF BEGINNING; IN THE TOWNSHIP OF SUGAR GROVE, KANE COUNTY, ILLINOIS.

PERMANENT REAL ESTATE INDEX NUMBER(S): 14-24-300-031 (Taxpayer of Record: International Church of Foursquare Gospel)

COMMONLY KNOWN AS: 7 S 641 BARNES RD, AURORA, IN SUGAR GROVE TOWNSHIP, KANE COUNTY, IL

THAT PART OF THE SOUTHWEST QUARTER OF SECTION 24, TOWNSHIP 38 NORTH, RANGE 7 EAST OF THE THIRD PRINCIPAL MERIDIAN DESCRIBED AS FOLLOWS: COMMENCING AT THE SOUTHWEST CORNER OF MEADOW BROOK ESTATES AS RECORDED IN PLAT BOOK 42 ON PAGE 10 AS DOCUMENT NO. 950385; THENCE SOUTH 05 DEGREES 22 MINUTES 25 SECONDS WEST ALONG THE CENTERLINE OF BARNES ROAD, 43.24 FEET TO AN ANGLE POINT IN SAID CENTERLINE; THENCE SOUTH 18 DEGREES 13 MINUTES 02 SECONDS EAST ALONG SAID CENTERLINE, 697.00 FEET TO AN ANGLE POINT IN SAID CENTERLINE FOR A POINT OF BEGINNING; THENCE SOUTH 05 DEGREES 18 MINUTES 19 SECONDS EAST ALONG SAID CENTERLINE, 295.16 FEET; THENCE NORTH 84 DEGREES 41 MINUTES 41 SECONDS EAST, PERPENDICULAR TO SAID CENTERLINE, 295.16 FEET; THENCE NORTH 05 DEGREES 18 MINUTES 19 SECONDS WEST, PARALLEL WITH SAID CENTERLINE, 295.16 FEET; THENCE SOUTH 84 DEGREES 14 MINUTES 41 SECONDS WEST, PERPENDICULAR TO THE LAST DESCRIBED COURSE, 295.16 FEET TO THE POINT OF BEGINNING, IN THE TOWNSHIP OF SUGAR GROVE, KANE COUNTY, ILLINOIS.

Such annexation is being contemplated under the provisions of Section 7-1-13 of the Illinois Municipal Code (65 ILCS 5/7-1-13) and the City Council may take final action on the annexation ordinance at the aforesaid meeting of July 23, 2024, or may continue consideration to another date, time and place in compliance with the Illinois Open Meetings Act. The property being considered for annexation is less than sixty (60) acres in size and shall be wholly bounded by the City of Aurora and the City of Kane County Forest Preserve District upon annexation by the City of Aurora.

Upon annexation of the Subject Property, the new corporate boundaries of the City of Aurora shall include all the above property and shall extend to the far side of any adjacent highway, street or right-of-way, and shall include all of every highway, street or right-of-way within or contiguous to each area annexed to the extent that any such highway, street or right-of-way is not currently located within the boundaries of an incorporated municipality.

A LOCATION MAP IS ALSO ATTACHED TO THIS NOTICE

This letter, including the exhibits and attachments, has been prepared and mailed by:

Tracey M. Vacek

Name

Duly Authorized Agent

Designate whether Owner of Record, contract purchaser, or
Duly Authorized Agent for one of the above

Tracey M. Vacek

Signature

July 11, 2024

Date of Signature

This Notice Sent

BY ORDER OF THE

AURORA CITY COUNCIL

LOCATION MAP

For the property generally bounded by the Kane County Forest Preserve to the east, ComEd utility right-of-way to the west, Progressive Baptist Church to the north, and the BNSF Railway to the south

Location Map (1:10,000)

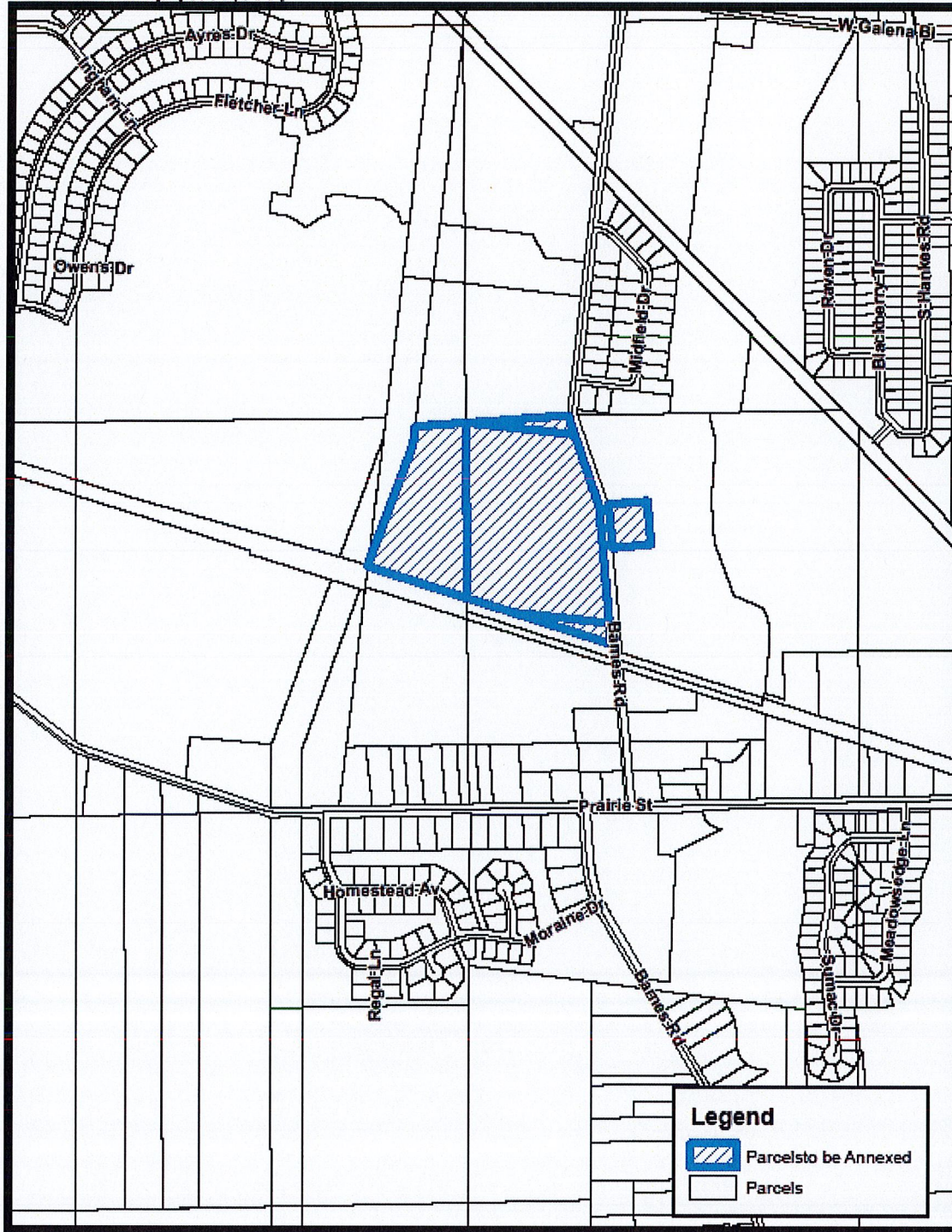

NOTIFICATION LIST

For the property generally bounded by the Kane County Forest Preserve to the east, ComEd utility right-of-way to the west, Progressive Baptist Church to the north, and the BNSF Railway to the south

County

John Cunningham, Clerk
719 S. Batavia Avenue, Building B
Geneva, IL 60134

Corinne Pierog, Madam Chair
719 S. Batavia Avenue, Building A
Geneva, IL 60134

Myrna Molina, County Board District 1
719 S. Batavia Avenue, Building A
Geneva, IL 60134

Dale Berman, County Board District 2
719 S. Batavia Avenue, Building A
Geneva, IL 60134

Anita Lewis, County Board District 3
719 S. Batavia Avenue, Building A
Geneva, IL 60134

Mavis Bates, County Board District 4
719 Batavia Avenue, Building A
Geneva, IL 60134

Bill Lenert, County Board District 5
719 S. Batavia Avenue, Building A
Geneva, IL 60134

Ron Ford, County Board District 6
719 S. Batavia Avenue, Building A
Geneva, IL 60134

Monica Silva, County Board District 7
719 S. Batavia Avenue, Building A
Geneva, IL 60134

Michelle Gumz, County Board District 8
719 S. Batavia Avenue, Building A
Geneva, IL 60134

Gary Daugherty, County Board District 9
719 S. Batavia Avenue, Building A
Geneva, IL 60134

Bill Tarver, County Board District 10
719 S. Batavia Avenue, Building A
Geneva, IL 60134

Leslie Juby, County Board District 11
719 S. Batavia Avenue, Building A
Geneva, IL 60134

Bill Roth, County Board District 12
719 S. Batavia Avenue, Building A
Geneva, IL 60134

Michael Linder, County Board District 13
719 S. Batavia Avenue, Building A
Geneva, IL 60134

Mark Davoust, County Board District 14
719 S. Batavia Avenue, Building A
Geneva, IL 60134

David Young, County Board District 15
719 Batavia Avenue, Building A
Geneva, IL 60134

Michael Kenyon, County Board District 16
719 S. Batavia Avenue, Building A
Geneva, IL 60134

Deborah Allan, County Board District 17
719 S. Batavia Avenue, Building A
Geneva, IL 60134

Rick Williams, County Board District 18
719 S. Batavia Avenue, Building A
Geneva, IL 60134

Mohammad Iqbal, County Board District 19
719 S. Batavia Avenue, Building A
Geneva, IL 60134

Cherryl Fritz Strathmann, County Board District 20
719 S. Batavia Avenue, Building A
Geneva, IL 60134

Clifford Surges, County Board District 21
719 S. Batavia Avenue, Building A
Geneva, IL 60134

Verner Tepe, County Board District 22
719 S. Batavia Avenue, Building A
Geneva, IL 60134

Chris Kious, County Board District 23
719 S. Batavia Avenue, Building A
Geneva, IL 60134

Jarett Sanchez, County Board District 24
719 S. Batavia Avenue, Building A
Geneva, IL 60134

Fire Protection District

David Blankenship, President
25 S. Municipal Drive
Sugar Grove, IL 60554

Nicole Lamela, Treasurer
25 S. Municipal Drive
Sugar Grove, IL 60554

Tim Cicero, Secretary
25 S. Municipal Drive
Sugar Grove, IL 60554

Patrick Hines, Trustee
25 S. Municipal Drive
Sugar Grove, IL 60554

Mike Fagel, Trustee
25 S. Municipal Drive
Sugar Grove, IL 60554

Township

Tom Rowe, Supervisor
54 Snow Street, P.O. Box 465
Sugar Grove, IL 60554

Doug Musser, Highway Commissioner
54 Snow Street, P.O. Box 465
Sugar Grove, IL 60554

Curt John Karas, Assessor
54 Snow Street, PO Box 465
Sugar Grove, IL 60554

Marion Bond, Clerk
54 Snow Street, P.O. Box 465
Sugar Grove, IL 60554

Phil Silagi, Trustee
54 Snow Street, P.O. Box 465
Sugar Grove, IL 60554

Jon Bobbe, Trustee
54 Snow Street, P.O. Box 465
Sugar Grove, IL 60554

Lewis Medina, Trustee
54 Snow Street, P.O. Box 465
Sugar Grove, IL 60554

Jerry Elliott, Trustee
54 Snow Street, P.O. Box 465
Sugar Grove, IL 60554