

Fire Access Plan for CyrusOne - Phase 2, Lot 1.

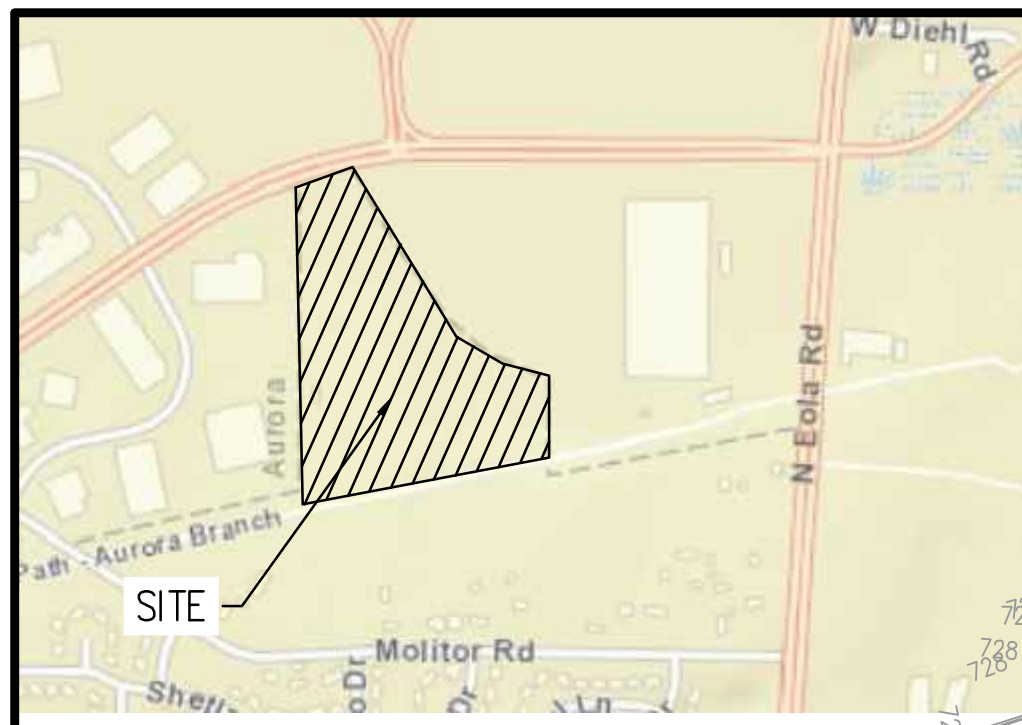

SITE LOCATION MAP
N.T.S.

- LEGEND**
- RIGHT OF WAY LINE
 - - - PROPERTY LINE
 - - - UTILITY EASEMENT
 - - - CURB AND GUTTER
 - - - WATER MAIN
 - - - FENCE
 - VALVE VAULT
 - VALVE BOX
 - FIRE HYDRANT

- SITE NOTES**
- 1 EXISTING FIRE HYDRANT
 - 2 PROPOSED FIRE HYDRANT
 - 3 EXISTING 8" WATERMAIN
 - 4 PROPOSED FIRE APPARATUS ACCESS ROAD
 - 5 EXISTING SECURITY FENCE AND GATE WITH LOCK BOX FOR EMERGENCY ACCESS
 - 6 PROPOSED FDC 4" STORZ CONNECTION WITH 30° ELBOW TO GRADE
 - 7 EXISTING 12" WATERMAIN
 - 8 8" WATERMAIN CONNECTION TO BUILDING
 - 9 APPROXIMATE LOCATION OF SPRINKLER RISE ROOM, W/ EXTERNAL ACCESS (SEE ARCH. PLAN)
 - 10 FLUSHING HYDRANT AND TEE

- FIRE NOTES:**
1. LOCATION AND DETAILS OF SPRINKLER RISER AREAS, AND LOCATION OF EXTERIOR ACCESS TO RISER ROOM: SPRINKLER ROOM TO BE LOCATED ON NORTH SIDE OF BUILDING WITH EXTERIOR ACCESS DOOR PROVIDED.
 2. PROPOSED FENCING: THERE IS PROPOSED SECURITY FENCING AROUND THE ENTIRE SITE. A GATE & SECURITY STATION ARE PROPOSED AT THE NORTHEAST CORNER OF THE SITE, ALONG WITH A RIGHT TURN ONLY EXIT.
 3. PROVIDE A 1 HOUR RATED ENCLOSURE FOR FIRE PUMPS, FIRE PROTECTION RISER AREAS AND/ OR SPRINKLER CONTROL VALVE AREAS PER THE INTERNATIONAL FIRE CODE, SECTION 509.3.
 4. PROVIDE STANDPIPE INSIDE BUILDING WHERE THE MOST REMOTE PORTION OF A SPRINKLERED FLOOR OR STORY IS MORE THAN 200' FROM A HOSE CONNECTION, THE FIRE CODE OFFICIAL IS AUTHORIZED TO REQUIRE THAT ADDITIONAL HOSE CONNECTIONS BE PROVIDED IN APPROVED LOCATIONS PER INTERNATIONAL FIRE CODE, SECTION 905.4, SEE ARCHITECTURAL PLANS FOR DETAILS.
 5. UNLESS OTHERWISE NOTED, ALL DIMENSIONS ARE TO FACE OF CURB.

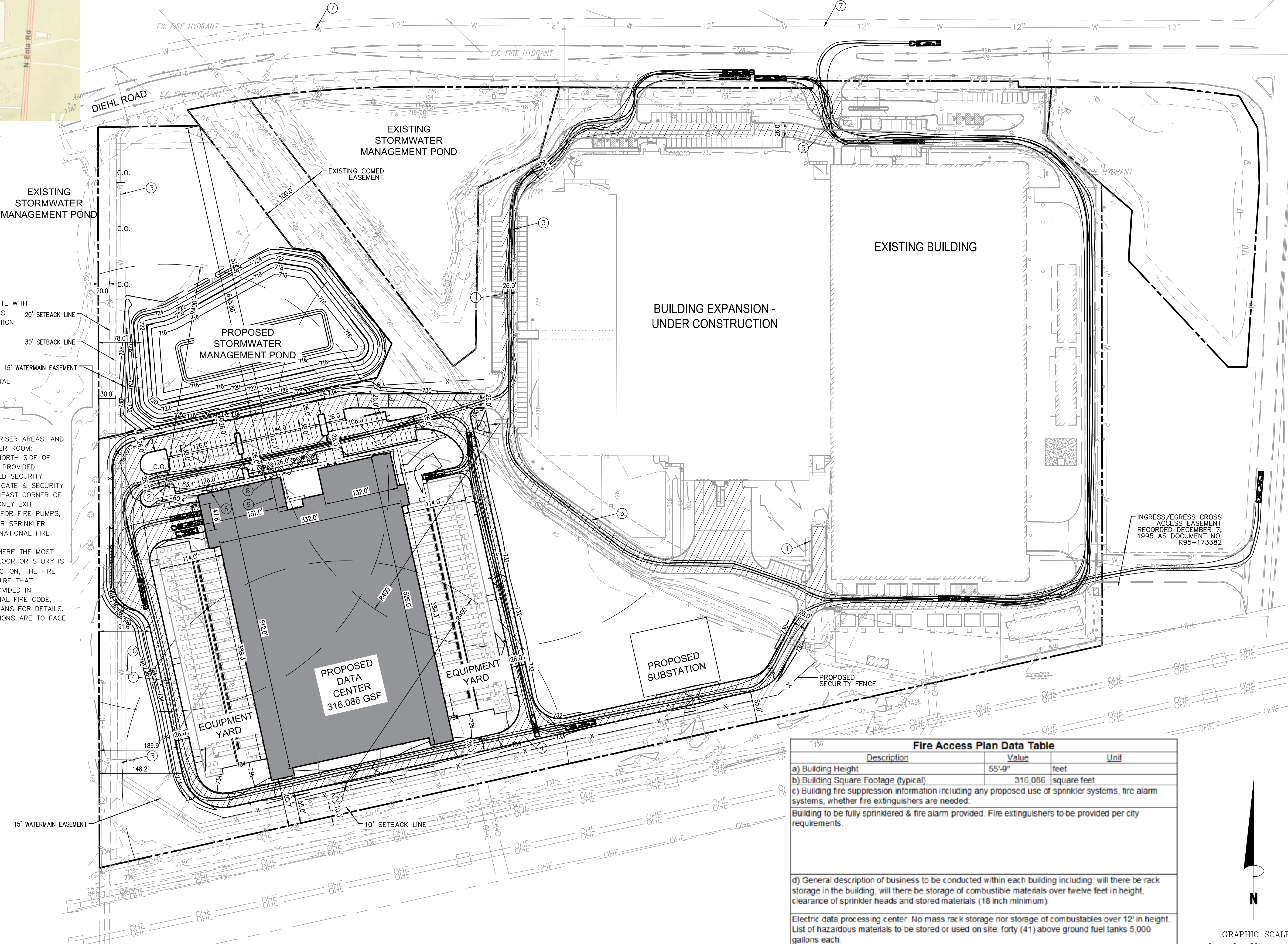

Fire Access Plan Data Table		
Description	Value	Unit
a) Building Height	55'-9"	feet
b) Building Square Footage (typical)	316,086	square feet
c) Building fire suppression information including any proposed use of sprinkler systems, fire alarm systems, whether fire extinguishers are needed: Building to be fully sprinklered & fire alarm provided. Fire extinguishers to be provided per city requirements.		
d) General description of business to be conducted within each building including: will there be rack storage in the building, will there be storage of combustible materials over twelve feet in height, clearance of sprinkler heads and stored materials (18 inch minimum): Electric data processing center. No mass rack storage nor storage of combustibles over 12' in height. List of hazardous materials to be stored or used on site: forty (41) above ground fuel tanks 5,000 gallons each.		

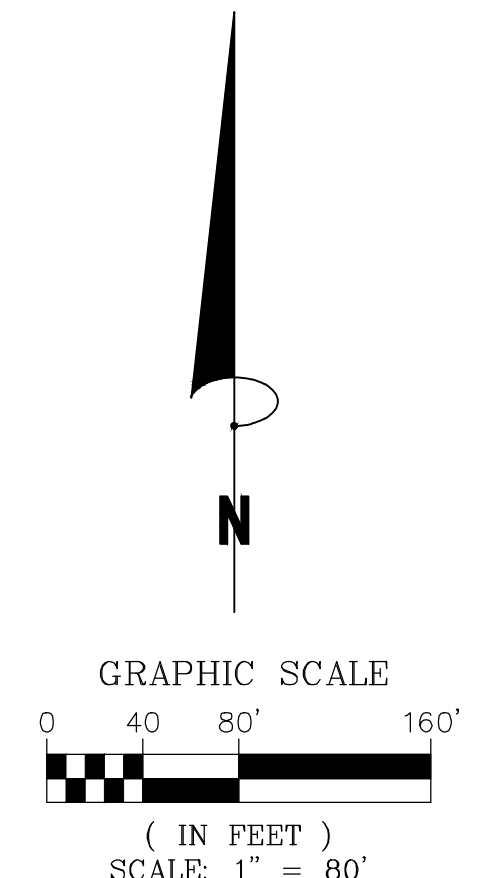

Bowman
CONSULTING

Bowman Consulting Group, Ltd.
440 South LaSalle Street,
Suite 3000A
Chicago, IL 60605
Phone: (312) 614-0360
www.bowmanconsulting.com
© Bowman Consulting Group, Ltd.

FIRE ACCESS PLAN
CYRUSONE AURORA DCIII
FINAL PLAN CYRUSONE SUBDIV. - PHASE 2, LOT 1
PETITIONER: JUAN VASQUEZ
2905 DIEHL ROAD
AURORA, ILLINOIS
DUPAGE COUNTY

FOR REVIEW
NOT FOR
CONSTRUCTION

PLAN STATUS
06/02/2017 OWNER'S REVIEW
09/01/2017 ISSUE FOR PERMIT
11/17/2017 FINAL PLAN

DATE	DESCRIPTION
JLT	JLT PH
DESIGN	DRAWN CHKD
SCALE 1" = 80'	
JOB No. 40029-01-005	
DATE 11/16/2017	
FILE 40029-01-005-D-CP-FRP	
C07-01	
SHEET	