



PRESENTATION TO THE AURORA CITY COUNCIL

June 20, 2023

INTRODUCTIONS

- Greg Moore, Vice President & General Manager, Hollywood Casino Aurora
- Mike Carroll, Vice President, Design & Construction, PENN Entertainment

AGENDA

1. Hollywood Casino Aurora & Opportunity to Relocate
2. Site Plans for Proposed Relocation
3. Conclusion

1

HOLLYWOOD CASINO AURORA & OPPORTUNITY TO RELOCATE

Greg Moore

HOLLYWOOD *Casino* — AURORA —

- Opened in 1993
- Penn National purchased in 2003
- 53,000 square feet of gaming space
- 1,200 gaming positions
- Aging barge-based facility



THE ILLINOIS GAMING MARKET HAS CHANGED OVER THE LAST 10+ YEARS

Hollywood Aurora Gross Gaming Revenues &
City of Aurora Gaming Tax Related Revenues

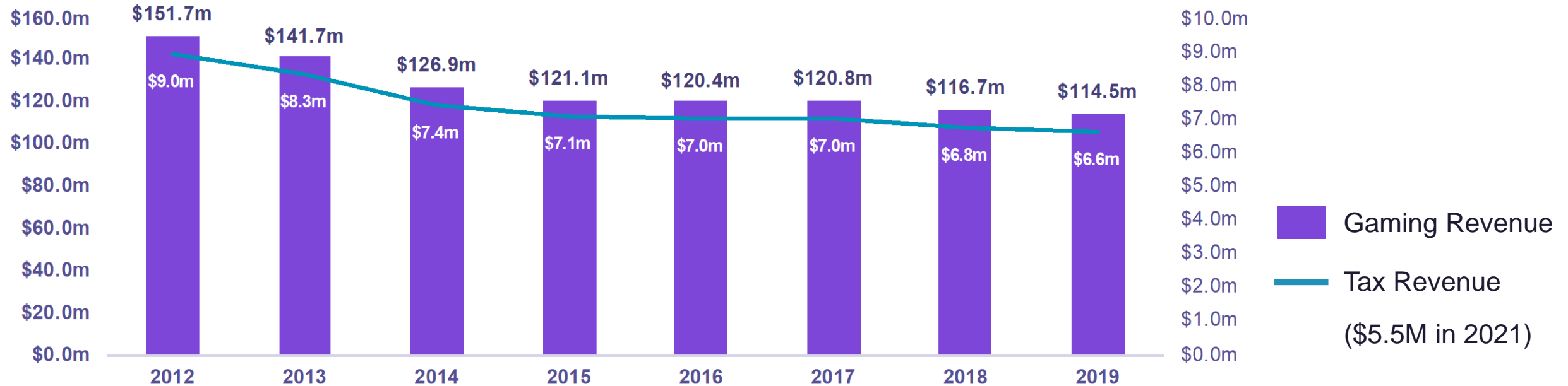

Macro Level Revenue Influencers

- Smoke Free Illinois Act
- Legalization of Video Gaming Terminals
- Opening of Rivers Des Plaines
- More Expansion on the Horizon
 - New Casinos in Chicagoland
 - Existing facilities can move landside

OPPORTUNITY TO RELOCATE

- **Partnership with the City**

- 2019 legislation permitted land-side relocation of the casino
- The City envisioned this opportunity and proactively acquired and optioned land for the new development

- **Superior Location**

- The I-88 interchange at Farnsworth Avenue is a high-visibility location with existing infrastructure due to the Chicago Premium Outlets
- Expected increase in tax revenue
- Hundreds of new construction jobs and approximately 700 permanent jobs
- Union and MBE/WBE/VBE opportunities
- LEED Certification

PROPOSED NEW HOLLYWOOD CASINO AURORA

- ~\$360M Casino & Hotel
- New restaurants, including:
 - Casual Steakhouse
 - Asian Noodle Bar
- ~220 hotel rooms
- 1,200 gaming positions
- Barstool Sportsbook
- Event Center
- Outdoor Entertainment Area
- 1,600 parking spaces



2

SITE PLAN AND RENDERINGS FOR PROPOSED RELOCATION

Mike Carroll

HOLLYWOOD *Casino*®

Video

BILTER RD (E) EL= +740'

(E) EL= +750'

CHURCH RD

(E) EL= +750'

TDR

KIT.

MP/
BALLROOM

MP/EVENT
COURTYARD

CASINO
(N) EL= +736'

(E) EL= +732'

(E) EL= +730'

(N) EL= +736'

(E) EL= +729'

(N) EL= +726'

WORTH AVE



BILTER RD (E) EL= +740'

CHURCH RD
(E) EL= +750'



NORTH AVE





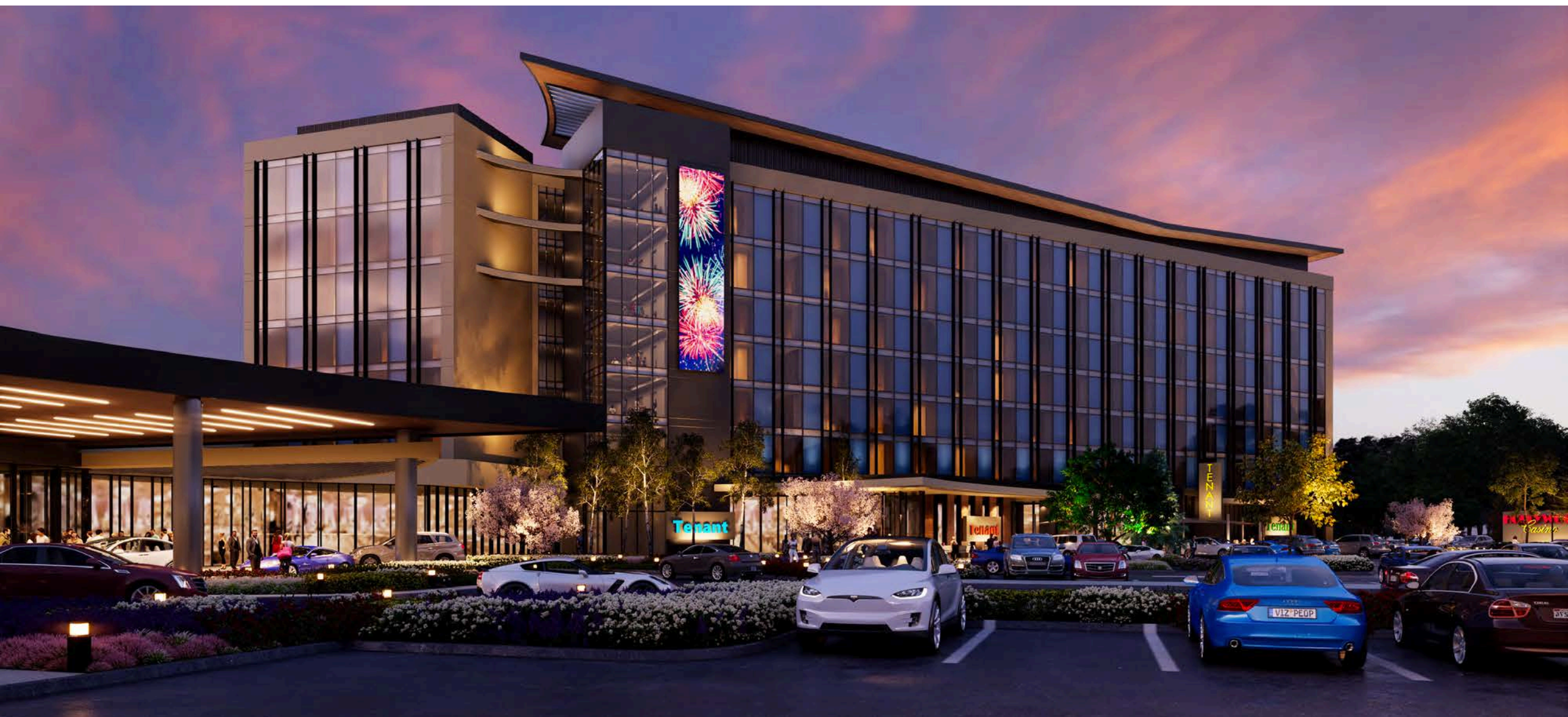

THANK YOU

