

**SSA# 183
TIME LINE
BICKFORD OF AURORA**

ROUND ONE PUBLIC HEARING

CITY OF AURORA
ORDINANCE NO. _____
DATE OF PASSAGE: _____

AN ORDINANCE PROPOSING THE ESTABLISHMENT OF
SPECIAL SERVICE AREA #183
BICKFORD OF AURORA
KANE COUNTY
IN THE CITY OF AURORA AND
PROVIDING FOR A PUBLIC HEARING
AND OTHER PROCEDURES IN CONNECTION THEREWITH

Finance Committee Referral Deadline Ordinance	11/20/15
Finance Committee Proposing Ordinance	11/24/15
COW Proposing Ordinance	12/01/15
CC Proposing Ordinance PUBLIC HEARING	12/08/15
Publish Notice By (15 days minimum/30 maximum)	11/20/15
Mail Notice By (10 days minimum)	11/20/15
Petition deadline (60 days after public hearing)	02/06/16

CITY OF AURORA
ORDINANCE NO. _____
DATE OF PASSAGE: _____
AN ORDINANCE PROPOSING THE ESTABLISHMENT OF
A SPECIAL SERVICE AREA #183
BICKFORD OF AURORA
KANE COUNTY
IN THE CITY OF AURORA AND
PROVIDING FOR A PUBLIC HEARING
AND OTHER PROCEDURES IN CONNECTION THEREWITH

WHEREAS, the City of Aurora has a population of more than 25,000 persons and is, therefore, a home rule unit under subsection (a) of Section 6 of Article VII of the Illinois Constitution of 1970; and

WHEREAS, subject to said Section, a home rule unit may exercise any power and perform any function pertaining to its government and affairs for the protection of the public health, safety, morals and welfare; and

WHEREAS, special service areas are established pursuant to subsection (1) of Section 6 of Article VII of the Illinois Constitution of 1970, and the Special Service Area Tax Law (35 ILCS 200/27-5 et seq) and the Property Tax Code (35 ILCS 200/1-1 et seq); and

WHEREAS, it is in the public interest that the Area described in the Notice set forth in paragraph 2 Section One hereof be established as a Special Service Area for the purposes set forth herein, an accurate map of said territory being attached hereto as Exhibit "A-1"; and

WHEREAS, said Area is compact and contiguous and constitutes a principal commercial area of the City; and

WHEREAS, said Area is zoned R-1(S) One Family Dwelling District, R-5(S) Multiple Family Dwelling District and OS-1(S) Conservation, Open Space and Drainage District, and will benefit specifically from the municipal services to be provided which include the maintenance and repair of the onsite stormwater retention, detention and drainage controls and common areas, all in accordance with the final plat of subdivision or final approved engineering plans for the Area; and the proposed municipal services are unique and in addition to municipal services provided to the City of Aurora as a whole, and it is, therefore, in the best interests of said Area and the City of Aurora as a whole, that the levy of special taxes against said Area for the services to be provided be considered.

NOW, THEREFORE, BE IT ORDAINED, by the City Council of the City of Aurora, Illinois, as follows:

SECTION ONE:

- (a) That a public hearing shall be held on the 8th day of December, 2015, at 6:00 p.m. in the City Council Chambers of the City Hall, 44 East Downer Place, Aurora, Illinois to consider the creation of SPECIAL SERVICE AREA #183 of the City of Aurora, in the territory described in the Notice set forth in Paragraph 2 hereof. At the hearing, there will be considered the levy of an annual tax on property by the City of Aurora at a rate or amount of tax sufficient to produce revenue required to provide the special services in the proposed SPECIAL SERVICE AREA #183. Said tax to be levied for an indefinite period of time from and after the date of the Ordinance establishing said Area. Said tax to be levied at a maximum rate of \$1.10 (one hundred and ten cents per one-hundred dollar valuation). Said taxes shall be in addition to all other taxes provided by law and shall be levied pursuant to the provisions of the Property Tax Code. Said levies are intended to produce an amount annually to pay for the cost for said special services. Notwithstanding the foregoing, taxes shall not be levied hereunder and said Area shall be "dormant," and shall take effect only if the owner fails to maintain or repair the aforesaid required items and the City is forced to assume said responsibilities.
- (b) The Notice of hearing was published at least once not less than fifteen (15) days prior to the public hearing in a newspaper in general circulation in the City of Aurora. In addition, notice by mailing was given by depositing said Notice in the U.S. Mails addressed to the person or persons in whose name the general taxes for the last preceding year were paid on each lot, block, tract or parcel of land lying within the proposed SPECIAL SERVICE AREA #183. Said Notice was mailed not less than ten (10) days prior to the time set for the public hearing. In the event taxes for the last preceding year were not paid, the Notice was sent to the person last listed on the tax rolls prior to that year as the owner of said property. The Notice shall be substantially the following form:

**NOTICE OF HEARING
CITY OF AURORA
SPECIAL SERVICE AREA #183
BICKFORD OF AURORA
KANE COUNTY**

NOTICE IS HEREBY GIVEN that on the 8th day of December, 2015 at 6:00 p.m., in the City Council Chambers of the City Hall, 44 East Downer Place, Aurora, Illinois, a hearing will be held by the City Council of the City of Aurora to consider the establishment of a Special Service Area consisting of the following described territory:

SEE ATTACHED EXHIBIT "A"

SECTION TWO:

The purpose of the formation of SPECIAL SERVICE AREA #183 in general is to provide for the maintenance and repair of the onsite stormwater retention, detention and drainage controls and common areas, in said Area, all in accordance with the final plat of subdivision or final approved engineering plans for the Area, and the proposed municipal services are unique and are in addition to the improvements and services provided and/or maintained by the City generally. It is hereby determined by the City Council that the establishment of said special service area is desirable and necessary to provide the special services to the said area.

SECTION THREE:

At the hearing, all persons affected will be given an opportunity to be heard. At the hearing, there will be considered the levy of an annual tax in the proposed SPECIAL SERVICE AREA #183 by the City of Aurora of not to exceed an annual rate of 1.10 one-hundredths percent (\$1.10 being 110 cents per \$100.00 of the equalized assessed value of the property) sufficient to produce revenues to provide the special services. Said tax to be levied for an indefinite period of time from and after the date of the Ordinance establishing said Area. Said taxes shall be in addition to all other taxes provided by law and shall be levied pursuant to the provisions of the Property Tax Code. Said levies are intended to produce an amount annually to pay for the cost for said special services. Notwithstanding the foregoing, taxes shall not be levied hereunder and said Area shall be "dormant," and shall take effect only if the applicable required Owners Association (or owner as the case may be) fails to maintain or repair the aforesaid required items or provide said special services and the City is forced to assume said responsibilities. The hearing may be adjourned by the City Council to another date without further notice other than a motion to be entered upon the minutes of its meeting fixing the time and place of its adjournment.

If a petition signed by at least fifty-one percent (51%) of the electors residing within the proposed SPECIAL SERVICE AREA #183 and by at least fifty-one percent (51%) of the owners of record of the land included within the boundaries of the proposed Area is filed with the City Clerk within sixty (60) days following the final adjournment of the public hearing objecting to the establishment of the Area, the enlargement thereof, or the levy or imposition of a tax for the provision of special services to the Area, no such Area may be established or enlarged, or tax levied or imposed.

SECTION FOUR:

The approximate location is the vacant land at southwest corner of Orchard Road and Galena Boulevard, Aurora, Illinois.

An accurate map of said territory is on file in the Office of the City Clerk and available for public inspection, and is attached hereto as Exhibit "A-1".

All interested persons affected by the formation of SPECIAL SERVICE AREA #183 will be given an opportunity to be heard regarding the formation of the boundaries of the Area and may object to the formation of the Area and the levy of taxes affecting said Area.

SECTION FIVE:

That this ordinance shall be in full force and effect, and shall be controlling, upon its passage and approval.

SECTION SIX:

That all ordinances or parts of ordinances thereof in conflict therewith are hereby repealed to the extent of any such conflict.

SECTION SEVEN:

That any Section or provisions of this Ordinance that is construed to be invalid or void shall not affect the remaining Sections or provisions which shall remain in full force and effect thereafter.

PASSED by the City Council of the City of Aurora, Illinois on this 8th day of December, 2015.

AYES _____ NAYS _____ NOT VOTING _____

APPROVED AND SIGNED by the Mayor of the City of Aurora, Illinois on this 8th day of December, 2015.

MAYOR

ATTEST:

City Clerk

Prepared by:
Blanca R. Dominguez
Assistant Corporation Counsel
City of Aurora Law Department
44 East Downer Place
Aurora, IL 60507

EXHIBIT A-1
SSA #183
BICKFORD OF AURORA
LOCATION MAP TO CONFORM WITH KANE REQUIREMENTS

Legal Description

THAT PART OF THE NORTHEAST QUARTER OF SECTION 24, TOWNSHIP 38 NORTH, RANGE 7 EAST OF THE THIRD PRINCIPAL MERIDIAN, BOUNDED AND DESCRIBED AS FOLLOWS:

LYING WEST OF THE WEST LINE OF ORCHARD ROAD, AS ESTABLISHED PER DOCUMENT 1287198, LYING EAST OF UNIT 1 CHERRY HILL ESTATES; LYING SOUTH OF THE CENTERLINE OF GALENA BOULEVARD AND LYING NORTH OF THE FOLLOWING DESCRIBED LINE:

BEGINNING AT THE NORTHEAST CORNER OF LOT 1 IN UNIT 3 CHERRY HILL ESTATES; THENCE EASTERLY PERPENDICULAR TO THE WEST LINE OF ORCHARD ROAD A DISTANCE OF 343.42 FEET TO SAID WEST LINE OF ORCHARD ROAD A DISTANCE OF 1254.71 FEET NORTHERLY OF THE NORTH LINE OF UNIT 7 SANS SOUCI AS MEASURED ALONG SAID WEST LINE OF ORCHARD ROAD, ALL IN KANE COUNTY, ILLINOIS;

EXCEPT THAT PART TAKEN BY KANE COUNTY DEPARTMENT OF TRANSPORTATION PER RIGHT OF WAY PLAT PREPARED BY CRAWFORD, MURPHY AND TILLY, INC. DATED JULY 14, 2003 AND AS DEPICTED IN SAID PLAT, A COPY OF WHICH WAS RECORDED FEBRUARY 6, 2014 AS DOCUMENT 2014K006231, IN KANE COUNTY, ILLINOIS.

PROPERTY ADDRESS:
SWC ORCHARD AND GALENA, AURORA, IL 60506

Locator Map

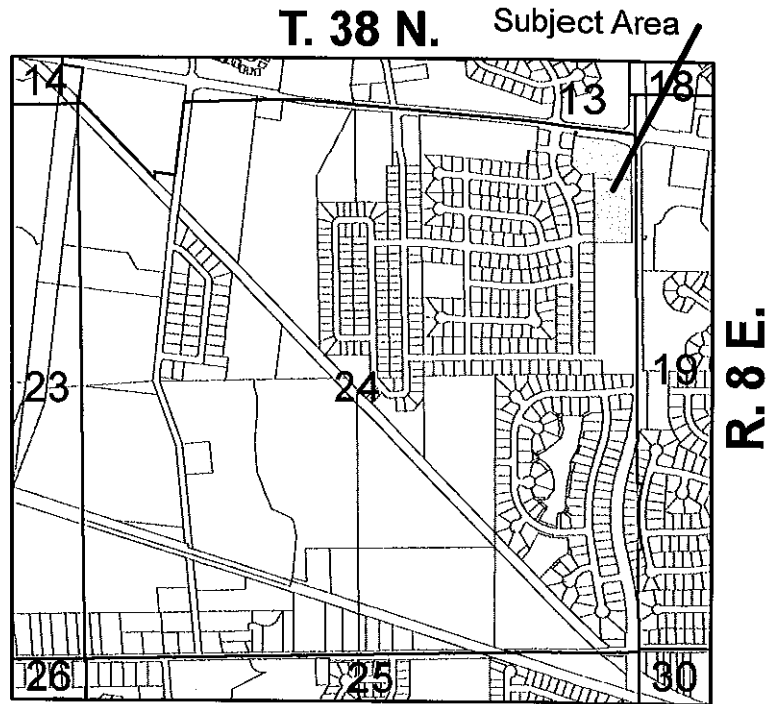

Actual Area

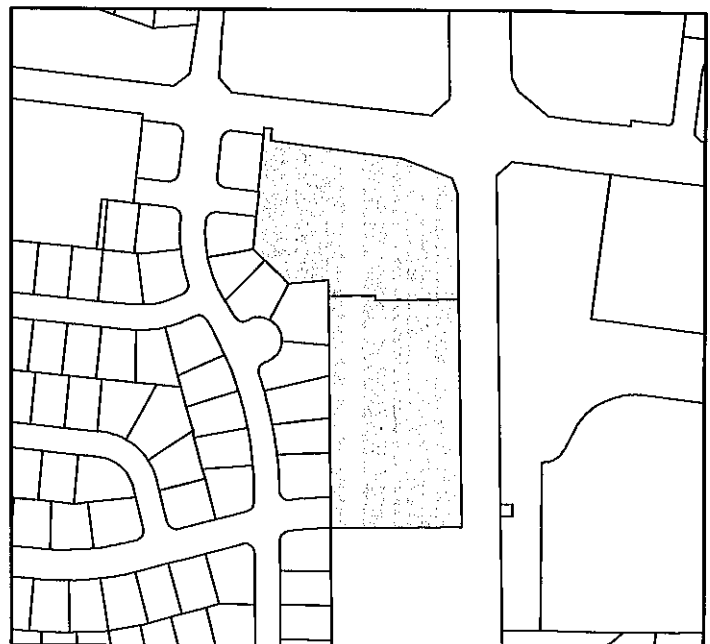

PIN(s)

14-24-232-011
14-24-276-029

Common Address

Vacant Land



EXHIBIT "A"
LEGAL DESCRIPTION OF SUBJECT PROPERTY

THAT PART OF THE NORTHEAST QUARTER OF SECTION 24, TOWNSHIP 38 NORTH, RANGE 7 EAST OF THE THIRD PRINCIPAL MERIDIAN, BOUNDED AND DESCRIBED AS FOLLOWS:

LYING WEST OF THE WEST LINE OF ORCHARD ROAD, AS ESTABLISHED PER DOCUMENT 1287198, LYING EAST OF UNIT 1 CHERRY HILL ESTATES; LYING SOUTH OF THE CENTERLINE OF GALENA BOULEVARD AND LYING NORTH OF THE FOLLOWING DESCRIBED LINE:

BEGINNING AT THE NORTHEAST CORNER OF LOT 1 IN UNIT 3 CHERRY HILL ESTATES; THENCE EASTERLY PERPENDICULAR TO THE WEST LINE OF ORCHARD ROAD A DISTANCE OF 343.42 FEET TO SAID WEST LINE OF ORCHARD ROAD A DISTANCE OF 1254.71 FEET NORTHERLY OF THE NORTH LINE OF UNIT 7 SANS SOUCI AS MEASURED ALONG SAID WEST LINE OF ORCHARD ROAD, ALL IN KANE COUNTY, ILLINOIS;

EXCEPT THAT PART TAKEN BY KANE COUNTY DEPARTMENT OF TRANSPORTATION PER RIGHT OF WAY PLAT PREPARED BY CRAWFORD, MURPHY AND TILLY, INC. DATED JULY 14, 2003 AND AS DEPICTED IN SAID PLAT, A COPY OF WHICH WAS RECORDED FEBRUARY 6, 2014 AS DOCUMENT 2014K006231, IN KANE COUNTY, ILLINOIS.

PROPERTY ADDRESS: SWC ORCHARD AND GALENA, AURORA, IL 60506

PIN(S): 14-24-276-029
 14-24-232-011

**EXHIBIT B
NOTICE OF HEARING
CITY OF AURORA
SPECIAL SERVICE AREA #183
BICKFORD OF AURORA
KANE COUNTY**

NOTICE IS HEREBY GIVEN that on the 8th day of December, 2015 at 6:00 p.m., in the City Council Chambers of the City Hall, 44 East Downer Place, Aurora, Illinois, a hearing will be held by the City Council of the City of Aurora to consider the establishment of a Special Service Area consisting of the following described territory:

SEE ATTACHED EXHIBIT "A"

The approximate location is vacant land southwest corner of Orchard Road and Galena Boulevard, Aurora, Illinois.

An accurate map of said Area is on file in the Office of the City Clerk and available for public inspection, and is attached hereto as Exhibit "A".

All interested persons affected by the formation of SPECIAL SERVICE AREA #183 will be given an opportunity to be heard regarding the formation of the boundaries of the Area and may object to the formation of the Area and the levy of taxes affecting said Area.

The purpose of the formation of SPECIAL SERVICE AREA #183 in general is to provide for the maintenance and repair of certain onsite stormwater detention, retention and drainage controls and common areas, all in accordance with the final plat of subdivision or final approved engineering plans for the Area, and the proposed municipal services are unique and are in addition to the improvements and services provided and/or maintained by the City generally.

At the hearing, all persons affected will be given an opportunity to be heard. At the hearing, there will be considered the levy of an annual tax in the proposed SPECIAL SERVICE AREA #183 by the City of Aurora of not to exceed an annual rate of 1.10 one-hundredths percent (\$1.10 being 110 cents per \$100.00 of the equalized assessed value of the property) sufficient to produce revenues to provide the special services. Said tax to be levied for an indefinite period of time from and after the date of the Ordinance establishing said Area. Said taxes shall be in addition to all other taxes provided by law and shall be levied pursuant to the provisions of the Property Tax Code. Said levies are intended to produce an amount annually to pay for the cost for said special services. Notwithstanding the foregoing, taxes shall not be levied hereunder and said Area shall be "dormant," and shall take effect only if the applicable required Owners Association (or owner as the case may be) fails to maintain or repair the aforesaid required items or provide said special services and the City is forced to assume said responsibilities. The

hearing may be adjourned by the City Council to another date without further notice other than a motion to be entered upon the minutes of its meeting fixing the time and place of its adjournment.

If a petition signed by at least fifty-one percent (51%) of the electors residing within the proposed SPECIAL SERVICE AREA #183 and by at least fifty-one percent (51%) of the owners of record of the land included within the boundaries of the proposed Area is filed with the City Clerk within sixty (60) days following the final adjournment of the public hearing objecting to the establishment of the Area, the enlargement thereof, or the levy or imposition of a tax for the provision of special services to the Area, no such Area may be established or enlarged, or tax levied or imposed.

City Clerk
City of Aurora
44 East Downer Place
Aurora, IL 60507
(630) 256-3070 Phone

EXHIBIT "A"
LEGAL DESCRIPTION OF SUBJECT PROPERTY

THAT PART OF THE NORTHEAST QUARTER OF SECTION 24, TOWNSHIP 38 NORTH, RANGE 7 EAST OF THE THIRD PRINCIPAL MERIDIAN, BOUNDED AND DESCRIBED AS FOLLOWS:

LYING WEST OF THE WEST LINE OF ORCHARD ROAD, AS ESTABLISHED PER DOCUMENT 1287198, LYING EAST OF UNIT 1 CHERRY HILL ESTATES; LYING SOUTH OF THE CENTERLINE OF GALENA BOULEVARD AND LYING NORTH OF THE FOLLOWING DESCRIBED LINE:

BEGINNING AT THE NORTHEAST CORNER OF LOT 1 IN UNIT 3 CHERRY HILL ESTATES; THENCE EASTERLY PERPENDICULAR TO THE WEST LINE OF ORCHARD ROAD A DISTANCE OF 343.42 FEET TO SAID WEST LINE OF ORCHARD ROAD A DISTANCE OF 1254.71 FEET NORTHERLY OF THE NORTH LINE OF UNIT 7 SANS SOUCI AS MEASURED ALONG SAID WEST LINE OF ORCHARD ROAD, ALL IN KANE COUNTY, ILLINOIS;

EXCEPT THAT PART TAKEN BY KANE COUNTY DEPARTMENT OF TRANSPORTATION PER RIGHT OF WAY PLAT PREPARED BY CRAWFORD, MURPHY AND TILLY, INC. DATED JULY 14, 2003 AND AS DEPICTED IN SAID PLAT, A COPY OF WHICH WAS RECORDED FEBRUARY 6, 2014 AS DOCUMENT 2014K006231, IN KANE COUNTY, ILLINOIS.

PROPERTY ADDRESS: SWC ORCHARD AND GALENA, AURORA, IL 60506

PIN(S): 14-24-276-029
14-24-232-011

**NOTICE OF HEARING
CITY OF AURORA
SPECIAL SERVICE AREA #183
BICKFORD OF AURORA
KANE COUNTY**

NOTICE IS HEREBY GIVEN that on the 8th day of December, 2015 at 6:00 p.m., in the City Council Chambers of the City Hall, 44 East Downer Place, Aurora, Illinois, a hearing will be held by the City Council of the City of Aurora to consider the establishment of a Special Service Area consisting of the following described territory:

SEE ATTACHED EXHIBIT "A"

The approximate location is vacant land southwest corner of Orchard Road and Galena Boulevard, Aurora, Illinois.

An accurate map of said Area is on file in the Office of the City Clerk and available for public inspection, and is attached hereto as Exhibit "A".

All interested persons affected by the formation of SPECIAL SERVICE AREA #183 will be given an opportunity to be heard regarding the formation of the boundaries of the Area and may object to the formation of the Area and the levy of taxes affecting said Area.

The purpose of the formation of SPECIAL SERVICE AREA #183 in general is to provide for the maintenance and repair of certain onsite stormwater detention, retention and drainage controls and common areas, all in accordance with the final plat of subdivision or final approved engineering plans for the Area, and the proposed municipal services are unique and are in addition to the improvements and services provided and/or maintained by the City generally.

At the hearing, all persons affected will be given an opportunity to be heard. At the hearing, there will be considered the levy of an annual tax in the proposed SPECIAL SERVICE AREA #183 by the City of Aurora of not to exceed an annual rate of 1.10 one-hundredths percent (\$1.10 being 110 cents per \$100.00 of the equalized assessed value of the property) sufficient to produce revenues to provide the special services. Said tax to be levied for an indefinite period of time from and after the date of the Ordinance establishing said Area. Said taxes shall be in addition to all other taxes provided by law and shall be levied pursuant to the provisions of the Property Tax Code. Said levies are intended to produce an amount annually to pay for the cost for said special services. Notwithstanding the foregoing, taxes shall not be levied hereunder and said Area shall be "dormant," and shall take effect only if the applicable required Owners Association (or owner as the case may be) fails to maintain or repair the aforesaid required items or provide said special services and the City is forced to assume said responsibilities. The hearing may be adjourned by the City Council to another date without further notice other than a motion to be entered upon the minutes of its meeting fixing the time and place of its adjournment.

If a petition signed by at least fifty-one percent (51%) of the electors residing within the proposed SPECIAL SERVICE AREA #183 and by at least fifty-one percent (51%) of the owners

of record of the land included within the boundaries of the proposed Area is filed with the City Clerk within sixty (60) days following the final adjournment of the public hearing objecting to the establishment of the Area, the enlargement thereof, or the levy or imposition of a tax for the provision of special services to the Area, no such Area may be established or enlarged, or tax levied or imposed.

City Clerk
City of Aurora
44 East Downer Place
Aurora, IL 60507
(630) 256-3070 Phone

EXHIBIT "A"
LEGAL DESCRIPTION OF SUBJECT PROPERTY

THAT PART OF THE NORTHEAST QUARTER OF SECTION 24, TOWNSHIP 38 NORTH, RANGE 7 EAST OF THE THIRD PRINCIPAL MERIDIAN, BOUNDED AND DESCRIBED AS FOLLOWS:

LYING WEST OF THE WEST LINE OF ORCHARD ROAD, AS ESTABLISHED PER DOCUMENT 1287198, LYING EAST OF UNIT 1 CHERRY HILL ESTATES; LYING SOUTH OF THE CENTERLINE OF GALENA BOULEVARD AND LYING NORTH OF THE FOLLOWING DESCRIBED LINE:

BEGINNING AT THE NORTHEAST CORNER OF LOT 1 IN UNIT 3 CHERRY HILL ESTATES; THENCE EASTERLY PERPENDICULAR TO THE WEST LINE OF ORCHARD ROAD A DISTANCE OF 343.42 FEET TO SAID WEST LINE OF ORCHARD ROAD A DISTANCE OF 1254.71 FEET NORTHERLY OF THE NORTH LINE OF UNIT 7 SANS SOUCI AS MEASURED ALONG SAID WEST LINE OF ORCHARD ROAD, ALL IN KANE COUNTY, ILLINOIS;

EXCEPT THAT PART TAKEN BY KANE COUNTY DEPARTMENT OF TRANSPORTATION PER RIGHT OF WAY PLAT PREPARED BY CRAWFORD, MURPHY AND TILLY, INC. DATED JULY 14, 2003 AND AS DEPICTED IN SAID PLAT, A COPY OF WHICH WAS RECORDED FEBRUARY 6, 2014 AS DOCUMENT 2014K006231, IN KANE COUNTY, ILLINOIS.

PROPERTY ADDRESS: SWC ORCHARD AND GALENA, AURORA, IL 60506

PIN(S): 14-24-276-029
14-24-232-011

AFFIDAVIT OF SERVICE OF NOTICE

Nancy L. Warren, after first being sworn under oath, states and deposes that she caused a copy of the within Notice of Hearing for SPECIAL SERVICE AREA #183 to be duly sent by mail, proper postage prepaid on or before November 20, 2015, to the person or persons in whose name the general taxes for the last preceding year were paid on each lot, block, tract or parcel of land lying within the proposed SPECIAL SERVICE AREA #183. In the event that taxes for the last preceding year were not paid, notice was sent to the person or persons last listed on the tax rolls prior to that year as the owner of said property, for the property described in said Notice to wit:

Dated this 20th day of November, 2015.

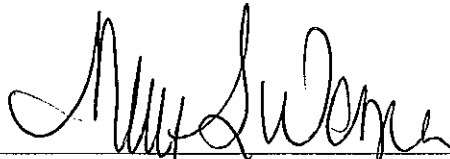

Nancy L. Warren

Subscribed and sworn to before me
this 20th day of November, 2015.

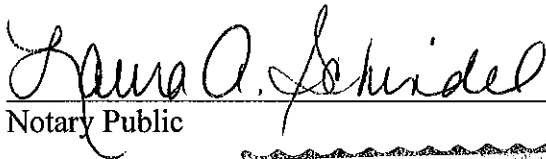
Notary Public



City of Aurora

Law Department • 44 East Downer Place • Aurora, Illinois 60507-2067

Pinnacle Capital Aurora, LLC
555 Corporate Woods Parkway
Vernon Hills IL 60061-3111

Parcels # 14-24-276-029
14-24-232-011



City of Aurora

Law Department • 44 East Downer Place • Aurora, Illinois 60507-2067

NHI-Bickford, RE LLC
222 Robert Rose Drive
Murfreesboro, TN 37129

Parcels # 14-24-276-029
14-24-232-011

David J. Rickert, CPA
Kane County Treasurer



719 South Batavia Ave
Geneva, Illinois 60134
(630) 232-3565

Kane County 2013 Payable 2014 Property Taxes

Parcel		14-24-276-029																							
Property Location IL	Mailing Address PINNACLE CAPITAL AURORA LLC, 555 CORPORATE WOODS PKWY VERNON HILLS, IL 60061-3111		Tax Rate 11.384450	Tax Code SG-014	Menu Page Treasurer Home Page Tax Extension Home Page County Assessments Home Page Print Payment Statement Print Current Tax Bill																				
	1st Installment Due 6/2/2014	2nd Installment Due 9/2/2014	Total	Equalized Assessed Value (EAV) 19,767 Senior Assessment Freeze (-) 0 Senior Exemption (-) 0 Homestead Exemption (-) 0 Other Exemptions (-) 0 Net Taxable Value 19,767	Click below to Pay Tax with E-Check Credit or Debit ca Pay 1st Installment Pay 2nd Installment Pay Both Installments Parcel Assessment Information Sugar Grove Township Assessor View Property Map																				
Tax Amount	1,125.18	1,125.18	2,250.36																						
Abated Amount (-)	0.00	0.00	0.00																						
Penalty Amount (+)	0.00	0.00	0.00																						
Additional Costs (+)	0.00	0.00	0.00																						
Amount Due	1,125.18	1,125.18	2,250.36																						
Paid Amount	1,125.18	1,125.18	2,250.36																						
Paid Date	05/02/2014	05/02/2014																							
Tax Sale/Redemption Information																									
Kane County Clerk, John A. Cunningham Tax Redemption Department 630/232-5964																									
				<table border="1"> <thead> <tr> <th>Year</th> <th>Base Tax Due</th> </tr> </thead> <tbody> <tr> <td>Current Year</td> <td>2295.06</td> </tr> <tr> <td>2013</td> <td>2250.36</td> </tr> <tr> <td>2012</td> <td>2140.60</td> </tr> <tr> <td>2011</td> <td>2057.52</td> </tr> <tr> <td>2010</td> <td>1652.74</td> </tr> <tr> <td>2009</td> <td>1666.42</td> </tr> <tr> <td>2008</td> <td>1616.82</td> </tr> <tr> <td>2007</td> <td>1437.70</td> </tr> <tr> <td>2006</td> <td>1269.60</td> </tr> </tbody> </table>		Year	Base Tax Due	Current Year	2295.06	2013	2250.36	2012	2140.60	2011	2057.52	2010	1652.74	2009	1666.42	2008	1616.82	2007	1437.70	2006	1269.60
Year	Base Tax Due																								
Current Year	2295.06																								
2013	2250.36																								
2012	2140.60																								
2011	2057.52																								
2010	1652.74																								
2009	1666.42																								
2008	1616.82																								
2007	1437.70																								
2006	1269.60																								

David J. Rickert, CPA
Kane County Treasurer



719 South Batavia Ave
Geneva, Illinois 60134
(630) 232-3565

Kane County 2014 Payable 2015 Property Taxes

Parcel 14-24-276-029						Menu Page																				
Property Location IL		Mailing Address PINNACLE CAPITAL AURORA LLC, . 555 CORPORATE WOODS PKWY VERNON HILLS, IL 60061-3111		Tax Rate 11.732768 Tax Code SG-014		Treasurer Home Page																				
	1st Installment Due 6/1/2015	2nd Installment Due 9/1/2015	Total	Equalized Assessed Value (EAV)	19,561	Tax Extension Home Page																				
Tax Amount	1,147.53	1,147.53	2,295.06	Senior Assessment (-)	0	County Assessments Home Page																				
Abated Amount (-)	0.00	0.00	0.00	Senior Exemption (-)	0	Print Payment Statement																				
Penalty Amount (+)	0.00	0.00	0.00	Homestead Exemption (-)	0																					
Additional Costs (+)	0.00	0.00	0.00	Other Exemptions (-)	0	Print Current Tax Bill																				
Amount Due	1,147.53	1,147.53	2,295.06	Net Taxable Value	19,561																					
Paid Amount	1,147.53	1,147.53	2,295.06																							
Paid Date	05/27/2015	05/27/2015																								
Tax Sale/Redemption Information				Tax History																						
Kane County Clerk, John A. Cunningham Tax Redemption Department 630/232-5964				<table border="1"> <thead> <tr> <th>Year</th> <th>Base Tax Due</th> </tr> </thead> <tbody> <tr> <td><u>Current Year</u></td> <td>2295.06</td> </tr> <tr> <td><u>2013</u></td> <td>2250.36</td> </tr> <tr> <td><u>2012</u></td> <td>2140.60</td> </tr> <tr> <td><u>2011</u></td> <td>2057.52</td> </tr> <tr> <td><u>2010</u></td> <td>1652.74</td> </tr> <tr> <td><u>2009</u></td> <td>1666.42</td> </tr> <tr> <td><u>2008</u></td> <td>1616.82</td> </tr> <tr> <td><u>2007</u></td> <td>1437.70</td> </tr> <tr> <td><u>2006</u></td> <td>1269.60</td> </tr> </tbody> </table>		Year	Base Tax Due	<u>Current Year</u>	2295.06	<u>2013</u>	2250.36	<u>2012</u>	2140.60	<u>2011</u>	2057.52	<u>2010</u>	1652.74	<u>2009</u>	1666.42	<u>2008</u>	1616.82	<u>2007</u>	1437.70	<u>2006</u>	1269.60	<div style="border: 1px solid black; padding: 5px; text-align: center;"> Click below to Pay Tax with E-Check Credit or Debit card </div> <p> Pay 1st Installment Pay 2nd Installment Pay Both Installments Parcel Assessment Information Sugar Grove Township Assessor View Property Map </p>
Year	Base Tax Due																									
<u>Current Year</u>	2295.06																									
<u>2013</u>	2250.36																									
<u>2012</u>	2140.60																									
<u>2011</u>	2057.52																									
<u>2010</u>	1652.74																									
<u>2009</u>	1666.42																									
<u>2008</u>	1616.82																									
<u>2007</u>	1437.70																									
<u>2006</u>	1269.60																									

David J. Rickert, CPA
Kane County Treasurer



719 South Batavia Ave
Geneva, Illinois 60134
(630) 232-3565

Kane County 2013 Payable 2014 Property Taxes

Parcel		14-24-232-011			
Property Location IL	Mailing Address PINNACLE CAPITAL AURORA LLC, 555 CORPORATE WOODS PKWY VERNON HILLS, IL 60061-3111		Tax Rate 11.384450	Tax Code SG-014	Menu Page
					Treasurer Home Page
					Tax Extension Home Page
					County Assessments Home Page
					Print Payment Statement
					Print Current Tax Bill
					Click below to Pay Tax with E-Check or Debit card
					Pay 1st Installment
					Pay 2nd Installment
					Pay Both Installments
					Parcel Assessment Information
					Sugar Grove Township Assessor
					View Property Map

	1st Installment Due 6/2/2014	2nd Installment Due 9/2/2014	Total		
Tax Amount	531.31	531.31	1,062.62	Equalized Assessed Value (EAV)	9,334
Abated Amount (-)	0.00	0.00	0.00	Senior Assessment Freeze	(-) 0
Penalty Amount (+)	0.00	0.00	0.00	Senior Exemption	(-) 0
Additional Costs (+)	0.00	0.00	0.00	Homestead Exemption	(-) 0
Amount Due	531.31	531.31	1,062.62	Other Exemptions	(-) 0
Paid Amount	531.31	531.31	1,062.62	Net Taxable Value	9,334
Paid Date	05/02/2014	05/02/2014			

Year	Base Tax Due
<u>Current Year</u>	1083.76
<u>2013</u>	1062.62
<u>2012</u>	1010.76
<u>2011</u>	971.46
<u>2010</u>	780.34
<u>2009</u>	786.82
<u>2008</u>	763.36
<u>2007</u>	678.76
<u>2006</u>	599.40

Tax Sale/Redemption Information

Kane County Clerk, John A. Cunningham
Tax Redemption Department 630/232-5964

David J. Rickert, CPA
Kane County Treasurer



719 South Batavia Ave
Geneva, Illinois 60134
(630) 232-3565

Kane County 2014 Payable 2015 Property Taxes

Parcel		14-24-232-011						
Property Location IL		Mailing Address PINNACLE CAPITAL AURORA LLC, 555 CORPORATE WOODS PKWY VERNON HILLS, IL 60061-3111		Tax Rate 11.732768 Tax Code SG-014		Menu Page		
						Treasurer Home Page		
						Tax Extension Home Page		
						County Assessments Home Page		
						Print Payment Statement		
						Print Current Tax Bill		
						Click below to Pay Tax with E-Check Credit or Debit card		
						Pay 1st Installment		
						Pay 2nd Installment		
						Pay Both Installments		
						Parcel Assessment Information		
						Sugar Grove Township Assessor		
						View Property Map		

	1st Installment Due 8/1/2015	2nd Installment Due 9/1/2015	Total		
Tax Amount	541.88	541.88	1,083.76	Equalized Assessed Value (EAV)	9,237
Abated Amount (-)	0.00	0.00	0.00	Senior Assessment Freeze	(-) 0
Penalty Amount (+)	0.00	0.00	0.00	Senior Exemption	(-) 0
Additional Costs (+)	0.00	0.00	0.00	Homestead Exemption	(-) 0
Amount Due	541.88	541.88	1,083.76	Other Exemptions	(-) 0
Paid Amount	541.88	541.88	1,083.76	Net Taxable Value	9,237
Paid Date	05/27/2015	05/27/2015			

Kane County Clerk, John A. Cunningham Tax Redemption Department 630/232-5964	
---	--

Year	Base Tax Due
<u>Current Year</u>	1083.76
<u>2013</u>	1062.62
<u>2012</u>	1010.76
<u>2011</u>	971.46
<u>2010</u>	780.34
<u>2009</u>	786.82
<u>2008</u>	763.36
<u>2007</u>	678.76
<u>2006</u>	599.40