

## Legal Description

That part of the Northwest Quarter of Section 16, Township 38 North, Range 8 East of the Third Principal Meridian described as follows: Commencing at the northwest corner of said Northwest Quarter; thence South 35 0' West along the West line of said Quarter 239.60 feet; thence South 89°19' East 1325.40 feet; thence South 0°40' West 1168.40 feet; thence South 88°54' East 1095.3 feet for a point of beginning; thence continuing South 88°54' East 203.00 feet to the West line of the former Chicago, Burlington and Quincy Railroad Company; thence South 0°15' West 500.0 feet; thence North 88°54' West 203.00 feet to a line parallel with said West line of the former Chicago, Burlington and Quincy Railroad Company; thence North 0°15' East along said parallel line 500.00 feet to the point of beginning in the City of Aurora, Kane County, Illinois and containing 2.330 acres

## Locator Map

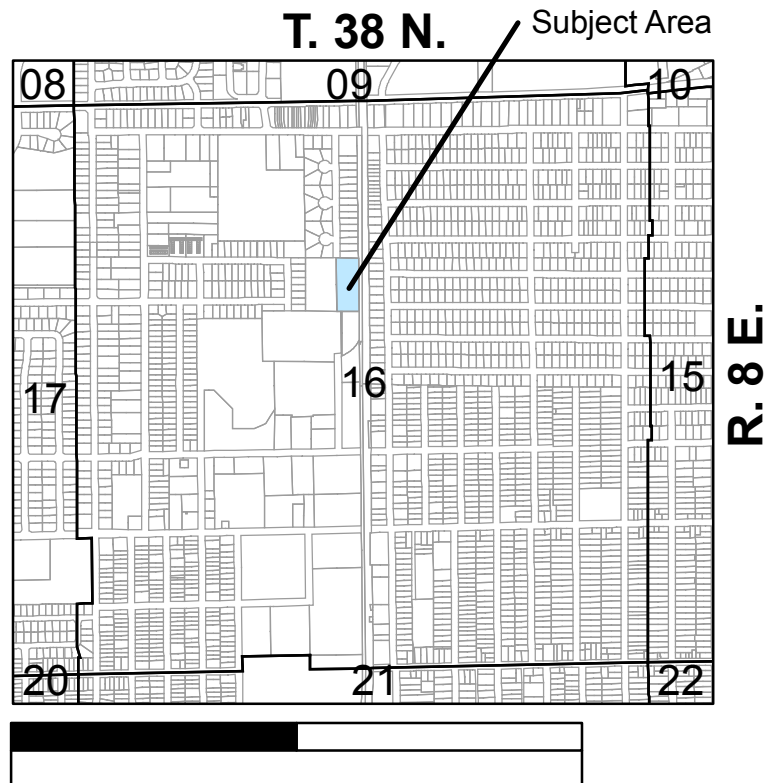

## Actual Area

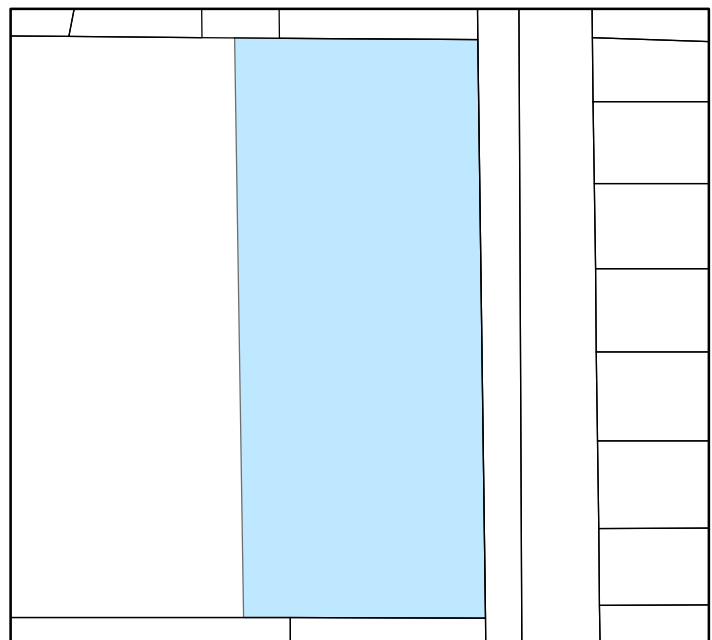

## PIN(s)

15-16-177-011

## Common Address

Vacant Lot

