

FINAL PLAN FOR LOT 8 OF SAVANNAH CROSSING SUBDIVISION

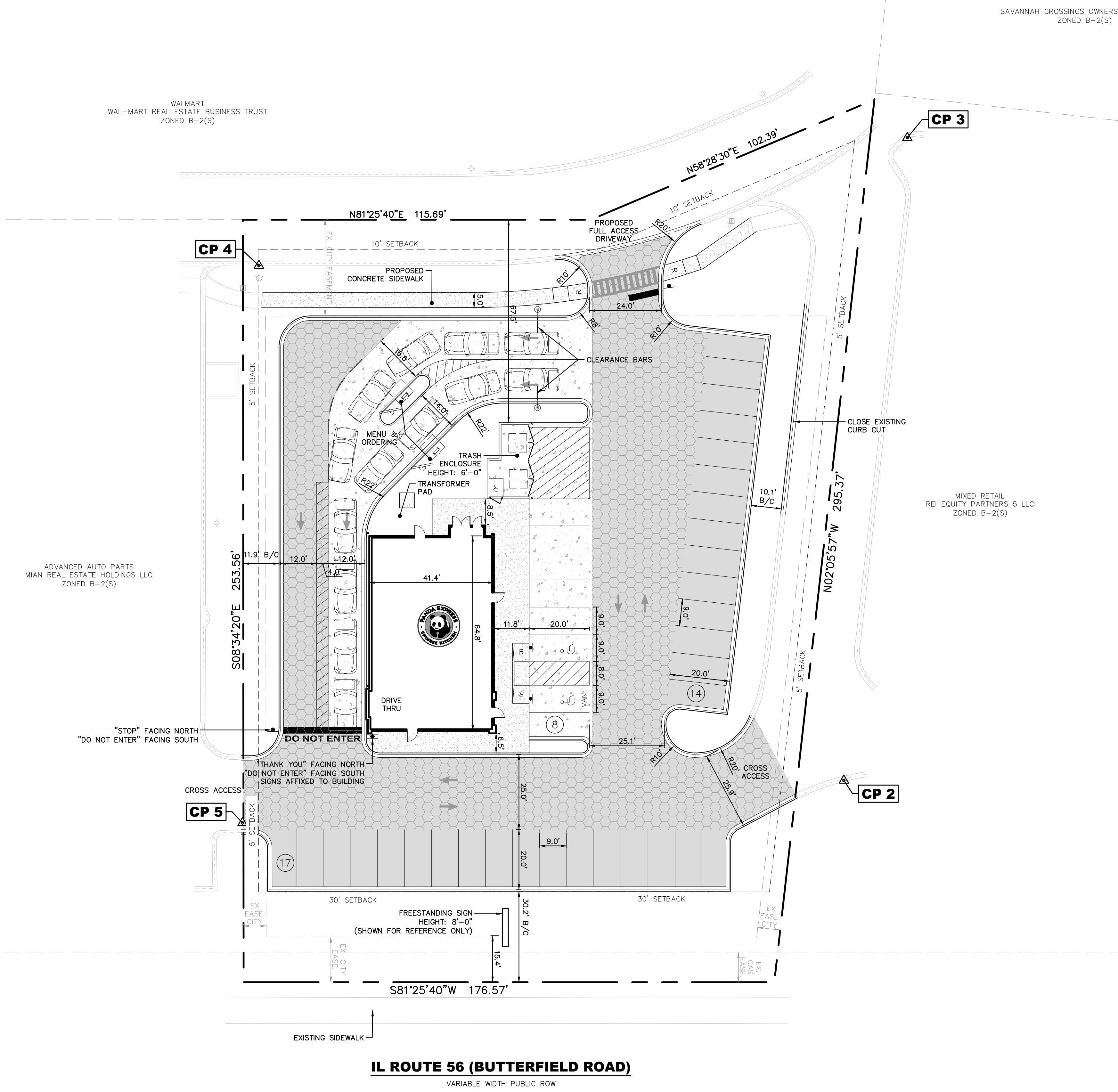

LEGEND

	PROPERTY LINE		STOP BAR AND STOP SIGN
	RIGHT-OF-WAY LINE		TRAFFIC FLOW ARROWS
	EXISTING CURB & GUTTER		PROPOSED SIGN
	PROPOSED CURB & GUTTER		PARKING ROW COUNT
	CONCRETE SIDEWALK		ACCESSIBLE PARKING SPACE
	CONCRETE		EXISTING / PROPOSED LIGHT POLE
	HEAVY-DUTY ASPHALT		PROPOSED RAMP
	STANDARD DUTY ASPHALT		EXISTING TELEPHONE PEDESTAL
			EXISTING FIRE HYDRANT

NOTES

- REFERENCE THE STANDARD NOTES SHEET FOR ADDITIONAL INFORMATION.
- FOR ALL APPLICABLE CONSTRUCTION DETAILS REFERENCE THE STANDARD DETAILS SHEET(S) AND ANY MUNICIPAL/JURISDICTIONAL DETAILS ATTACHED TO THIS PLAN SET.
- REFERENCE THE ALTA/ACSM LAND TITLE SURVEY FOR ADDITIONAL EXISTING FEATURES AND PROPERTY BOUNDARY INFORMATION.
- ALL DIMENSIONS ARE TO EDGE OF BUILDING, FACE OF CURB, OR EDGE OF PAVEMENT, UNLESS OTHERWISE NOTED.
- REFERENCE ARCHITECTURAL / FOUNDATION PLANS FOR BUILDING DIMENSIONS.
- ALL RADII ARE 5' UNLESS OTHERWISE NOTED.
- ALL SIDEWALK ADJACENT TO THE BUILDING SHALL BE INTEGRAL WALK UNLESS OTHERWISE NOTED.
- LIGHT POLE LOCATIONS ARE SHOWN FOR REFERENCE ONLY, SEE LIGHTING PLAN (BY OTHERS) FOR LIGHT POLE DETAILS, LOCATION, AND INTENSITIES.

Description	Value	Unit	Description	Value	Unit
a) Tax/Parcel Identification Number(s) (PINs): 12-36-354-004			j) Total Number of Residential Dwelling Units	0	units
			i. Gross Density	0.00	du/acre
b) Proposed land use(s): Restaurant with Drive-thru			k) Number of Single Family Dwelling Units	0	units
			i. Gross Density	0.00	du/acre
c) Total Property Size	1.15300735	Acres	iii. Unit Square Footage (average)	0	square feet
	50225	Square feet	iv. Bedroom Mix	0%	% 1 bdr
d) Total Lot Coverage (buildings and pavement)	36870	Square feet		0%	% 2 bdr
	73%	Percent		20%	% 3 bdr
e) Open space / landscaping	13355	Square feet	v. Number of Single Family Corner Lots	0	units
	27%	Percent	j) Number of Single Family Attached Dwelling Units	0	units
f) Land to be dedicated to the School District	0	Acres	i. Gross Density	0.00	du/acre
g) Land to be dedicated to the Park District	0	Acres			
h) Number of parking spaces provided (individually accessible)	41	spaces	iii. Unit Square Footage (average)	0	square feet
i. surface parking lot	41	spaces	iv. Bedroom Mix	0%	% 1 bdr
perpendicular	39	spaces		90%	% 2 bdr
parallel	0	spaces		10%	% 3 bdr
angled	0	spaces		0%	% 4 bdr
handicapped	2	spaces	m) Number of Multifamily Dwelling Units	0	units
ii. enclosed	0	spaces	i. Gross Density	0.00	du/acre
iii. bike	0	racks			
j) Number of buildings	1		iii. Unit Square Footage (average)	0	square feet
i. Number of stories	1	stories	iv. Bedroom Mix	0%	Efficiency
ii. Building Square Footage (typical)	2300	square feet		40%	% 1 bdr
iii. Square Footage of retail floor area	955	square feet		50%	% 2 bdr
iv. First Floor Building Square Footage (typical)	2300	square feet		10%	% 3 bdr

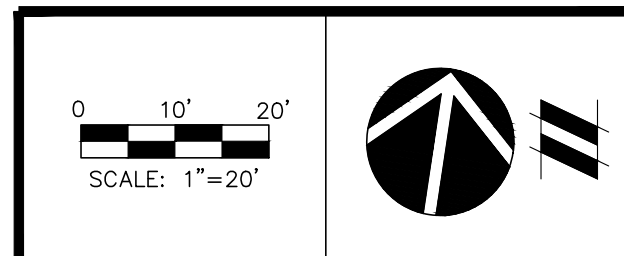
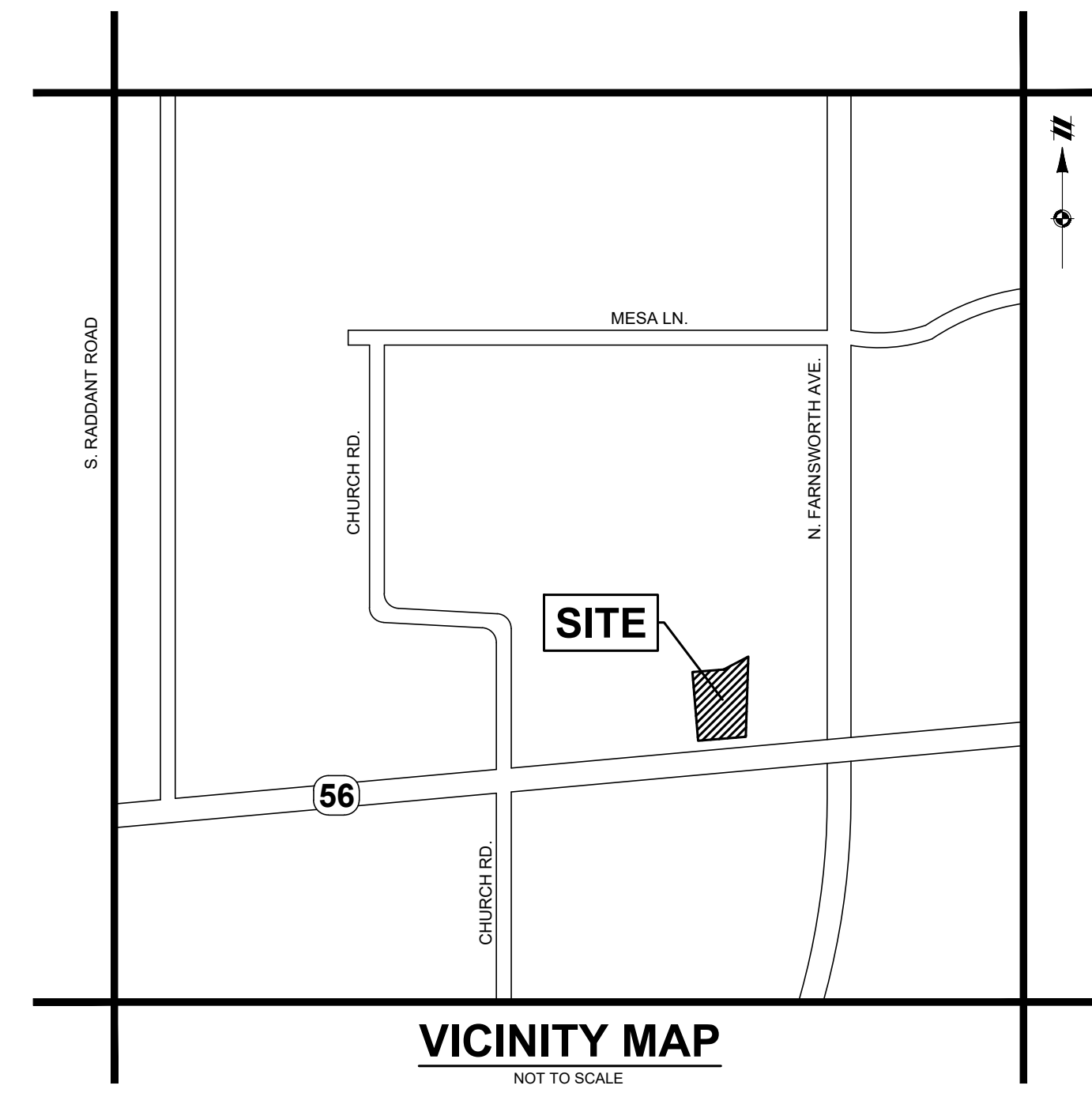

VICINITY MAP
NOT TO SCALE
NOT FOR CONSTRUCTION



PANDA RESTAURANT GROUP INC.
1683 Walnut Grove Ave.
Rosemead, California
91770
Telephone: 626.799.9898
Facsimile: 626.372.8288

All ideas, designs, arrangement and plans indicated or represented by this drawing are the property of Panda Express Inc. and were created for use on this specific project. None of these ideas, designs, arrangements or plans may be used by or disclosed to any person, firm, or corporation without the written permission of Panda Express Inc.

REVISIONS:

NO.	DATE	DESCRIPTION

ISSUE DATE:

NO.	DATE	DESCRIPTION

DRAWN BY: EM

PANDA PROJECT #: D33024
PANDA STORE #:
ENGR PROJECT #: 24001077



PANDA EXPRESS
TRUE WARM & WELCOME
BUTTERFIELD ROAD
AURORA, IL
FINAL PLAN FOR LOT 8 OF SAVANNAH CROSSING

C01

SITE LAYOUT PLAN



Project: _____ Type: _____
Prepared By: _____ Date: _____

TYPE A - SLM-LED-18L-SIL-FT-UNV-DIM-40-70 -BRZ

Back to Quick Links

Slice Medium (SLM) Outdoor LED Area Light

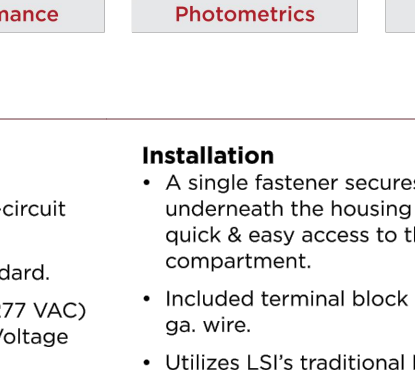
OVERVIEW

Lumen Package (lm)	9,000 - 48,000
Wattage Range (W)	63 - 401
Efficacy Range (LPW)	112 - 156
Weight lbs (kg)	27 (12.2)

QUICK LINKS

[Ordering Guide](#)
 [Performance](#)
 [Photometrics](#)
 [Dimensions](#)

FEATURES & SPECIFICATIONS

Construction

- Rugged die-cast aluminum housing contains factory prewired driver and optical unit. Cast aluminum wiring access door located underneath.
- Fixtures are finished with LSI's DuraGrip® polyester powder coat finishing process. The DuraGrip finish withstands extreme weather changes without cracking or peeling. Other standard LSI finishes available. Consult factory.
- Shipping weight: 33 lbs in carton.

Optical System

- State-of-the-art one piece silicone optic sheet delivers industry leading optical control with an integrated gasket to provide IP66 rated seal.
- Proprietary silicone refractor optics provide exceptional coverage and uniformity in distribution types 2, 3, 5W, FT, FTA and AM.
- Silicone optical material does not yellow or crack with age and provides a typical light transmittance of 93%.
- Zero uplight.
- Available in 5000K, 4000K, and 3000K color temperatures per ANSI C78.377. Also available in phosphor converted amber with peak intensity at 610nm.
- Minimum CRI of 70
- Integral louver (IL) and integral half louver (HL) options available for enhanced backlight control.

LSI Industries Inc., 10000 Alliance Rd., Cincinnati, OH 45242 • (513) 372-3200 • www.lsicorp.com
(LSI Industries Inc. All Rights Reserved. Specifications and dimensions subject to industry standard tolerances. Specifications subject to change without notice. Page 8/9 Rev. 01/23/23 SPEC.110.0.1122



Project: _____ Type: _____
Prepared By: _____ Date: _____

TYPE A - SLM-LED-18L-SIL-FT-UNV-DIM-40-70 -BRZ

Back to Quick Links

Slice Medium Outdoor LED Area Light

ORDERING GUIDE

Typical Order Example: **SLM LED 36L SIL FTA UNV DIM 50 70CRI ALSCS04 BRZ IL**

Prefix	Light Source	Lumen Package	Lens	Distribution	Orientation ²	Voltage
SLM - Slice Medium	LED	SL - 9,000 lms L2A - 12,000 lms L2B - 18,000 lms L2C - 24,000 lms SL - 30,000 lms SL - 36,000 lms SL - 42,000 lms SL - 48,000 lms Custom Lumen Packages!	SL - Clear SL - Clear	2 - Type 2 3 - Type 3 5W - Type 5 Wide FT - Forward Throw FTA - Forward Throw Automotive AM - Automotive Merchandise	(Blank) - Standard (no rotation) L - Optics rotated left 90° R - Optics rotated right 90°	UNV - Universal Voltage (120-277V) HW - High Voltage (347-480V)

Driver	Color Temperature	Color Rendering	Controls	Finish	Options
DM - 0-10V Summary (10-100%)	50 - 5,000 CCT 40 - 4,000 CCT	70CRI - 70 CRI	(Blank) - None Wireless Control System ALS - AirLink Synapse Control System ALS04 - AirLink Synapse Control System with 12-20" Motion Sensor ALS04A - AirLink Synapse Control System with 20-40" Motion Sensor ALS04B - AirLink Blue Wireless Motion & Photo Sensor Controller (8-24" mounting height) ALS04C - AirLink Blue Wireless Motion & Photo Sensor Controller (25-47" mounting height) Stand-Alone Controls EET - 0-10V Dimming leads extended to housing exterior CRP - 7 Pin Control Receptacle (ANSI C136.41) MBT - Integral Bluetooth™ Motion and Photoelectric Sensor (8-24" Height) MBT2 - Integral Bluetooth™ Motion and Photoelectric Sensor (25-47" Height) Button Type Photocells PCL20 - 120V PCL20B - 277 - 208 - 277V PCL27 - 54V	BLK - Black BRZ - Dark Bronze CG - Cast Metal Gray GPT - Graphite MSV - Metallic Silver PLP - Platinum Plus SG - Satin Verde Green WHT - White	(Blank) - None HL - Integral Half Louver (Moderate Backlight Control) IL - Integral Louver (Sharp Side Light Control)

Need more information? [Click here for our glossary.](#) **Have additional questions?** Call us at (800) 436-7800

Accessory Ordering Information*

DESCRIPTION	Order Number
Twist Lock Photocell (120V) for use with CRP	122514
Twist Lock Photocell (208-277V) for use with CRP	122515
Twist Lock Photocell (240V) for use with CRP	122516
Twist Lock Photocell (480V) for use with CRP	122518
AirLink 5 Pin Twist Lock Controller ¹	61409
AirLink 7 Pin Twist Lock Controller ¹	66140
Shorting Cap for use with CRP	14832

CONTROLS ACCESSORIES

- Listed to UL 1598 and UL 8750.
- Meets Buy American Act requirements.
- IDA compliant; with 3000K color temperature selection.
- Title 24 Compliant; see local ordinance for qualification information.
- Suitable for wet locations.
- IP66 rated Luminaire per IEC 60598-1.
- 3G rated for ANSI C136.31 high vibration applications; applications are qualified.
- IP68 rated luminaire per IEC 66262 mechanical impact code.
- DesignLights Consortium™ (DLC) qualified product. Not all versions of this product may be DLC qualified. Please check the DLC Qualified Products List at www.designlights.org/QPL to confirm which versions are qualified.
- Patented Silicone Optics (US Patent NO. 10,816,165 B2)

MOUNTING ACCESSORIES¹

DESCRIPTION	Order Number
Round Pole Adapter (3" Round/Upgraded Poles)	4062792R
Round Pole Adapter (4" Round Poles)	3799614R
Round Pole Adapter (5" Round Poles)	3799616R

FUSING OPTIONS²

Single Fusing (120V)	
Single Fusing (277V)	
Double Fusing (208V, 240V)	
Double Fusing (480V)	
Double Fusing (347V)	

SHIELDING OPTIONS

Mixing Small	
Mixing Medium	
Mixing Large	
Zone Medium	
Zone Large	
Side Medium	

LSI Industries Inc., 10000 Alliance Rd., Cincinnati, OH 45242 • (513) 372-3200 • www.lsicorp.com
(LSI Industries Inc. All Rights Reserved. Specifications and dimensions subject to industry standard tolerances. Specifications subject to change without notice. Page 8/9 Rev. 01/23/23 SPEC.110.0.1122



Project: _____ Type: _____
Prepared By: _____ Date: _____

TYPE A - SLM-LED-18L-SIL-FT-UNV-DIM-40-70 -BRZ

Back to Quick Links

Slice Medium Outdoor LED Area Light

ACCESSORIES

Accessories	Shielding, Poles & Misc. Accessories
Minimum Mounting Bracket Mounts the 2" square or round (upside/bright) poles with (2) mounting hole spacings between 15" & 17"	Integral Louver Provides integral louvers provides maximum backlight control by shielding each individual row of LEDs Part Number: 50402
Quick Mount Pole One per person installation to existing/new contractor poles with hole spacings between 2.4' to 4.4'	Integral Half Louver Provides integral half louvers provides great backlight control without impacting front side distribution. Part Number: 70204
1" x 1" Back Mount Pole One per person installation to existing/new contractor poles with hole spacings between 2.4' to 4.4'	External Shield External shield blocks view of light source from angle of luminaire, additional shielding configurations available Part Number: 7050204 (17" / 7050204 (8"))
Adjustable Spitter Mounts into 2" (30mm) (2.25" (56mm) O.D. beam and provides 180° of tilt (max 40° above horizontal)	Square Pole 1/2" x 3/8" steel and aluminum poles in 4", 5" and 6" sizes for retrofit and new construction Part Number: 450/550/650
Spine Mount Pole Mounts into 2" (30mm) (2.25" (56mm) O.D. beam and allows for mounting up to 4 luminaires	Round Pole 1/2" x 3/8" steel and aluminum poles in 4" and 5" sizes for retrofit and new construction Part Number: 480/580
Spine Mount Spitter Mounts into 4" or 5" square pole and allows for mounting up to 4 luminaires	Tapered Pole 2 1/2" x 3/8" steel and aluminum poles for retrofit and new construction Part Number: 810
Wall Mount Bracket Mounts into vertical wall surface (hardware/anchors not included)	Red Spikes 1/2" steel spikes (4" if recommended per luminaire, includes stone adhesive and application tool) Part Number: 29076
Wood Pole Bracket Mounts into wooden poles (3" minimum O.D., hardware/anchors not included)	Wood Pole Bracket Part Number: 380 HW CR
Part Number: 380 HW CR	Part Number: 380 HW CR

OPTICS ROTATION

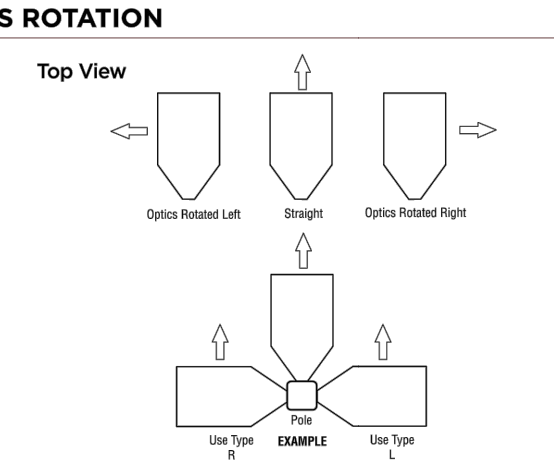

ACCESSORIES/OPTIONS

Integral Louver (IL) and House-Side Shield (HS)

Integral louver (IL) and half louver (HL) accessory shields available for improved backlight control without sacrificing street side performance. LSI's Integral Louver (IL) and Integral House-Side Shield (HS) options deliver backlight control that significantly reduces spill light behind the poles for applications with pole locations close to adjacent properties. The design maximizes forward reflected light while reducing glare, maintaining the optical distribution selected, and most importantly eliminating light trespass. Both options rotate with the optical distribution.

7 Pin Photoelectric Control

7-pin ANSI C136.41-2013 control receptacle option available for twist lock photocells or wireless control modules. Control accessories sold separately. Dimming leads from the receptacle will be connected to the driver mounting leads (Consult factory for alternate wiring).

LSI Industries Inc., 10000 Alliance Rd., Cincinnati, OH 45242 • (513) 372-3200 • www.lsicorp.com
(LSI Industries Inc. All Rights Reserved. Specifications and dimensions subject to industry standard tolerances. Specifications subject to change without notice. Page 8/9 Rev. 01/23/23 SPEC.110.0.1122



Project: _____ Type: _____
Prepared By: _____ Date: _____

TYPE A - SLM-LED-18L-SIL-FT-UNV-DIM-40-70 -BRZ

Back to Quick Links

Slice Medium Outdoor LED Area Light

PERFORMANCE

Delivered Lumens*

Lumen Package	Distribution	CRI	3000K CCT			4000K CCT			5000K CCT			Wattage
			Delivered Lumens	Efficacy	BUG Rating	Delivered Lumens	Efficacy	BUG Rating	Delivered Lumens	Efficacy	BUG Rating	
9L	2	70	9401	149	82-10-42	9625	152	82-10-42	9625	152	82-10-42	63
	3		9548	152	82-10-42	9805	155	82-10-42	9805	155	82-10-42	
	5W		9328	147	82-10-42	9450	150	82-10-42	9450	150	82-10-42	
	FT		9464	150	82-10-42	9652	153	82-10-42	9652	153	82-10-42	
	FTA		9520	151	82-10-42	9725	154	82-10-42	9725	154	82-10-42	
12L	AM	70	9649	153	82-10-41	9845	156	82-10-41	9845	156	82-10-41	85
	2		12355	147	85-10-42	12388	150	85-10-42	12388	150	85-10-42	
	3		12714	150	82-10-42	12934	153	82-10-42	12934	153	82-10-42	
	5W		12333	145	84-10-42	12584	148	84-10-42	12584	148	84-10-42	
	FT		12655	148	82-10-42	12861	151	82-10-42	12861	151	82-10-42	
18L	FTA	70	13012	149	85-10-42	12950	152	85-10-42	12950	152	85-10-42	105
	AM		13246	150	85-10-41	13011	154	85-10-42	13011	154	85-10-42	
	2		13427	156	85-10-43	13731	159	85-10-43	13731	159	85-10-43	
	3		13601	158	85-10-43	13972	161	85-10-43	13972	161	85-10-43	
	5W		13028	154	84-10-42	13498	157	84-10-42	13498	157	84-10-42	
24L	FT	70	18526	157	85-10-43	18934	160	85-10-43	18934	160	85-10-43	135
	FTA		18656	158	85-10-43	19027	161	85-10-43	19027	161	85-10-43	
	AM		18886	160	85-10-42	19271	163	85-10-42	19271	163	85-10-42	
	2		24847	161	84-10-43	25354	164	84-10-43	25354	164	84-10-43	
	3		25200	165	85-10-44	25724	166	85-10-44	25724	166	85-10-44	
30L	FT	70	24943	159	85-10-43	24950	162	85-10-43	24950	162	85-10-43	176
	FTA		24987	162	85-10-44	25007	165	85-10-44	25007	165	85-10-44	
	AM		25262	163	84-10-43	25276	166	84-10-43	25276	166	84-10-43	
	2		25475	165	82-10-42	25991	168	83-10-42	25991	168	83-10-42	
	3		31009	154	84-10-43	31363	157	84-10-43	31363	157	84-10-43	
36L	5W	70	32562	156	84-10-64	32206	159	84-10-64	32206	159	84-10-64	232
	FT		33062	152	85-10-43	33257	155	85-10-43	33257	155	85-10-43	
	FTA		32283	155	84-10-64	32621	158	84-10-64	32621	158	84-10-64	
	AM		32503	156	84-10-43	32465	159	84-10-43	32465	159	84-10-43	
	2		33892	157	85-10-43	32543	160	84-10-43	32543	160	84-10-43	
42L	3	70	33946	159	84-10-43	33797	161	84-10-43	33797	161	84-10-43	302
	5W		33782	157	84-10-64	33946	161	84-10-64	33946	161	84-10-64	
	FT		34258	157	85-10-44	34998	159	85-10-44	34998	159	85-10-44	
	FTA		33922	159	84-10-64	33808	162	84-10-64	33808	162	84-10-64	
	AM		33713	159	84-10-64	33805	163	84-10-64	33805	163	84-10-64	
48L	2	70	42623	121	85-10-64	43482	124	85-10-64	43482	124	85-10-64	401
	3		43245	123	84-10-43	44227	125	84-10-43	44227	125	84-10-43	
	5W		42943	119	85-10-64	42799	122	85-10-64	42799	122	85-10-64	
	FT		42863	122	84-10-43	42757	124	84-10-43	42757	124	84-10-43	
	FTA		42863	123	85-10-64	44844	125	85-10-64	44844	125	85-10-64	
54L	2	70	42996	124	84-10-43	42928	127	84-10-43	42928	127	84-10-43	477
	3		42995	124	85-10-64	42914	126	85-10-64	42914	126	85-10-64	
	5W		42646	125	84-10-43	42598	128	84-10-43	42598	128	84-10-43	
	FT		42625	124	84-10-43	42718	126	84-10-43	42718	126	84-10-43	
	FTA		42659	125	85-10-64	42509	127	85-10-64	42509	127	85-10-64	
60L	AM	70	42754	126	84-10-43	42826	129	84-10-43	42826	129	84-10-43	552
	2		42863	122	84-10-43	42757	124	84-10-43	42757	124	84-10-43	
	3		42863	123	85-10-64	44844	125	85-10-64	44844	125	85-10-64	
	5W		42996	124	84-10-43	42928	127	84-10-43	42928	127	84-10-43	
	FT		42995	124	85-10-64	42914	126	85-10-64	42914	126	85-10-64	
72L	3	70	42646	125	84-10-43	42598	128	84-10-43	42598	128	84-10-43	727
	5W		42625	124	84-10-43	42718	126	84-10-43	42718	126	84-10-43	
	FT		42659	125	85-10-64	42509	127	85-10-64	42509	127	85-10-64	
	FTA		42659	125	85-10-64	42509	127	85-10-64	42509	127	85-10-64	
	AM		42754	126	84-10-43	42826	129	84-10-43	42826	129	84-10-43	

LSI Industries Inc., 10000 Alliance Rd., Cincinnati, OH 45242 • (513) 372-3200 • www.lsicorp.com
(LSI Industries Inc. All Rights Reserved. Specifications and dimensions subject to industry standard tolerances. Specifications subject to change without notice. Page 8/9 Rev. 01/23/23 SPEC.110.0.1122



Project: _____ Type: _____
Prepared By: _____ Date: _____