

COMMONWEALTH AVENUE SEWER SEPARATION

APRIL, 2019

GENERALLY LOCATED: NE 1/4 SECTION 20, T38N, R8E, AURORA TOWNSHIP

| LEGEND | | |
|---|----------|----------|
| | EXISTING | PROPOSED |
| SANITARY SEWER | --- | --- |
| STORM SEWER | --- | --- |
| WATERMAIN | --- | --- |
| GAS LINE | --- | --- |
| TELEPHONE LINE | --- | --- |
| ELECTRIC LINE | --- | --- |
| FENCE | --- | --- |
| INDEX CONTOUR | --- | --- |
| INTERMEDIATE CONTOUR | --- | --- |
| EDGE OF PAVEMENT | --- | --- |
| CURB AND GUTTER | --- | --- |
| RIGHT-OF-WAY | --- | --- |
| SANITARY MANHOLE | ○ | ○ |
| SANITARY CLEANOUT | ○ | ○ |
| STORM MANHOLE | ○ | ○ |
| CATCH BASIN | ○ | ○ |
| INLET | ○ | ○ |
| FLARED END SECTION | ○ | ○ |
| FIRE HYDRANT | ○ | ○ |
| VALVE VAULT | ○ | ○ |
| VALVE BOX | ○ | ○ |
| STREET LIGHT | ○ | ○ |
| POWER POLE | ○ | ○ |
| STREET SIGN | ○ | ○ |
| ELECTRIC BOX | ○ | ○ |
| TELEPHONE BOX | ○ | ○ |
| TELEPHONE MANHOLE | ○ | ○ |
| B-BOX | ○ | ○ |
| GAS VALVE | ○ | ○ |
| TRAFFIC HANDHOLE | ○ | ○ |
| ELECTRIC HANDHOLE | ○ | ○ |
| MAILBOX | ○ | ○ |
| PARKING METER | ○ | ○ |
| TREE W/ DIAMETER | ○ | ○ |
| UTILITY CROSSING | ○ | ○ |
| SPOT ELEVATION | X | X |
| TOP OF CURB ELEVATION | X | X |
| TOP OF FOUNDATION ELEVATION | X | X |
| GUTTER ELEVATION | X | X |
| PAVEMENT ELEVATION | X | X |
| FORCE MAIN | --- | --- |
| UNDERDRAIN | --- | --- |
| OVERHEAD LINE | --- | --- |
| CABLE TV LINE | --- | --- |
| HIGH WATER LEVEL | --- | --- |
| NORMAL WATER LEVEL | --- | --- |
| PAVEMENT FLOW DIRECTION | --- | --- |
| EXPLORATORY EXCAVATION LOCATION | ○ | ○ |
| ADDRESS | ○ | ○ |
| SANITARY MANHOLE REHABILITATION NUMBER | ○ | ○ |
| SOIL BORING LOCATION WITH IDENTIFICATION NUMBER & ELEVATION | ○ | ○ |
| STRUCTURE TO BE REMOVED | X | X |
| PLUG EXISTING PIPE | ○ | ○ |

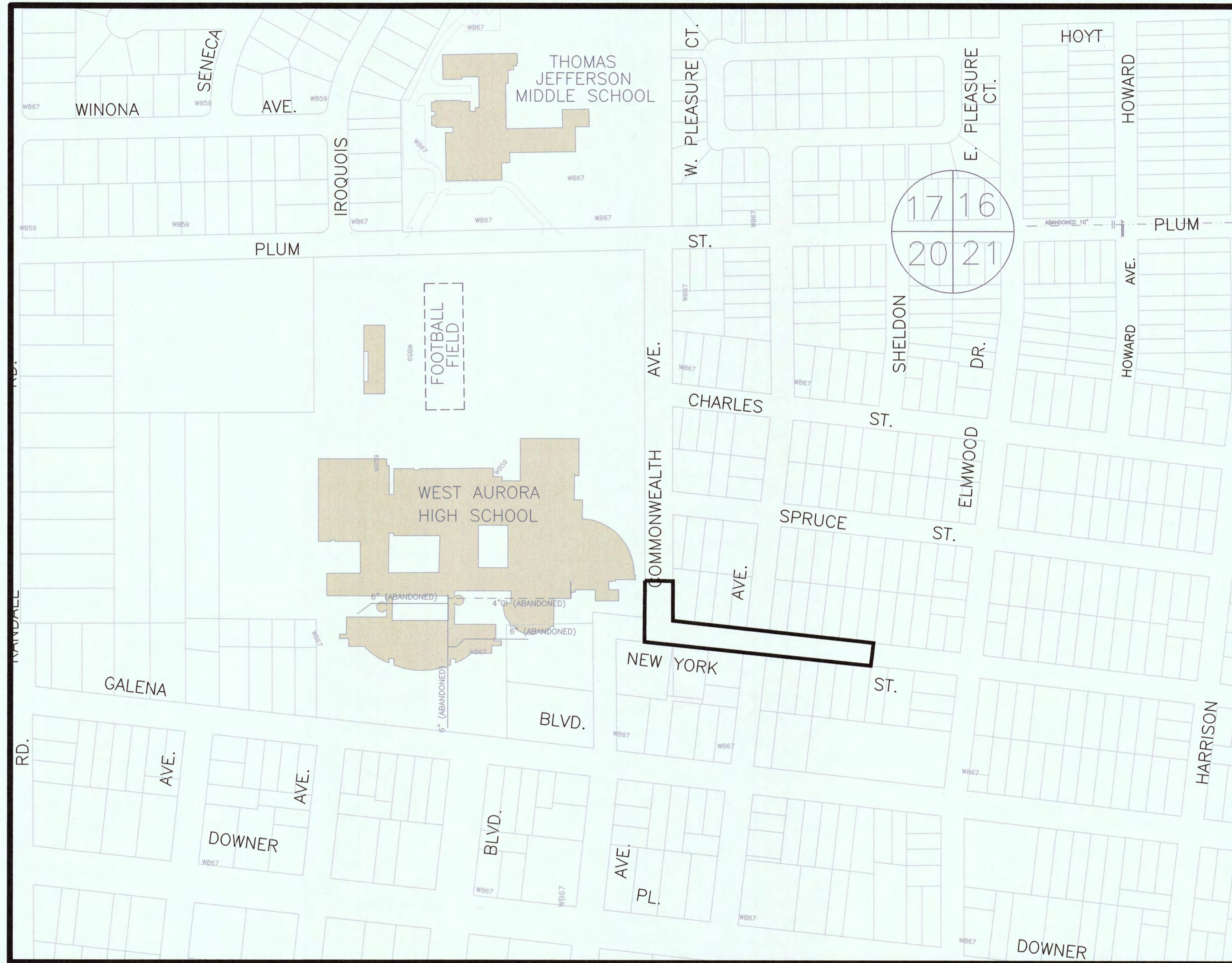

INDEX OF SHEETS

- 1 COVER SHEET
- 2-3 PLAN AND PROFILE
- 4-7 STANDARD DETAIL SHEETS

PLANS PREPARED BY:

CITY OF AURORA

DEPARTMENT OF PUBLIC WORKS, DIVISION OF ENGINEERING

44 E. DOWNER PLACE - AURORA, IL

PHONE: 630-256-3200 FAX: 630-256-3229

REVISIONS:

| | | | | | |
|------------------|---------------|-----------------|------------------|-------------------|------------------|
| DESIGNED BY: KTM | DRAWN BY: KTM | CHECKED BY: JMB | APPROVED BY: JMB | HORIZ. SCALE: N/A | DATE: MARCH 2019 |
| | | | | VERT. SCALE: N/A | |

STAMP
 ILLINOIS REGISTERED PROFESSIONAL
 ENGINEER No.
 LICENSE EXPIRES

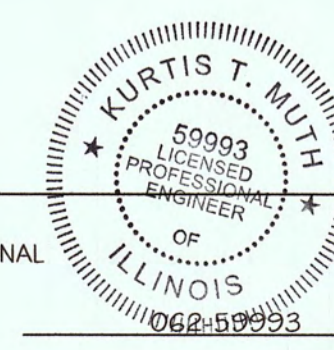

DATE: 3/6/19

NOVEMBER 30, 2019