

# EAST PARK AVE & SOUTH AVE SEWER SEPARATION

JULY 2023

GENERALLY LOCATED: NW 1/4 SECTION 27, T38N, R8E

LEGEND	
EXISTING	PROPOSED
SANITARY SEWER	8" PVC
STORM SEWER	12" STORM
WATERMAIN	8" VM
GAS LINE	
TELEPHONE LINE	
ELECTRIC LINE	
FENCE	
INDEX CONTOUR	
INTERMEDIATE CONTOUR	
EDGE OF PAVEMENT	
CURB AND GUTTER	
RIGHT-OF-WAY	
SANITARY MANHOLE	
SANITARY CLEANOUT	
STORM MANHOLE	
CATCH BASIN	
INLET	
FLARED END SECTION	
FIRE HYDRANT	
VALVE VAULT	
VALVE BOX	
STREET LIGHT	
POWER POLE	
STREET SIGN	
ELECTRIC BOX	
TELEPHONE BOX	
TELEPHONE MANHOLE	
B-BOX	
GAS VALVE	
TRAFFIC HANDHOLE	
ELECTRIC HANDHOLE	
MAILBOX	
PARKING METER	
TREE W/ DIAMETER	
UTILITY CROSSING	
SPOT ELEVATION	X 682.6
TOP OF CURB ELEVATION	X 682.6 TC
TOP OF FOUNDATION ELEVATION	X 682.6 TF
GUTTER ELEVATION	X 682.6 FL
PAVEMENT ELEVATION	X 682.6 P
FORCE MAIN	
UNDERDRAIN	
OVERHEAD LINE	
CABLE TV LINE	
HIGH WATER LEVEL	
NORMAL WATER LEVEL	
PAVEMENT FLOW DIRECTION	
EXPLORATORY EXCAVATION LOCATION	
ADDRESS	123
SANITARY MANHOLE REHABILITATION NUMBER	3-C-100
SOIL BORING LOCATION WITH IDENTIFICATION NUMBER & ELEVATION	SB #1 600.00
STRUCTURE TO BE REMOVED	
PLUG EXISTING PIPE	

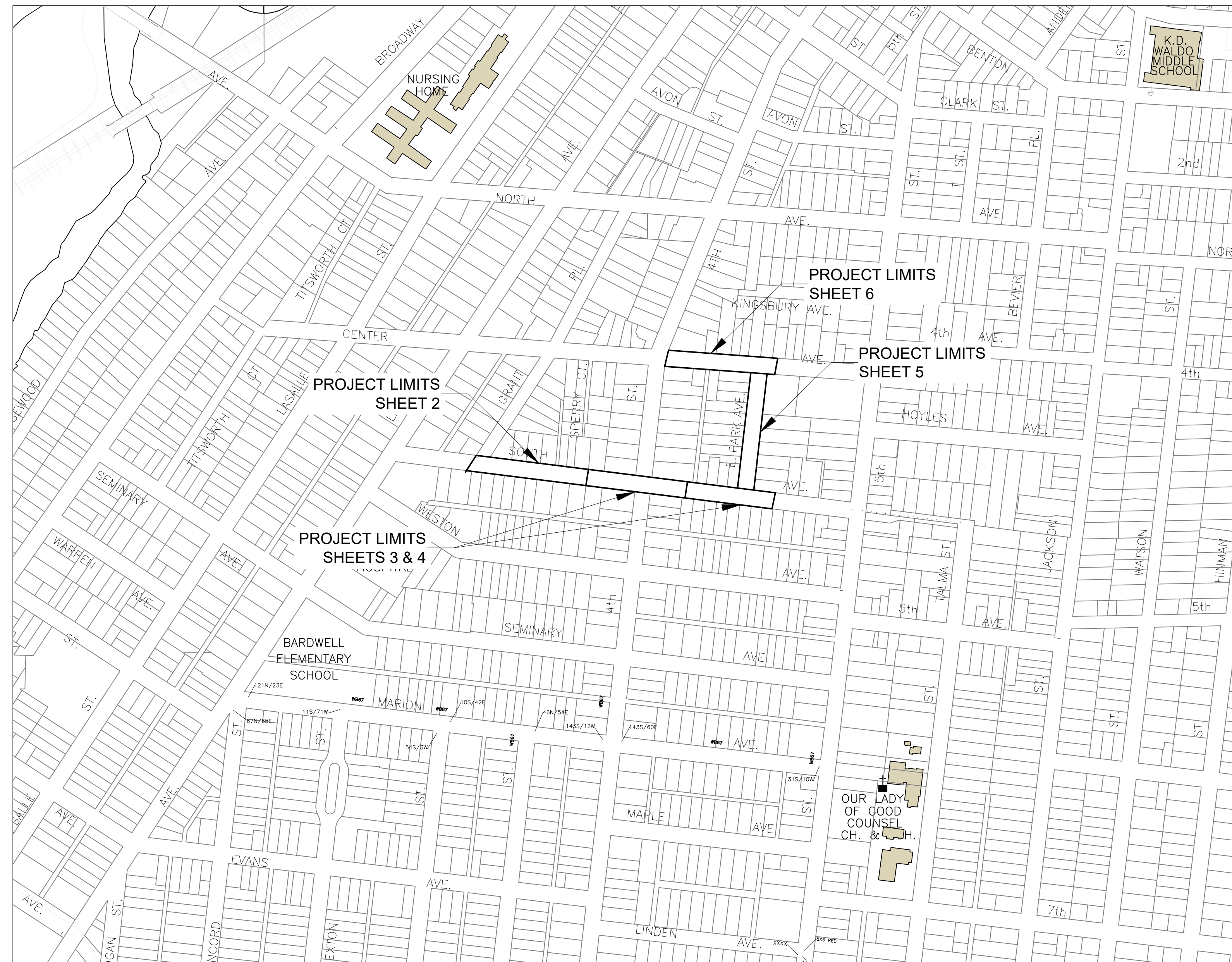

## INDEX OF SHEETS

- 1 COVER SHEET
- 2-6 PLAN AND PROFILE SHEETS
- 7-12 STANDARD DETAIL SHEET

PLANS PREPARED BY:

**CITY OF AURORA**

DEPARTMENT OF PUBLIC WORKS, DIVISION OF ENGINEERING  
77 S. BROADWAY AVE. - AURORA, IL

PHONE: 630-256-3200 FAX: 630-256-3229

REVISIONS:

DESIGNED BY: KTM DRAWN BY: AHB CHECKED BY: KTM APPROVED BY: KTM

HORIZ. SCALE: N/A

VERT. SCALE: N/A

DATE: 2023



*Kurtis T. Muth*

7/20/23  
DATE

ILLINOIS REGISTERED PROFESSIONAL

ENGINEER No. 062-59993

LICENSE EXPIRES NOVEMBER 30, 2023