

LANDSCAPE IMPLEMENTATION PLAN FOR AURORA FIRE STATION #7

PLANTING NOTES

- Seed limit line is approximate. Seed to limits of grading and disturbance. Contractor responsible for restoration of any unauthorized disruption outside of designated construction area.
- Contractor responsible for erosion control in all seeded areas.
- Tree mulch rings in turf areas are 5 foot diameter, typical. Contractor shall provide a mulch ring around all existing trees within the limit of work. Remove all existing grass from area to be mulched and provide a typical v-trench edge.
- Bedlines are to be spade cut to a minimum depth of 3 inches unless otherwise shown on the plans. Curved bedlines are to be smooth and not segmented.

- All perennial combinations are to be mixed evenly in the planting bed.
- Install 6" of topsoil in all seeded areas and 12" of amended topsoil in all planting beds.
- Do not locate plants within 10' of utility structures, or within 5' horizontally of underground utility lines unless otherwise shown on the plans. Consult with Landscape Architect if these conditions exist.
- Plants and other materials are quantified and summarized for the convenience of the Owner and jurisdictional agencies only. Confirm and install sufficient quantities to complete the work as drawn and specified.
- Refer to specifications for additional conditions, standards and notes.

PLANTING LEGEND

- Canopy tree
- Evergreen tree
- Understory tree
- Deciduous shrub
- Evergreen shrub
- Ornamental grass
- Perennials
- Turf grass (seeded)
- Naturalized planting area:
IDOT seeding class 4B
wetland grass and sedge mix
(Refer to Sheet C-106 Site
Erosion Control and SWPP
Plan for additional detail)

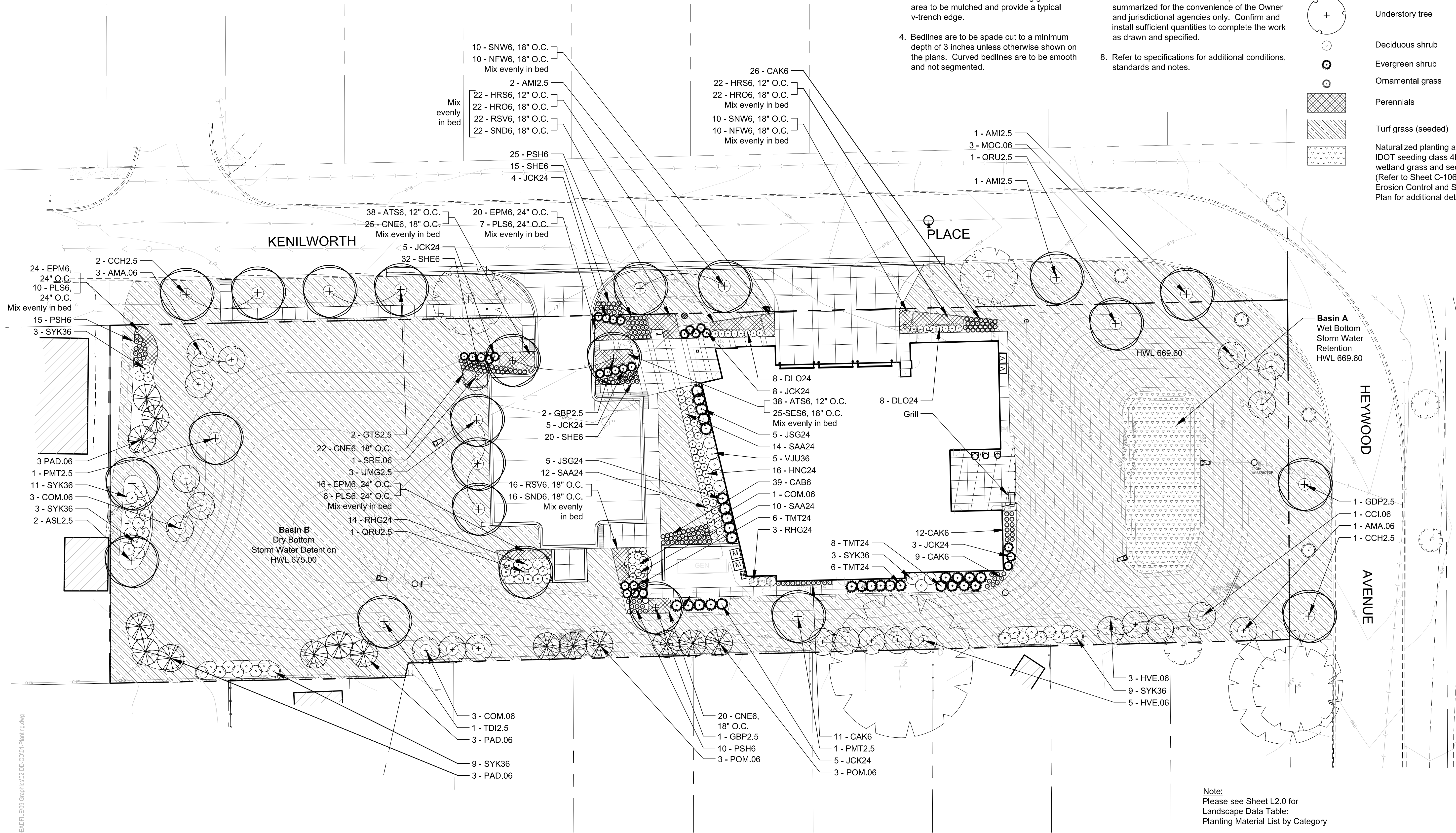

Note:
Please see Sheet L2.0 for
Landscape Data Table:
Planting Material List by Category

	CTE Value	Count Provided	Total CTEs Provided
Canopy Trees	1	23	23
Evergreen Trees	3	15	5
Understory Trees	3	24	8
Deciduous Shrubs	20	125	6
Evergreen Shrubs	20	57	3
Total:		244	45



225 W. Jefferson Avenue
Naperville, IL 60540
T 630.961.1787
hitchcockdesigngroup.com

PREPARED FOR
**Aurora Fire
Department**

75 N Broadway
Aurora, IL 60505

PROJECT

**Aurora Fire
Station #7**
824 Kenilworth Place
Aurora Illinois 60506



Tim King

PROJECT LOCATION



ISSUED
June 8, 2018
REVISIONS

No	Date	Issue

CHECKED BY: TCK
DRAWN BY: MPW

SHEET TITLE
**LANDSCAPE
PLAN**

SCALE IN FEET
1" = 20'



NORTH SHEET NUMBER



©2017 Hitchcock Design Group



ISSUED
June 8, 2018
REVISIONS

No	Date	Issue

CHECKED BY TCK DRAWN BY MPW

SHEET TITLE
LANDSCAPE DETAILS

SCALE IN FEET
as noted

NORTH SHEET NUMBER
L2.0

Landscape Implementation Data Table: Plant List by Category								
	QTY	Percent	SYM	BOTANICAL NAME (Family / Genus / Species)	COMMON NAME	SIZE	COMMENTS	
Canopy Trees	4	17%	AM2.5	Sapindaceae Acer miyabe 'Morton'	State Street Miyabe Maple	2 1/2" C		
	2	9%	ASL2.5	Sapindaceae Acer saccharum 'Legacy'	Legacy Sugar Maple	2 1/2" C		
	3	13%	CCH2.5	Cannabaceae Celtis occidentalis 'Chicagoland'	Chicagoland Hackberry	2 1/2" C		
	3	13%	GBP2.5	Ginkgoaceae Ginkgo biloba 'Princeton Sentry'	Princeton Sentry Ginkgo	2 1/2" C		
	2	9%	GTS2.5	Fabaceae Gleditsia triacanthos var. inermis 'Shademaster'	Shademaster Thornless Honeylocust	2 1/2" C		
	1	4%	GDP2.5	Fabaceae Gymnocladus dioicus 'Prairie Titan (male)'	Prairie Titan Kentucky Coffeetree	2 1/2" C		
	2	9%	PMT2.5	Platanaceae Platanus x acerifolia 'Morton Circle'	Exclamation! London Planetree	2 1/2" C		
	2	9%	QRU2.5	Fagaceae Quercus rubra	Red Oak	2 1/2" C		
	1	4%	TD2.5	Cupressaceae Taxodium distichum	Common Baldcypress	2 1/2" C		
	3	13%	UMG2.5	Ulmaceae Ulmus 'Morton Glossy'	Triumph Elm	2 1/2" C		
Total:	23	100%						
Evergreen Trees	9	60%	PAD.06	Pinaceae Picea glauca 'Densata'	Black Hills White Spruce	6' HT		
	6	40%	POM.06	Pinaceae Picea omorika	Serbian Spruce	6' HT		
Total:	15	100%						
Understory Trees	4	17%	AMA.06	Rosaceae Amelanchier x grandiflora 'Autumn Brilliance'	Autumn Brilliance Serviceberry	6' HT		
	4	17%	COM.06	Cornaceae Cornus mas	Cornellancherry Dogwood	6' HT		
	1	4%	CCI.06	Rosaceae Crataegus crusgalli var. inermis	Thornless Cockspur Hawthorn	6' HT		
	8	33%	HVE.06	Hamamelidaceae Hamamelis vernalis	Vernal Witchhazel	6' HT		
	6	25%	MOC.06	Rosaceae Malus 'Orange Crush'	Orange Crush Flowering Crabapple	6' HT		
	1	4%	SRE.06	Oleaceae Syringa reticulata 'Ivory Silk'	Ivory Silk Japanese Tree Lilac	6' HT		
	Total:	24	100%					
Deciduous Shrubs	16	12%	DLO24	Caprifoliaceae Diervilla lonicera	Dwarf Bush-honeysuckle	24" HT		
	16	12%	HNC24	Hydrangeaceae Hydrangea arborescens "NCHA1"	Invincibelle Spirit Hydrangea	24" HT		
	17	13%	RHG24	Anacardiaceae Rhus aromatica 'Gro-Low'	Gro-Low Fragrant Sumac	24" HT		
	39	29%	SAA24	Rosaceae Spiraea alba	Meadowsweet	24" HT		
	35	26%	SYK36	Oleaceae Syringa patula 'Miss Kim'	Miss Kim Manchurian Lilac	36" HT		
	7	5%	VCC36	Adoxaceae Viburnum carlesii 'Compactum'	Compact Koreanspice Viburnum	36" HT		
	5	4%	VJU36	Adoxaceae Viburnum x juddii	Judd Viburnum	36" HT		
	Total:	135	100%					
	Evergreen Shrubs	33	49%	JCK24	Cupressaceae Juniperus chinensis 'Kallay Compact'	Kallay Compact Chinese Juniper	24" HT	
		15	22%	JSG24	Cupressaceae Juniperus chinensis 'Sea Green'	Sea Green Chinese Juniper	24" HT	
20		29%	TMT24	Taxaceae Taxus x media 'Tauntonii'	Taunton Intermediate Yew	24" HT		
Total:	68	100%						
Ornamental Grasses	39	15%	CAB6	Poaceae Calamagrostis brachytricha	Korean Feather Reed Grass	1 GAL 3-4' HT		
	58	22%	CAK6	Poaceae Calamagrostis x acutiflora 'Karl Foerster'	Karl Foerster Feather Reed Grass	1 GAL 3-5' HT		
	50	19%	PSH6	Poaceae Panicum virgatum 'Shenandoah'	Shenandoah Switch Grass	1 GAL 3-4' HT		
	50	19%	SES6	Poaceae Seleria autumnalis	Autumn Moor Grass	1 GAL 1'HT		
	67	25%	SHE6	Poaceae Sporobolus heterolepis	Prairie Dropseed	1 GAL 2-3'HT		
	Total:	264	100%					
Perennials	76	19%	ATS6	Amaryllidaceae Allium tanguticum 'Summer Beauty'	Summer Beauty Ornamental Chive	1 GAL		
	42	10%	CNE6	Laminaceae Calamintha nepeta ssp nepeta	Lesser Calamint	1 GAL		
	60	15%	EPM6	Asteraceae Echinacea purpurea 'Magnus'	Magnus Purple Coneflower	1 GAL		
	44	11%	HHR6	Xanthorrhoeaceae Hemerocallis 'Happy Returns'	Happy Returns Daylily	1 GAL		
	44	11%	HRO6	Xanthorrhoeaceae Hemerocallis 'Rosy Returns'	Rosy Returns Daylily	1 GAL		
	20	5%	NFW6	Laminaceae Nepeta x faassenii 'Walker's Low'	Walker's Low Catmint	1 GAL		
	23	6%	PLS6	Laminaceae Perovskia atriplicifolia 'Little Spire'	Little Spire Russian Sage	1 GAL		
	38	9%	RSV6	Asteraceae Rudbeckia speciosa 'Viette's Little Suzy'	Viette's Little Suzy Black-eyed Susan	1 GAL		
	20	5%	SNW6	Laminaceae Salvia nemorosa 'Wesuwe'	Wesuwe Salvia	1 GAL		
	38	9%	SND6	Asteraceae Symphyotrichum (Aster) novae-angliae 'Purple Dome'	Purple Dome New England Aster	1 GAL		
	Total:	405	100%					

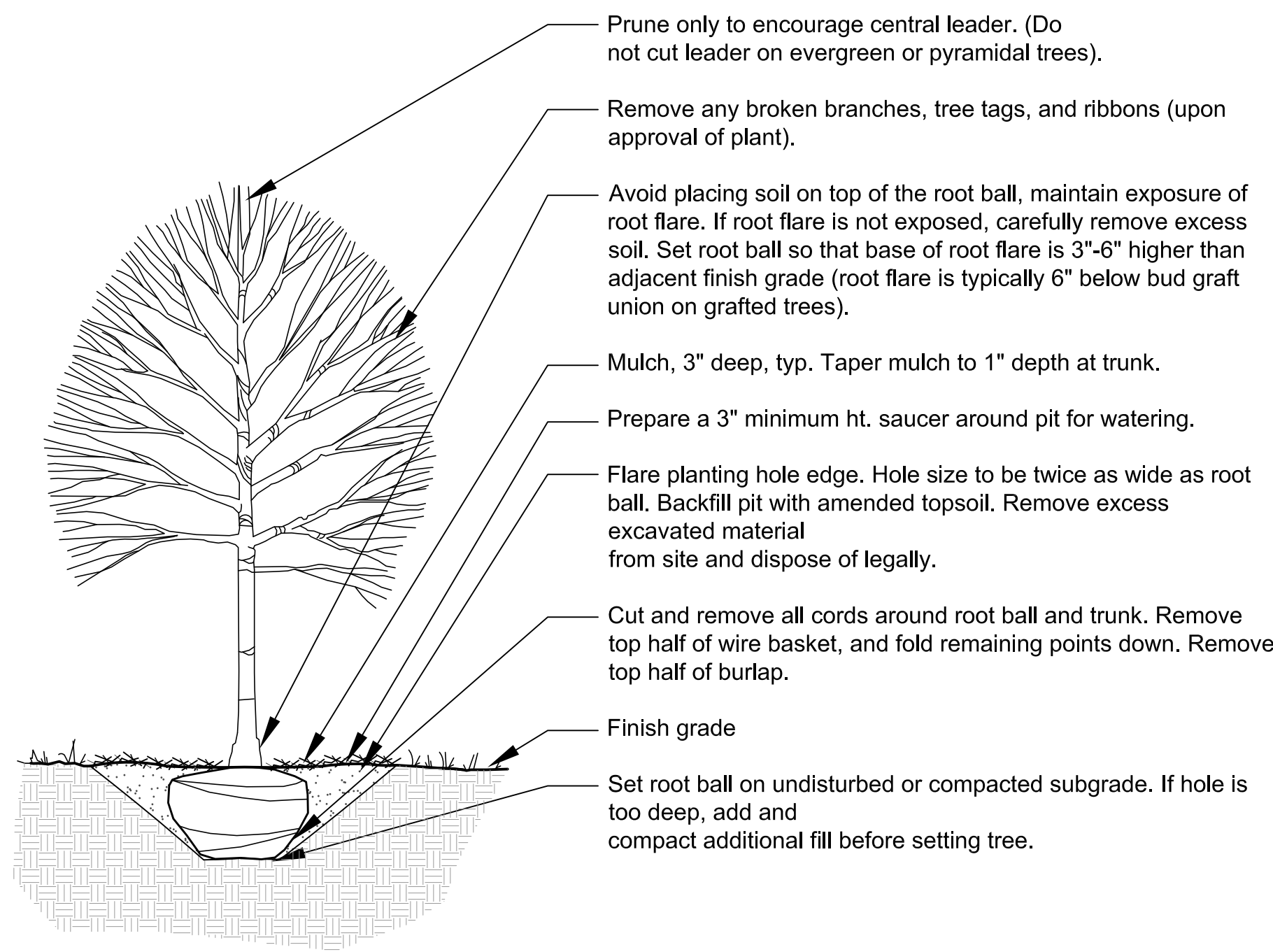

1 Deciduous Tree Planting

1/2" = 1'-0"

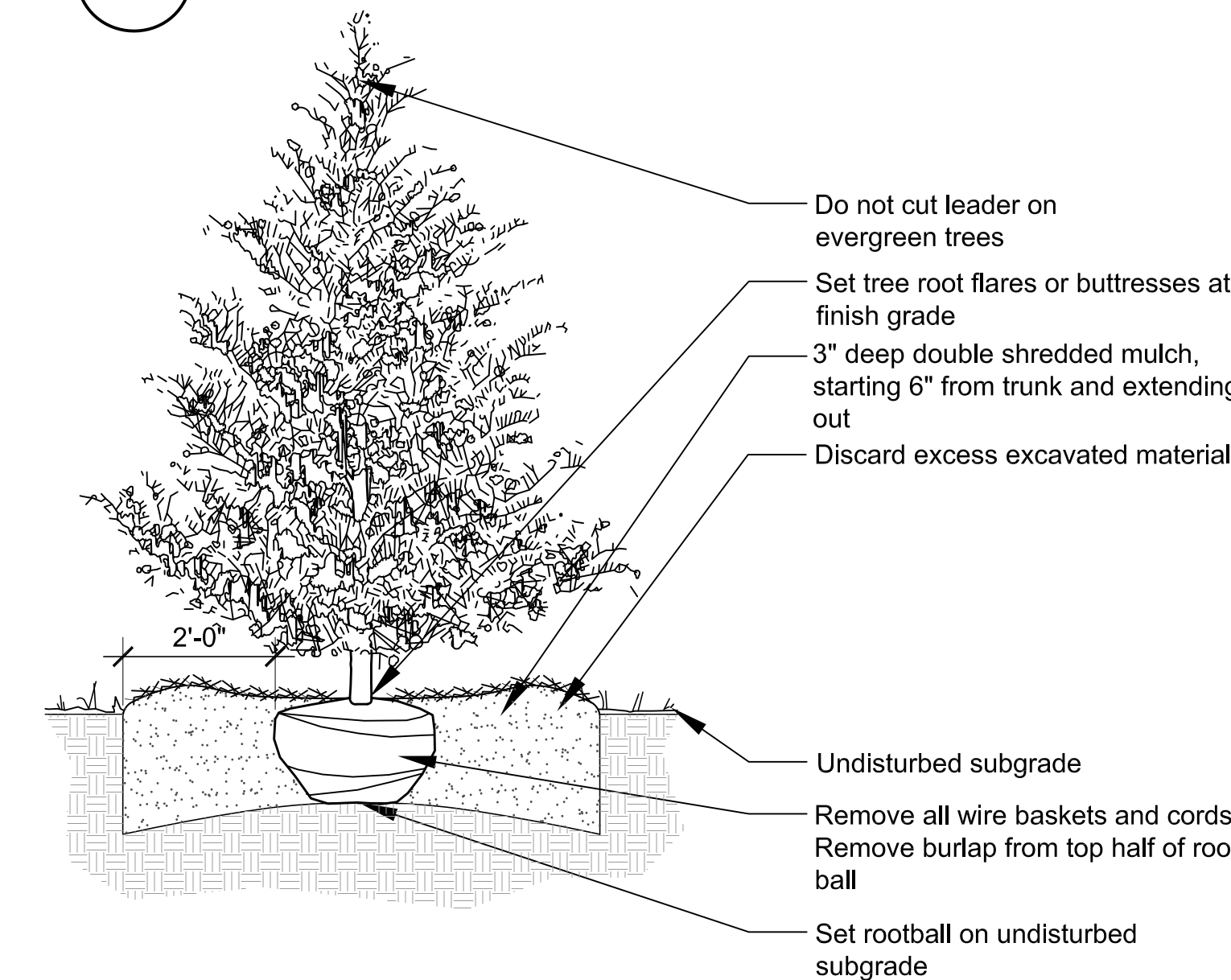

2 Evergreen Tree Planting

1/2" = 1'-0"

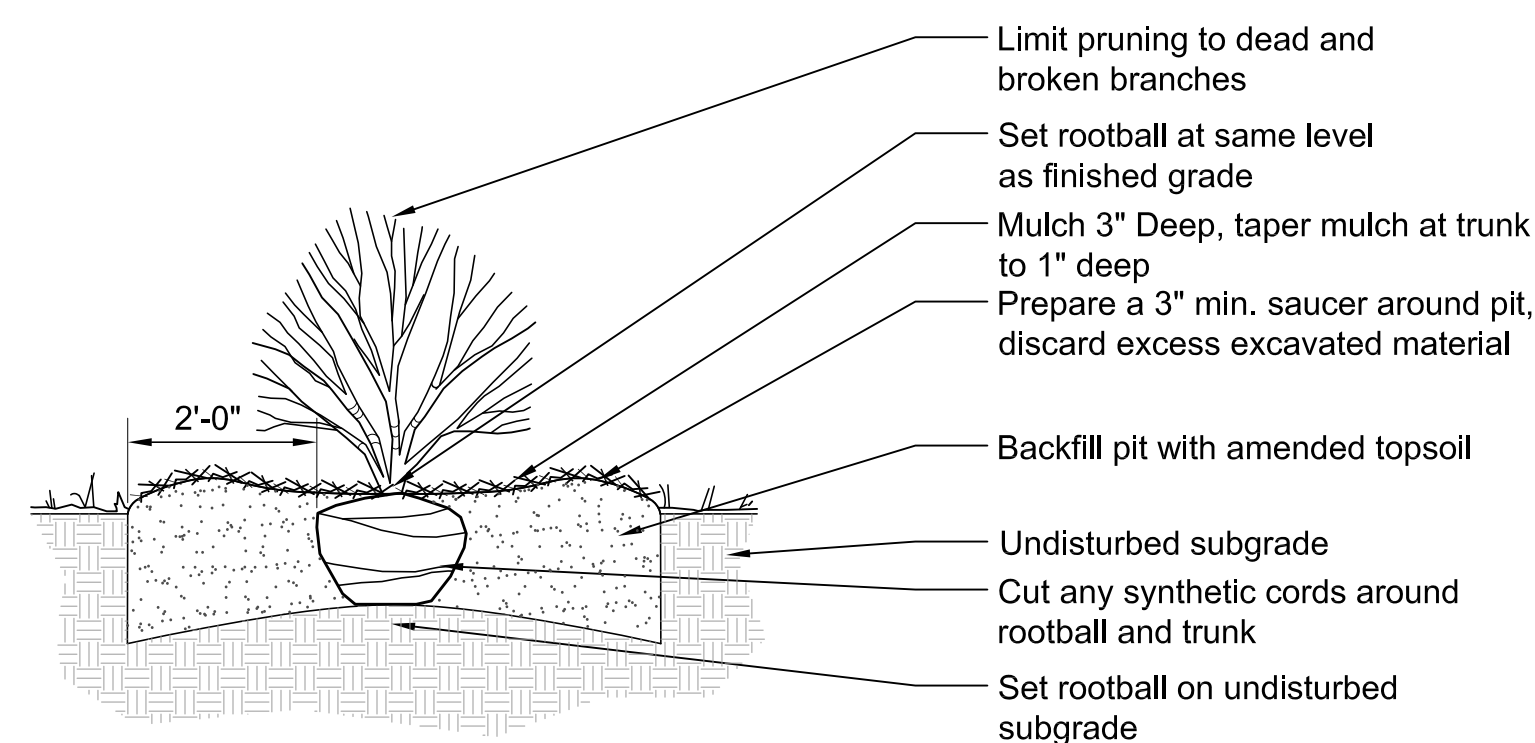

4 Shrub Planting

1/2" = 1'-0"

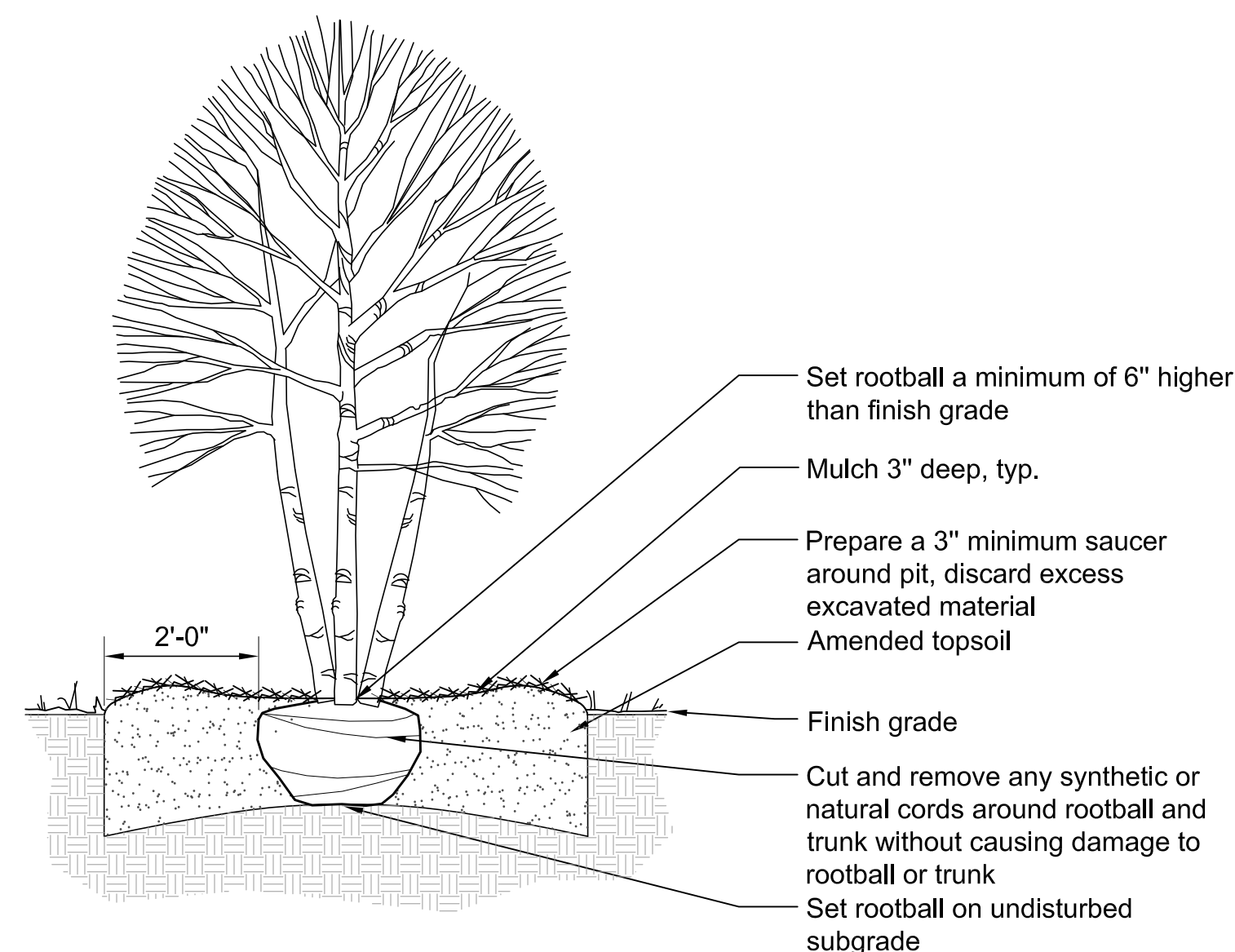

3 Understory Tree Planting

1/2" = 1'-0"

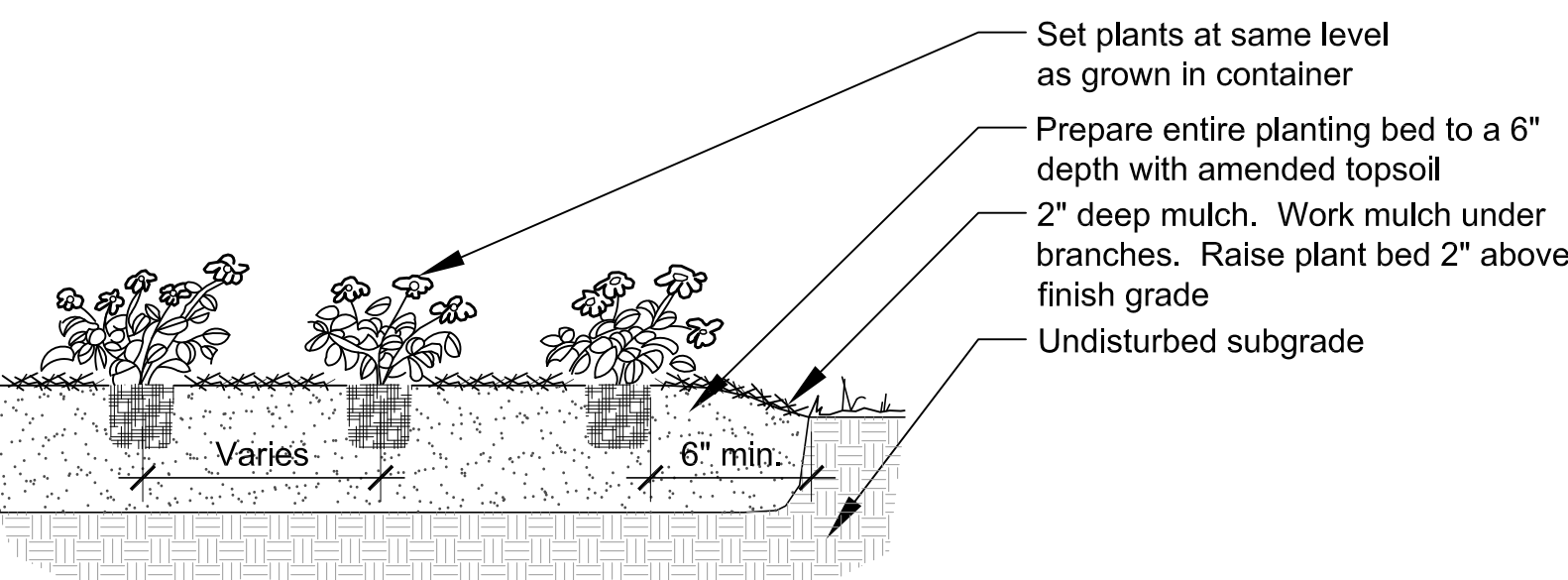

5 Perennial Planting

1/2" = 1'-0"



225 W. Jefferson Avenue
Naperville, IL 60540
T 630.961.1787
hitchcockdesigngroup.com

PREPARED FOR
Aurora Fire Department

75 N Broadway
Aurora, IL 60505

PROJECT
Aurora Fire Station #7
824 Kenilworth Place
Aurora Illinois 60506



ISSUED

June 8, 2018

REVISIONS

No	Date	Issue

CHECKED BY TCK DRAWN BY MPW

SHEET TITLE
LANDSCAPE SPECIFICATIONS

SCALE IN FEET



NORTH SHEET NUMBER

L3.0

©2017 Hitchcock Design Group

TREES, SHRUBS, AND GROUNDCOVERS

PART 1 - GENERAL

1.1 SUMMARY

A. Section Includes:

1. Trees.
2. Shrubs.
3. Ground cover.
4. Perennials.

1.2 DEFINITIONS

- A. Backfill: The earth used to replace or the act of replacing earth in an excavation.
- B. Finish Grade: Elevation of finished surface of planting soil.
- C. Manufactured Topsoil: Soil produced off-site by homogeneously blending mineral soils or sand with stabilized organic soil amendments to produce topsoil or planting soil.
- D. Planting Soil: Native or imported topsoil, manufactured topsoil, or surface soil modified to become topsoil; mixed with soil amendments.
- E. Subgrade: Surface or elevation of subsoil remaining after completing excavation, or top surface of a fill or backfill, before placing planting soil.
- F. Subsoil: All soil beneath the topsoil layer of the soil profile, and typified by the lack of organic matter and soil organisms.

1.3 SUBMITTALS

- A. Product Data: For each type of product indicated.
- B. Samples of mulch.
- C. Product certificates.
- D. Maintenance Instructions: Recommended procedures to be established by Owner for maintenance of exterior plants during a calendar year.

1.4 QUALITY ASSURANCE

- A. Installer's Field Supervision: Require Installer to maintain an experienced full-time supervisor on Project site when planting is in progress.
- B. Select plant material grown in the same USDA Hardiness Zone as the project site. Obtain Owner approval, prior to plant selection, for each species not grown in the same hardiness zone.
- C. Provide quality, size, genus, species, and variety of exterior plants indicated, complying with applicable requirements in ANSI Z60.1, "American Standard for Nursery Stock."
- D. Plants are subject to inspection by the Owners Representative at the job site or nursery. The Owners Representative reserves the right to personally select any or all nursery stock prior to digging.
- E. Preinstallation Conference: Conduct conference at Project site.

1.5 DELIVERY, STORAGE, AND HANDLING

- A. Do not prune trees and shrubs before delivery. Protect bark, branches, and root systems from sun scald, drying, sweating, whipping, and other handling and tying damage. Do not bend or bind-tie trees or shrubs in such a manner as to destroy their natural shape. Provide protective covering of exterior plants during delivery. Do not drop exterior plants during delivery and handling.
- B. Handle planting stock by root ball.
- C. Deliver exterior plants after preparations for planting have been completed and install immediately. If planting is delayed more than six hours after delivery, set exterior plants and trees in shade, protect from weather and mechanical damage, and keep roots moist.

1.6 WARRANTY

- A. Warranty: Installer's standard form in which Installer agrees to repair or replace plantings that fail in materials, workmanship, or growth within specified warranty period.
 1. Failures include, but are not limited to, the following:
 - a. Death and unsatisfactory growth, except for defects resulting from lack of adequate maintenance, neglect, abuse by Owner, or incidents that are beyond Contractor's control.

- b. Structural failures including plantings falling or blowing over.
2. Warranty Period from date of Final Acceptance for all plant material shall be one year.

1.7 MAINTENANCE SERVICE

- A. Initial Maintenance Service: Provide full maintenance by skilled employees of landscape Installer. Maintain as required in Part 3. Begin maintenance immediately after each area is planted and continue until plantings are acceptably healthy and well established, and until Final Acceptance.

PART 2 - PRODUCTS

2.1 TREE AND SHRUB MATERIAL

- A. General: Furnish nursery-grown trees and shrubs complying with ANSI Z60.1, "American Standard for Nursery Stock", with healthy root systems developed by transplanting or root pruning. Provide well-shaped, fully branched, healthy, vigorous stock free of disease, insects, eggs, larvae, and defects such as knots, sun scald, injuries, abrasions, and disfigurement.
- B. Root-Ball Depth: Furnish trees and shrubs with root balls measured from top of root ball, which shall begin at root flare according to ANSI Z60.1. Root flare shall be visible before planting.
- C. Provide balled and burlapped trees, oak trees may be fabric bag-grown.
- D. Shrub sizes indicated on Drawings are sizes after pruning.

2.2 GROUND COVER PLANTS

- A. Ground Cover: Provide ground cover of species indicated, established and well rooted in pots or similar containers, and complying with ANSI Z60.1.

2.3 PLANTS

- A. Annuals and Biennials: Provide healthy, disease-free plants of species and variety shown or listed, with well-established root systems reaching to sides of the container to maintain a firm ball, but not with excessive root growth encircling the container. Provide only plants that are acclimated to outdoor conditions before delivery and that are in bud but not yet in bloom.
- B. Perennials: Provide healthy, field-grown plants from a commercial nursery, of species and variety shown or listed, complying with requirements in ANSI Z60.1.
- C. Vines: Provide vines of species indicated complying with requirements in ANSI Z60.1.

2.4 TOPSOIL

- A. Topsoil: ASTM D 5268, pH range of 5.5 to 7, a minimum of 4 percent organic material content; free of stones 1 inch or larger in any dimension and other extraneous materials harmful to plant growth.
 1. Topsoil Source: Reuse surface soil stockpiled on-site. Verify suitability of stockpiled surface soil to produce topsoil. Clean surface soil of roots, plants, sod, stones, clay lumps, and other extraneous materials harmful to plant growth.
 - a. Supplement with imported or manufactured topsoil from off-site sources when quantities are insufficient. Obtain topsoil displaced from naturally well-drained construction or mining sites where topsoil occurs at least 4 inches deep; do not obtain from agricultural land, bogs or marshes.

2.5 SOIL AMENDMENTS

- A. Soil Conditioner: One Step Soil Conditioner, available from White Premium Organics, 2560 Foxfield Road, Suite 200, St. Charles, IL 60174. Phone (866) 586-1563. Fax (630) 377-9934. www.whitepremiuorganics.com or equal as approved by Owners Representative.

2.6 FERTILIZER

- A. Commercial Fertilizer: Commercial-grade complete fertilizer of neutral character, consisting of fast- and slow-release nitrogen, 50 percent derived from natural organic sources of urea formaldehyde, phosphorous, and potassium in the following composition:
 1. Composition: 1 lb/1000 sq. ft. of actual nitrogen, 0 percent phosphorous, and 2 percent potassium, by weight.

- B. Slow-Release Fertilizer: Granular or pelleted fertilizer consisting of 50 percent water-insoluble nitrogen, phosphorus, and potassium in the following composition:

1. Composition: 20 percent nitrogen, 0 percent phosphorous, and 10 percent potassium, by weight.

2.7 MULCHES

- A. Hardwood Mulch: Six-month old, well rotted, shredded, native hardwood bark mulch, not larger than 4" in length and ½" in width, free of wood chips and sawdust.

2.8 PLANTING SOIL MIX

- A. Planting Soil Mix: Mix topsoil with the following soil amendments and fertilizers in the following quantities:
 1. Ratio of Loose Soil Conditioner to Topsoil by Volume: 1:4.
 2. Weight of Commercial Fertilizer per 1000 sq. ft.: 5 pounds.
 3. Weight of Slow-Release Fertilizer per 1000 sq. ft.: 5 pounds.

PART 3 - EXECUTION

3.1 PLANTING BED ESTABLISHMENT

- A. Loosen subgrade of planting beds to a minimum depth of 8 inches. Remove stones larger than 1 inch in any dimension and sticks, vegetation, roots, rubbish, and other extraneous matter and legally dispose of them off Owner's property.
 1. Thoroughly blend planting soil mix off-site before spreading; or spread topsoil, apply soil amendments and fertilizer on surface, and thoroughly blend planting soil mix.
 2. Prepare planting bed areas and spread soil mix to a depth of 12 inches, meeting finish grades after natural settlement. Do not spread if planting soil or subgrade is frozen, muddy, or excessively wet.
- B. Finish Grading: Grade planting beds to a smooth, uniform surface plane with loose, uniformly fine texture. Roll and rake, remove ridges, and fill depressions to meet finish grades.

3.2 TREES AND SHRUBS

- A. Excavation of Pits and Trenches: Excavate circular pits with sides sloped inward. Trim base leaving center area raised slightly to support root ball and assist in drainage. Do not further disturb base. Scarify sides of plant pit smeared or smoothed during excavation.
 1. Excavate approximately three times as wide as ball diameter.
 2. Excavate at least 12 inches wider than root spread and deep enough to accommodate vertical roots for bare-root stock.
- B. Before planting, verify that root flare is visible at top of root ball according to ANSI Z60.1.
- C. Stock with Root Balls: Set trees and shrubs plumb and in center of pit or trench with top of root ball 6 inches above adjacent finish grades.
 1. Balled and Burlapped: Remove burlap and wire baskets from tops of root balls and partially from sides, but do not remove from under root balls. Remove pallets, if any, before setting. Do not use planting stock if root ball is cracked or broken before or during planting operation.
 2. Fabric Bag Grown: Carefully remove root ball from fabric bag without damaging root ball or plant. Do not use planting stock if root ball is cracked or broken before or during planting operation.
 3. Place planting soil mix around root ball in layers, tamping to settle mix and eliminate voids and air pockets. When pit is approximately one-half backfilled, water thoroughly before placing remainder of backfill. Repeat watering until no more water is absorbed. Water again after placing and tamping final layer of planting soil mix.
- D. Mulching: Apply 3-inch average thickness of organic mulch extending 12 inches beyond edge of planting pit or trench. Do not place mulch within 3 inches of trunks or stems.

3.3 TREE AND SHRUB PRUNING

- A. Remove only dead, dying, or broken branches. Do not prune for shape.
- B. Prune, thin, and shape trees and shrubs according to standard horticultural practice. Prune trees to retain required height and spread. Do not cut tree leaders; remove only injured or dead branches from flowering trees. Prune shrubs to retain natural character.

3.4 GROUND COVER AND PLANT PLANTING

- A. Set out and space ground cover and plants as shown on the plans, groundcovers typically 6-12 inches apart, plants typically 12-24 inches apart.
- B. Dig holes large enough to allow spreading of roots and backfill with planting soil.
- C. Work soil around roots to eliminate air pockets and leave a slight saucer indentation around plants to hold water.
- D. Water thoroughly after planting, taking care not to cover plant crowns with wet soil.
- E. Protect plants from hot sun and wind; remove protection if plants show evidence of recovery from transplanting shock.

3.5 PLANTING BED MULCHING

- A. Mulch planting beds and other areas indicated. Provide 5-foot diameter mulch ring around trees in lawn areas.
 1. Apply 3-inch average thickness of mulch, and finish level with adjacent finish grades. Do not place mulch against plant stems.

3.6 PLANT MAINTENANCE

- A. Tree and Shrub Maintenance: Maintain plantings by pruning, cultivating, watering, weeding, fertilizing, restoring planting saucers, and resetting to proper grades or vertical position, as required to establish healthy, viable plantings. Spray or treat as required to keep trees and shrubs free of insects and disease.
- B. Ground Cover and Plant Maintenance: Maintain and establish plantings by watering, weeding, fertilizing, mulching, and other operations as required to establish healthy, viable plantings.
- C. Protect exterior plants from damage due to landscape operations, operations by other contractors and trades, and others. Maintain protection during installation and maintenance periods. Treat, repair, or replace damaged plantings.

3.7 ACCEPTANCE

- D. Planted areas will be inspected during and upon completion of installation and accepted subject to compliance with specified materials and installation requirements.
 1. Planted areas will be Finally Accepted provided all requirements, including maintenance, have been complied with and plant materials are alive and in a healthy, vigorous condition.

END OF SECTION



225 W. Jefferson Avenue
Naperville, IL 60540
T 630.961.1787
hitchcockdesigngroup.com

PREPARED FOR
Aurora Fire Department
75 N Broadway
Aurora, IL 60505

PROJECT
Aurora Fire Station #7
824 Kenilworth Place
Aurora Illinois 60506

PROJECT LOCATION



ISSUED
June 8, 2018
REVISIONS

No	Date	Issue

CHECKED BY
TCK

DRAWN BY
MPW

SHEET TITLE
LANDSCAPE SPECIFICATIONS

SCALE IN FEET



NORTH

SHEET NUMBER

L3.1

©2017 Hitchcock Design Group

3.4 SEED INSTALLATION

- A. General:
 1. Seed immediately after preparation of bed.
 2. Seed indicated areas within contract limits and areas adjoining contract limits disturbed as a result of construction operations.
 3. Perform seeding operations when the soil is dry and when winds do not exceed 10 miles per hour velocity.
 4. Sow sun grass seed mix at the following rates:
New Seeding Rate: 4-5 pounds per 1,000 SF
Overseeding Rate: 2-3 pounds per 1,000 SF
 5. Sow shade grass seed mix at the following rates:
New Seeding Rate: 5-7 pounds per 1,000 SF
Overseeding Rate: 3-5 pounds per 1,000 SF
- B. Method:
 1. Conventional Seeding:
 - a. Apply seed with a rotary or drop type distributor. Install seed evenly by sowing equal quantities in two directions, at right angles to each other.
 - b. After seeding, rake soil surface lightly to incorporate seed. Roll with light lawn roller. Within 24 hours, hydrotackifyer to secure seed in place. On slopes of 3:1 or steeper, or within drainage areas, apply erosion control blanket and secure. Contractor responsible for repairing wash outs where blanket is not applied.
- C. Reconditioning Existing Turf:
 1. Recondition existing turf damaged by Contractor's operations, including storage of materials or equipment and movement of construction vehicles.
 2. Provide fertilizer, seed and soil amendments as specified for new lawns and as required to provide a satisfactory reconditioned lawn. Provide topsoil as required to fill low areas and meet new finish grades.
 3. Cultivate bare and compacted areas thoroughly.
 4. Remove diseased or unsatisfactory lawn areas. Do not bury into soil. Remove topsoil containing foreign materials resulting from Contractor's operations, including oil drippings, stone, gravel, and other construction materials.
 5. Where substantial, but thin lawn remains, rake, aerate if compacted, and cultivate soil; fertilize and seed.
 6. Water newly seeded areas. Maintain adequate soil moisture until new grass is established.

3.5 MAINTENANCE

- A. Maintain lawn areas for a period of at least 30 days after all Substantially Completed work in this section has received written Preliminary Acceptance by the Owner's Representative. Continue the required maintenance until all work in other sections receive written Final Acceptance.
- B. Maintain lawn areas, including watering, spot weeding, mowing, application of herbicides, fungicides, insecticides, and resodding or reseeding until a full, uniform stand of grass free of weed, undesirable grass species, disease, and insects is achieved and accepted by the Owner's Representative.
 1. Water seeded areas thoroughly as required to establish proper rooting.
 2. Repair and rework, all areas that have washed out or are eroded. Replace undesirable or dead areas with new seed.
 3. Mow lawn areas as soon as top growth reaches a 3" height. Cut back to 2" height. Repeat mowing as required to maintain specified height. Not mowing more than 40% of grass leaf shall be removed at any single mowing.
 4. Remove sod pegs following turf establishment.

3.6 ACCEPTANCE

- A. Lawn areas will be inspected at completion of installation and accepted subject to compliance with specified materials and installation requirements.
 1. Lawn areas will be acceptable provided all requirements, including maintenance, have been complied with, and a healthy, even colored viable lawn is established, free of weeds, undesirable grass species, bare areas 6" square or larger, disease, and insects.

3.7 CLEANING

- A. Perform cleaning during installation of the work and upon completion of the work. Remove from site all excess materials, debris, and equipment. Repair damage resulting from seeding operations.

END OF SECTION

2.3 SEED

- A. Lawn seed: Fresh, clean seed from most recently harvested crop which complies with all local, state, and federal seed and weed laws and is free from Poa annua, bent grass and noxious weeds. Mix to the specified proportions by weight.
 1. Sun Seed Blend:

Percent:	Percent:
Clesen Premium Mix	
"Full Moon" Kentucky Bluegrass	55%
"Moonlight" Kentucky Bluegrass	15%
"Jumpstart" Kentucky Bluegrass	10%
"Silver Dollar" Perennial Ryegrass	10%
"Gray Fox" Perennial Ryegrass	10%
 2. Shade Seed Blend:

Percent:	Percent:
Fancy Shade Mix	
"Epic" Creeping Red Fescue	35%
"Blitz" Kentucky Bluegrass	20%
"Diva" Kentucky Bluegrass	15%
"Reliant IV" Hard Fescue	15%
"Fairmont" Chewings Fescue	10%
"Palmer III" Perennial Ryegrass	5%
- 2.4 MULCHES AND ACCESSORIES
 - A. Straw Mulch: Clean oat or wheat straw, well seasoned before baling, free from mature seed-baring stalks or roots of prohibited or noxious weeds.
 - B. Tackifier: Liquid concentrate diluted with water forming a transparent 3-dimensional film-like crust permeable to water and air and containing no agents toxic to seed germination.
 - C. Stakes
 1. Softwood, 3/4" dia. x 8" long or,
 2. Steel, tee shaped pins, 4" head x 8" leg.
 - D. Water: Free of substances harmful to turf growth. Hoses or other method of transportation furnished by contractor.

PART 3 - EXECUTION

3.1 INSPECTION

- A. Examine finish surfaces, grades, topsoil quality, and depth. Do not start grassing work until unsatisfactory conditions are corrected.

3.2 LAWN PREPARATION

- A. Newly Graded Subgrades: Loosen subgrade to a minimum depth of 6 inches. Remove stones larger than 1 inch in any dimension and sticks, vegetation, roots, rubbish, and other extraneous matter and legally dispose of them off Owner's property.
 1. Thoroughly blend planting soil mix with topsoil off-site before spreading or spread topsoil, till-in soil amendments, and add fertilizer on surface.
 2. Spread planting soil mix to a depth of 6 inches but not less than required to meet finish grades after light rolling and natural settlement. Do not spread if planting soil or subgrade is frozen, muddy, or excessively wet.
- B. Unchanged Subgrades: If lawns are to be planted in areas unaltered or undisturbed by excavating, grading, or surface-soil stripping operations, prepare surface soil as follows:
 1. Remove existing grass, vegetation, and turf. Do not mix into surface soil.
 2. Loosen surface soil to a depth of at least 6 inches. Apply soil amendments according to planting soil mix proportions and mix thoroughly into top 6 inches of soil. Till soil to a homogeneous mixture of fine texture. Apply fertilizer directly to surface soil.
 3. Remove stones larger than 1 inch in any dimension and sticks, roots, trash, and other extraneous matter.
 4. Legally dispose of waste material, including grass, vegetation, and turf, off Owner's property.
- C. Finish Grading: Grade planting areas to a smooth, uniform surface plane with loose, uniformly fine texture. Grade to within plus or minus 1/2 inch of finish elevation. Roll and rake, remove ridges, and fill depressions to meet finish grades. Limit finish grading to areas that can be planted in the immediate future.
- D. Moisten prepared lawn areas before planting if soil is dry. Water thoroughly and allow surface to dry before planting. Do not create muddy soil.
- E. Before planting, restore areas if eroded or otherwise disturbed after finish grading.

3.3 FERTILIZATION

- A. Obtain Owner's Representative's approval of prepared topsoil.
- B. For seeded areas:
 1. Apply starter fertilizer to indicated seed areas at a rate equal to 650 lbs. per acre.
 2. Apply fertilizer by mechanical rotary or drop type distributor, thoroughly and evenly incorporated with soil to a depth of 3" by discing or other approved method. Fertilize areas inaccessible to power equipment with hand tools and incorporate into soil.

TURF GRASS

PART 1 - GENERAL

1.1 DESCRIPTION

- A. Provide turf areas as shown and specified. The work includes:
 1. Soil preparation.
 2. Fertilizing indicated areas.
 3. Seeding indicated areas.
 4. Maintenance and guarantee.
 5. Cleaning up work area.
- B. Related work:
 1. TREES, SHRUBS, AND GROUNDCOVERS

1.2 QUALITY ASSURANCE

- A. Comply with General and Supplementary Conditions.
- B. Apply with applicable local regulations.

1.3 SUBMITTALS

- A. Seed: Submit seed vendor's certification for required grass seed mixture, indicating percentage by weight, and percentages of purity, germination, and weed seed for each grass species.

1.4 DELIVERY, STORAGE, AND HANDLING

- A. Seed: Deliver seed and fertilizer materials in original unopened containers, showing weight, analysis, and name of manufacturer. Store in a manner to prevent wetting and deterioration.

1.5 PROJECT CONDITIONS

- A. Work notification: Notify Owner's Representative at least 2 working days prior to start of grassing operations.
- B. Fine grading must be approved by Owner's Representative prior to start of grassing operations.
- C. Protect existing utilities, paving, and other facilities from damage caused by grassing operations.
- D. Perform grassing work only after planting and other work affecting ground surface has been completed.
- E. Install seed under favorable weather conditions unless approved by the Owner's Representative. The conditions of the guarantee apply regardless of the date of installation. The generally accepted times for seeding are:

Spring - April 1 to May 31

Fall - August 15 to September 31

1.6 GUARANTEE

- A. Guarantee all work in this Section for one year following the date of Final Acceptance by the Owner's Representative. At the end of the guarantee period, reseed areas, with specified materials, which fail to provide a uniform stand of grass until all affected areas are accepted by the Owner's Representative.

PART 2 - PRODUCTS

2.1 TOPSOIL

- A. Topsoil: ASTM D 5268, pH range of 5.5 to 7, a minimum of 4 percent organic material content; free of stones 1 inch or larger in any dimension and other extraneous materials harmful to plant growth.
 1. Topsoil Source: Reuse surface soil stockpiled on-site. Verify suitability of stockpiled surface soil to produce topsoil. Clean surface soil of roots, plants, sod, stones, clay lumps, and other extraneous materials harmful to plant growth.
 - a. Supplement with imported or manufactured topsoil from off-site sources when quantities are insufficient. Obtain topsoil displaced from naturally well-drained construction or mining sites where topsoil occurs at least 4 inches deep; do not obtain from agricultural land, bogs or marshes.

2.1 FERTILIZER

- A. Seed Fertilizer
 1. Granular, non-burning product composed of not less than 50% organic slow acting, guaranteed analysis professional fertilizer.
 - a. Starter fertilizer with an approximate analysis of 6N, 24P2O5, 24K2O, or similar approved composition.
 - b. Post emergent fertilizer with an approximate analysis of 30-0-5.



225 W. Jefferson Avenue
Naperville, IL 60540
T 630.961.1787
hitchcockdesigngroup.com

PREPARED FOR
Aurora Fire Department
75 N Broadway
Aurora, IL 60505

PROJECT
Aurora Fire Station #7
824 Kenilworth Place
Aurora Illinois 60506



ISSUED
June 8, 2018
REVISIONS

No	Date	Issue

CHECKED BY TCK DRAWN BY MPW

SHEET TITLE
LANDSCAPE SPECIFICATIONS

SCALE IN FEET



NORTH SHEET NUMBER

L3.2

©2017 Hitchcock Design Group

NATURALIZED PLANTING AREAS - SEEDING

PART 1 - GENERAL

1.1 DESCRIPTION

A. This work shall consist of furnishing, transporting, and installing all seeds, plant, or other materials required for (1) the establishment of the native seeding areas, (2) post-planting management until released by the Owner's Representative, and (3) any remedial operations in conformance with the Plans as specified in this Special Provision or as directed by the Owner's Representative.

B. Related work:

- NATURALIZED PLANTING AREA ESTABLISHMENT for post installation management requirements.

1.2 PROJECT CONDITIONS

- The grade to be shaped to the elevation shown in the Plans.
- The topsoil will be free of all clods, stones, roots sticks, rivulets, gullies, crusting, caking, and have a soil particle size of no larger than 2" unless using a No-till Rangeland Grass Drill or Hydro-seeder.
- A temporary fuel matrix cover crop will be established on the all prairie areas after the first full growing season.

1.3 SUBMITTALS

- A. Product Data: For each type of product indicated.
- B. Certification of Native Seed: From seed vendor for each seed monostand or mixture stating the botanical and common name and percentage by weight of each species and variety, and percentage of purity, germination, and weed seed. Include the year of production and date of packaging.
- C. Product Certificates: For soil amendments and fertilizers, signed by product manufacturer.
- D. Material Test Reports: For existing surface soil and imported topsoil.
- E. Planting Schedule: Indicating anticipated planting dates for each type of planting.
- F. Maintenance Instructions: Recommended procedures to be established by Owner for maintenance of lawns during a calendar year. Submit before expiration of required maintenance periods.

1.4 QUALITY ASSURANCE

- A. Installer Qualifications: A qualified landscape installer whose work has resulted in successful native plant establishment for at least 5 years including 3 compatible project examples.
- Installer's Field Supervision: Require Installer to maintain an experienced full-time supervisor on Project site when planting is in progress.
- B. Soil-Testing Laboratory Qualifications: An independent laboratory, recognized by the State Department of Agriculture, with the experience and capability to conduct the testing indicated and that specializes in types of tests to be performed.
- Topsoil Analysis: As indicated in Division 2 "Exterior Plants"

1.5 DELIVERY, STORAGE, AND HANDLING

- A. Seed: Deliver seed in original sealed, labeled, and undamaged containers.

1.6 SCHEDULING

- A. Planting Restrictions: Plant during one of the following periods. Coordinate planting periods with maintenance periods to provide required maintenance from date of Substantial Completion. Avoid planting during times of drought.
- Spring Planting: April 15-June 1
 - Fall Planting: September 15- October 15
- B. Weather Limitations: Proceed with planting only when existing and forecasted weather conditions permit.

1.7 MAINTENANCE

- A. Refer to NATURALIZED PLANTING AREA ESTABLISHMENT

1.8 WARRANTY

- A. Special Warranty: Installer's standard form in which Installer agrees to repair or replace plantings that fail in materials, workmanship, or growth within specified warranty period.
- Failures include, but are not limited to, the following:
 - Death and unsatisfactory growth, except for defects resulting from lack of adequate maintenance, neglect, abuse by Owner, or incidents that are beyond Contractor's control.
 - Warranty Periods from Date of Substantial Completion:
 - Plants: one year from final acceptance.

PART 2 - PRODUCTS

2.1 MATERIALS

- A. All materials shall conform to the following requirements:
- All seeds shall be guaranteed by the Contractor to be true to name and variety.
 - Seed mixtures shall be proportioned by seed count and seed count percentages. Seed mixtures shall be approved by the Owner's Representative.
 - The seed counts and seed counts percentages indicated per acre in these specifications shall mean the total amount of pure live seed per acre for all species listed except forbs.
 - At least 2 weeks prior to the time of seeding, the Contractor shall provide for the approval of the Owner's Representative a written description for the grass, sedges, and forbs seed and/or plant mix showing the percentages by number of seed and/or plants of each species. This description shall also include the following:
 - Name and location of seed and/or plant supplier.
 - Origin of the various species of seed.
 - A statement of the purity of the grasses.
 - The estimated number of seeds per pound of each of the kinds of seed to be furnished.
 - All seeds shall have the proper stratification and/or scarification to break seed dormancy for other than fall planting.
 - All legumes shall be inoculated with the proper rhizobia and at appropriate time prior to planting.
 - All seeds shall be packed and covered in such a manner as to insure adequate protection against damage and maintain dormancy while in transit, storage or during planting operations.
 - Seeds and plants shall be true to their name as specified. The seed sources shall be within a 200 mile radius of the project location.

2.2 NATURALIZED PLANTING AREA SEED MIX

- A. IDOT Class 4B Wetland Grass & Sedge Mixture

Annual Ryegrass	25 lbs./acre
Spring Oats	25 lbs./acre
Wetland Grasses (Below)	6lbs./acre
	56lbs./acre

Wetland Grasses: Species % by Weight

Blue Joint Grass	12%
Lake-Bank Sedge	6%
Tussock Sedge	6%
Fox Sedge	6%
Needle Spike Rush	3%
Blunt Spike Rush	3%
Fowl Manna Grass	14%
Common Rush	6%
Slender Rush	6%
Torrey's Rush	6%
Rice Cut Grass	10%
Hard-Stemmed Bulrush	3%
Dark Green Rush	3%
River Bulrush	3%
Softstem Bulrush	3%
Cord Grass	4%

2.3 SEEDING EQUIPMENT

If the Contractor elects to use the following seeding equipment, it shall meet the following requirements. Any other equipment deemed necessary shall be subject to the approval of the Owner's Representative.

- A. Disc: Any disc proposed for the use shall be in a good state of repair with sound, unbroken blades. The disc shall be weighted if necessary to achieve the required tillage depth.
- B. Hydraulic Seeder: Hydraulic seeding equipment shall include a pump rated and operated and no less than 100 gallons per minute and no less than 100 pounds per square inch pressure. The tank shall have a mechanical agitator powerful enough to keep the seed in suspension in the water.
- C. Rollers or Cultipackers: The roller or cultipacker shall have rollers at least six inches in diameter and shall be of sufficient weight to pulverize the clods of soil.
- D. Spinning Disc Seeder: When spinning-disc seeders are used, the individual seeds comprising the seeding mixture shall be mixed with an appropriate dispersal medium prior to sowing and seeds with awns shall be de-bearded.
- E. Tractor Drawn or Mounted Seeders: Tractor drawn or mounted seeders shall have an adjustable gate opening providing uniform flow over a width adapted to the work and shall drop the seed directly into place on the prepared seedbed. The seeder may be of the type mounted on cultipacker rollers which covers the seed and rolls the seedbed in one operation, and shall be approved by the Owner's Representative prior to use.
- F. No-Till Planters and Drills: Rangeland type drills and no-till planters shall be designed specifically for the seeding of native grasses and forbs.
- G. Equipment shall be clean and free of weed or invasive species seed prior to each use.

2.4 MULCHES

- A. Erosion Control Blanket: Coordinate with Civil Plans for installation of erosion control blanket.

PART 3 - INSTALLATION

3.1 SEEDBED PREPARATION

- A. Seedbed preparation methods shall be approved by the Owner's Representative. Cultivation shall be accomplished at such a time that seeding may occur immediately and without delay. No seeds shall be sown until the seedbed has been approved by the Owner's Representative. If a no-till planter is used, seedbed preparation will not be necessary.

3.2 SEEDING METHODS

- A. General: The Contractor shall submit for approval by the Owner's Representative a plan and schedule for seeding and/or planting at least two weeks prior to the scheduled commencement of work. For broadcast seeders, no seeds shall be sown during high winds or when the seedbed is not in a proper condition for seeding. The Owner's Representative shall examine and then approve any equipment to be used. Prior to starting work, all seeding equipment shall be calibrated and adjusted to sow seeds at the proper seeding rate. Equipment shall be operated in a manner to insure complete coverage of the entire area to be seeded. The Owner's Representative shall be notified 48 hours prior to beginning the seeding operations. Any gaps between areas of growth greater than eight square feet shall be resown and/or replanted.
- B. Seed shall be packaged individually and sorted by size prior to seeding. Till in separately to ensure uniform coverage of all seed types and sizes.
- C. Hydroseeding: The hydraulic seeding equipment shall include a pump rated and operated at no less than 100 gallons per minute and at no less than 100 pounds per square inch pressure. A minimum of 1,000 gallons of slurry shall be used. The tank shall have a mechanical agitator powerful enough to keep all materials in a uniform suspension in the water. Calibration of the hydraulic seeding equipment shall be accurate and to the satisfaction of the Owner's Representative. If the Contractor has another method for hydroseeding, he shall submit this method to the Owner's Representative for evaluation and approval 30 days prior to his scheduled start date.

- D. No-Till or Drill Method: Seed shall be drilled by a rangeland type no-till drill designed to plant native grass and forb seed (such as the Truax No-Till Drill) if the soil is firm enough. Seed shall be drilled in two (2) separate runs where each application of seed shall overlap the previous application by one half (1/2) the weight to insure double coverage of seeded areas (example: seed in a north to south direction @ ten pounds per acre, then overlap by seeding in an east to west direction @ ten pounds per acre, resulting in a total coverage of twenty pounds per acre [twenty pounds per acre is an example only, see the plans for actual project seeding rates]). Each planting run shall overlap by a minimum of one (1) planting row. Some seed species require exposure to sunlight for germination, these species shall be planted separately, after drilling, utilizing the broadcasting method.
- If a rangeland type grass drill or no-till planter is used, rolling of the seedbed will not be required. The placing of mulch is not be required when a no-till planter is used, except on sloping ground with exposed soil, where erosion control blanket is necessary.
- E. Broadcast Method: If soil conditions are too wet or slopes are too steep for drilling, broadcasting of seed is acceptable. If seed is broadcast, it should be mixed with an equal amount of inert filter (such as perlite, sand, vermiculite, ground corn cobs) to enable an even distribution of seed. Mix ratios of seed and inert filters at 2:1 (filter: seed). A mechanical broadcast seeder may also be utilized, such as Cyclone or Seed Slinger. Seed shall be broadcast in two (2) separate applications where each application of seed shall overlap the previous application by one half (1/2) the weight to insure double coverage of seeded areas (example: seed in a north to south direction @ ten pounds per acre, then overlap by seeding in an east to west direction @ ten pounds per acre, resulting in a total coverage of twenty pounds per acre [twenty pounds per acre is an example only, see the plans for actual project seeding rates]).
- F. Seed shall be installed at a depth no greater than 0.25" (1/4")

3.3 EROSION AND NUSIANCE CONTROLS

- A. Install erosion control blanket on all areas where soil is exposed per civil plans and specifications.

3.4 ACCEPTANCE

- A. The contractor shall be responsible for the satisfactory growth of grass and forbs on all areas and/or planted under the contract until final acceptance of the work. Acceptance of the work will be determined as indicated in NATURALIZED PLANTING AREA ESTABLISHMENT.

END OF SECTION

NATURALIZED PLANTING AREA ESTABLISHMENT (ALTERNATE)

PART 1 - GENERAL

1.1 DESCRIPTION

- A. This section includes management of seeding and planting work to encourage growth of desirable species.

1.2 QUALITY ASSURANCE

- A. Provide at least one person who shall be present at all times during execution of this portion of the work, and shall be thoroughly familiar with the type and operation of equipment and techniques being used. Said person shall direct all work performed under this section.
- B. Botanical nomenclature shall follow "Plants of the Chicago Region" by F. Swink and G. Wilhelm (1994). The term non-native species shall include all those identified as introduced to the Chicago region in the above reference.

1.3 LAWS AND REGULATIONS

- A. The Contractor shall comply with applicable regulations. All materials and workmanship shall meet or exceed applicable federal, state, county and local laws and regulations.
- B. In the event of a conflict between the requirements of these Specifications and rules or regulations of Federal, State or Local agencies, the more restrictive shall govern.
- C. The use of any herbicide shall follow directions given on the herbicide label. In the case of a discrepancy between these specifications and the herbicide label, the label shall prevail.

1.4 SUBMITTALS

- A. Contractor completing the work described in this section must submit documentation of prior experience and expertise in this type of work. Submit a minimum of three references, including contact names and phone numbers, who can verify these qualifications. Work described in this section may not begin until these qualifications are approved.
- B. Prior to delivery of any materials to the site, submit a complete list of all materials to be used during this portion of the work. Include complete data on source, quantity and quality. This submittal shall in no way be construed as permitting substitution for specific items described on the plans or in these specifications unless approved in writing by the Owner. Materials shall not be delivered to project site until this submittal has been approved.
- C. Prior to commencement of seeding or planting, submit material certificates for all seed and plant materials, signed by nursery. Planting shall not begin until this submittal is approved.
- D. Prior to any herbicide use, submit a current copy of the State of Illinois commercial pesticide operator's or applicator's license, with certification in the appropriate categories, for each person who will be applying herbicide at the project site. A copy of each license must be maintained on site at all times during completion of the work.

1.5 SATISFACTORY PERFORMANCE

- A. Management work shall at all times be satisfactory to the City of Aurora. When it becomes necessary, the City of Aurora will inform the Contactor of unsatisfactory procedures and operations. If the unsatisfactory procedures and operations are not corrected promptly, the City of Aurora may suspend the performance of any or all other Work until the unsatisfactory condition has been corrected, and such suspension shall not be the basis of any claim by the Contractor for additional compensation from the Owner nor for an extension of time to complete the Work.

1.3 SAFETY

- A. The work described in this section may involve hazardous conditions, operations, and equipment. These specifications do not purport to address all of the safety concerns, if any, associated with the completion of the work. It is the responsibility of the Contractor to establish appropriate safety and health practices and determine the applicability of regulatory limitations prior to beginning the work.

PART 2 - PRODUCTS

2.1 HERBICIDE

- A. Vegetation in areas without standing water or saturated soils shall be treated with Glyphosate, N-(phosphonomethyl) glycine, trade name Roundup or approved equal.
- B. All vegetation to be treated with herbicide in areas with standing water or saturated soils shall be treated with Glyphosate, N-(phosphonomethyl) glycine in a form approved for aquatic applications such as Rodeo or approved equal.

2.2 PLANT MATERIALS

- A. All seed shall conform to section NATIVE PLANTING AREA - SEEDING.

2.3 EROSION CONTROL

- A. All erosion control blanket for the naturalized planting areas shall conform to Civil Plans and Specifications.

PART 3 - EXECUTION

3.1 QUALITY ASSURANCE

- A. Contractor's qualifications for fine grading: Minimum 5 years experience successfully maintaining and managing native seeding areas. Provide a minimum of 3 references for comparable work if requested.

3.2 EVALUATION

- A. Contractor must inspect Prairie Planting work every 30 days after completion of work during the first growing season and complete management activities described herein, and any additional work as may be necessary, to ensure the following performance criteria are met or exceeded.

1. Seeding completed prior to June 1 will meet the following performance criteria no later than June 30: 90% overall areal vegetative cover, with no area larger than 100 square feet with less than 50% cover. This criterion must be maintained throughout the first growing season. No later than September 15 of the same year, the following criteria will also be met: seedlings of a minimum of one planted grass or sedge and two planted forb species, excluding cover crop species, found per acre in each zone. These criteria will be applied to the next growing season for work completed after October 15.
2. Throughout the first growing season non-native and/or otherwise objectionable weeds including but not limited to thistle, ragweed, reed canary grass, purple loosestrife, common reed, and others defined by the City of Aurora shall be controlled by the Contractor. At no time shall non-native and/or otherwise objectionable weeds be allowed to dominate any portion of the site.

- B. Contractor shall inspect Prairie Planting work at least once a month from May through September for two years after the first growing season and complete management activities described herein, and any additional work as may be necessary, to ensure the following performance criteria are met or exceeded.

1. Seeding work will meet or exceed the following performance criteria by June 30 of the first growing season following seed installation: 75% overall areal vegetative cover with no area(s) larger than 100 square feet with less than 25% cover, a minimum of one planted grass or sedge and two planted forb species excluding cover crop species found per acre in each zone, and at least 25% of all seeded species found in each zone throughout the site. These performance criteria will be maintained throughout the second growing season.
2. Seeding work will meet or exceed the following performance criteria by June 30 of the second growing season following seed installation: 95% overall areal vegetative cover with no area(s) larger than 100 square feet with less than 75% cover, a minimum of one planted grass or sedge and two planted forb species excluding cover crop species found per acre in each zone, and at least 50% of all seeded species found in each zone throughout the site. These performance criteria will be maintained throughout the second growing season.
3. Seeding work will meet or exceed the following performance criteria by June 30 of the third growing season following seed installation: 99% overall areal vegetative cover with no area(s) larger than 100 square feet with less than 90% cover, a minimum of one planted grass or sedge and two planted forb species excluding cover crop species found per acre in each zone, and at least 75% of all seeded species found. These performance criteria will be maintained throughout the third growing season.
4. Throughout the second and third growing seasons, non-native and/or otherwise objectionable weeds including but not limited to thistle, ragweed, reed canary grass, purple loosestrife, common reed, and others defined by the City of Aurora shall be controlled by the Contractor. At no time shall non-native and/or otherwise objectionable weeds be allowed to dominate any portion of the site.

3.3 HERBICIDE APPLICATION

- A. The Contractor shall selectively treat non-native and/or otherwise objectionable weeds with an approved herbicide.
- B. Care should be taken not to affect surrounding desirable vegetation. The Contractor will be required to replace any vegetation affected by their herbicide other than that which was approved.
- C. A supply of chemical absorbent shall be maintained at the project site any time herbicides are on-site. Any chemical spills shall be properly cleaned up and reported to the City of Aurora within 24 hours.
- D. The Contractor shall maintain copies at the project site of all current pesticide applicator's licenses, herbicide labels, and Material Safety Data Sheets (MSDS) for all chemicals utilized during completion of the work.
- E. Herbicides may be applied using a backpack sprayer or a hand held wick applicator.
- F. Herbicide application instructions given on the label shall be followed at all times.

3.4 SELECTIVE MOWING

- A. The Contractor shall selectively mow or weed whip non-native and/or otherwise objectionable weeds, or cover crop, to minimize competition and prevent re-seeding of weeds.
- B. The Contractor shall ensure cut weeds are not allowed to drop seed or smother desirable vegetation. Contractor shall remove and properly dispose of cut vegetation as necessary.
- C. Care should be taken not to affect surrounding desirable vegetation. The Contractor will be required to replace any vegetation affected other than that which was approved.

3.5 PRESCRIBED CONTROLLED BURNING

- A. Prescribed burning may be employed as a management and weed control tool at the project site with written authorization from the Owner. Burning may be conducted annually beginning the second growing season or as approved by the Owner.
- B. Prior to the commencement of prescribed burning, the Contractor shall compile a burn plan that outlines a plan of action, identifies contingencies, and lists the names and phone numbers of emergency agencies (fire department, police department, etc.). Proper notice of intent to burn shall be given.
- C. The Contractor shall apply for and receive all required permits prior to the commencement of prescribed burning.

3.6 OVER-SEEDING

- A. The Contractor shall complete supplemental seeding as necessary to achieve performance criteria given above.
- B. All seeding work shall conform to section NATURALIZED PLANTING AREA - SEEDING with the following exceptions.
 1. Seeding may be completed during the growing season with prior approval.
- C. The Contractor shall exercise care so as not to damage established or emerging desirable vegetation while performing over-seeding operations.

3.7 EROSION CONTROL

- A. The Contractor shall install erosion control blanket or straw mulch as needed in areas that are over-seeded.
- B. The Contractor shall exercise care so as not to damage established or establishing desirable vegetation during installation of erosion control measures.

3.8 SUPPLEMENTAL PLANTING

- A. The Contractor shall complete supplemental planting as necessary to achieve performance criteria given above.
- B. All planting work shall conform to section NATURALIZED PLANTING AREA - SEEDING with the following exceptions.
 1. Planting may be completed during the growing season with prior approval.
- C. The Contractor shall exercise care so as not to damage established or establishing desirable vegetation during supplemental planting.

3.9 IRRIGATION

- A. Provide temporary irrigation as necessary during dry periods for seeding and planting work to establish and/or sustain growth necessary to meet or exceed performance criteria given above.

3.10 CLEAN UP, REMOVAL, AND REPAIR

- A. The work area shall be kept free of debris. After management work is complete, clean up any remaining materials, debris, trash, etc., generated by the Contractor.
- B. After work has been completed remove tools, equipment, empty containers, and all other debris accumulated during completion of the work.
- C. Repair any damages incurred during completion of the work described in this section.

3.11 SUPPLEMENTAL WATERING

- A. If natural rainfall of 1" per week does not occur, Contractor is responsible for supplemental watering.

3.12 ACCEPTANCE AND GUARANTEE

- A. Acceptance shall be granted after the performance standards given in 3.2 of this section have been met or exceeded, and all required clean up, removal, and repair as described in this section have been completed.

END OF SECTION



225 W. Jefferson Avenue
Naperville, IL 60540
T 630.961.1787
hitchcockdesigngroup.com

PREPARED FOR

Aurora Fire Department

75 N Broadway
Aurora, IL 60505

PROJECT

Aurora Fire Station #7
824 Kenilworth Place
Aurora Illinois 60506

PROJECT LOCATION



ISSUED

June 8, 2018

REVISIONS

No	Date	Issue

CHECKED BY
TCK

DRAWN BY
MPW

SHEET TITLE
LANDSCAPE SPECIFICATIONS

SCALE IN FEET



NORTH

SHEET NUMBER



L3.3

©2017 Hitchcock Design Group