

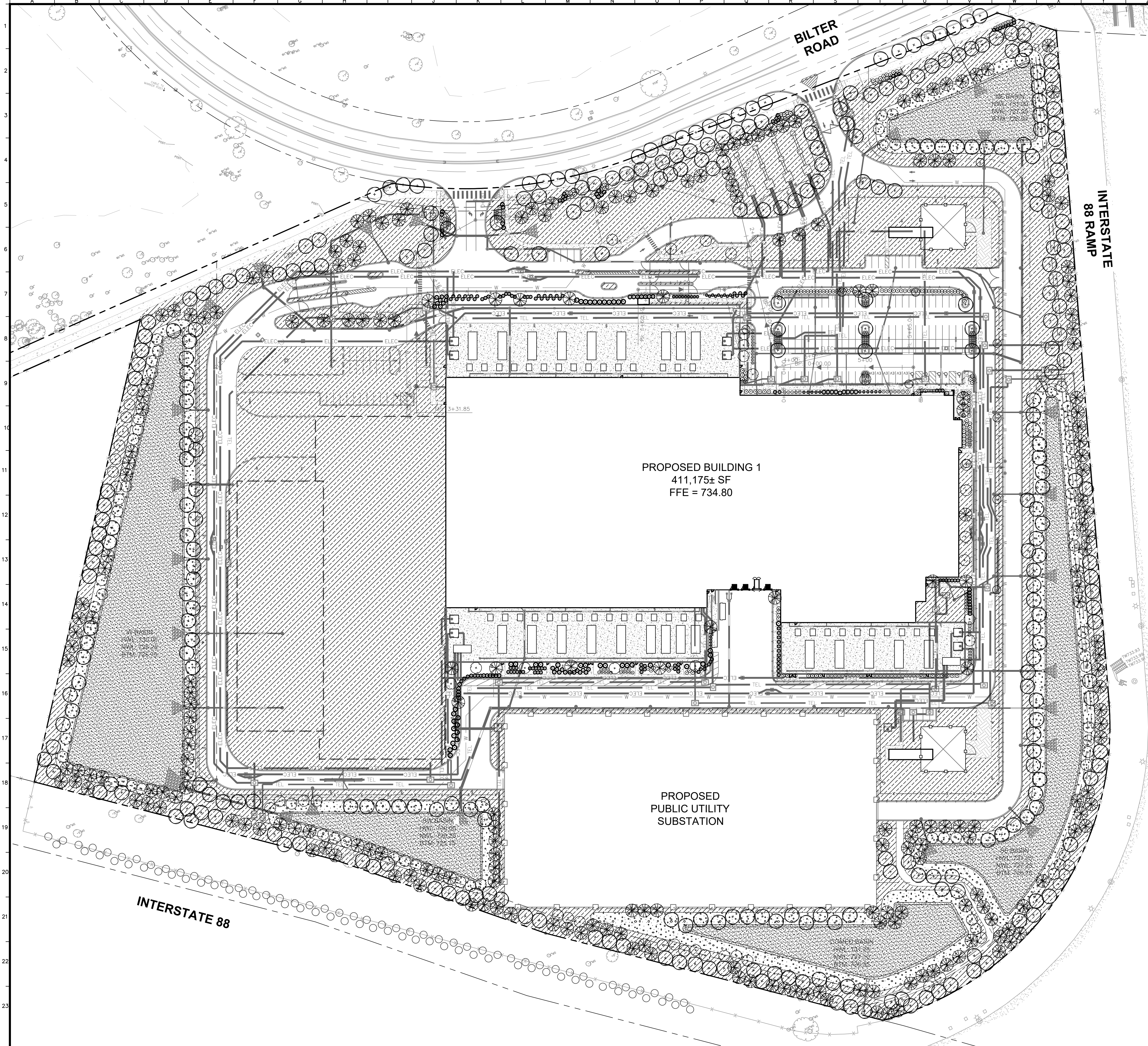



Drawing name: K:\GIS\_DEVELOPMENT\Projects\Aurora\_L1.0 OVERALL LANDSCAPE PLAN.dwg May 08, 2024, 4:52pm By: Hope.Lipkuk  
 This document, together with the concepts and designs presented herein, is intended only for the specific purpose and client for which it was prepared. Reuse of and improper reliance on this document without written authorization and adaptation by Kimley-Horn and Associates, Inc. shall be without liability to Kimley-Horn and Associates, Inc.



NORTH

GRAPHIC SCALE IN FEET

1" = 40'

Call  
Before  
You Dig

**1-800-892-0123**

SEE SHEET L2.0 FOR LANDSCAPE NOTES & DETAILS  
SEE SHEET L2.1 FOR LANDSCAPE SCHEDULES CODE INFORMATION

**Landscape Data Table: CTEs Provided**

Plant Species	CTE Value	Count Provided	Total CTEs
			Provided
Canopy Trees	1	334	334
Evergreen Trees	1/3	238	79
Understory Trees	1/3	110	37
Deciduous Shrubs	1/20	392	20
Evergreen Shrubs	1/20	272	14
<b>Total:</b>		<b>1346</b>	<b>483</b>

- LANDSCAPE KEYNOTES**
- ① SHOVEL CUT BED EDGE, TYP.
  - ② WET TO MESIC PRAIRIE SEED MIX
  - ③ BASIN BOTTOM PLUG MIX
  - ④ EXISTING LANDSCAPE VEGETATION, PROTECT IN PLACE, TYP.
  - ⑤ PROPERTY LINE, TYP.
  - ⑥ FENCE, SEE SITE PLAN, TYP.
  - ⑦ TURF SEED UP TO LIMITS OF DISTURBANCE, TYP.

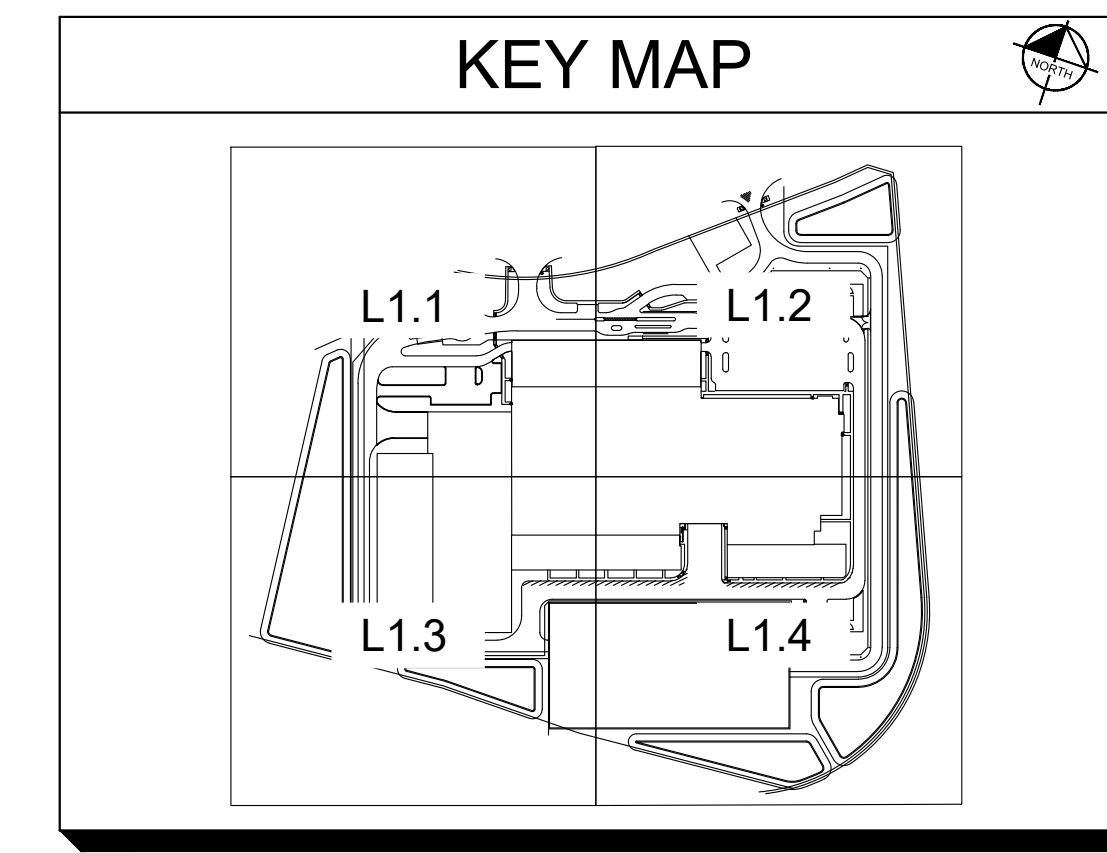

PROPOSED BUILDING 1  
411,175± SF  
FFE = 734.80

PROPOSED  
PUBLIC UTILITY  
SUBSTATION

	DATE	BY
<b>Kimley»Horn</b>		
© 2024 KIMLEY-HORN AND ASSOCIATES, INC. 4201 WINFIELD ROAD, SUITE 600 AURORA, ILLINOIS 60504 PHONE: 630-487-5550 WWW.KIMLEY-HORN.COM		
SCALE: AS NOTED	DESIGNED BY: HL	DRAWN BY: HL
	CHECKED BY: CW	
OVERALL LANDSCAPE PLAN		
CYRUSONE AURORA	2725 BILTER RD AURORA, IL 60502	
	ORIGINAL ISSUE: 05/06/2024	
	KHA PROJECT NO. 268485001	
	SHEET NUMBER	
L1.0		



Drawing name: K:\GIS\_DEVELOPMENT\Aurora\_IL\2 Design\CAD\PlanSheets\Final Engineering\1.0 LANDSCAPE PLAN.dwg L1.1 LANDSCAPE PLAN May 09, 2024 4:50pm By Hope Lipik  
 This document, together with the concepts and designs presented herein, is intended only for the specific purpose and client for which it was prepared. Reuse of and improper reliance on this document without written authorization and adaptation by Kimley-Horn and Associates, Inc. shall be without liability to Kimley-Horn and Associates, Inc.

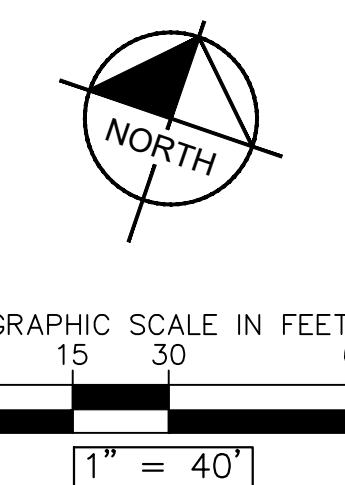
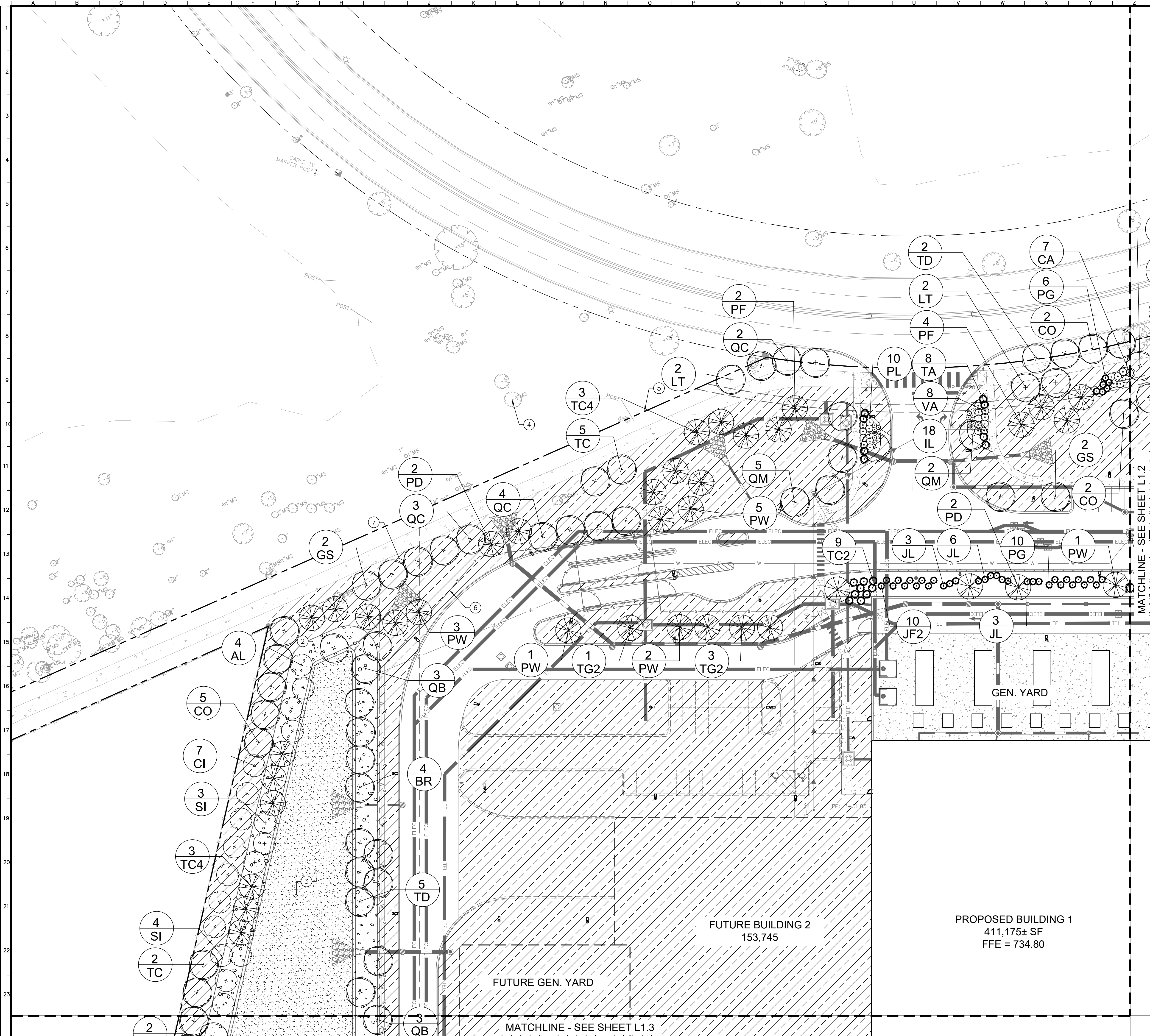

SEE SHEET L2.0 FOR LANDSCAPE NOTES & DETAILS  
 SEE SHEET L2.1 FOR LANDSCAPE SCHEDULES CODE INFORMATION

Landscape Data Table: CTEs Provided			
	CTE Value	Count Provided	Total CTEs
			Provided
Canopy Trees	1	334	334
Evergreen Trees	1/3	238	79
Understory Trees	1/3	110	37
Deciduous Shrubs	1/20	392	20
Evergreen Shrubs	1/20	272	14
<b>Total:</b>		<b>1346</b>	<b>483</b>

- ### LANDSCAPE KEYNOTES
- 1 SHOVEL CUT BED EDGE, TYP.
  - 2 WET TO MESIC PRAIRIE SEED MIX
  - 3 BASIN BOTTOM PLUG MIX
  - 4 EXISTING LANDSCAPE VEGETATION, PROTECT IN PLACE, TYP.
  - 5 PROPERTY LINE, TYP.
  - 6 FENCE, SEE SITE PLAN, TYP.
  - 7 TURF SEED UP TO LIMITS OF DISTURBANCE, TYP.

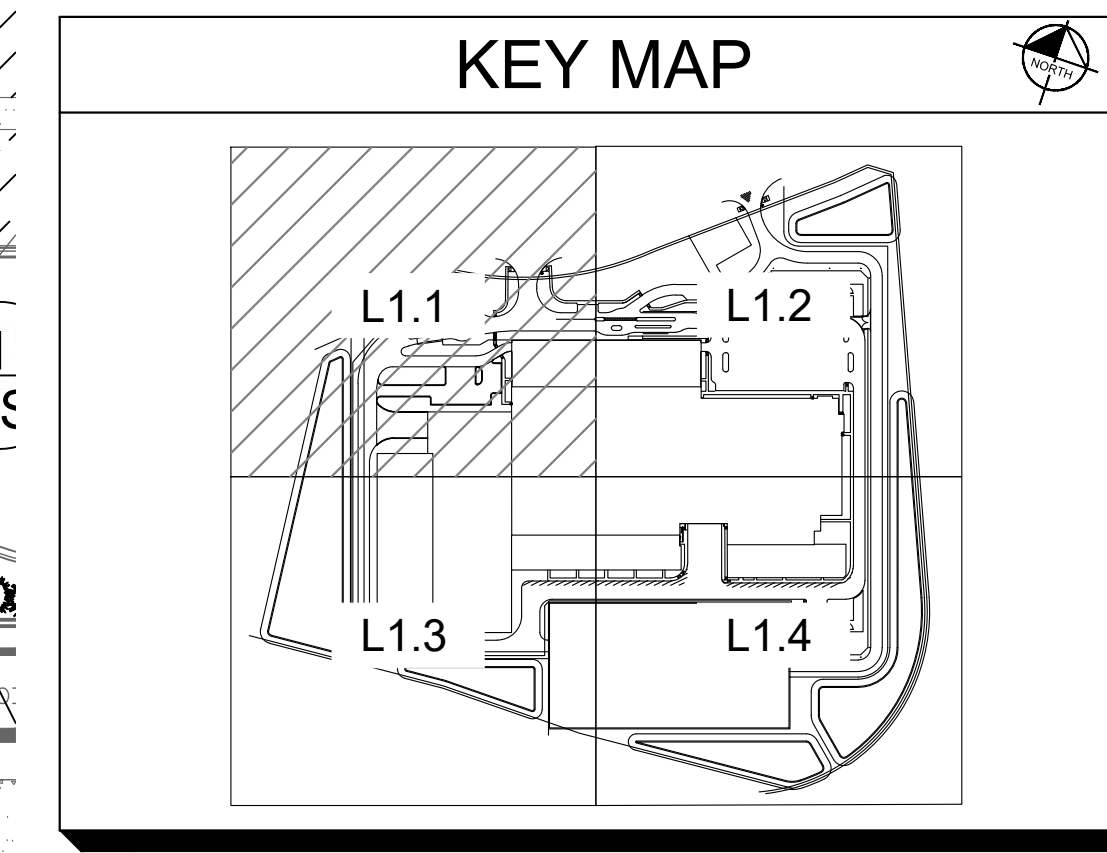

No.	BY	DATE	REVISIONS
<small>© 2024 KIMLEY-HORN AND ASSOCIATES, INC.          4201 WINFIELD ROAD, SUITE 600          PHOENIX, AZ 85040-4550          WWW.KIMLEY-HORN.COM</small>			
SCALE:	DESIGNED BY: HL	DRAWN BY: HL	CHECKED BY: CW
LANDSCAPE PLAN			
<b>CYRUSONE</b> <b>AURORA</b> <small>2725 BILTER RD          AURORA, IL 60502</small>			
<small>ORIGINAL ISSUE:          05/06/2024          KHA PROJECT NO.          268485001</small>			
<small>SHEET NUMBER</small> <span style="font-size: 1.5em; font-weight: bold;">L1.1</span>			



Drawing name: K:\GIS\_DEVELOPMENT\Aurora\_IL\2 Design\PlanSheets\Final Engineering\1.0 Landscape Plan.dwg May 09, 2024 4:52pm by HopeLipik  
 This document, together with the concepts and designs presented herein, is intended only for the specific purpose and client for which it was prepared. Reuse of and improper reliance on this document without written authorization and adaptation by Kimley-Horn and Associates, Inc. shall be without liability to Kimley-Horn and Associates, Inc.

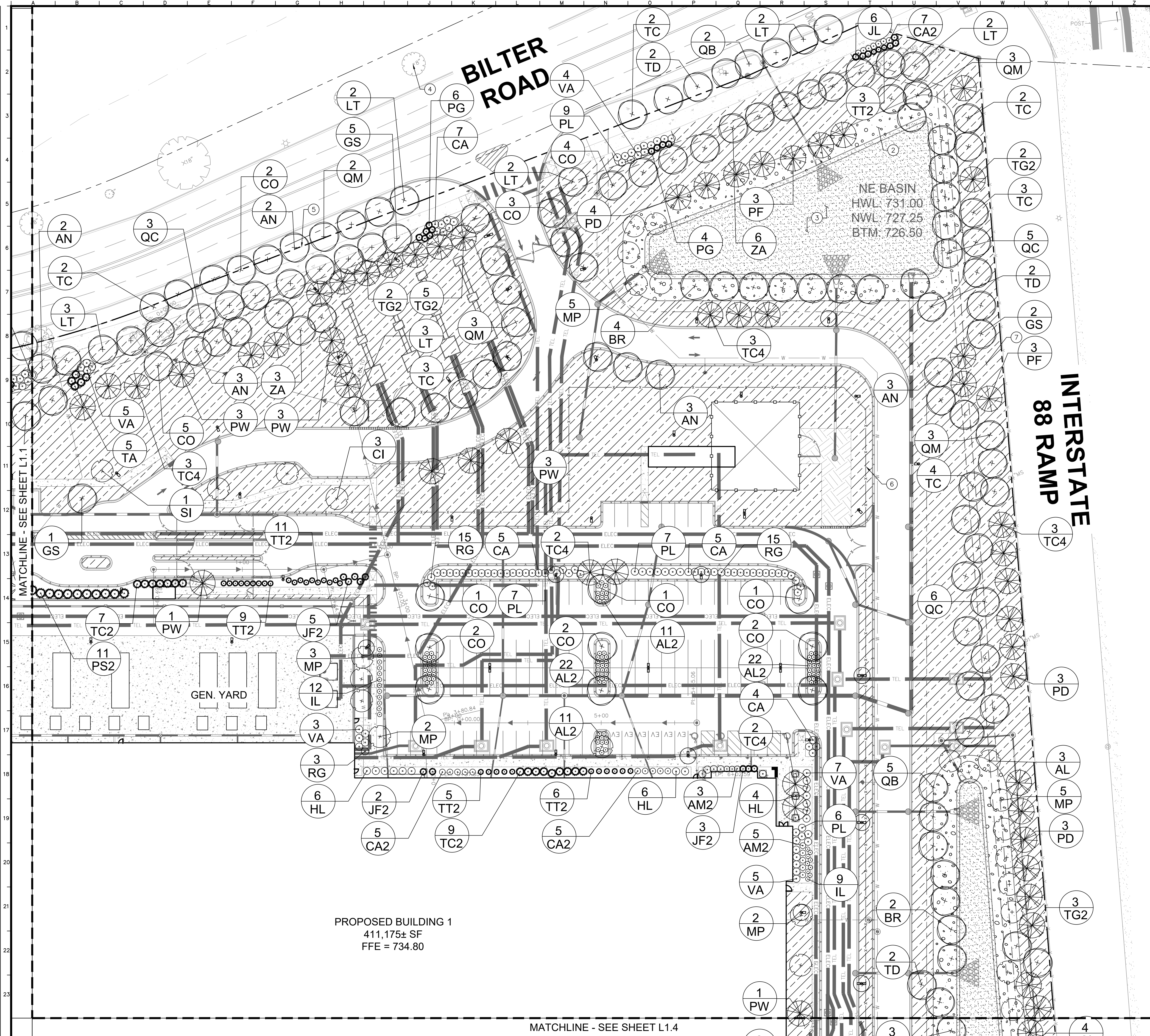

NORTH

GRAPHIC SCALE IN FEET  
 0 15 30 60  
 1" = 40'

Call Before You Dig  
**1-800-892-0123**

SEE SHEET L2.0 FOR LANDSCAPE NOTES & DETAILS  
 SEE SHEET L2.1 FOR LANDSCAPE SCHEDULES CODE INFORMATION

**Landscape Data Table: CTEs Provided**

	CTE Value	Count Provided	Total CTEs Provided
Canopy Trees	1	334	334
Evergreen Trees	1/3	238	79
Understory Trees	1/3	110	37
Deciduous Shrubs	1/20	392	20
Evergreen Shrubs	1/20	272	14
<b>Total:</b>		<b>1346</b>	<b>483</b>

- LANDSCAPE KEYNOTES**
- ① SHOVEL CUT BED EDGE, TYP.
  - ② WET TO MESIC PRAIRIE SEED MIX
  - ③ BASIN BOTTOM PLUG MIX
  - ④ EXISTING LANDSCAPE VEGETATION, PROTECT IN PLACE, TYP.
  - ⑤ PROPERTY LINE, TYP.
  - ⑥ FENCE, SEE SITE PLAN, TYP.
  - ⑦ TURF SEED UP TO LIMITS OF DISTURBANCE, TYP.

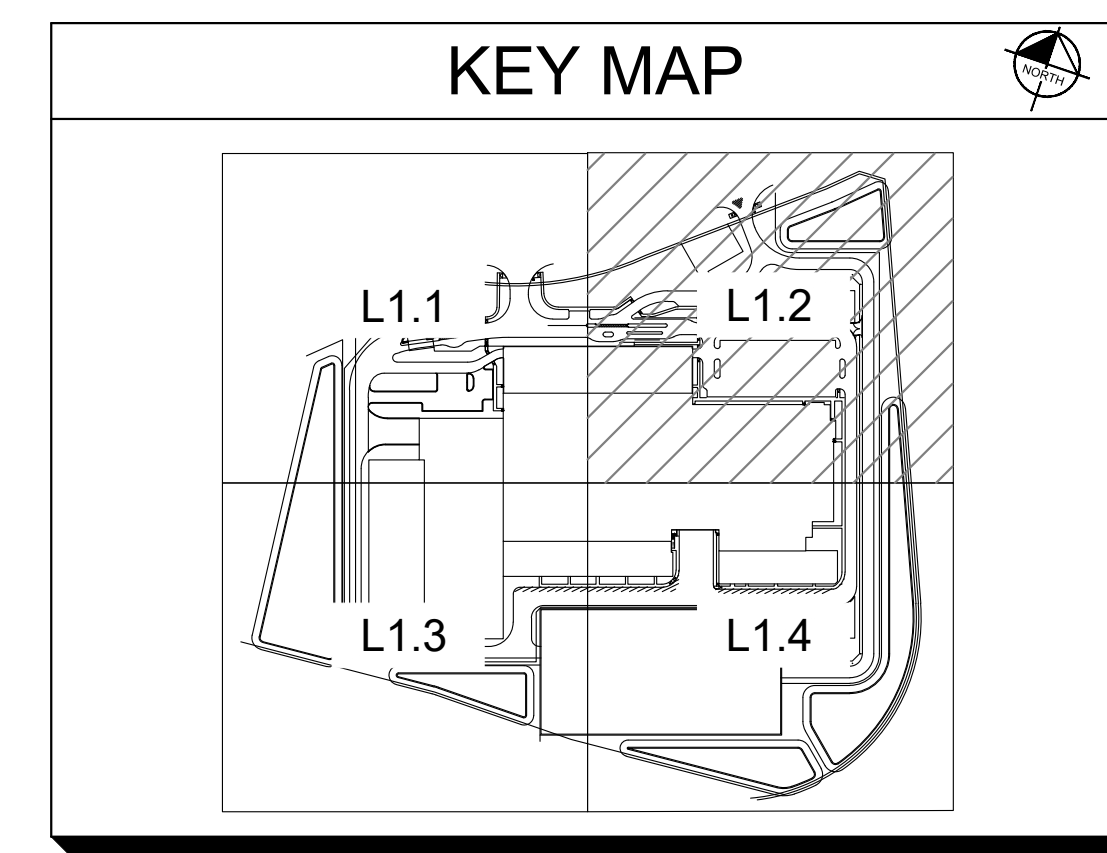

No.		DATE		BY	
<b>LANDSCAPE PLAN</b>					
<b>CYRUSONE</b> <b>AURORA</b> 2725 BILTER RD AURORA, IL 60502					
ORIGINAL ISSUE: 05/06/2024 KHA PROJECT NO. 268485001 SHEET NUMBER <b>L1.2</b>					



Drawing name: K:\GIS\_DEVELOPMENT\268485001\_Aurora\_IL\2 Design\CAD\PlanSheets\Final Engineering\1.0 LANDSCAPE PLAN May 09, 2024 4:52pm by HegeLipok  
 This document, together with the concepts and designs presented herein, is intended only for the specific purpose and client for which it was prepared. Reuse of and improper reliance on this document without written authorization and adaptation by Kimley-Horn and Associates, Inc. shall be without liability to Kimley-Horn and Associates, Inc.

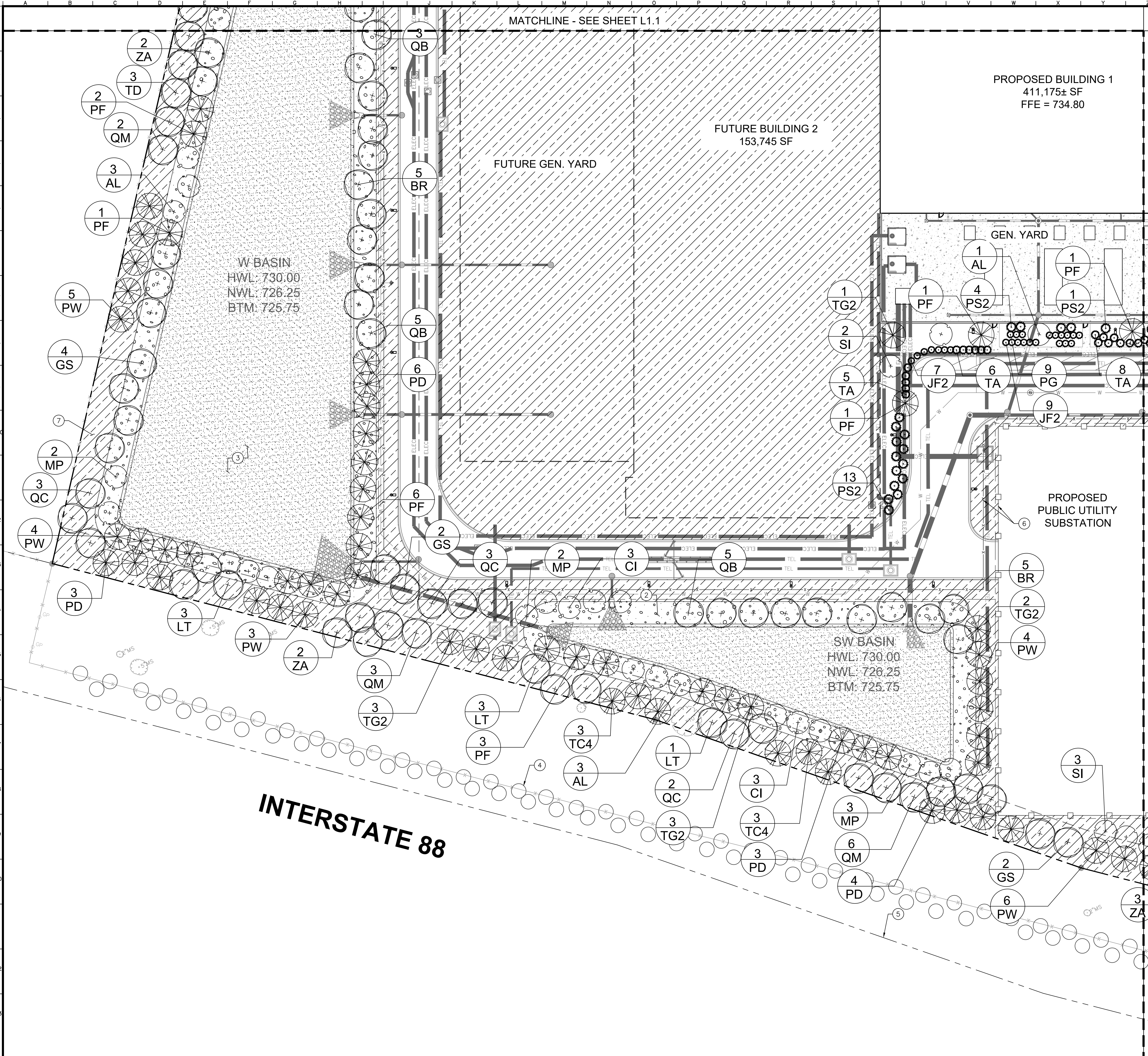

**Call Before You Dig**  
**1-800-892-0123**

SEE SHEET L2.0 FOR LANDSCAPE NOTES & DETAILS  
 SEE SHEET L2.1 FOR LANDSCAPE SCHEDULES CODE INFORMATION

**Landscape Data Table: CTEs Provided**

	CTE Value	Count Provided	Total CTEs Provided
Canopy Trees	1	334	334
Evergreen Trees	1/3	238	79
Understory Trees	1/3	110	37
Deciduous Shrubs	1/20	392	20
Evergreen Shrubs	1/20	272	14
<b>Total:</b>		<b>1346</b>	<b>483</b>

- LANDSCAPE KEYNOTES**
- 1 SHOVEL CUT BED EDGE, TYP.
  - 2 WET TO MESIC PRAIRIE SEED MIX
  - 3 BASIN BOTTOM PLUG MIX
  - 4 EXISTING LANDSCAPE VEGETATION, PROTECT IN PLACE, TYP.
  - 5 PROPERTY LINE, TYP.
  - 6 FENCE, SEE SITE PLAN, TYP.
  - 7 TURF SEED UP TO LIMITS OF DISTURBANCE, TYP.

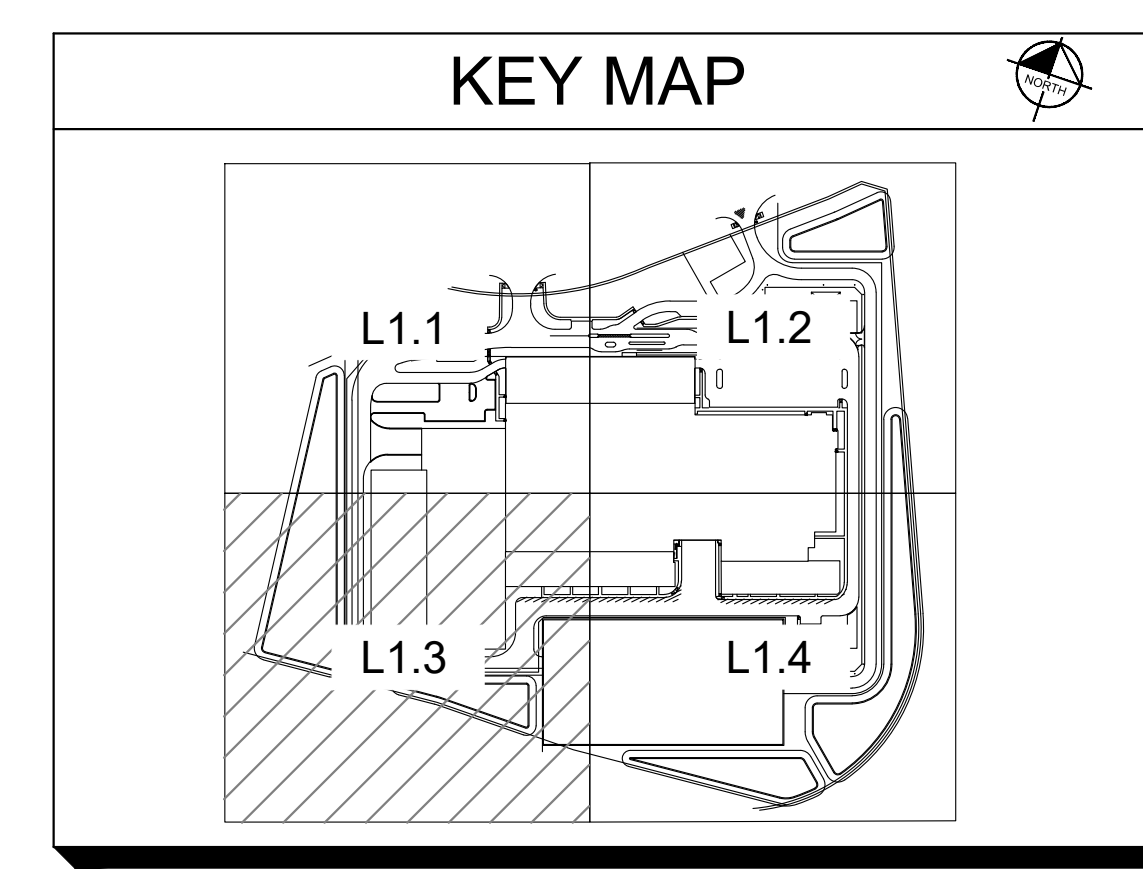

 <small>© 2024 KIMLEY-HORN AND ASSOCIATES, INC.          4201 WINFIELD ROAD, SUITE 600          PHOENIX, AZ 85044-4850          WWW.KIMLEY-HORN.COM</small>	REVISIONS NO. _____ BY _____ DATE _____
 <b>CYRUSONE</b> AURORA <small>2725 BILTER RD          AURORA, IL 60502</small>	<b>LANDSCAPE PLAN</b>
<b>LANDSCAPE PLAN</b>	
ORIGINAL ISSUE: 05/06/2024 KHA PROJECT NO. 268485001 SHEET NUMBER <b>L1.3</b>	



Drawing name: K:\GIS\_DEVELOPMENT\Aurora\_L1.4\Design\Aurora\_L1.4 Landscape Plan.dwg L1.4 LANDSCAPE PLAN May 09, 2024 4:52pm by Hope.Lipok  
 This document, together with the concepts and designs presented herein, is intended only for the specific purpose and client for which it was prepared. Reuse of and improper reliance on this document without written authorization and adaptation by Kimley-Horn and Associates, Inc. shall be without liability to Kimley-Horn and Associates, Inc.

MATCHLINE - SEE SHEET L1.1

**PROPOSED BUILDING 1**  
 411,175± SF  
 FFE = 734.80

Call Before You Dig  
**1-800-892-0123**

SEE SHEET L2.0 FOR LANDSCAPE NOTES & DETAILS  
 SEE SHEET L2.1 FOR LANDSCAPE SCHEDULES CODE INFORMATION

**Landscape Data Table: CTEs Provided**

	CTE Value	Count Provided	Total CTEs Provided
Canopy Trees	1	334	334
Evergreen Trees	1/3	238	79
Understory Trees	1/3	110	37
Deciduous Shrubs	1/20	392	20
Evergreen Shrubs	1/20	272	14
<b>Total:</b>		<b>1346</b>	<b>483</b>

- LANDSCAPE KEYNOTES**
- 1 SHOVEL CUT BED EDGE, TYP.
  - 2 WET TO MESIC PRAIRIE SEED MIX
  - 3 BASIN BOTTOM PLUG MIX
  - 4 EXISTING LANDSCAPE VEGETATION, PROTECT IN PLACE, TYP.
  - 5 PROPERTY LINE, TYP.
  - 6 FENCE, SEE SITE PLAN, TYP.
  - 7 TURF SEED UP TO LIMITS OF DISTURBANCE, TYP.

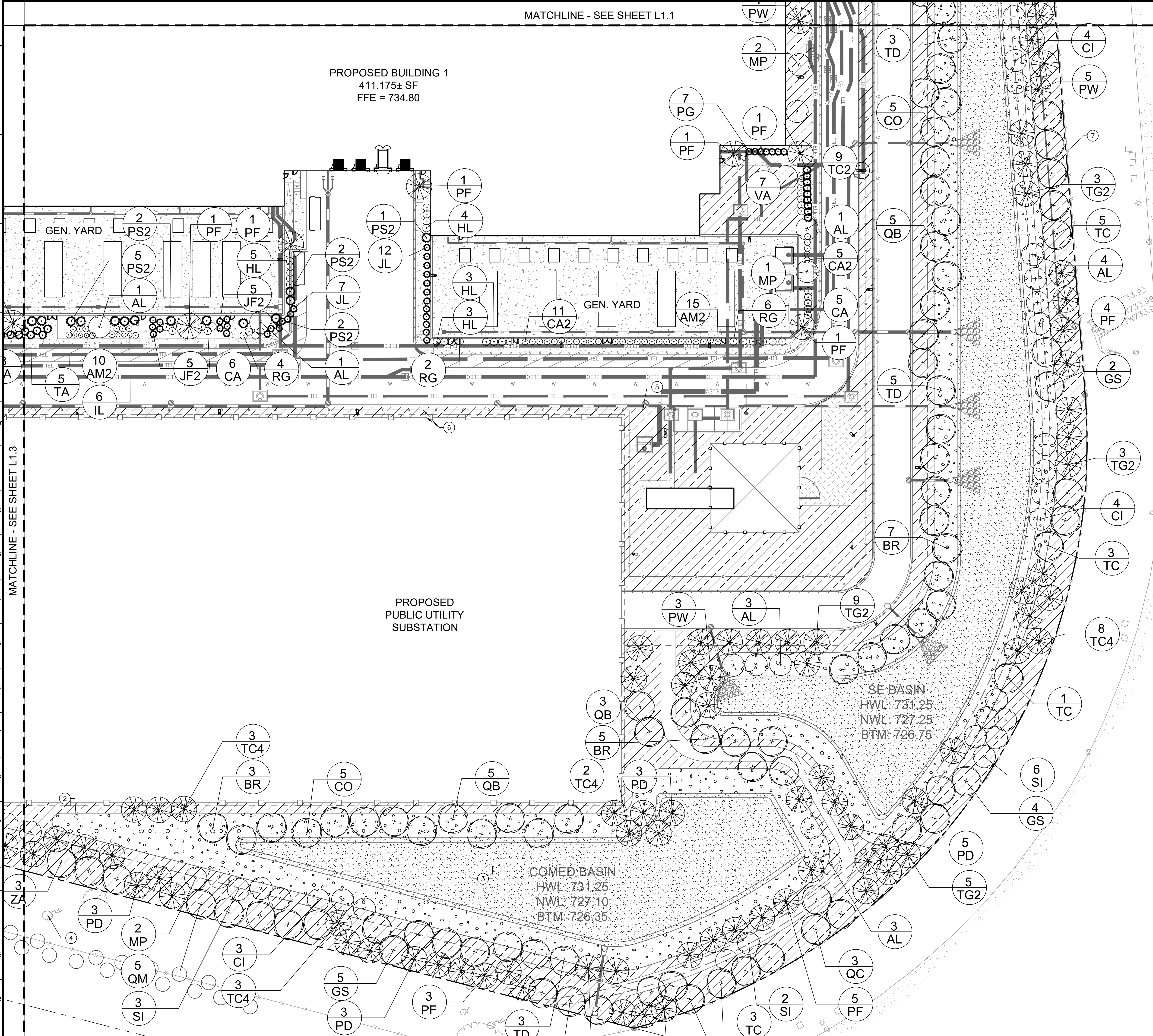
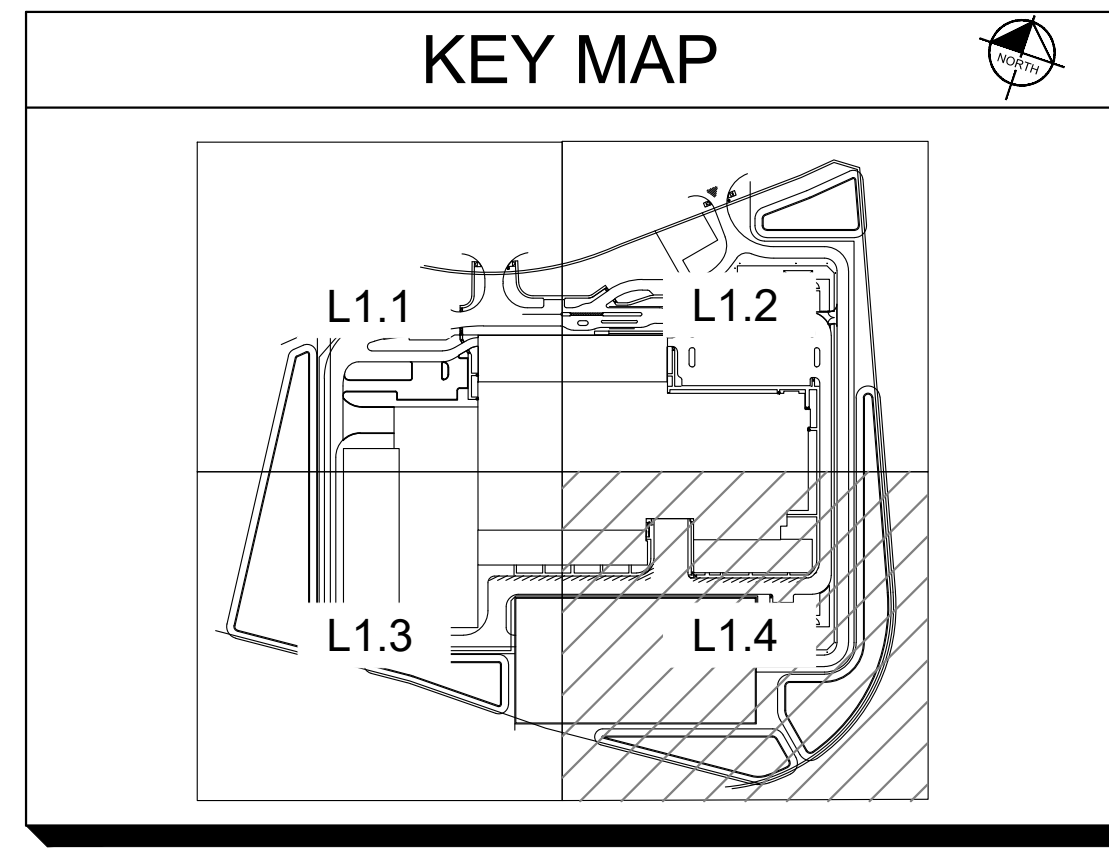

MATCHLINE - SEE SHEET L1.3

**PROPOSED PUBLIC UTILITY SUBSTATION**

**SE BASIN**  
 HWL: 731.25  
 NWL: 727.25  
 BTM: 726.75

**COMED BASIN**  
 HWL: 731.25  
 NWL: 727.10  
 BTM: 726.35

<p><b>Kimley»Horn</b></p> <p style="font-size: small;">             © 2024 KIMLEY-HORN AND ASSOCIATES, INC.              4201 WINFIELD ROAD, SUITE 600              AURORA, IL 60504              PHONE: 630-487-5550              WWW.KIMLEY-HORN.COM           </p>	<p style="writing-mode: vertical-rl; transform: rotate(180deg);">             SCALE: AS NOTED              DESIGNED BY: HL              DRAWN BY: HL              CHECKED BY: CW           </p>
<p><b>LANDSCAPE PLAN</b></p>	
<p> <b>CYRUSONE</b>  <b>AURORA</b>              2725 BILTER RD              AURORA, IL 60502           </p>	
<p>             ORIGINAL ISSUE:              05/06/2024              KHA PROJECT NO.              268485001              SHEET NUMBER  <b>L1.4</b> </p>	



**GENERAL LANDSCAPE NOTES**

- THE LANDSCAPE CONTRACTOR SHALL BE RESPONSIBLE FOR INSTALLING MATERIALS AND PLANTS SHOWN ON THE LANDSCAPE PLAN. THE CONTRACTOR IS RESPONSIBLE FOR THE COST TO REPAIR UTILITIES, ADJACENT LANDSCAPE, PUBLIC AND PRIVATE PROPERTY THAT IS DAMAGED BY THE CONTRACTOR OR THEIR SUBCONTRACTOR'S OPERATIONS DURING INSTALLATION OR DURING THE SPECIFIED MAINTENANCE PERIOD. CALL FOR UTILITY LOCATIONS PRIOR TO ANY EXCAVATION.
- THE CONTRACTOR SHALL REPORT ANY DISCREPANCY IN PLAN VS. FIELD CONDITIONS IMMEDIATELY TO THE LANDSCAPE ARCHITECT, PRIOR TO CONTINUING WITH THAT PORTION OF WORK.
- NO PLANTING WILL BE INSTALLED UNTIL ALL GRADING AND CONSTRUCTION HAS BEEN COMPLETED IN THE IMMEDIATE AREA.
- THE CONTRACTOR SHALL BE RESPONSIBLE FOR THE REPAIR OF ANY OF THEIR TRENCHES OR EXCAVATIONS THAT SETTLE.
- ALL PLANTS TO BE SPECIMEN GRADE, WELL BRANCHED, HEALTHY, FULL, PRE-INOCULATED AND FERTILIZED. PLANTS SHALL BE FREE FROM DISEASE, PESTS, WOUNDS, AND SCARS. PLANTS SHALL BE FREE FROM NOTICEABLE GAPS, HOLES, OR DEFORMITIES. PLANTS SHALL BE FREE FROM BROKEN OR DEAD BRANCHES. TRUNKS WILL BE WRAPPED IF NECESSARY TO PREVENT SUN SCALD AND INSECT DAMAGE. THE LANDSCAPE CONTRACTOR SHALL REMOVE THE WRAP AT THE PROPER TIME AS PART OF THIS CONTRACT.
- THE OWNER'S REPRESENTATIVE MAY REJECT ANY PLANT MATERIALS THAT ARE DISEASED, DEFORMED, OR OTHERWISE NOT EXHIBITING SUPERIOR QUALITY.
- ALL NURSERY STOCK SHALL BE GUARANTEED, BY THE CONTRACTOR, FOR ONE YEAR FROM DATE OF FINAL INSPECTION. THE GUARANTEE BEGINS ON THE DATE OF THE LANDSCAPE ARCHITECT'S OR OWNERS WRITTEN ACCEPTANCE OF THE INITIAL PLANTING. REPLACEMENT PLANT MATERIAL SHALL HAVE A ONE YEAR GUARANTEE COMMENCING UPON PLANTING.
- PLANTS TO MEET AMERICAN STANDARD FOR NURSERY STOCK (ANSI Z60.1-2014 OR MOST CURRENT VERSION) REQUIREMENTS FOR SIZE AND TYPE SPECIFIED.
- PRUNE PLANTS AS NECESSARY- PER STANDARD NURSERY PRACTICE AND TO CORRECT POOR BRANCHING OF EXISTING AND PROPOSED TREES.
- SEED LIMIT LINES ARE APPROXIMATE. CONTRACTOR SHALL SEED ALL AREAS WHICH ARE DISTURBED WITH THE SPECIFIED SEED MIXES.
- CONTRACTOR SHALL INSTALL SHREDDED HARDWOOD MULCH AT A 3" DEPTH TO ALL TREES AND SHRUB.
- INSTALLATION OF TREES WITHIN PARKWAYS SHALL BE COORDINATED IN THE FIELD WITH LOCATIONS OF UNDERGROUND UTILITIES. TREES SHALL NOT BE LOCATED CLOSER THAN 5' FROM UNDERGROUND UTILITY LINES AND NO CLOSER THAN 10' FROM UTILITY STRUCTURES.
- DO NOT DISTURB THE EXISTING PAVING, LIGHTING, OR LANDSCAPING THAT EXISTS ADJACENT TO THE SITE UNLESS OTHERWISE NOTED ON PLAN.
- PLANT QUANTITIES SHOWN ARE FOR THE CONVENIENCE OF THE OWNER AND JURISDICTIONAL REVIEW AGENCIES. THE CONTRACTOR IS RESPONSIBLE FOR VERIFYING ALL PLANT QUANTITIES AS DRAWN.
- THE CONTINUED MAINTENANCE OF ALL REQUIRED LANDSCAPING SHALL BE THE RESPONSIBILITY OF THE OWNER OF THE PROPERTY ON WHICH SAID MATERIALS ARE REQUIRED. ALL PLANT MATERIALS REQUIRED BY THIS SECTION SHALL BE MAINTAINED AS LIVING VEGETATION AND SHALL BE PROMPTLY REPLACED IF THE PLANT MATERIAL HAS DIED PRIOR TO FINAL ACCEPTANCE.
- SPOT HERBICIDE TREATMENT SHOULD ONLY BE USED IN AREAS OF LIVESTOCK GRAZING AS A LAST RESORT TO CONTROL WEEDS AND SHOULD BE APPLIED IN A VERY CONCENTRATED LOCATION AT THE BASE OF WEEDS. NO GENERAL SPAY OF HERBICIDES IS TO BE USED FOR ANY SEEDED AREAS.
- ONLY HERBICIDES FORMULATED FOR PET AND ANIMAL SAFETY SHALL BE USED.
- ALL PLANTS IMPORTED ACROSS ILLINOIS STATE LINES MAY BE SUBJECT TO CERTIFICATION AND INSPECTION PRIOR TO PLANTING.
- ALL WORK DEEMED NATURAL AREA TO BE SEEDED OR PLANTED SHALL BE PERFORMED BY A QUALIFIED LANDSCAPE CONTRACTOR.
- SEED LIMIT LINES ARE APPROXIMATE. THE CONTRACTOR SHALL SEED ALL AREAS WHICH ARE DISTURBED WITH THE SPECIFIED SEED MIXES.
- SEED SHALL BE OBTAINED FROM SOURCES SPECIALIZING IN NATIVE SPECIES, WHEN AVAILABLE OR AS APPROVED BY CLIENT OR CLIENT'S REPRESENTATIVE.
- ALL SEED MIXES SHALL BE INSTALLED WITH A COVER CROP DEPENDENT ON SEASON AND REQUIREMENTS SPECIFIED PER SEED MIX / SEED SUPPLIER.

**SEED NOTES**

- INSTALL A MYCORRHIZAL INOCULANT WITH SEED MIX AT 40 LBS/ACRE
- FOR SPRING PLANTING, INSTALL A COVER CROP OF SEED OATS (AVENA SATIVA) WITH SEED MIX AT 40 LBS/ACRE
- FOR FALL PLANTING, INSTALL A COVER CROP OF REGREEN (A WINTER WHEAT X WHEATGRASS STERILE HYBRID) WITH SEED MIX AT 50 LBS/ACRE
- AT NO TIME SHOULD ANNUAL OR PERENNIAL RYE (LOLIUM MULTIFLORUM OR PERENNE) BE UTILIZED AS A COVER CROP.
- SEED IS TO BE INSTALLED ONLY WITHIN AREAS THAT ARE NOT INUNDATED WITH WATER AT THE TIME OF PLANTING. PLUGGING TO BE USED IN LIEU OF SEEDING IN AREAS WHERE SEEDING IS IMPOSSIBLE DUE TO HIGH WATER LEVELS AND PLUGS ARE TO SUPPLEMENT SEED AREAS AS NEEDED TO IMPROVE VEGETATIVE COVER.

**ESTABLISHMENT NOTES AND STANDARDS**

**TREE / SHRUB ESTABLISHMENT**

**PREPARATION**

HOLES DUG FOR TREES AND SHRUBS SHALL BE NO DEEPER THAN THE ROOTBALL OR CONTAINER, MEASURED TO THE TRUNK FLARE. DIAMETER OF HOLES SHALL BE TWICE THE DIAMETER OF THE ROOT BALL FOR TREES, AND AT MINIMUM 6 INCHES BEYOND THE DIAMETER OF CONTAINERS FOR SHRUBS.

**INSTALLATION**

INSTALL TREES AND SHRUBS SO THAT THE TRUNK FLARE IS AT A MAXIMUM 2 INCHES ABOVE GRADE, AND AT MINIMUM, AT GRADE. REMOVE CONTAINER AND REMOVE ANY BURLAP 6 INCHES FROM THE HEIGHT OF THE ROOT BALL, THEN BACKFILL TO FINISHED GRADE USING EXCAVATED SOIL FROM THE DUG HOLE.

**SEED AREA ESTABLISHMENT**

**PREPARATION**

SOIL PH IS TO BE TESTED PRIOR TO AMENDMENT AND FINAL GRADING. LIME OR SULFUR IS TO BE ADDED IN APPROPRIATE QUANTITY TO BRING PH TO ACCEPTABLE LEVELS FOR SEED APPLICATION AS NEEDED. IN AREAS OF SOIL AMENDMENT OR EXISTING AGRICULTURAL LAND, SOIL IS RECOMMENDED TO BE DISKED, CULTIVATED, AND PLANED / ROLLED AS NEEDED. SOILS SHALL BE UNIFORM, WITHOUT EXCESSIVE FURROWS, RUTS, OR RIDGES, AND LOW AREAS WHERE WATER MAY COLLECT. SOIL PREPARATION SHALL OCCUR WHEN WEATHER PERMITS AND TIMING ALLOWS FOR AT LEAST A FOLLOWING 48 HOURS WHERE SEEDING AND STABILIZATION METHODS MAY TAKE PLACE.

**TIMING**

IN ORDER TO MINIMIZE INITIAL USES OF BROAD APPLICATION HERBICIDE TREATMENT, AND PROMOTE EARLY AND STRONG ESTABLISHMENT OF SPECIFIED SEED MIXES WITH MINIMAL UNDESIRABLE WEED COMPETITION, DORMANT SEEDING SHOULD BE UTILIZED AS SITE CONDITIONS AND CONSTRUCTION TIMELINE PERMITS. IF ACTIVE SEASON SEEDING SHOULD BE REQUIRED, IT IS RECOMMENDED TO DO SO BETWEEN APRIL 1ST AND MAY 30TH, AFTER RISK OF MAJOR FREEZING CONDITIONS IS MINIMIZED. COVER CROPS MAY BE SEEDED AT ANY TIME IN THE EVENT THAT STABILIZATION IS REQUIRED OUTSIDE OF RECOMMENDED PLANTING TIMES. COVER CROPS MAY BE REQUIRED TO BE IRRIGATED IF APPLIED DURING WARM SEASONS AND IF ADEQUATE SOIL MOISTURE IS NOT PRESENT.

**APPLICATION**

SEED MIXTURES SHALL BE MECHANICALLY DRILLED, BROADCAST, OR HYDROSEEDED WITH STRAW MULCH PER SUPPLIER'S RECOMMENDATION (IF APPLICABLE). NO STRAW MULCH IS REQUIRED IF DRILL APPLIED, UNLESS NEEDED FOR STEEP SLOPES, SOIL STABILIZATION, OR OTHER AREAS THAT ARE IDENTIFIED FOR EROSION PREVENTION. SEED SHALL BE APPLIED AT INDICATED RATES WITH COVER CROP OATS, JAPANESE MILLET, WINTER PEA, OR ANNUAL RYE DEPENDENT ON SEASON AND SOIL CONDITIONS. SEED SPECIES SHALL BE LOCALLY SOURCED WHEN FEASIBLE. FINAL SEED MIX MAY VARY DEPENDENT UPON SPECIFIC SPECIES AVAILABILITY AND TIME OF INSTALLATION. FINAL SEED MIX SHALL BE APPROVED BY OWNER, OWNER'S REPRESENTATIVE, OR LANDSCAPE ARCHITECT. IF SEEDING IS PERFORMED PRIOR TO FINAL SITE INSTALLATION, ADDITIONAL SEED MAY BE APPLIED BY A LOW SPREADER IN AREAS THAT WERE DISTURBED. SITE SHOULD BE MONITORED FOLLOWING INSTALLATION FOR AREAS IDENTIFIED FOR ADDITIONAL RESEEDING UNTIL SEED MIX IS SUFFICIENTLY ESTABLISHED.

**INVASIVE WEED CONTROL, MONITORING, AND MANAGEMENT**

A WORK PLAN SHOULD BE DEVELOPED TO AVOID THE SPREAD OF INVASIVE PLANTS FROM THESE AREAS. IF SUBSTANTIAL AREAS OF INVASIVE HERBACEOUS SPECIES ARE FOUND PRIOR TO OR AFTER PROJECT DEVELOPMENT, FOLIAR OR BROADCAST HERBICIDE APPLICATIONS MAY BE REQUIRED. FOR INVASIVE TREES, SHRUBS, AND VINES, MANAGEMENT MAY REQUIRE CUT-STEM HERBICIDE TREATMENTS. ALL INVASIVE SPECIES MANAGEMENT SHOULD BE CONDUCTED DURING THE SUMMER MONTHS WHILE THE TARGET PLANTS ARE ACTIVELY GROWING. TREATMENTS SHOULD BE CONDUCTED BETWEEN JULY AND AUGUST OF EACH YEAR AND SHOULD BE SEPARATED BY AT LEAST TWO WEEKS. APPROXIMATELY TWO HERBICIDE TREATMENTS SHOULD BE SCHEDULED PER SEASON FOR AT LEAST TWO YEARS FOLLOWING INITIATION OF PROJECT WORK. HERBICIDE USE REPORTING WILL ADHERE TO ALL APPLICATOR LICENSING REQUIREMENTS.

**VEGETATION MANAGEMENT NOTES**

- IN AREAS WHERE VEGETATION REMOVAL IS SPECIFIED, SOIL IS RECOMMENDED TO BE CLEARED, GRUBBED, MECHANICALLY REMOVED BY HAND, DISKED, CULTIVATED, AND/OR ROLLED IN AS NEEDED. THE INTENT IS TO COMPLETELY ELIMINATE EXISTING VEGETATION, PREPARE THE SOIL FOR NEW PLANT MATERIAL ACCEPTANCE OF OBNOXIOUS WEEDS, AND TO ACHIEVE GOOD SOIL-TO-SEED CONTACT.
- SITE MANAGER TO OBSERVE SITE IN THE SPRING, TWICE IN THE SUMMER, AND ONCE IN THE FALL TO IDENTIFY GROWTH RATES, NOXIOUS WEEDS AND ESTABLISHMENT PROBLEMS.
- MOWING, WEEDING, HAND PULLING OF WEEDS, AND SPOT APPLYING HERBICIDE MAY NEED TO OCCUR AT EACH OBSERVATION (MOWING HEIGHT TO NOT BE LESS THAN 8" FROM GRADE). IF PROBLEMS ARE NOT IDENTIFIED WITH EITHER HEIGHT OF VEGETATION OR QUANTITY OF WEEDS, NO ACTION SHOULD BE TAKEN.
- THE INITIAL THREE YEARS WILL REQUIRE MORE FREQUENT MAINTENANCE AND MONITORING TO PROVIDE NATIVE PLANT ESTABLISHMENT INSTEAD OF INVASIVE WEEDS.
- WITHIN FIRST TWO YEARS OF COMPLETION, LANDSCAPE CONTRACTOR TO VISIT THE SITE ONCE PER MONTH THROUGHOUT THE GROWING SEASON TO CONTROL INVASIVE WEEDS. ALSO DURING THIS TIME, MOWING SHOULD OCCUR AT LEAST TWICE PER YEAR TO ELIMINATE SHADING FROM AGRONOMIC, ANNUAL WEEDS.
- SITE MANAGER SHOULD PERFORM YEARLY INSPECTIONS WITH A LANDSCAPE MAINTENANCE PROFESSIONAL TO IDENTIFY WEED PROBLEMS AND TO DISCUSS A STRATEGY FOR MAINTENANCE FOR THE YEAR.
- ANNUALLY, AT THE START OF SPRING, SITE SHOULD BE MOWED WITH A ROTARY MOWER TO (NO LESS THAN 8" IN HEIGHT TO NOT BE LESS THAN 8" FROM GRADE) KNOCKDOWN STANDING VEGETATION FROM THE PREVIOUS SEASONS.
- IF SITE MANAGER DETERMINES THE NEED TO REMOVE INVASIVE WEEDS WITH A HERBICIDE, THE MOST EFFECTIVE METHOD IS DURING THE FALL WITH A DIRECT APPLICATION. SITE MANAGER SHOULD CONDUCT A THOROUGH WALK-THROUGH OF THE SITE TO FIND WEEDS AND APPLY HERBICIDE. THE USE OF HERBICIDES SHALL FOLLOW AND ABIDE BY ALL LOCAL AND FEDERAL LAWS.

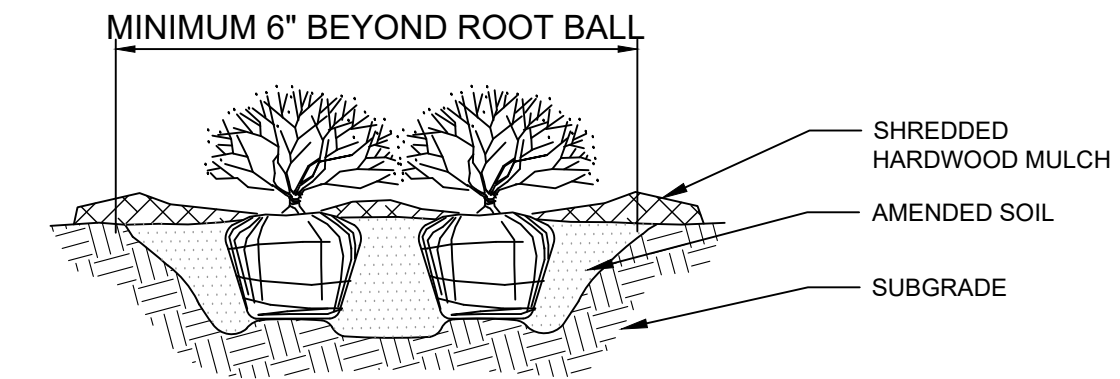

**NOTES:**

- APPLY CORRECTIVE PRUNING.
- SET ROOT BALL OR CONTAINER ON UNEXCAVATED OR TAMPED SOIL. TOP OF ROOTBALL (CONTAINER) SHALL BE ONE INCH ABOVE SURROUNDING GRADE. FOR LARGER SHRUBS WITHIN PLANTING BED DIG A DEEPER PIT ONLY FOR THOSE SHRUBS.
- REMOVE BURLAP FROM TOP HALF THE LENGTH OF ROOTBALL. TWINE AND (IF USED) SYNTHETIC MATERIAL SHALL BE REMOVED FROM PLANTING BED. FOR CONTAINER GROWN SHRUBS, REMOVE CONTAINER AND LOOSEN ROOTS PRIOR TO INSTALLATION.
- REMOVE OR CORRECT GIRDLING ROOTS.
- PLUMB AND BACKFILL WITH AMENDED SOIL PER LANDSCAPE NOTES. WATER THOROUGHLY WITHIN TWO HOURS.
- APPLY MULCH IN EVEN LAYER, KEEPING AWAY FROM ROOT FLARE. MULCH LIMITS FOR SHRUBS EXTEND TO ALL LIMITS OF PLANTING BED. SEE PLANS FOR BED LAYOUTS.

**1 SHRUB PLANTING**

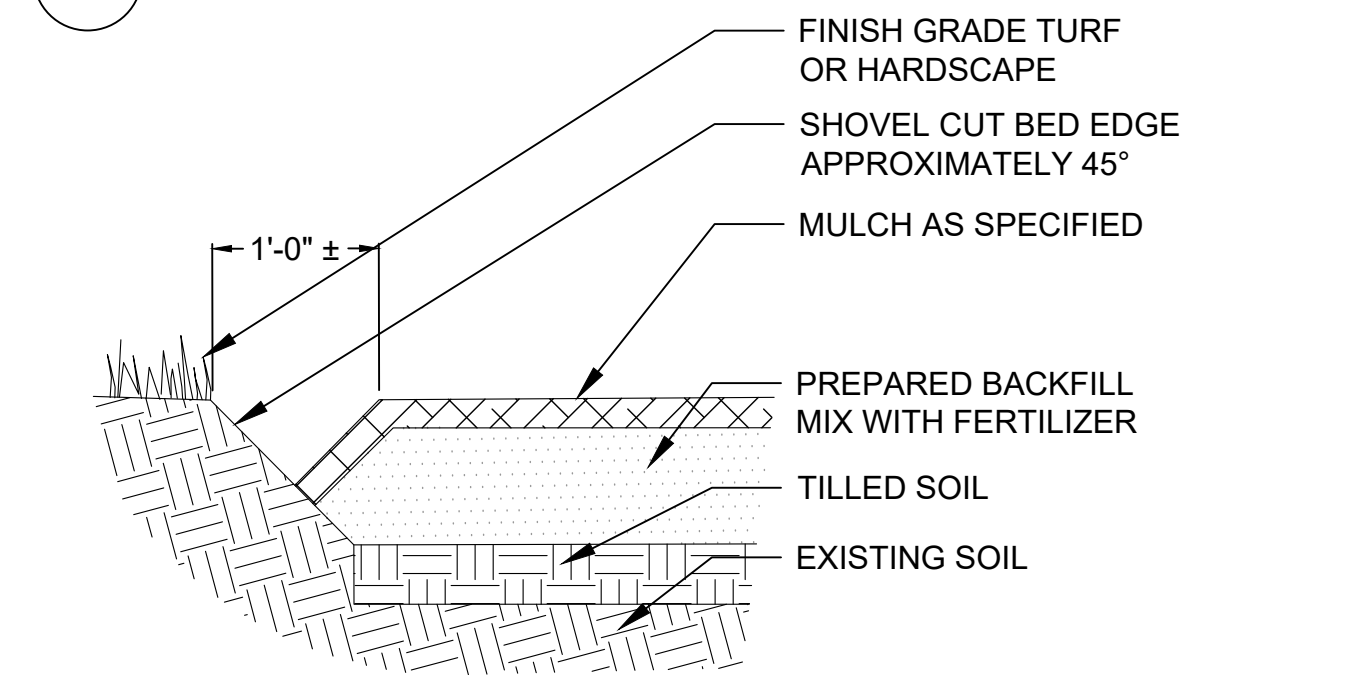

**2 LANDSCAPE BED EDGE**

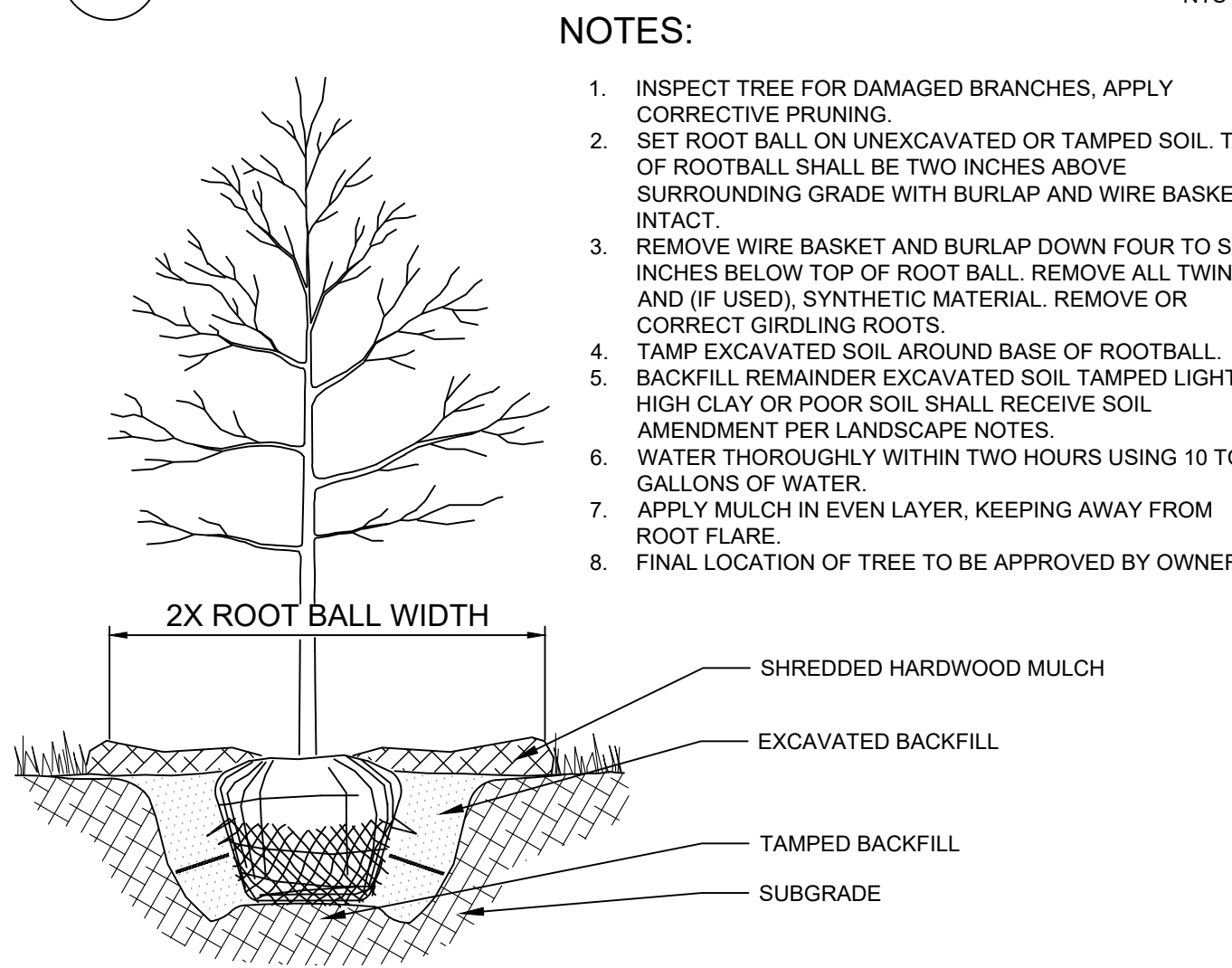

**NOTES:**

- INSPECT TREE FOR DAMAGED BRANCHES, APPLY CORRECTIVE PRUNING.
- SET ROOT BALL ON UNEXCAVATED OR TAMPED SOIL. TOP OF ROOTBALL SHALL BE TWO INCHES ABOVE SURROUNDING GRADE WITH BURLAP AND WIRE BASKET INTACT.
- REMOVE WIRE BASKET AND BURLAP DOWN FOUR TO SIX INCHES BELOW TOP OF ROOT BALL. REMOVE ALL TWINE AND (IF USED), SYNTHETIC MATERIAL. REMOVE OR CORRECT GIRDLING ROOTS.
- TAMP EXCAVATED SOIL AROUND BASE OF ROOTBALL.
- BACKFILL REMAINDER EXCAVATED SOIL TAMPED LIGHTLY. HIGH CLAY OR POOR SOIL SHALL RECEIVE SOIL AMENDMENT PER LANDSCAPE NOTES.
- WATER THOROUGHLY WITHIN TWO HOURS USING 10 TO 15 GALLONS OF WATER.
- APPLY MULCH IN EVEN LAYER, KEEPING AWAY FROM ROOT FLARE.
- FINAL LOCATION OF TREE TO BE APPROVED BY OWNER.

**3 TREE PLANTING**

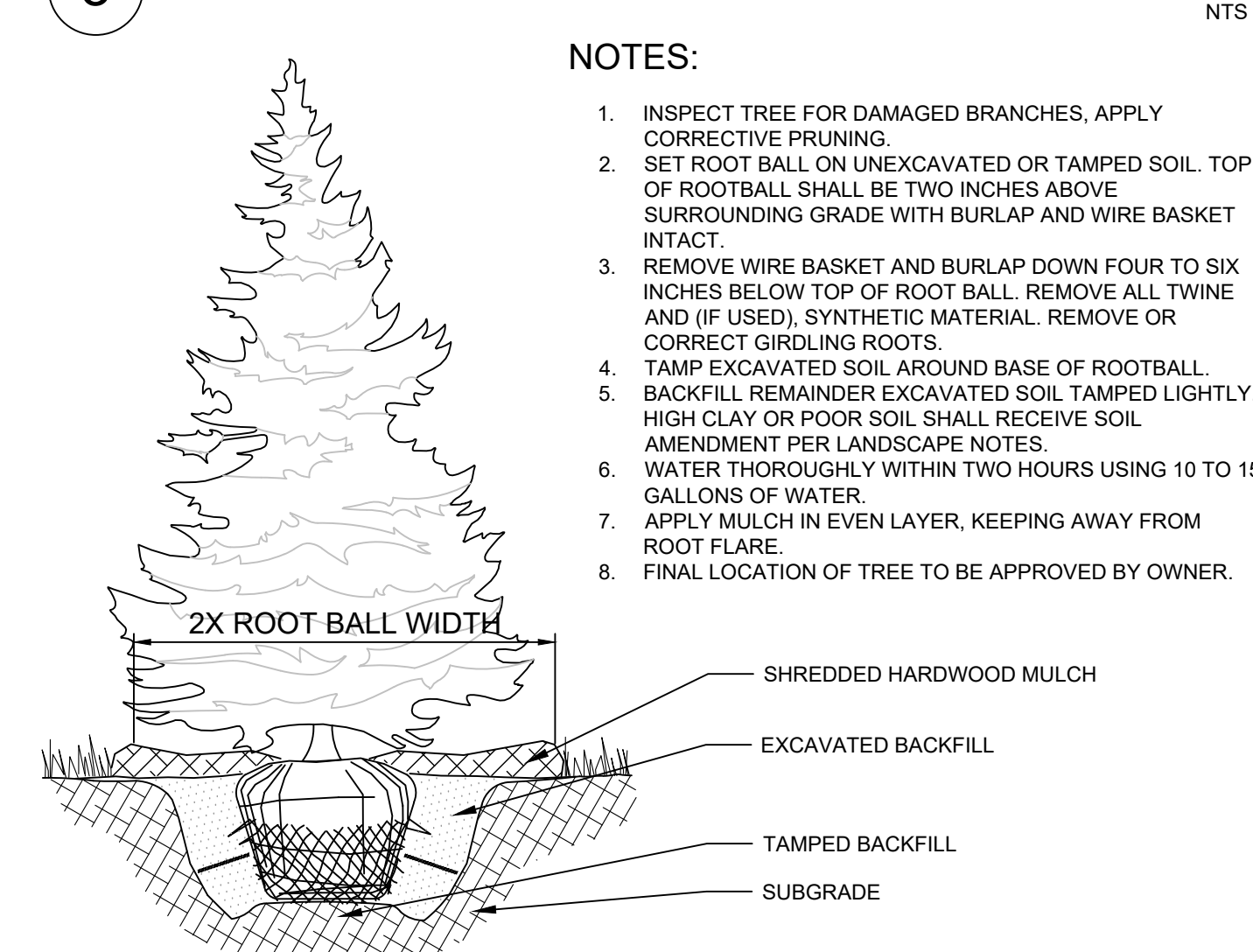

**NOTES:**

- INSPECT TREE FOR DAMAGED BRANCHES, APPLY CORRECTIVE PRUNING.
- SET ROOT BALL ON UNEXCAVATED OR TAMPED SOIL. TOP OF ROOTBALL SHALL BE TWO INCHES ABOVE SURROUNDING GRADE WITH BURLAP AND WIRE BASKET INTACT.
- REMOVE WIRE BASKET AND BURLAP DOWN FOUR TO SIX INCHES BELOW TOP OF ROOT BALL. REMOVE ALL TWINE AND (IF USED), SYNTHETIC MATERIAL. REMOVE OR CORRECT GIRDLING ROOTS.
- TAMP EXCAVATED SOIL AROUND BASE OF ROOTBALL.
- BACKFILL REMAINDER EXCAVATED SOIL TAMPED LIGHTLY. HIGH CLAY OR POOR SOIL SHALL RECEIVE SOIL AMENDMENT PER LANDSCAPE NOTES.
- WATER THOROUGHLY WITHIN TWO HOURS USING 10 TO 15 GALLONS OF WATER.
- APPLY MULCH IN EVEN LAYER, KEEPING AWAY FROM ROOT FLARE.
- FINAL LOCATION OF TREE TO BE APPROVED BY OWNER.

**4 EVERGREEN TREE PLANTING**

NTS



NO.	REVISIONS	DATE	BY

**Kimley»Horn**  
 © 2024 KIMLEY-HORN AND ASSOCIATES, INC.  
 4201 WINFIELD ROAD, SUITE 600  
 PHOENIX, AZ 85044  
 WWW.KIMLEY-HORN.COM

SCALE:	AS NOTED
DESIGNED BY:	HL
DRAWN BY:	HL
CHECKED BY:	CW



**LANDSCAPE NOTES & DETAILS**

**CYRUSONE AURORA**  
 2725 BILTER RD  
 AURORA, IL 60502

ORIGINAL ISSUE:  
 05/06/2024  
 KHA PROJECT NO.  
 268485001  
 SHEET NUMBER

**L2.0**

Drawing name: K:\GIS\DEV\268485001\_CyrusOne\_Aurora\_IL\2 Design\CAD\PlanSheets\Final Engineering\L2.0 LANDSCAPE PLAN.dwg May 09, 2024 4:52pm By: Hope Lipkik  
 This document, together with the concepts and designs presented herein, is an instrument of service, and is intended only for the specific purpose and client for which it was prepared. Release of and improper reliance on this document without written authorization and adaptation by Kimley-Horn and Associates, Inc. shall be without liability to Kimley-Horn and Associates, Inc.



Drawing name: K:\CHS\_LDEV\268485001\_CyrusOne\_Aurora\_IL\2 Design\CAD\PlantSchedules\Final Engineering\1.0 LANDSCAPE PLAN.dwg L2.1 LANDSCAPE SCHEDULES May 09, 2024 4:53pm By: Hope.Liptak  
 This document, together with the concepts and designs presented herein, is intended only for the specific purpose and client for which it was prepared. Reuse of and improper reliance on this document without written authorization and adaptation by Kimley-Horn and Associates, Inc. shall be without liability to Kimley-Horn and Associates, Inc.

PLANT SCHEDULE						
SYMBOL	CODE	QTY	BOTANICAL / COMMON NAME	CONT	SPACING	SIZE
<b>TREES</b>						
	AN	18	ACER X FREEMANII 'AUTUMN BLAZE' / AUTUMN BLAZE MAPLE	B & B	2.5' CAL MIN	
	BR	35	BETULA NIGRA / RIVER BIRCH	B & B	2.5' CAL MIN	
	CO	38	CELTIS OCCIDENTALIS / COMMON HACKBERRY	B & B	2.5' CAL MIN	
	GS	31	GLEDTISIA TRIACANTHOS INERMIS 'SKYLINE' / SKYLINE HONEY LOCUST	B & B	2.5' CAL MIN	
	LT	28	LIRIODENDRON TULIPIFERA / TULIP POPLAR	B & B	2.5' CAL MIN	
	QB	39	QUERCUS BICOLOR / SWAMP WHITE OAK	B & B	2.5' CAL MIN	
	QM	33	QUERCUS MACROCARPA / BURR OAK	B & B	2.5' CAL MIN	
	QC	34	QUERCUS ROBUR X ALBA 'CRIMSCHMIDT' / CRIMSON SPIRE™ OAK	B & B	2.5' CAL MIN	
	TD	27	TAXODIUM DISTICHUM / BALD CYPRESS	B & B	2.5' CAL MIN	
	TC	33	TILIA CORDATA / LITTLELEAF LINDEN	B & B	2.5' CAL MIN	
	ZA	18	ZELKOVA SERRATA 'AUTUMN GLOW' / AUTUMN GLOW JAPANESE ZELKOVA	B & B	2.5' CAL MIN	
<b>EVERGREEN TREES</b>						
	PW	57	PINUS ALBA / WHITE PINE	B & B	6' HT MIN	
	PF	45	PINUS FLEXILIS 'VANDERWOLF'S PYRAMID' / VANDERWOLF'S LIMBER PINE	B & B	6' HT MIN	
	PD	46	PSEUDOTSUGA MENZIESII / DOUGLAS FIR	B & B	6' HT MIN	
	TG2	46	THUJA STANDISHII X PLICATA 'GREEN GIANT' / GREEN GIANT ARBORVITAE	B & B	6' HT MIN	
	TC4	44	TSUGA CANADENSIS / CANADIAN HEMLOCK	B & B	6' HT MIN	
<b>ORNAMENTAL TREES</b>						
	AL	27	AMELANCHIER LAEVIS / ALLEGHENY SERVICEBERRY	B & B	8' HT MIN	MULTI-STEM
	CI	30	CRATAEGUS CRUS-GALLI INERMIS / THORNLESS COCKSPUR HAWTHORN	B & B	2.5' CAL MIN	SINGLE STEM
	MP	28	MALUS X 'PRAIRIFIRE' / PRAIRIFIRE CRABAPPLE	B & B	2.5' CAL MIN	SINGLE STEM
	SI	25	SYRINGA RETICULATA 'IVORY SILK' / IVORY SILK JAPANESE TREE LILAC	B & B	2.5' CAL MIN	SINGLE STEM
<b>SHRUBS</b>						
	AM2	33	ARONIA MELANOCARPA 'MORTON' TM / IROQUIS BEAUTY BLACK CHOKEBERRY	-	SEE PLAN	18" HT MIN
	AL2	88	ARONIA MELANOCARPA 'UCONNAM165' / LOW SCAPE MOUND® BLACK CHOKEBERRY	-	SEE PLAN	18" HT MIN
	CA2	33	CEANOTHUS AMERICANUS / NEW JERSEY TEA	-	SEE PLAN	18" HT MIN
	CA	39	CORNUS SANGUINEA 'CATO' TM / ARCTIC SUN BLOODTWIG DOGWOOD	-	SEE PLAN	18" HT MIN
	HL	31	HYDRANGEA PANICULATA 'JANE' TM / LITTLE LIME PANICLE HYDRANGEA	-	SEE PLAN	18" HT MIN
	IL	45	ITEA VIRGINICA 'LITTLE HENRY' TM / VIRGINIA SWEETSPIRE	-	SEE PLAN	18" HT MIN
	PL	39	PHYSOCARPUS OPULIFOLIUS 'LITTLE DEVIL' TM / DWARF NINEBARK	-	SEE PLAN	18" HT MIN
	RG	45	RHUS AROMATICA 'GRO-LOW' / GRO-LOW FRAGRANT SUMAC	-	SEE PLAN	18" HT MIN
	VA	39	VIBURNUM DENTATUM 'CHRISTOM' / BLUE MUFFIN VIBURNUM	-	SEE PLAN	18" HT MIN
<b>EVERGREEN SHRUBS</b>						
	JF2	46	JUNIPERUS CHINENSIS 'FAIRVIEW' / FAIRVIEW JUNIPER	-	SEE PLAN	18" HT MIN
	JL	37	JUNIPERUS CHINENSIS 'GOLD LACE' / GOLD LACE JUNIPER	-	SEE PLAN	18" HT MIN
	PG	42	PICEA PUNGENS 'GLAUCA GLOBOSA' / COLORADO SPRUCE	-	SEE PLAN	18" HT MIN
	PS2	43	PINUS STROBUS 'STOWE PILLAR' / STOWE PILLAR WHITE PINE	-	SEE PLAN	18" HT MIN
	TT2	33	TAXUS X MEDIA 'TAUNTONII' / TAUNTON'S ANGLO-JAPANESE YEW	-	SEE PLAN	18" HT MIN
	TC2	34	THUJA OCCIDENTALIS 'CONCESARINI' TM / PANCAKE ARBORVITAE	-	SEE PLAN	18" HT MIN
	TA	37	THUJA OCCIDENTALIS 'WOODWARDII' / WOODWARDII EASTERN ARBORVITAE	-	SEE PLAN	18" HT MIN
<b>GROUND COVERS</b>						
	BB		BASIN BOTTOM PLUG MIX			
	TS		TURF SEED			
	WM		WET-MESIC PRAIRIE SEED MIX			

Landscape Implementation Data Table: Plant List by Category							
	QTY	Percent	SYM	BOTANICAL NAME (Family / Genus / Species)	COMMON NAME	SIZE	COMMENTS
<b>Canopy Trees</b>	18	5%	AN	ACER FREEMANII 'AUTUMN BLAZE'	AUTUMN BLAZE MAPLE	2.5" CAL MN	
	35	10%	BR	BETULA NIGRA	RIVER BIRCH	2.5" CAL MN	
	38	11%	CO	CELTIS OCCIDENTALIS	COMMON HACKBERRY	2.5" CAL MN	
	31	9%	GS	GLEDTISIA TRIACANTHOS 'SKYLINE'	SKYLINE HONEY LOCUST	2.5" CAL MN	
	28	8%	LT	LIRIODENDRON TULIPIFERA	TULIP POPLAR	2.5" CAL MN	
	39	12%	QB	QUERCUS BICOLOR	SWAMP WHITE OAK	2.5" CAL MN	
	33	10%	QM	QUERCUS MACROCARPA	BURR OAK	2.5" CAL MN	
	34	10%	QC	QUERCUS ROBUR X ALBA 'CRIMSCHMIDT' TM	CRIMSON SPIRE OAK	2.5" CAL MN	
	33	10%	TC	TILIA CORDATA	LITTLELEAF LINDEN	2.5" CAL MN	
	27	8%	TD	TAXODIUM DISTICHUM	BALD CYPRESS	2.5" CAL MN	
	18	5%	ZA	ZELKOVA SERRATA 'AUTUMN GLOW'	AUTUMN GLOW JAPANESE ZELKOVA	2.5" CAL MN	
<b>Total:</b>	<b>334</b>	<b>100%</b>					
<b>Evergreen Trees</b>	57	24%	PW	PINUS ALBA	WHITE PINE	6' HT MIN	
	45	19%	PF	PINUS FLEXILIS 'VANDERWOLF'S PYRAMID'	VANDERWOLF'S LIMBER PINE	6' HT MIN	
	46	19%	PD	PSEUDOTSUGA MENZUESII	DOUGLAS FR	6' HT MIN	
	46	19%	TG2	THUJA STANDISHII X PLICATA 'GREEN GIANT'	GREEN GIANT ARBORVITAE	6' HT MIN	
	44	18%	TC4	TSUGA CANADENSIS	CANADIAN HEMLOCK	6' HT MIN	
<b>Total:</b>	<b>238</b>	<b>100%</b>					
<b>Undersory Trees</b>	27	25%	AL	AMELANCHIER LAEVIS	ALLEGHENY SERVICEBERRY	8' HT MIN	MULTI-STEM
	30	27%	CI	CRATAEGUS CRUS-GALLINERMIS TM	THORNLESS COCKSPUR HAWTHORN	2.5" CAL MN	
	28	25%	CI	SYRINGA RETICULATA 'IVORY SILK'	IVORY SILK JAPANESE TREE LILAC	2.5" CAL MN	
	25	23%	MP	MALUS X 'PRAIRIFIRE'	PRAIRIFIRE CRABAPPLE	2.5" CAL MN	
<b>Total:</b>	<b>110</b>	<b>100%</b>					
<b>Deciduous Shrubs</b>	33	8%	AM2	ARONIA MELANOCARPA 'MORTON' TM	IROQUIS BEAUTY BLACK CHOKEBERRY	18" HT MIN	
	88	22%	AL2	ARONIA MELANOCARPA 'UCONNAM165'	LOW SCAPE MOUND BLACK CHOKEBERRY	18" HT MIN	
	33	8%	CA2	CEANOTHUS AMERICANUS	NEW JERSEY TEA	18" HT MIN	
	39	10%	CA	CORNUS SANGUINEA 'CATO' TM	ARCTIC SUN BLOODTWIG DOGWOOD	18" HT MIN	
	31	8%	FG	HYDRANGEA PANICULATA 'JANE' TM	LITTLE LIME PANICLE HYDRANGEA	18" HT MIN	
	45	11%	IL	ITEA VIRGINICA 'LITTLE HENRY' TM	VIRGINIA SWEETSPIRE	18" HT MIN	
	39	10%	PL	PHYSOCARPUS OPULIFOLIUS 'LITTLE DEVIL' TM	DWARF NINEBARK	18" HT MIN	
	45	11%	IL	RHUS AROMATICA 'GRO-LOW'	GRO-LOW FRAGRANT SUMAC	18" HT MIN	
	39	10%	VA	VIBURNUM DENTATUM 'CRISTOM'	BLUE MUFFIN VIBURNUM	18" HT MIN	
<b>Total:</b>	<b>392</b>	<b>100%</b>					
<b>Evergreen Shrubs</b>	46	17%	JF2	JUNIPERUS CHINENSIS 'FAIRVIEW'	FAIRVIEW JUNIPER	18" HT MIN	
	37	14%	JL	JUNIPERUS CHINENSIS 'GOLD LACE'	GOLD LACE JUNIPER	18" HT MIN	
	42	15%	PG	PICEA PUNGENS 'GLAUCA GLOBOSA'	COLORADO SPRUCE	18" HT MIN	
	43	16%	PS2	PINUS STROBUS 'STOWE PILLAR'	STOWE PILLAR WHITE PINE	18" HT MIN	
	33	12%	TT2	TAXUS X MEDIA 'TAUNTONII'	TAUNTON'S ANGLO-JAPANESE YEW	18" HT MIN	
	34	13%	TC2	THUJA OCCIDENTALIS 'CONCESARINI' TM	PANCAKE ARBORVITAE	18" HT MIN	
	37	14%	TA	THUJA OCCIDENTALIS 'WOODWARDII'	WOODWARDII EASTERN ARBORVITAE	18" HT MIN	
<b>Total:</b>	<b>272</b>	<b>100%</b>					



No.	REVISIONS	DATE	BY
<small>© 2024 KIMLEY-HORN AND ASSOCIATES, INC.        4201 WINFIELD ROAD, SUITE 600        PHONE: 630-487-2550        WWW.KIMLEY-HORN.COM</small>			
SCALE:	DESIGNED BY: HL	DRAWN BY: HL	CHECKED BY: CW
LANDSCAPE SCHEDULES			
<b>CYRUSONE</b> <b>AURORA</b> <small>2725 BILTER RD        AURORA, IL 60502</small>			
<small>ORIGINAL ISSUE:        05/06/2024        KHA PROJECT NO.        268485001        SHEET NUMBER</small>			
L2.1			