

# LANDSCAPE PLAN FOR 410 HILL AVENUE

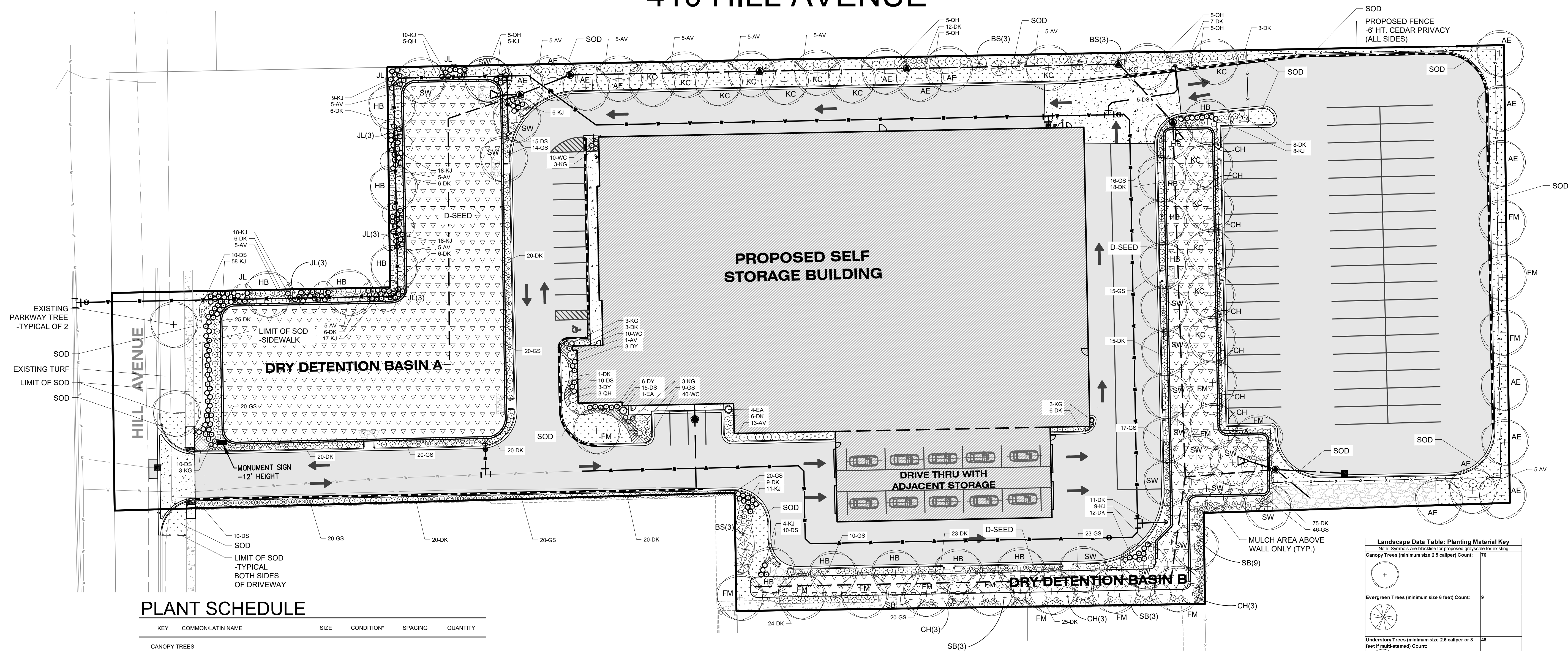

## PLANT SCHEDULE

KEY	COMMON/LATIN NAME	SIZE	CONDITION*	SPACING	QUANTITY
CANOPY TREES					
AE	ACCOLADE SMOOTHLEAF ELM ULMUS CARPINIFOLIA	2.5" CAL.	B & B	SPECIMEN	15
HB	CHICAGO/LAND COMMON HACKBERRY CELTIS OCCIDENTALIS	2.5" CAL.	B & B	SPECIMEN	15
FM	AUTUMN BLAZE FREEMAN MAPLE ACER X FREEMANII	2.5" CAL.	B & B	SPECIMEN	15
KC	ESPRESSO KENTUCKY COFFEETREE GYMNOCLADUS DIOICUS	2.5" CAL.	B & B	SPECIMEN	15
SW	SWAMP WHITE OAK QUERCUS BICOLOR	2.5" CAL.	B & B	SPECIMEN	16
UNDERSTORY TREES					
CH	COCKSPUR HAWTHORN CRATAEGUS CRUS-GALLI VAR. INERMIS	8' HT.	B & B	SPECIMEN	16
JL	JAPANESE TREE LILAC SYRINGA RETICULATA	2.5" CAL.	B & B	SPECIMEN	16
SB	ALLEGHENY SERVICEBERRY AMELANCHIER LAEVIS	8' HT.	B & B	SPECIMEN	16
EVERGREEN TREES					
BS	BLACK HILLS SPRUCE PICEA GLAUCOA VAR. DENSATA	6' HT.	B & B	SPECIMEN	9
EVERGREEN SHRUBS					
EA	EMERALD GREEN ARBORVITAE THUJA OCCIDENTALIS SMAGARD	5' HT.	B & B	4.5' O.C.	2
DY	DENSE YEW TAXUS X MEDIA DENSIFORMIS	18"	B & B	3' O.C.	12
KJ	KALLAY JUNIPER JUNIPERUS CHINENSIS KALLAYS COMPACTA	18"	B & B	3' O.C.	208
DECIDUOUS SHRUBS					
AV	AMERICAN CRANBERRY VIBURNUM VIBURNUM TRILOBUM	30"	B & B	4.5' O.C.	74
DK	DIERVILLA KODIAK RED DIERVILLA G2X88544	18"	B & B	3' O.C.	397
GS	GRO-LOW SUMAC RHUS AROMATICA	18"	B & B	3' O.C.	281
QH	QUICK FIRE HYDRANGEA HYDRANGEA PANICULATA BULK	30"	B & B	4.5' O.C.	30
GROUNDCOVERS, PERENNIALS AND ORNAMENTAL GRASSES					
DS	STELLA DE ORO DAYLILY HEMERCALLIS SPECIES	1G.	CONTR.	2' O.C.	95
KG	*KARL FOERSTER FEATHER REED GRASS CALAMAGROSTIS X ACUTIFLORA	3G.	CONTR.	3' O.C.	15
WC	WALKERS LOW CATMINT NEPETA RACEMOSA	1G.	CONTR.	2' O.C.	55
SOD	SODDED LAWN BLACK BEAUTY TALL FESCUE	S.Y.	(OWNERS OPTION) SEED W/BLANKET		1,300
D-SEED	DETENTION BASIN SEED MIX GENESIS LO PRO SALT TOLERANT WETLAND / DETENTION MIX	S.Y.	W/ CRIMPED STRAW MULCH		3,300

\* IF B & B PLANTS ARE NOT AVAILABLE DUE TO TIME OF SEASON, CONTAINER GROWN PLANTS MAY BE SUBSTITUTED, AS APPROVED BY THE LANDSCAPE ARCHITECT.

\*\*\*OWNER'S OPTION: SEED WITH STRAW BLANKET.

\*\*\*ALL MIXES ARE TO BE SUPPLIED BY ARTHUR CLESEN, INC. 847/537-2177 (OR APPROVED EQUAL). INSTALL PER GROWER'S RECOMMENDATIONS. SEE SHEET LS-2 FOR DETAILED SEED LIST.

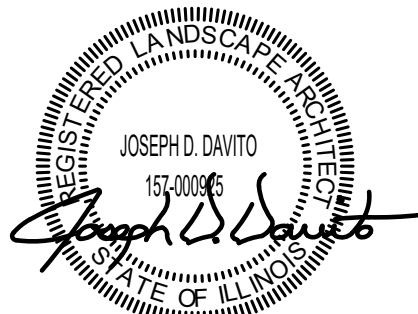
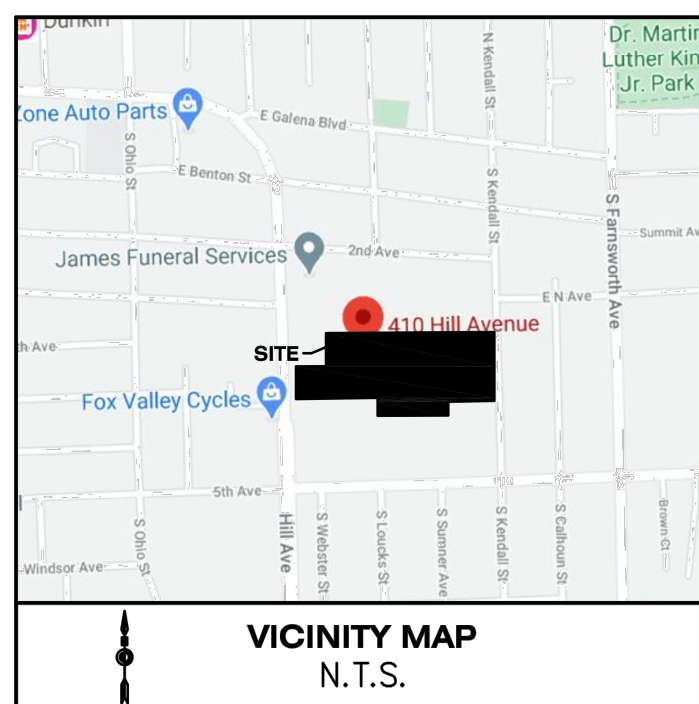
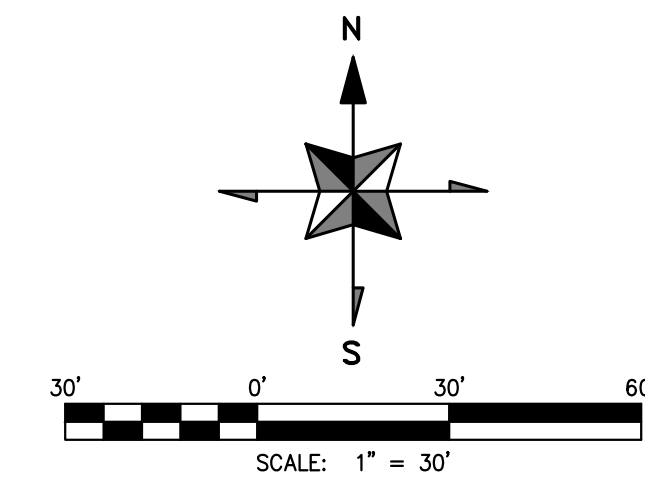

Landscape Data Table: CTEs Provided			
	CTE Value	Count Provided	Total CTEs Provided
Canopy Trees	1	76	76
Evergreen Trees	1/3	9	3
Understory Trees	1/3	48	16
Deciduous Shrubs	1/20	782	39
Evergreen Shrubs	1/20	222	11
Total:		1137	145

Landscape Data Table: Planting Material Key	
Note: Symbols are indicative for proposed materials for existing	
Canopy Trees (minimum size 2.5 caliper) Count:	76
Evergreen Trees (minimum size 6 feet) Count:	9
Understory Trees (minimum size 2.5 caliper or 8 feet if multi-stemmed) Count:	48
Evergreen Shrubs (minimum of 18 inches) Count:	222
Deciduous Shrubs (minimum of 18 inches) Count:	782
Ornamental Grasses Count:	15
Perennials Count:	150
Annals Count:	0
Groundcover Square Footage:	0
Turf (Seeded) Square Footage:	0
Turf (Sod) Square Footage:	11700
Native Prairie Planting Square Footage:	0
Native Wetland Planting Square Footage:	25700

REVISIONS		
DATE	DESCRIPTION	PER CITY
11/25/20		

## SELF STORAGE

410 HILL AVENUE  
AURORA, ILLINOIS

## LANDSCAPE PLAN

SCALE: 1"=30'-0"  
DATE: SEPTEMBER 18, 2020  
DESIGNED BY: J. DAVITO, PLA  
CHECKED BY: JDD



PROJ. NO. 20-010

LS-1

J. DAVITO DESIGN, INC. COPYRIGHT © 2020

FOR PERMIT REVIEW



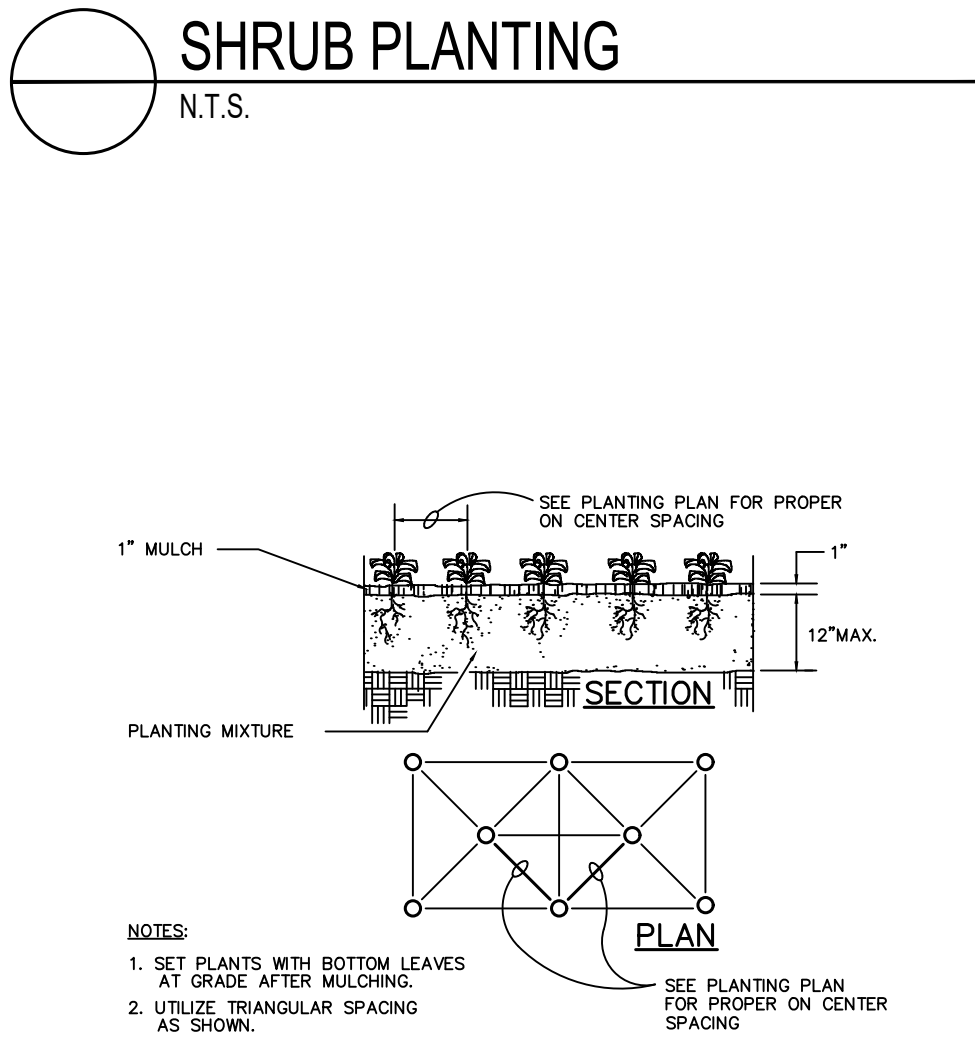
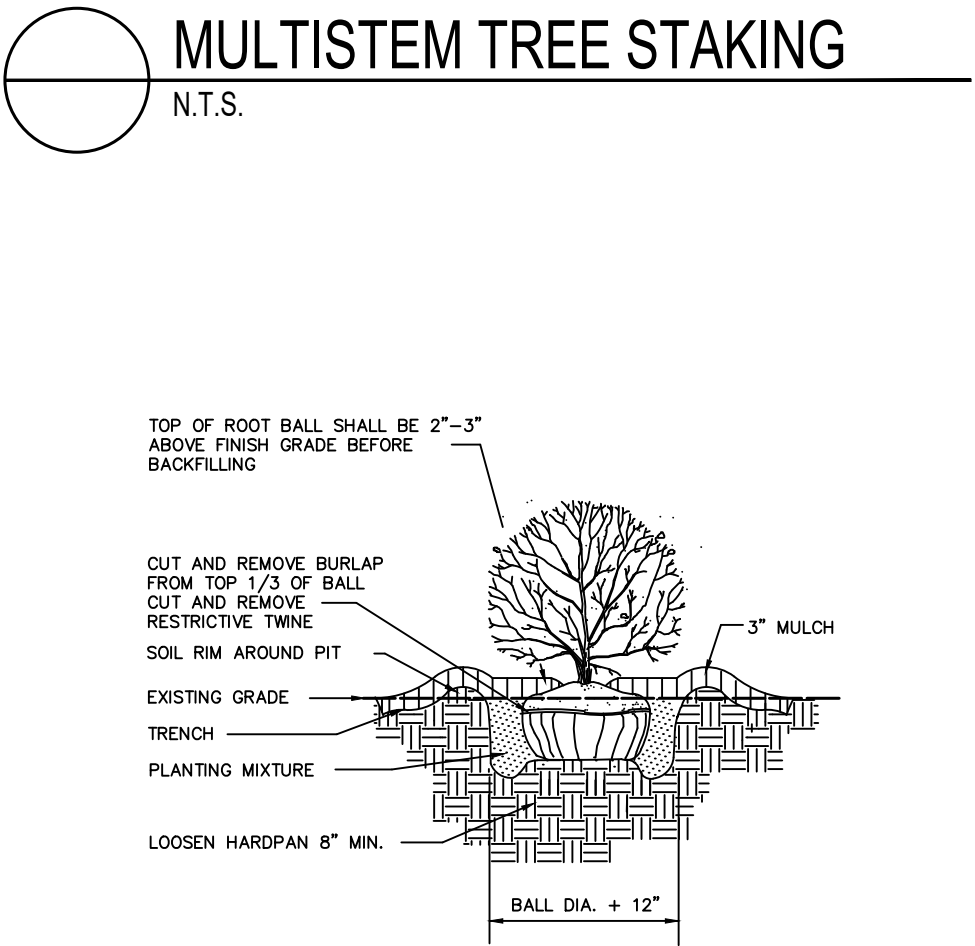
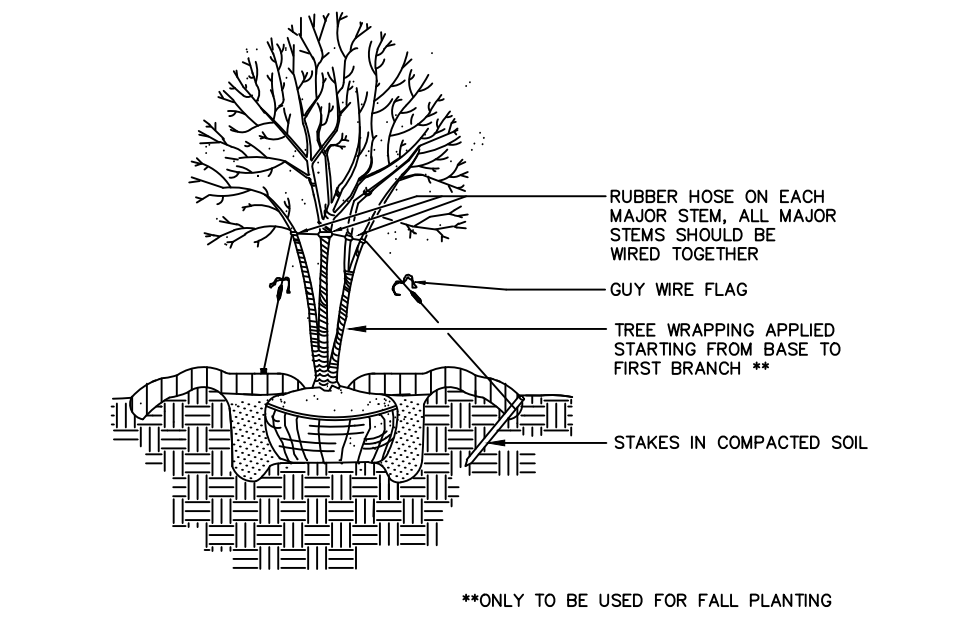
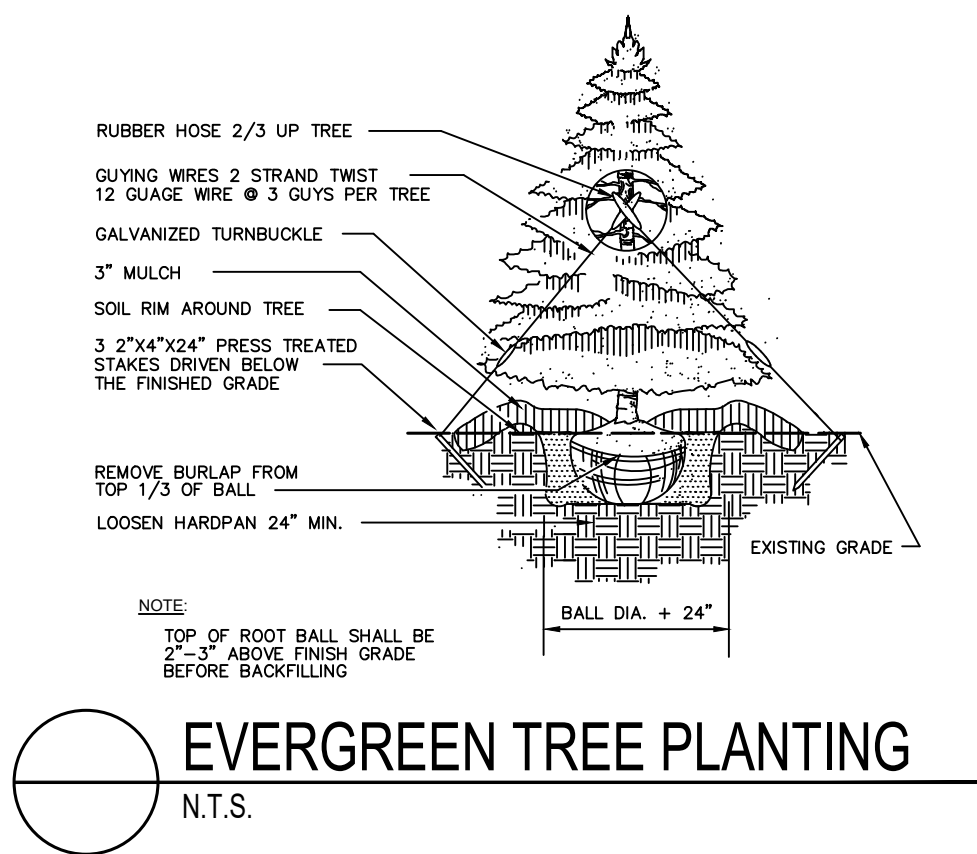
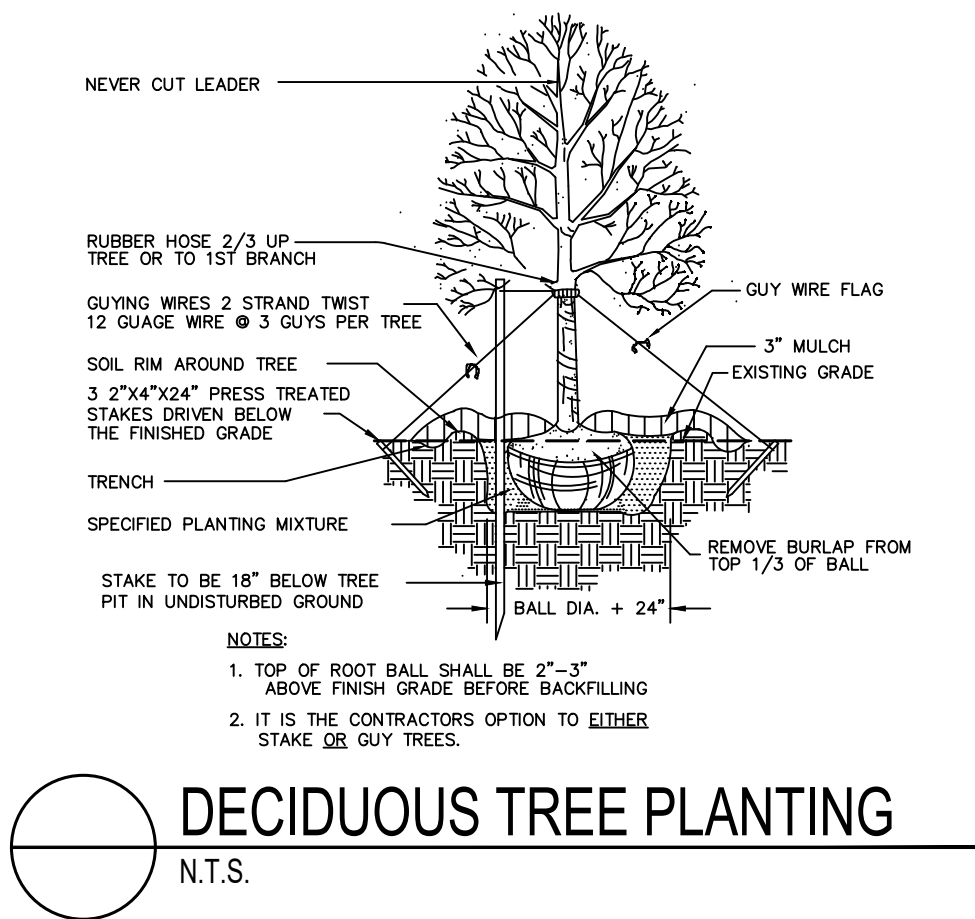

## SEED LIST

WET-MESIC DETENTION BASIN SEED MIX

GRASSES	LBS./ACRE
BENT GRASS	2.000
ALKALI BULRUSH	0.375
NEBRASKA SEDGE	0.250
EXPRESSWAY SEDGE	0.250
AWLFRUIT SEDGE	0.063
FOX SEDGE	1.000
GREAT SPIKERUSH	0.063
LAKE SHORE RUSH	0.188
COMMON RUSH	0.094
JOINT GRASS	0.031
CHAIRMAKERS RUSH	0.250
GRASSES TOTAL:	4.564
FORBS	LBS./ACRE
COMMON WATER PLANTIAN	1.000
NODDING BUR MARIGOLD	0.250
PANICLED ASTER	0.250
BLUE VERVAIN	1.000
COVER CROP	LBS./ACRE
RED TOP GRASS	3.000
OATS	32.000
SALT GRASS	1.000
INDIAN RYE	5.000
ALKALI GRASS	5.000
COVER CROP TOTAL:	46.000

NOTE: ALL SEED TO BE SUPPLIED BY AURTHUR CLESEN, INC. (847) 537-2177, OR APPROVED EQUAL.

## NATIVE SEED MAINTENANCE AND ESTABLISHMENT PLAN

### MONITORING AND MANAGEMENT PLAN

#### 1.0 MONITORING METHODOLOGY

The native plant communities will be monitored annually for 3 years following planting. The purpose of this monitoring will be to measure and assess the effectiveness of the plantings. Vegetation monitoring will be performed through the utilization of a meander search. The meander survey will identify all species encountered, dominant species within each plant community, and identify areas that require management necessary to reach design goals. Site conditions shall be photo documented during the monitoring session.

#### 2.0 PERFORMANCE CRITERIA

1. At least 90% of the seeded area should be vegetated with cover crop species from the seed mix by June 1st following a spring seeding. If planting occurred in the fall or winter, minimum cover crop is expected. Matting shall be inspected to ensure that proper erosion control and seed protection is in place.

2. After one full growing season, aerial coverage of native species should be at least 20%.

3. After two full growing seasons, aerial coverage of native species should be at least 50%.

4. After the third full growing season, aerial coverage of native species should be at least 75%.

5. In no year should areas contain rills or gullies greater than four inches wide by four inches deep.

6. No area greater than 1 square meter shall be devoid of vegetation as measured by aerial coverage.

7. No more than 25% (by aerial cover) of the seeded area should be dominated by aggressive exotic species such as Reed Canary Grass (*Phalaris arundinacea*), Red Clover (*Trifolium spp.*), White or Yellow Sweet Clover (*Mellilotus spp.*), Canada Thistle (*Cirsium arvense*), or Tall Fescue (*Festuca elatior*).

8. If these standards are not met, the contractor shall be responsible for supplemental seedings and herbicide applications in accordance with the specifications and input from a restoration ecologist. Losses due to animal depredation, extremes in weather or precipitation, or acts of vandalism shall not be covered under Landscape Contractor guarantees.

#### 3.0 REPORTING

An annual vegetation monitoring report will be submitted to the client and the local municipality by December 31st of each year (or as required). If it appears that these standards will not be met (based on monitoring results), replanting and/or additional vegetation monitoring will be conducted as necessary to achieve the objectives outlined above.

#### 4.0 MANAGEMENT PLAN

1. **First Season.** Control of undesirable plant species, when present in small quantities, shall consist primarily of selective herbicide application. Selective herbicides are absorbed through the plant tissues and into the root system, effectively killing the plant. Mowing shall be conducted twice in the spring and once in the summer at a height of at least 6 to 12 inches to prevent annual weeds from producing seed.

2. **Second Season.** Control of undesirable plant species during the second growing season shall consist primarily of herbicide application. The area shall be mowed at least once in the spring at a height of at least 6 to 8 inches to prevent annual weeds from producing seed.

3. **Third Season and Long Term.** Control of undesirable plant species shall consist primarily of spot herbicide application as needed. Mowing at a height of at least 6 to 8 inches may also be used as a management tool on an as needed basis.

## LANDSCAPE PLAN NOTES

- ALL PROPOSED SHRUB BEDS AND TREE RINGS TO RECEIVE 3" THC. SHREDDED HARDWOOD MULCH (PERENNIALS/GROUNDCOVERS 1" THC.)
- REPAIR ALL EXISTING TURF AREAS DISTURBED DURING CONSTRUCTION (SOD).
- LIMIT OF SEED & SOD = PROPERTY LINE (UNLESS OTHERWISE NOTED).
- THE CONTRACTOR SHALL LOCATE THE EXISTENCE OF UTILITIES PRIOR TO STARTING WORK.
- THE CONTRACTOR SHALL SUPPLY ALL PLANT MATERIALS IN QUANTITIES SUFFICIENT TO COMPLETE THE PLANTING SHOWN ON THE DRAWING. PLANT MATERIAL QUANTITIES SHOWN ON PLAN TAKE PRECEDENCE TO THOSE OF THE PLANT LIST.
- ALL PLANT MATERIALS SHALL CONFORM TO THE GUIDELINES ESTABLISHED BY THE CURRENT AMERICAN STANDARD FOR NURSERY STOCK, PUBLISHED BY THE AMERICAN ASSOC. OF NURSERYMEN OR EQUIVALENT. NO "PARK GRADE" MATERIAL SHALL BE ACCEPTED.
- ALL PLANT MATERIAL SHALL BEAR THE SAME RELATIONSHIP TO FINISHED GRADE AS THE PLANTS ORIGINAL GRADE BEFORE DIGGING.
- ALL PLANTS SHALL BE BALLED AND WRAPPED OR CONTAINER GROWN AS SPECIFIED. NO CONTAINER GROWN STOCK SHALL BE ACCEPTED IF IT IS ROOT BOUND. ALL WRAPPING MATERIAL MADE OF SYNTHETICS OR PLASTICS SHALL BE REMOVED AT THE TIME OF PLANTING.
- ALL PLANTINGS SHALL BE WATERED DURING THE FIRST 24 HOUR PERIOD AFTER PLANTING. WATER THOROUGHLY TO ENSURE ALL AIR POCKETS ARE REMOVED AROUND ROOT BALL.
- CONTRACTOR IS RESPONSIBLE FOR WATERING SOD UNTIL TIME OF KNOTTING.
- IMPORTED TOPSOIL (PLANTING AREAS) AND SPREADING BY EXCAVATING CONTRACTOR.
- ALL PROPOSED TREES OUTSIDE PLANTING BED AREAS SHALL RECEIVE A 5' DIA. MULCH RING AROUND TRUNK.
- ALL PLANTS AND STAKES SHALL BE SET PLUMB, UNLESS OTHERWISE NOTED. IT IS THE CONTRACTOR'S OPTION TO STAKE TREES, BUT HIS RESPONSIBILITY TO ASSURE PLANTS REMAIN PLUMB UNTIL END OF GUARANTEE PERIOD. IF STAKING OF TREES IS NOT PERFORMED, REMOVAL OF TOP 1/3 OF BURLAP AND ROPES IS UNNECESSARY (REMOVE ALL NON-BIODEGRADABLE MATERIAL).
- INFORMATION CONTAINED IN "PLAN NOTES" TAKES PRECEDENCE OVER INFORMATION IN "DETAILS".
- VERIFY SITE CONDITIONS AND INFORMATION ON DRAWINGS. PROMPTLY REPORT ANY DISCREPANCIES AND/OR DEVIATIONS FROM THE INFORMATION SHOWN ON THE PLAN. THE OWNER IS NOT RESPONSIBLE FOR UNAUTHORIZED CHANGES OR EXTRA WORK REQUIRED TO CORRECT UNREPORTED DISCREPANCIES.
- ALL PLANTING BED EDGES TO BE CULTIVATED.
- SHADE TREES, OTHER THAN THOSE IN SCREENING AREAS, TO HAVE LOWEST LIMBS AT LEAST SIX (6) FEET ABOVE THE GROUND.
- AMEND ALL GROUNDCOVER BEDS W/4" THC. SAND AND COMPOST MIX PRIOR TO PLANTING. MIX INTO EXISTING TOPSOIL.
- OWNER'S OPTION: ALL LANDSCAPED AREAS TO BE IRRIGATED WITH AN APPROPRIATE UNDERGROUND IRRIGATION SYSTEM. RECORD DRAWINGS TO BE SUBMITTED TO OWNER FOR APPROVAL.
- ALL TREES TO BE GROWN IN A NURSERY LOCATED WITHIN ONE HUNDRED FIFTY (150) MILES OF THE SITE.

REVISIONS		
DATE	DESCRIPTION	PER CITY
11/25/20		

## SELF STORAGE

410 HILL AVENUE  
AURORA, ILLINOIS

### LANDSCAPE DETAILS

SCALE:	1"=30'-0"
DATE:	SEPTEMBER 18, 2020
DESIGNED BY:	J. DAVITO, PLA
CHECKED BY:	JDD

**J. DAVITO DESIGN, INC.**  
LANDSCAPE ARCHITECTURAL DESIGN  
1510 N. LAKE DRIVE  
AURORA, IL 60009  
(847) 489-8797  
WWW.JDAVITODESIGN.COM

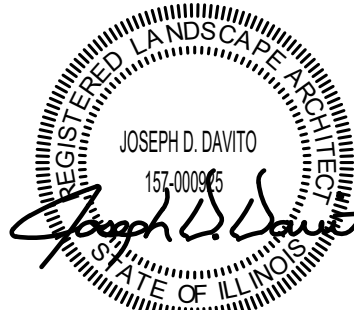

PROJ. NO. 20-010

LS-2

J. DAVITO DESIGN, INC. COPYRIGHT © 2020

FOR PERMIT REVIEW