

LANDSCAPE PLAN FOR LOTS 2-4
OF MELODY TOWN CENTER

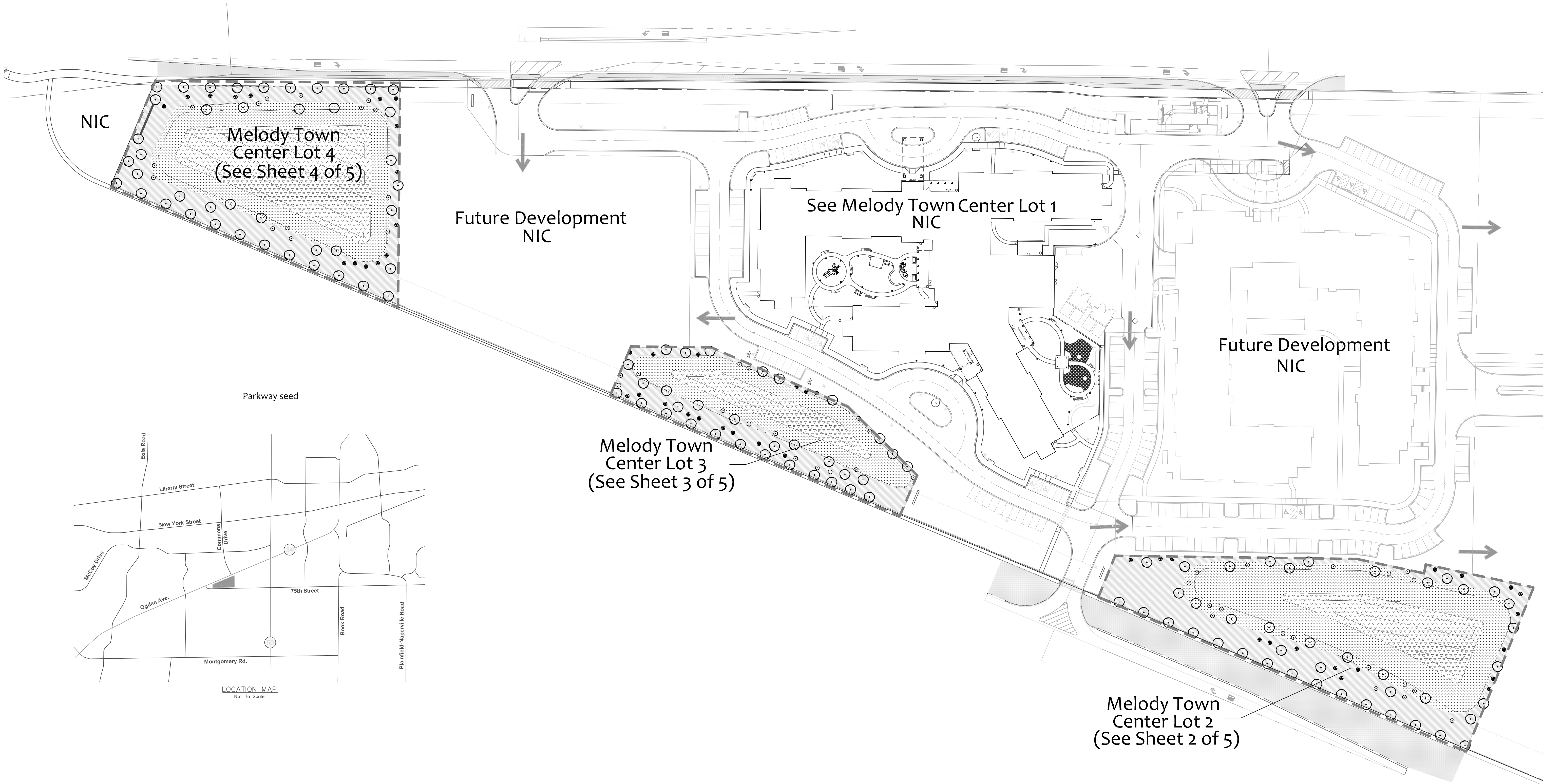

GENERAL NOTES

1. CONTRACTOR IS RESPONSIBLE FOR VERIFYING QUANTITIES, AND FOR PROVIDING SUFFICIENT MATERIALS TO COMPLETE THE JOB PER PLAN.
2. CONTRACTOR SHALL VERIFY UNDERGROUND UTILITY LOCATIONS PRIOR TO COMMENCEMENT OF WORK. CONTRACTOR SHALL AVOID ALL EXISTING UTILITIES, UNDERGROUND AND OVERHEAD WHERE APPLICABLE, AND IS RESPONSIBLE FOR ANY DAMAGE. IF ANY CONFLICTS SHOULD EXIST BETWEEN UTILITIES AND PROPOSED MATERIAL LOCATIONS, FIELD ADJUSTMENTS MUST BE APPROVED BY THE OWNER OR DESIGNATED AGENT PRIOR TO INSTALLATION.
3. CONTRACTOR SHALL VERIFY ALL EXISTING CONDITIONS IN THE FIELD PRIOR TO COMMENCEMENT OF CONSTRUCTION, AND SHALL REPORT TO LANDSCAPE ARCHITECT ANY VARIANCE OR CONDITION WHICH WOULD PREVENT ADHERENCE TO SCHEDULE, PLANS OR SPECIFICATIONS.
4. WORK SHALL CONFORM TO LOCAL MUNICIPAL REQUIREMENTS.
5. FINE GRADE, FERTILIZE AND SEED ALL DISTURBED AREAS WITHIN THE CONSTRUCTION LIMITS AS SHOWN. ALL AREAS SHALL DRAIN COMPLETELY AND SHALL NOT POND OR PUDDLE.
6. CONTRACTOR SHALL BE RESPONSIBLE FOR PROVIDING AND INSTALLING ALL MATERIALS SHOWN ON THE PLAN IN ACCORDANCE WITH THE PLAN DESIGN AND MATERIALS QUANTITIES.
7. THE CONTRACTOR IS RESPONSIBLE FOR PROTECTING UNDERGROUND UTILITIES, SIDEWALKS, AND OTHER PREVIOUSLY CONSTRUCTED SITE IMPROVEMENTS.
8. TOPSOIL TO BE SPREAD IN ALL LAWN AREAS DESIGNATED AS SEED, PER THE ENGINEERS SPECIFICATIONS.

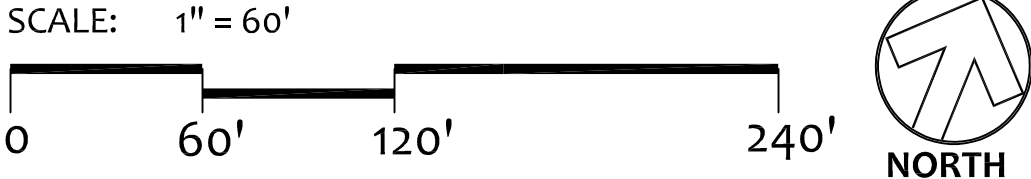

Cedarwood Development
3200 WEST MARKET ST.
FAIRLAWN, OHIO 44133
P: 330-535-4591

Ron Dillaro
Director of Development
(330) 744-0510

Laura Heister
VP of Senior Housing
(330) 744-0517



Karl T Krogstad
Illinois Registered Landscape Architect
License No. 157,000349 - Expires 08/31/2021

KROGSTAD
LAND DESIGN LIMITED
LANDSCAPE ARCHITECTURE • CONSULTING
519 PEMBROOK CT., N., CRYSTAL LAKE, IL 60044
P: 815-529-1511
KROGSTAD@LANDDESIGNLIMITED.COM

LANDSCAPE PLAN FOR LOTS 2-4
OF MELODY TOWN CENTER
AURORA, ILLINOIS

PROJECT # HEL1723

Date: 11/18/20







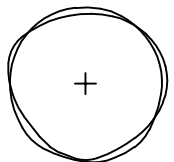
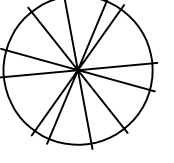
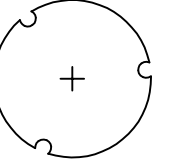

REVISIONS:	
Rev:	12/17/20
Rev:	2/18/21
Rev:	3/23/21

DRAWN KTK

CHECKED KTK

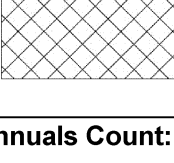
SHEET NO.

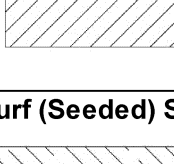
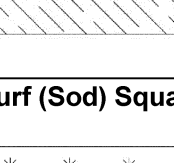
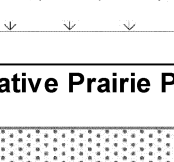
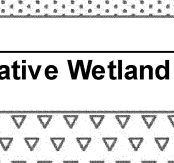
1 of 5

Landscape Data Table: Planting Material Key	
Note: Symbols are blackline for proposed grayscale for existing	
Canopy Trees (minimum size 2.5 caliper) Count:	42
	
Evergreen Trees (minimum size 6 feet) Count:	17
	
Understory Trees (minimum size 2.5 caliper or 8 feet if multi-stemmed) Count:	18
	
Evergreen Shrubs (minimum of 18 inches) Count:	0
	
Deciduous Shrubs (minimum of 18 inches) Count:	0
	
Ornamental Grasses Count:	0
	
Perennials Count:	0
	
Annuals Count:	0
	
Groundcover Square Footage:	0
	
Turf (Seeded) Square Footage:	27604
	
Turf (Sod) Square Footage:	0
	
Native Prairie Planting Square Footage:	32239
	
Native Wetland Planting Square Footage:	11512
	

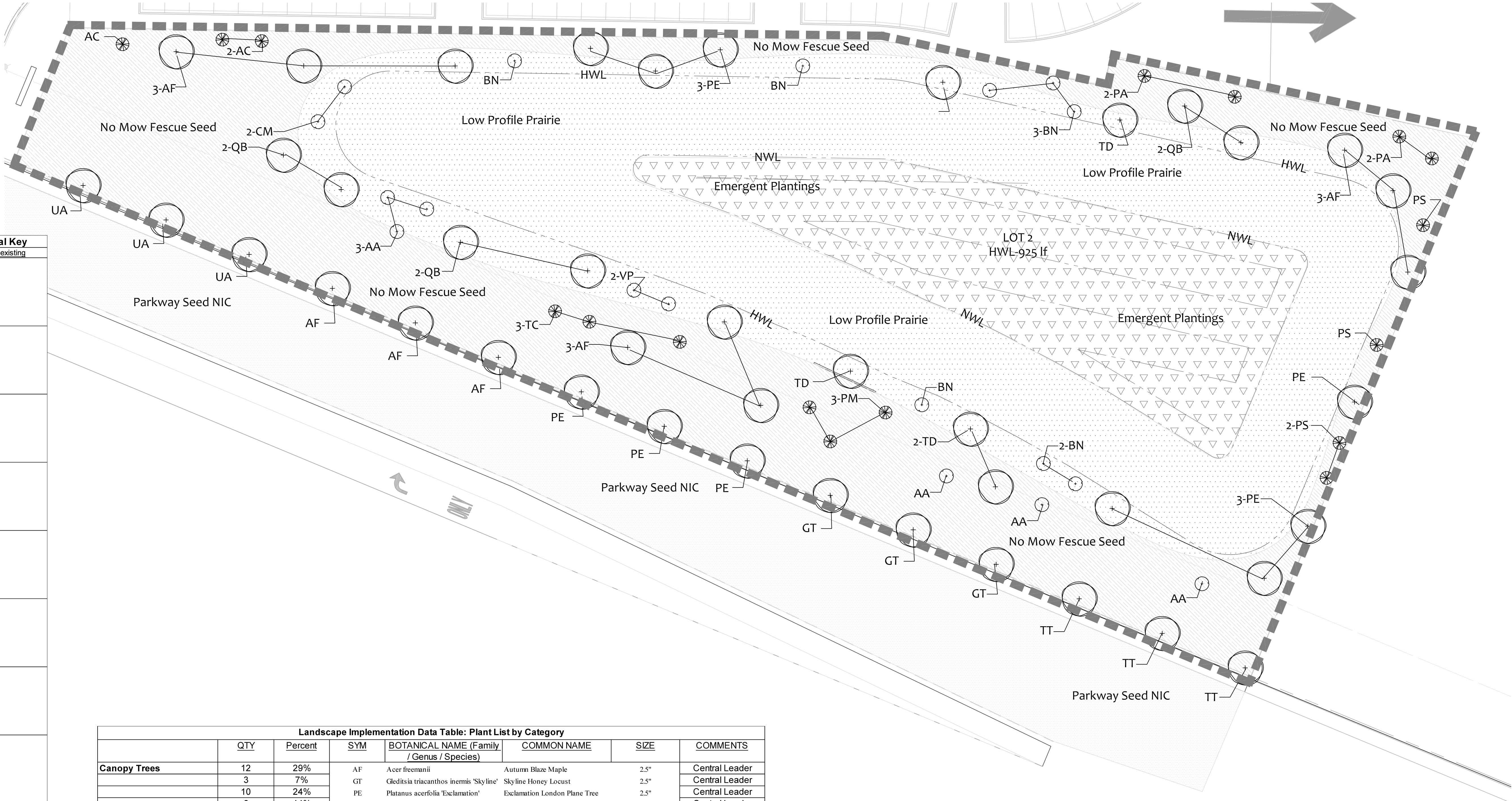

Landscape Implementation Data Table: Plant List by Category						
	QTY	Percent	SYM	BOTANICAL NAME (Family / Genus / Species)	COMMON NAME	COMMENTS
Canopy Trees	12	29%	AF	Acer freemanii	Autumn Blaze Maple	Central Leader
	3	7%	GT	Gleditsia triacanthos inermis 'Skyline'	Skyline Honey Locust	Central Leader
	10	24%	PE	Platanus acerifolia 'Exclamation'	Exclamation London Plane Tree	Central Leader
	6	14%	QB	Quercus bicolor	Swamp White Oak	Central Leader
	5	12%	TD	Taxodium distichum	Bald Cypress	Central Leader
	3	7%	TT	Tilia tomentosa 'Sterling'	Sterling Silver Linden	Central Leader
	3	7%	UA	Ulmus 'Morton'	Accolade Elm	Central Leader
Total:	42	100%				
Evergreen Trees	4	24%	PA	Picea abies	Norway Spruce	
	3	18%	AC	Abies concolor	White Fir	
	3	18%	PM	Pseudotsuga menziesii	Douglas Fir	
	4	24%	PS	Pinus strobus	Eastern White Pine	
	3	18%	TC	Tsuga canadensis	Canadian Hemlock	
	Total:	17	100%			
Understory Trees	6	33%	AA	Amelanchier 'Autumn Brilliance'	Autumn Brilliance Serviceberry	Clump Form
	8	44%	BN	Betula Nigra	River Birch	Clump Form
	2	11%	CM	Cornus mas	Cornelian Cherry Dogwood	Clump Form
	2	11%	VP	Viburnum prunifolium	Blackhaw Viburnum	Clump Form
	Total:	18	100%			
Deciduous Shrubs	0	0%				
	0	0%				
	0	0%				
	0	0%				
	Total:	0	0%			
Evergreen Shrubs	0	0%				
	0	0%				
	0	0%				
	0	0%				
	Total:	0	0%			

Landscape Data Table: CTEs Provided			
	CTE Value	Count Provided	Total CTEs Provided
Canopy Trees	1	42	42
Evergreen Trees	1/3	17	6
Understory Trees	1/3	18	6
Deciduous Shrubs	1/20	0	0
Evergreen Shrubs	1/20	0	0
Total:		77	54

Melody Town Center Lot 2 Detail



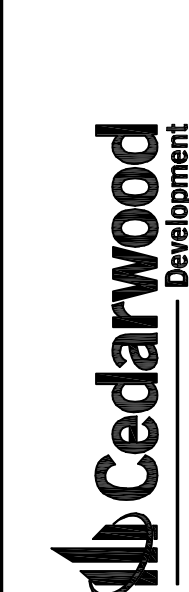

3300 WEST MARKET ST.
PARLAWN, OHIO 44333
P: 330-836-9871
F: 330-836-4591

Ron Dikario
Director of Development
(330) 714-9817



Karl T Krogstad
Illinois Registered Landscape Architect
License No. 157-000349 - Expires 08/31/2021

KROGSTAD
LAND DESIGN LIMITED
LANDSCAPE ARCHITECTURE • CONSULTING
519 PEMBROOK CT. N., CRYSTAL LAKE, IL 60014
815-829-1511
KROGSTAD@LANDDESIGNLIMITED.COM

**LANDSCAPE PLAN FOR LOTS 2-4
OF MELODY TOWN CENTER
AURORA, ILLINOIS**

PROJECT # HEL1723

Date: 11/18/20

REVISIONS:

Rev:	12/17/20
Rev:	2/18/21
Rev:	3/23/21

DRAWN KTK

CHECKED KTK

SHEET NO.

2 of 5

Cedarwood
Development

3200 WEST MARKET ST.
FAIRLAWN, OHIO 44333

P: 330.838-5671
F: 330.838-4591

Ron Eliaerts
Landscape Architect
Landscape Development
(330) 714-8617
(330) 414-8315



Karl T Krogstad
Illinois Registered Landscape Architect
License No. 157-000349 - Expires 08/31/2021

<p>KROGSTAD LAND DESIGN LIMITED <small>LANDSCAPE ARCHITECTURE * CONSULTING 519 PEMBROKE CT. N., CRYSTAL LAKE, IL 60014 P: 815-239-9151 KROGSTAD@LANDDESIGNLIMITED.COM</small></p> <h1 style="text-align: center;">LANDSCAPE PLAN FOR LOTS 2-4 OF MELODY TOWN CENTER AURORA, ILLINOIS</h1>	
PROJECT # HEL1723	
Date:	11/18/20
REVISIONS:	
Rev:	12/17/20
Rev:	2/18/21
Rev:	3/23/21
DRAWN	KTK
CHECKED	KTK
SHEET NO.	
3 of 5	



SCALE: 1" = 20'

0 20' 40' 80'

NORTH

Landscape Data Table: Planting Material Key	
Note: Symbols are blackline for proposed grayscale for existing	
Canopy Trees (minimum size 2.5 caliper) Count:	42
Evergreen Trees (minimum size 6 feet) Count:	15
Understory Trees (minimum size 2.5 caliper or 8 feet if multi-stemmed) Count:	15
Evergreen Shrubs (minimum of 18 inches) Count:	0
Deciduous Shrubs (minimum of 18 inches) Count:	0
Ornamental Grasses Count:	0
Perennials Count:	0
Annuals Count:	0
Groundcover Square Footage:	0
Turf (Seeded) Square Footage:	24141
Turf (Sod) Square Footage:	0
Native Prairie Planting Square Footage:	19473
Native Wetland Planting Square Footage:	22575

Landscape Implementation Data Table: Plant List by Category							
	QTY	Percent	SYM	BOTANICAL NAME (Family / Genus / Species)	COMMON NAME	SIZE	COMMENTS
Canopy Trees	9	21%	AF	Acer freemanii	Autumn Blaze Maple	2.5"	Central Leader
	5	12%	GT	Gleditsia triacanthos inermis 'Skyline'	Skyline Honey Locust	2.5"	Central Leader
	8	19%	PE	Platanus acerifolia 'Exclamation'	Exclamation London Plane Tree	2.5"	Central Leader
	4	10%	QB	Quercus Bicolor	Swamp White Oak	2.5"	Central Leader
	6	14%	TD	Taxodium distichum	Bald Cypress	2.5"	Central Leader
	5	12%	TT	Tilia tomentosa 'Sterling'	Sterling Silver Linden	2.5"	Central Leader
	5	12%	UA	Ulmus 'Morton'	Accolade Elm	2.5"	Central Leader
Total:	42	100%					
Evergreen Trees	5	33%	PA	Picea abies	Norway Spruce	6'	
	5	33%	PG	Picea glauca	Black Hills Spruce	6'	
	5	33%	PM	Psuedotsuga menziesii	Douglas Fir	6'	
Total:	15	100%					
Understory Trees	3	18%	AA	Amelanchier 'Autumn Brilliance'	Autumn Brilliance Serviceberry	8'	Clump Form
	3	18%	BN	Betula Nigra	River Birch	8'	Clump Form
	5	29%	CM	Cornus mas	Cornelian Cherry Dogwood	8'	Clump Form
	6	35%	VP	Viburnum prunifolium	Blackhaw Viburnum	8'	Clump Form
Total:	17	100%					
Deciduous Shrubs	0	0%					
	0	0%					
	0	0%					
	0	0%					
Total:	0	0%					
Evergreen Shrubs	0	0%					
	0	0%					
	0	0%					
	0	0%					
Total:	0	0%					

Landscape Data Table: CTEs Provided			
	CTE Value	Count Provided	Total CTEs Provided
Canopy Trees	1	42	42
Evergreen Trees	1/3	15	5
Understory Trees	1/3	15	5
Deciduous Shrubs	1/20	0	0
Evergreen Shrubs	1/20	0	0
Total:		72	52

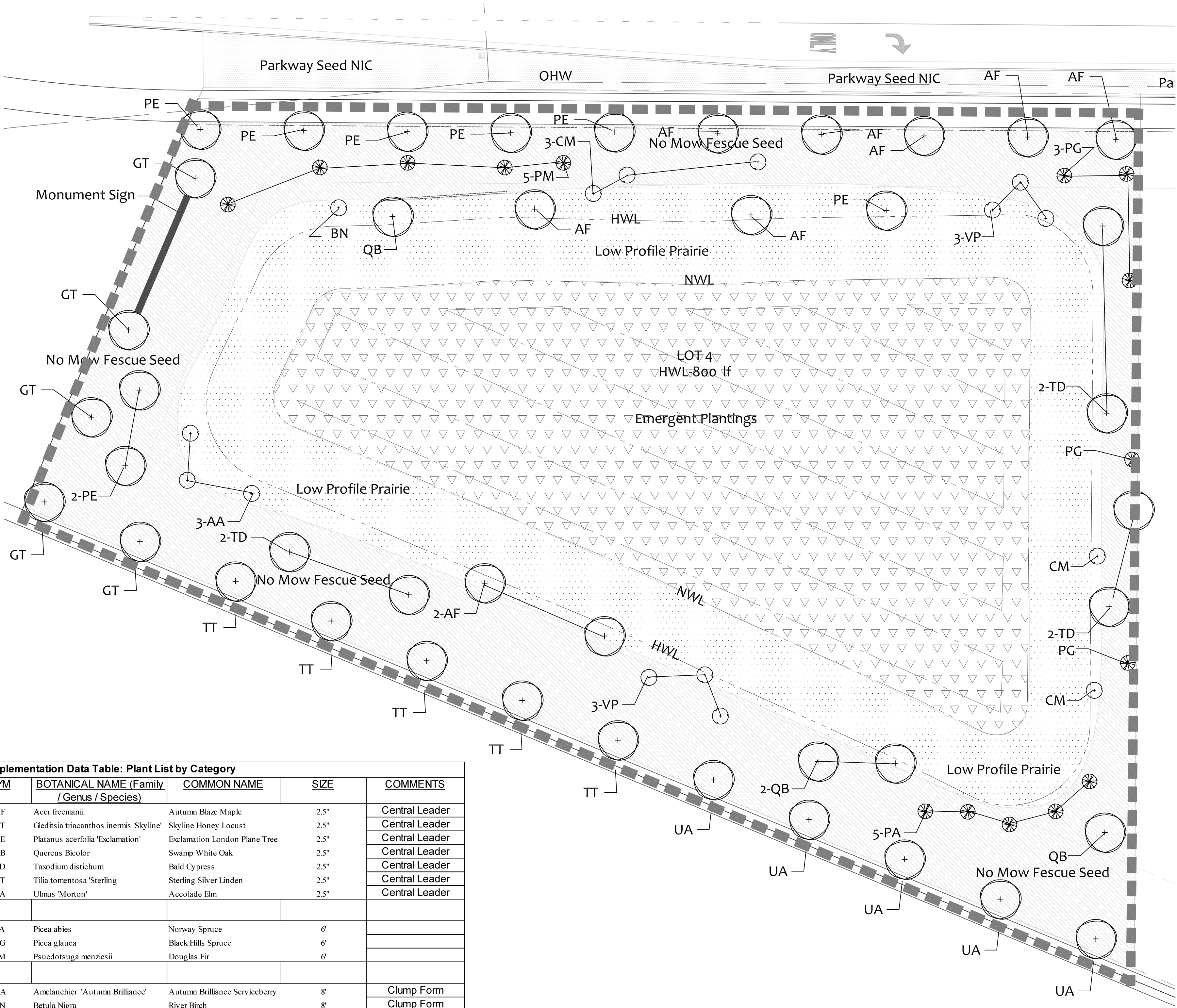

Melody Town Center Lot 4 Detail



3200 WEST MARKET ST.
FAIRLAWN, OHIO 44333
P: 330.636.9871
F: 330.636.4391

157-000349
REGISTERED
LANDSCAPE
ARCHITECT
ILLINOIS

Karl T. Krogstad
Illinois Registered Landscape Architect
License No. 157.000349 - Expires 08/31/2021

KROGSTAD
LAND DESIGN LIMITED
LANDSCAPE ARCHITECTURE * CONSULTING
519 PEMBROOK CT. N., CRYSTAL LAKE, IL 60044
815.239.1511
KROGSTAD@LANDDESIGNLIMITED.COM

**LANDSCAPE PLAN FOR LOTS 2-4
OF MELODY TOWN CENTER
AURORA, ILLINOIS**

PROJECT # HEL1723

Date: 11/18/20

REVISIONS:

Rev:	12/17/20
Rev:	2/18/21
Rev:	3/23/21

DRAWN KTK

CHECKED KTK

SHEET NO.

4 of 5

LANDSCAPE WORK

PART 1 - GENERAL

1.01 SUMMARY

A.Landscape work includes the following:

1. Lawns
2. Trees
3. Planting soil mixture
4. Fertilizer
5. Trunk wrap
6. Stakes and guys
7. Mulch

1.02 SUBMITTALS

A.Planting schedule

Submit two (2) copies of the proposed planting schedule to client and Landscape Architect showing dates for each type of planting.

Data substantiating that trees and shrubs comply with specified requirements.

B.Material test reports from a qualified independent testing agency indicating and interpreting test results for the following materials.

1. Analysis of existing topsoil
2. Analysis of imported soil

Submittal should include recommendations for soil additive requirement for Landscape Architect's review.

H.Provide shredded hardwood mulch sample to Landscape Architect.

I. Qualification data for firms and individuals dedicated to the job, to demonstrate their capabilities and experience. Include list of completed projects, with project and owner's names and addresses, and other pertinent information.

J. Maintenance instructions recommending procedures to be established by the owner to maintain the landscaping during the entire year. Submit two (2) copies before expiration of required maintenance period. Instructions shall include: watering, fertilizing, spraying, mulching, pruning and trimming for plant material, groundcovers and perennials. Instructions for watering, fertilizing, and mowing turf areas shall be provided.

1.03 QUALITY ASSURANCE

A.Installing contractor to have a minimum of 5 years experience on comparable projects.

B.Installing Contractor to maintain an experienced full time supervisor on the project site during times that landscape installation is in progress.

C.Landscape Contractor to conduct a pre-construction meeting with owner's representative and Landscape Architect prior to commencement of construction.

D.Substitution will not be permitted without approval of the Landscape Architect and governing municipality.

1.04 DELIVERY, STORAGE, AND HANDLING

A.Packaged materials: Deliver packaged materials in containers showing weight, analysis, and name of manufacturer. Protect materials from moisture and deterioration during delivery and while stored at site.

B.Trees: Deliver freshly dug trees directly to jobsite. Do not prune before delivery. Protect bark, branches, and root systems from sun scald, drying, whipping and other handling and tying damage. Do not bond or tie plant material in such a manner as to destroy the natural shape. Provide protective covering during transport and delivery.

C.Handle balled and bur lapped stock by the root ball. Handle container stock by the container.

D.Deliver plant material after planting preparations have been completed, and install immediately. If planting is delayed more than 8 hours, after delivery, set plant material in shade, protect from weather and mechanical damages, and keep roots moist.

1. Set balled and bur lapped stock on ground and cover ball with soil, peat moss or shredded hardwood mulch.
2. Do not remove container-grown stock from containers before time of planting.

1.05 PROJECT CONDITIONS

A.Examine and evaluate entire site including grades, soils; water level, and existence of debris. Observe the conditions under which work is to be performed and notify Landscape Architect immediately of any unsatisfactory conditions. Do not proceed with work until all unsatisfactory conditions have been addressed in an acceptable manner.

B.Utilities: Prior to commencement of work, review all underground utility location plans, notify local utility location service to clearly mark all underground utilities. Determine the location of all above grade and overhead utilities and perform work in a manner that will avoid damage. Provide plan for protection of utilities, including hand excavation, as necessary.

Contractor shall be responsible for any damage to utilities or property.

C.Excavation: When conditions detrimental to plant growth are encountered, including but not limited to rubble fill, adverse drainage conditions, or obstructions, notify Landscape Architect prior to planting.

1.06 COORDINATION AND SCHEDULING

A.Coordinate installation of planting materials during industry accepted planting seasons for each type of plant or seed specified.

B.Coordinate with other trades performing work on site to minimize potential conflicts and prevent damage to plant materials.

C.Contractors shall secure all plants and materials for landscaping immediately after being awarded contract to ensure availability.

1.07 WARRANTY

A.Warrant the following plant materials for a period of one year after date of final acceptance, against defects including death, unsatisfactory growth, except for defects resulting from lack of adequate maintenance, neglect by owner, abuse, vandalism or inadvertent damage by others, or unusual phenomena including abnormal weather conditions or incidents during the warranty period that are beyond the Landscape Contractor's control:

1. Trees

B.Remove and replace dead plant material immediately. If replacement is delayed to the next planting season, the dead plant material shall be removed immediately.

C.Replace plant materials that are partially dead, in unhealthy condition or where shape and symmetry have been affected at the end of the warranty period. Final determination of material requiring replacement shall be made by the Landscape Architect.

D.Replace plant material shall be of the same kind, size, and quality as those originally planted, unless otherwise approved in writing by Landscape Architect. Replacement plants shall carry the same establishment period as the original.

E. A limit of one replacement of each plant will be required, except for losses or replacements due to failure to comply with requirements.

F.Final acceptance will be made only if all plants are in place, in satisfactory conditions and in conformance with the drawing, as determined by Landscape Architect.

1.08 TREE & LAWN MAINTENANCE

A.Maintenance agreement: The landscape contractor shall provide maintenance for a period of 90 days from the date of acceptance or substantial completion as determined by Landscape Architect.

B.Maintain trees by pruning, cultivating, watering, weeding, fertilizing, restoring planting saucers and bed lines, tightening and repairing stakes, and guy supports, resetting to proper grades or vertical position, as required to establish healthy, viable plantings. Apply insecticides and herbicides as required to keep trees and shrubs free of insects and disease. Restore or replace damaged tree wrappings. Maintain trees, and lawns until final acceptance by the Landscape Architect. Supply adequate water for all plant material within the warranty period after the final acceptance.

C.Maintain and establish lawns by watering, fertilizing, weeding, mowing, and trimming as necessary. Roll re-grade, and replant bare or eroded areas and re-mulch to produce a uniformly smooth lawn.

D.Mow lawn a soon as top growth reaches no more than 40% of 2" mowing height. Repeat subsequent mowing as required to maintain height without cutting more than 40% of the grass of the grass-leaf growth. Do not delay mowing until grass blades bend over and become matted. Do not mow when grass is wet.

1.09 FINAL INSPECTION & ACCEPTANCE

A.Final acceptance, which marks the beginning of the warranty and maintenance period, will be made by the Landscape Architect upon a written request by the Landscape Contractor after all plants are in place per specifications. The request for inspection shall be submitted to the Landscape Architect at least ten (10) days prior to the inspection date.

B.The Contractor will be notified in the form of a written punch list, any deficiencies to be fulfilled in order to receive the final acceptance. All outstanding items shall be subject to re-inspection before final acceptance is issued.

C.Upon contractor completion of punch list, Landscape Architect shall re-inspect all work to determine completion. The contractor and owner will be notified in writing of final acceptance, and commencement of one year warranty period.

D.Upon completion of one year warranty period, contractor shall submit request for one year warranty inspection to Landscape Architect at least ten (10) days prior to inspection date.

E.The Contractor shall be notified in the form of a written punch list any deficiencies based on section 1.08. All outstanding items shall be subject to re-inspection before final warranty acceptance is issued.

F.Upon contractor completion of warranty punch list, Landscape Architect shall re-inspect all work to determine compliance. The Contractor and owner will be notified in writing of final warranty inspection.

PART 2 - MATERIALS

2.01 MATERIALS

Grass seed: Provide fresh, clean, new crop seed complying with the Association of Official Seed Analysts of North America "Rules for Testing" for purity and germination tolerances. Provide seed of grass species and varieties proportions by weight, and minimum percentages of purity, germination, and maximum percentages of weed seed:

No-mow fescue blend seed Mixture.

2.04 TREES

A.Name and Variety: Provide nursery grown plant material true to name and variety per sheets 1 & 2.

B.General: Provide plant material complying with the recommendations and requirements of ANSI Z60.1 "Standard for Nursery Stock" with healthy root systems, developed by transplanting or root pruning. Provide well shaped, fully branched, healthy, vigorous stock free of disease, insects, eggs, larvae, and defects such as knots, sunscald, injuries, abrasion, and disfigurement.

C.Deciduous Shade Trees: Provide trees of caliper and quantity listed on sheets 1& 2 with branching configuration recommended by ANSI Z60.1 for type and species required. Provide single stem trees with straight trunk, well-balanced crown, and intact leader. Provide balled and burlapped (B&B) deciduous trees.

D.Deciduous Ornamental Trees: provide trees of height or caliper and quantity listed on sheets 1 & 2, branched or pruned naturally according to species and type, conforming to ANSI Z60.1.

E.Inspection: All plants shall be subject to inspection and review at the place of growth, upon delivery or after installation. Plants shall be inspected as to conformity to specification requirements and quality. Landscape Architect has the right to reject plant material at time of inspection due to non-compliance to ANSI Z60.1 size and condition of root balls, diseases, insects and latent defects or injuries. Landscape Architect reserves the right to remove tree wrap or soil backfill for any installed plantings, as a part of the inspection process. Rejected plants shall be removed immediately from the site.

2.05 SOIL

A.Existing Soil: Revise pulverized surface soil stockpiled on the site. Verify suitability, of topsoil, free of stones 1" or larger in any dimension, and other extraneous materials harmful to plant growth, to produce topsoil meeting requirements and amend when necessary. Supplement with imported topsoil when quantities are insufficient. Clean topsoil of roots, plants, sods, stones, clay lumps and other extraneous materials harmful to plant growth.

B.Imported Topsoil: Import topsoil from off-site sources that meets the criteria established for existing topsoil. Obtain topsoil from naturally well-drained sites where topsoil occurs at least 4" deep.

C.Planting Soil Mixtures: Provide planting soil mixture consisting of three (3) parts friable topsoil (stockpiled at site) and one part mushroom compost (1) for all planting pits, perennial, annual, and groundcover areas.

2.06 FERTILIZER

A.Slow Release Fertilizer: Granular fertilizer consisting of 50% water-insoluble nitrogen, phosphorus, and potassium in composition and amounts recommended in soil reports from a qualified soil-testing agency.

2.08 TREE WRAP

A.Standard waterproofed tree wrapping paper, 2 ½ inches wide, made of two (2) layers of crepe kraft paper, weighing not less than 30 pounds per ream (Fall planting only).

2.09 MULCH

A.Organic mulch, free from deleterious materials and suitable as a top dressing of trees and shrubs, consisting of shredded hardwood mulch. Provide sample to Landscape Architect for approval.

2.10 STAKES & GUYS

A.Upright and Guys Stakes: Rough-sawn, sound, new hardwood, free of knots, holes, cross grain, and other defects, 2 by 2 inches by length indicated on landscape details, pointed on one end.

B.Guy and Tie Wire: ASTM A 641 Class 1, Galvanized-steel wire, 2-strand, twisted 0.106 inches in diameters.

C.Guy Cable: 5-strand, 3/16 inches diameter, galvanized-steel cable, with zinc-coated turn buckles, 3 inches long minimum, with two (2) 3/8 inches galvanized eyebolts.

D.Hose Chafing Guard: Reinforced rubber on plastic hose at least ½ inches in diameter, cut in lengths required to protect tree trunk, from damage.

PART 3 - EXECUTION

3.01 PLANTING SCHEDULE

A.At least thirty (30) days prior to commencement of work for each area or phase, Landscape Contractor shall submit a planting schedule for approval by the Landscape Architect.

3.02 EXAMINATION

A.Landscape Contractor shall examine all areas to receive landscaping for compliance with requirements and for conditions affecting performance of work. Notify owner and Landscape Architect of unsatisfactory conditions. Do not proceed with installation until unsatisfactory conditions have been corrected.

3.03 PREPARATION

A.Lay out individual tree locations. Stake locations, outline areas and secure Landscape Architect's acceptance before the start of planting work. Adjust as required. Any planting completed without prior approval may be subject to alteration in field by Landscape Architect.

3.04 PLANTING SOIL PREPARATION

A.Before mixing, remove all roots, vegetation, turf, stones, clay lumps, and other extraneous materials harmful to plant growth.

B.Mix soil Amendments and fertilizers as determined with topsoil, based on material test reports.

3.05 GENERAL LAWN PLANTING PREPARATIONS

A.General: Limit subgrade preparation to areas that will be planted within five (5) days.

B.Remove existing grasses, vegetation, and turf.

C.Loosen subgrade to a minimum depth of two (2) inches. Remove stones larger than one (1) inch in any dimensions, sticks, roots, rubbish, and other extraneous materials.

D.Dispose of all removed material legally off-site; do not turn over into soil being prepared for lawns, or other areas on site.

E.Spread topsoil mixture to depth required to meet thickness, grades, and elevations shown, after light rolling and natural settlement. Do not spread if planting soil or subgrade is frozen.

F. Respread approximately ½ the depth of topsoil mixture required, work into top of loosened subgrade to create a transition layer. Upon completion, respread remainder of topsoil mixture.

G.Preparation of unchanged grades: Where lawns are to be planted in areas unaltered or undisturbed by excavating, grading, or surface soil stripping operations, prepare soil as follows:

1. Remove and dispose legally off-site existing grass, vegetation, and turf. Do not turn over into soil being prepared for lawns, plant beds or native seeding.
2. Till surface soil to a depth of at least 2 inches. Apply required soil amendments and mix thoroughly into top 2 inches of soil. Trim high areas and fill in depressions. Till soil to a homogenous mixture of fine texture.
3. Clean surface soil of roots, vegetation, grass, stones over 1 inch in any dimension, clay lumps and other extraneous materials harmful to plant growth. Dispose of legally off-site.

H.Grade lawn areas to a smooth, even surface with loose, uniformly fine texture. Roll and rake, remove ridges, and fill depressions to meet finish grades. Limit fine grading to areas that can be planted within 5 days. Remove trash, debris, stones larger than 1 inch in any dimension, and other objects that may interfere with planting or maintenance operations.

I.Moisten prepared lawn areas before planting when soil is dry. Water evenly and allow surface to dry before installation. Do not allow water to pond or create muddy soil.

J. Restore prepared areas if eroded or otherwise distributed after fine grading and before installation.

3.08 SEEDED LAWN

A.Seeded lawn areas shall receive an application of commercial fertilizer 6-24-24 at the rate of 5 pounds per 1,000 sq. ft. Fertilizer shall be uniformly spread and mixed into soil to a depth of 1 inch.

B.Do not use wet seed or seed which is moldy or otherwise damaged.

C.Sow seed using a spreader or seeding machine. Do not apply seed when wind velocity exceeds five (5) miles per hour. Distribute seed evenly over entire designated area by sowing an equal quantity in two directions at right angles to each other.

D.Do not sow less than the specified rate.

E.Rake lawn seed lightly into top 1 inch of soil, roll lightly and water with a fine spray.

F.After the seeding operation is completed, spray recycled fiber mulch (Lebanon PennMulch or equal as approved by Landscape Architect) over the entire seeded area, unless otherwise specified, at the rate of 2000 pounds per acre. Use a mechanical spray unit to insure uniform coverage. Exercise care to protect buildings, automobiles, paving, amenities, etc. during the application of the mulch.

G.For slopes greater than 3:1, or in areas indicated on Landscape Plans. Install erosion control blanket per manufacturer's specifications.

3.09 GENERAL NATIVE SEED PREPARATIONS

A.Remove existing grass, vegetation and turf, dispose of material legally off-site. Do not turn over into soil being prepared for lawns, plant beds, or native seeding.

B.Till to a depth of not less than 3 inches, apply soil amendments, remove high areas, and fill in depressions; till soil to a homogenous mixture of fine texture. Remove clumps, clods, and stones over 2 inches in diameter, roots and other extraneous matter. Dispose of legally off-site.

C.Do not fertilize Native Seed areas.

D.For areas receiving Emergent, Sedge or Prairie mix, mark area with survey flags. Do not mow Emergent, Sedge or Prairie.

3.14 EXCAVATION FOR TREES

A.Trees And Shrub Pits: Exchange with vertical sides and bottom of excavation slightly raised at center to assist drainage.

Loosen hard subsoil or existing subgrade in bottom of tree pit.

1. Balled And Burlapped Trees: Excavate approximately 2 times as wide as ball diameter and 1 inch less than ball depth. Cultivate soil around tree pits to a depth of 18 inches and diameter of 8 inches and incorporate 25% mushroom compost into existing soil to promote root growth.

B.Obstructions: Notify Landscape Architect if unexpected rock or obstructions detrimental to trees or shrubs are encountered in excavation.

C.Drainage: Notify Landscape Architect if subsoil conditions evidence or unexpected water seepage or retention in tree or shrub pits.

D.Fill excavations with water and allow to percolate out before placing, setting layer, and positioning trees and shrubs.

3.15 PLANTING TREES

A.Set balled and burlapped plant material plumb and in center of pit or trench with top of ball raised 1 inch above adjacent finished grades. Remove burlap and wire baskets from tops of ball, and partially from sides, but do not remove from under balls. Do not use plant material if ball is cracked, or broken before or during planting operation.

B.Set container-grown shrubs plumb and in center of pit with top of ball raised 1 inch above adjacent finished grade. Carefully remove containers so as not to damage root balls. Place shrub on setting layer of compacted planting soil.

C.Place backfill around root ball in layers, tamping to settle backfill and eliminate voids and air pockets. When pit is approximately ½ backfilled, water thoroughly before placing remainder of backfill. Repeat watering until no more is absorbed. Water again after placing and tamping final layer of backfill.

D.Dish and tamp top of backfill to form a 3 inch high mound around rim of pit. Do not cover top of root ball with backfill.

E.Cut a 3 inch deep spaded trench around all individual tree pits, or around plant beds.

F.Mulch tree rings and plant beds. Spread mulch evenly at a depth of 3 inches. Cover root balls and match finish level with adjacent finish grades. Remove any bark pieces in excess of 6 inches, and dispose of legally off-site.

G.Prune, thin and shape trees and shrubs according to standard horticultural practice. Prune trees to retain required height and spread unless otherwise directed by Landscape Architect. Do not cut leaders; remove only injured or dead branches from flowering trees. Prune shrubs to retain natural character. Remove and replace excessively pruned or ill-formed stock resulting from improper pruning.

3.16 TREE GUYING AND STAKING

A.The Landscape Contractor shall be wholly responsible for assuring that all trees are planted in vertical and plumb position and remain so throughout the life of the contract and warranty period. Trees may or may not be staked and guyed depending upon the individual preference of the Contractor, except where specified by the Landscape Architect.

B.Upright Staking and Tying: Use a minimum of 2 stakes of length required to penetrate at least 18 inches below bottom of backfilled excavation and to extend at least 54 inches above grade. Set stakes vertical and space to avoid penetrating root balls or masses. Support trees with strands of the wire encased in hose sections at contact points with tree trunks. Allow enough slack to avoid rigid restraint of tree. Remove stakes and guys when trees are able to stand on their own.

C.Guying and Staking: Guy and Stake trees exceeding 14 feet and more than 3 inch caliper unless otherwise indicated. Securely attach no fewer than 3 guys to stakes 30 inches long, driven to grade.

3.17 CLEANUP AND PROTECTION

A.During landscape work, store materials and equipment where directed. Keep pavements clean and work areas and adjoining areas in an orderly condition.

B.Protect landscape work and materials from damage due to landscape operations, operations by other contractors and trades, and trespassers. Maintain protection during installation, maintenance and warranty period. Treat, repair or replace damaged landscape work as directed by Landscape Architect.

Temporary Cover Crop:

Cover crops shall be installed in all planting areas containing dry mesic, mesic, and wet mesic soils to, stabilize soils, and combat weed pressure during the germination and establishment of the native seedling area.

For spring plantings use Seed Oats at the specified rate below:

Botanical Name	Common Name	Lbs /AC
Avena sativa	Seed Oats	30.0 lbs

For fall or dormant plantings, use Regreen at the specified rates below:

Botanical Name	Common Name	Lbs /AC
Trisetum aestivum	Regreen	10.0 lbs

Emergent Plantings

Botanical Name	Common Name	Lbs /AC	Plugs /AC
Acorus calamus	Sweet Flag	0.500	272
Alisma subcordatum	Water Plantain	1.250	
Eleocharis obtusa	Blunt Spike Rush	0.375	
Eleocharis palustris	Marsh Spike Rush	0.375	
Glyceria grandis	Reed Manna Grass	0.375	
Hibiscus laevis	Rose Mallow	0.250	
Iris virginica shrevei	Blue Flag	0.500	272
Juncus effusus	Common Rush	0.500	
Leersia Oryzoides	Rice Cut Grass	1.250	272
Pontederia Cordata	Pickereelweed	0.250	272
Sagittaria latifolia	Common Arrowhead	1.250	272
Serpurus acutus	Hardstem Bulrush	0.250	544
Serpurus pinnatus	Chairmakers Rush	0.250	
Serpurus validus	Great Bulrush	0.250	544
Sparganium eurycarpum	Bar Reed	1.000	544
Total Emergent Plantings		8.125	2992

Note: If emergent zone is permanently flooded seeding will be impossible and live plugs shall be installed at the specified rate. Plugs are specified at a standard 38 cell flat and shall measure 2.25" x 5" with a volume of 11.30 inches. Substitution of plug size must be approved by the Landscape Architect prior to installation.

Low Profile Prairie

Botanical Name	Common Name	oz /AC
Andropogon scoparius	Little Bluestem grass	60
Bouteloua curtipendula	Side-Oats Grama	60
Elymus virginicus	Virginia Wild Rye	30
Panicum virgatum	Switch Grass	20
Sporobolus heterolepis	Prairie Dropseed	12
Total Low Profile Prairie		182

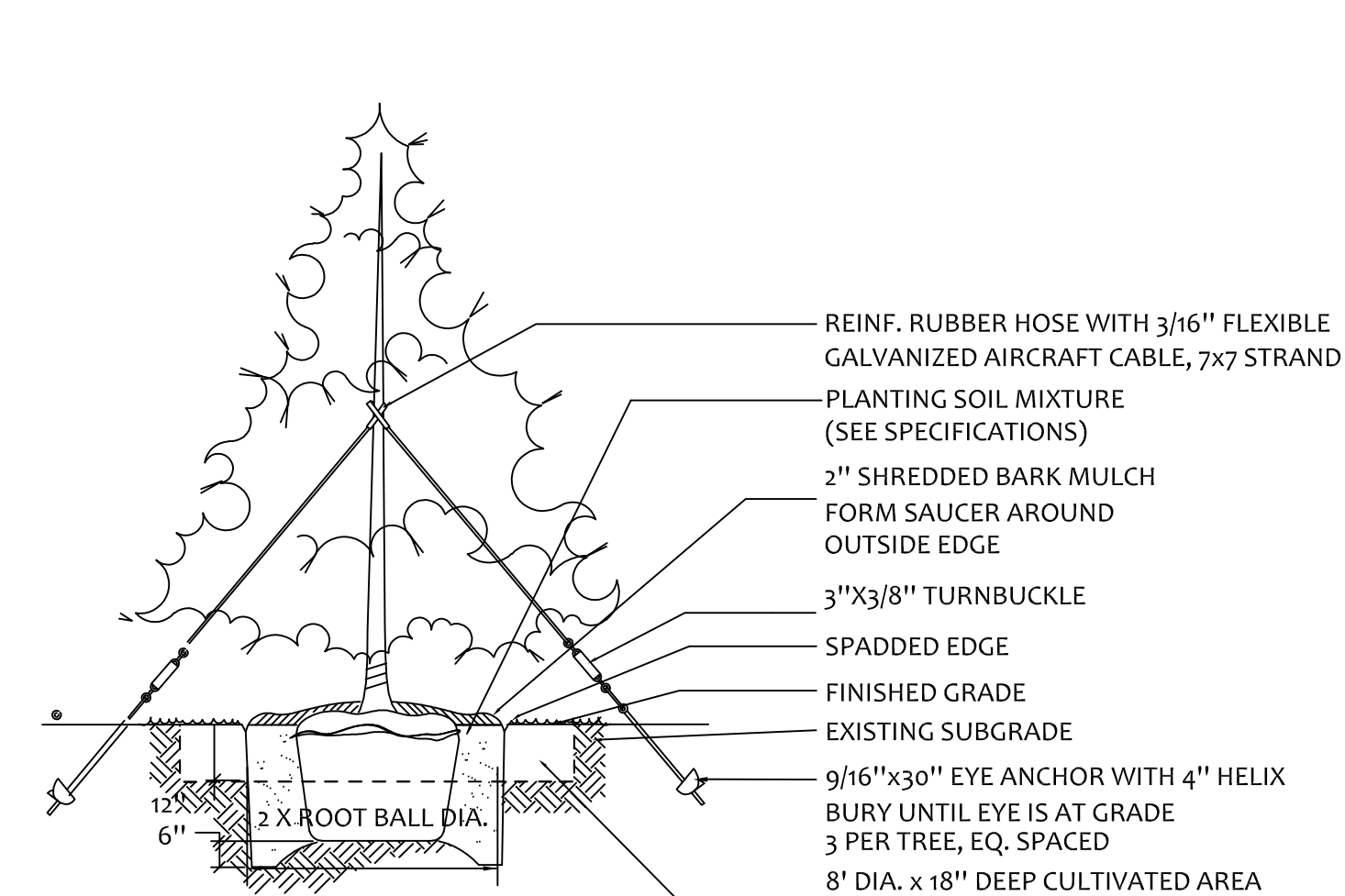

EVERGREEN TREES
N.T.S.

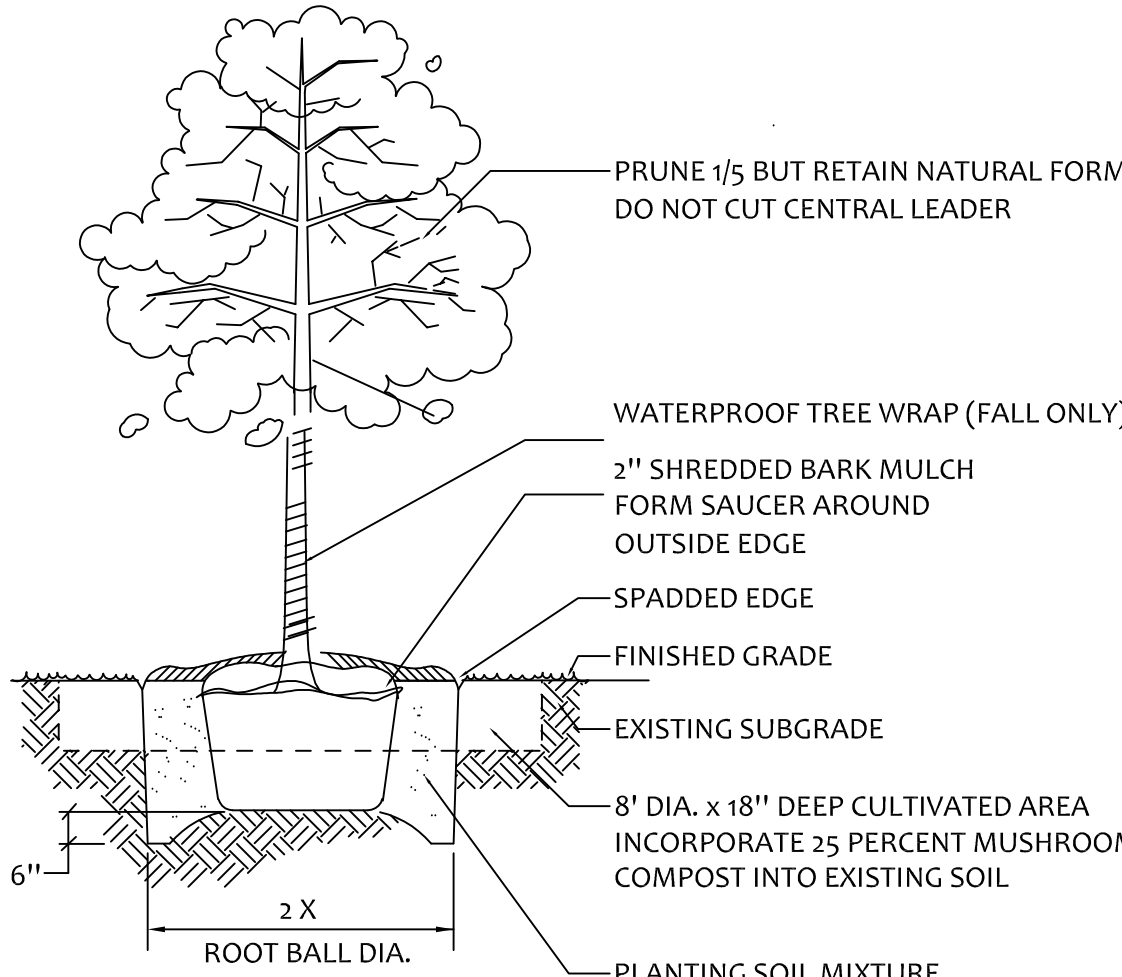

DECIDUOUS TREES
N.T.S.

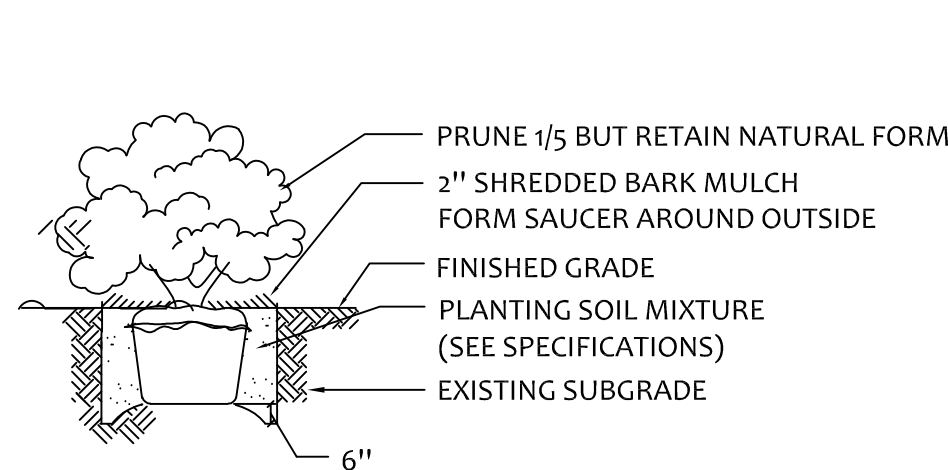

DECIDUOUS AND EVERGREEN SHRUBS
N.T.S.

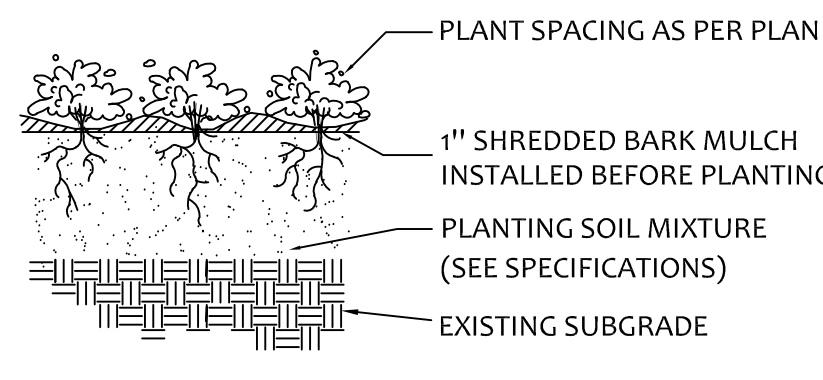

PERENNIALS AND GROUNDCOVERS
N.T.S.

LANDSCAPE PLAN FOR LOTS 2-4
OF MELODY TOWN CENTER
AURORA, ILLINOIS

PROJECT # HEL1723

Date: 11/18/20

REVISIONS:

Rev: 12/17/20

Rev: 2/18/21

Rev: 3/23/21

DRAWN KTK

CHECKED KTK

SHEET NO.