

Drawing name: K:\GIS\DEV\268485001_CyrusOne_Aurora_IL\2 Design\CAD\PlanSheets\Preliminary Engineering\L1.0 Landscape Plan.dwg L1.0 LANDSCAPE PLAN Apr 30, 2024 10:31am by Kyle OSullivan
 This document, together with the concepts and designs presented herein, is intended only for the specific purpose and client for which it was prepared. Reuse of and improper reliance on this document without written authorization and adaptation by Kimley-Horn and Associates, Inc. shall be without liability to Kimley-Horn and Associates, Inc.

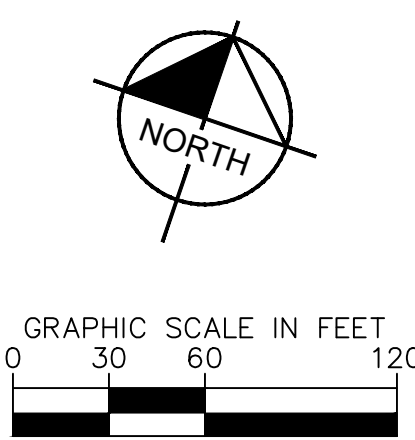
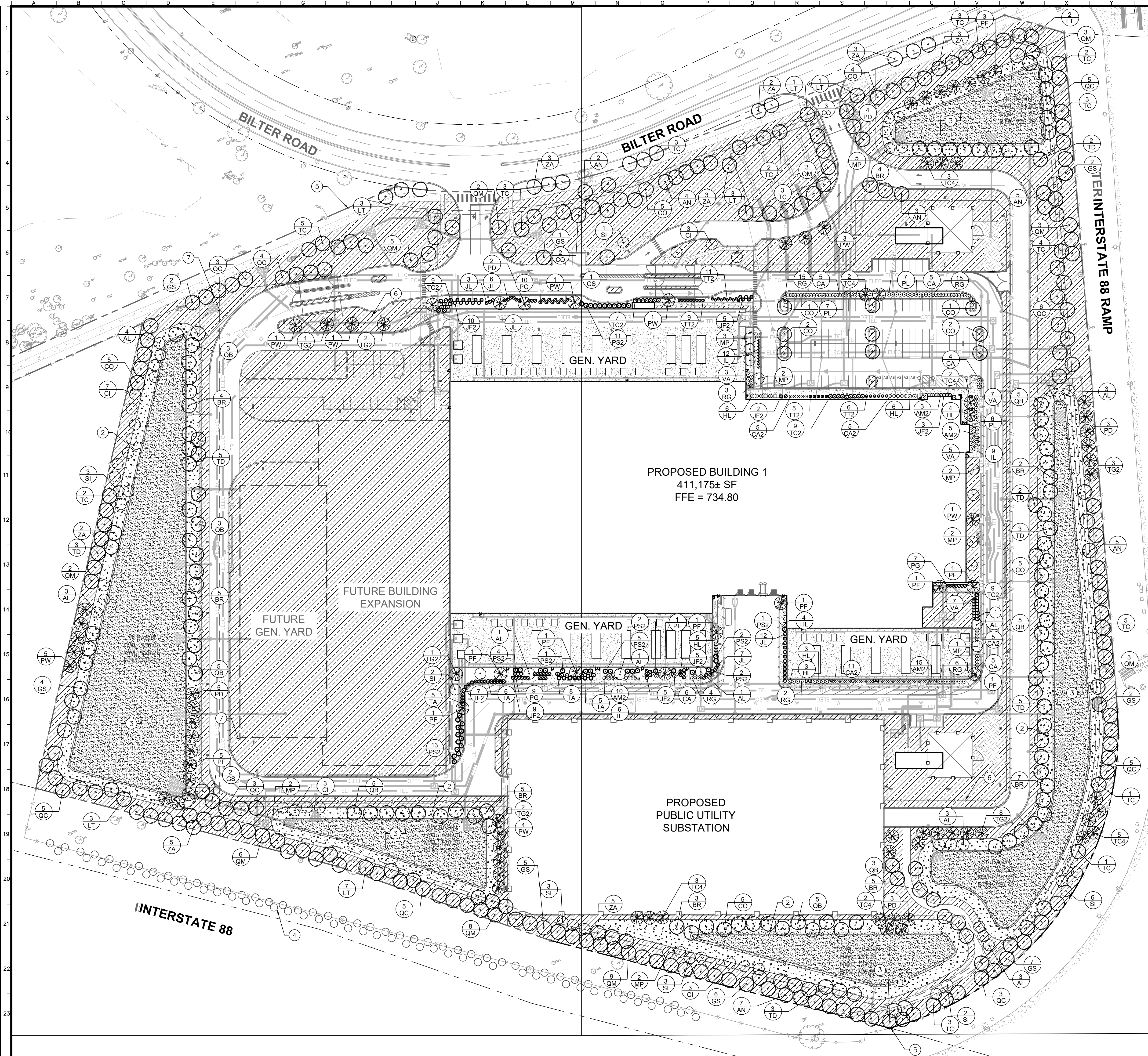

Call Before You Dig
1-800-892-0123

SEE SHEET L2.0 FOR LANDSCAPE NOTES & DETAILS
 SEE SHEET L2.1 FOR LANDSCAPE SCHEDULES CODE INFORMATION

Landscape Data Table: CTEs Provided			
	CTE Value	Count Provided	Total CTEs Provided
Canopy Trees	1	368	368
Evergreen Trees	1/3	85	28
Understory Trees	1/3	75	25
Deciduous Shrubs	1/20	229	11
Evergreen Shrubs	1/20	234	12
Total:		991	444

- ### LANDSCAPE KEYNOTES
- 1 SHOVEL CUT BED EDGE, TYP.
 - 2 WET TO MESIC PRAIRIE SEED MIX
 - 3 BASIN BOTTOM PLUG MIX
 - 4 EXISTING LANDSCAPE VEGETATION, PROTECT IN PLACE, TYP.
 - 5 PROPERTY LINE, TYP.
 - 6 FENCE, SEE SITE PLAN, TYP.
 - 7 TURF SEED UP TO LIMITS OF DISTURBANCE, TYP.

<p style="writing-mode: vertical-rl; transform: rotate(180deg);"> Kimley»Horn <small>© 2024 KIMLEY-HORN AND ASSOCIATES, INC. 4201 WINFIELD ROAD, SUITE 600 AURORA, IL 60504 PHONE: 630-487-5550 WWW.KIMLEY-HORN.COM</small> </p>	<p style="writing-mode: vertical-rl; transform: rotate(180deg);"> <small>SCALE:</small> AS NOTED <small>DESIGNED BY:</small> HL <small>DRAWN BY:</small> HL <small>CHECKED BY:</small> CW </p>	<p style="writing-mode: vertical-rl; transform: rotate(180deg);"> CyrusOne </p>	<p style="writing-mode: vertical-rl; transform: rotate(180deg);"> LANDSCAPE PLAN </p>	<p style="writing-mode: vertical-rl; transform: rotate(180deg);"> CYRUSONE AURORA <small>2725 BILTER RD AURORA, IL 60502</small> </p>	<p style="writing-mode: vertical-rl; transform: rotate(180deg);"> <small>ORIGINAL ISSUE:</small> 02/23/2024 <small>KHA PROJECT NO.</small> 268485001 <small>SHEET NUMBER</small> L1.0 </p>	<p style="writing-mode: vertical-rl; transform: rotate(180deg);"> <small>PER CITY COMMENTS</small> 04/30/24 <small>DATE</small> TTS <small>BY</small> </p>
--	--	--	--	--	--	--

GENERAL LANDSCAPE NOTES

1. THE LANDSCAPE CONTRACTOR SHALL BE RESPONSIBLE FOR INSTALLING MATERIALS AND PLANTS SHOWN ON THE LANDSCAPE PLAN. THE CONTRACTOR IS RESPONSIBLE FOR THE COST TO REPAIR UTILITIES, ADJACENT LANDSCAPE, PUBLIC AND PRIVATE PROPERTY THAT IS DAMAGED BY THE CONTRACTOR OR THEIR SUBCONTRACTOR'S OPERATIONS DURING INSTALLATION OR DURING THE SPECIFIED MAINTENANCE PERIOD. CALL FOR UTILITY LOCATIONS PRIOR TO ANY EXCAVATION.
2. THE CONTRACTOR SHALL REPORT ANY DISCREPANCY IN PLAN VS. FIELD CONDITIONS IMMEDIATELY TO THE LANDSCAPE ARCHITECT, PRIOR TO CONTINUING WITH THAT PORTION OF WORK.
3. NO PLANTING WILL BE INSTALLED UNTIL ALL GRADING AND CONSTRUCTION HAS BEEN COMPLETED IN THE IMMEDIATE AREA.
4. THE CONTRACTOR SHALL BE RESPONSIBLE FOR THE REPAIR OF ANY OF THEIR TRENCHES OR EXCAVATIONS THAT SETTLE.
5. ALL PLANTS TO BE SPECIMEN GRADE, WELL BRANCHED, HEALTHY, FULL, PRE-INOCULATED AND FERTILIZED. PLANTS SHALL BE FREE FROM DISEASE, PESTS, WOUNDS, AND SCARS. PLANTS SHALL BE FREE FROM NOTICEABLE GAPS, HOLES, OR DEFORMITIES. PLANTS SHALL BE FREE FROM BROKEN OR DEAD BRANCHES. TRUNKS WILL BE WRAPPED IF NECESSARY TO PREVENT SUN SCALD AND INSECT DAMAGE. THE LANDSCAPE CONTRACTOR SHALL REMOVE THE WRAP AT THE PROPER TIME AS PART OF THIS CONTRACT.
6. THE OWNER'S REPRESENTATIVE MAY REJECT ANY PLANT MATERIALS THAT ARE DISEASED, DEFORMED, OR OTHERWISE NOT EXHIBITING SUPERIOR QUALITY.
7. ALL NURSERY STOCK SHALL BE GUARANTEED, BY THE CONTRACTOR, FOR ONE YEAR FROM DATE OF FINAL INSPECTION. THE GUARANTEE BEGINS ON THE DATE OF THE LANDSCAPE ARCHITECT'S OR OWNERS WRITTEN ACCEPTANCE OF THE INITIAL PLANTING. REPLACEMENT PLANT MATERIAL SHALL HAVE A ONE YEAR GUARANTEE COMMENCING UPON PLANTING.
8. PLANTS TO MEET AMERICAN STANDARD FOR NURSERY STOCK (ANSI Z60.1-2014 OR MOST CURRENT VERSION) REQUIREMENTS FOR SIZE AND TYPE SPECIFIED.
9. PRUNE PLANTS AS NECESSARY- PER STANDARD NURSERY PRACTICE AND TO CORRECT POOR BRANCHING OF EXISTING AND PROPOSED TREES.
10. SEED LIMIT LINES ARE APPROXIMATE. CONTRACTOR SHALL SEED ALL AREAS WHICH ARE DISTURBED WITH THE SPECIFIED SEED MIXES.
11. CONTRACTOR SHALL INSTALL SHREDDED HARDWOOD MULCH AT A 3" DEPTH TO ALL TREES AND SHRUB.
12. INSTALLATION OF TREES WITHIN PARKWAYS SHALL BE COORDINATED IN THE FIELD WITH LOCATIONS OF UNDERGROUND UTILITIES. TREES SHALL NOT BE LOCATED CLOSER THAN 5' FROM UNDERGROUND UTILITY LINES AND NO CLOSER THAN 10' FROM UTILITY STRUCTURES.
13. DO NOT DISTURB THE EXISTING PAVING, LIGHTING, OR LANDSCAPING THAT EXISTS ADJACENT TO THE SITE UNLESS OTHERWISE NOTED ON PLAN.
14. PLANT QUANTITIES SHOWN ARE FOR THE CONVENIENCE OF THE OWNER AND JURISDICTIONAL REVIEW AGENCIES. THE CONTRACTOR IS RESPONSIBLE FOR VERIFYING ALL PLANT QUANTITIES AS DRAWN.
15. THE CONTINUED MAINTENANCE OF ALL REQUIRED LANDSCAPING SHALL BE THE RESPONSIBILITY OF THE OWNER OF THE PROPERTY ON WHICH SAID MATERIALS ARE REQUIRED. ALL PLANT MATERIALS REQUIRED BY THIS SECTION SHALL BE MAINTAINED AS LIVING VEGETATION AND SHALL BE PROMPTLY REPLACED IF THE PLANT MATERIAL HAS DIED PRIOR TO FINAL ACCEPTANCE.
16. SPOT HERBICIDE TREATMENT SHOULD ONLY BE USED IN AREAS OF LIVESTOCK GRAZING AS A LAST RESORT TO CONTROL WEEDS AND SHOULD BE APPLIED IN A VERY CONCENTRATED LOCATION AT THE BASE OF WEEDS. NO GENERAL SPAY OF HERBICIDES IS TO BE USED FOR ANY SEEDED AREAS.
17. ONLY HERBICIDES FORMULATED FOR PET AND ANIMAL SAFETY SHALL BE USED.
18. ALL PLANTS IMPORTED ACROSS ILLINOIS STATE LINES MAY BE SUBJECT TO CERTIFICATION AND INSPECTION PRIOR TO PLANTING.
19. ALL WORK DEEMED NATURAL AREA TO BE SEEDED OR PLANTED SHALL BE PERFORMED BY A QUALIFIED LANDSCAPE CONTRACTOR.
20. SEED LIMIT LINES ARE APPROXIMATE. THE CONTRACTOR SHALL SEED ALL AREAS WHICH ARE DISTURBED WITH THE SPECIFIED SEED MIXES.
21. SEED SHALL BE OBTAINED FROM SOURCES SPECIALIZING IN NATIVE SPECIES, WHEN AVAILABLE OR AS APPROVED BY CLIENT OR CLIENT'S REPRESENTATIVE.
22. ALL SEED MIXES SHALL BE INSTALLED WITH A COVER CROP DEPENDENT ON SEASON AND REQUIREMENTS SPECIFIED PER SEED MIX / SEED SUPPLIER.

SEED NOTES

1. INSTALL A MYCORRHIZAL INOCULANT WITH SEED MIX AT 40 LBS/ACRE
2. FOR SPRING PLANTING, INSTALL A COVER CROP OF SEED OATS (AVENA SATIVA) WITH SEED MIX AT 40 LBS/ACRE
3. FOR FALL PLANTING, INSTALL A COVER CROP OF REGREEN (A WINTER WHEAT X WHEATGRASS STERILE HYBRID) WITH SEED MIX AT 50 LBS/ACRE
4. AT NO TIME SHOULD ANNUAL OR PERENNIAL RYE (LOLIUM MULTIFLORUM OR PERENNE) BE UTILIZED AS A COVER CROP.
5. SEED IS TO BE INSTALLED ONLY WITHIN AREAS THAT ARE NOT INUNDATED WITH WATER AT THE TIME OF PLANTING. PLUGGING TO BE USED IN LIEU OF SEEDING IN AREAS WHERE SEEDING IS IMPOSSIBLE DUE TO HIGH WATER LEVELS AND PLUGS ARE TO SUPPLEMENT SEED AREAS AS NEEDED TO IMPROVE VEGETATIVE COVER.

ESTABLISHMENT NOTES AND STANDARDS

TREE / SHRUB ESTABLISHMENT

PREPARATION

HOLES DUG FOR TREES AND SHRUBS SHALL BE NO DEEPER THAN THE ROOTBALL OR CONTAINER, MEASURED TO THE TRUNK FLARE. DIAMETER OF HOLES SHALL BE TWICE THE DIAMETER OF THE ROOT BALL FOR TREES, AND AT MINIMUM 6 INCHES BEYOND THE DIAMETER OF CONTAINERS FOR SHRUBS.

INSTALLATION

INSTALL TREES AND SHRUBS SO THAT THE TRUNK FLARE IS AT A MAXIMUM 2 INCHES ABOVE GRADE, AND AT MINIMUM, AT GRADE. REMOVE CONTAINER AND REMOVE ANY BURLAP 6 INCHES FROM THE HEIGHT OF THE ROOT BALL, THEN BACKFILL TO FINISHED GRADE USING EXCAVATED SOIL FROM THE DUG HOLE.

SEED AREA ESTABLISHMENT

PREPARATION

SOIL PH IS TO BE TESTED PRIOR TO AMENDMENT AND FINAL GRADING. LIME OR SULFUR IS TO BE ADDED IN APPROPRIATE QUANTITY TO BRING PH TO ACCEPTABLE LEVELS FOR SEED APPLICATION AS NEEDED. IN AREAS OF SOIL AMENDMENT OR EXISTING AGRICULTURAL LAND, SOIL IS RECOMMENDED TO BE DISKED, CULTIVATED, AND PLANED / ROLLED AS NEEDED. SOILS SHALL BE UNIFORM, WITHOUT EXCESSIVE FURROWS, RUTS, OR RIDGES, AND LOW AREAS WHERE WATER MAY COLLECT. SOIL PREPARATION SHALL OCCUR WHEN WEATHER PERMITS AND TIMING ALLOWS FOR AT LEAST A FOLLOWING 48 HOURS WHERE SEEDING AND STABILIZATION METHODS MAY TAKE PLACE.

TIMING

IN ORDER TO MINIMIZE INITIAL USES OF BROAD APPLICATION HERBICIDE TREATMENT, AND PROMOTE EARLY AND STRONG ESTABLISHMENT OF SPECIFIED SEED MIXES WITH MINIMAL UNDESIRABLE WEED COMPETITION, DORMANT SEEDING SHOULD BE UTILIZED AS SITE CONDITIONS AND CONSTRUCTION TIMELINE PERMITS. IF ACTIVE SEASON SEEDING SHOULD BE REQUIRED, IT IS RECOMMENDED TO DO SO BETWEEN APRIL 1ST AND MAY 30TH, AFTER RISK OF MAJOR FREEZING CONDITIONS IS MINIMIZED. COVER CROPS MAY BE SEEDED AT ANY TIME IN THE EVENT THAT STABILIZATION IS REQUIRED OUTSIDE OF RECOMMENDED PLANTING TIMES. COVER CROPS MAY BE REQUIRED TO BE IRRIGATED IF APPLIED DURING WARM SEASONS AND IF ADEQUATE SOIL MOISTURE IS NOT PRESENT.

APPLICATION

SEED MIXTURES SHALL BE MECHANICALLY DRILLED, BROADCAST, OR HYDROSEEDED WITH STRAW MULCH PER SUPPLIER'S RECOMMENDATION (IF APPLICABLE). NO STRAW MULCH IS REQUIRED IF DRILL APPLIED, UNLESS NEEDED FOR STEEP SLOPES, SOIL STABILIZATION, OR OTHER AREAS THAT ARE IDENTIFIED FOR EROSION PREVENTION. SEED SHALL BE APPLIED AT INDICATED RATES WITH COVER CROP OATS, JAPANESE MILLET, WINTER PEA, OR ANNUAL RYE DEPENDENT ON SEASON AND SOIL CONDITIONS. SEED SPECIES SHALL BE LOCALLY SOURCED WHEN FEASIBLE. FINAL SEED MIX MAY VARY DEPENDENT UPON SPECIFIC SPECIES AVAILABILITY AND TIME OF INSTALLATION. FINAL SEED MIX SHALL BE APPROVED BY OWNER, OWNER'S REPRESENTATIVE, OR LANDSCAPE ARCHITECT. IF SEEDING IS PERFORMED PRIOR TO FINAL SITE INSTALLATION, ADDITIONAL SEED MAY BE APPLIED BY A LOW SPREADER IN AREAS THAT WERE DISTURBED. SITE SHOULD BE MONITORED FOLLOWING INSTALLATION FOR AREAS IDENTIFIED FOR ADDITIONAL RESEEDING UNTIL SEED MIX IS SUFFICIENTLY ESTABLISHED.

INVASIVE WEED CONTROL, MONITORING, AND MANAGEMENT

A WORK PLAN SHOULD BE DEVELOPED TO AVOID THE SPREAD OF INVASIVE PLANTS FROM THESE AREAS. IF SUBSTANTIAL AREAS OF INVASIVE HERBACEOUS SPECIES ARE FOUND PRIOR TO OR AFTER PROJECT DEVELOPMENT, FOLIAR OR BROADCAST HERBICIDE APPLICATIONS MAY BE REQUIRED. FOR INVASIVE TREES, SHRUBS, AND VINES, MANAGEMENT MAY REQUIRE CUT-STEM HERBICIDE TREATMENTS. ALL INVASIVE SPECIES MANAGEMENT SHOULD BE CONDUCTED DURING THE SUMMER MONTHS WHILE THE TARGET PLANTS ARE ACTIVELY GROWING. TREATMENTS SHOULD BE CONDUCTED BETWEEN JULY AND AUGUST OF EACH YEAR AND SHOULD BE SEPARATED BY AT LEAST TWO WEEKS. APPROXIMATELY TWO HERBICIDE TREATMENTS SHOULD BE SCHEDULED PER SEASON FOR AT LEAST TWO YEARS FOLLOWING INITIATION OF PROJECT WORK. HERBICIDE USE REPORTING WILL ADHERE TO ALL APPLICATOR LICENSING REQUIREMENTS.

VEGETATION MANAGEMENT NOTES

1. IN AREAS WHERE VEGETATION REMOVAL IS SPECIFIED, SOIL IS RECOMMENDED TO BE CLEARED, GRUBBED, MECHANICALLY REMOVED BY HAND, DISKED, CULTIVATED, AND/OR ROLLED IN AS NEEDED. THE INTENT IS TO COMPLETELY ELIMINATE EXISTING VEGETATION, PREPARE THE SOIL FOR NEW PLANT MATERIAL ACCEPTANCE OF OBNOXIOUS WEEDS, AND TO ACHIEVE GOOD SOIL-TO-SEED CONTACT.
2. SITE MANAGER TO OBSERVE SITE IN THE SPRING, TWICE IN THE SUMMER, AND ONCE IN THE FALL TO IDENTIFY GROWTH RATES, NOXIOUS WEEDS AND ESTABLISHMENT PROBLEMS.
3. MOWING, WEEDING, HAND PULLING OF WEEDS, AND SPOT APPLYING HERBICIDE MAY NEED TO OCCUR AT EACH OBSERVATION (MOWING HEIGHT TO NOT BE LESS THAN 8" FROM GRADE). IF PROBLEMS ARE NOT IDENTIFIED WITH EITHER HEIGHT OF VEGETATION OR QUANTITY OF WEEDS, NO ACTION SHOULD BE TAKEN.
4. THE INITIAL THREE YEARS WILL REQUIRE MORE FREQUENT MAINTENANCE AND MONITORING TO PROVIDE NATIVE PLANT ESTABLISHMENT INSTEAD OF INVASIVE WEEDS.
5. WITHIN FIRST TWO YEARS OF COMPLETION, LANDSCAPE CONTRACTOR TO VISIT THE SITE ONCE PER MONTH THROUGHOUT THE GROWING SEASON TO CONTROL INVASIVE WEEDS. ALSO DURING THIS TIME, MOWING SHOULD OCCUR AT LEAST TWICE PER YEAR TO ELIMINATE SHADING FROM AGRONOMIC, ANNUAL WEEDS.
6. SITE MANAGER SHOULD PERFORM YEARLY INSPECTIONS WITH A LANDSCAPE MAINTENANCE PROFESSIONAL TO IDENTIFY WEED PROBLEMS AND TO DISCUSS A STRATEGY FOR MAINTENANCE FOR THE YEAR.
7. ANNUALLY, AT THE START OF SPRING, SITE SHOULD BE MOWED WITH A ROTARY MOWER TO (NO LESS THAN 8" IN HEIGHT TO NOT BE LESS THAN 8" FROM GRADE) KNOCKDOWN STANDING VEGETATION FROM THE PREVIOUS SEASONS.
8. IF SITE MANAGER DETERMINES THE NEED TO REMOVE INVASIVE WEEDS WITH A HERBICIDE, THE MOST EFFECTIVE METHOD IS DURING THE FALL WITH A DIRECT APPLICATION. SITE MANAGER SHOULD CONDUCT A THOROUGH WALK-THROUGH OF THE SITE TO FIND WEEDS AND APPLY HERBICIDE. THE USE OF HERBICIDES SHALL FOLLOW AND ABIDE BY ALL LOCAL AND FEDERAL LAWS.

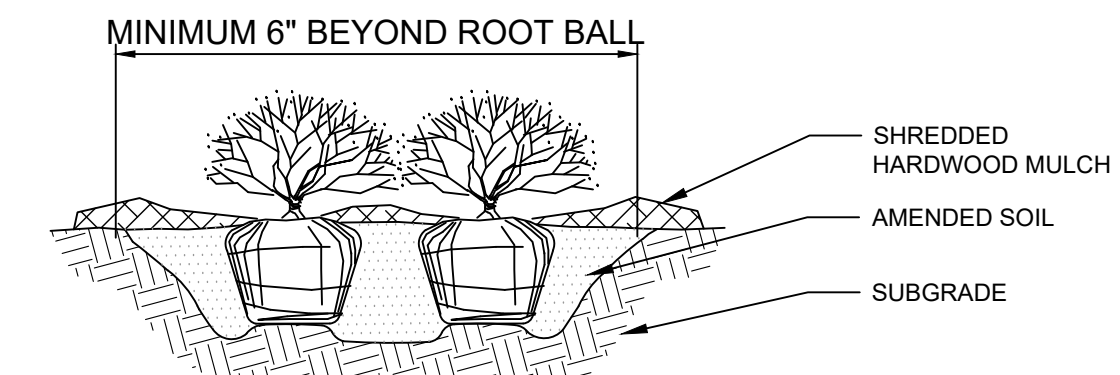

NOTES:

1. APPLY CORRECTIVE PRUNING.
2. SET ROOT BALL OR CONTAINER ON UNEXCAVATED OR TAMPED SOIL. TOP OF ROOTBALL (CONTAINER) SHALL BE ONE INCH ABOVE SURROUNDING GRADE. FOR LARGER SHRUBS WITHIN PLANTING BED DIG A DEEPER PIT ONLY FOR THOSE SHRUBS.
3. REMOVE BURLAP FROM TOP HALF THE LENGTH OF ROOTBALL. TWINE AND (IF USED) SYNTHETIC MATERIAL SHALL BE REMOVED FROM PLANTING BED. FOR CONTAINER GROWN SHRUBS, REMOVE CONTAINER AND LOOSEN ROOTS PRIOR TO INSTALLATION.
4. REMOVE OR CORRECT GIRDLING ROOTS.
5. PLUMB AND BACKFILL WITH AMENDED SOIL PER LANDSCAPE NOTES. WATER THOROUGHLY WITHIN TWO HOURS.
6. APPLY MULCH IN EVEN LAYER, KEEPING AWAY FROM ROOT FLARE. MULCH LIMITS FOR SHRUBS EXTEND TO ALL LIMITS OF PLANTING BED. SEE PLANS FOR BED LAYOUTS.

1 SHRUB PLANTING

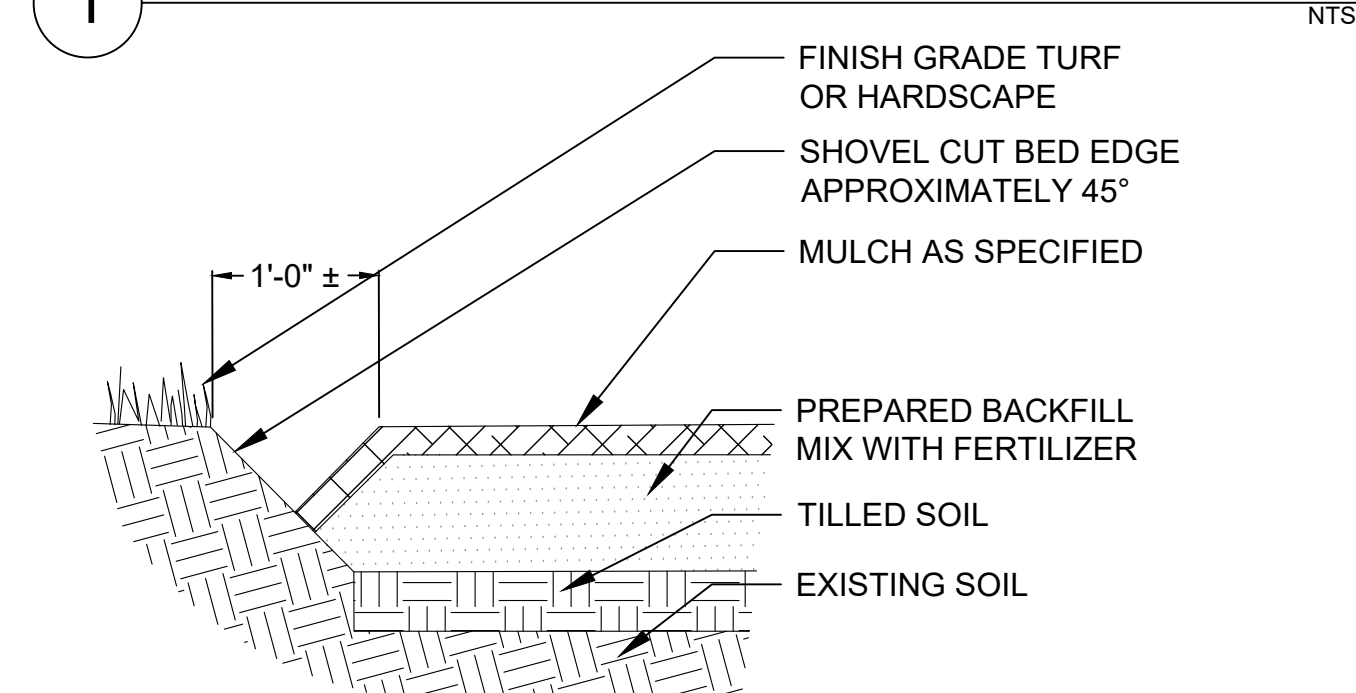

2 LANDSCAPE BED EDGE

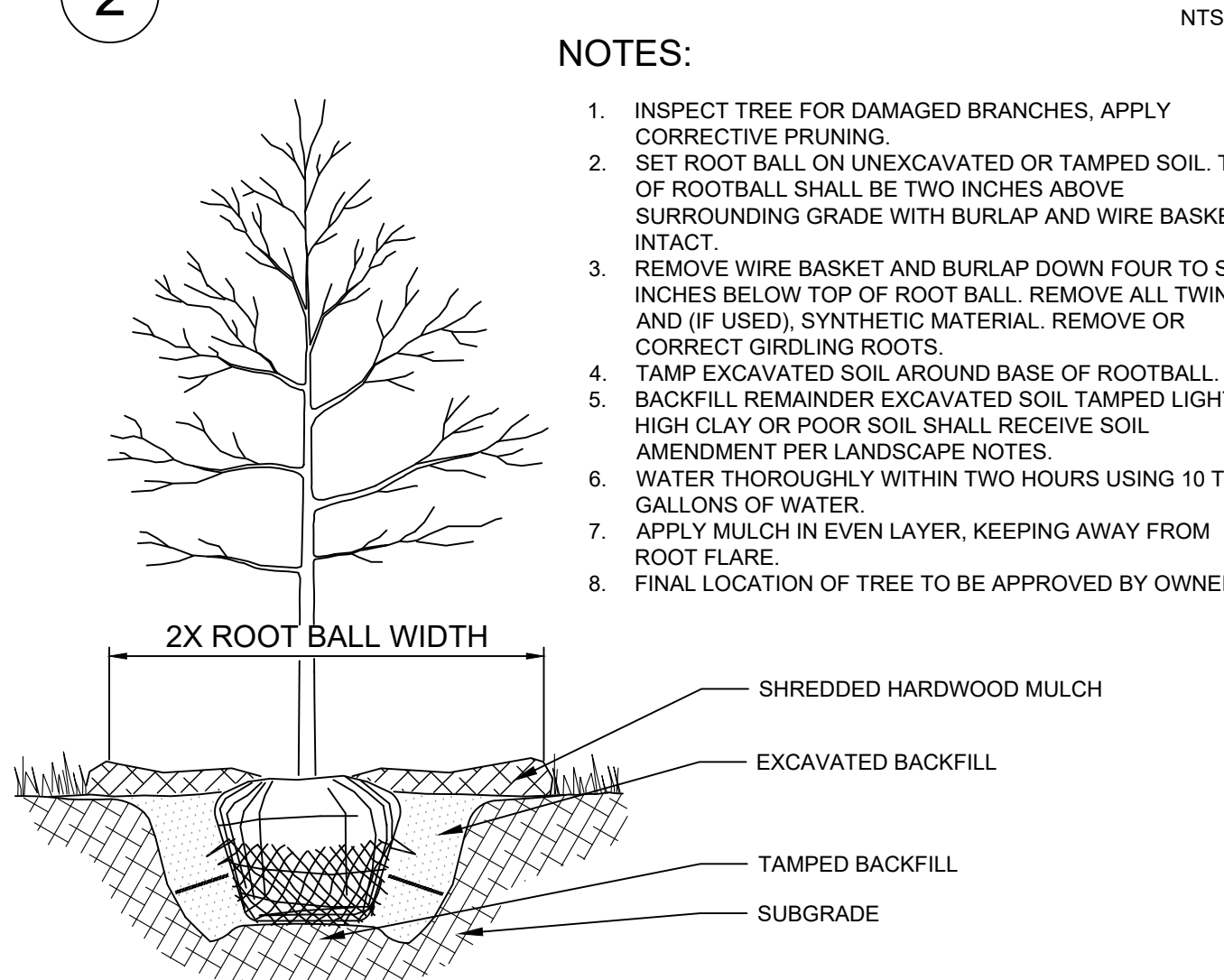

NOTES:

1. INSPECT TREE FOR DAMAGED BRANCHES, APPLY CORRECTIVE PRUNING.
2. SET ROOT BALL ON UNEXCAVATED OR TAMPED SOIL. TOP OF ROOTBALL SHALL BE TWO INCHES ABOVE SURROUNDING GRADE WITH BURLAP AND WIRE BASKET INTACT.
3. REMOVE WIRE BASKET AND BURLAP DOWN FOUR TO SIX INCHES BELOW TOP OF ROOT BALL. REMOVE ALL TWINE AND (IF USED), SYNTHETIC MATERIAL. REMOVE OR CORRECT GIRDLING ROOTS.
4. TAMP EXCAVATED SOIL AROUND BASE OF ROOTBALL.
5. BACKFILL REMAINDER EXCAVATED SOIL TAMPED LIGHTLY. HIGH CLAY OR POOR SOIL SHALL RECEIVE SOIL AMENDMENT PER LANDSCAPE NOTES.
6. WATER THOROUGHLY WITHIN TWO HOURS USING 10 TO 15 GALLONS OF WATER.
7. APPLY MULCH IN EVEN LAYER, KEEPING AWAY FROM ROOT FLARE.
8. FINAL LOCATION OF TREE TO BE APPROVED BY OWNER.

3 TREE PLANTING

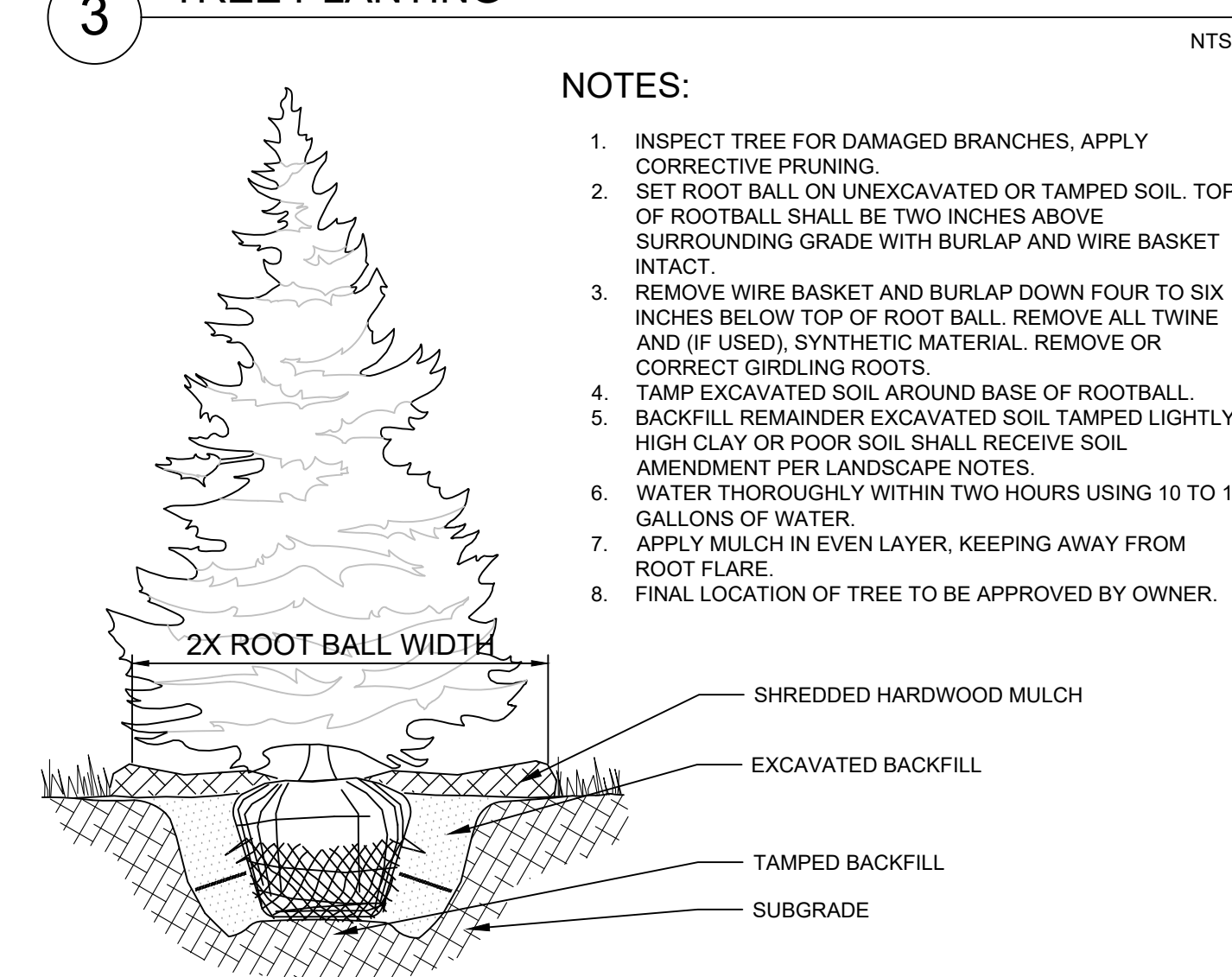

NOTES:

1. INSPECT TREE FOR DAMAGED BRANCHES, APPLY CORRECTIVE PRUNING.
2. SET ROOT BALL ON UNEXCAVATED OR TAMPED SOIL. TOP OF ROOTBALL SHALL BE TWO INCHES ABOVE SURROUNDING GRADE WITH BURLAP AND WIRE BASKET INTACT.
3. REMOVE WIRE BASKET AND BURLAP DOWN FOUR TO SIX INCHES BELOW TOP OF ROOT BALL. REMOVE ALL TWINE AND (IF USED), SYNTHETIC MATERIAL. REMOVE OR CORRECT GIRDLING ROOTS.
4. TAMP EXCAVATED SOIL AROUND BASE OF ROOTBALL.
5. BACKFILL REMAINDER EXCAVATED SOIL TAMPED LIGHTLY. HIGH CLAY OR POOR SOIL SHALL RECEIVE SOIL AMENDMENT PER LANDSCAPE NOTES.
6. WATER THOROUGHLY WITHIN TWO HOURS USING 10 TO 15 GALLONS OF WATER.
7. APPLY MULCH IN EVEN LAYER, KEEPING AWAY FROM ROOT FLARE.
8. FINAL LOCATION OF TREE TO BE APPROVED BY OWNER.

4 EVERGREEN TREE PLANTING

NTS



DATE	04/30/24
REVISIONS	
BY	
TTS	
NO.	

Kimley»Horn
 © 2024 KIMLEY-HORN AND ASSOCIATES, INC.
 4201 WINDFIELD ROAD, SUITE 600
 WILMINGTON, OHIO 45396
 PHONE: 630-487-2500
 WWW.KIMLEY-HORN.COM

SCALE:	AS NOTED
DESIGNED BY:	HL
DRAWN BY:	HL
CHECKED BY:	CW



LANDSCAPE NOTES & DETAILS

CYRUSONE
AURORA
 2725 BILTER RD
 AURORA, IL 60502

ORIGINAL ISSUE:
 02/23/2024
 KHA PROJECT NO.
 268485001

SHEET NUMBER
L2.0

Drawing name: K:\GIS\DEV\268485001_CyrusOne_Aurora_IL\2 Design\CAD\PlanSheets\Preliminary Engineering\L2.0 LANDSCAPE PLAN.dwg L2.0 LANDSCAPE NOTES & DETAILS Apr 30, 2024 10:31am by: Kyoa.Sullivan
 This document, together with the concepts and designs presented herein, is intended only for the specific purpose and client for which it was prepared. Reuse of and improper reliance on this document without written authorization and adaptation by Kimley-Horn and Associates, Inc. shall be without liability to Kimley-Horn and Associates, Inc.

Drawing name: K:\CHS_LDEV\268485001_CyrusOne_Aurora_IL\2 Design\CAD\PlantSchedules\Preliminary Engineering\1.0 Landscape Plan.dwg L2.1 LANDSCAPE SCHEDULES Apr 30, 2024 10:31am by: Kyoa.Guilliver
 This document, together with the concepts and designs presented herein, is intended only for the specific purpose and client for which it was prepared. Reuse of any part of this document without written authorization and adaptation by Kimley-Horn and Associates, Inc. shall be without liability to Kimley-Horn and Associates, Inc.

PLANT SCHEDULE

SYMBOL	CODE	QTY	BOTANICAL / COMMON NAME	CONT	CAL	SIZE
TREES						
	AN	26	ACER X FREEMANII 'AUTUMN BLAZE' / AUTUMN BLAZE MAPLE	B & B	2.5" CAL. MIN	
	BR	35	BETULA NIGRA / RIVER BIRCH	B & B	2.5" CAL. MIN	
	CO	38	CELTIS OCCIDENTALIS / COMMON HACKBERRY	B & B	2.5" CAL. MIN	
	GS	32	GLEDITSIA TRIACANTHOS INERMIS 'SKYLINE' / SKYLINE HONEY LOCUST	B & B	2.5" CAL. MIN	
	LT	25	LIRIODENDRON TULIPIFERA / TULIP POPLAR	B & B	2.5" CAL. MIN	
	QB	37	QUERCUS BICOLOR / SWAMP WHITE OAK	B & B	2.5" CAL. MIN	
	QM	44	QUERCUS MACROCARPA / BURR OAK	B & B	2.5" CAL. MIN	
	QC	39	QUERCUS ROBUR X ALBA 'CRIMSCHMIDT' / CRIMSON SPIRE™ OAK	B & B	2.5" CAL. MIN	
	TD	23	TAXODIUM DISTICHUM / BALD CYPRESS	B & B	2.5" CAL. MIN	
	TC	40	TILIA CORDATA / LITTLELEAF LINDEN	B & B	2.5" CAL. MIN	
	ZA	29	ZELKOVA SERRATA 'AUTUMN GLOW' / AUTUMN GLOW JAPANESE ZELKOVA	B & B	2.5" CAL. MIN	
EVERGREEN TREES						
	PW	17	PINUS ALBA / WHITE PINE	B & B	6" HT. MIN	
	PF	17	PINUS FLEXILIS 'VANDERWOLF'S PYRAMID' / VANDERWOLF'S LIMBER PINE	B & B	6" HT. MIN	
	PD	17	PSEUDOTSUGA MENZIESII / DOUGLAS FIR	B & B	6" HT. MIN	
	TG2	17	THUJA STANDISHII X PLICATA 'GREEN GIANT' / GREEN GIANT ARBORVITAE	B & B	6" HT. MIN	
	TC4	17	TSUGA CANADENSIS / CANADIAN HEMLOCK	B & B	6" HT. MIN	
ORNAMENTAL TREES						
	AL	20	AMELANCHIER LAEVIS / ALLEGHENY SERVICEBERRY	B & B	8" HT. MIN	MULTI-STEM
	CI	16	CRATAEGUS CRUS-GALLI INERMIS / THORNLESS COCKSPUR HAWTHORN	B & B	2.5" CAL. MIN	SINGLE STEM
	MP	19	MALUS X 'PRAIRIFIRE' / PRAIRIFIRE CRABAPPLE	B & B	2.5" CAL. MIN	SINGLE STEM
	SI	20	SYRINGA RETICULATA 'IVORY SILK' / IVORY SILK JAPANESE TREE LILAC	B & B	2.5" CAL. MIN	SINGLE STEM
SHRUBS						
	AM2	33	ARONIA MELANOCARPA 'MORTON' TM / IROQUIS BEAUTY BLACK CHOKEBERRY	-	SEE PLAN	18" HT. MIN
	CA2	26	CEANOTHUS AMERICANUS / NEW JERSEY TEA	-	SEE PLAN	18" HT. MIN
	CA	25	CORNUS SANGUINEA 'CATO' TM / ARCTIC SUN BLOODTWIG DOGWOOD	-	SEE PLAN	18" HT. MIN
	HL	31	HYDRANGEA PANICULATA 'JANE' TM / LITTLE LIME PANICLE HYDRANGEA	-	SEE PLAN	18" HT. MIN
	IL	27	ITEA VIRGINICA 'LITTLE HENRY' TM / VIRGINIA SWEETSPIRE	-	SEE PLAN	18" HT. MIN
	PL	20	PHYSOCARPUS OPULIFOLIUS 'LITTLE DEVIL' TM / DWARF NINEBARK	-	SEE PLAN	18" HT. MIN
	RG	45	RHUS AROMATICA 'GRO-LOW' / GRO-LOW FRAGRANT SUMAC	-	SEE PLAN	18" HT. MIN
	VA	22	VIBURNUM DENTATUM 'CRISTOM' / BLUE MUFFIN VIBURNUM	-	SEE PLAN	18" HT. MIN
EVERGREEN SHRUBS						
	JF2	46	JUNIPERUS CHINENSIS 'FAIRVIEW' / FAIRVIEW JUNIPER	-	SEE PLAN	18" HT. MIN
	JL	31	JUNIPERUS CHINENSIS 'GOLD LACE' / GOLD LACE JUNIPER	-	SEE PLAN	18" HT. MIN
	PG	26	PICEA PUNGENS 'GLAUCA GLOBOSA' / COLORADO SPRUCE	-	SEE PLAN	18" HT. MIN.
	PS2	43	PINUS STROBUS 'STOWE PILLAR' / STOWE PILLAR WHITE PINE	-	SEE PLAN	18" HT. MIN
	TT2	30	TAXUS X MEDIA 'TAUNTONII' / TAUNTON'S ANGLO-JAPANESE YEW	-	SEE PLAN	18" HT. MIN
	TC2	34	THUJA OCCIDENTALIS 'CONCESARINI' TM / PANCAKE ARBORVITAE	-	SEE PLAN	18" HT. MIN
	TA	24	THUJA OCCIDENTALIS 'WOODWARDII' / WOODWARDII EASTERN ARBORVITAE	-	SEE PLAN	18" HT. MIN.
GROUND COVERS						
	BB		BASIN BOTTOM PLUG MIX			
	TS		TURF SEED			
	WM		WET-MESIC PRAIRIE SEED MIX			

Landscape Implementation Data Table: Plant List by Category							
	QTY	Percent	SYM	BOTANICAL NAME (Family / Genus / Species)	COMMON NAME	SIZE	COMMENTS
Canopy Trees	26	7%	AN	ACER FREEMANII 'AUTUMN BLAZE'	AUTUMN BLAZE MAPLE	2.5" CAL. MIN	
	35	10%	BR	BETULA NIGRA	RIVER BIRCH	2.5" CAL. MIN	
	38	10%	CO	CELTIS OCCIDENTALIS	COMMON HACKBERRY	2.5" CAL. MIN	
	32	9%	GS	GLEDITSIA TRIACANTHOS 'SKYLINE'	SKYLINE HONEY LOCUST	2.5" CAL. MIN	
	25	7%	LT	LIRIODENDRON TULIPIFERA	TULIP POPLAR	2.5" CAL. MIN	
	37	10%	QB	QUERCUS BICOLOR	SWAMP WHITE OAK	2.5" CAL. MIN	
	44	12%	QM	QUERCUS MACROCARPA	BURR OAK	2.5" CAL. MIN	
	39	11%	QC	QUERCUS ROBUR X ALBA 'CRIMSCHMIDT' TM	CRIMSON SPIRE OAK	2.5" CAL. MIN	
	40	11%	TC	TILIA CORDATA	LITTLELEAF LINDEN	2.5" CAL. MIN	
	23	6%	TD	TAXODIUM DISTICHUM	BALD CYPRESS	2.5" CAL. MIN	
	29	8%	ZA	ZELKOVA SERRATA 'AUTUMN GLOW'	AUTUMN GLOW JAPANESE ZELKOVA	2.5" CAL. MIN	
	Total:	368	100%				
Evergreen Trees	17	20%	PW	PINUS ALBA	WHITE PINE	6' HT. MIN	
	17	20%	PF	PINUS FLEXILIS 'VANDERWOLF'S PYRAMID'	VANDERWOLF'S LIMBER PINE	6' HT. MIN	
	17	20%	PD	PSEUDOTSUGA MENZIESII	DOUGLAS FIR	6' HT. MIN	
	17	20%	TG2	THUJA STANDISHII X PLICATA 'GREEN GIANT'	GREEN GIANT ARBORVITAE	6' HT. MIN	
	17	20%	TC4	TSUGA CANADENSIS	CANADIAN HEMLOCK	6' HT. MIN	
	Total:	85	100%				
Understory Trees	20	27%	AL	AMELANCHIER LAEVIS	ALLEGHENY SERVICEBERRY	8' HT. MIN	MULTI-STEM
	16	21%	CI	CRATAEGUS CRUS-GALLINERMIS TM	THORNLESS COCKSPUR HAWTHORN	2.5" CAL. MIN	
	20	27%	CI	SYRINGA RETICULATA 'IVORY SILK'	IVORY SILK JAPANESE TREE LILAC	2.5" CAL. MIN	
	19	25%	MP	MALUS X 'PRAIRIFIRE'	PRAIRIFIRE CRABAPPLE	2.5" CAL. MIN	
	Total:	75	100%				
Deciduous Shrubs	33	14%	AM2	ARONIA MELANOCARPA 'MORTON' TM	IROQUIS BEAUTY BLACK CHOKEBERRY	18" HT. MIN	
	26	11%	CA2	CEANOTHUS AMERICANUS	NEW JERSEY TEA	18" HT. MIN	
	25	11%	CA	CORNUS SANGUINEA 'CATO' TM	ARCTIC SUN BLOOD TWIG DOGWOOD	18" HT. MIN	
	31	14%	FG	HYDRANGEA PANICULATA 'JANE' TM	LITTLE LIME PANICLE HYDRANGEA	18" HT. MIN	
	27	12%	IL	ITEA VIRGINICA 'LITTLE HENRY' TM	VIRGINIA SWEETSPIRE	18" HT. MIN	
	20	9%	PL	PHYSOCARPUS OPULIFOLIUS 'LITTLE DEVIL' TM	DWARF NINEBARK	18" HT. MIN	
	45	20%	IL	RHUS AROMATICA 'GRO-LOW'	GRO-LOW FRAGRANT SUMAC	18" HT. MIN	
	22	10%	VA	VIBURNUM DENTATUM 'CRISTOM'	BLUE MUFFIN VIBURNUM	18" HT. MIN	
	Total:	229	100%				
	Evergreen Shrubs	46	20%	JF2	JUNIPERUS CHINENSIS 'FAIRVIEW'	FAIRVIEW JUNIPER	18" HT. MIN
31		13%	JL	JUNIPERUS CHINENSIS 'GOLD LACE'	GOLD LACE JUNIPER	18" HT. MIN	
26		11%	PG	PICEA PUNGENS 'GLAUCA GLOBOSA'	COLORADO SPRUCE	18" HT. MIN	
43		18%	PS2	PINUS STROBUS 'STOWE PILLAR'	STOWE PILLAR WHITE PINE	18" HT. MIN	
30		13%	TT2	TAXUS X MEDIA 'TAUNTONII'	TAUNTON'S ANGLO-JAPANESE YEW	18" HT. MIN	
34		15%	TC2	THUJA OCCIDENTALIS 'CONCESARINI' TM	PANCAKE ARBORVITAE	18" HT. MIN	
24		10%	TA	THUJA OCCIDENTALIS 'WOODWARDII'	WOODWARDII EASTERN ARBORVITAE	18" HT. MIN	
Total:		234	100%				

AURORA, IL LANDSCAPE CODE REQUIREMENTS		
ZONING ORDINANCE	REQUIRED	PROPOSED
SECTION 49-105.4 LANDSCAPING		
STREET TREE REQUIREMENT: PROVIDE THREE CANOPY TREES PER 100 FEET OF RIGHT OF WAY FRONTAGE.	BILTER ROAD 938 LF 938 / 100 = 9 9 TREES X 3 = 27 27 TREES REQUIRED ALONG BILTER ROAD EOLA ROAD 2,660 LF 2660 / 100 = 27 27 TREES X 3 = 81 81 TREES REQUIRED ALONG INST 88 ON-RAMP	TOTAL OF EXISTING HEALTHY VEGETATION ALONG BILTER ROAD (IN CALIPER INCHES): 40 / 12 = 3 CTE CREDIT 24 CTE PROPOSED ALONG BILTER ROAD TOTAL OF EXISTING HEALTHY VEGETATION ALONG INST 88 (IN CALIPER INCHES): 14 / 12 = 1 CTE CREDIT 80 CTE PROPOSED ALONG INST 88
DETENTION FACILITIES: PROVIDE 5 CANOPY TREE EQUIVALENTS PER 100 FEET OF HIGH WATER LINE. A MINIMUM OF 25% OF THE REQUIRED CANOPY TREE EQUIVALENT SHALL BE NON-CANOPY TREE PLANTING MATERIAL.	LENGTH OF HIGH WATER LINE = 5,645 LF 5,645 LF / 100 LF = 56 56 X 5 CANOPY TREE EQUIVALENTS = 282 282 CANOPY TREE EQUIVALENTS REQUIRED (93 CREDITS MUST BE NON-CANOPY TREES)	DUE TO SITE CONSTRAINTS AND UTILITY CONFLICTS 144 CANOPY TREE EQUIVALENTS ARE PROVIDED VARIANCE REQUESTED
PARKING LOT INTERNAL REQUIREMENT: 1 LANDSCAPE ISLAND SHALL BE PROVIDED FOR EVERY 20 PARKING SPACES. SAID LANDSCAPE ISLANDS SHALL BE PLANTED WITH 1.5 CANOPY TREE EQUIVALENTS (INCLUDING 1 CANOPY TREE).	TOTAL NUMBER OF PARKING SPACES = 160 160 SPACES / 20 = 8 1 TREE REQUIRED PER ISLAND = 9 TREES REQUIRED 9 X 1.5 CANOPY TREE EQUIVALENTS = 13.5 14 CANOPY TREE EQUIVALENTS REQUIRED	9 CANOPY TREES 100 DECIDUOUS SHRUBS (5 CTE) 100 EVERGREEN SHRUBS (5 CTE) 12 EVERGREEN TREES (4 CTE) PROVIDED THROUGHOUT THE PARKING LOT
PERIMETER YARD REQUIREMENT: PROVIDE 3 CANOPY TREE EQUIVALENTS PER 100 FEET OF LOT PERIMETER, WHICH MAY BE CLUSTERED.	LENGTH OF LOT = 5,205 LF 5,205 / 100 = 52 52 X 3 CANOPY TREE EQUIVALENTS = 156 156 PERIMETER TREE EQUIVALENTS REQUIRED	TOTAL PERIMETER TREE EQUIVALENTS PROVIDED: 156 PERIMETER TREE EQUIVALENTS
FOUNDATION PLANTING REQUIREMENT: PROVIDE ONE CANOPY TREE EQUIVALENT PER 100 LINEAL FEET OF BUILDING FOUNDATION OF WHICH 100% OF THE REQUIREMENT SHALL BE NON-CANOPY TREE PLANTING MATERIAL.	BUILDING IN LINEAL FEET: 2,097 2,097 / 100 = 20.96 21 TREES REQUIRED = 21 TREE EQUIVALENTS REQUIRED	120 DECIDUOUS SHRUBS (6 CTE) 120 EVERGREEN SHRUBS (6 CTE) 15 ORNAMENTAL TREES (5 CTE) 12 EVERGREEN TREES (4 CTE)
PARKING LOT SCREENING PROVISIONS: SCREEN PARKING LOTS WITHIN SOFFET OF PUBLIC RIGHT-OF-WAY WITH COMPACT HEDGING, BERMING, DECORATIVE FENCING, DECORATIVE MASONRY OR A COMBINATION.	PARKING LOT SCREENING REQUIRED	BERM AND LANDSCAPE PLANTINGS ARE PROVIDED TO SCREEN PARKING LOTS FROM ALL PUBLIC ROW



DATE	04/30/24
BY	TTS
REVISIONS	PER CITY COMMENTS
No.	△
 © 2024 KIMLEY-HORN AND ASSOCIATES, INC. 4201 WINFIELD ROAD, SUITE 600 WILMINGTON, OHIO 45396 PHONE: 630-487-5550 WWW.KIMLEY-HORN.COM	
SCALE:	AS NOTED
DESIGNED BY:	HL
DRAWN BY:	HL
CHECKED BY:	CW
 LANDSCAPE SCHEDULES	
CYRUSONE AURORA 2725 BILTER RD AURORA, IL 60502	
ORIGINAL ISSUE:	02/23/2024
KHA PROJECT NO.	268485001
SHEET NUMBER	L2.1