

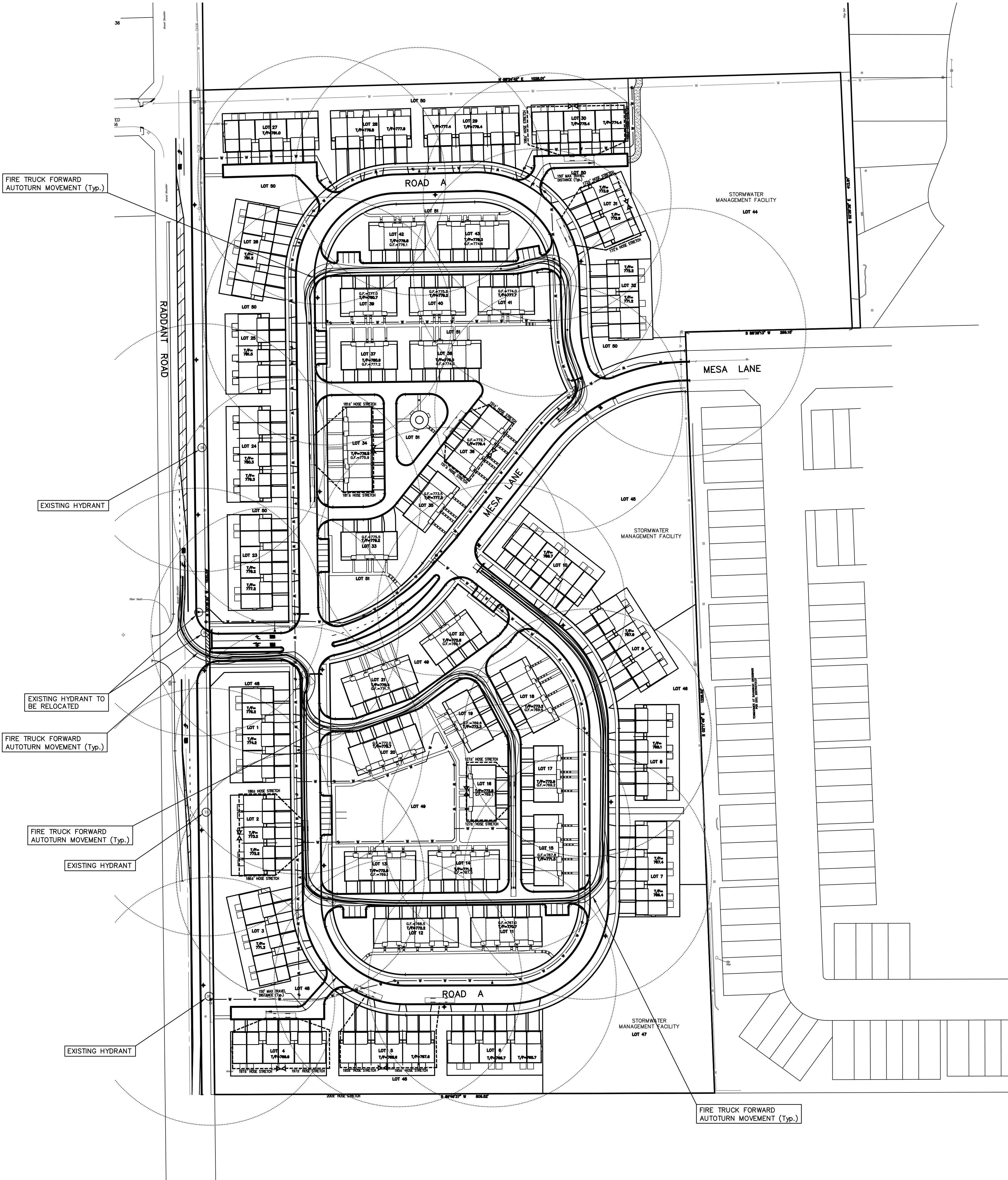

LOCATION MAP

FINAL FIRE ACCESS PLAN
FOR
ABBEY MEADOWS
AURORA, ILLINOIS

SHEET 1 OF 1

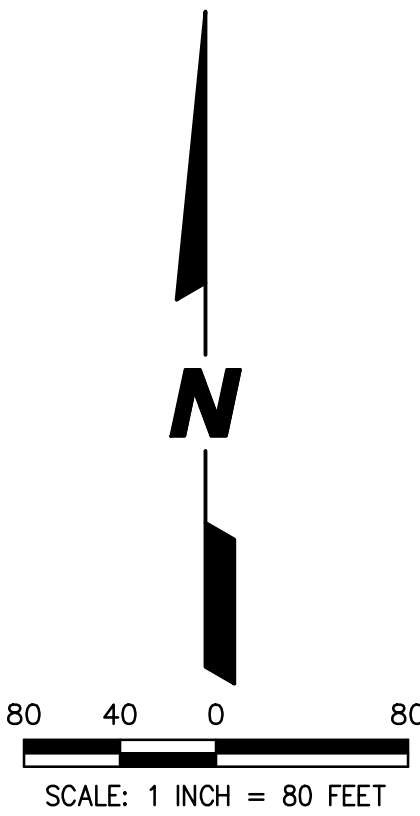

FIRE ACCESS PLAN DATA TABLE		
Description	Value	Unit
a) Building Height *	28'-1"	feet
b) Building Square Footage (typical)	14,000-22,000	square feet
c) Building fire suppression information including any proposed use of sprinkler systems, fire alarm systems, whether fire extinguishers are needed:		
No Proposed Sprinkler Systems within Development. Buildings will meet or exceed building code requirements for fire alarm systems.		
d) General description of business to be conducted within each building including: will there be rack storage in the building, will there be storage of combustible materials over twelve feet in height, clearance of sprinkler heads and stored materials (18 in. minimum)		
Residential (Only)		
*Building Height measured where shingles meet gutter.		

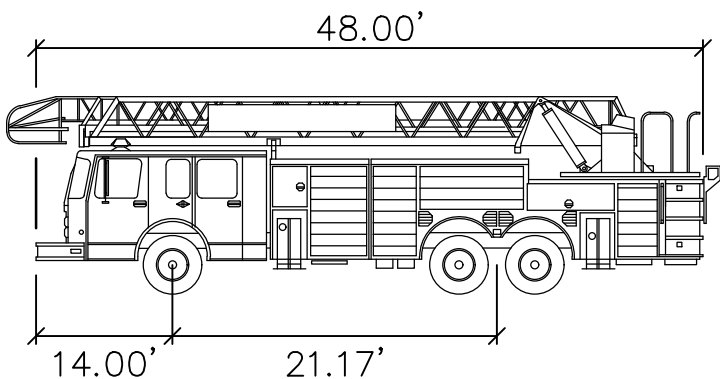

FIRETRUCK feet
Width : 8.00
Track : 7.00
Lock to Lock Time : 6.00
Steering Angle : 31.90

LEGEND		
EXISTING	PROPOSED	DESCRIPTION
— W	— W	WATERMAIN
⊗	⊗	VALVE & BOX
⊙	⊙	WATER VALVE IN VAULT
⊙	⊙	FIRE HYDRANT
---	---	HOSE STRETCH w/LENGTH
—	—	FIRE ENGINE LOCATION
—	—	FIRE LANE SIGNAGE

PREPARED FOR:
LENNAR HOMES
1700 E. GOLF ROAD
SUITE 1100
SCHAUMBURG, IL 60173



PREPARED BY:
CEMCON, Ltd.
Consulting Engineers, Land Surveyors & Planners
2280 White Oak Circle, Suite 100
Aurora, Illinois 60502-9675
PH: 630.862.2100 FAX: 630.862.2199
E-Mail: info@cemcon.com Website: www.cemcon.com

DISC NO.: 608087 FILE NAME: FINAL FIRE ACCESS EXH
DRAWN BY: JGC FLD. BK. / PG. NO.: ---
COMPLETION DATE: 03-11-25 JOB NO.: 608.087
XREF: TOPO PROJECT MANAGER: MAM

REVISIONS		
NO.	DATE	DESCRIPTION
1	05-21-25/JM	PER CITY OF AURORA