

FIRE ACCESS PLAN FOR  
NANCY HILL  
ELEMENTARY SCHOOL

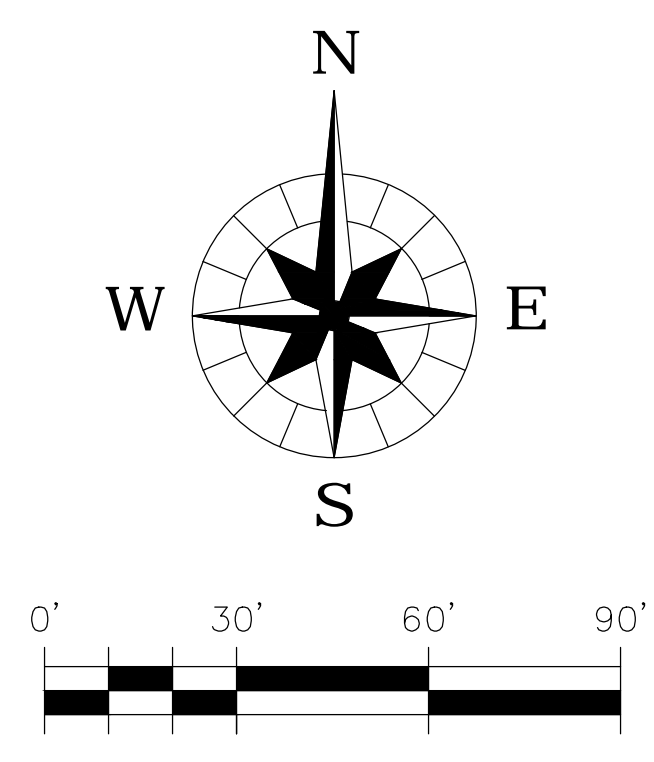
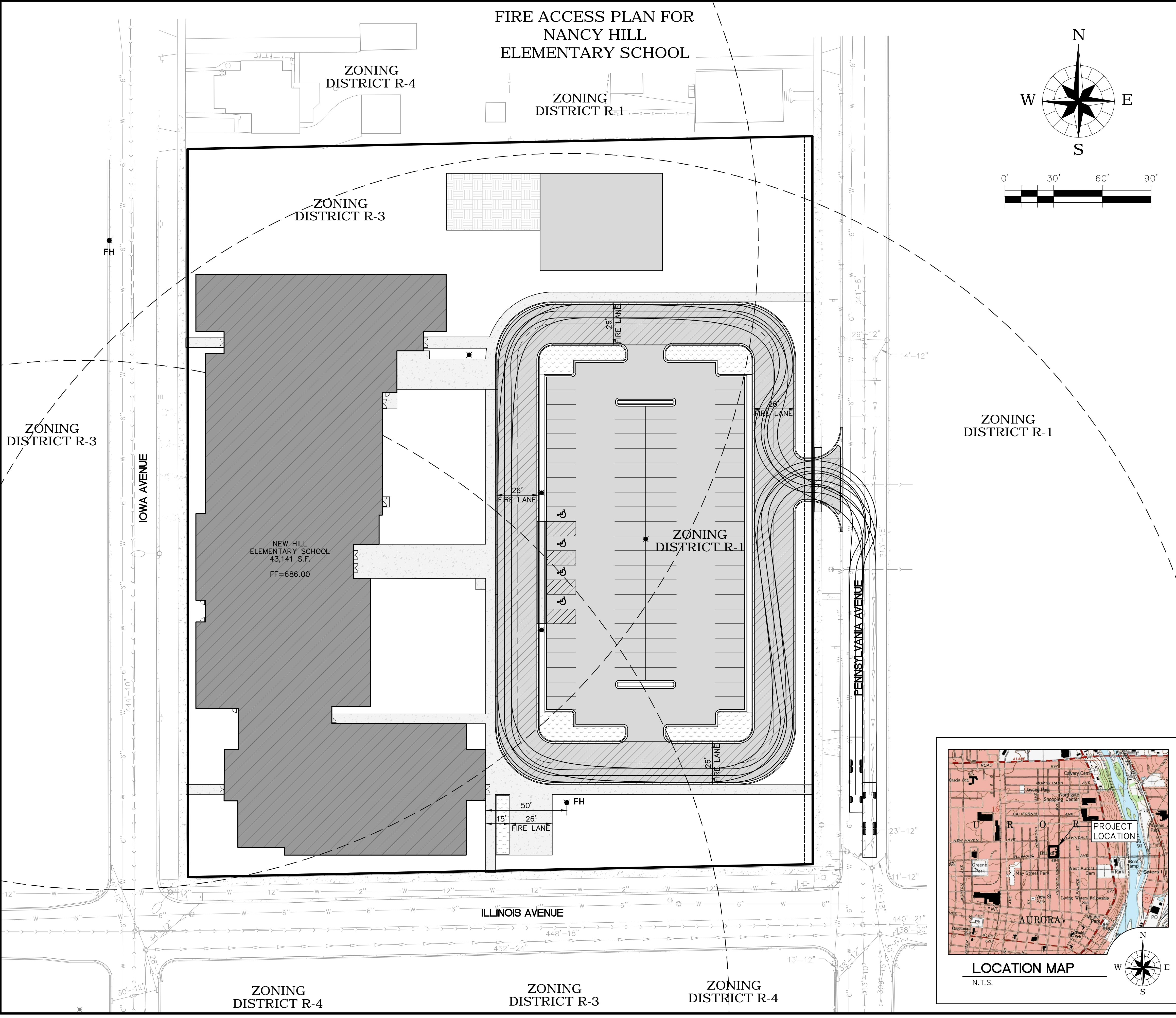

LEGEND:

—UE—	UNDERGROUND ELECTRIC
—W—	WATER MAIN
—S—	STORM SEWER
—SM—	SANITARY MAIN
—FO—	FIBER OPTIC LINE
---	FENCE
—G—	GAS LINE
○	FIRE HYDRANT
⊙	WATER VALVE
⊙	WATER VALVE VAULT
⊙	STORM MANHOLE
⊙	SANITARY MANHOLE
□	POWER POLE
⊗	GROUND LIGHT
□	SIGN
▨	EXISTING BUILDING
■	PROPOSED BUILDING
▨	PROPOSED ASPHALT

FIRE ACCESS DATA TABLE		
Description	Value	Unit
a) Building Height	45.00	Feet
b) Square footage of each building	72,341	Square Feet
c) Building fire suppression information including any proposed use of sprinkler systems, fire alarm systems, whether fire extinguishers are needed: Building will be equipped with an automatic fire sprinkler system and a fire alarm system.		
d) General description of business to be conducted within each building including: will there be rack storage in the building, will there be storage of combustible materials over twelve feet in height, clearance of sprinkler heads and stored materials (18 in minimum): Elementary school. No rack storage.		

WEST AURORA SCHOOL DISTRICT #129 Development Data Table: Preliminary/Final Plan		
Description	Value	Unit
*a) Tax/Parcel Identification Number(s) (PINs): 15-16-428-017, 15-16-428-018, 15-16-428-019, 15-16-428-036, 15-16-428-037, 15-16-428-038, 15-16-428-039		
*b) Proposed land use(s): Education*		
c) Total Property Size	3.96	Acres
d) Total Lot Coverage	172,637	Square Feet
(buildings and pavement)	107,647	Square Feet
e) Open space / landscaping	64,990	Square Feet
f) Land to be dedicated to the School District	38	Percent
g) Land to be dedicated to the Park District	0	Acres
h) Number of parking spaces provided (individually accessible)	80	spaces
i. surface parking lot	80	spaces
perpendicular	76	spaces
parallel	0	spaces
angled	0	spaces
handicapped	4	spaces
ii. enclosed	0	spaces
iii. bike	4	racks
i) Number of buildings	1	
i. Number of stories	3	stories
ii. Building Square Footage (average)	43,170	square feet
iii. Gross Floor Area of commercial use	0	GFA
iv. Building Foundation perimeter (Typical)	1,273	Linear Footage

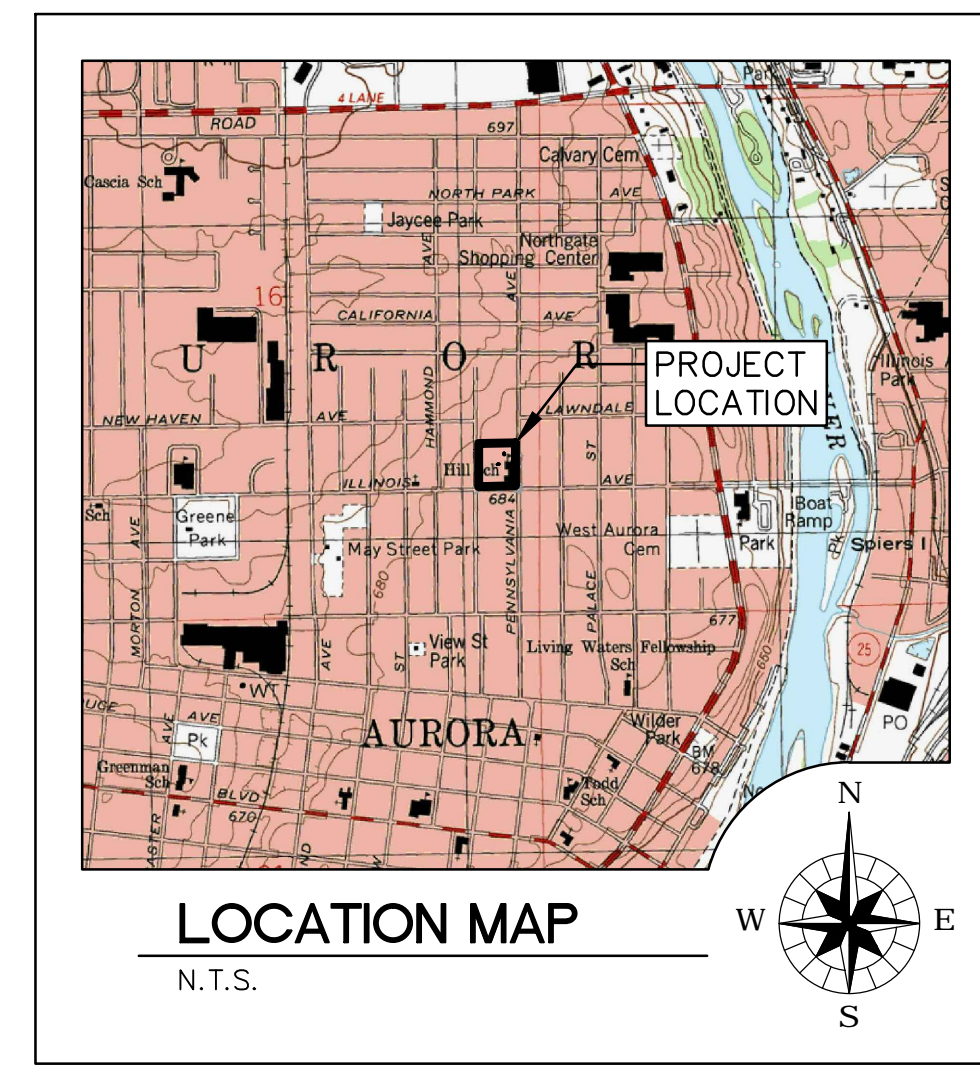

TITLE: NANCY HILL ELEMENTARY SCHOOL			
DSGN.	DWN.	CHKD.	SCALE: 1" = 30'
JLB	EAM	JLB	
NO. DATE NATURE OF REVISION			
CLIENT: WEST AURORA SCHOOL DISTRICT #129 80 S. RIVER ST. AURORA, IL 60506			
PROJECT NO. 150160_03			
DATE: 10/22/2015			
DRAWING NO. FAP1			
SHEET:			
1 OF 1			

W:\Projects\150160\_03\150160\_03\150160\_03.dwg FAP1 10/22/2015 10:28:27 AM emiller  
 PLOTTED BY: emiller