

FIRE PLAN FOR LAURELTON PLACE

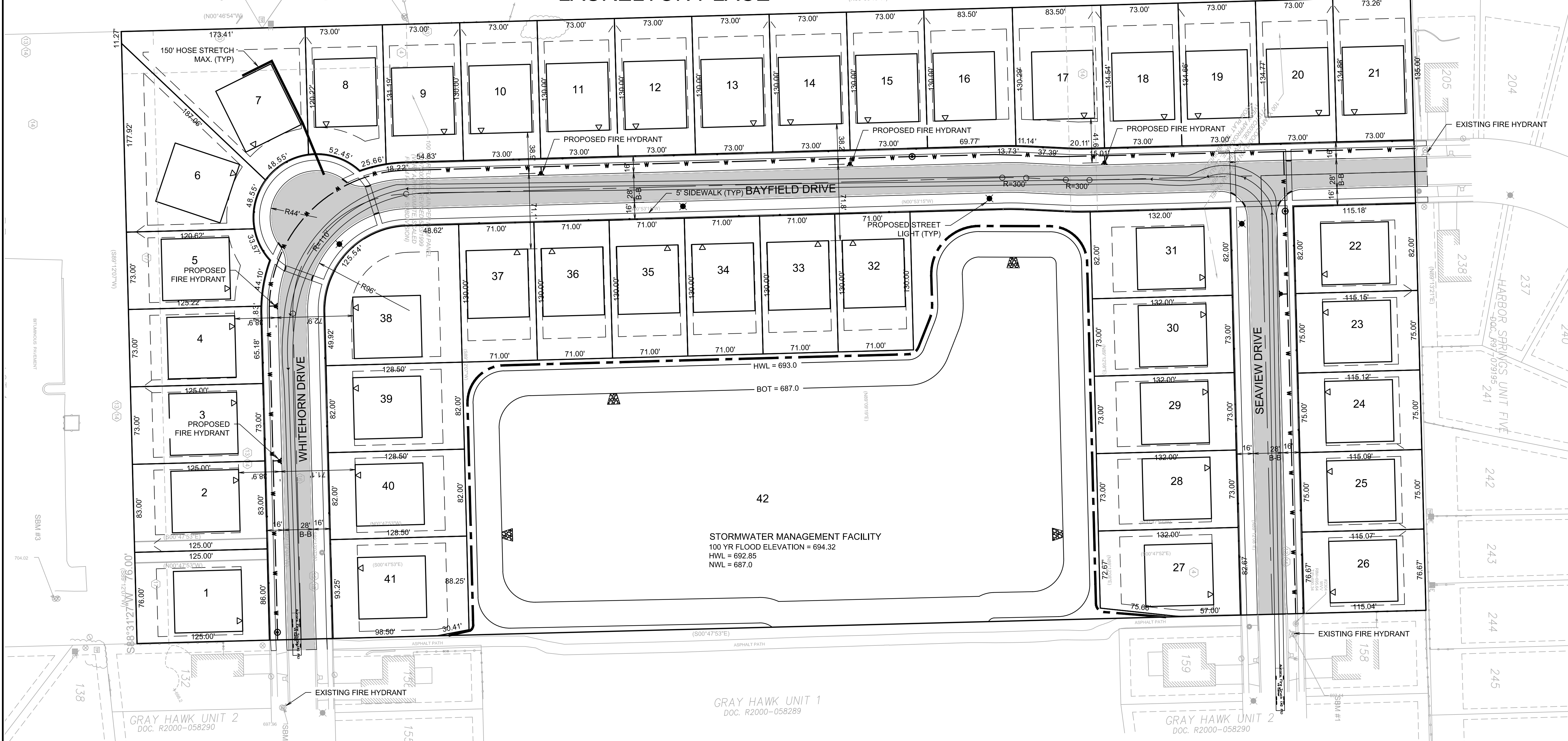

42
STORMWATER MANAGEMENT FACILITY
100 YR FLOOD ELEVATION = 694.32
HWL = 692.85
NWL = 687.0

GRAY HAWK UNIT 1
DOC. R2000-058289

GRAY HAWK UNIT 2
DOC. R2000-058290

REVISIONS	
NO.	DATE
1	04/11/19

PROJECT NO.	PROJECT MANAGER	DESIGNED BY	DRAWN BY
18338	BR	MB	DB

NO.	DATE	DESCRIPTION
1	04/11/19	REVISED PER FIRE DEPARTMENT REVIEW

DRAWING NO.
1 OF 1

LEGEND

EXISTING	PROPOSED	DESCRIPTION
		SANITARY SEWER
		SANITARY FORCE MAIN
		STORM SEWER
		COMBINED SEWER
		WATER MAIN
		UNDERGROUND FIBER OPTIC
		UNDERGROUND ELECTRIC
		UNDERGROUND TELEPHONE
		OVERHEAD ELECTRIC
		OVERHEAD TELEPHONE
		OVERHEAD WIRE
		UTILITY STRUCTURE WITH CLOSED LID
		CURB INLET
		DRAINAGE STRUCTURE WITH OPEN LID
		FIRE HYDRANT
		VALVE IN VALVE BOX
		GATE VALVE IN VALVE VAULT
		FLARED END SECTION (F.E.S.)
		LIGHT STANDARD
		OVERHEAD UTILITY POLE

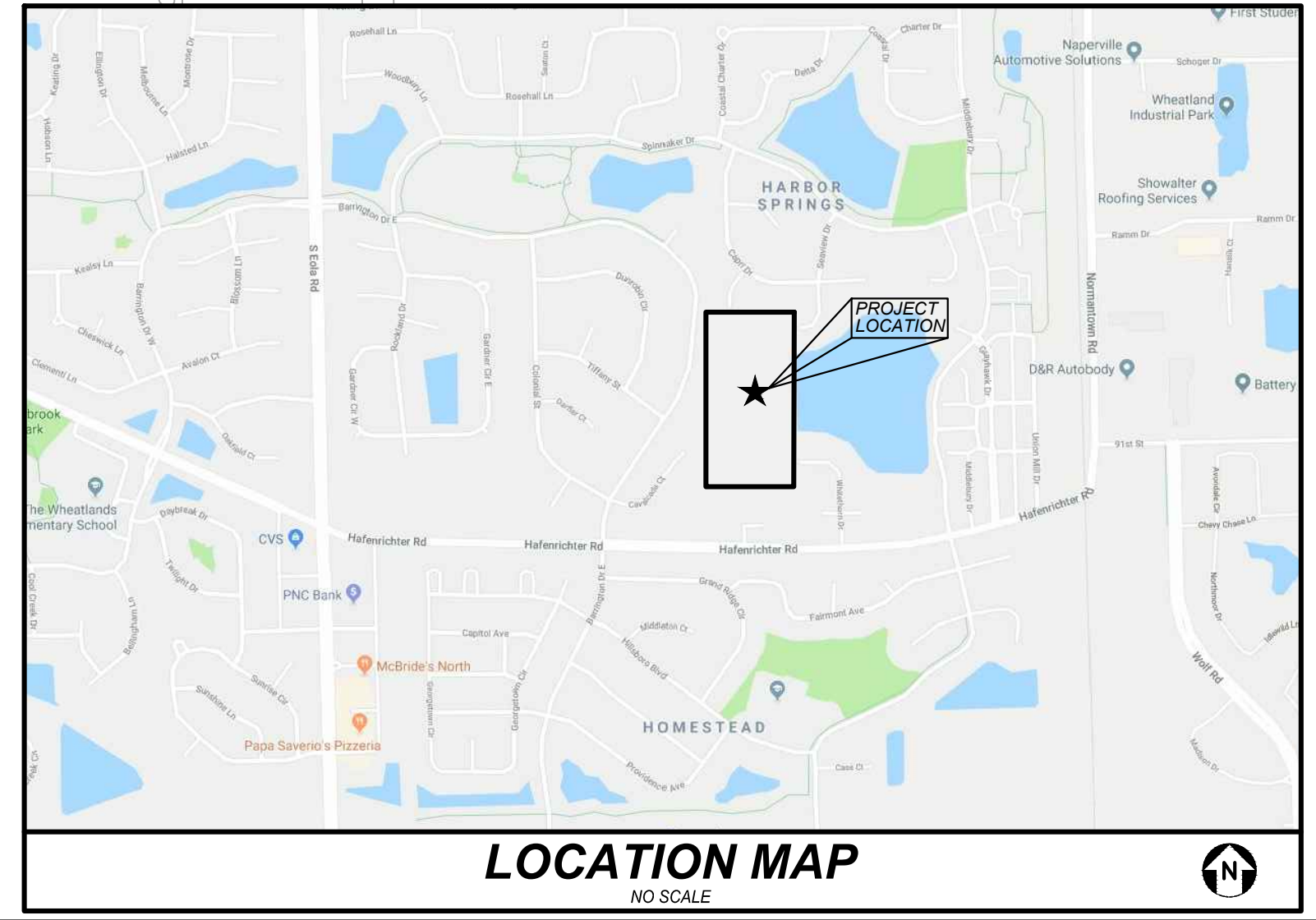

Fire Access Plan Data Table		
Description	Value	Unit
a) Building Height	35.00	feet
b) Building Square Footage (typical)	3,000	square feet
c) Building fire suppression information including any proposed use of sprinkler systems, fire alarm systems, whether fire extinguishers are needed: 0		
SEE ARCHITECTURAL PLANS.		
d) General description of business to be conducted within each building including: will there be rack storage in the building, will there be storage of combustible materials over twelve feet in height, clearance of sprinkler heads and stored materials (18 inch minimum): 0		
NO HAZARDOUS MATERIALS TO BE STORED ON SITE.		

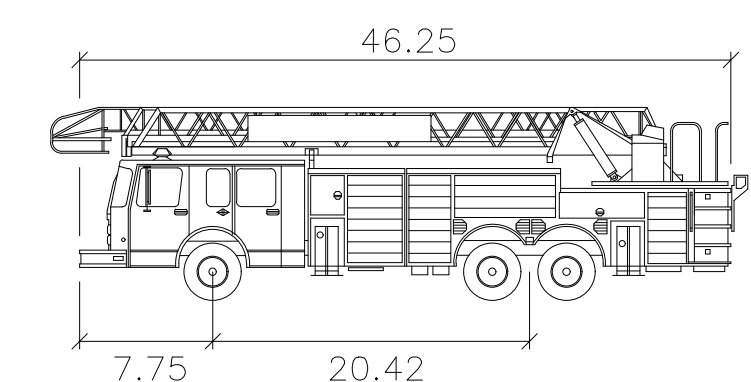

Aurora Firetruck
 Width : 8.33
 Track : 8.33
 Lock to Lock Time : 6.0
 Steering Angle : 23.2

LEGEND

DESIGNATES FIRE APPARATUS ACCESS ROAD
 MINIMUM WIDTH = 24 FEET
 GRADE NOT TO EXCEED 10%

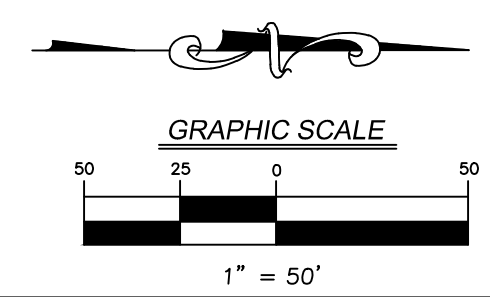

OWNER/DEVELOPER
 Pulte Home Company, LLC
 1900 East Golf Road, Suite 300
 Schaumburg, Illinois 60173
 847.230.5284
 Contact: Robert Getz, P.E.

ENGINEER
 V3 Companies, Ltd.
 7325 Janes Avenue
 Woodridge, Illinois 60517
 630.724.9200
 Project Manager: Bryan Rieger, P.E.
 briege@v3co.com
 Project Engineer: Matt Brolley, P.E.
 mbrolley@v3co.com

7325 Janes Avenue
 Woodridge, IL 60517
 630.724.9200 phone
 www.v3co.com