

CENTURY LANE STORM SEWER EXTENSION

MAY, 2019

GENERALLY LOCATED: SE 1/4 SECTION 23, T38N, R8E, AURORA TOWNSHIP

LEGEND	
EXISTING	PROPOSED
SANITARY SEWER	---# PVC---
STORM SEWER	---# 15" STP---
WATERMAIN	---# 12" W---
GAS LINE	---# 8" G---
TELEPHONE LINE	---# 4" T---
ELECTRIC LINE	---# 4" E---
FENCE	---# F---
INDEX CONTOUR	---# I---
INTERMEDIATE CONTOUR	---# M---
EDGE OF PAVEMENT	---# E---
CURB AND GUTTER	---# C---
RIGHT-OF-WAY	---# R---
SANITARY MANHOLE	⊙
SANITARY CLEANOUT	⊙
STORM MANHOLE	⊙
CATCH BASIN	⊙
INLET	⊙
FLARED END SECTION	⊙
FIRE HYDRANT	⊙
VALVE VAULT	⊙
VALVE BOX	⊙
STREET LIGHT	⊙
POWER POLE	⊙
STREET SIGN	⊙
ELECTRIC BOX	⊙
TELEPHONE BOX	⊙
TELEPHONE MANHOLE	⊙
B-BOX	⊙
GAS VALVE	⊙
TRAFFIC HANDHOLE	⊙
ELECTRIC HANDHOLE	⊙
MAILBOX	⊙
PARKING METER	⊙
TREE W/ DIAMETER	⊙
UTILITY CROSSING	⊙
SPOT ELEVATION	⊙
TOP OF CURB ELEVATION	X 602.6 TC
TOP OF FOUNDATION ELEVATION	X 602.6 TF
GUTTER ELEVATION	X 602.6 FL
PAVEMENT ELEVATION	X 602.6 P
FORCE MAIN	---
UNDERDRAIN	---
OVERHEAD LINE	---
CABLE TV LINE	---
HIGH WATER LEVEL	---
NORMAL WATER LEVEL	---
PAVEMENT FLOW DIRECTION	---
EXPLORATORY EXCAVATION LOCATION	⊙
ADDRESS	123
SANITARY MANHOLE REHABILITATION NUMBER	3-100
SOIL BORING LOCATION WITH IDENTIFICATION NUMBER & ELEVATION	SB #1 600.00
STRUCTURE TO BE REMOVED	X
PLUG EXISTING PIPE	⊙

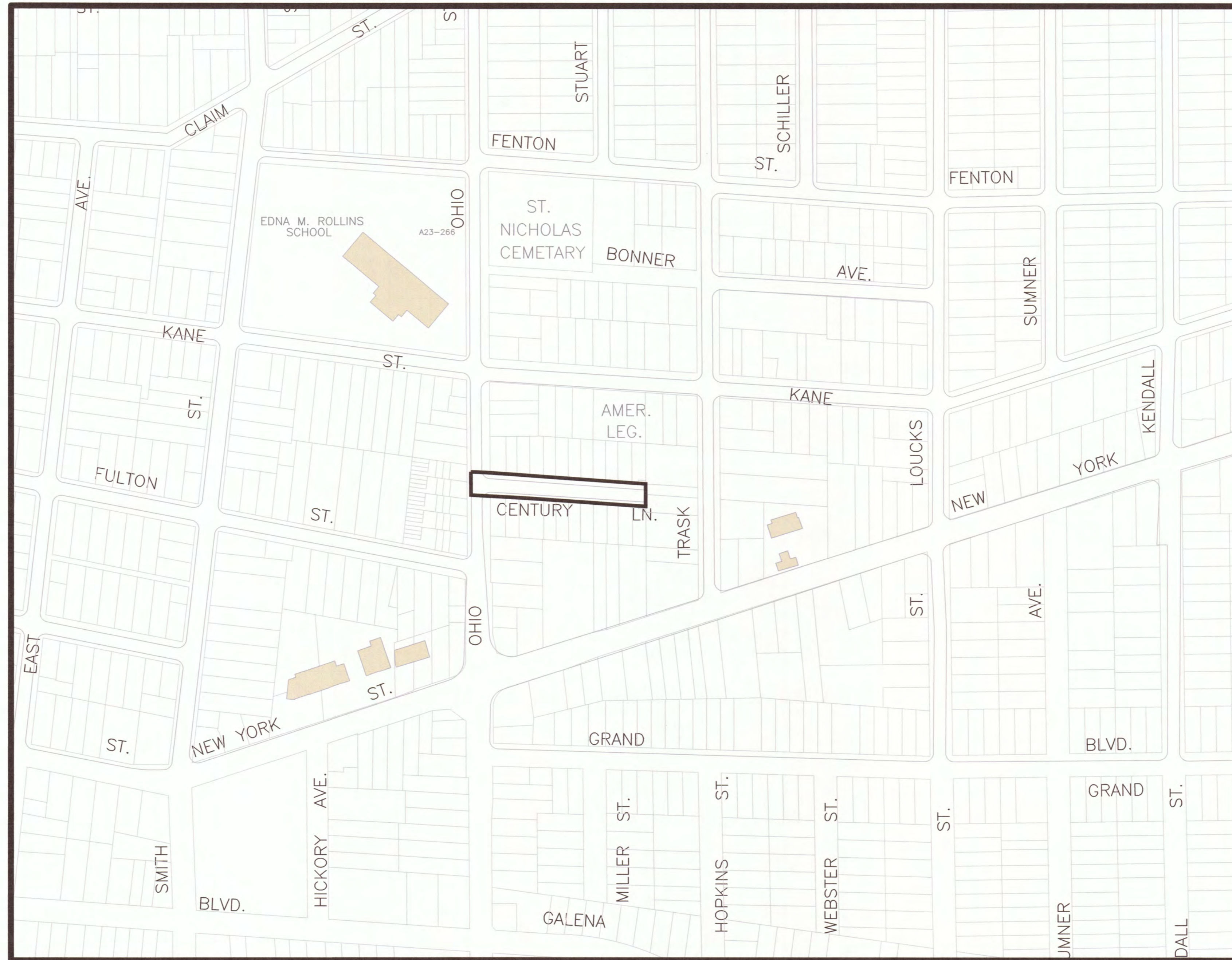

INDEX OF SHEETS

- 1 COVER SHEET
- 2 PLAN AND PROFILE
- 3-6 STANDARD DETAIL SHEETS

PLANS PREPARED BY:

CITY OF AURORA

DEPARTMENT OF PUBLIC WORKS, DIVISION OF ENGINEERING
77 S. BROADWAY AVENUE - AURORA, IL

PHONE: 630-256-3200 FAX: 630-256-3229

REVISIONS:

DESIGNED BY: GIL	DRAWN BY: GIL	CHECKED BY: JMB	APPROVED BY: JMB	HORIZ. SCALE: N/A	DATE: MAY 2019
				VERT. SCALE: N/A	

STAMP
ILLINOIS REGISTERED PROFESSIONAL
ENGINEER No. 062-59993
LICENSE EXPIRES NOVEMBER 30, 2019



DATE: 5/24/19