

# LANDSCAPE PLAN FOR LOT 7 OF ORCHARD ROAD SUBDIVISION

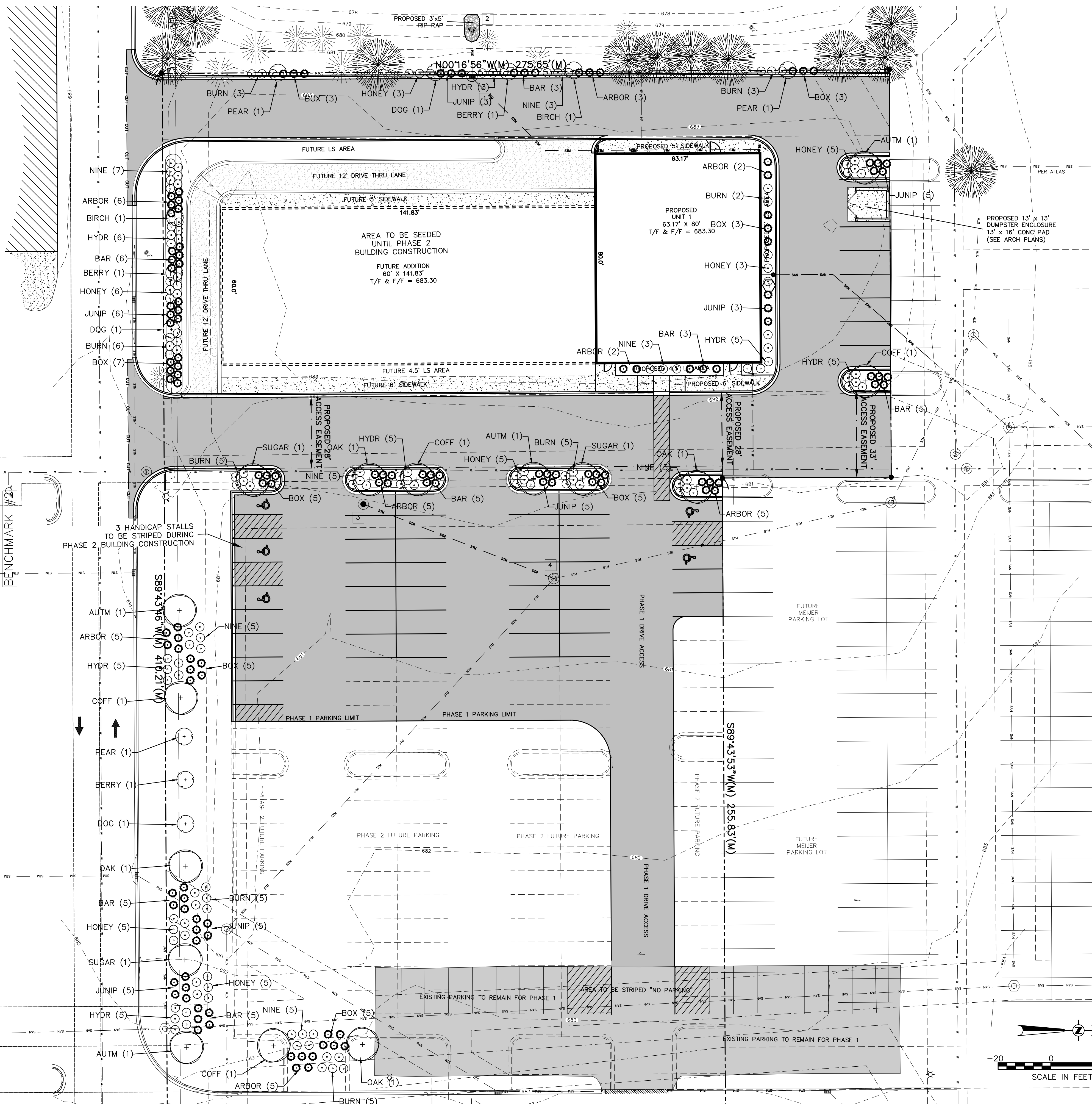

**Landscape Data Table: Planting Material Key**  
 Note: Symbols are blackline for proposed grayscale for existing

Canopy Trees (minimum size 2.5 caliper) Count:	15
Evergreen Trees (minimum size 6 feet) Count:	0
Understory Trees (minimum size 2.5 caliper or 8 feet if multi-stemmed) Count:	11
Evergreen Shrubs (minimum of 18 inches) Count:	133
Deciduous Shrubs (minimum of 18 inches) Count:	133
Ornamental Grasses Count:	0
Perennials Count:	0
Annuals Count:	0
Groundcover Square Footage:	0
Turf (Seeded) Square Footage:	0
Turf (Sod) Square Footage:	0
Native Prairie Planting Square Footage:	0
Native Wetland Planting Square Footage:	0

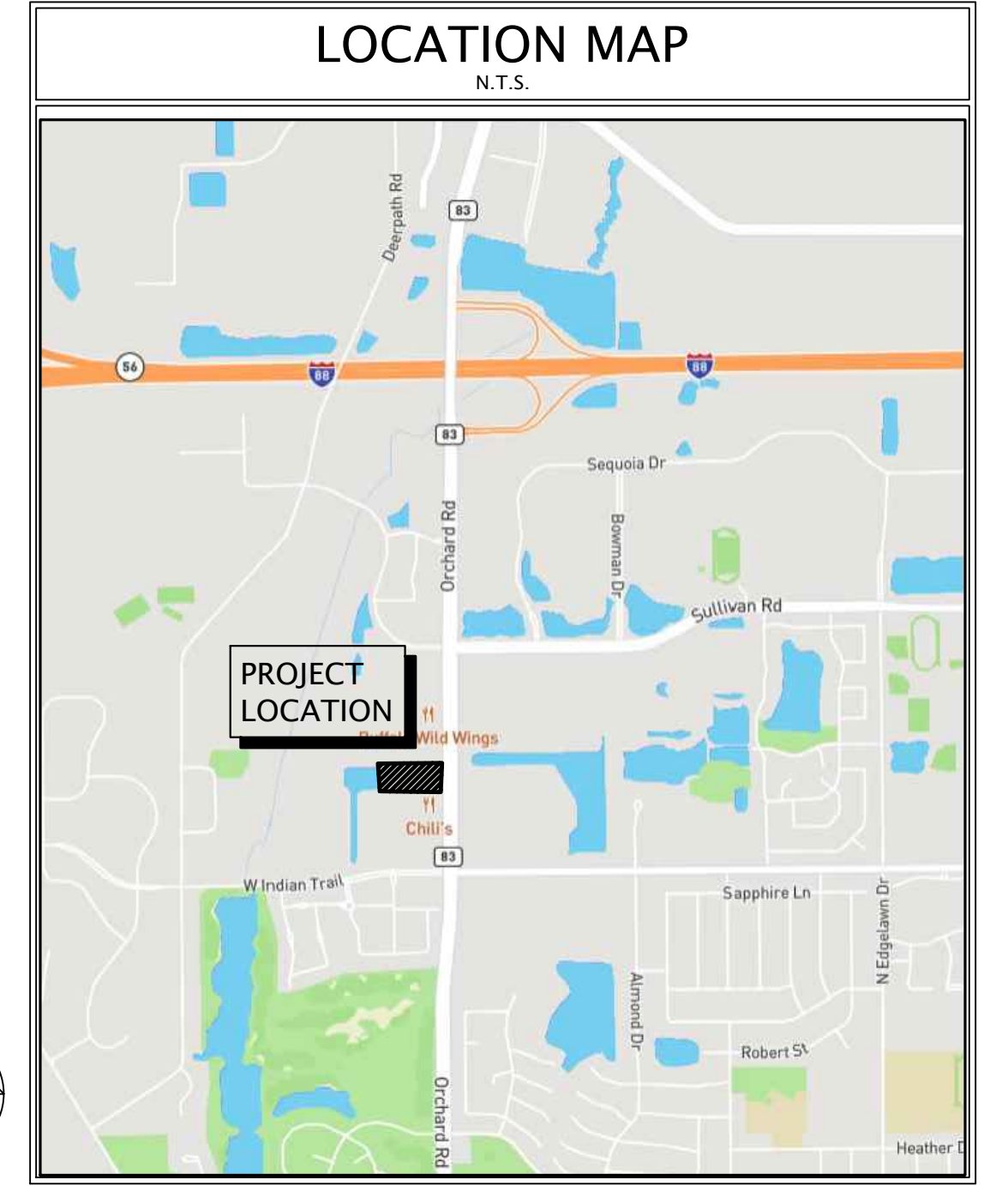

**LEGEND**

---	PROPERTY BOUNDARY	---	EXISTING CONTOUR LINE
---	EXISTING STORM SEWER	---	EXISTING SANITARY SEWER LINE
---	EXISTING WATERMAIN	---	EXISTING UNDERGROUND ELECTRIC
---	EXISTING OVERHEAD ELECTRIC	---	EXISTING GAS SERVICE
---	EXISTING TELEPHONE	---	EXISTING TELEPHONE
---	PROPOSED CONTOUR LINE	---	PROPOSED WATERMAIN
---	PROPOSED STORM SEWER	---	PROPOSED SANITARY SEWER LINE
---	PROPOSED GREASE SERVICE LINE	---	PROPOSED VENT LINE
---	EXISTING FENCELINE	---	PROPOSED SILT FENCE
---	PROPOSED SPOT SHOT	---	EXISTING SPOT SHOT
---	PROPOSED SPOT GRADE	---	EXISTING SPOT GRADE
---	EXIST	---	PROP
---	WATER: B-BOX	---	HYDRANT
---	VALVE	---	VALVE VAULT
---	INLET-CURB	---	INLET OR MANHOLE
---	FLARED END SECTION	---	CLEANOUT
---	MANHOLE	---	UTILITY POLE
---	UTILITY POLE	---	GUY WIRE LOC.
---	UTIL. CABINET	---	UTIL. PEDESTAL
---	UTIL. PEDESTAL	---	TRAFFIC SIGNAL
---	TRAFFIC SIGNAL	---	ELECTRIC VAULT
---	ELECTRIC VAULT	---	GAS VALVE
---	GAS VALVE	---	

**Landscape Data Table: CTEs Provided**

	CTE Value	Count Provided	Total CTEs Provided
Canopy Trees	1	15	15
Evergreen Trees	1/3	0	0
Understory Trees	1/3	11	4
Deciduous Shrubs	1/20	133	7
Evergreen Shrubs	1/20	133	7
<b>Total:</b>		<b>292</b>	<b>32</b>

For Trees no more than three of the same species shall be clustered together. And the goal should be that no Family shall account for more than 30%, no Genus shall account for more than 20%, and no Species shall account for more than 10% of any Planting Material Type.

ALL BUSHES SHALL BE IN MULCHED LANDSCAPE BEDS  
 ALL DISTURBED AREAS THAT ARE NOT BEING MULCHED SHALL RECEIVE A MINIMUM OF 6" OF PULVERIZED TOP SOIL & BE SEEDD

NO.	DATE	NOTES
1	1.16.23	COA DST REVIEW LETTER 1.12.23
2	1.19.23	COA DST REVIEW EMAIL 1.19.23

**LANDSCAPE NOTES**

**PART 1 – GENERAL**

**1.01 DESCRIPTION**

- A. PROVIDE TURF, TREES, SHRUBS, AND GROUND COVER AS SHOWN AND SPECIFIED. THE WORK INCLUDES:
  1. SOIL PREPARATION
  2. FERTILIZATION
  3. SEEDING
  4. TREES, SHRUBS, AND GROUND COVERS
  5. MULCH AND PLANT ACCESSORIES
  6. MAINTENANCE AND GUARANTEE
  7. CLEANING UP WORK AREAS

**1.02 QUALITY ASSURANCE**

- A. COMPLY WITH APPLICABLE LOCAL REGULATIONS.
- B. SOD: COMPLY WITH AMERICAN SOD PRODUCERS ASSOCIATION (ASPA) CLASSES OF SOD MATERIAL.
- C. PLANT NAMES INDICATED COMPLY WITH "STANDARD PLANT NAMES" AS ADOPTED BY THE LATEST EDITION OF THE AMERICAN JOINT COMMITTEE OF HORTICULTURAL NOMENCLATURE, NAMES OF VARIETIES NOT LISTED CONFORM GENERALLY WITH NAMES ACCEPTED BY THE NURSERY TRADE. PROVIDE STOCK TRUE TO BOTANICAL NAME AND LEGALLY TAGGED.
- D. COMPLY WITH SIZING AND GRADING STANDARDS OF THE LATEST EDITION OF "AMERICAN STANDARD FOR NURSERY STOCK". A PLANT SHALL BE DIMENSIONED AS IT STANDS IN ITS NATURAL POSITION.
- E. ALL PLANTS SHALL BE NURSERY GROWN UNDER CLIMATIC CONDITIONS SIMILAR TO THOSE IN THE LOCALITY OF THE PROJECT FOR A MINIMUM OF 2 YEARS.

**1.03 SUBMITTALS**

- A. SEED: SUBMIT SEED VENDOR'S CERTIFICATION FOR REQUIRED GRASS SEED MIXTURE, INDICATING PERCENTAGE BY WEIGHT, AND PERCENTAGES OF PURITY, GERMINATION, AND WEED SEED FOR EACH GRASS SPECIES.
- B. SOD: SUBMIT SOD GROWER'S CERTIFICATION OF GRASS SPECIES. IDENTIFY SOURCE.
- C. MULCH
- D. STRAW BLANKET

**1.04 DELIVERY, STORAGE, AND HANDLING**

- A. SEED: DELIVER SEED AND FERTILIZER MATERIALS IN ORIGINAL UNOPENED CONTAINERS, SHOWING WEIGHT, ANALYSIS, AND NAME OF MANUFACTURER. STORE IN MANNER TO PREVENT WETTING AND DETERIORATION.
- B. SOD: DELIVER AND INSTALL SOD CUT WITHIN 48-HOUR PERIOD.
- C. DELIVER FERTILIZER MATERIALS IN ORIGINAL, UNOPENED, AND UNDAMAGED CONTAINERS SHOWING WEIGHT, ANALYSIS, AND NAME OF MANUFACTURER. STORE IN MANNER TO PREVENT WETTING AND DETERIORATION.
- D. TAKE ALL PRECAUTIONS CUSTOMARY IN GOOD TRADE PRACTICE IN PREPARING PLANTS FOR MOVING. WORKMANSHIP THAT FALLS TO MEET THE HIGHEST STANDARDS WILL BE REJECTED. DIG, PACK, TRANSPORT, AND HANDLE PLANTS WITH CARE TO ENSURE PROTECTION AGAINST INJURY. INSPECTION CERTIFICATES REQUIRED BY LAW SHALL ACCOMPANY EACH SHIPMENT INVOICE OR ORDER TO STOCK AND ON ARRIVAL: THE CERTIFICATE SHALL BE FILLED WITH THE LANDSCAPE ARCHITECT. PROTECT ALL PLANTS FROM DYING OUT, IF PLANTS CANNOT BE PLANTED IMMEDIATELY UPON DELIVERY, PROPERLY PROTECT THEM WITH SOIL, OR MULCH. WATER HEEL-IN PLANTINGS REGULARLY.
- E. COVER PLANTS TRANSPORTED ON OPEN VEHICLES WITH A PROTECTIVE COVERING TO PREVENT WINDBURN, WHEN IN LEAF.

**1.05 PROJECT CONDITIONS**

- A. CONFIRM THAT THE QUALITY AND DEPTH OF TOPSOIL IS SATISFACTORY PRIOR TO BEGINNING FINE GRADING.
- B. FINE GRADING MUST BE APPROVED BY OWNER PRIOR TO START OF SEEDING OR SODDING.
- C. PERFORM GRASSING WORK ONLY AFTER PLANTING AND OTHER WORK AFFECTING GROUND SURFACE HAS BEEN COMPLETED.
- D. INSTALL SEED UNDER FAVORABLE WEATHER CONDITIONS UNLESS APPROVED BY THE OWNER'S REPRESENTATIVE. THE GENERALLY ACCEPTED TIMES FOR SEEDING ARE:
  - SPRING – APRIL 1ST TO MAY 31ST
  - FALL – AUGUST 15TH TO SEPTEMBER 30TH

**1.06 GUARANTEE**

- A. GUARANTEE ALL WORK FOR ONE YEAR FOLLOWING THE DATE OF INSTALLATION.
- B. AT THE END OF THE GUARANTEE PERIOD, RESEED AND RESED AREAS WITH SPECIFIED MATERIALS, WHICH FAIL TO PROVIDE A UNIFORM STAND OF GRASS.
- C. REPLACE, IN ACCORDANCE WITH THE DRAWINGS AND SPECIFICATIONS, ALL PLANTS THAT ARE DEAD OR, AS DETERMINED BY THE LANDSCAPE ARCHITECT, ARE IN AN UNHEALTHY OR UNSIGHTLY CONDITION.
- D. GUARANTEE SHALL NOT INCLUDE DAMAGE OR LOSS OF TREES, PLANTS, GROUND COVERS, OR TURF CAUSED BY FIRES, FLOODS, FREEZING RAINS, LIGHTNING STORMS, OR WINDS OVER 75 MILES PER HOUR, WINTER KILL CAUSED BY EXTREME COLD AND SEVERE WINTER CONDITIONS NOT TYPICAL OF PLANTING AREA; OR ACT OF VANDALISM.

**PART 2 – PRODUCTS**

**2.01 MATERIALS**

- A. SEED/SOD FERTILIZER:
  1. GRANULAR, 10-10-10. ALL PURPOSE AT A RATE OF 1LBS N-P-K PER 1,000 S.F.
  2. PLANT FERTILIZER:
    1. PROVIDE A GRANULAR COMMERCIAL FERTILIZER WITH AN ANALYSIS OF 10-10-10.
- C. SEED:
  1. LAWN SEED: FRESH, CLEAN SEED FROM MOST RECENTLY HARVESTED CROP WHICH COMPLIES WITH ALL LOCAL, STATE, AND FEDERAL SEED AND WEED LAWS IS FREE FROM POA ANNUAL, BENT GRASS AND NOXIOUS WEEDS.
  2. BLEND: PERCENT BY WEIGHT:
    - FIELD OF DREAMS RESEEDER MIX, (AS AVAILABLE FROM NATURAL SEED, DOWNERS GROVE, IL)
    - 2 – NAMED KENTUCKY BLUE GRASSES 50%
    - 2 – NAMED TURF TYPE PERENNIAL GRASSES 50%
  3. BOTTOM OF STORM WATER MANAGEMENT BASINS TO BE OVER SEEDED WITH RED TOP SEED AT A RATE OF 50 LBS PER ACRE.
- D. PLANTS: PROVIDE PLANTS TYPICAL OF THEIR SPECIES OR VARIETY WITH NORMAL, DENSELY DEVELOPED BRANCHES AND VIGOROUS, FIBROUS ROOT SYSTEMS. ONLY SOUND, HEALTHY, PLANTS FREE FROM DEFECTS, SUN SCALD INJURIES, FROST CRACKS, ABRASIONS OF THE BARK, PLANT DISEASE, INSECT EGGS, BORERS, AND ALL FORMS OF INFESTATION. ALL PLANTS SHALL HAVE A FULL DEVELOPMENT FORM.
  1. DIG BALLED AND BURLAPPED PLANTS WITH FIRM, NATURAL BALLS OR EARTH. PROVIDE BALL SIZES COMPLYING WITH THE LATEST EDITION OF THE "AMERICAN STANDARD FOR NURSERY STOCK".
  2. PROVIDE SHADE AND EVERGREEN TREE SPECIES WITH A SINGLE MAIN TRUNK UNLESS OTHERWISE SPECIFIED OR ACCEPTED.
  3. PROVIDE PLANTS MATCHED IN FORM WHEN ARRANGED IN GROUPS.
  4. PROVIDE EVERGREEN TREES BRANCHED TO THE GROUND UNLESS OTHERWISE SPECIFIED OR ACCEPTED.
  5. PROVIDE SHRUBS AND SMALL PLANTS MEETING THE REQUIREMENTS FOR SPREAD AND HEIGHT INDICATED IN THE PLANT LIST.
    - 5.a. THE MEASUREMENTS FOR HEIGHT SHALL BE TAKEN FROM THE GROUND LEVEL TO THE AVERAGE HEIGHT OF THE TOP OF THE PLANT AND NOT THE LONGEST BRANCH.

**PART 3 – EXECUTION**

**3.01 INSPECTION**

- A. EXAMINE FINISH SURFACE GRADES, TOPSOIL QUALITY, DEPTH, AND CONDITIONS OF INSTALLATIONS.

**3.02 PREPARATION**

- A. LOOSEN TOPSOIL OF LAWN AREAS TO MINIMUM DEPTH OF 2". REMOVE STONES OVER 1" IN ANY DIMENSION AND STICKS, ROOTS, RUBBISH, AND EXTRANEOUS MATTER.
- B. GRADE LAWN AREAS TO SMOOTH, FREE DRAINING AND EVEN SURFACE WITH A LOOSE, UNIFORMLY FINE TEXTURE. MECHANICALLY OR MANUALLY RAKE; REMOVE RIDGES AND FILL DEPRESSIONS AS REQUIRED TO DRAIN.
- C. RESTORE PREPARED AREAS TO SPECIFIED CONDITION IF ERODED, SETTLED, OR OTHERWISE DISTURBED AFTER FINE GRADING AND PRIOR TO SEEDING OR SODDING.
- D. TIME OF PLANTING:
  1. EVERGREEN MATERIAL; PLANT EVERGREEN MATERIALS BETWEEN SEPTEMBER 2ND AND NOVEMBER 1ST OR IN SPRING BEFORE NEW GROWTH BEGINS
  2. DECIDUOUS MATERIAL; PLANT DECIDUOUS MATERIALS IN A DORMANT CONDITION OR PRE-DIG AND HEAL UNTIL SITE IS READY.
- E. LOCATE PLANTS AS INDICATED AND APPROVED IN THE FIELD BY THE LANDSCAPE ARCHITECT.
- F. ROTOTILL ALL GROUND COVER BEDS.
- G. PROVIDE SHRUB PITS AT LEAST 8" GREATER THAN THE DIAMETER OF THE ROOT SYSTEM AND 12" GREATER FOR TREES.

**3.03 SEED INSTALLATION**

- A. TURF AREAS:
  1. SEED IMMEDIATELY AFTER PREPARATION OF BED.
  2. PERFORM SEEDING OPERATIONS WHEN THE SOIL IS DRY AND WHEN WINDS DO NOT EXCEED 20 MILES PER HOUR VELOCITY.
  3. SOW SEED AT 300 LBS. PER ACRE.
    - 3.a. CONVENTIONAL SEEDING:
      - 3.a.1. APPLY SEED WITH A ROTARY OR DROP TYPE DISTRIBUTOR. SEED EVENLY.
      - 3.a.2. AFTER SEEDING, RAKE SOIL SURFACE LIGHTLY TO INCORPORATE SEED.
    - 3.b. WITHIN 24 HOURS, PLACE STRAW BLANKET OVER ALL SEEDED AREAS. PLACE BLANKET PERPENDICULAR TO CONTOUR LINES AND FASTEN IN PLACE PER MANUFACTURER'S RECOMMENDATIONS.

**3.04 PLANT INSTALLATION**

- A. TREES AND SHRUBS:
  1. SET PLANT MATERIAL IN THE PLANTING PIT TO PROPER GRADE AND ALIGNMENT. DO NOT FILL AROUND TRUNKS OR STEMS.
  2. AFTER BALLED OR BURLAPPED PLANTS ARE SET, FILL ALL VOIDS.
  3. MIX APPROVED COMMERCIAL FERTILIZER AT 10 LBS. PER CUBIC YARD OF BACKFILL.
- B. GROUND COVERS:
  1. WHERE GROUND COVERS ARE SPECIFIED ON THE PLANS, ROTOTILL ENTIRE PLANT BED TO 6" DEPTH USING AMENDED TOPSOIL. INCORPORATE COMMERCIAL 10-10-10 FERTILIZER INTO PREPARED SOIL MIXTURE AT AN APPROPRIATE RATE OF 1 LB. PER SQUARE YARD.
- C. MULCHING:
  1. MULCH TREE AND SHRUB PLANTING PITS AND SHRUB BEDS WITH REQUIRED MULCHING MATERIAL 3" DEEP IMMEDIATELY AFTER PLANTING. THOROUGHLY WATER MULCHED AREAS. AFTER WATERING, RAKE MULCH TO PROVIDE A UNIFORM FINISHED SURFACE.
- D. WRAPPING:
  1. INSPECT TREES FOR INJURY TO TRUNKS, EVIDENCE OF INSECT INFESTATIONS, AND IMPROPER PRUNING BEFORE WRAPPING.
  2. WRAP TRUNKS OF ALL TREES SPIRALLY FROM BOTTOM TO TOP WITH SPECIFIED TREE WRAP AND SECURE IN PLACE. WRAPPING IS AT THE DISCRETION OF THE CONTRACTOR.

**E. PRUNING:**

1. PRUNE BRANCHES OF DECIDUOUS STOCK, AFTER PLANTING, TO PRESERVE THE NATURAL CHARACTER APPROPRIATE TO THE PARTICULAR PLANT REQUIREMENTS. IN GENERAL, REMOVE APPROXIMATELY ¼ OF THE LEAF BEARING BUDS. REMOVE OR CUT BACK BROKEN, DAMAGED, AND UNSYMMETRICAL GROWTH OF NEW WOOD.
2. MULTIPLE LEADER PLANTS: PRESERVE THE LEADER WHICH WILL BEST PROMOTE THE SYMMETRY OF THE PLANT. CUT BRANCHES FLUSH WITH THE TRUNK OR MAIN BRANCH, AT DIAMETER OF THE SUPPORTING BRANCH. MAKE CUT ON AN ANGLE.
3. PRUNE EVERGREENS ONLY TO REMOVE BROKEN OR DAMAGED BRANCHES.

**3.05 FINAL COMPLETION, INSPECTION, AND ACCEPTANCE**

- A. UPON COMPLETION INSPECTION OF ALL WORK WILL BE MADE BY THE OWNER OR HIS REPRESENTATIVE. AT THAT TIME IF ALL WORK IS SATISFACTORY, THAT WILL CONSTITUTE FINAL ACCEPTANCE.
- B. SEEDED AREAS WILL BE INSPECTED AT COMPLETION OF THE INSTALLATION AND ACCEPTED SUBJECT TO COMPLIANCE WITH SPECIFIED MATERIALS AND INSTALLATION REQUIREMENTS.
  1. SEEDED AREAS WILL BE ACCEPTABLE PROVIDED ALL REQUIREMENTS, HAVE BEEN COMPLIED WITH.
  2. NO SEEDED AREAS SHALL HAVE BARE SPOTS OR UNACCEPTABLE COVER TOTALING MORE THAN 2% OF THE INDIVIDUAL AREAS, IN AREAS REQUESTED TO BE INSPECTED.
- C. INSPECTION OF ALL WORK SHALL BE MADE UPON REQUEST OF CONTRACTOR. AT THAT TIME, IF ALL WORK IS SATISFACTORY, THAT WILL CONSTITUTE FINAL ACCEPTANCE.
- D. PLANTS THAT HAVE DIED OR ARE IN UNHEALTHY OR BADLY IMPAIRED CONDITION UPON INSPECTION SHALL BE TREATED OR REPLACED AT NO ADDITIONAL COST TO OWNER.
- E. REPLACE REJECTED PLANTS IN THE SEASON THAT IS MOST FAVORABLE FOR RESETTING KINDS OF PLANTS REQUIRED.

**3.06 CLEANING**

- A. PERFORM CLEANING DURING INSTALLATION OF THE WORK AND UPON COMPLETION OF THE WORK. REMOVE FROM SITES ALL EXCESS MATERIALS, SOIL, DEBRIS, AND EQUIPMENT.

**4.01 MISC. NOTES**

- A. ALL GRADES TO BE ESTABLISHED TO MEET ENGINEERING DRAWINGS BY OTHERS.
- B. BASIN BOTTOMS SEED, BLOW WITH STRAW MULCH AND CRIMP STRAW IN PLACE, AS NOTED ON PLANS.
- C. SEED AND INSTALL STRAW BLANKET ALL OTHER TURF AREAS.
- D. ALL DISTURBED AREAS THAT ARE NOT MULCHED SHALL BE SEEDED.

**AURORA ILLINOIS** Planning and Zoning Division 1 S. Broadway, 2nd Floor, Aurora, IL  
CITY OF LIGHTS phone (630) 256-3080 fax (630) 256-3081 email COAPlanning@aurora-il.org

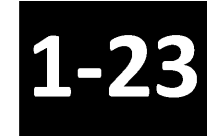

**Landscape Material Worksheet**

**Project Number:** 2021.231  
**Petitioner:** The Tito Group, LLC

**Proposed Street Trees (Minimum of 4 unique entries required)**

Family	Genus	Species	Common Name

**Proposed Canopy Trees (Minimum of 4 unique entries required)**

Family	Genus	Species	Common Name	
Sapindaceae	Acer	acer rubrum	Autumn Blaze Maple	<b>AUTM (4)</b>
Fabaceae	Caesalpinioideae	gymnocladus dioicus	Kentucky Coffee	<b>COFF (4)</b>
Fagaceae	Quercus	quercus bicolor	Swamp White Oak	<b>OAK (4)</b>
Aceraceae	Acer L.	Acer saccharum	Sugar Maple	<b>SUGAR (3)</b>

**Proposed Evergreen Trees (Minimum of 4 unique entries required)**

Family	Genus	Species	Common Name

**Proposed Understory Trees (Minimum of 4 unique entries required)**

Family	Genus	Species	Common Name	
Rosaceae	Pyrus	pyrus calleryana	Bradford Pear	<b>PEAR (3)</b>
Betulaceae	Betula	betula nigra	River Birch	<b>BIRCH (2)</b>
Rosaceae	Amelanchier	amelanchier laevis	Allegheny Serviceberry	<b>BERRY (3)</b>
Cornaceae	Cornus	Cornus florida	Flowering Dogwood	<b>DOG (3)</b>

**Proposed Deciduous Shrubs (Minimum of 4 unique entries required)**

Family	Genus	Species	Common Name	
Celastraceae	euonymus	euonymus alatus	Dwarf Burning Bush	<b>BURN (34)</b>
Rosaceae	Physocarpus	physocarpus opulifolius	Common Ninebark	<b>NINE (33)</b>
Hydrangeaceae	Hydrangea	hydrangea	Annabelle Hydrangea	<b>HYDR (34)</b>
Caprifoliaceae	Diervilla Mill		Bush Honeysuckle	<b>HONEY (32)</b>

**Proposed Evergreen Shrubs (Minimum of 4 unique entries required)**

Family	Genus	Species	Common Name	
Buxaceae	buxus	buxus x "glencoe"	Chicagoland Green Boxwood	<b>BOX (36)</b>
cupressaceae	thuja	thuja	Arborvitae	<b>ARBOR (33)</b>
Berberidaceae	berberis L.	berberis	Barberry	<b>BAR (32)</b>
Cupressaceae	Juniperus	Juniperus Chinesis	Blue Point Juniper	<b>JUNIP (32)</b>

For Trees no more than three of the same species shall be clustered together. And the goal should be that no Family shall account for more than 30%, no Genus shall account for more than 20%, and no Species shall account for more than 10% of any Planting Material Type.

The Landscape Materials are subject to review and approval by the Review Planner.

Verified By: \_\_\_\_\_ Date: \_\_\_\_\_

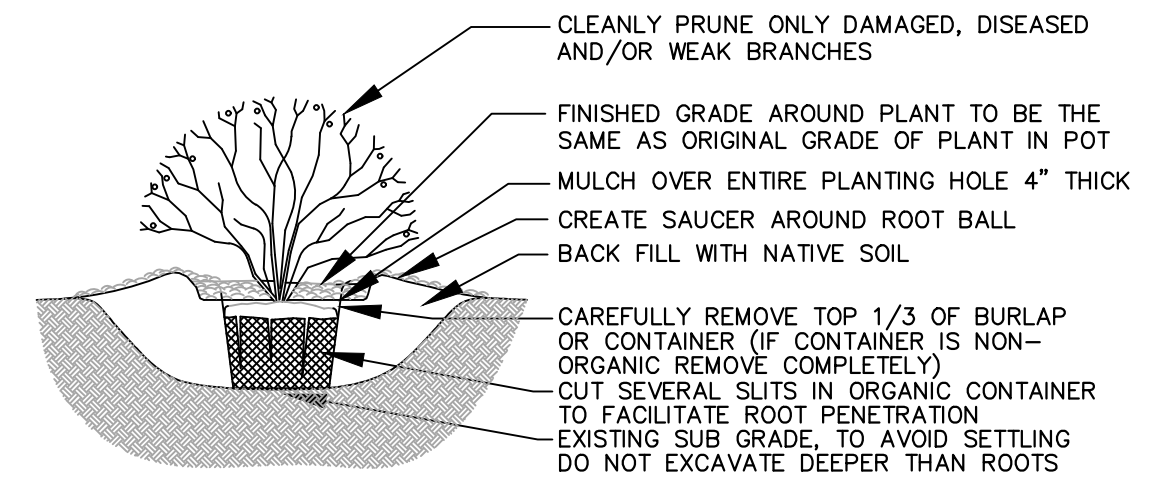

**NOTES:**

1. WATER THOROUGHLY AFTER INSTALLATION.
2. USE EXISTING SOIL AS BACK FILL. IF DIRECTED BY OWNER, AMEND WITH 1/3 COMPOST.
3. ALL SHRUBS TO BE MULCH OVER ENTIRE PLANTING HOLE

**SHRUB DETAIL – CONTAINER OR B&B**

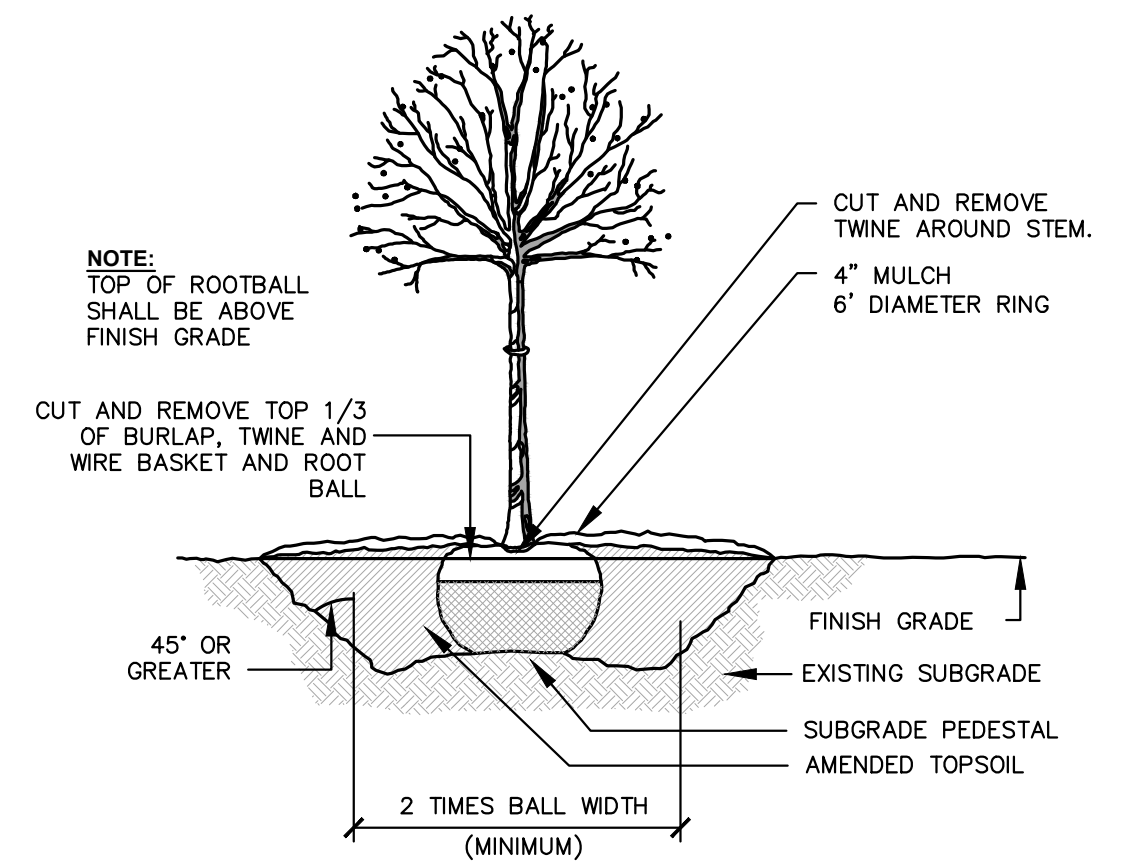

**TREE DETAIL**  
N.T.S.

ALL DISTURBED AREAS THAT ARE NOT BEING MULCHED SHALL RECEIVE A MINIMUM OF 6" OF PULVERIZED TOP SOIL & BE SEEDED

**TEBRUGGE ENGINEERING**  
410 E. CHURCH STREET - SUITE A • SANDWICH, IL 60548  
PHONE: (815) 786-0195 • TEBRUGGEENGINEERING.COM

NO.	DATE	NOTES
1	1.16.23	COA DST REVIEW LETTER 1.12.23
2	1.19.23	COA DST REVIEW EMAIL 1.19.23

PREPARED FOR:  
**THE TITO GROUP, LLC**  
88 N DUGAN RD, SUGAR GROVE, IL

**LANDSCAPE PLAN FOR LOT 7 OF ORCHARD ROAD SUBDIVISION**  
**LANDSCAPE DETAILS**

PROJECT NO.	22 535 01	SHEET NO.	2
SCALE:	NTS		
DATE:	NOV 2, 2022		OF 2 SHEETS