

Legal Description

SEE ATTACHED

Locator Map

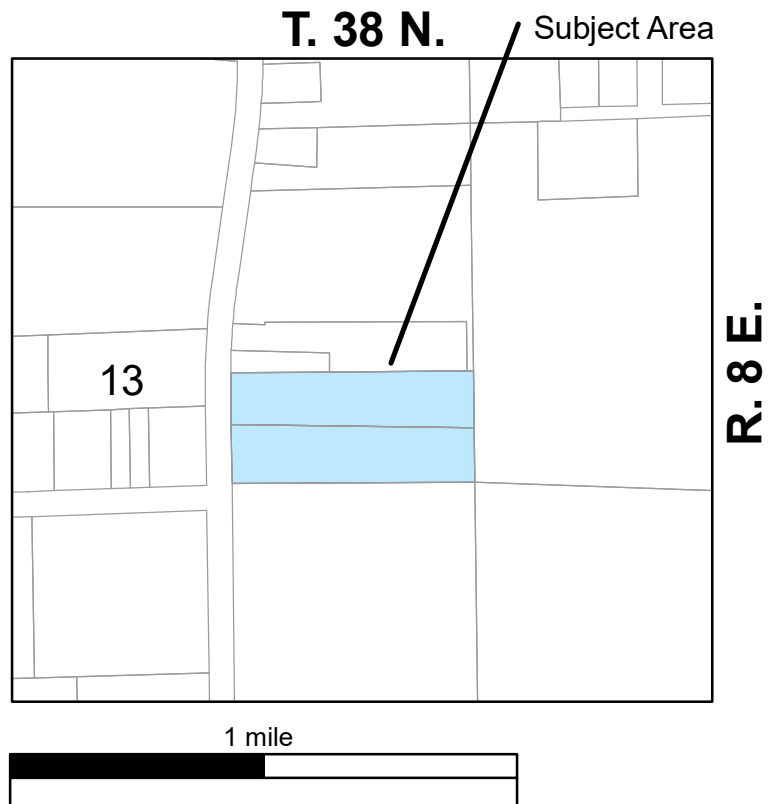

Actual Area

PIN(s)

15-13-326-008
15-13-326-009

Common Address

733 & 743 McClure Road



LEGAL DESCRIPTION

THAT PART OF THE SOUTH 1/2 OF SECTION 13, TOWNSHIP 38 NORTH, RANGE 8, EAST OF THE THIRD PRINCIPAL MERIDIAN, DESCRIBED AS FOLLOWS: COMMENCING AT THE LOCATION OF A MONUMENTAL STONE SET BY GEORGE WILDER, FORMER COUNTY SURVEYOR, TO MARK THE NORTHEAST CORNER OF THE SOUTHWEST 1/4 OF SECTION 13; THENCE SOUTHERLY, ALONG THE WEST LINE OF SAID SOUTHWEST 1/4, AS MONUMENTED AND OCCUPIED, 641.24 FEET TO THE POINT OF BEGINNING; THENCE CONTINUING SOUTHERLY, ALONG THE LAST DESCRIBED COURSE, 147.96 FEET; THENCE WESTERLY, ALONG A LINE FORMING AN ANGLE OF 90 DEGREES 04 MINUTES 40 SECONDS WITH THE LAST DESCRIBED COURSE (AS MEASURED CLOCKWISE THEREFROM), 693.58 FEET TO THE WESTERLY LINE OF MCCLURE ROAD; THENCE NORTHERLY, ALONG SAID WESTERLY LINE, FORMING AN ANGLE OF 89 DEGREES 52 MINUTES 09 SECONDS WITH THE LAST DESCRIBED COURSE (AS MEASURED COUNTER CLOCKWISE THEREFROM), 147.96 FEET; THENCE EASTERLY, ALONG A LINE FORMING AN ANGLE OF 90 DEGREES 08 MINUTES 00 SECONDS WITH THE LAST DESCRIBED COURSE (AS MEASURED COUNTER CLOCKWISE THEREFROM), 693.04 FEET TO THE POINT OF BEGINNING, IN THE CITY OF AURORA, KANE COUNTY, ILLINOIS.