

**Legal Description**

See Attached

**Locator Map**

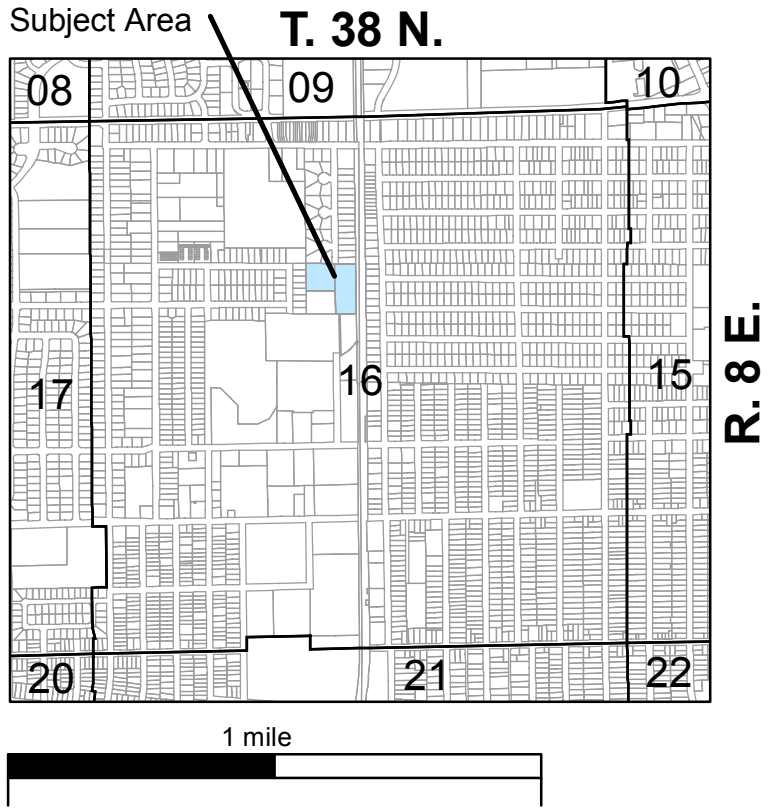

**Actual Area**

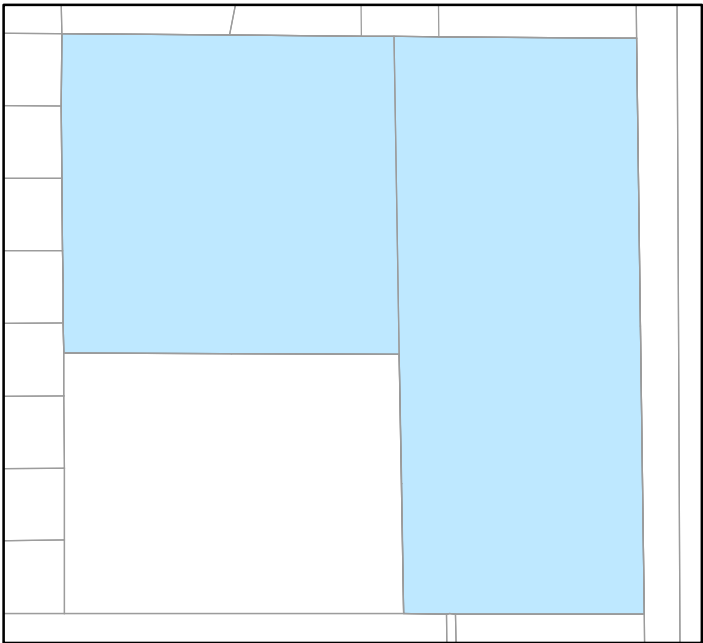

**PIN(s)**

15-16-177-011  
15-16-177-013

**Common Address**

Vacant Land



## LEGAL DESCRIPTION OF SUBJECT PROPERTY

Parcel A PIN# 15-16-177-011

That part of the Northwest Quarter of Section 16, Township 38 North, Range 8 East of the Third Principal Meridian described as follows: Commencing at the northwest corner of said Northwest Quarter; thence South 0°35' West along the West line of said Quarter 239.60 feet; thence South 89°19' East 1325.40 feet; thence South 0°40' West 1168.40 feet; thence South 88°54' East 1095.3 feet for a point of beginning; thence continuing South 88°54' East 203.00 feet to the West line of the former Chicago, Burlington and Quincy Railroad Company; thence South 0°15' West 500.0 feet; thence North 88°54' West 203.00 feet to a line parallel with said West line of the former Chicago, Burlington and Quincy Railroad Company; thence North 0°15' East along said parallel line 500.00 feet to the point of beginning in the City of Aurora, Kane County, Illinois and containing 2.330 acres.

Parcel B PIN# 15-16-177-013

That part of the Northwest Quarter of Section 16, Township 38 North, Range 8 East of the Third Principal Meridian, described as follows: Beginning at the northeast corner of Pearl Gardens Second Addition, Recorded August 9, 1983 as Document Number 1648475, also being the southwest corner of Indian Trail Estates, Recorded March 27, 1962 as Document Number 973766; thence South 89 degrees 50 minutes 23 seconds East along the south line of said Indian Trail Estates 287.25 feet to a line 203.00 feet west of and parallel with the westerly right of way line of the B.N.S.F. Railroad (formerly C.B. & Q. Railroad); thence South 00 degrees 40 minutes 10 seconds East along said parallel line 275.00 feet; thence North 89 degrees 50 minutes 23 seconds West parallel with said south line of Indian Trail Estates, 287.20 feet to the east line of said of Pearl Gardens Second Addition; thence North 00 degrees 40 minutes 49 seconds West along said east line of Pearl Gardens Second Addition, 275.00 feet to the point of beginning, in Kane County, Illinois. Said parcel containing 1.813 acres, (78,979 square feet), more or less.

Property Address: Vacant Lot East of Russell Avenue & North of New Haven Avenue