

Property Research Sheet

Location ID#(s): 63635

As of: 4/8/2020

Researched By: Steve Broadwell

Address: NO STREET ADDRESS

Current Zoning: Unincorporated, Kane County zoning

Parcel Number(s): 15-24-276-015

Comp Plan Designation: Industrial

Size: 4.42 Acres / 192,535 Sq. Ft.

ANPI Neighborhood: Light of the Community

School District: SD 131 - East Aurora School District

Park District: FVPD - Fox Valley Park District

Current Land Use

Current Land Use: Industry ..

AZO Land Use Category: Processing, finishing and assembly facilities (3140)

Number of Buildings: 1

Total Building Area: 3,200 sq. ft.

Building Built In: 2019

Zoning Provisions

Unincorporated Property, no current City of Aurora zoning provisions.

Legislative History

The known legislative history for this Property is as follows:

R1999-063 approved on 3/9/1999: RECOMMENDING APPROVAL OF THE KANE COUNTY REZONING PETITION FILED BY DUKANE PRECAST, INC. TO REZONE PROPERTY LOCATED ON THE NORTH SIDE OF LIBERTY EAST OF SARTOR LANE FROM F-FARMING TO I-INDUSTRIAL

R2008-029 approved on 1/29/2008: A RESOLUTION ADOPTING THE LIGHT OF THE COMMUNITY NEIGHBORHOOD PLAN CREATED AS PART OF THE AURORA NEIGHBORHOOD PLANNING INITIATIVE (WARD 7).

Location Maps Attached:

Aerial Overview

Location Map

Zoning Map

Comprehensive Plan Map

Aerial Photo (1:5,000):



Sartor Ln

Liberty St

Legend

Subject Property



Planning & Zoning Division

N



Source: Esri, DigitalGlobe, GeoEye, Earthstar Geographics, CNES/Airbus DS, USDA, USGS, AeroGRID, IGN, and the GIS User Community

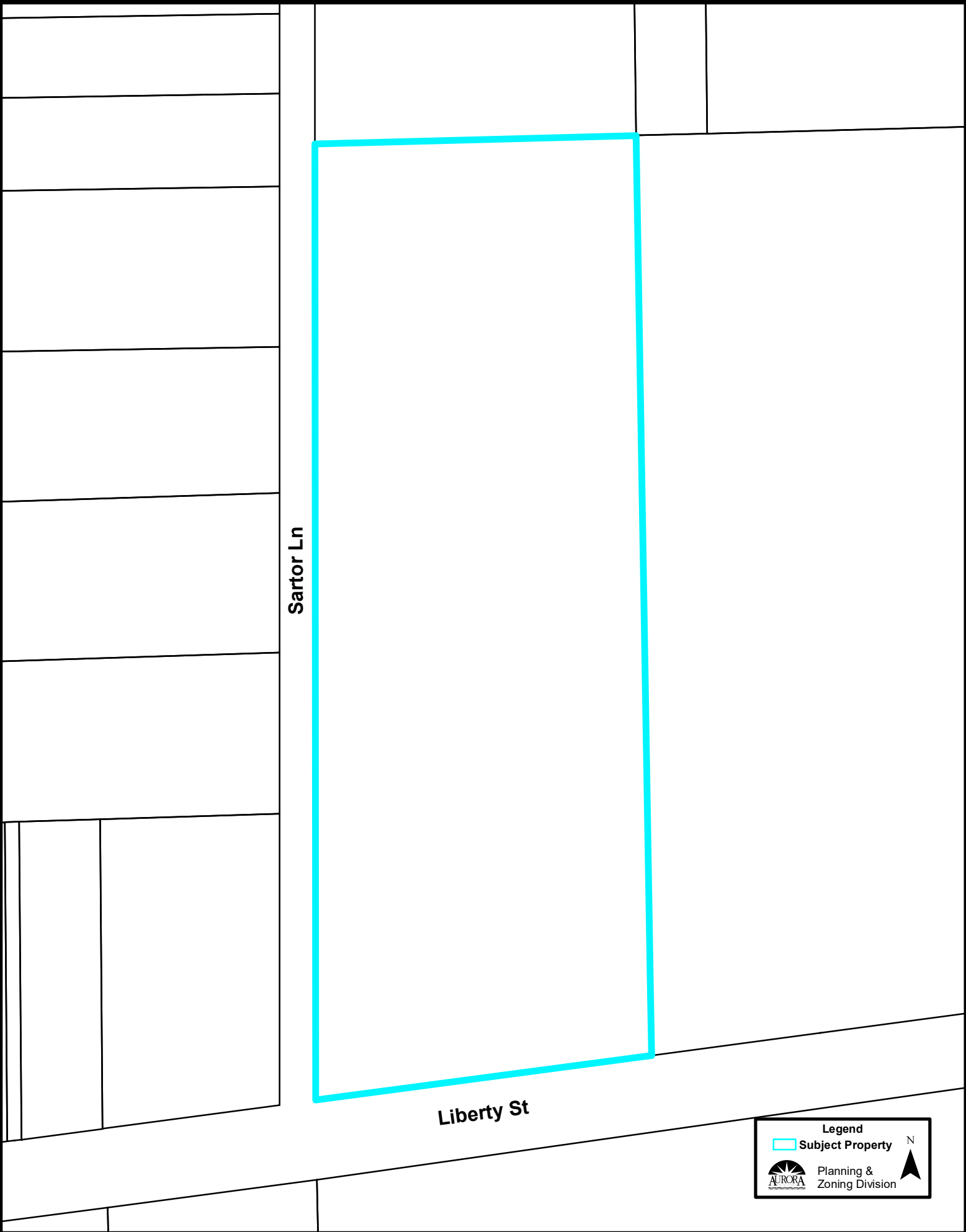

Sartor Ln

Liberty St

Legend

 Subject Property

 Planning & Zoning Division

N



Zoning Map (1:5,000):

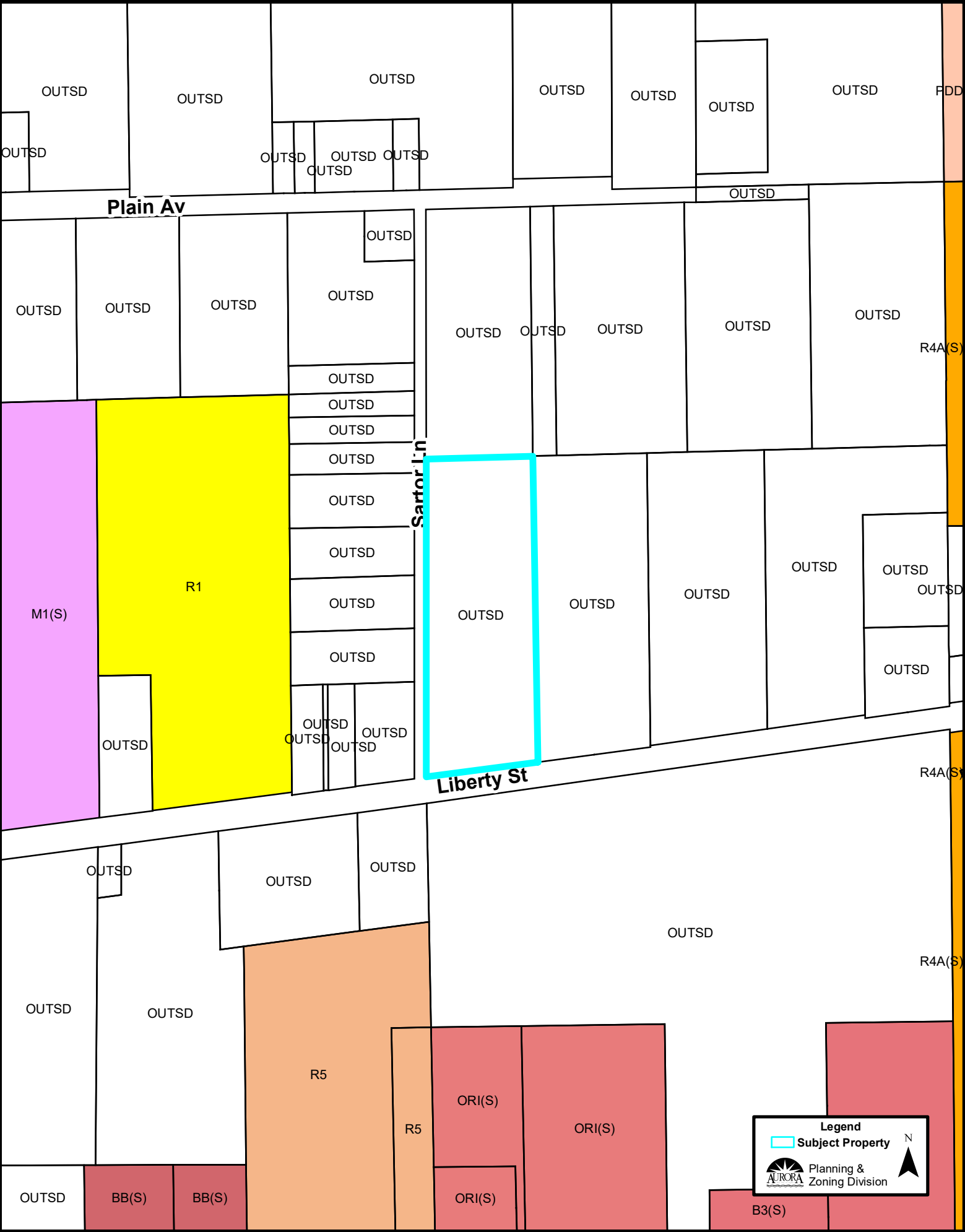

Legend

 Subject Property

 Planning & Zoning Division



Comprehensive Plan (1:5,000):

