

LANDSCAPE IMPLEMENTATION PLAN

FOR LAURELTON PLACE

Landscape Data Table: Planting Material Key	
Note: Symbols are blackline for proposed grayscale for existing	
Canopy Trees (minimum size 2.5 caliper) Count:	121
Evergreen Trees (minimum size 6 feet) Count:	14
Understory Trees (minimum size 2.5 caliper or 8 feet if multi-stemmed) Count:	13
Evergreen Shrubs (minimum of 18 inches) Count:	96
Deciduous Shrubs (minimum of 18 inches) Count:	89
Ornamental Grasses Count:	0
Perennials Count:	0
Annuals Count:	0
Groundcover Square Footage:	8375
Turf (Seeded) Square Footage:	8375
Turf (Sod) Square Footage:	0
Native Prairie Planting Square Footage:	60840
Native Wetland Planting Square Footage:	22717

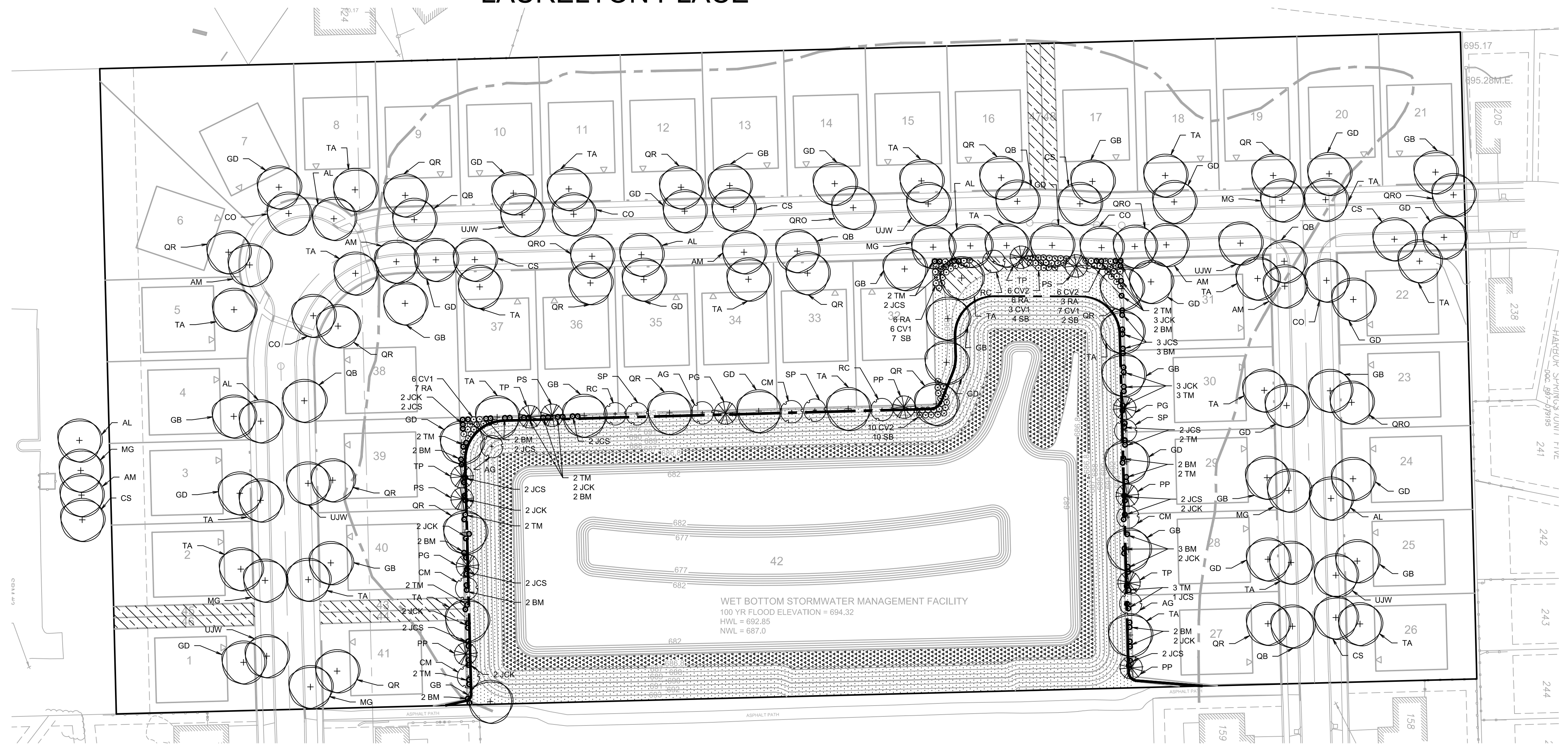

Landscape Data Table: CTEs Provided			
	CTE Value	Count Provided	Total CTEs Provided
Canopy Trees	1	121	121
Evergreen Trees	1/3	14	5
Understory Trees	1/3	13	4
Deciduous Shrubs	1/20	89	4
Evergreen Shrubs	1/20	96	5
Total:		333	139

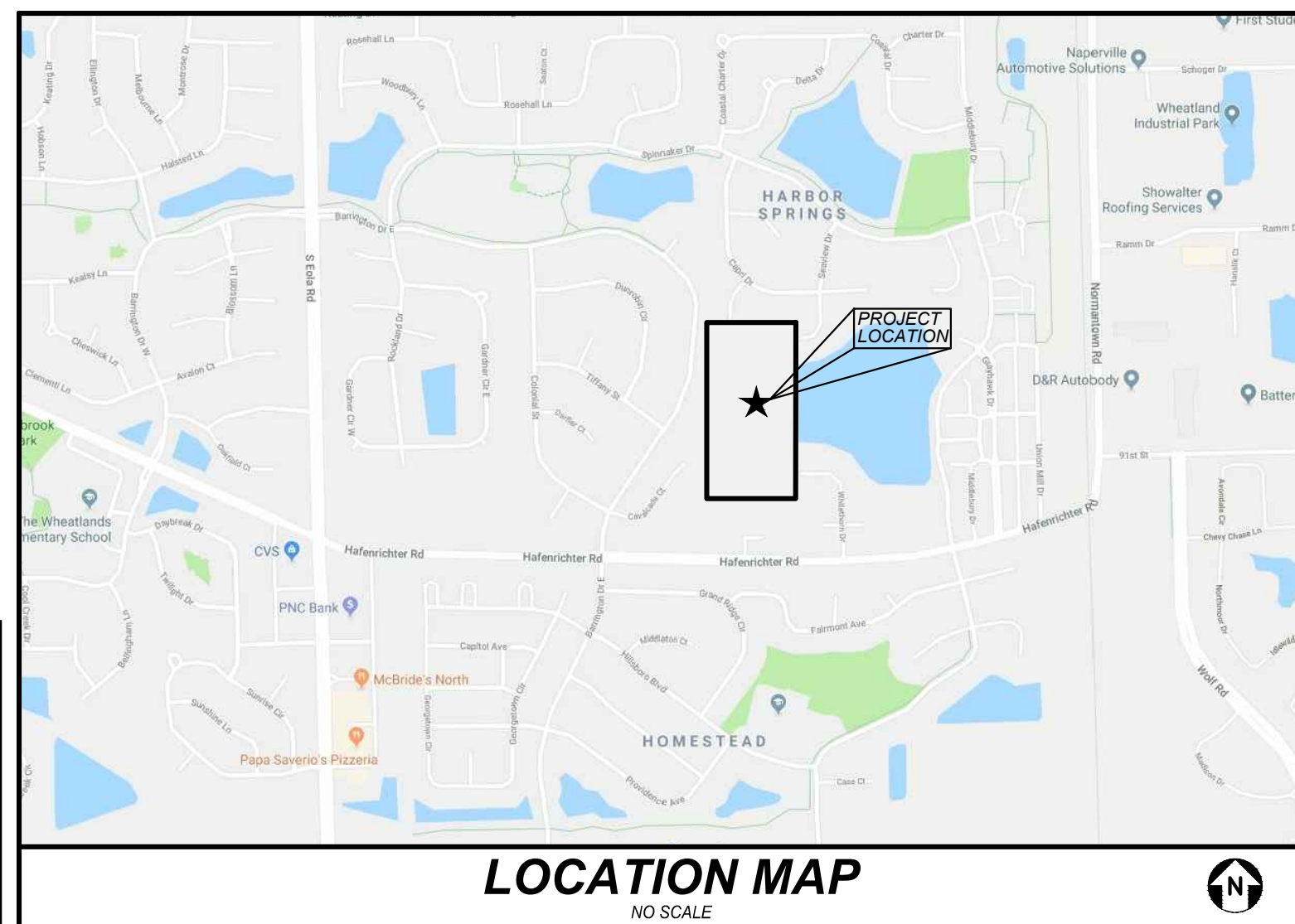

Landscape Implementation Data Table: Plan List by Categor							
	QTY	Percent	SYM	BOTANICAL NAME (Family/ Genus / Species)	COMMON NAME	SIZE	COMMENTS
Canop Trees	21	17%	GD	Fabaceae Gymnocladus dioicus	Kentucky Coffee tree		
	15	12%	QR	Fagaceae Quercus rubra	Northern Red Oak		
	15	12%	GB	Ginkgoaceae Ginkgo biloba	Ginkgo		
	6	5%	MG	Taxodiaceae Metasequoia glyptostroboides	Dawn Redwood		
	6	5%	UJW	Ulmaceae Ulmus japonica x wilsonia	Accolade Elm		
	5	4%	QRO	Fabaceae Quercus robur	English Oak		
	6	5%	QB	Fagaceae Quercus bicolor	Swamp White Oak		
	5	4%	CO	Ulmaceae Celtis occidentalis	Hackberry		
	6	5%	AM	Aceraceae Acer miyabei	State Street Miyabe Maple		
	6	5%	AL	Rosaceae Amelanchier laevis	Allegheny Serviceberry		
Total:	121	100%					
Evergreen Trees	4	29%	PP	Pinaceae Picea pungens	Colorado Spruce		
	3	21%	PG	Pinaceae Picea glauca 'Densata'	Black Hills Spruce		
	3	21%	PS	Pinaceae Picea strobus	White Pine		
	4	29%	TP	Cupressaceae Thuja plicata	Giant Arborvitae		
Total:	14	100%					
Understory Trees	3	23%	AG	Rosaceae Amelanchier x grandifolia	Autumn Brilliance Serviceberry		
	4	31%	CM	Cornaceae Cornus mas	Golden Glory Cornelian Dogwood		
	3	23%	SP	Oleaceae Syringa pekinensis	China Snow Peking Lilac		
	3	23%	RC	Anacardiaceae Rhus copallina	Flameleaf Sumac		
	Total:	13	100%				
Deciduous Shrubs	22	25%	CV1	Caprifoliaceae Viburnum	Blue Muffin Viburnum		
	22	25%	CV2	Caprifoliaceae Viburnum	Mohican Viburnum		
	22	25%	RA	Arcaniaceae Rhus aromatica	Fragrant Sumac		
	23	26%	SB	Rosaceae Spiraea betulifolia 'Tor'	Birchleaf Spirea		
	Total:	89	100%				
Evergreen Shrubs	24	25%	BM	Buxaceae Buxus microphylla	Wintergreen Boxwood		
	24	25%	JCK	Cupressaceae Juniperus chinensis 'Kalley'	Kalley Compact Juniper		
	24	25%	JCS	Cupressaceae Juniperus chinensis 'Sea Green'	Sea Green Juniper		
	24	25%	TM	Taxaceae Taxus medeia 'Hicksii'	Hicks Yew		
	Total:	96	100%				

OWNER/DEVELOPER
Pulte Home Company, LLC
1900 East Golf Road, Suite 300
Schaumburg, Illinois 60173
847.230.5284
Contact: Robert Getz, P.E.

ENGINEER
V3 Companies, Ltd.
7325 Janes Avenue
Woodridge, Illinois 60517
630.724.9200
630.724.9200
Project Manager: Bryan Rieger, P.E.
brieger@v3co.com
Project Engineer: Matt Brolley, P.E.
mbrolley@v3co.com

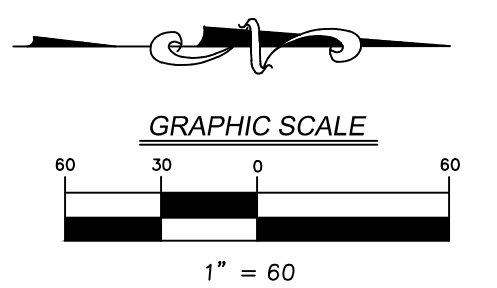

REVISIONS		NO.	DATE	DESCRIPTION
ORIGINAL ISSUE DATE: FEBRUARY 22, 2019		1		
REVISED FOR FINAL PLAN/PLAT REVIEW		1	04-29-19	

PROJECT NO.: 18338
PROJECT MANAGER: BR
DESIGNED BY: MB
DRAWN BY: DB

LANDSCAPE IMPLEMENTATION PLAN
LAURELTON PLACE
PULTE HOMES

AURORA

7325 Janes Avenue
Woodridge, IL 60517
630.724.9200 phone
www.v3co.com

V3

DRAWING NO.
L1.0