

PURCHASING OF FF&E FOR FIRE STATIONS 9 & 13

BUDGET

Station	Estimated Total Cost
Station 9	\$165,000 Budgeted
Station 13	\$290,000 Budgeted
Combined Total	\$455,000

PROCUREMENT METHODS

- Under \$5,000-Due Diligence
- \$5,000-\$25,000-Informal Solicitation
- \$25,000 and over-Formal Solicitation
- For all solicitations over \$25,000
 - Formal Solicitation
 - Cooperative Contract
 - Sole Source

Some items may be able to be bid out by combining packages to receive better pricing

- We've developed detailed estimates based on known needs, current pricing, and similar recent projects. However, until we finalize exact specifications, confirm quantities, and issue quotes or cooperative purchase orders, these numbers are working estimates – not final contracted amounts.
- **3** We want to make sure we have flexibility to adjust for actual vendor pricing, supply chain availability, and any changes in the building's fit-out that might affect the furniture, fixtures, or equipment needs.

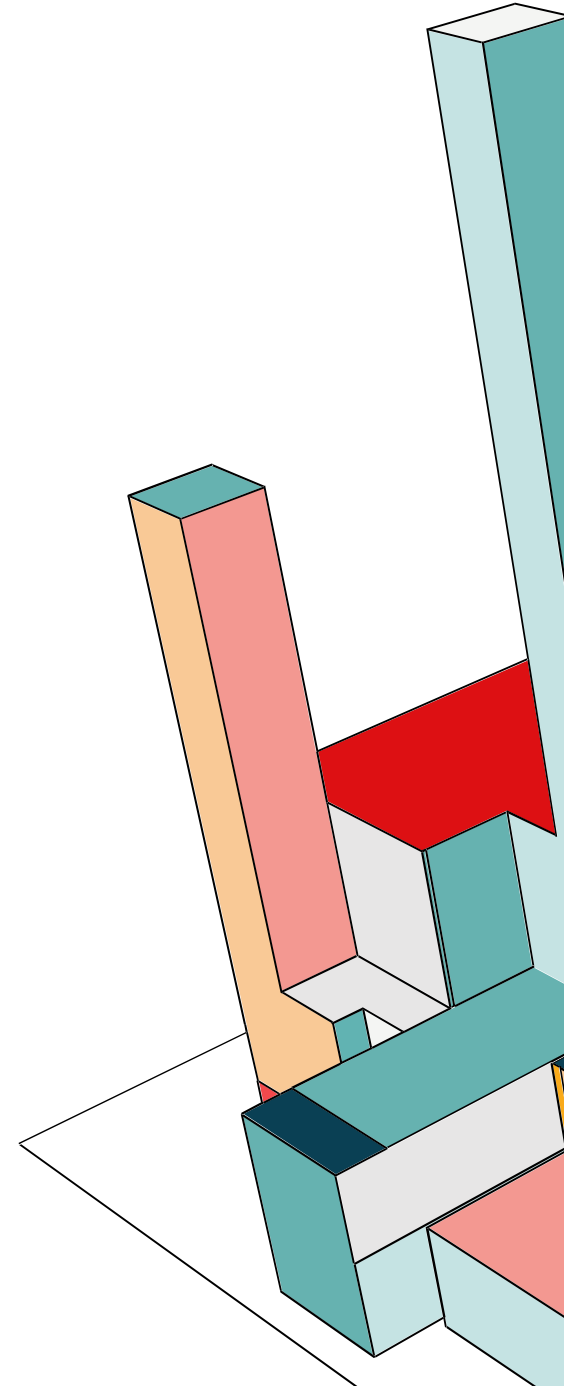

STATION #9



STATION #9 UNDER \$5,000

Station #9 will be bringing many items from the previous location over to the new station.

Items under \$5,000 will be acquired using due diligence and accepting the lowest most responsible bidder

Dishwasher
Ice Maker
Workout Flooring
Range Hood
Under Counter
Fridge, Etc.

Estimated Subtotal:
\$6,816

STATION #9 INFORMAL SOLICITATION \$5,000-\$25,000

Item	Estimated Cost
8 Sleep Number Beds	\$10,520
3 Refrigerators	\$5,694
Stove	\$6,836
Estimated Subtotal	\$23,050
Moving Expenses	TBD

STATION #9 COOPERATIVE CONTRACTS

Item	Quoted Cost
Workout Equipment	\$20,000
Furniture	\$49,330.57
Subtotal	\$69,330.57

STATION #9 COMBINED PROCUREMENT

All items needed out of
Remainder of funds will
be sourced using city
policy procurement
methods

Procurement Method	Estimated Cost
Under \$5,000	\$6,816
Informal Solicitation	\$23,050
Cooperative Contracts	\$69,330.57
Estimated Shipping	\$13,000
Total Cost at this time	\$112,196.57
Remainder	\$52,803.43



STATION #13

STATION #13 UNDER \$5,000

Items under \$5,000 will
be acquired using due
diligence and accepting
the lowest most
responsible bidder

Dishwasher
Ice Maker
Coffee Maker
Washer & Dryer
TV's
Small Appliances
Dishes, Silverware,
pots and pans, Etc.

Estimated Subtotal:
\$36,512.48

STATION #13 INFORMAL SOLICITATION \$5,000-\$25,000

Item	Estimated Cost
11 Sleep Number Beds	\$14,465
3 Refrigerators	\$5,694
Stove	\$6,835.30
Recliners	\$8,000
Kitchen Table	\$6,000
Estimated Subtotal	\$40,994.30

STATION #13 COOPERATIVE CONTRACTS

Item	Quoted Cost
Workout Equipment	\$57,250
Furniture	\$66,019.23
Subtotal	\$123,269.23

STATION #13 SOLE SOURCE

Item	Estimated Cost
Gear Washer	\$17,000
Estimated Subtotal	\$17,000

STATION #13 COMBINED PROCUREMENT

All items procured out of Remainder of funds will be sourced using city policy procurement methods

Procurement Method	Estimated Cost
Under \$5,000	\$36,512.48
Informal Solicitation	\$40,994.30
Cooperative Contracts	\$123,269.23
Estimated Shipping	\$22,000
Sole Source	\$17,000
Total Cost at this time	\$239,776.01
Remainder	\$52,803.43

COMBINED PROCUREMENT

	Procurement Method	Station 9	Station 13	Combined
	Under \$5,000	\$6,816	\$36,512.48	\$43,328.48
	Informal Solicitation	\$23,050	\$40,994.30	\$64,044.30
	Cooperative Contract	\$69,330.57	\$123,269.23	
	Sole Source	-	\$17,000	\$17,000
	Estimated Shipping	\$13,000	\$22,000	\$35,000
	Estimated Total	\$112,196.57	\$239,776.01	\$351,972.58
15	Remainder of Budget	\$52,803.43	\$50,223.99	\$103,027.42

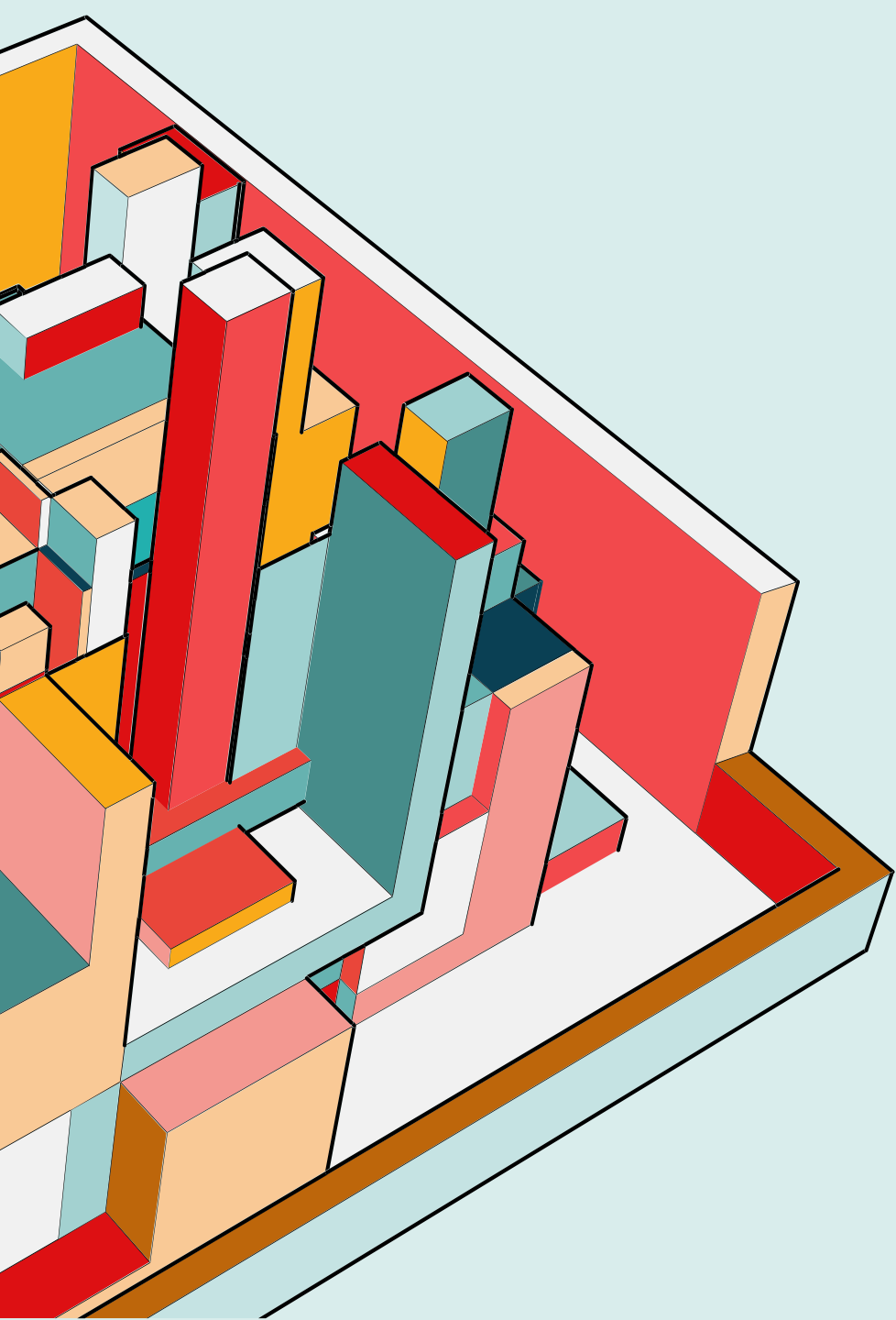

THANK YOU